

POPP

Smart Thermostat

The POPP Smart Thermostat is a connected radiator thermostat for the residential use.

The POPP Smart Thermostat is battery powered, compact and easy to operate with a manual hand wheel and single button. The POPP Smart Thermostat is a Zigbee Certified Product, compatible with the POPP ZB-Stick, ZB-Shield and with the third party certified systems using Zigbee technology.

The POPP Smart Thermostat is easy to install, in just 30 seconds!



Features

- Programming and control via a Zigbee gateway
- Energy savings
- Easy to install
- Easy to operate
- The Manual mode
- The Open-window function
- The PID Accurate temperature control
- The Adaptive learning
- Easy to read LCD display
- Display rotation -180 degrees
- Min./max. temp. range
- The Child lock function
- The Frost protection function
- The Valve exercise function
- Backlit display
- Battery life time up to 2 years
- The Visual warning of low battery

Installation of the POPP Smart Thermostat

1. Start to identify the valve by comparing the shape of the valve body with the red lines and mount the right adapter.

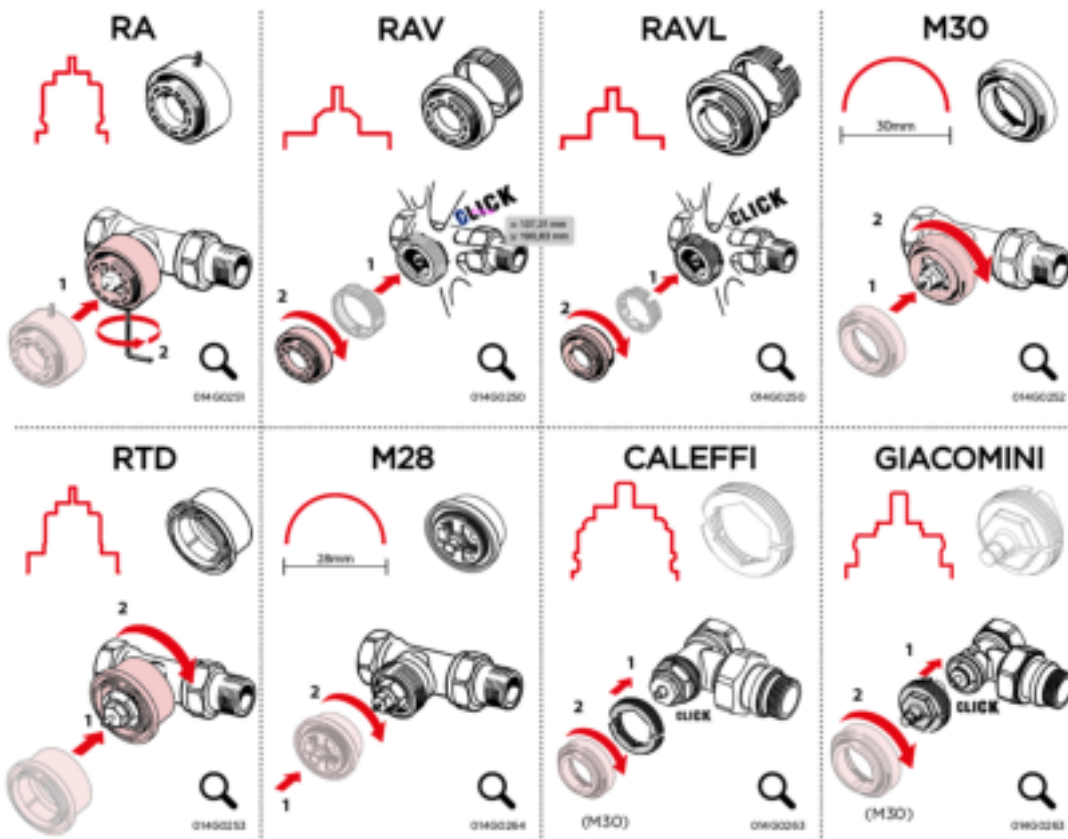

The following adapters are included in the scope of the delivery. Remaining adapters in the overview can be purchased separately. Adapter code number can be found below each adapter illustration.



POPP

2. Insert the batteries, then mount the thermostat onto the adapter by turning it until you hear a click. Leave the POPP Smart Thermostat in Mounting mode, which will be shown by the "M" on the display.

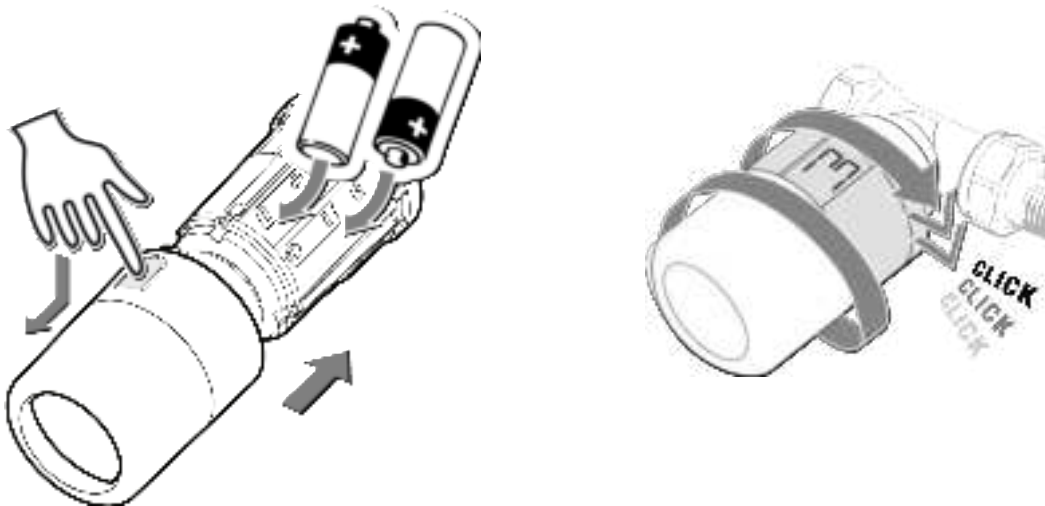

3. Open your Zigbee enabled gateway App or user interface. Look up the Gateways user manual to get the instructions, how you start the Zigbee connecting mode in your App or user interface.
4. Start the Zigbee connecting mode in your gateways App or User interface.
5. Press the button on the POPP Smart Thermostat once. The connecting symbol on the Screen will start to flash.

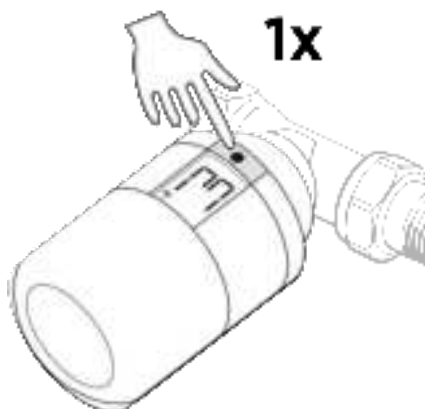

6. The POPP Smart Thermostat will appear in your gateways app or user interface.

7. Finish the installation by pressing the button on the POPP Smart Thermostat for 3 seconds. The Thermostat will end its mounting mode and will show the set on the screen.

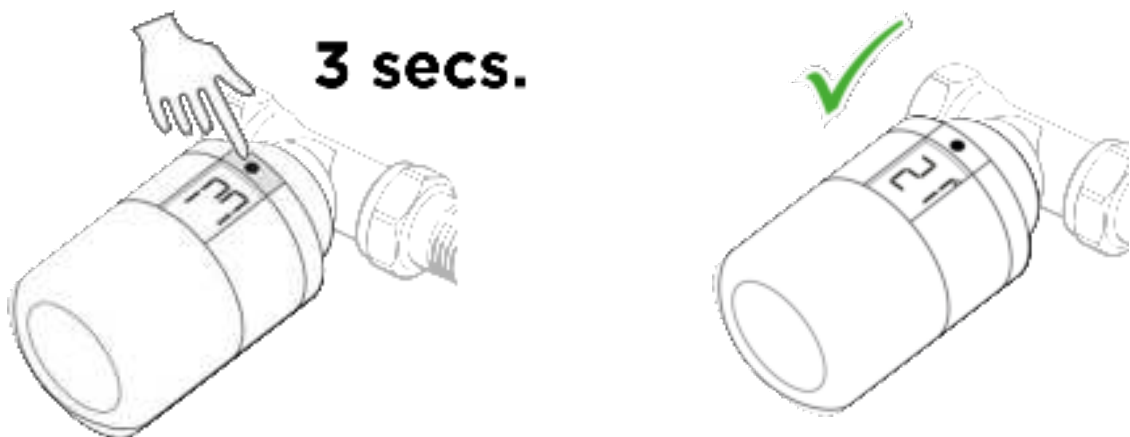

Troubleshooting

The POPP Smart Thermostat will not connect to your gateway

1. Remove one battery.
2. Hold the button on the POPP Smart Thermostat while inserting the battery. The display will start flashing. Release the button, when the display stops flashing. The POPP Smart Thermostat is now reset to factory default.
3. The POPP Smart Thermostat will change into the mounting mode. You will see the "M" on the screen of the POPP Smart Thermostat. Now repeat the Installation of the POPP Smart Thermostat with your Zigbee Gateway.