

Acer CastMaster WPS1 Web Setting Manual



Introduction

Thanks for choosing Acer CastMaster.

Acer CastMaster can support up to four mobile devices as input sources, casting the content to the same output screen simultaneously.

Also, Acer CastMaster is user-friendly to heterogeneous platforms, supporting Android, iOS, Windows, and Mac, which greatly enhances the availability for business, education or meeting usage scenarios.

Configuring your CastMaster via Web

For CastMaster, user may configure their device via a web browser interface, which greatly enhances user experience.

In CastMaster's Web setting sections, customers may do custom setting including output resolution, preferred language, max connections, etc, based on different needs and usage scenarios.

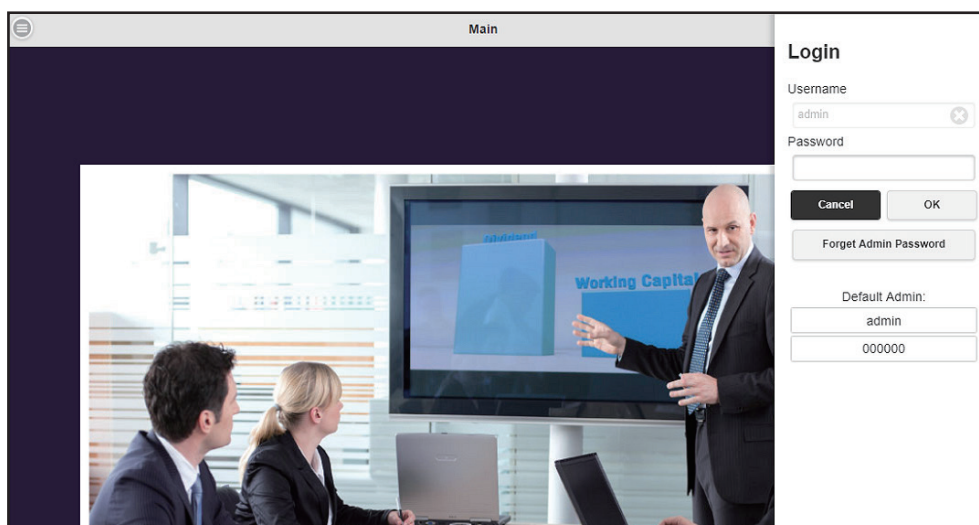

Begin to set with CastMaster

To access Web settings with CastMaster, please follow the below instructions, connecting your phone or laptop to CastMaster. We provide user with two connecting methods: Direct Link or Through Wi-Fi.

1. Connecting through Direct Link

- 1.1 Connecting CastMaster to an external power supply.
- 1.2 Connecting CastMaster to an external display via HDMI port.

Once the above steps are done, users will see the below standby screen on the external display.

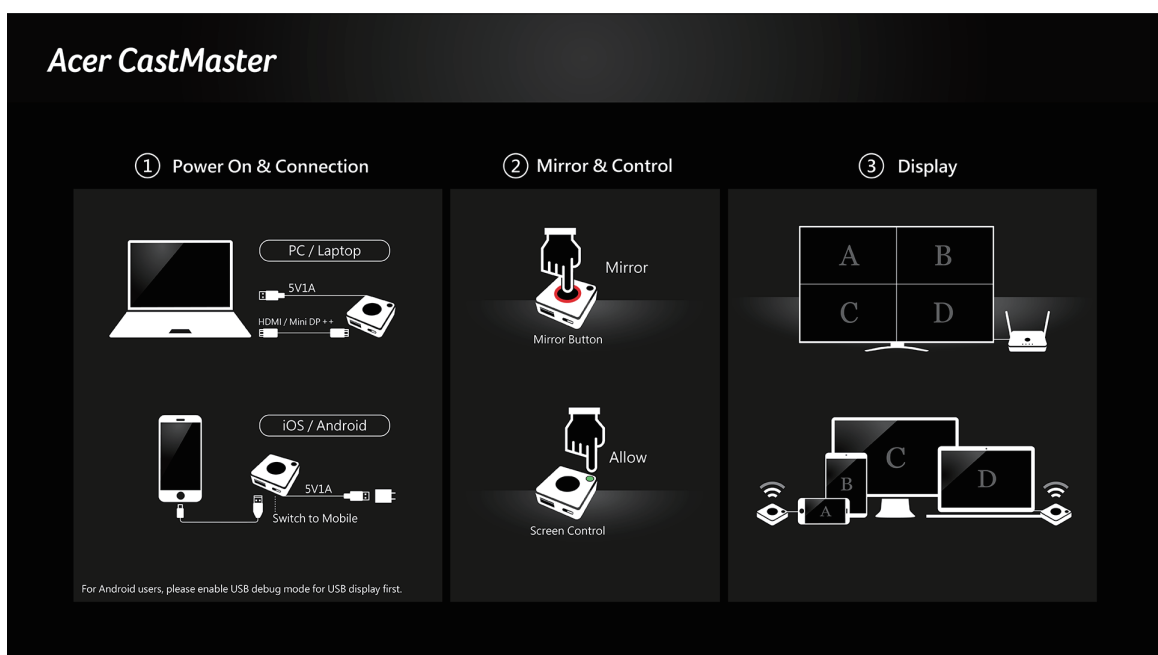

- 1.3 User may see the required information for connection at the upper middle of the standby screen: SSID and Password.



- 1.3.1 SSID: Selecting the correct SSID in the device's Wi-Fi list
- 1.3.2 Password: Entering the password to connect your device with CastMaster

- 1.4 Once connected, open your web browser, entering the IP address at the URL bar. You may see the IP address at the bottom left corner. Please note that the below IP is for reference only, which may vary depending on the device.

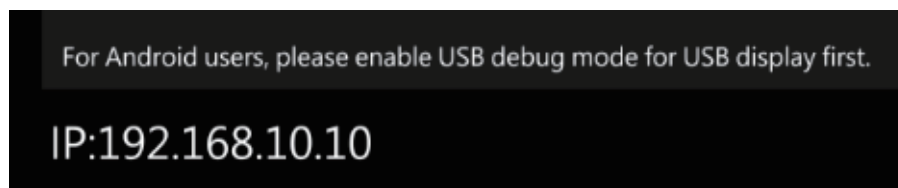

- 1.5 You may see the Web Setting Page once successfully connected.

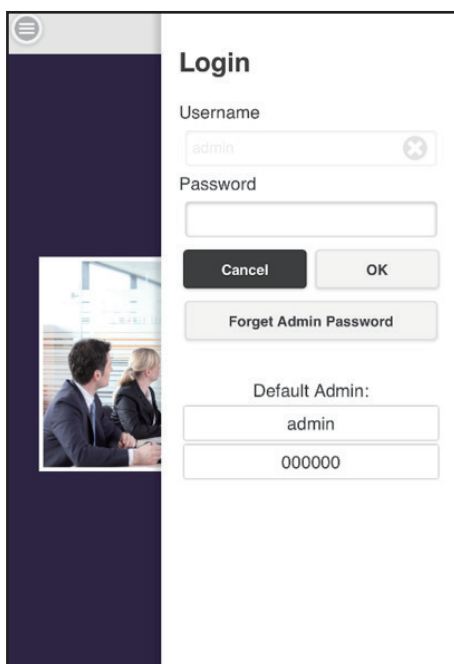

2. Connecting Through Wi-Fi or External AP

- 2.1 If CastMaster is connected to the internet, the Wi-Fi icon will be displayed at the upper right corner of the standby screen.



- 2.2 Entering the IP address at the URL bar. You may see the IP address at the bottom left corner. Please note that CastMaster and mobile device must facilitate the same network.

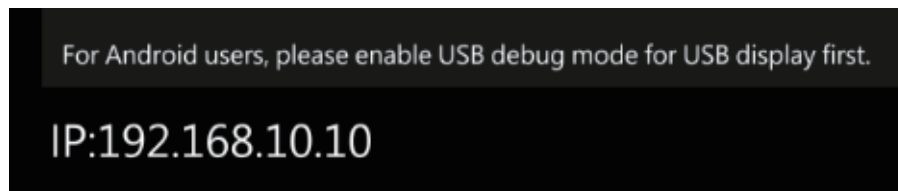

- 2.3 You may see the Web Setting Page once successfully connected.

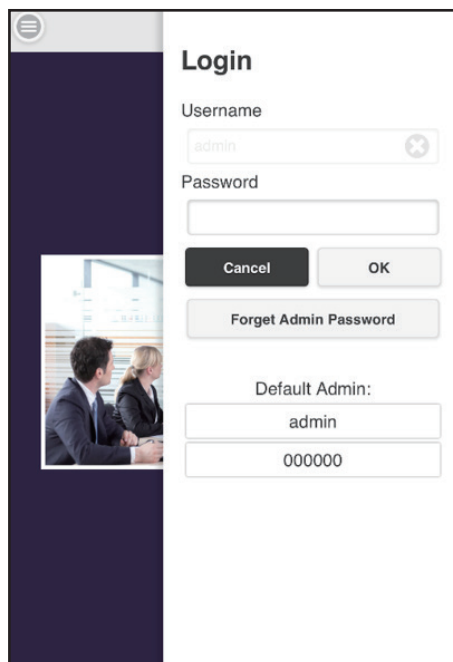

Web Setting Home Page

User may see two icons at Web Setting Home Page. Each of them serves a different purpose.

1. Upper Right Icon-Login as Admin



- 1.1 Press this icon and login as an Admin role. Please note that the first time login as Admin user, entering the default password “000000”.

Login

Username

Password

Cancel **OK**

[Forget Admin Password](#)

- 1.2 To provide better security for CastMaster, user must modify the default admin password.

Admin Password

Change Admin Password

New Password

Confirm Password

Apply

2. Upper left Icon-CastMaster Setting



After pressing, the left side menu will pop out, providing user with different options about device configuration. CastMaster is designed with two login mode: Non-Admin and Admin.

2.1 Non-Admin User

A user is provided with normal access control right, including Device Management, Network Management, etc.

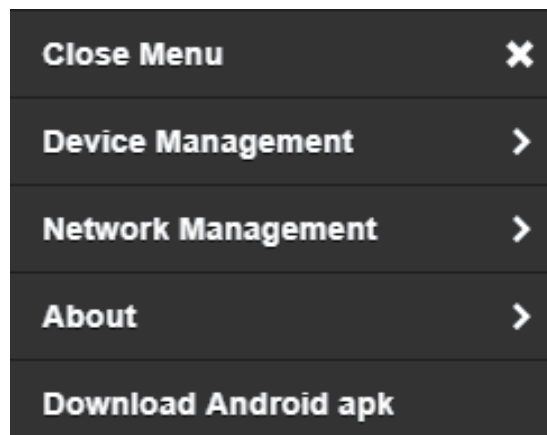

2.2 Admin User

An Admin User is provided with the finer granularity of access control right.

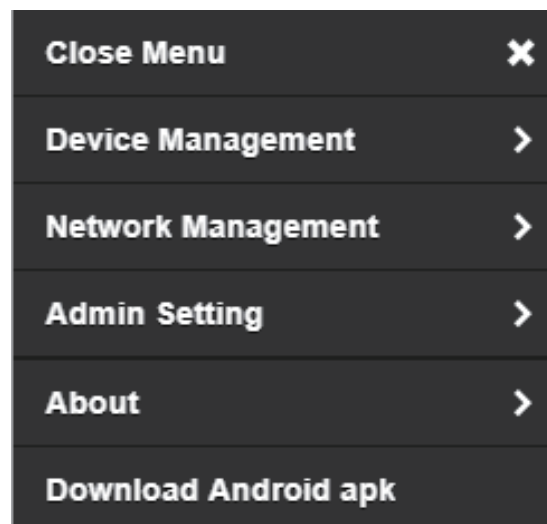

Start Configuring your CastMaster

In the following section, we will elaborate on the details of each configuration option.

1. Close Menu

When clicking the “X” mark, the window will return to Web Setting Home Page.

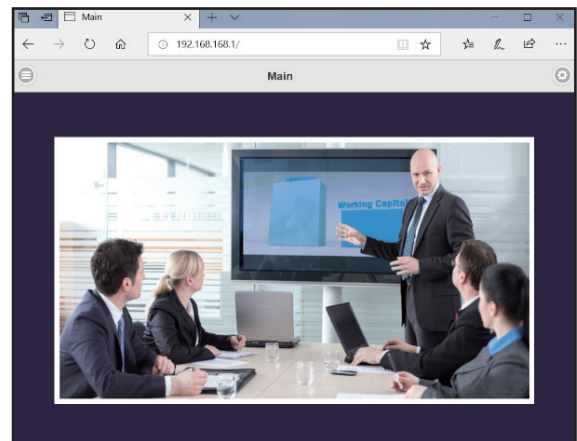
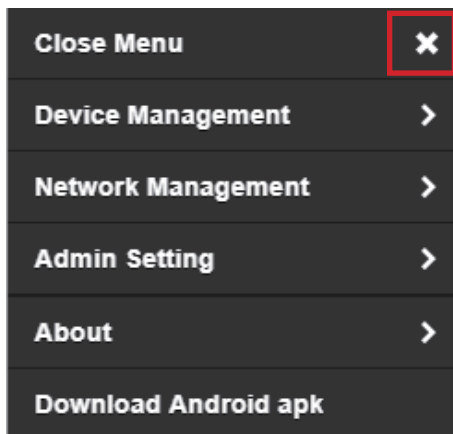

2. Device Management

CastMaster provides users with the following configuration options, including Language, Resolution, Max Connections, and Download Pairing File.

2.1 Language: Supporting mainstream languages, such as English, German, French, Chinese, etc.

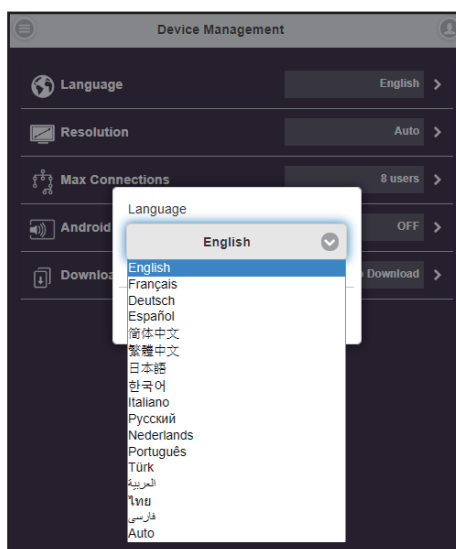

- 2.2 Resolution: CastMaster will select proper output resolution automatically. User may switch to other options based on different usage scenarios.

The default output resolution will be 1920 x 1080_60P. CastMaster can support up to 4K with frame rate 24P.

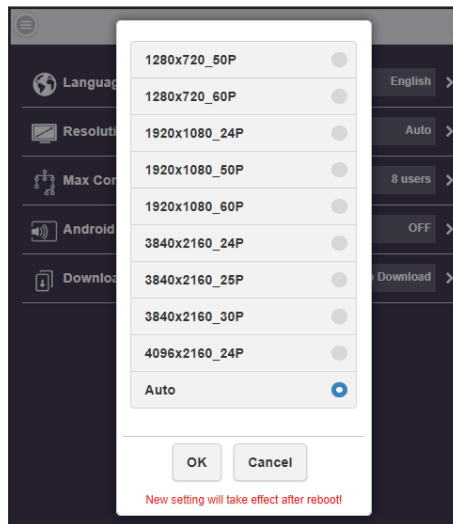

- 2.3 Max Connections: Host may decide the number of devices that allowed to connect to CastMaster. The default setting of connections is 8 users.

Please note that with the rising of connected devices, the lower network bandwidth would have for each user.

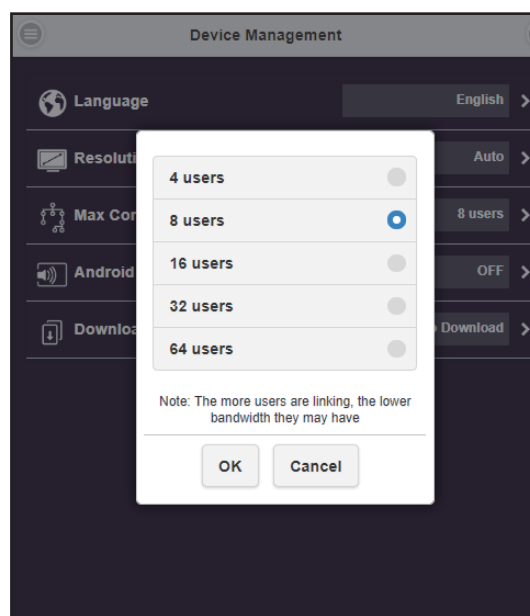

- 2.4 Download Pairing File: Download the required file for pairing receiver and transmitter.

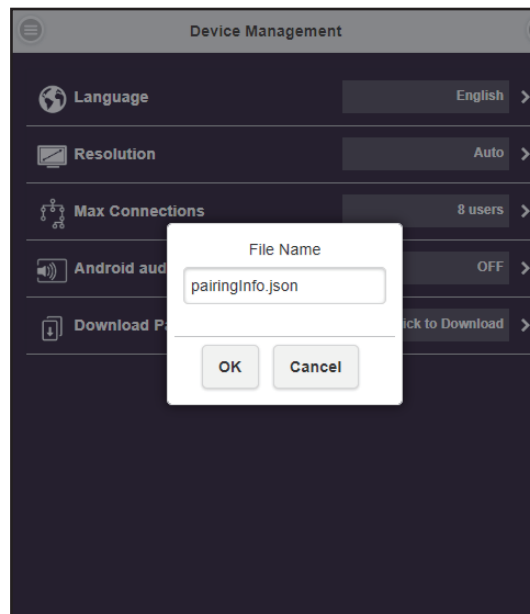

3. Network Management

Connecting CastMaster to the internet through external Wi-Fi or LAN.

- 3.1 Connect to 5Ghz Wireless Access Point: Once your device is connected to CastMaster, entering the required password to access to an external Wi-Fi.

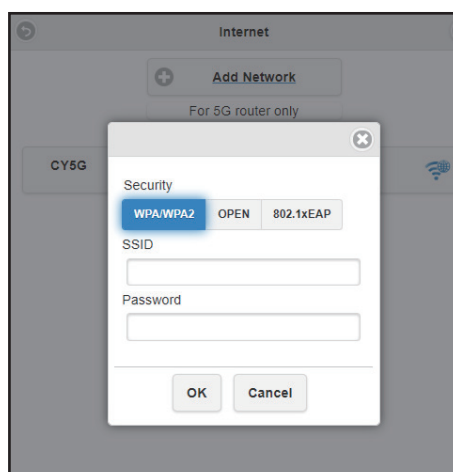

- 3.2 Remember Wi-Fi:

- 3.2.1 Remember Wi-Fi On: CastMaster will remember the previous Wi-Fi configuration.

3.2.2 Remember Wi-Fi Off: CastMaster will erase the Wi-Fi configuration once disconnected.

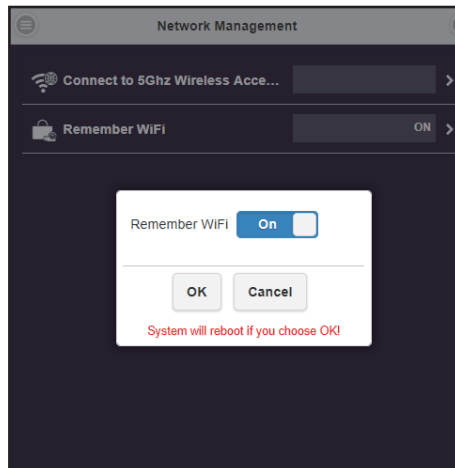

4. Admin Setting

Admin Setting is designed for advanced users, including MIS Engineer, IT specialist, Network admin, etc. In Admin Setting section, CastMaster provides users with various custom configurations.

- **Wi-Fi Channel:** Setting up Wi-Fi Channel. CastMaster provides the below three options:
 1. Country
 2. Channel
 3. Bandwidth

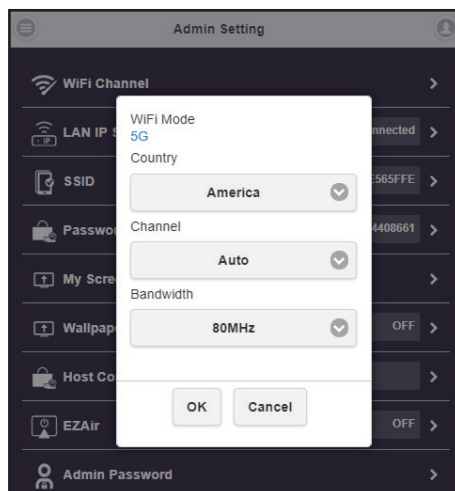

Please note that user can only configure Wi-Fi Channel while CastMaster is not connected to Wi-Fi.

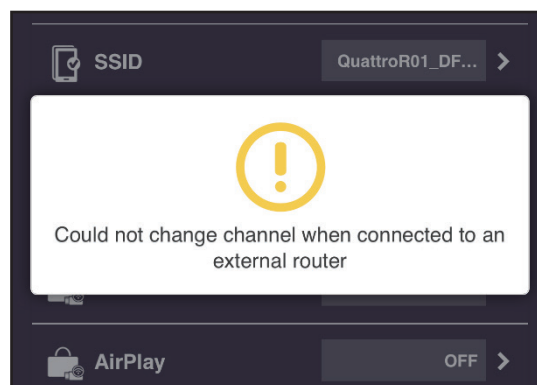

- LAN IP Setting: Configuring LAN network, including IP address, Gateway, Netmask, DNS, etc.

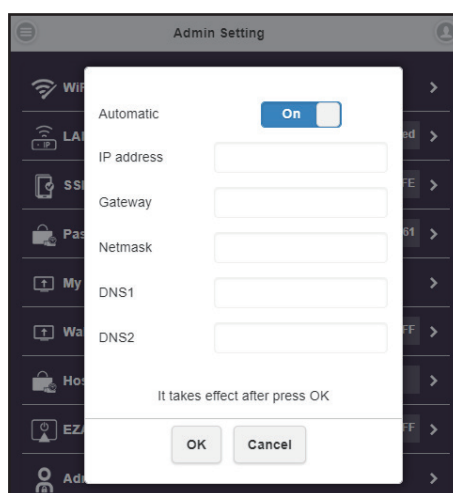

- SSID: Custom setting for SSID, including renaming, Hide SSID or Turn Off SSID.
 1. Hide SSID: Hide SSID from the standby screen. Please make sure you've written it down.

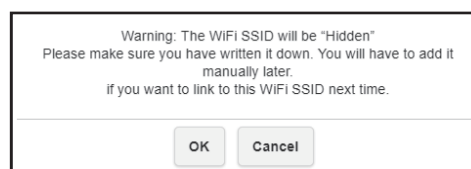

2. Turn Off SSID: Deactivating CastMaster's SSID function. Please make sure that the device is already connected to LAN.

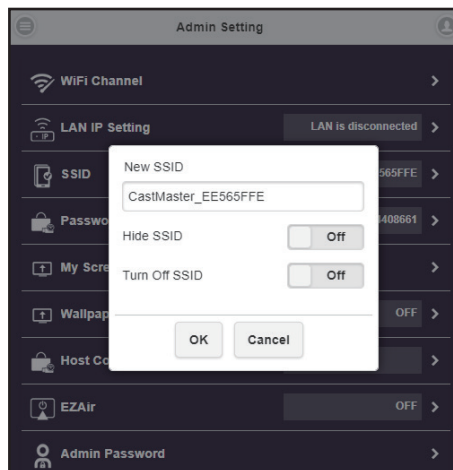

- Password: Change CastMaster's Wi-Fi connection password.
To provide better connection security, an admin may hide the Wi-Fi password from the standby screen.

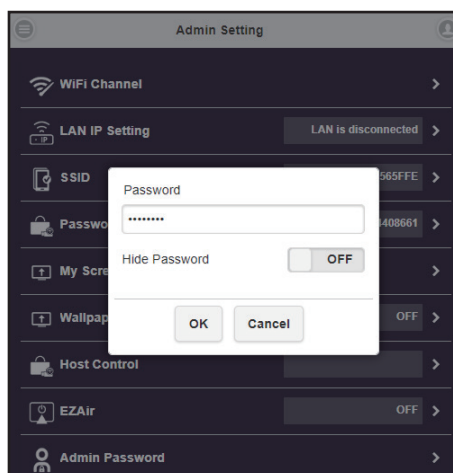

- My Screen: User may replace the default theme of standby screen by uploading photos. Please make sure the image format is JPEG in 1920 x 1080 and smaller than 3MB.

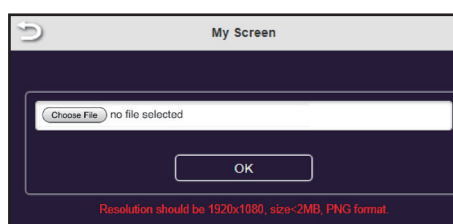

- Host Control: Admin can control other casting devices.
 1. Auto Allow Request: Once turned on, other devices can cast content to output screen directly.

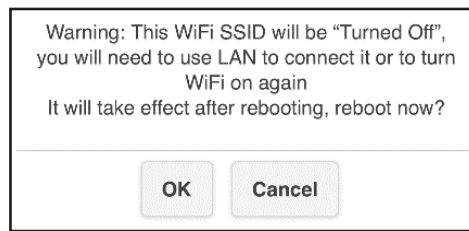

2. Share Screen: Once turned on, based on the number of connected devices, the output screen will be split into one-half or one-quarter.
- AirPlay: AirPlay function is turned off by default. iOS, OSX users may turn on to utilize AirPlay, native casting function provided by iOS or Mac OS.
 - Admin Password: To provide better security, we suggest that user may change an Admin Password regularly.

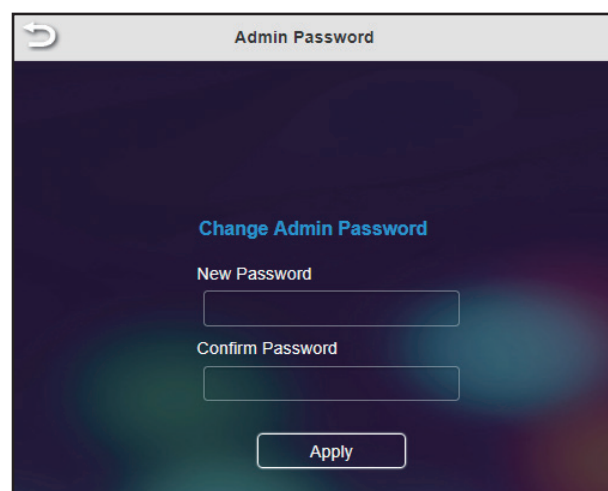

- Screen Saver: Specifies how much user idle time must elapse before the screen saver is launched.

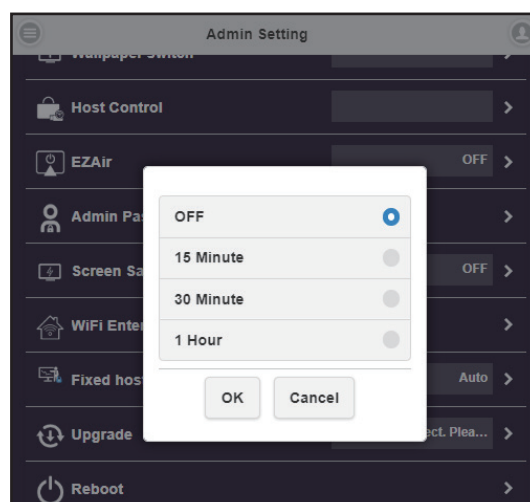

- **WiFi Enterprise:** Wi-Fi Enterprise function allows a user to upload a Digital certificate. This function is designed for the advanced user, including MIS Engineer, Network Admin, etc.

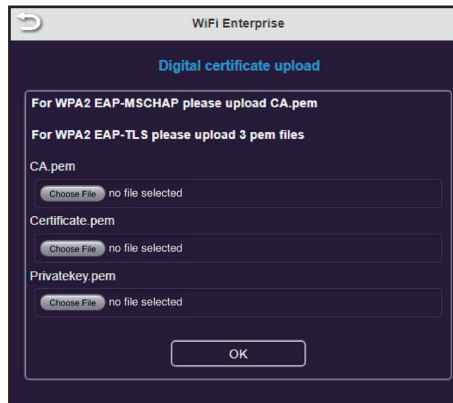

- **Upgrade:** Upgrade your CastMaster receiver and transmitter's firmware to latest version. Please make sure CastMaster is connected to the internet during the updating process.

To better enhance user experience, it is highly recommended that maintaining the consistency of devices' firmware version, both CastMaster receiver and transmitter.

The following section elaborates on details process of firmware update.

1. Please make sure CastMaster receiver is connected to the internet.
 2. Connect CastMaster transmitter to an external power supply. Please make sure your transmitter has been paired with receiver.
 3. Click "Select All", allowing user to update all CastMaster devices at once.
 4. Press "Update" button to activate the download process. The whole process will be done within a few minutes, please be patient.
- **Reboot:** User may reboot device when new configuration applied to CastMaster.

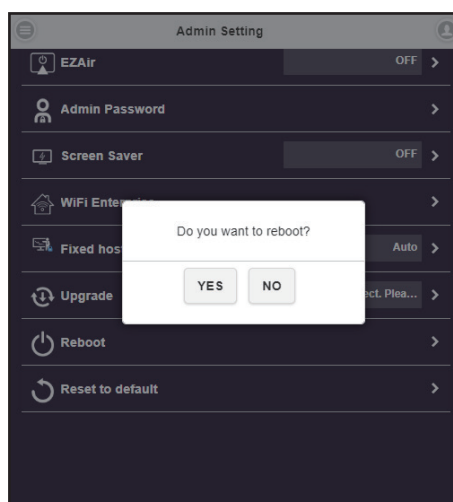

- Reset to default: Reset CastMaster to factory defaults. Please note that all the custom configuration will be cleared.

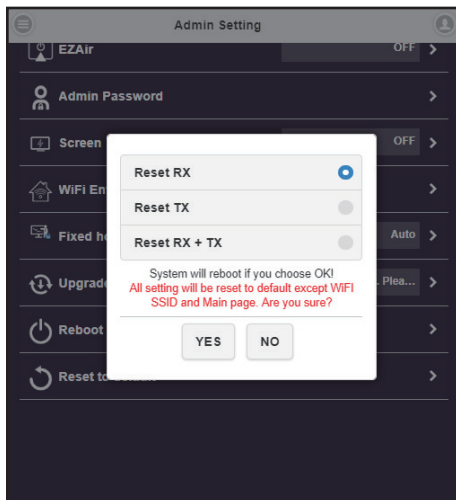

1. Reset RX: Reset CastMaster receiver only.
2. Reset TX: Reset CastMaster transmitter only.
3. Reset RX + TX: Reset both CastMaster receiver and transmitter.

5. About

Showing details device information about CastMaster, including SSID, Firmware Version, Wi-Fi Channel, etc.

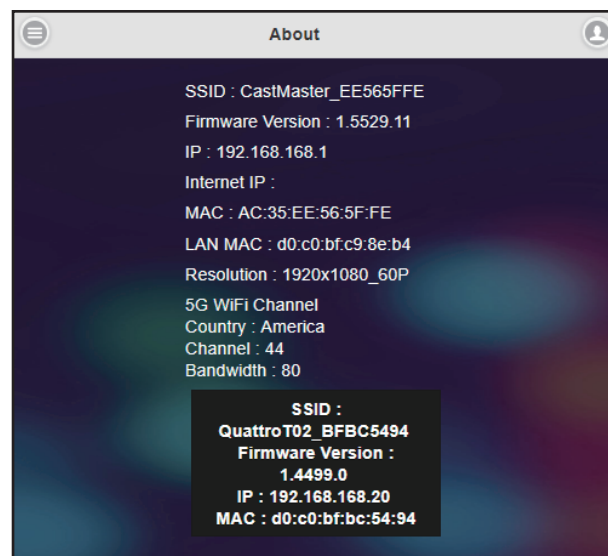

6. Download Android APP

For Android users, please enable USB debugging mode for USB display first, or you can download CastMaster APK from CastMaster's webpage or Google Play.

Users who download APK from CastMaster receiver's webpage, CastMaster may need your further authorization and trust to install APK file, since this APK is not directly downloaded from Google Play.

