



INSTRUCTION MANUAL

Pet Grooming Vacuum

A03-PGV-001-RD



DESCRIPTION OF THE SYMBOLS

The use of symbols in this manual is intended to draw your attention to possible risks. The safety symbols and the explanations that accompany them must be perfectly understood. The warnings in themselves do not remove the risks and cannot replace correct actions for preventing accidents.



This symbol, marking a point of safety, indicates a caution, warning or danger. Ignoring this warning can result in an accident to yourself or others. To limit the risks of injury, fire or electrocution, always follow the recommendations indicated.



WARNING – To reduce the risk of injury, user must read instruction manual. Before any use, refer to the corresponding section in this user manual.



The crossed-out wheeled bin symbol indicates that the item should be disposed of separately from household waste. The item should be handed in for recycling in accordance with local environmental regulations for waste disposal. By separating a marked item from household waste, you will help reduce the volume of waste sent to incinerators or land-fill and minimize any potential negative impact on human health and the environment.

GENERAL POWER TOOL SAFETY WARNINGS



WARNING Read all safety warnings and all instructions. Failure to follow the warnings and instructions may result in electric shock, fire and/or serious injury.

Save all warnings and instructions for future reference.

The term "power tool" in the warnings refers to your mains-operated (corded) power tool or battery-operated (cordless) power tool.

1. Work area safety

- a) **Keep work area clean and well lit.** Cluttered or dark areas invite accidents.
- b) **Do not operate power tools in explosive atmospheres, such as in the presence of flammable liquids, gases or dust.** Power tools create sparks which may ignite the dust or fumes.
- c) **Keep children and bystanders away while operating a power tool.** Distractions can cause you to lose control.

2. Electrical safety

- a) **Power tool plugs must match the outlet. Never modify the plug in any way. Do not use any adapter plugs with earthed (grounded) power tools.** Unmodified plugs and matching outlets will reduce risk of electric shock.
- b) **Avoid body contact with earthed or grounded surfaces, such as pipes, radiators, ranges and refrigerators.** There is an increased risk of electric shock if your body is earthed or grounded.
- c) **Do not expose power tools to rain or wet conditions.** Water entering a power tool will increase the risk of electric shock.
- d) **Do not abuse the cord. Never use the cord for carrying, pulling or unplugging the power tool. Keep cord away from heat, oil, sharp edges or moving parts.** Damaged or entangled cords increase the risk of electric shock.
- e) **When operating a power tool outdoors, use an extension cord suitable for outdoor use.** Use of a cord suitable for outdoor use reduces the risk of electric shock.
- f) **If operating a power tool in a damp location is unavoidable, use a residual current device (RCD) protected supply.** Use of an RCD reduces the risk of electric shock.

3. Personal safety

- a) **Stay alert, watch what you are doing and use common sense when operating a power tool. Do not use a power tool while you are tired or under the influence of drugs, alcohol or medication.** A moment of inattention while operating power tools may result in serious personal injury.
- b) **Use personal protective equipment. Always wear eye protection.** Protective equipment such as dust mask, non-skid safety shoes, hard hat, or hearing protection used for appropriate conditions will reduce personal injuries.
- c) **Prevent unintentional starting. Ensure the switch is in the off-position before connecting to power source and/or battery pack, picking up or carrying the tool.** Carrying power tools with your finger on the switch or energising power tools that have the switch on invites accidents.
- d) **Remove any adjusting key or wrench before turning the power tool on.** A wrench or a key left attached to a rotating part of the power tool may result in personal injury.
- e) **Do not overreach. Keep proper footing and balance at all times.** This enables better control of the power tool in unexpected situations.
- f) **Dress properly. Do not wear loose clothing or jewellery. Keep your hair, clothing and gloves away from moving parts.** Loose clothes, jewellery or long hair can be caught in moving parts.
- g) **If devices are provided for the connection of dust extraction and collection facilities, ensure these are connected and properly used.** Use of dust collection can reduce dust-related hazards.

4. Power tool use and care

- a) **Do not force the power tool. Use the correct power tool for your application.** The correct power tool will do the job better and safer at the rate for which it was designed.
- b) **Do not use the power tool if the switch does not turn it on and off.** Any power tool that cannot be controlled with the switch is dangerous and must be repaired.
- c) **Disconnect the plug from the power source and/or the battery pack from the power tool before making any adjustments, changing accessories, or storing power tools.** Such preventive safety measures reduce the risk of starting the power tool accidentally.
- d) **Store idle power tools out of the reach of children and do not allow persons unfamiliar with the power tool or these instructions to operate the power tool.** Power tools are dangerous in the hands of untrained users.
- e) **Maintain power tools. Check for misalignment or binding of moving parts, breakage of parts and any other condition that may affect the power tool's operation. If damaged, have the power tool repaired before use.** Many accidents are caused by poorly maintained power tools.
- f) **Keep cutting tools sharp and clean.** Properly maintained cutting tools with sharp cutting edges are less likely to bind and are easier to control.
- g) **Use the power tool, accessories and tool bits etc. in accordance with these instructions, taking into account the working conditions and the work to be performed.** Use of the power tool for operations different from those intended could result in a hazardous situation.

5. Service

- a) **Have your power tool serviced by a qualified repair person using only identical replacement parts.** This will ensure that the safety of the power tool is maintained.
- b) **Caution!**
If the replacement of the supply cord is necessary, this has to be done by the manufacturer or his agent in order to avoid a safety hazard.

SAFETY WARNING AND DAILY APPLICATION

- Any other use not explicitly stated in this manual may cause equipment damage and pose serious danger to users.
- This product is only for domestic use, not for commercial or industrial purposes, nor for outdoor or humid environments.
- It is prohibited to give this product to children or individuals with low physical, sensory or intellectual abilities or lack of experience and knowledge for independent use.
- Those who can use the product safely should fully understand the safe use methods and risks of the product. Children should not use the product unless under the supervision of adults with the above conditions.
- Pay full attention to safety when using the product and accessories. Prohibit to use the products as toys for children.
- Please do not touch the power plug and this product with wet hands, and do not suck hair and liquid.
- Please do not use this product when the power cord or power plug is damaged.
- Please do not disassemble the product. The wrong assembly method may lead to electric shock or fire. Please dial the after-sales service phone when there is a need for maintenance.
- Please do not inhale flammable or combustible liquids such as gasoline, and do not use them in or near the environment with flammable and combustible gases.
- Do not pull the power cord forcibly, do not place heavy objects on the upper part of the machine, and be careful to clamp the power cord when closing the cover.
- It is strictly prohibited to inhale cigarettes and matches with hot soot and other burning, smoking and high-temperature objects.
- Please do not put things on the suction mouth or block the suction mouth when use.
- After use and before maintenance or parts replacement, please pull the plug out of the socket, and it is strictly prohibited to operate with power on.
- Those shall not be stored outdoors or places that may easily get wet.
- Please do not use products with aromatic agents and strong fragrance to clean the filter. Chemicals may cause fire.
- If the power cord is damaged, please contact professional maintenance personnel to replace it. Non-professional personnel are not allowed to replace it without authorization.

Caution!

- Please do not operate or plug the power cord with wet hands to avoid failure or electric shock, it is strictly prohibited
- Those who do not smoke cigarette butts and other highly combustible materials;
- Please do not use it in places with combustible gas or liquid;
- Inhalation of highly flammable gases or liquids may cause fire or explosion
- When using for the first time, pay attention to whether there is peculiar smell in the use process. If there is a persistent burning smell, please stop using immediately;
- Please keep the dust cup and filter clean for a long time;
- Long term use with dirty dust cups and filters may lead to unpredictable situations such as increased machine load and overheating
- During maintenance, you must unplug the power cord and cut off the power supply of the machine before operation;
- When the power supply is not disconnected, there will be electric shock, accidents and injuries caused by accidental startup during maintenance
- If the temperature of the machine rises abnormally during use, please stop using it immediately;
- In case of abnormal heating of the motor, please stop the operation. If the suction port is blocked, please stop the operation in time, take out the dust cup, confirm that the suction port and filter are clean, and then open them 30 minutes later
- Please be sure to use each filter when it is completely installed;
- Please be sure to install and use the filter. Removing the filter may lead to uncontrollable faults such as motor stalling, abnormal motor temperature, etc
- Those who must pay attention to sharp knife edges to avoid scratches;
- Some accessories have sharp cutting edges due to functional requirements. Please pay attention to safety when using

INTENDED USE

The machine is designed for pet cleaning up, which integrates grooming, de-shedding, trimming, dry, and vacuum cleaning functions.

LIST OF MAIN PART

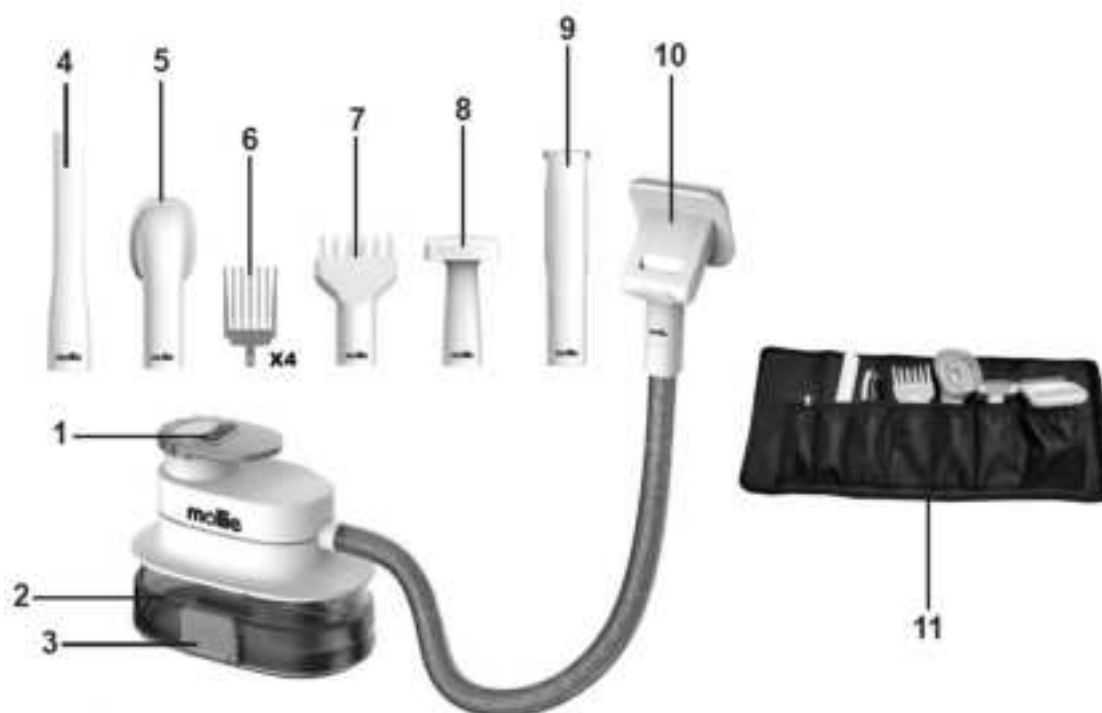

1. On/off switch & speed regulator	2. Dust collection tank
3. Dust collector latch	4. Blowing & vacuuming nozzle
5. Cleaning brush	6. Guard Combs x 4pcs
7. Hot hair dryer	8. De-shedding head
9. Trimming head	10. Grooming head
11. Storage bag for accessories	

TECHNICAL SPECIFICATIONS

Model	A03-PGV-001-RD
Voltage	120V~60Hz
Input power	300W
Heating power	200W
Capacity of dust tank	4L

OPERATION

Before use

Remove any packing material and loose parts from unit.

Check the accessories before use. It should be fit with the machine and your purpose.



The machine makes certain noise when operation. To help your pets adapt to it, before any operation, please start it up for a while and keep it away from pets. Then continue your cleaning and grooming work.

Operation

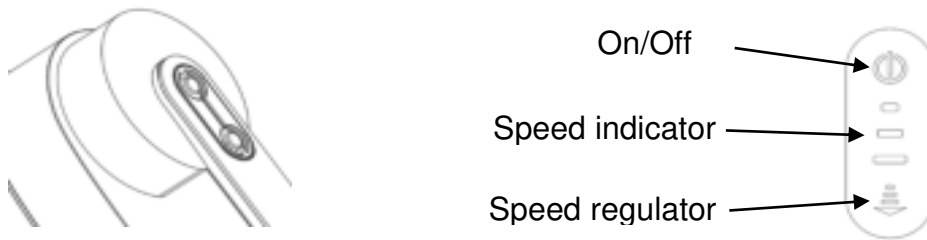

1. Press the on/off switch to turn on the machine, it will automatically start at the lowest speed.
2. Press the speed regulator button to select speed required for different application scenarios.

Selection of accessories

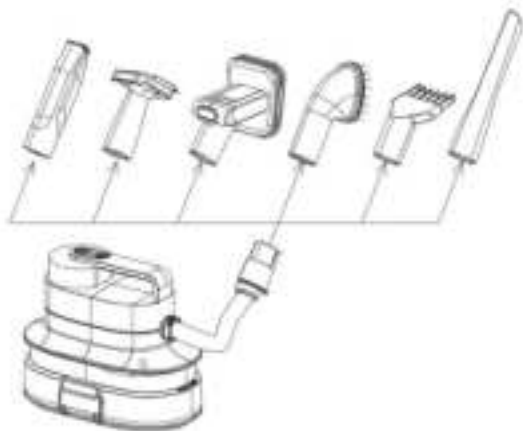

1. Connect the accessory head to machine through hose.
 2. Choose suitable head for different application scenarios.
- Trimming head can shave the pet's hair and inhale it into the dust cup at the same time, so as to ensure that there is no residue and flying hair during process.
Caution! Scissors have sharp edges, do not apply excessive force to prevent people and pets from being scratched.
 - Guard Combs, with 4 detachable Guard Combs: 6mm/12mm/18mm/24mm to be installed on the trimming head, which is convenient to trim hair of different lengths and create different hair style.



- De-shedding head, install the head to the flexible hose, turn on the machine to remove loose hair and suck adhering dirt on pet to the dust cup.



- Grooming head, use a grooming brush to gently remove hair and dander from pup's coat while eliminating tangles and preventing mats. In addition, it is ideal for distributing natural oils through pup's coat to make their hair healthy, shiny, and soft.



- Cleaning brush, to collecting pet hair falling on the carpet, sofa and floor.



- Hot hair dryer, the temperature of the hot air is about 40°C. Use a hot hair dryer to quickly dry your hair while combing/massaging/scratching your pet.



- Blowing & vacuuming nozzle, quickly dry the pet hair, blow or absorb the fallen hair and dust.



In box it contains below storage bag for better accessories collection.



Blow suction conversion

Rotate the hose interface left and right to realize free switching between vacuum and hot air blowing.

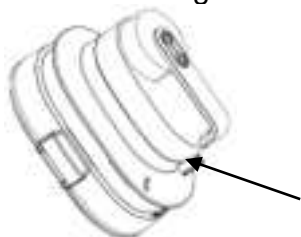

Converter for blow & vacuum

This product is with vacuum and blow two functions.

With below state, the machine is on vacuum model, please follow below steps for model change:



1. Turn the converter 180° to the left, the model will change from vacuum to blow as below



2. If needs vacuum function, turn the converter 180° back to the first place.

Cleaning the dust cup

To clean the dust cup, aim at the trash can, push the latch on whether side (one on each side, total two) to pour out the trash, then simply snap the dust cup cover to close.

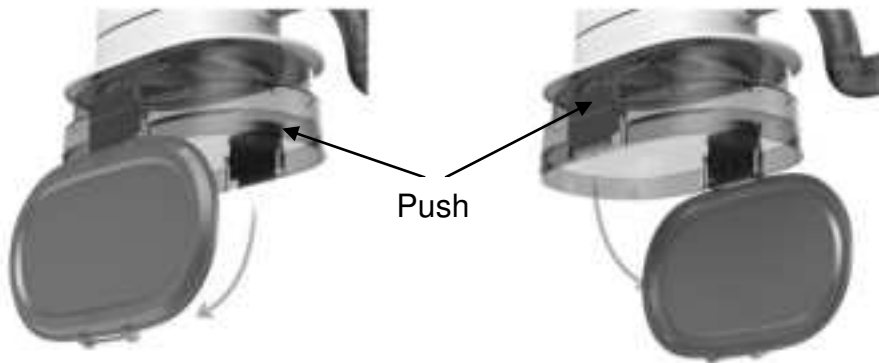

MAINTENANCE

Cleaning of dust cup

1. pour out the dust in the dust cup
2. remove the dust cup
3. clean the dust cup
4. dry the dust cup
5. install the dust cup

Scissor care

1. Remove the cutter head
2. Remove dust at suction port
3. Store in dry and clean places

Filter cleaning

1. Remove the dust cup and take out the filter
2. Clean the filter with water, then drain in the shade
3. Natural drying for at least 24 hours in good places
4. After complete drying, install the filter and dust cup

Keep the ventilation openings clear and clean the product regularly.

If something unusual occurs during use, switch off the supply and disconnect the plug. Inspect and repair the tool before using it again. The repairs must be carried out by a qualified technician.

Repair of the tool must only be carried out by a qualified repair technician.

Repair or maintenance by unqualified personnel can lead to a risk of injury.

Use only identical spare parts for repairing a tool. Follow the instructions in the maintenance section of this user manual.

Caution!

If the supply cord of this power tool is damaged, it must be replaced by a specially prepared cord available through the service organization.

Care and cleaning

Clean the housing only with a damp cloth-do not use any solvents! Dry thoroughly afterwards.

STORING

Store the machine, operating instructions and where necessary the accessories in the original packaging. In this way you will always have all the information and parts ready to hand.

Pack the device well or use the original packaging in order to avoid transit damage. Always keep the machine in dry place.

