



> QUICK START GUIDE



VOID PRO RGB

WIRELESS

PREMIUM GAMING HEADSET WITH DOLBY HEADPHONE 7.1



PACKAGE CONTENTS

- A** CORSAIR VOID PRO RGB Wireless headset
- B** Wireless Transmitter (USB)
- C** Base station for wireless transmitter (Special Edition models only)

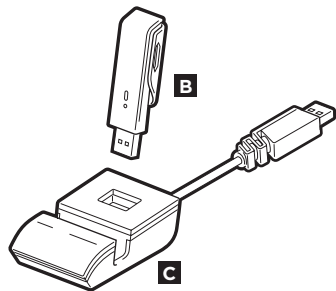

- D** Charging cable (USB, 2.0m)
- E** Microphone foam windscreen (removable)
- F** Quick start guide

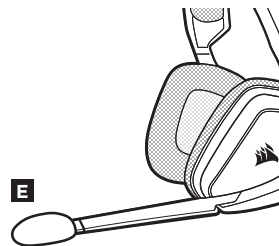
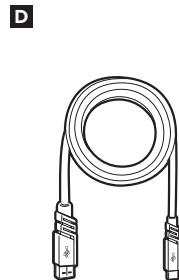

F

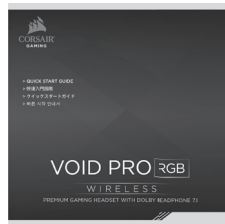



CONTROLS AND FEATURES

- A** Power button
- B** Mute button
- C** Jog Dial (volume + EQ/Dolby)
- D** RGB light (user programmable)
- E** Mic LED (mute)
- F** Status LED (RF, Battery)
- G** Charging port
- H** Microfiber covered ear pads
- I** Headband adjustment
- J** Cantilevered arm + hinge

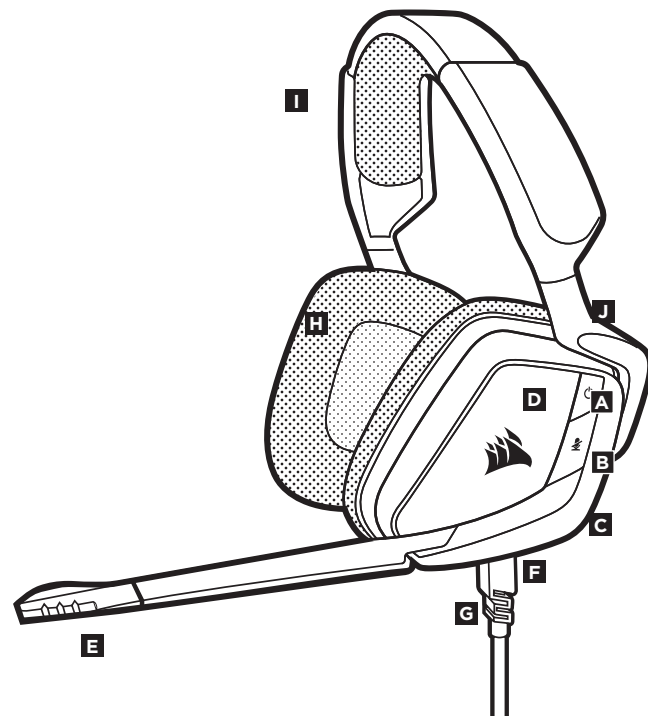



PRODUCT DETAIL (Controls and Wireless Transmitter)

- A** Power button
- B** Mute button
- C** Jog Dial (volume + EQ/Dolby)
- D** RGB light (user programmable)
- E** Charging port
- F** Status LED

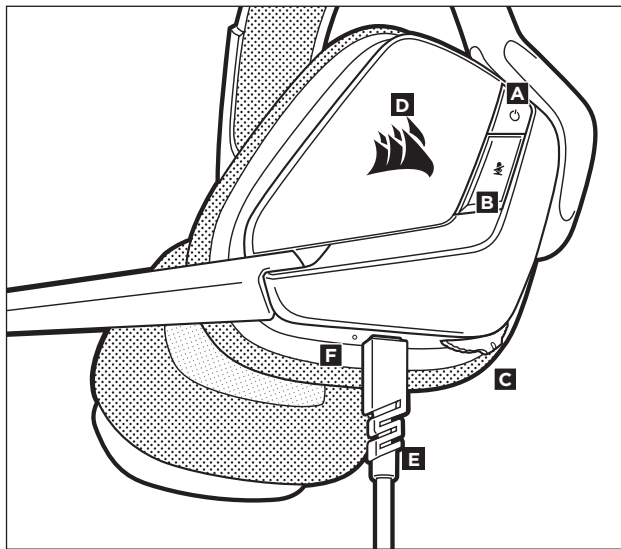

- G** Wireless sync LED indicator
- H** Pairing button (transmitter paired by default)

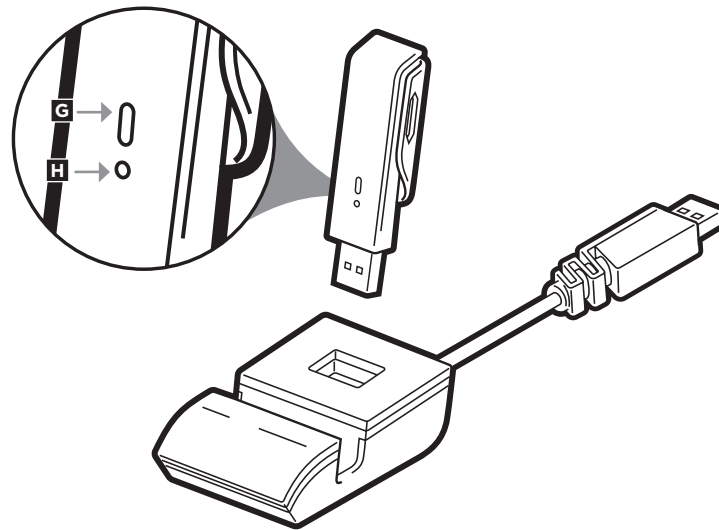



Connect the wireless USB transmitter to any working USB port on your PC or connect the base station (included with the Special Edition models), and then attach the wireless transmitter to the base station.

Using the USB extension base station may extend the wireless range of your CORSAIR VOID PRO RGB Wireless Headset, by enabling you to position the antenna for best reception. The headset is designed to operate at a range of up to 40 feet (12m) from the wireless transmitter, but other wireless devices, electronics, and obstructions such as walls may reduce wireless range.

IMPORTANT: The first time you use the CORSAIR VOID PRO RGB Wireless Headset transmitter on a PC, the operating system will automatically install the device driver. After the device driver loads, we recommend you reboot your PC before use.

Status LED indications:

Single Blink Red = Connected, Battery Low

Single Blink Green = Connected, Battery Normal

Rapid Blink Red = Disconnected, Battery Low

Rapid Blink Green = Disconnected, Battery Normal

Solid Amber = Battery Charging

Solid Green = Battery Charged

Rapid Blink Amber = Pairing Mode

IMPORTANT:

The CORSAIR VOID PRO RGB Wireless Headset must be fully charged before its first use.

- Connect the USB charging cable to any working USB port on your PC
- Connect the USB charging cable to the CORSAIR VOID PRO RGB Wireless Headset

The CORSAIR VOID PRO RGB Wireless Headset battery has no “memory effect”, so there is no need to completely discharge it before recharging.

Remember that the USB charging cable requires a high power (USB 2.0 or better) port. Some USB ports found on older devices do not support USB 2.0.

CHARGING WHILE POWER IS OFF:

When the VOID PRO Headset is OFF, and CHARGING with a connected USB cable.



CHARGING WHILE POWER IS ON – “Play and Charge Mode”:

When the VOID PRO Headset is ON, and CHARGING with a connected USB cable

Using the CUE software will enable the full feature set of the CORSAIR VOID PRO RGB Wireless Headset. Note: if the headset is used without software, some features will be disabled.

- Install the software on a PC running Windows 10, Windows 8, or Windows 7.
- After installation is complete, reboot your PC, and launch CUE.

You can use it to:

- Choose your RGB color preference and light intensity
- Select and customize audio equalizer (EQ) settings
- Adjust headset volume, microphone input volume, and microphone sidetone
- Set Dolby Headphone 7.1 surround sound on or off

The software’s built-in documentation explains how to use the headset’s features in greater detail.



For optimal wireless performance:

- Place the wireless adapter in an open, unobstructed area. Special Edition models include a base station for the wireless transmitter, which can be used to optimize placement.
- The wireless adapter requires a powered USB port (100mA).

For optimal battery life:

- Make sure the battery is fully charged before initial use.
- Do not leave the battery fully discharged for long periods. Battery life is maximized by keeping the battery in a partially charged state.
- If RGB lighting effects are unimportant to you, they can be disabled with CUE. This greatly extends battery life.
- Remove the USB charging cable promptly after the headset has been fully charged.
- Keep the headset at room temperature (20-30°C or 68-86°F).

For the best audio performance:

- Download the CORSAIR Utility Engine software.
- Don't be afraid to use the software equalizer to adjust the audio quality to your liking. We've provided EQ presets for popular gaming and media types.

Prolonged listening at high volumes may adversely affect your hearing. Take breaks between sessions and always begin with the volume at the lowest possible level before increasing.

Place the headset on your head and adjust the headband for a comfortable fit. The extra-large ear pads and deep earcups enable the CORSAIR VOID PRO RGB headset to fit comfortably so you can play for hours without fatigue.

As with any audio product, reduce the volume before trying it with an audio source the first time.

You can adjust the volume with:

- The “CUE Control” is the digital volume controller on the headset at the bottom corner of your left earcup: hold or repeatedly toggle it downwards to reduce volume, and upwards in short increments to increase volume.
- The standard Windows audio controller can also be used to adjust volume.
- Once an audio source is playing, set the volume to a comfortable level.

Headset audio settings

Short key press (.1-.5 seconds) on JOG DIAL toggles EQ

Medium key press (.6-2 seconds) on JOG DIAL toggles Dolby Headphone 7.1 surround sound

Headset mic control

Short key press (.1-.5 seconds) on mic mute button toggles mute on and off

Long key press (2-4 seconds) on mic mute button toggles sidetone on and off

Note: CUE software can also be used to control these features



MICROPHONE ADJUSTMENT

Your new VOID PRO RGB Wireless Headset features a high performance “unidirectional” microphone designed to reject noise other than your voice, but it must be pointed directly at your mouth to function correctly.

- Bend the flexible microphone boom to best fit near to the left corner of your mouth.
Mic automatically mutes when boom is up
Mic automatically un-mutes when boom is down
- For improved voice quality, the included microphone foam windscreen may be applied over the microphone head.
- We’ve found that about a 30 degree bend is a good place to start, but feel free to increase or decrease this if your mic is too loud or too soft.

Enjoy your CORSAIR VOID PRO RGB Wireless Headset! If you have any questions or comments, see the back panel of this guide for contact information.