

groov▶▶e

GV-TW02 SoundBuds *True Wireless Earphones*



Easy Start Up Guide



True Wireless Stereo

SoundBuds  **Bluetooth®**



30 Day Right To Return

We do not envisage any problems occurring with your Groov-e GVTW02 True Wireless Earphones. However, for your peace of mind, should any fault occur, please return it within 30 days to your retailer with your proof of purchase for an exchange or refund.



12 Month Guarantee

This product is guaranteed for twelve months. Please retain your receipt as this will be required as proof of purchase, in the event that the device does not perform as expected then please contact your original point of purchase, should you require further assistance then please contact us.



Contact Us

Reach out to us at info@groov-e.co.uk or visit www.groov-e.co.uk

"Congratulations on your purchase and **Thank You** for choosing the groov-e GV-TW02 SoundBuds True Wireless Stereo Earphones. Please read the guide carefully before using".

Caution

1. When not in use for a long period of time please turn off the Earbuds and store carefully to avoid any damage.
2. In order to prolong the battery life, please charge every 6 months
3. Please charge the Earphones first if they have been left unused for a long time.
4. The batteries in the Earphones and Charging case are original and please do not attempt to change them yourself.
5. Please keep the Earphones and Charge Case in a dry place.
6. Please keep away from high heat sources to avoid battery blast accidents.
7. Do not play at high volumes for long periods at a time. to avoid potential hearing damage.
8. Do not use the Earphones in a dangerous place or whilst driving.

How to wear

Please select the best fit Ear caps for use, there are two sizes to select from. Adjust to a comfortable fit.

Charging

There is a built-in rechargeable battery inside both Earphones and the charging case, which must not be disassembled.

Basic operations

1. To switch the Earphones on or off, press the MFB button for approximately 4 seconds. You will hear a voice prompt confirming "Power on/power off".
2. Whilst receiving a phone call, short press the MFB button to answer the call, and short press the MFB again to hang up. To reject an incoming call, press the MFB button for 1 second until you hear a prompt tone confirming your action.
3. If you wish to open voice assistant (Siri or Google) whilst in standby mode, press the MFB button for 1 second until you hear the prompt tone confirming your action. This will open your device's default assistant without having to retrieve or unlock it, which will then listen and respond to any voice command. Ensuring that a voice assistant is installed on your device.
4. To play/pause music, press the MFB button once.
To play next track (Right Earphone) quickly double click the MFB button
To turn Volume up (Right Earphone) quickly triple click the MFB button
To play previous track (Left Earphone) quickly double click the MFB button
To turn volume down (Left Earphone) quickly triple click the MFB button

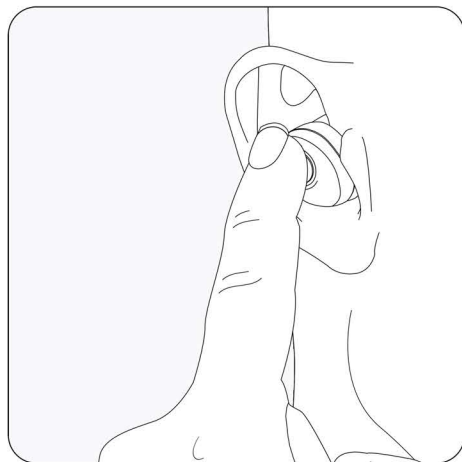

Please Note: During music playback, Phone calls or disconnection due to the Earphones being too far from your Bluetooth device/phone the LED's will not flash. In Stereo mode if you switch off one Earphone it will also power off the second.

PRODUCT OVERVIEW

Package Contents:

1. GV-TW02 Earphones *1 pair
2. USB Cable *1pc
3. Small & Medium Ear Caps *2 pair
4. Charging Dock *1pc

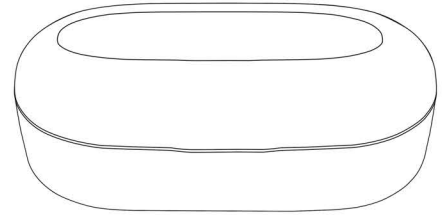

Charging Dock X1

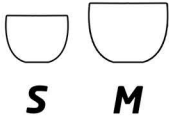

Ear Caps X2

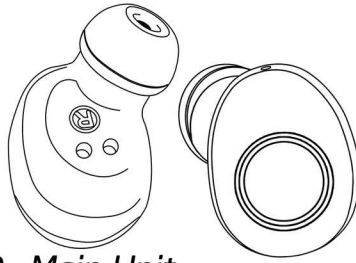

R - Main Unit
Bluetooth
Earphones X1

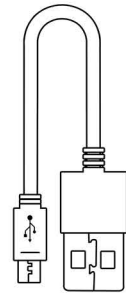

Micro-USB
Charging Cable X1

BRIEF INTRODUCTION

Multifunction Power
Button (MFB)

LED Indicator

Microphone

Ear Cap

Charging Port

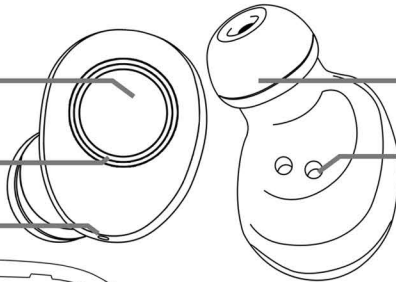

LED
Display

Contact
Charging
Port

Case Power
Button

(FRONT)

Micro USB Charging Port

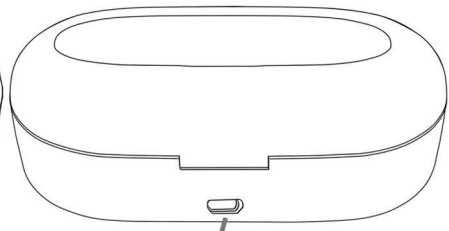
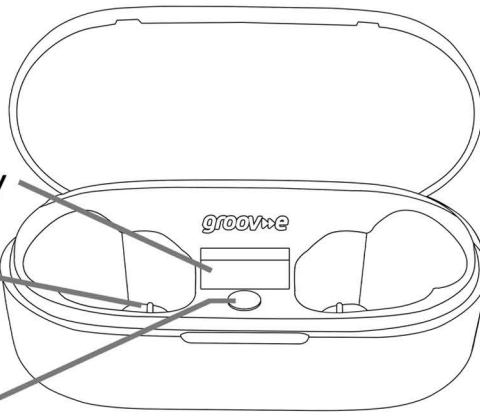

(BACK)

CHARGING THE CASE

To charge the case plug the USB charging cable supplied into the charging port.

Connect it to DC5.0V USB port or a suitable USB charging device.

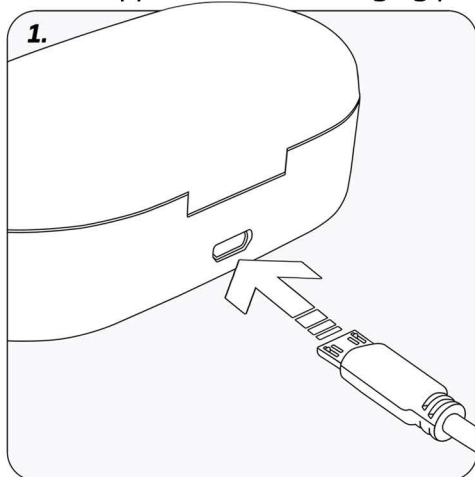

You can charge the case and carry it with you as a portable charging device and storage case for your Earphones.

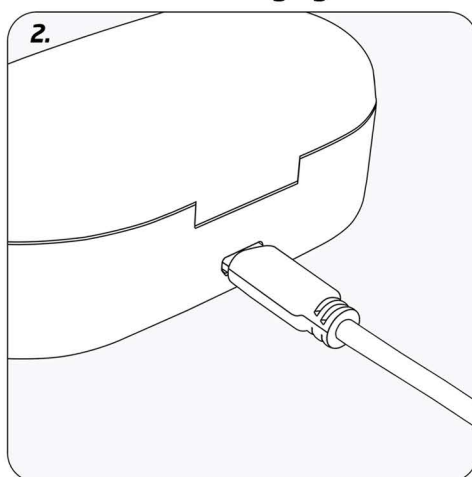

The battery status of the case is indicated by the % number in the display.

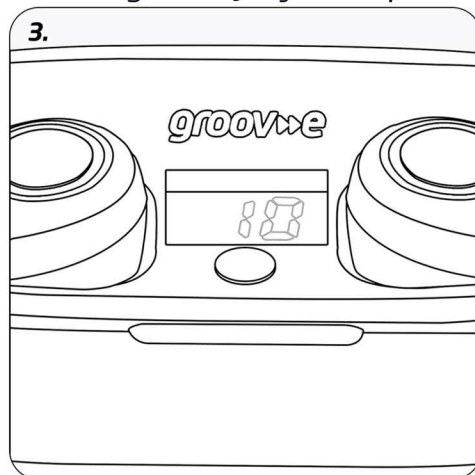

The LED display will flash during charging to show its status.

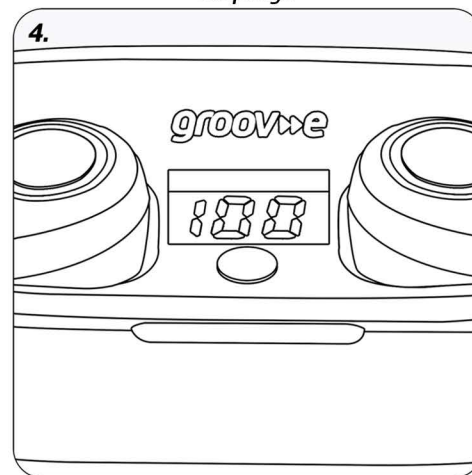

The LED display will show "100" when the charging is complete.

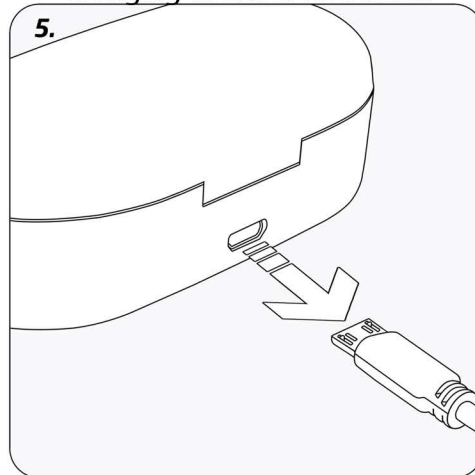

You can then unplug the USB cable.

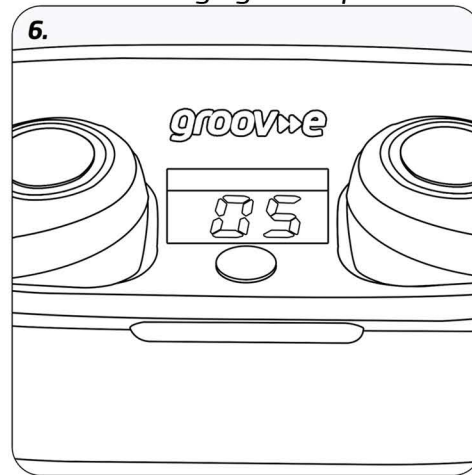

The LED display will flash "5" indicating when power in the case is at a low level.

CHARGING THE EARPHONES

Place the earphones into the charging case.

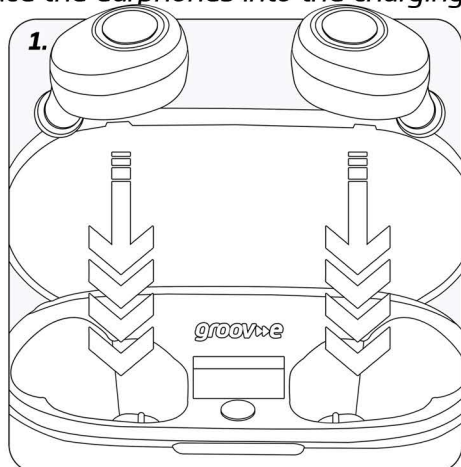

The led lights remain red on both Earphones indicating that they are charging.

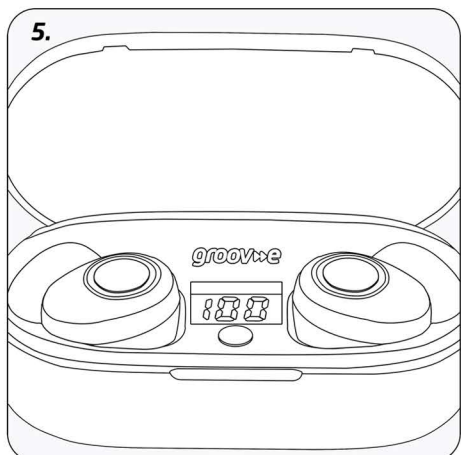
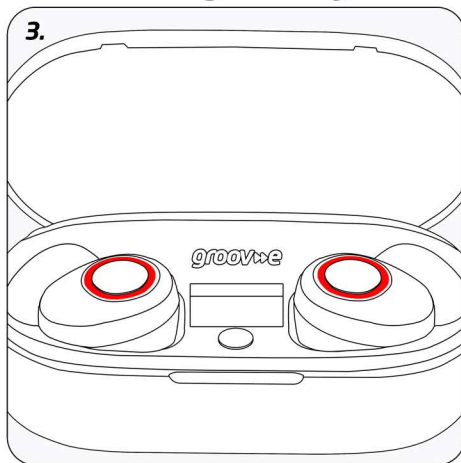

The blue light will switch off when the Earphones are fully charged, the charging case will also stop charging automatically.

Single click the power button on the charging case.

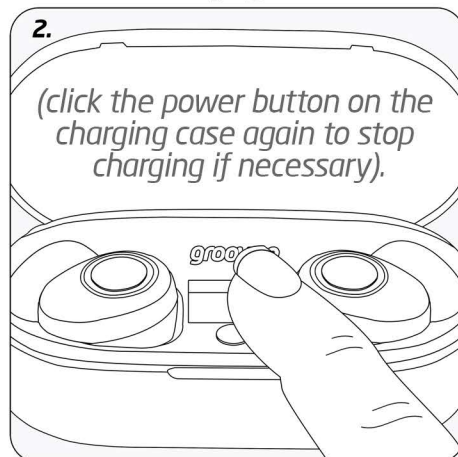

When reaching full charge, the lights on the Earphones will change to blue.

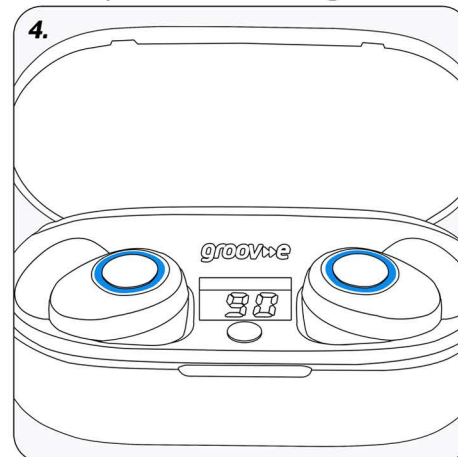

To alert you to the fact that your Earphones require charging you will hear a voice prompt indicating "low power, please charge"

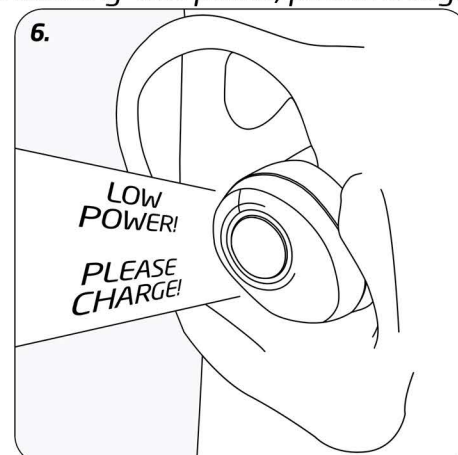

Phone calls will revert to your mobile device if your Earphones reach low power during a call. Please note the Earbuds will switch off automatically whilst in the charging case.

HOW TO REMOVE THE EARPHONES FROM THE CHARGING CASE

Open the charging case's cover to about 90 degrees.

Then remove both Earphones vertically.

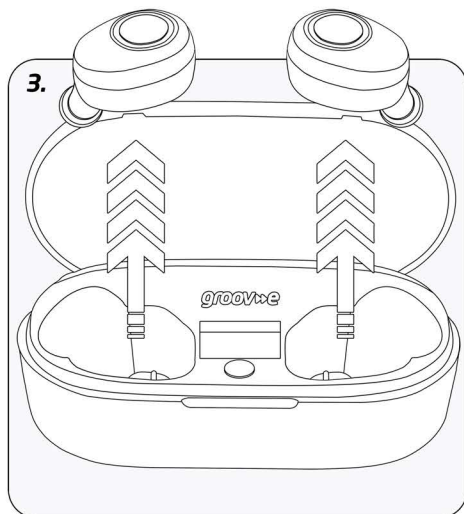
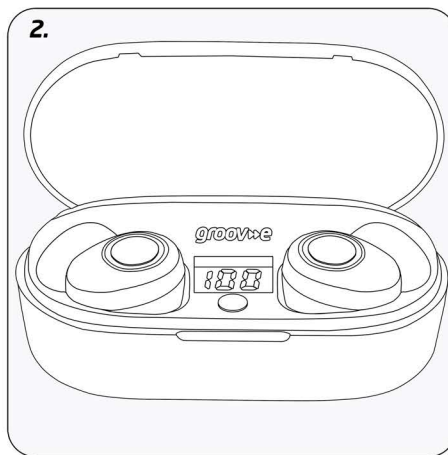
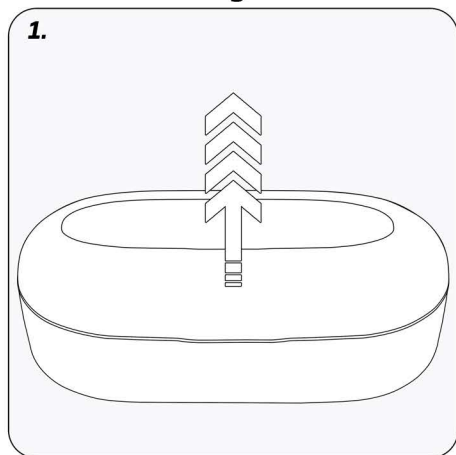

HOW TO PAIR

Remove both Earphones from the case.

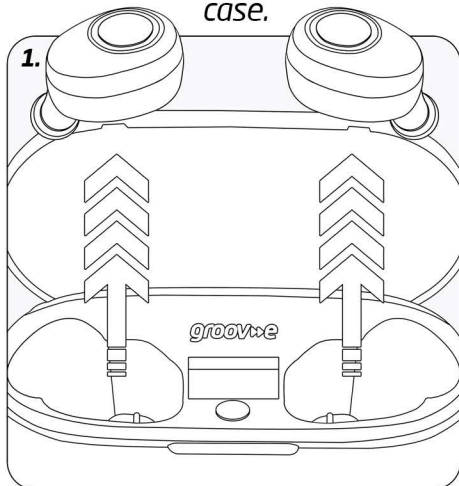

When the blue lights flash, release the buttons.

Press the MFB Button on both Earphones for approximately 4 seconds.

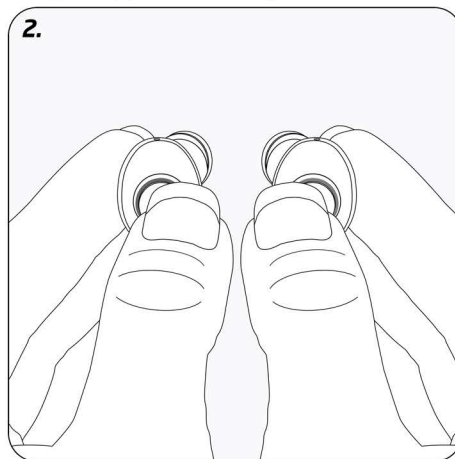

The red and blue lights flash alternatively to confirm you are in pairing mode.

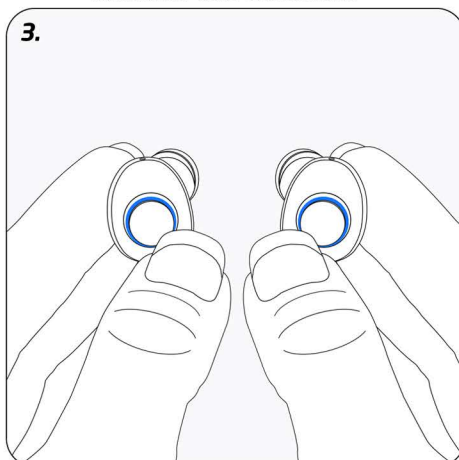

The Earbuds will pair with each other automatically, the right Earbud will be the main control to pair with your bluetooth device/phone.

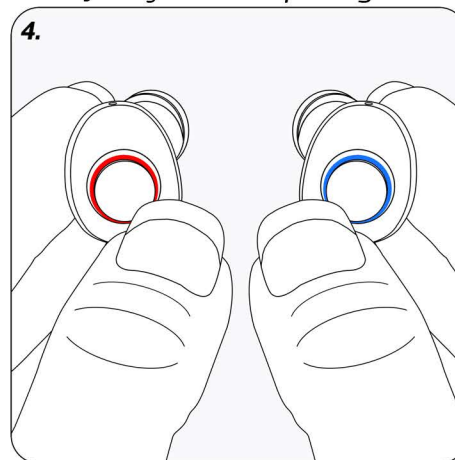

Providing your device/phone is switched on and within pairing distance your earphones will autoconnect to your device the next time you switch them on.

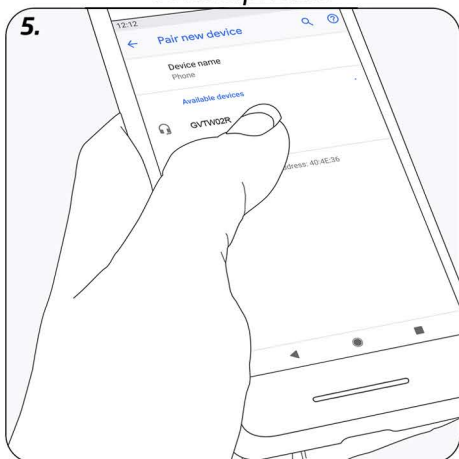

Turn on Bluetooth on your Bluetooth enabled device/phone and scan for "GVTW02R" select and pair with the Earphones.

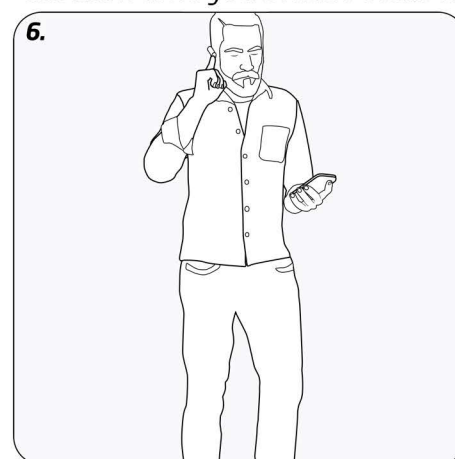

Enjoy your music wirelessly in Stereo!

TROUBLESHOOTING EARPHONES PAIRING

Press the MFB buttons on the Earphones until the red and blue lights flash alternatively.

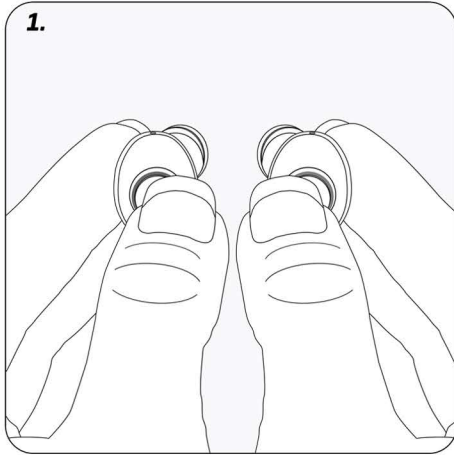

Release the MFB Buttons, you will see the left Earphone flash blue and the right Earphone flash red confirming the two Earphones have paired.

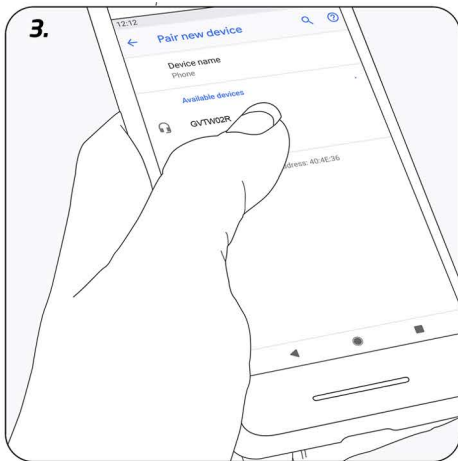
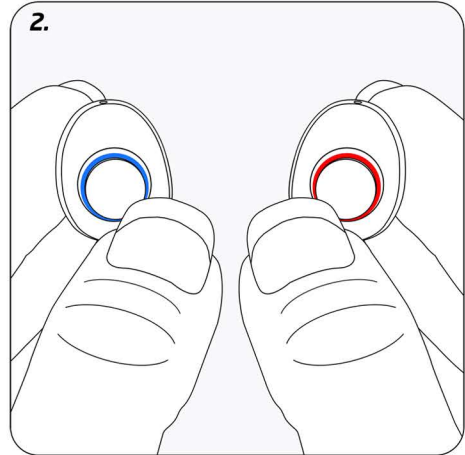

Turn on Bluetooth on Bluetooth enabled device/phone and scan for "GV-TW02R" and pair with the earphones.

MONO EARPHONE USE

Remove one of the Earphones from the charging case.

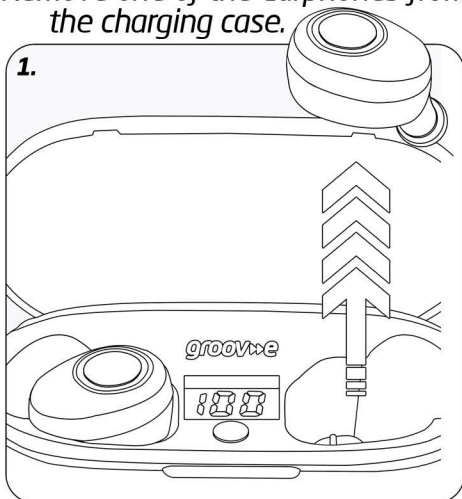

The red and blue lights flash alternately to confirm you are in pairing mode.

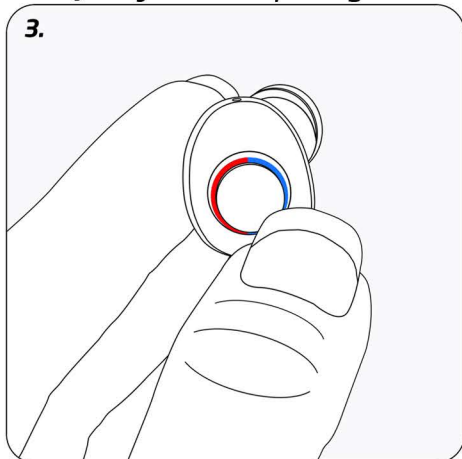

Press the MFB Button for approximately 4 seconds.

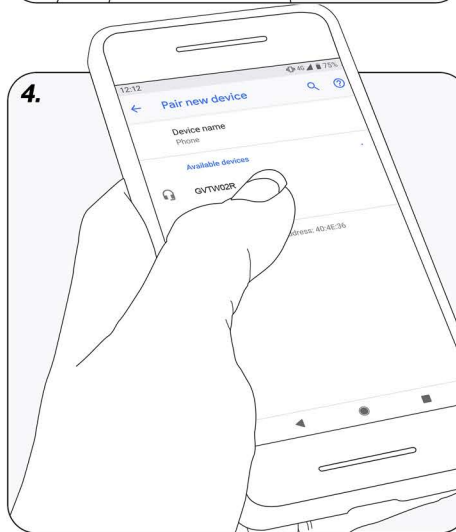
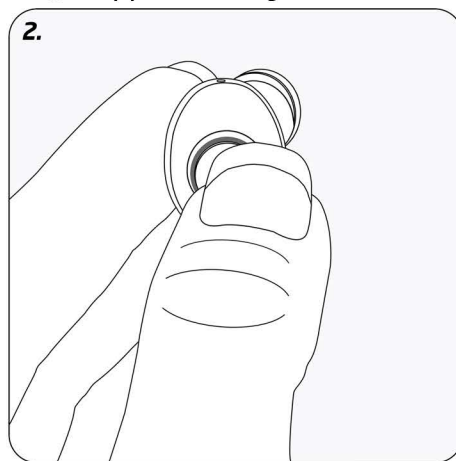

Turn on Bluetooth on your Bluetooth enabled device and dependent on which Earphone you selected scan for either "GVTW02R" or "GVTW02L" and pair.

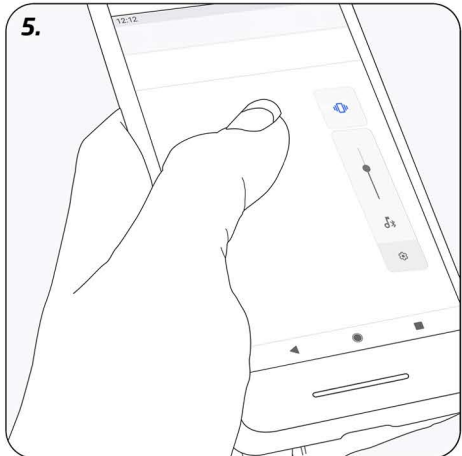

Whilst in Mono mode the volume is controlled via your Bluetooth device/phone.

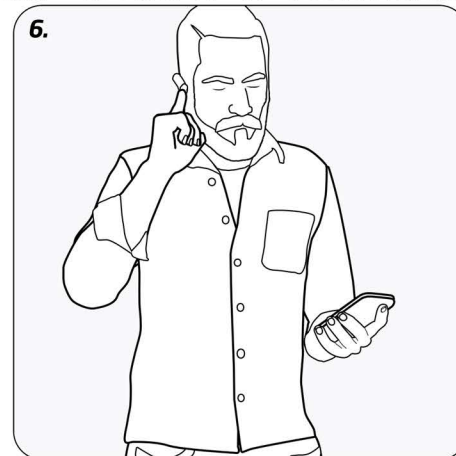

Enjoy your music wirelessly in Mono!

SPECIFICATIONS (earphones)

Bluetooth version 5.0

Bluetooth profiles: A2DP, AVRCP, HFP, HSP, SPP

Wireless range: 10M (open area)

Battery: 60mAH x 2

Music playing time up to 4 hours (1 charge)

Standby time: 50 hours

Speaker frequency: 20-20KHz

Speaker sensitivity: 96dB +/- 3dB

LED battery indicator

SPECIFICATIONS (charging case)

Box recharge capacity: 800mA

Charging time for case: 3 hours

LED battery charging indicator

LED display for case power

FEATURES

Bluetooth connectivity

True Wireless Stereo (TWS)

Up to 4 hours music playback - and up to an additional 10 hours

using the charging case

Music play/pause

Volume & track control

Siri & Google assistant

Clear sound with powerful bass

Comfortable fit

Ergonomic design

Rechargeable battery

Built-in mic for hands-free calls

Answer/Reject incoming calls

Micro-USB charging cable (included)

Portable intelligent charging case (included)

Extra ear buds (included)



Bluetooth Connectivity



True Wireless Stereo



Hands-Free Mic



Comfortable Fit



Charging Case Included

Battery Removal/Disposal

This product contains batteries and should not be treated as normal household waste and should be recycled. Please take it to your nearest collection facility or for further details contact your local council or visit www.recycle-more.co.uk.

Batteries contain substances that may be harmful to the environment and human health. Keep out of the reach of children and seek immediate medical help if swallowed.

Never throw batteries into a fire or attempt to open the outer casing.

Should your product develop a fault and your battery needs replacing for further advice on how to safely remove your battery please visit our website at www.groov-e.co.uk

Environment Protection

Waste electrical products should not be disposed of with household waste. Please recycle where facilities exist.

Check with you Local Authority or retailer for recycling advice.



GUARANTEE

Subject to the conditions state below, Groov-e guarantees this equipment against defects in workmanship or materials of its mechanical and electronic component parts (excluding styling, battery cells, magnetic tapes, re-chargeable batteries, user removeable memory devices, with the exception where the battery is inbuilt into the product) for a period of one year from the date of purchase. This product will be repaired or if necessary replaced free of charge if it has been proven to be defective within the one year warranty period.

1) *Claims under this guarantee should be made through the authorised dealer/retailer from whom the equipment was purchased. If this is not possible, please contact Groov-e directly.*

2) *This guarantee is only valid when the equipment is purchased and retained within the United Kingdom and a valid proof of purchase has been provided.*

3) *This guarantee excludes:*

(i) *All damage caused through accident, misuse, wear and tear, neglect, installation and/or use in a manner inconsistent with technical and safety standards in a country other than the country of purchase*

(ii) *Alterations or adjustments made to equipment*

(iii) *Loss of data resultant from malfunction of hard drive or other storage device*

(iv) *Damage caused to any third party device as a result of using the product*

4) *No liability under this guarantee shall be incurred:*

(i) *In respect of damage or loss occurring during transit to or from the purchaser*

(ii) *Where the serial number plate of the equipment has been removed or altered in any way.*

5) *Groov-e shall not be liable for consequential damage, loss or injury arising from or in connection with the equipment, excepting only that nothing in this condition shall or shall be construed so as to exclude or restrict liability for negligence.*

6) *The cost of carriage to and from Groov-e shall be borne by the purchaser.*

7) *This guarantee is personal to the original purchaser and is not transferable*

8) *If the equipment, in respect of which a claim hereunder is made, is found on examination to comply with the published specifications, a test fee may be incurred.*

This guarantee is in addition to and does not in any way affect any statutory or other right of consumer purchasers, including those rights in relation to sections 13 to 15 of the Sale of Goods Act 1979, the Sale and Supply of Goods to Consumer Regulations 2002, The Consumer Rights Act 2015 or the Sale of Goods and Supply of Services Act 1980 (for ROI).

DECLARATION OF CONFORMANCE

Groov-e hereby declares that this product is in compliance with the essential requirements and other relevant provisions of the Radio Equipment Directive 2014/53/EU. The complete declaration of conformity can be requested from us at:

groov»e

Unit J

Braintree Industrial Estate

Braintree Road

Ruislip

Middlesex

HA4 0EJ UK

www.groov-e.co.uk

Email: info@groov-e.co.uk

Telephone: 020 8845 7704

www.groov-e.co.uk

MADE IN CHINA