

INSTRUCTION MANUAL

Zigbee Curtain Module

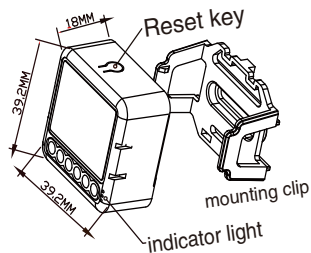

RoHS



TECHNICAL SPECIFICATIONS

Product type	Zigbee Curtain Module
Voltage	AC100~240V 50/60Hz
Max. load	3A
Operation frequency	2.405GHz~2.480GHz IEEE802.15.4
Operation temp.	-10℃ + 40℃
Protocol	Zigbee 3.0
Operation range	<100m
Dims (WxDxH)	39.2x39.2x18 mm
IP rating	IP20
Warranty	2years
Certificates	CE ROHS

with mounting clip

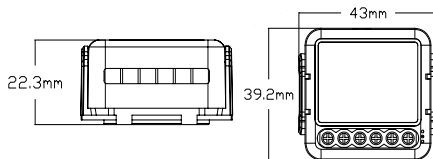

Global international operation Whenever & Wherever
You are, All-in-one Mobile App

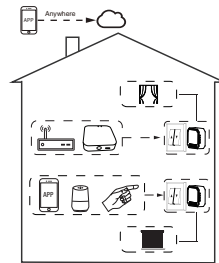
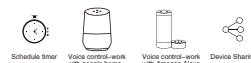

Inhouse local operation



MANUAL OVERRIDE

The Curtain module terminal reserves the access of manual override function for the end-user to switch on/off.

If you have connected the wall push-button, check its work. Single pressing of the "down" button / "up" button, will cause that the roller shutters moves in the desired direction to the end position. If the electric shutter goes in the opposite direction to the expected, select "motor reversal" in the "More" option. When the electric shutter is moving up, pressing "up" button switches causes that the shutter will stop immediately; when the electric shutter is moving down, pressing "down" button switches causes that the shutter will stop immediately.

Notes:

- Both the adjustment on App and Curtain can overwrite each other, the last adjustment remains in memory.
- The App control is synchronized with the manual switch.
- Traditional switch selection button type.

INSTALLATION

▲ Warnings:

- Installation must be carried out by a qualified electrician in accordance with local regulations.
- Keep the device out of reach of children.
- Keep the device away from water, damp or hot environment.
- Install the device away from strong signal sources such as microwave oven that may cause signal interruption resulted to abnormal operation of the device.
- Obstruction by concrete wall or metallic materials may reduce the effective operation range of the device and should be avoided.
- Do NOT attempt to disassemble, repair or modify the device.

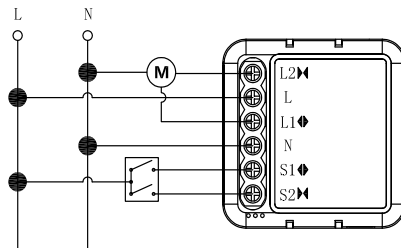
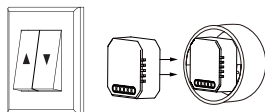

Wiring Instructions and Diagrams

- Turn off the power supply before carrying out any electrical installation work.
- Connect wires according to the wiring diagram.
- Insert the module into the junction box.
- Turn on the power supply and follow switch module configuration instructions.

FAQ

Q1: What should I do if I can't configure the switch module?

- Please check whether device is powered on.
- Make sure the Zigbee Gateway is available.
- Whether it's in good internet conditions.
- Make sure the password entered in App is correct.
- Make sure the wiring is correct.

Q2: What device can be connected to this Zigbee switch module?

Q3: What happens if the WIFI goes off?

Most of your household electrical appliances, such as lamps, laundry machine, coffee maker, etc. You can still control the device connected to the switch module with your traditional switch and once WIFI is active again the device connected to module will connect automatically to your WIFI network.

Q4: What should I do if I change the WIFI network or change the password?

You have to re-connect our Zigbee switch module to the new Wi-Fi network accordingly as per the App User Q5: How do I reset the device?

- Power on/off device for 5 times until the indicator light flash.
- Switch on/off the traditional switch for 5 times until the indicator light flash.
- Press the reset key for about 10 seconds until the indicator light flash.

APP USER MANUAL



IOS APP / Android APP

1

Scan the QR code to download Tuya Smart App, or you can also search keyword "Tuya Smart" at App Store or Googleplay to download App.

2

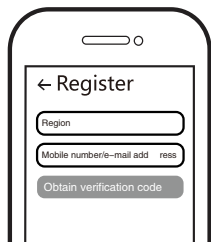

Log in or register your account with your mobile number or e-mail address. Type in the verification code sent to your mobile or mail box, then set your login password. Click "Create Family" to enter into the APP.

3

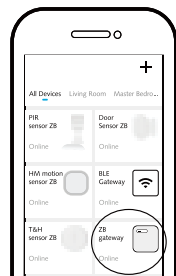

Open the control panel of the ZigBee gateway on the App

Before making the reset operation, pls make sure the Zigbee Gateway is added and installed to the WIFI network. Ensure that the product is within the range of Zigbee Gateway Network.

4

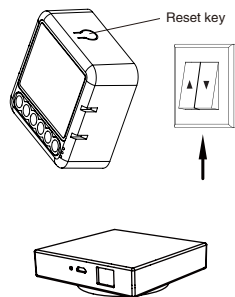

Zigbee Gateway

After the wiring of switch module is done, press the reset key or the traditional switch for about 10 seconds until the indicator light inside the module is flashing quickly for pairing.

5

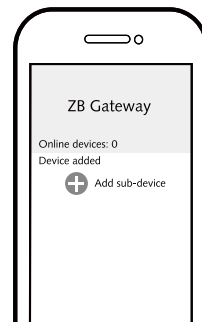

Click "+" (Add sub-device) to select the suitable product gateway and follow the on-screen instruction for pairing.

6

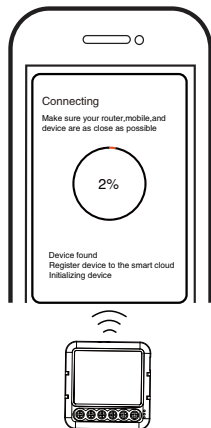

The connecting will take about 10-120 seconds to complete depending on your network condition.

7

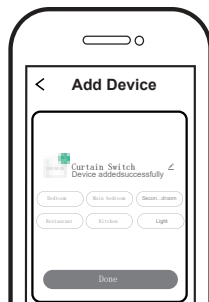

When pairing is done, the Zigbee curtain will be shown on the App.

8

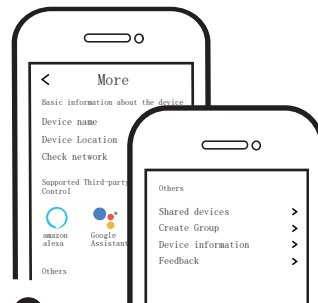

Connect to amazon alexa or Google Assistant for voice control, or share the devices with your families or friends.

SYSTEM REQUIREMENTS

WIFI Router
ZigBee gateway
iPhone, iPad (iOS 7.0 or higher)
Android 4.0 or higher

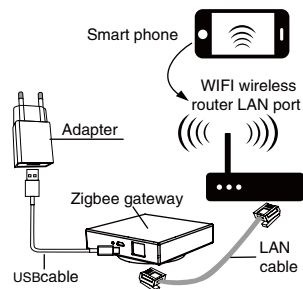

INSTRUCTION MANUAL

WIFI Curtain Module

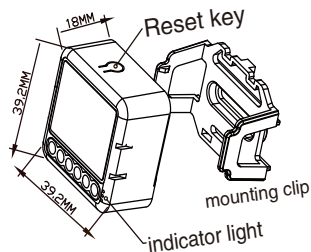

RoHS



TECHNICAL SPECIFICATIONS

Product type	WIFI Curtain Module
Voltage	AC100-240V 50/60Hz
Max. load	3A
Operation frequency	2.412GHz-2.484GHz
Operation temp.	-10℃ + 40℃
Protocol	WiFi IEEE 802.11b/g/n
Operation range	<100m
Dims (WxDxH)	39.2x39.2x18 mm
IP rating	IP20
Warranty	2years
Certificates	CE ROHS

with mounting clip

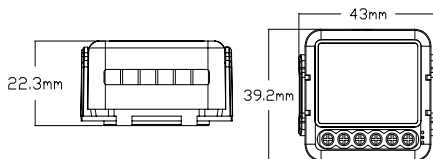

Global international operation Whenever & Wherever You are, All-in-one Mobile App

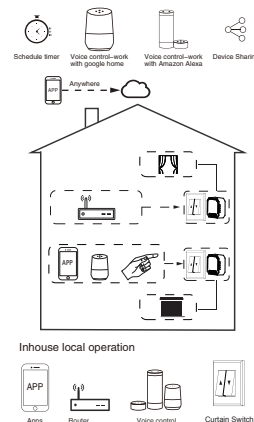

INSTALLATION

▲ Warnings:

1. Installation must be carried out by a qualified electrician in accordance with local regulations.
2. Keep the device out of reach of children.
3. Keep the device away from water, damp or hot environment.
4. Install the device away from strong signal sources such as microwave oven that may cause signal interruption resulted to abnormal operation of the device.
5. Obstruction by concrete wall or metallic materials may reduce the effective operation range of the device and should be avoided.
6. Do NOT attempt to disassemble, repair or modify the device.

MANUAL OVERRIDE

The Curtain module terminal reserves the access of manual override function for the end-user to switch on/off.

If you have connected the wall push-button, check its work. Single pressing of the "down" button / "up" button, will cause that the roller shutters moves in the desired direction to the end position. If the electric shutter goes in the opposite direction to the expected, select "motor reversal" in the "More" option. When the electric shutter is moving up, pressing "up" button switches causes that the shutter will stop immediately; when the electric shutter is moving down, pressing "down" button switches causes that the shutter will stop immediately.

Wiring Instructions and Diagrams

1. Turn off the power supply before carrying out any electrical installation work.
2. Connect wires according to the wiring diagram.
3. Insert the module into the junction box.
4. Turn on the power supply and follow switch module configuration instructions.

Notes: Take your smartphone close to the switch module when you're configuring, and make sure you have min. 50% Wi-Fi signal.

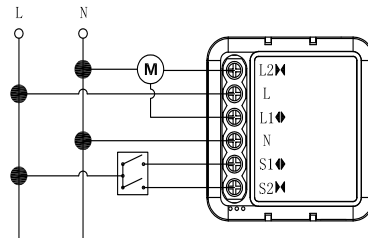
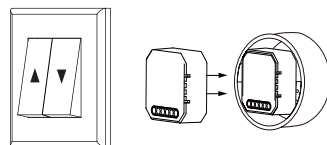

Notes:

- 1) Both the adjustment on App and Curtains can overwrite each other, the last adjustment remains in memory.
- 2) The App control is synchronized with the manual switch.
- 3) Traditional switch selection button type.

FAQ

Q1: What should I do if I can't configure the switch module?

- a. Please check whether device is powered on.
- b. Make sure your mobile and switch module are under the same 2.4 GHz Wi-Fi network.
- c. Whether it's in good internet conditions.
- d. Make sure the password entered in App is correct.
- e. Make sure the wiring is correct.

Q2: What device can be connected to this Wi-Fi switch module?

Most of your household electrical appliances can be, such as lamps, laundry machine, coffee maker, etc.

Q3: What happens if the Wi-Fi goes off?

You can still control the device connected the switch module with your traditional switch and once Wi-Fi is active again the device connected to module will connect automatically to your Wi-Fi network.

Q4: What should I do if I change the Wi-Fi network or change the password?

You have to re-connect our Wi-Fi switch module to the new Wi-Fi network accordingly as per the App User Manual.

Q5: How do I reset the device?

Power on/off device for 5 times until the indicator light flash.

APP USER MANUAL



IOS APP / Android APP

1

Scan the QR code to download Tuya Smart App, or you can also search keyword "Tuya Smart" at App Store or Googleplay to download App.

2



Log in or register your account with your mobile number or e-mail address. Type in the verification code sent to your mobile or mail box, then set your login password. Click "Create Family" to enter into the APP.

3

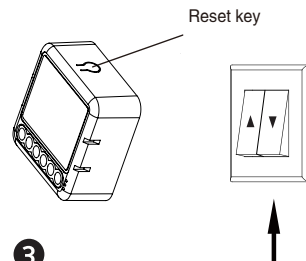

After the wiring of switch module is done, press the reset key or the traditional switch for about 10 seconds until the indicator light inside the module is flashing quickly for pairing.

4



1, Support multi-protocol matching : WIFI/Bluetooth.
2, Turn on Bluetooth, Click "+", follow the on-screen instruction for pairing.

5

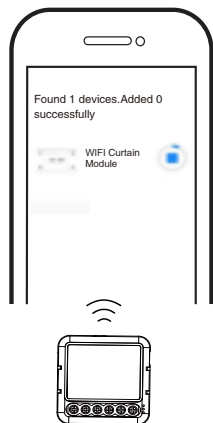

The connecting will take about 10-120 seconds to complete depending on your network condition.

6

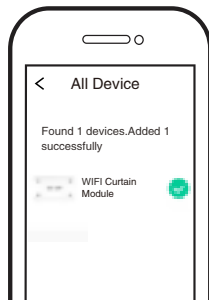

Finally, you can control the device via your mobile phone.

7

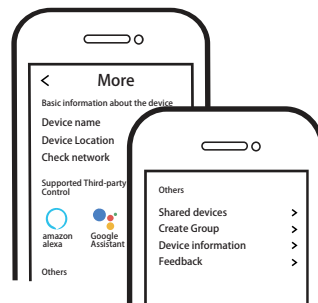

Connect to amazon alexa or Google Assistant for voice control, or share the devices with your families or friends.

8

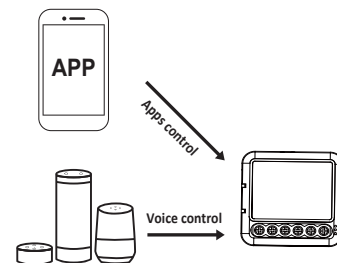

Enjoy your smart life of home automation for lighting control by using our All-in-one mobile app wherever you are in the world or simply by voice control when you are sitting at home comfortably.