

S9 Pro UK User Manual

IMPORTANT! Read carefully and keep for future reference.
Illustrations of product, accessories, and user interface in the user manual are for reference purposes only. Actual product and functions may vary due to product enhancements.

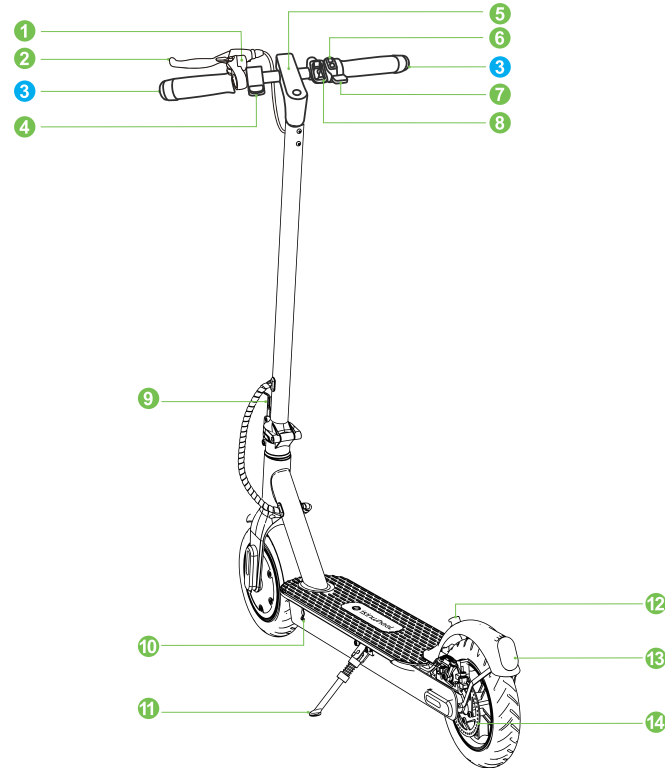

Product Overview



- ① Bell
- ② Brake Lever
- ③ Indicators
- ④ Thumb Brake
- ⑤ Display
- ⑥ Indicator Switch
- ⑦ Throttle
- ⑧ Latch
- ⑨ Folding Mechanism
- ⑩ Charging Port
- ⑪ Kickstand
- ⑫ Hook
- ⑬ Taillight
- ⑭ Disc Brake Rotor



Package Contents

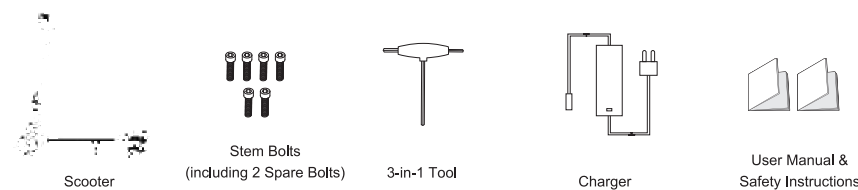

WARNING! Before folding or any servicing, power off the scooter first!



Assembly

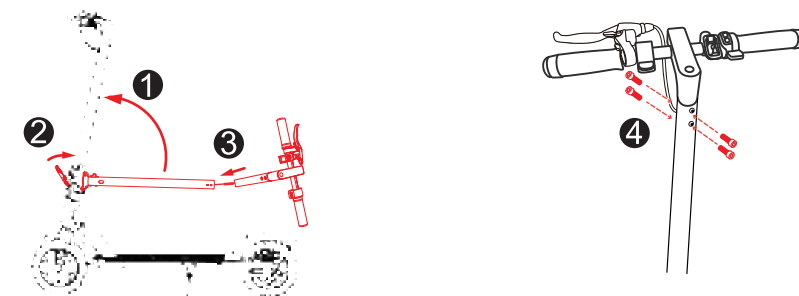

Raise the stem to the riding position and close the folding latch until you hear a click.

Install the handlebar assembly onto the stem. Pre-tighten all four bolts, then fully tighten them using the supplied tool.

Scan to install the "isinwheel club" App



You will get

- Digital manual
- Step-by-step setup videos
- FAQs & troubleshooting
- Electronic Lock

...

Customer Service:

Contact us if you experience issues relating to riding, maintenance and safety, or errors / faults with your scooter.

www.isinwheel.co.uk
support@isinwheel.co.uk

Manufacturer: Shenzhen Xincheng Times Technology Co.,Ltd
Add: 104-105, Block C, Donghai Wang Building, No. 369 Bulong Road, Ma'antang Community, Bantian Street, Longgang District, Shenzhen
E-mail: support@isinwheelLeu

UK **REP** JunBright Ltd
Add: 51 Chalfon Street London, England, NW1 1HY
E-mail: junbrigh2024@gmail.com
Tel: +44 0756 1533298
Contact: Shaopeng Yang



UK_V3



Folding

Open the folding latch, fold down the stem, adjust the handlebar so that the hook on the fender catches the latch on the handlebar. And the stem can be used as a carrying handle.

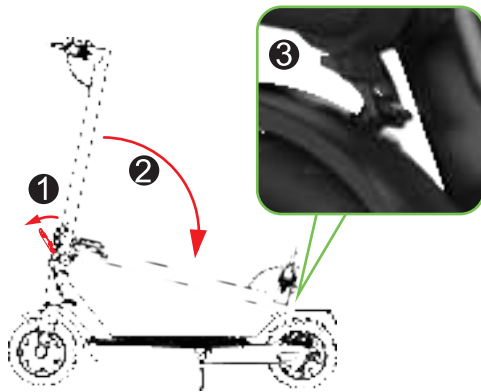

Display

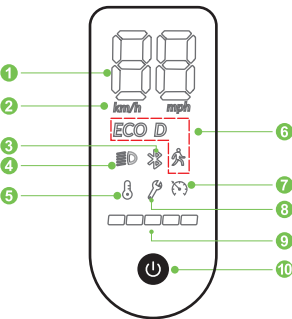

- ① Real-time Speed / Error Code
- ② Speed Unit
- ③ App Connected
- ④ Headlight
- ⑤ Motor Overheating Alarm
- ⑥ Riding Mode
- ⑦ Cruise Control
- ⑧ Error Prompt
- ⑨ Battery Level
- ⑩ Power Button

Riding Mode	Max Speed
	6 km/h
<i>ECO</i>	15 km/h
<i>D</i>	25 km/h

Error code

The following are common error codes you may encounter. If you experience any of these or other error codes, contact us for support.

Codes	Definition
E10	Communication Fault
E14	Throttle Fault

E15	Brake Lever Fault
E16	Motor Hall Sensor Fault
E50	Over-voltage



Power Button

Power ON/OFF

Press and hold the Power button.

Headlight ON/OFF

Press the Power button to turn on/off the headlight & taillight.

Switching Riding Mode

Double-press the Power button to cycle through the riding modes.

Switching Speed Unit

Press the Power button three times to switch between km/h and mph.

Zero Start and Non-zero Start

Press the Power button four times.

Cruise Control ON/OFF

Press the Power button five times.

Note:

- The scooter will automatically shut down if there is no operation for 10 minutes.
- When cruise control is turned on, keep a speed for 5 seconds and the scooter will move forward at this speed without applying the throttle.



About Charging

- The scooter is fully charged when the charger indicator changes from red to green.
- With charging protection, the scooter will cut off charging automatically after a full charge. We still don't recommend overcharging it.
- Keep the charging port cover closed when not charging.
- During charging, the scooter can not be turned on.



Disc Brake Adjustment

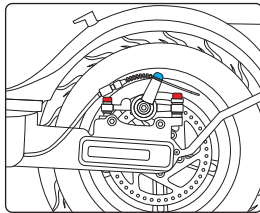

Red Heads: Caliper Mounting Bolts
Blue Head: Cable Clamp Bolt

To adjust the brake cable:

You need a hex wrench to loosen the bolt on the cable clamp.

- If the disc brake is dragging, slide the arm of the clamp backward along the cable while holding the cable in one hand. Then, retighten the bolt on the brake clamp.
- If the disc brake does not work efficiently, the cable is slack. You need to slide the arm of the clamp forward along the cable while holding the cable in one hand. Then, retighten the bolt on the brake cable clamp.

To eliminate brake noise:

- Loosen the two brake caliper mounting bolts (not the bolt on the cable clamp).
- Reposition the brake caliper to ensure the brake rotor is centered between the brake pads.
- Retighten the mounting bolts.



Specifications

Model	S9 Pro
Unfolded Size	1080 x 430 x 1120 mm (42.5 x 17 x 44 in.)
Folded Size	1080 x 430 x 500 mm (42.5 x 17 x 19.7 in.)
Weight	11.4 kg (25.1 lbs)
Battery Capacity	36 V, 10 Ah
Motor Power	350 W
Range	22–30 km (14–18 miles) *
Max Load Capacity	100 kg (220 lbs) *
Recommended Age	18+
Operating Temperature	-2°C–35°C (28.4°F–95°F)
Charger Input	AC 100–240 V, 50/60 Hz
Charger Output	DC 42 V, 1.5 A
Charging Time	3–6 h
Waterproof Rating	IPX4

* About the range: Measured in a laboratory under 100% battery level condition. The range will differ depending on different factors, such as load, humidity, wind speed, and operation habits.

* The structure of this scooter is designed to support a maximum load of 100 kg (220 lbs). For the best riding experience, 70% of the maximum load is recommended.

CE Warning

1) The appliance is not to be used by persons (including children) with reduced physical, sensory or mental capabilities, or lack of experience and knowledge, unless they have been given supervision or instruction.
2) Children being supervised not to play with the appliance.



Disposal of Electrical and Electronic Equipment

The crossed-out garbage can means that you are legally obliged to dispose of these devices separately from unsorted municipal waste. Disposal via the residual waste bin or the yellow bin is prohibited. If the products contain batteries or rechargeable batteries that are not permanently installed, they must be removed before disposal and disposed of separately as a battery.

Options for Returning Old Devices (EAR)

Owners of old devices can hand them over within the scope of the options for returning or collecting old devices that have been set up and made available by public waste disposal authorities, so that proper disposal of the old devices is ensured.

Data Protection

We would like to point out to all end users of waste electrical and electronic equipment that they are responsible for: deleting personal data on the old equipment itself to be disposed of.

Declaration of Conformity

For the full text of the EU Declaration of Conformity, visit the link: www.isinwheel.co.uk/pages/declaration-of-conformity