

USB-C BLADELESS FAN

KABLFANICCA

SAFETY & WARNINGS

Safety & Warnings

When using electrical appliances, basic safety precautions should always be followed to reduce the risk of fire, electric shock, and injury:

- Read all instructions carefully, even if you are familiar with the appliance. Retain this user guide for future reference.
- This product is intended for general domestic use only. Do not use the product for any other purpose.
- This appliance is not intended for use by persons (including children) with reduced physical, sensory, or mental capabilities or lack of experience and knowledge unless they have been given supervision or instruction concerning use of the appliance by a person responsible for their safety.
- Children should be supervised to ensure that they do not play with the appliance.
- Do not leave the product unattended while it is in use, especially when children are present.
- Always unplug the product from the electrical outlet when it is not in use.
- Always operate the product on a flat, level, steady, and stable surface to avoid it overturning.
- Do not hang or wall-mount the product.
- Do not place the product in or near an open window. Rain, snow, and other weather elements may create an electrical hazard.
- Keep the power cord and product away from heated surfaces.
- Always unplug the product from the electrical outlet when cleaning it.
- Do not plug or unplug the product into or from the electrical outlet with wet hands.
- Never drop or insert objects into any opening of the product.
- Do not attempt to open any part of the motor housing, as there is a risk of electrical shock.
- Do not allow the power cord to hang over the edge of a table or counter where it may be tripped over or pulled.
- Do not operate the product if the power cord is cut, damaged, or if the wires are exposed.
- Do not immerse or expose the motor housing, power cord, or plug to water or other liquids.
- Do not put any stress on the power cord where it connects to the product, as the power cord could fray and break.
- Only use the adaptor supplied with the product.

- Do not operate the product if it has a damaged power cord or plug, malfunctions, or is dropped or damaged. Do not attempt to examine or repair this product yourself. Qualified service personnel should perform any servicing.
- This product is intended for indoor, non-commercial, non-industrial, household use only. Do not use outdoors.
- To disconnect the product, set the main switch to OFF and then remove the plug from the outlet. Do not pull on the power cord when disconnecting.
- Ensure that the product is switched OFF and unplugged from the supply mains before cleaning and maintenance.
- Do not move the product when it is in use.
- Do not run the power cord under carpeting or cover the power cord with throw rugs, runners, or similar items. Arrange the power cord away from traffic areas where it will not be tripped over.
- Do not use this product with a programmer, timer, or any other device that switches the product on automatically, as a fire risk exists if the product is covered or positioned incorrectly.
- Do not place any objects on or cover the air inlet or outlet. Make sure that the ventilation openings are free of dust, lint, hair, or any other obstacles that could impair airflow.
- The appliance is designed to function quietly and safely under normal circumstances.

Warning:

- Do not place the appliance near any power board or socket outlet.
- If the supply power cord is damaged, it must be replaced by Kogan.com, its service agent, or similarly qualified persons to avoid a hazard.
- This product has not been designed for any uses other than those specified in this booklet.

COMPONENTS



Fan



USB-C cable

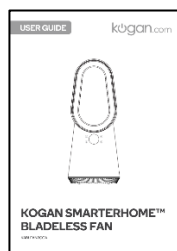

User guide

OVERVIEW

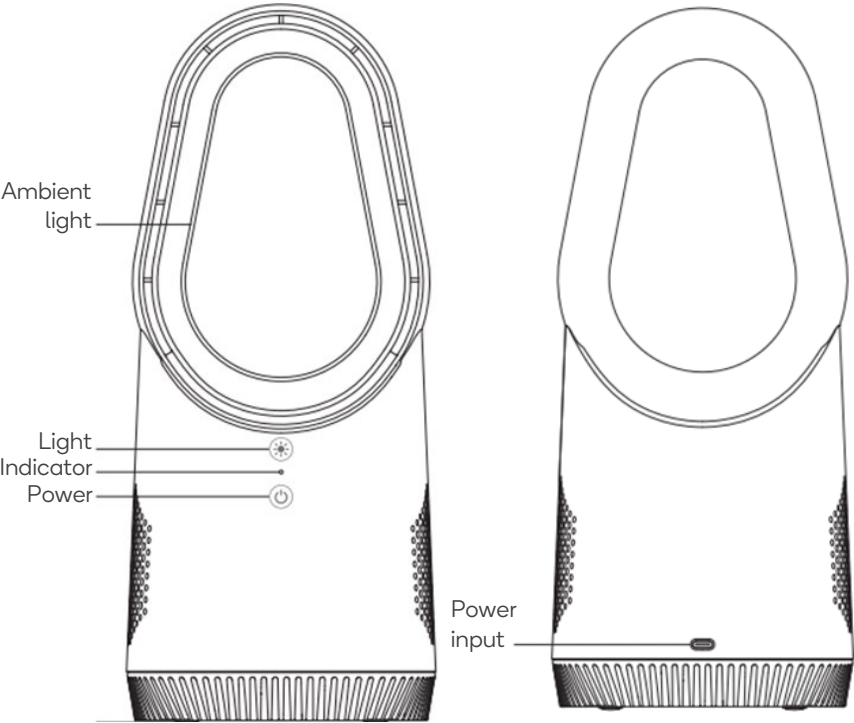

INSTALLATION

Remove all packaging material from the device.

Choose an installation location with the following requirements:

- The floor should be firm, flat, and horizontal.
- Do not place the unit in a hot, wet, or very humid environment.
- The outlet must be easily accessible for easy disconnection if necessary.
- Temperature range: 0 to +40 °C
- Air humidity (no condensation): 5–75 %
- Ensure there are no obstacles like curtains blocking the air circulation.

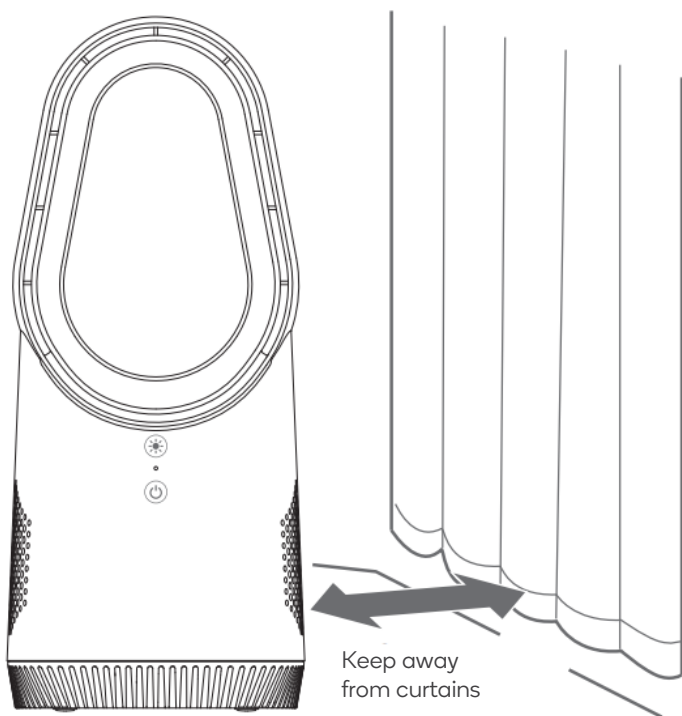

OPERATION

Charging the Fan:

Insert the output end of the USB charging cable into the fan interface first, then insert the USB charging cable into a standard 5V=2A adapter (maximum output power does not exceed 15W) to charge to the fan.

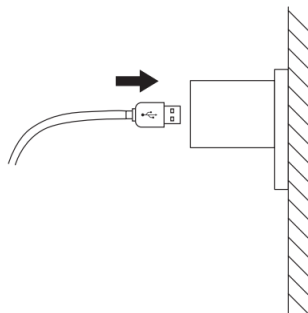
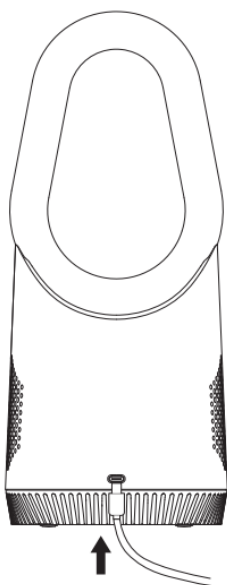

Battery and Charging Indicators:

- The indicator lights red and blinks 3 times before automatically shutting down when the power is insufficient.
- When charging the battery through the USB charging cable, the green indicator blinks and turns off when the battery is fully charged.

Fan Controls

Power button



- Press the power button on the fan, the power indicator will light up white to set in speed 1 press it again for speed 2, the power indicator will light up blue.
- Press it again for speed 3, the power indicator will light up green.
- Press it again to turn off.

Ambience button



- Press the ambience button to start the atmospheric light function.
- Press the ambience button repeatedly to obtain the desired colour scheme (white, blue, green, red, purple, Breath varied colour).
- To end the atmospheric light function, Long press the ambience button. The indicator light goes out.

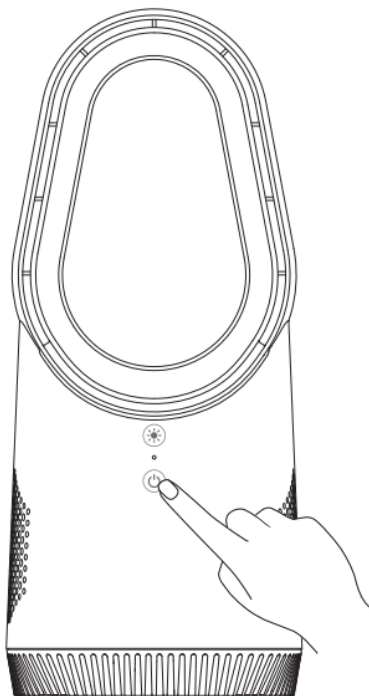

CLEANING & CARE

When performing maintenance, be sure to unplug the power supply first.

- Do not soak or splash water on the fan, as it may cause water damage.
- Avoid using banana water, gasoline, alcohol, bleach, or metal objects to wipe the fan surface, as these may cause discoloration and deterioration.

Object Surface:

- Gently wipe the fan surface with a dry, soft cloth.
- If the surface is dirty, use a soft cloth dampened with a diluted neutral detergent. Wipe it clean, then dry with a soft cloth.

Air Inlet and Air Outlet:

Use a soft brush or a vacuum cleaner to clean dust from the air inlet and outlet. Excessive dust can affect fan performance, so clean it regularly.

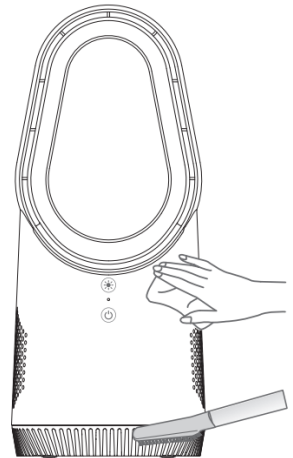

Storage:

- Store the fan in a plastic bag after maintenance.
- Avoid places with vibration and electrical appliances with cooling or heating functions.
- Keep it out of direct sunlight, high temperatures, and humidity.
- Keep it out of the reach of children.
- During maintenance, please do not soak or splash water on the fan, it may cause the machine to get water and damage it.
- Please do not use banana water, gasoline, alcohol, bleach or metal objects to wipe the fan surface, which may cause the fan surface to discolour and deteriorate.

Battery Removal Instructions:

- The battery inside the fan may contain substances that pollute the environment and cannot be disposed of as domestic waste.
- If you want to discard the fan, remove the battery and take it to an official collection point or dispose of it according to local regulations.
- Before removing the battery, power off the fan to ensure the battery is fully discharged. If there is surplus power, let the fan run until the power is exhausted. Do not short-circuit the battery contact strip.

Remove the Battery:

1. Remove the 6 silicone covers **(1)** and screws from the fan.
2. Remove the lower shell **(2)** of the chassis and remove 2 screws **(3)**.
3. Remove the outer shell **(4)**, disconnect the battery terminal, and remove the battery **(5)**.

Do not reconnect the fan to the power supply after removing the battery.

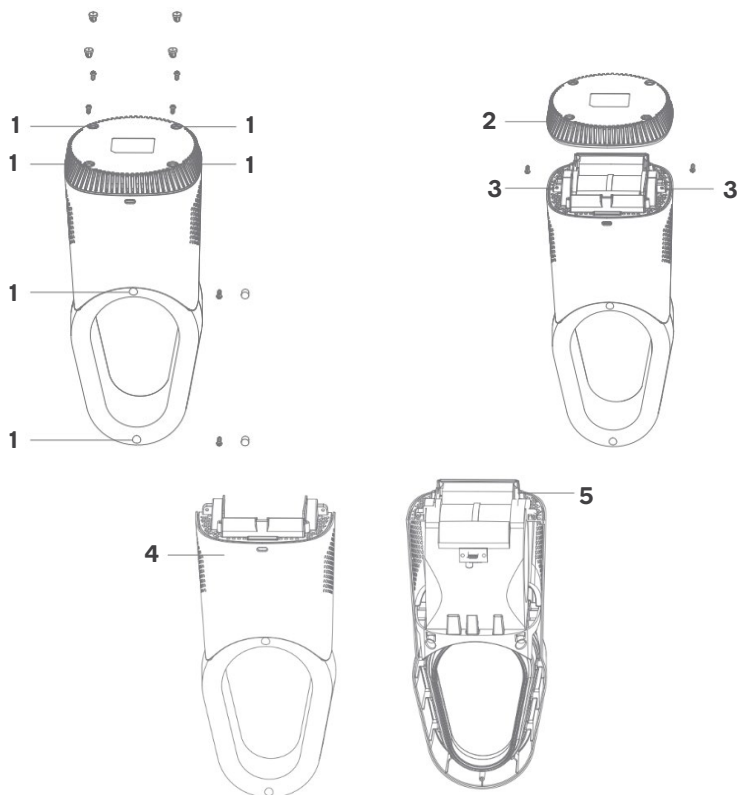

SPECIFICATIONS

Rated voltage	5V 2A
Rated power	10W
Charging time	3 hours
Working hours	2-5 hours (depending on usage)
Product size	130 x 130 x 303mm

Disposal

	This marking indicates that this appliance should not be disposed with other household wastes. To prevent possible harm to the environment or human health from uncontrolled waste disposal, recycle it responsibly to promote the sustainable reuse of material resources.
--	---

Need more information?

We hope that this user guide has given you the assistance needed for a simple set-up.

For the most up-to-date guide for your product, as well as any additional assistance you may require, head online to **help.kogan.com**

kogan.com