



Shown with optional  
accessories



# OWNER'S MANUAL

Safety Guidelines  
Assembly Guidelines  
Troubleshooting  
General Information  
Care and Maintenance  
Warranty Information



...*BUILT FOR THE HUNT.*



***Congratulations, you are the proud owner of the finest production crossbow in the world!***

Please follow all safety, assembly and troubleshooting instructions contained in this manual. It is extremely important to read and follow the instructions before attempting to use your crossbow. Serious injuries to yourself or others, damage to your crossbow or poor performance from your crossbow could result from failure to thoroughly read and understand these instructions. If any part of this manual is unclear to you contact the Sales Department at (727) 234-4999. After assembly of your crossbow, please keep manual for future reference.

As with any other high-performance equipment, meticulous care and a regular maintenance schedule must be maintained.

## ***Manual Contents***

Specifications	3
Parts Checklist	3
Safety Guidelines	4
Crossbow Breakdown	5
Assembly Guide	6
Crossbow Operation	8
Troubleshooting	11
Care and Maintenance	13
Warranty	14
Warranty Registration	19

## ***Specifications***

Feet per Second	320
Power Stroke	13"
Draw Weight	150 lbs
Physical Weight	8.5 lbs
Width	26.5"
Length	32.5"
String Length	38.875"
Number of Strands	24
String Stock Number	16159
Cable Stock Number	16173

## ***Parts List***

Before assembling your crossbow, take a moment to organize these parts and ensure you have everything you need.

If you are missing any of the parts below, contact the Barnett Sales Department at (727) 234-4999.

- 1 Hex Key
- 1 Lubewax
- 1 Nose Bolt
- 1 Lock Washer

## ***Safety Guidelines***

The **JACKAL** is equipped with an automatic **Anti-Dry Fire** safety, which engages every time the crossbow is cocked. The safety must be released before each shot. This, as with any other mechanical device, does not guarantee total safety, as no safety device is a substitute for common sense and safe handling. The crossbow trigger is only to be pulled when the safety is in “fire” position and NEVER when it is in the “safe” position or anywhere between “safe” and “fire.” Do not attempt to alter or modify the safety or the trigger mechanism.

***The following rules should be followed at all times:***

***EXTREME CAUTION SHOULD BE USED AT ALL TIMES WHEN HANDLING A CROSSBOW. FAILURE TO FOLLOW THESE RULES COULD RESULT IN SERIOUS INJURY OR DEATH.***

- Always keep your fingers below the flight track and out of the path of cables and strings when firing the crossbow. The velocity of the string striking your fingers as the string travels forward could cause severe personal injury.
- Never dry fire the crossbow (shoot without an arrow). ***Dry firing will void the warranty*** and can result in damage to the limbs, string, and cables, possibly causing personal injury.
- Never fire the crossbow until you are sure of your target.
- Always use an adequate target and backstop when target shooting.
- Always use suitable crossbow arrows, such as Barnett 20” carbon arrows with half-moon nocks. Arrows of improper stiffness or mass weight may damage the limbs, string, and cable assembly, *voiding the warranty*, and could possibly cause personal injury. Too light of an arrow can cause a dry fire/misfire.
- Always inspect the crossbow and arrows before firing. Bent or damaged arrows or nocks are not safe to fire and should be discarded or repaired.

## ***Crossbow Breakdown***

1. Stock
2. Red Dot Scope
3. String
4. Cables
5. Cable Slide
6. Arrow Retainer Spring
7. Scope Mount
8. ADF Trigger Assembly
9. Limbs
10. Quiver (Not included if bow only is purchased)
11. Foot Stirrup
12. Limb Bolts
13. Picatinny Rail

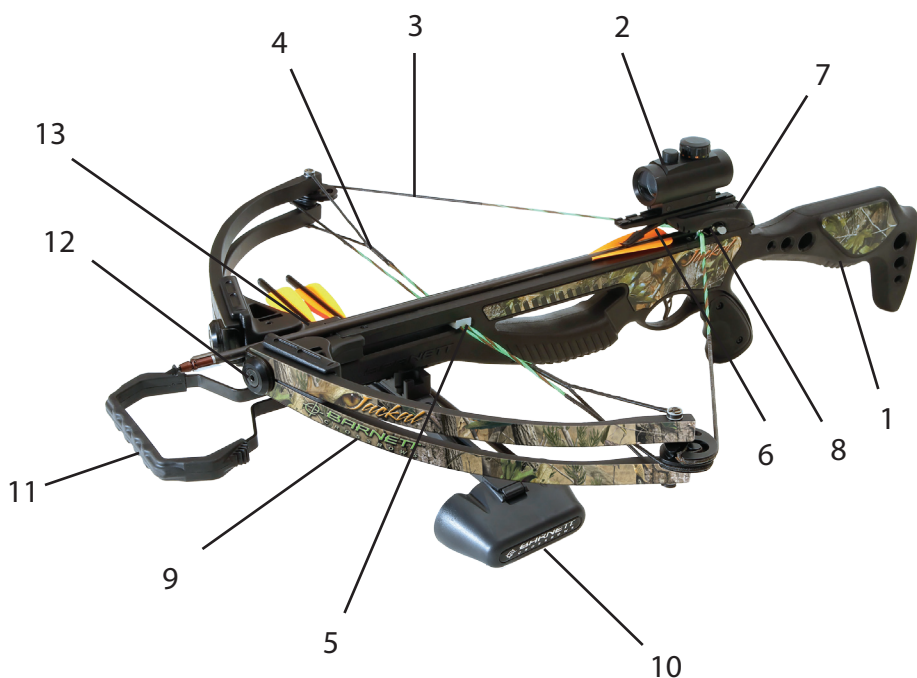

## ASSEMBLY GUIDE

### *Installing Optional Quiver*

- Locate the Picatinny Rail on the underside of the stock (front of forearm).
- Slide on the plastic quick-detach quiver bracket until it lines up with one of two optional quiver placement holes. Attach with screw provided. **See Figure 1**
- Attach quiver by placing it on the quick-detach bracket with the plastic studs facing the mounting plate at a slight angle and twist it secure.

Hardware included: quiver bracket, hex key, hex screw.

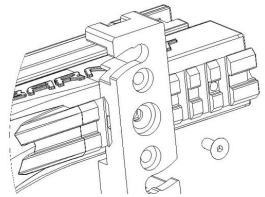

*Fig. 1*

### *Installing Cable Slide*

When viewing the cable slide from the side, with the concave surface facing up, notice that one of the two cable notches is positioned deeper into the cable slide than the other. **See Figure 2**

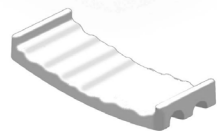

*Fig. 2*

***IMPORTANT: Cable slide must be installed prior to attaching the bow assembly.***

- Place the top cable into the deeper of the two notches and the bottom cable slide into the more shallow notch on the cable slide. This allows the cable slide to maintain a relatively level position on top of the two cables.
- Before sliding the cable slide into the stock's flight track (**See Figure 3**) apply Barnett lubewax to the top of the cable slide (the part that comes in contact with the underside of the flight track in the stock) and apply to the cables in that area also.

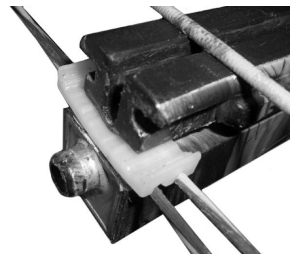

*Fig. 3*

### ***Attaching Prod Housing to Stock***

- Place bow string on top of the flight track. Place cables under the front edge of the flight track.

*Fig. 4*

#### **See Figure 4**

- Push riser assembly gently until it engages with stock.
- Secure the prod housing with the hex bolt and lock washer. **See Figure 5**
- To aid with this process, place the rear stock on the ground and turn the bow over with the rod gently leaning against a hard surface (such as a table). While GENTLY pushing down on the foregrip, tighten the bolt with the hex key

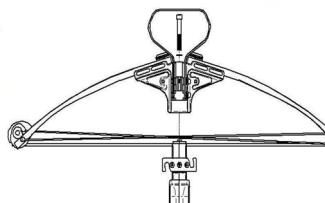
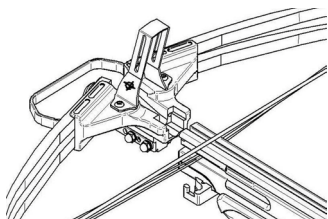

*Fig. 5*

### ***Attaching the Foot Stirrup Assembly***

- Remove the button-head cap screw, two nylon washers, lock washer and acorn nut from the second hole of the prod housing.
- Flip the foot stirrup forward on the prod. Insert the button-head cap screw through the third hole of the foot stirrup and through one nylon washer, then through the second hole of the riser housing, and through the second nylon washer. Attach lock washer and acorn nut. Tighten with hex key.

**Note:** Nylon washers must be installed between foot stirrup and riser.

#### **See Figure 6**

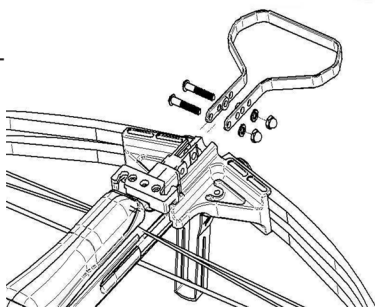

*Fig. 6*

**Note:** Mark the serving of the string on each side of the flight track at rest. After cocking the crossbow make sure that the marks on the string are showing equally on each side of the trigger mechanism. Unevenly cocked crossbows will have erratic arrow flight. Apply Barnett Lubewax to the string serving and track surface.

### ***Installing an Optional Scope***

- Position your scope by moving it forward or backward until the proper eye relief is found. This is typically three to four inches from your eye to the eyepiece when you are holding the crossbow in a shooting position.
- Tighten the scope mounting side plates with caution.

**Important:** Be sure to tighten windage/elevation caps and scope mount rings before shooting crossbow.

## **CROSSBOW OPERATION**

### ***Cocking your Crossbow***

- Be sure to apply Barnett lubewax to the string including the center serving, cables and the flight track before cocking.
- Place the foot stirrup on the ground with one foot in the stirrup and the stock end resting against your thigh. **See Figure 7**
- Place both hands on the string no more than a ½ inch on each side of the crossbow body. With even pressure on each side, pull the string back until it locks into the trigger mechanism with an audible “click”. Be sure to apply downward pressure against flight track. **DO NOT** pull or lift the string away from the stock.
- Slowly release hand pressure on the string until you are sure it is locked securely into the trigger mechanism. The crossbow is now cocked with the safety on. **Make sure that the string is seated at the bottom of the tumbler.** The tumbler is the part of the trigger that the string is rest-



*Fig. 7*



ing on when cocked. If it is resting at the top of the tumbler, use both thumbs and gently push the string down until it is seated at the bottom of the tumbler to ensure proper arrow flight.

### ***Loading your Crossbow***

- Place the arrow forward under the front sight bracket (if installed) and lay the arrow on the flight surface. When using arrows with moon nocks, be sure that the odd-colored fletch is placed in the flight groove and that the concavednock is parallel to the string.
- Slide the arrow back under the arrow retaining spring and **fully into the trigger mechanism**. MAKE SURE THAT CONCAVE SECTION OF NOCK IS TOUCHING THE STRING.

### ***Firing your Crossbow***

To fire the arrow from your crossbow:

- Point the crossbow in a safe direction.
- Make sure the arrow retainer spring has maintained the arrow's fully loaded position into the trigger mechanism.
- Push the safety forward to the "off" position. The crossbow will now fire when the trigger is pulled. The safety **MUST** be disengaged in this manner prior to every shot. ***The Anti-Dry Fire trigger mechanism will not fire without an arrow fully loaded in the trigger mechanism.***

**BE SURE TO KEEP YOUR FINGERS BELOW THE STOCK FORE-END (FLIGHT TRACK) WHILE SHOOTING. Note photos below.**



**CORRECT**



**CORRECT**



**INCORRECT**



**INCORRECT**

**This will prevent your hands from being struck by the string as it travels forward. The velocity of the string hitting your fingers will cause severe injury.**

### ***Unloading your Crossbow***

The safest way to uncock your crossbow is to fire an arrow into a target or into the ground away from debris, loose rocks or other people.

### ***Sighting In the Crossbow***

Please refer to the instructions included with your scope package.

### ***Arrow Retainer Spring***

When loaded, the arrow should lie “flat” in the flight groove. The arrow retainer spring should not be twisted to the left or right and should exert only enough pressure on the rear of the arrow to hold it in place. It should not lift the front of the arrow off the flight groove. At this point, the arrow should be lying directly parallel with the flight groove.

### ***Arrow Selection and Proper Flight***

Due to the unique design of your Barnett crossbow, it is *imperative* that only specified arrows are used. These arrows are correctly weighted to absorb the high energy generated by the compound design. Lighter arrows simulate a “dry fire” condition and will result in damage to the crossbow VOIDING the warranty. Barnett 20” carbon arrows are correctly “spined”. The minimum arrow weight for a **JACKAL** bow is 400 grains–this includes a 125-grain field point/broadhead. (We recommend the use of Barnett arrows manufactured specifically for your Barnett crossbow.)

### **DRY FIRING WILL VOID THE WARRANTY.**

- Use Barnett’s 20” carbon arrows with straight fletches and a half-moon nock.
- Mechanical broadheads that simulate the flight of a field point may be used where legal.
- The recommended fixed-blade broadheads can be any three-blade low-profile broadhead with a cutting diameter no larger than 1-3/16”.

- When using fixed-blade broadheads, the blades must be aligned with the fletches of the arrow. This can be done by placing a rubber O-ring between the broadhead and the arrow front insert. All broadheads are suggested to be 125 grains.

## **IMPORTANT DISCLAIMER**

Due to the power of the **JACKAL** and the inconsistent properties of wooden shafts (which have a tendency to warp, vary in spine stiffness, density, and moisture absorption--all of which could result in inaccuracy), Barnett Outdoors does not recommend their use under any circumstance. Possible injury could result from shaft breakage, etc. **We accept no responsibility or liability arising from the use of wooden-shaft arrows.**

## **Troubleshooting**

### ***Arrow Flight***

The greatest variable in accuracy are arrows, as they differ greatly and have totally different flight characteristics. Generally speaking, when practicing with field points, target arrows are more accurate than hunting arrows. Fixed-blade broadheads used in hunting, due to their large surface area, tend to cause the arrow to “plane”. To help overcome this, we suggest practicing well in advance of hunting season with the type of arrows that will be used to achieve consistent groupings. Consider the following when selecting arrows: Heavier arrows hold more energy for humane harvesting at reasonable ranges (15-35 yards). Lighter arrows are much faster but hold less energy. ***Never use less than 400-grain arrows (this includes a 125-grain field point/broadhead).***

- If the string has been changed, is it a Barnett string?
- Are the arrows straight and fletches (vanes) in good condition?
- Does the arrow lie flat (true) on the flight groove? Is the arrow retainer spring too tight or twisted?
- Does the arrow slide smoothly and evenly into the trigger mechanism?

- When cocking your crossbow, are you pulling equally on each side of the string? After cocking the crossbow, make sure the marks are shown evenly on each side of the trigger mechanism. When cocking your crossbow, make a conscious effort to hold the string on the flight track so as not to lift over the arrow retainer spring.
- Are you putting the odd-colored fletch down in the flight groove?
- When using broadheads, line up the blades with the fletches on the arrow (using O-ring).
- Are the nocks damaged?

### ***String Fraying***

- Are you using Barnett lubewax on the center string serving and flight track every 5-10 shots and on the cables when needed?
- Keep the trigger mechanism and flight surface free of obstruction.
- Check for metal burrs on the flight track.

### ***Limbs Weak or Losing Power***

- Has the crossbow been dry fired (could cause limbs to crack)?
- Inspect the limbs for splits or cracks.
- Are you using Barnett string (proper length)?
- Are your cams in time? Please refer to the diagram below to view appropriate

timing marks and their location. If timing marks are not as shown for both cams, please contact the Service Department for assistance.

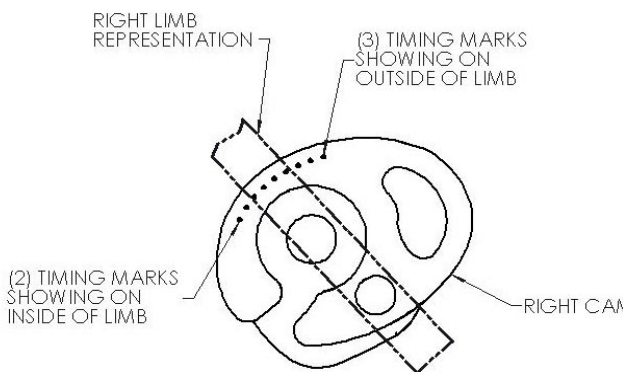

## Care and Maintenance

### *Care of String*

The owner's kit contains a tube of Barnett lubewax that should be applied to the center serving and flight track every 5-10 shots. Barnett lubewax should also be applied anywhere the cables make contact with the cable slide every 20-30 shots.

To extend the life of your cables, it is important to apply Barnett lubewax to all of the nonserved area of the cables. Apply Barnett lubewax every 30-50 shots to the nonserved area of the string, or when white fuzz begins to appear. If the crossbow has been exposed to excessive moisture, you may need to apply the lubewax more often.

**PRIOR TO EVERY SHOOTING SESSION, IT IS RECOMMENDED THAT A COMPLETE CHECK OF STRING, CABLES, CAMS, SCREWS AND ARROWS BE MADE.**

- Always store your crossbow in a safe, dry place.
- Do not expose your crossbow to extreme moisture or heat, such as closed, hot vehicles or near heat sources.
- Inspect cables and string for signs of wear. An authorized service center or the factory should replace cables showing wear immediately.
- Periodically lubricate the cams with lightweight machine oil.
- Keep the flight track and the string serving waxed, reducing friction.
- We do not recommend that the bow be left in the cocked position for periods longer than four hours.

With reasonable care of your equipment and diligent practice, your crossbow will remain an accurate, highly efficient hunting weapon.

## Warranty Information

The stock, trigger mechanism and limbs are covered under a five-year limited warranty. Our liability extends to parts and labor.

**Not covered are:** strings, cables, arrows, transportation of product to our Service Center; damage caused by abuse, modification or failure to perform normal maintenance; or any other expense, consequential damages, coincidental damages, or incidental expenses including damage to property or person. There are no other warranties expressed or implied. This warranty gives you specific legal rights and you may also have other rights that vary from state to state.

**Warranty Registration Card must be mailed within 10 days of purchase to validate the warranty.**

**TO OBTAIN SERVICE:** You must call our Sales Department at (727) 234-4999 for a Return Authorization number (RA#) prior to sending the unit. Write the RA# on the outside of the package along with the words "Service Return". Attach a note to the product containing your name, address, telephone number and a description of the problem. Carefully package and return the product, transportation charges prepaid, to the factory.

**Collect shipments will not be accepted.**

### **How to reach us:**

Barnett Outdoors, L.L.C.

955 Live Oak St.

Tarpon Springs, FL 34689

Phone: (727) 234-4999 Fax: (727) 942-6100

E-mail [service@barnettcrossbows.com](mailto:service@barnettcrossbows.com)

## **AMERICAN CROSSBOW FEDERATION MEMBERSHIP APPLICATION**

### **Annual Benefits Include, but are not limited to:**

#### **Quarterly Issues of the Horizontal Bowhunter Magazine**

*As a member of the American Crossbow Federation, you will receive quarterly issues of the **Horizontal Bowhunter Magazine**. This unique and timely magazine keeps our membership up to date on the latest innovations and developments in the crossbow industry. More importantly, it gives our members an opportunity to share their personal experiences, hunting stories, photos and letters to the editor. It is important to realize and remember that the ACF and the HBM are dedicated to the promotion and preservation of ALL forms of hunting with ALL weapons, especially the crossbow.*

#### **Free Classified Ads in the HBM and Support for Your State Crossbow Organization**

*Your membership includes free classified ads in the HBM. If you have crossbow-related merchandise you would like to buy, sell, trade or hunts to swap, the Classified Ads are free for ACF members. Plus \$5 of your ACF membership will be donated back to your affiliated State organization in your name. If there is no affiliated state organization, the \$5 will be used to help bring the crossbow to states that do not have a crossbow season and are struggling to get one.*

#### **Membership Card and Member's ACF Bumper Sticker**

*Each member of the American Crossbow Federation will receive a membership package containing your first HBM, a membership card and an ACF Bumper Sticker to proudly display on their vehicle.*

#### **Trophy Entries into the American Crossbow Federation Big Game Register**

*As a member of the ACF, you are entitled to enter your trophy animals taken with horizontal and vertical bows in the official big game record book created for ALL archery hunters. **The ACF Big Game Crossbow Register** is a history of animals taken by ACF members with ANY archery equipment, including the crossbow from around the world. Qualified animals that have been taken all the way back to 1975 may be entered into the register. This compilation of crossbow hunting statistics covers ALL big game species from ALL continents with ALL archery equipment.*

## Notes



**Rates:**  
**U.S. Membership**  
**\$30.00-1 yr./\$58.00-2 yr.**  
**Lifetime Membership U.S.**  
**\$700.00**  
**Lifetime Over 65 Membership U.S.**  
**\$450.00**  
**Corporate Membership**  
**\$250.00**  
**Canadian Membership (U.S Funds)**  
**\$35.00-1 yr./\$68.00-2 yr.**  
**Lifetime Canadian (U.S Funds)**  
**\$850.00**  
**Overseas Membership (U.S Funds)**  
**\$40.00-1 yr./78.00-2yr.**  
**Overseas Lifetime (U.S. Funds)**  
**\$1000.00**

-----  
(Remove the form below and return to receive your membership benefits)

**\*\*AMERICAN CROSSBOW FEDERATION  
MEMBERSHIP APPLICATION\*\***

NAME: \_\_\_\_\_  
TELEPHONE: \_\_\_\_\_  
ADDRESS: \_\_\_\_\_  
E-MAIL ADDRESS: \_\_\_\_\_  
CITY: \_\_\_\_\_  
STATE: \_\_\_\_\_ ZIP: \_\_\_\_\_

Barnett Outdoors, LLC  
Mail your membership application to:  
American Crossbow Federation  
POB 251, 20 NE 9th Ave  
Glenwood, MN 56334  
Or call our main desk at 320-634-3660 to use a credit card.



**Cut out and mail immediately to:**  
**Barnett Outdoors, L.L.C.**  
**PO Box 1209**  
**Tarpon Springs, FL 34688**

---

WARRANTY CARD

Name\_\_\_\_\_ Age\_\_\_\_\_

Address\_\_\_\_\_

City\_\_\_\_\_ State\_\_\_\_\_ Zip\_\_\_\_\_

Email:\_\_\_\_\_

Date of Purchase\_\_\_\_\_ Phone # \_\_\_\_\_

Place of Purchase\_\_\_\_\_ Price Paid\_\_\_\_\_

Purchase Address\_\_\_\_\_

City\_\_\_\_\_ State \_\_\_\_\_ Zip \_\_\_\_\_

Serial No. \_\_\_\_\_