



## Fridge

Instructions for use



BLSA821M3SN

ENG



**Please read the operating instructions first!**

Dear Client,

We hope that your product, which has been manufactured in modern factories and checked under the most meticulous quality control procedures, will give you satisfaction.

For this reason, we recommend that you carefully read the entire user manual for your product before using it, and then keep it for future use.

**This manual**

- Help you use your product quickly and safely.
  - Read the manual before installing and operating your product.
  - Follow the instructions, especially those relating to safety.
  - Keep this manual in an easily accessible place as you may need it later.
- 
- In addition, also read the other documents supplied with your product.
  - Please note that this manual may also be valid for other models.

**Symbols and descriptions**

You will find the following symbols in this manual:

**V** Important information or tips.

**H** Warning of conditions dangerous to life and property.

**B** Electrical voltage warning.



***WARNING!***

To ensure normal operation of your appliance which uses an ecological refrigerant, R600a (inflammable only under certain conditions) you must respect the following rules:

- Do not prevent the free circulation of air around the device.
- Do not use mechanical devices to accelerate defrosting, other than those recommended by the manufacturer.
- Do not destroy the refrigeration circuit.
- Do not use electrical appliances inside the compartment to store food, except those which may be recommended by the manufacturer.

**VS INFORMATION**



<div><b>ENERG</b></div> <div></div> <div><div>SUPPLIER'S NAME</div><div><b>HAS</b></div></div> <div><div>MODEL IDENTIFY</div><div><b>H</b></div></div> <div>→ (*)</div>	<p>You can access the model information as saved in the product database by entering the following website and searching for your model identifier (*) which can be found on the energy sticker</p> <p><a href="https://eprel.ec.europa.eu/">https://eprel.ec.europa.eu/</a></p>
----------------------------------------------------------------------------------------------------------------------------------------------------------------------------------------------------------------------------------------------------------------------------------------------------------------------------------------------------------------------------------------------------------------------------------	----------------------------------------------------------------------------------------------------------------------------------------------------------------------------------------------------------------------------------------------------------------------------------

TABLE OF CONTENTS

<b>1 Your refrigerator</b>	<b>3</b>	<b>4 Preparation</b>	<b>10</b>
----------------------------	----------	----------------------	-----------

<b>2 Important Safety Precautions</b>	<b>4</b>	<b>5 Using the fridge</b>	<b>11</b>
---------------------------------------	----------	---------------------------	-----------

Recommended use.....	4	Adjusting the operating temperature .....	11
General Safety.....	4	Using the Interior Compartments.....	11
For appliances equipped with a water fountain connected to running water.....	6	Refrigeration .....	11
Child safety.....	6	Defrosting .....	12
Warning on the use of refrigerants .....	6	Switching off the product .....	12
Energy-saving measures.....	6	Bottle holder .....	12

<b>3 Setup</b>	<b>7</b>	<b>6 Care and cleaning</b>	<b>13</b>
Things to consider when moving your refrigerator .....	7	Protection of plastic surfaces.....	13

Before switching on your refrigerator, .....	7	<b>7 Recommended Solutions to Problems</b>	<b>14</b>
Electrical connection.....	7		
Disposal of the packaging .....	8		
Disposal of your old refrigerator .....	8		
Layout and Installation .....	8		
Replacing the interior bulb .....	8		
Reversibility of doors.....	9		

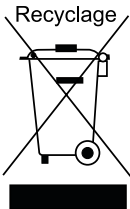

Ce produit est marqué du symbole du tri sélectif, relatif aux déchets d'équipements électriques et électroniques. Cela signifie que ce produit doit être pris en charge par un système de collecte sélectif conformément à la directive européenne 2002/96/CE, afin de pouvoir être recyclé ou démantelé dans le but de réduire tout impact sur l'environnement. Attention les produits électroniques n'ayant pas fait l'objet d'un tri sélectif sont potentiellement dangereux pour l'environnement et la santé humaine en raison de la présence potentielle de substances dangereuses.

# 1 Your refrigerator

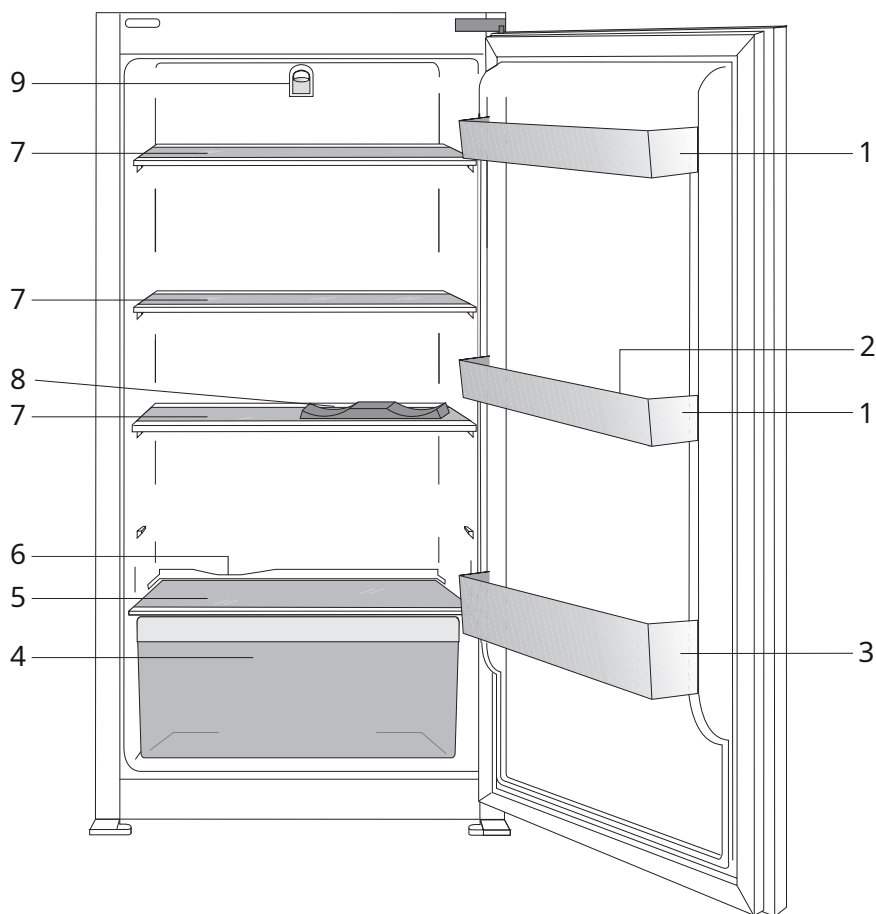

1. Adjustable door shelves

2. egg rack

3. Bottle shelf

4. Crisper drawer

5. Crisper cover

6. Defrost water recovery path -  
drain tube

7. Glass shelves

8. Bottle holder

9. Bulb and thermostat housing

**V** The illustrations presented in this user manual are schematic and may not match your product exactly. If parts presented are not included in the product you purchased, they are valid for other models.

## 2 Important Safety Precautions

---

Please review the following information: Failure to follow these instructions may result in injury or property damage. Otherwise, any commitment related to the guarantee and the reliability of the product becomes invalid.

Original spare parts are available for 10 years from the date of purchase of the product.

### Recommended use

This product is intended for a use:

- indoors and in enclosed areas such as homes;
- in work environments closed, such as shops and offices;
- in closed places of accommodation, such as farms, hotels, boarding houses.
- It should not be used outdoors.

### General Safety

- Before disposing of your appliance, please consult the local authorities or your retailer to find out about the procedure and the approved collection organisations.
- Consult the authorized service center regarding any questions or refrigerator problems. Do not intervene or allow anyone to intervene on the refrigerator without informing the authorized after-sales service.
- For products equipped with a freezer compartment: do not eat ice cream cones or ice cubes immediately after taking them out of the freezer compartment! (This could cause frostbite in your mouth).
- For products equipped with a freezer compartment: do not place bottled or canned drinks in the freezer compartment. This can cause them to burst.
- Do not touch frozen products with your hands, they could stick to them.
- Unplug your refrigerator before cleaning or defrosting it.
- Steam and pulverized cleaning materials should never be used for the cleaning or defrosting processes of your refrigerator. The steam could penetrate electrical parts and cause short circuits or electric shocks.
- Never use parts of your refrigerator such as the door as a support or step.
- Do not use electrical appliances inside the refrigerator.
- Do not damage the parts through which the refrigerant liquid circulates with drilling or cutting tools. Liquid refrigerant that may escape if the evaporator gas lines, extension tubes or surface coatings were punctured, may irritate skin and cause eye injury.
- Do not cover or block the ventilation holes of the refrigerator.
- Electrical devices may only be repaired by authorized persons. Repairs carried out by people who do not have the required skills may pose a risk to the user.
- In the event of a malfunction or during maintenance or repair, disconnect the power supply to the refrigerator either by deactivating the corresponding fuse or by unplugging the appliance.
- Do not pull on the cable when unplugging the plug.
- Place alcoholic beverages upright, in properly sealed containers.
- Never store aerosols containing flammable and explosive substances in the refrigerator.
- Do not use mechanical tools or other devices to speed up the defrosting process other than those recommended by the manufacturer.

- This appliance can be used by children aged at least 8 years and by people with reduced physical, sensory or mental abilities or lacking in experience or knowledge, if they are properly supervised. ) or if instructions relating to the use of the appliance in complete safety have been given to them and if the risks involved have been apprehended. Children should not play with the device. Cleaning and user maintenance shall not be made by children without supervision.
- Should this device change ownership, be sure to give this user manual to the new beneficiary.
- Avoid damaging the power cable when you carry the refrigerator. Twisting the cable can cause a fire. Never place heavy objects on the power cable.

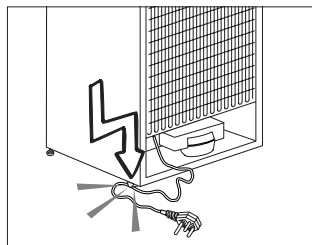

- Do not operate a damaged refrigerator. Consult the authorized service in the event of a problem.
- The electrical safety of the refrigerator is only ensured if the earthing system of your home complies with the standards in force.
- Exposing the product to rain, snow, sun, or wind poses electrical safety hazards.
- Contact the authorized service when a power cable is damaged to avoid any danger.
- Never plug the refrigerator into the wall outlet during installation. You would put yourself at risk of death or serious injury.
- This refrigerator is designed for food storage only. Therefore, it should not be used for any other purpose.
- The label with the technical characteristics is located on the left wall inside the refrigerator.
- Never connect your refrigerator to energy saving systems energy, it can be damaged.
- If there is a blue light on the refrigerator, do not view it with optical tools.
- For manually controlled refrigerators, wait at least 5 minutes to turn on the refrigerator after a power outage.
- Avoid touching the plug with wet hands when plugging in the appliance.
- Avoid plugging in the refrigerator when the electrical outlet has failed.
- For safety reasons, avoid spraying water directly on the external and internal parts of the fridge.
- Do not spray substances containing flammable gases such as propane near the refrigerator to avoid the risk of fire and of explosion.
- Never place containers containing water on your refrigerator, they could cause electric shocks or a fire.
- Avoid overloading the refrigerator with excessive amounts of food. If overloaded, food may fall, injure yourself and damage the refrigerator when you open the door.
- Never place objects on top of the refrigerator, they could fall when you open or close the refrigerator door.
- Products that require precise temperature control (vaccine, heat-sensitive medicine, scientific materials, etc.) should not be stored in the refrigerator.

- If the refrigerator is not used for a long time, it should be unplugged. A problem with the power cable could cause a fire.
- The end of the electrical outlet must be cleaned regularly with a dry cloth, otherwise it may cause a fire.
- The refrigerator can move if its adjustable feet are not firmly fixed on the floor. Fixing the adjustable feet securely on the floor can prevent the refrigerator from moving.
- When carrying the refrigerator, do not hold it by the door handle. It can damage it.
- When you need to place your product near another fridge or freezer, the distance between the appliances should be at least 8 cm. Otherwise, the adjacent walls may be dampened.

## For devices with a water cooler

- The water supply pressure must be between 1 and 8 bar.
- Use only potable water.

## Child safety

- If the door has a lock, the key should be kept out of reach of children.
- Children should be supervised and prevented from playing with the product.

## Warning on the use of refrigerants

**If your device's cooling system contains R600a:** This gas is flammable. Therefore, please take care not to damage the cooling system and piping when using or transporting it. In case of damage, keep your product away from any potential source of flames that could cause the device to catch fire. Also, place the product in a ventilated room.

## Disregard this warning if your device's cooling system contains R134a.

The type of gas used in the appliance is mentioned on the plate sign located on the left wall of the refrigerator interior.

Never throw the appliance into a fire to get rid of it.

## Economy measures energy

- Do not leave refrigerator doors open for long periods of time.
- Do not put hot food or drinks in the refrigerator.
- Do not overload the refrigerator so as not to block the air circulation inside.
- Do not install the refrigerator in direct sunlight or near heat-emitting appliances such as ovens, dishwashers or radiators. Maintain a distance of at least 30 cm between your refrigerator and any heat source, and at a distance of 5 cm from an electric oven.
- Be sure to store your food in closed containers.
- Defrosting food in the refrigerator compartment saves energy and preserves food quality.



### 3 Facility

---

B In the event that the information contained in this manual has not been taken into account by the user, the manufacturer will not be responsible for any problems.

#### Things to consider when making move of your fridge

1. Your refrigerator must be unplugged.
2. Before transporting your refrigerator, you must empty and clean it. Before packing your refrigerator, you must secure its shelves, drawers, accessories, etc., with adhesive tape to protect them against shocks.
3. The packaging should be securely tied with thick tape or strong rope. Transport and packaging marking regulations must be strictly observed.
4. The packaging and the protective packaging materials must be kept for possible future transport or travel.

#### Before turning on your refrigerator

Check the following points before start using your refrigerator

1. Is the inside of the refrigerator dry and air can circulate freely in the back?
2. Clean the inside of the refrigerator as indicated in the section "Care and cleaning".

3. Insert the refrigerator plug into the wall socket. When the door of refrigerator is opened, the interior refrigerator light comes on.
4. When the compressor starts working, it will make a sound. Liquid and gases built into the refrigerator system can also make noise whether the compressor is running or not. This is completely normal.
5. The front parts of the refrigerator can heat up. This phenomenon is normal. These areas must in principle be warm to avoid any risk of condensation.

#### Electrical connection

Connect your refrigerator to an electrical outlet protected by a fuse of the appropriate capacity.

Important:

- The connection must comply with the standards in force on the National territory.
- The power cable plug must be easily accessible after installation.
- The electrical safety of the refrigerator is only ensured if the earthing system of your home complies with the standards in force.
- The voltage indicated on the label located on the inside left wall of your product must correspond to that provided by your electrical network.
- **Extension cords and multiple sockets must not be used to connect the device.**

BA damaged power cable must be replaced by an electrician qualified.

B The device must not be switched on service before being repaired! This precaution avoids any risk of electric shock!

## Disposal of packaging

Packaging materials can be dangerous for children. Keep packaging materials out of the reach of children or dispose of them in accordance with the guidelines established by the local waste authorities. Do not dispose of them with household waste, deposit them in the collection centers designated by the local authorities.

The packaging of your appliance is produced from recyclable materials.

## Disposal of your old refrigerator

Get rid of your old refrigerator without harming the environment.

- You can consult the service authorized service center or disposal center in your municipality for more information on the disposal of your product. Before disposing of your machine, switch off the electrical plug and, if present, any locks that may be on the door. Make them inoperative so as not to expose children to possible dangers.

## Layout and Installation

HAS If the entrance door to the room where the refrigerator will be installed is not wide enough to allow the refrigerator to pass through, call the after-sales service who will remove the doors of the refrigerator and will bring it sideways into the room.

1. Install the refrigerator in a location that allows for convenient use.
2. Keep the refrigerator away from all heat sources, damp places and direct sunlight.
3. Air ventilation around the refrigerator must be provided for efficient operation. If the refrigerator is placed in a recess in the wall, there must be a space of at least 5 cm with the ceiling and at least 5 cm with the wall. Do not place the appliance on coverings such as a rug or carpet.
4. Place the refrigerator on a flat surface so that it is stable.
5. Do not expose the refrigerator to ambient temperatures below 10°C.

## Interior bulb replacement

To replace the LED bulb in the refrigerator, please contact the authorized service centre. The bulb(s) used in this appliance are not suitable for kitchen lighting. The intended purpose of this light is to help the user place food in the fridge/freezer in a safe and comfortable manner. Indicators used in this device must withstand the conditions physical extremes such as temperatures below -20°C.

## Reversibility of doors

Proceed in numerical order.

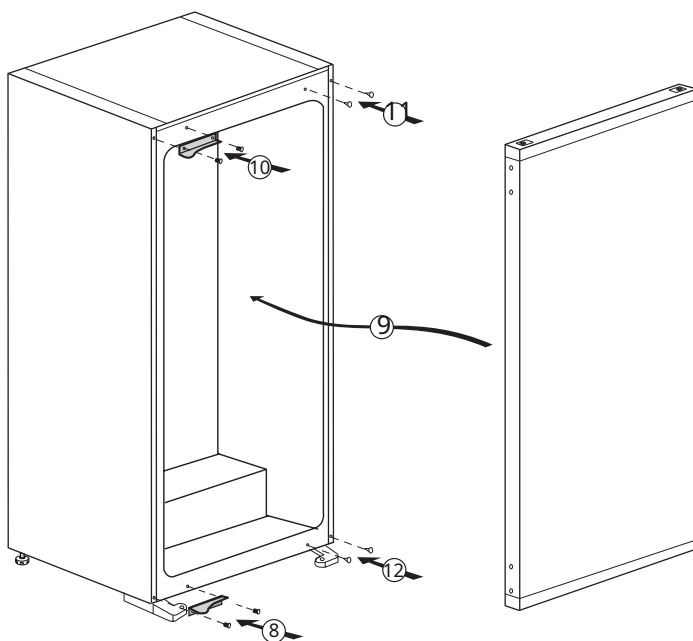
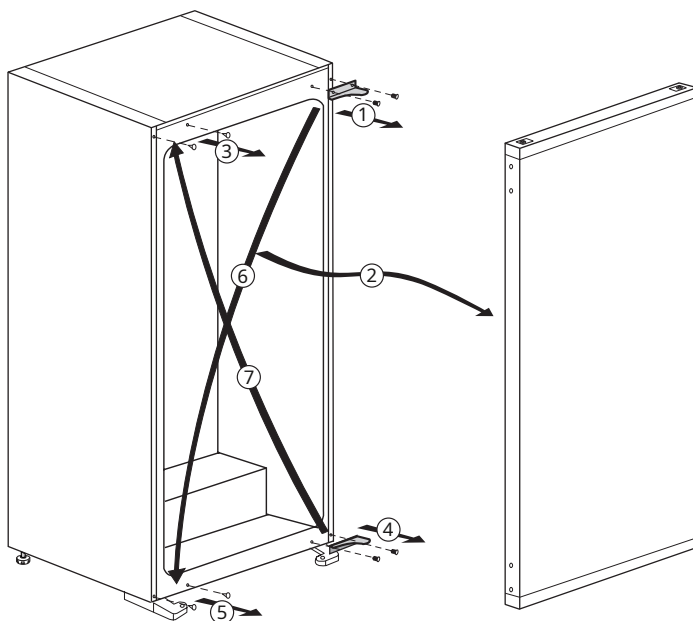

## 4 Preparation

---

**V** Your refrigerator must be installed at least 30 cm from heat sources such as hobs, ovens, heaters or stoves, and at least 5 cm from electric ovens. Likewise, it should not be exposed to direct sunlight.

**V** Packaging and materials packaging protection must be kept for any future transport or travel.

**V** The ambient room temperature where you install the refrigerator should be at least 10°C. Operating the device in lower temperatures is not recommended and may affect its efficiency.

**V** Please ensure that the interior of your device is thoroughly cleaned.

**V** If two refrigerators are installed side by side, they must be separated by at least 2 cm.

**V** When you operate the refrigerator for the first time, be sure to follow these instructions for the first six hours.

- The door should not be opened frequently.
- The refrigerator must be started empty, without food inside.
- Do not unplug the refrigerator. If a power failure occurs, please refer to the warnings in the "Solutions" section.

recommended to problems".

## 5 Using the refrigerator

### Setting the operating temperature

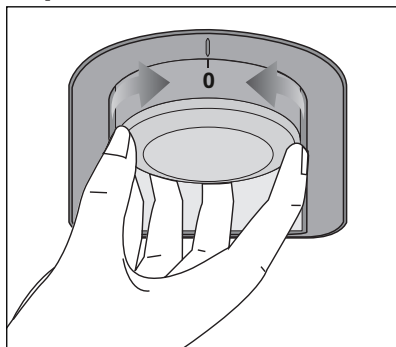

The operating temperature is set using the temperature control.

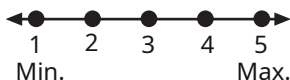

**1 = Lowest refrigeration setting (least cold setting)**

**5 = Strongest Refrigeration Setting (Coldest Setting)**

(Or)

**Min. = Lowest refrigeration setting (least cold setting)** **Max. = Strongest cooling setting (coldest setting)** The median temperature inside the refrigerator should be close to

+ 5°C. Please choose the setting according to the desired temperature.

You will notice that there are several different temperatures in the refrigeration area.

The coldest area is located directly below the vegetable drawer.

The interior temperature is also a function of the ambient temperature, the frequency of opening the door and the quantity of food stored inside.

If the door is opened frequently, the interior temperature rises. For this reason, it is recommended to close the door as soon as possible after use.

### Use of interior compartments

**Glass shelves:** The gap between the shelves can be adjusted if necessary.

**Crisper:** Fruits and vegetables can be stored in this compartment for long periods of time without deteriorating.

**Bottle shelf:** Bottles, jars and cans can be placed in these shelves.

### Refrigeration

#### Food preservation

The refrigerator compartment is intended for short-term storage of fresh food and drinks.

Store dairy products in the compartment provided for this purpose in the refrigerator.

The bottles can be stored on the bottle support shelf or in the bottle rack on the door.

Raw meat is best stored in a polythene bag in the compartment at the very bottom of the refrigerator.

Allow food and drink to cool to room temperature before placing in the fridge.

#### • Attention

Store high strength alcohol upright and tightly closed only.

#### • Attention

Do not store explosive substances or containers with flammable propellant gases (cream spray, aerosol cans etc.). There is a risk of explosion.

## Defrosting

The refrigerator compartment defrosts automatically.

The defrost water runs down the drain path and empties into the drain pan at the rear of the unit.

During defrosting, water droplets form on the back of the refrigerator because of the evaporator.

If all the drops do not drain, they may freeze again after defrosting. Remove them with a cloth dampened with lukewarm water, and never with a hard or sharp object.

Check the flow of defrost water from time to time. The orifice can sometimes become clogged.

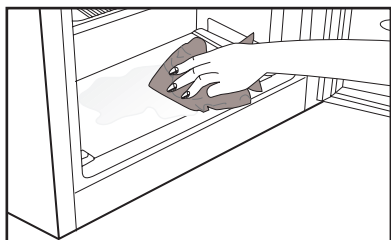
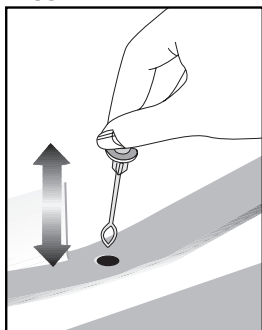

## Switch off the product

If the "0" position is on your thermostat:

- Your appliance will stop working when you turn the thermostat knob to position "0" (zero). Your appliance will not start unless you turn the thermostat knob to position "1" or one of the other positions.

If the "min" position is on your thermostat:

- Unplug your device to shut it down.

## Bottle holder

This accessory can be used to store bottles or cans side by side.

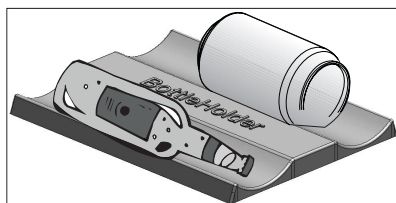

## 6 Maintenance and cleaning

---

**H**Never use gasoline, benzene or similar materials for cleaning up.

**B**We recommend that you unplug the appliance before cleaning.

**V**Never use utensils sharp edges, soap, household cleaner, detergent and shoe polish for cleaning.

**V**Use lukewarm water to clean the cabinet of the freezer / refrigerator and dry it thoroughly with a cloth.

**V**Use a damp cloth soaked a solution of one teaspoon of baking soda to half a liter of water to clean the interior and dry thoroughly.

**B**Take care not to spill water in the lamp housing and other electrical parts.

**B**If you do not use your freezer / refrigerator for an extended period, unplug the power cord, take out all the food, clean it and leave the door ajar.

**V**Inspect door seals regularly to check that they are clean and that there are no food residues.

**V**To remove the door shelves, take out all of its contents then simply push the bin up from the base.

**V**Never use products cleaners or water containing chlorine for cleaning the external surfaces and chrome parts of the product. Chlorine causes these metal surfaces to corrode.

### Protection of plastic surfaces

- Do not place oils or oily dishes in the freezer / refrigerator in unsealed containers, as fats can damage the plastic surfaces of the freezer / refrigerator. If you spill or splash oil on plastic surfaces, clean and wash the soiled parts with hot water immediately.

## 7 Recommended Solutions to Problems

Please check the following list before calling for service. It can save you time and money. This list gathers the most frequent problems not resulting from a defect of manufacture or use of the material. Some of the functions described may not be present on your product.

### The refrigerator does not work.

- Is the refrigerator properly plugged in? Insert the plug into the wall outlet.
- Is the fuse or the connection socket of the refrigerator connected or has the main fuse blown? Check the fuse.

### Condensation on the inside wall of the refrigerator compartment. (MULTIZONE, COOL CONTROL and FLEXI ZONE).

- Very low ambient temperature. Frequent opening and closing of the door. Very high ambient humidity. Storage of liquid foods in open containers. Door left ajar. Set the thermostat to a higher cold level.
- Reduce door opening times or use the door less frequently.
- Cover food in open containers with suitable material.
- Wipe off the condensation with a dry cloth and check if it persists.

### The compressor does not work.

- The compressor's thermal protection device will trip in the event of sudden power cuts or unintentional disconnection, because the pressure of the refrigerant in the cooling system will not be balanced. The refrigerator will resume normal operation after approximately 6 minutes. Please contact the after-sales service if the refrigerator does not restart after this period.
- The refrigerator is in defrost mode. This is normal for a semi-automatic defrost refrigerator. The defrost cycle starts regularly.
- The refrigerator is not plugged into the outlet. Make sure the plug is plugged into the wall outlet.
- Are the temperature settings correct?
- There may be a power outage.



The refrigerator operates frequently or for long periods of time.
<ul style="list-style-type: none"> <li>• Your new refrigerator may be wider than your old one. This is completely normal. Large refrigerators operate for a longer period of time.</li> <li>• Ambient room temperature may be high. This is completely normal.</li> <li>• The refrigerator may have been plugged in recently or may have been loaded with food. Complete cooling of the refrigerator may take a few more hours.</li> <li>• Large quantities of hot food may have been placed in the refrigerator recently. Hot foods cause the refrigerator to run for a long time before reaching the reasonable storage temperature level.</li> <li>• The doors may have been opened frequently or left ajar for an extended period of time. Hot air entering the refrigerator makes it work for longer periods of time. Open the doors less often.</li> <li>• The refrigerator or freezer door may have been left ajar. Check that the doors are properly closed.</li> <li>• The refrigerator is set at a very low temperature. Set the refrigerator temperature to a higher degree and wait until the temperature is good.</li> <li>• The refrigerator or freezer door seal may be dirty, torn, broken, or improperly seated. Clean or replace gasket. Any damaged/torn gaskets cause the refrigerator to operate for a longer period of time to maintain the current temperature.</li> </ul>
The temperature of the freezer is very low while that of the refrigerator is correct.
<ul style="list-style-type: none"> <li>• The freezer temperature is set to a very low temperature. Set the freezer temperature to a higher degree and check.</li> </ul>
The temperature of the refrigerator is very low while that of the freezer is correct.
<ul style="list-style-type: none"> <li>• The refrigerator temperature may have been set to a very low temperature. Set the refrigerator temperature to a higher degree and check.</li> </ul>
Food stored in the refrigerator compartment drawers freezes.
<ul style="list-style-type: none"> <li>• The refrigerator temperature may have been set to a very low temperature. Set the refrigerator temperature to a higher degree and check.</li> </ul>

<b>The temperature in the refrigerator or freezer is very high.</b>
<ul style="list-style-type: none"> <li>• The refrigerator temperature may have been set very high. The fridge setting affects the freezer temperature. Change the temperature of the refrigerator or freezer until they reach a correct level.</li> <li>• The doors may have been opened frequently or left ajar for an extended period of time; open them less frequently.</li> <li>• The door may have remained open; close the door completely.</li> <li>• Large quantities of hot food may have been placed in the refrigerator recently. Wait for the refrigerator or freezer to reach the correct temperature.</li> <li>• Refrigerator may have been plugged in recently. Complete cooling of the refrigerator requires time.</li> </ul>
<b>The noise level increases when the refrigerator is in operation.</b>
<ul style="list-style-type: none"> <li>• The performance characteristics of the refrigerator may change due to variations in ambient temperature. This is normal and is not a fault.</li> </ul>
<b>Vibrations or noises.</b>
<ul style="list-style-type: none"> <li>• The ground is not flat or not solid. The refrigerator rocks when moved slowly. Make sure the floor is flat and strong enough to support the refrigerator.</li> <li>• Noises can be produced by objects placed on the refrigerator. Remove everything above the refrigerator.</li> </ul>
<b>The refrigerator makes noises similar to running water or liquid spraying.</b>
<ul style="list-style-type: none"> <li>• Leaks of gases and liquids occur in the refrigerator, due to its operating principles. This is normal and is not a defect.</li> </ul>
<b>The refrigerator makes wind-like noises.</b>
<ul style="list-style-type: none"> <li>• Fans are used to cool the refrigerator. This is normal and not a defect.</li> </ul>
<b>Condensation on interior walls of refrigerator.</b>
<ul style="list-style-type: none"> <li>• Hot, humid weather increases the formation of frost and condensation. This is normal and not a defect.</li> <li>• The door may have remained open; make sure the doors are fully closed.</li> <li>• The doors may have been opened frequently or left ajar for an extended period of time; open them less frequently.</li> </ul>
<b>Moisture is present on the outside or between the refrigerator doors.</b>
<ul style="list-style-type: none"> <li>• There may be moisture in the air; this is quite normal in wet weather. When the humidity is low, the condensation will disappear.</li> </ul>
<b>Presence of a bad smell in the refrigerator.</b>
<ul style="list-style-type: none"> <li>• The inside of the refrigerator must be cleaned. Clean the inside of the refrigerator with a sponge, lukewarm water or sparkling water.</li> <li>• Some containers or packaging materials may cause these odors. Use another container or change the brand of packaging material.</li> </ul>
<b>The door does not close.</b>
<ul style="list-style-type: none"> <li>• Containers may prevent the door from closing. Replace wrappers that are blocking the door.</li> <li>• The refrigerator is not completely upright and may rock when moved slightly. Adjust the lifting screws.</li> <li>• The floor is not flat or solid. Make sure the floor is flat and can support the refrigerator.</li> </ul>
<b>Crisper drawers are jammed.</b>
<ul style="list-style-type: none"> <li>• Food may touch the top of the drawer. Put the food back in the drawer.</li> </ul>