

COMPONENT ACCESS AND REMOVAL

This section explains how to access and remove components from Wolf Pro Series ventilation products.

An attempt has been made to arrange these procedures in such a way as to simulate which components would need to be removed first in order to gain access to other components. When following a component removal procedure, it may be necessary to reference another component removal procedure listed earlier in this section.

NOTE: Before continuing, please take note of the **WARNINGS** and **CAUTIONS** below.

⚠ WARNING

- **IF IT IS NECESSARY TO REMOVE A VENTILATION UNIT FROM ITS INSTALLATION, REMEMBER THAT THEY ARE HEAVY AND COULD FALL RESULTING IN SERIOUS INJURY OR DEATH. PULLING A UNIT FROM ITS INSTALLATION SHOULD ONLY BE PERFORMED BY A TRAINED AUTHORIZED SERVICE TECHNICIAN OR INSTALLER.**
- **TO AVOID ELECTRIC SHOCK, POWER TO A VENTILATION UNIT MUST BE DISCONNECTED WHENEVER ACCESSING AND/OR REMOVING COMPONENTS POWERED BY ELECTRICITY OR COMPONENTS NEAR OTHER ELECTRICAL COMPONENTS.**

⚠ CAUTION

- **Metal edges may be sharp. Use caution when servicing unit to avoid personal injury.**

Filter Removal

NOTE: See CAUTION at beginning of this section.

Slide the center filter upward against the spring retainer until filter is clear of the bottom track. Pull the bottom of filter forward and out removing the filter from the hood.

Remove the right and left side filters by moving them toward the center of the hood and repeat the removal procedure above for each remaining filter. (See Figure 3-1)

Grease Cup Removal

Carefully lift the grease cups up and out of the bottom track. Use caution not to spill any grease that may have accumulated in the cups. (See Figure 3-2)

Switch Bezel Removal

Gently pry front of bezel and push toward rear of hood to disengage plastic clips securing bezel. Rotate downward to remove. (See Figure 3-3)

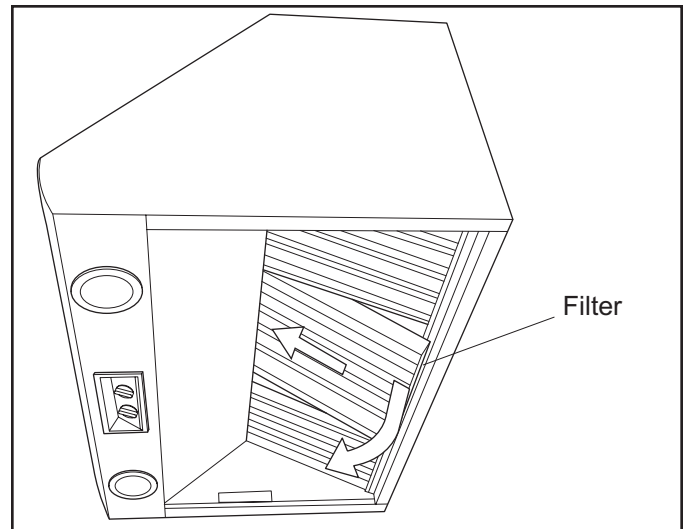

Figure 3-1.

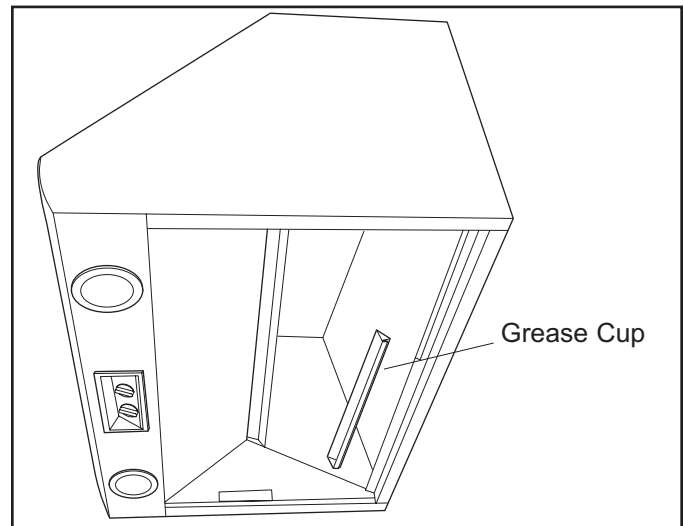

Figure 3-2.

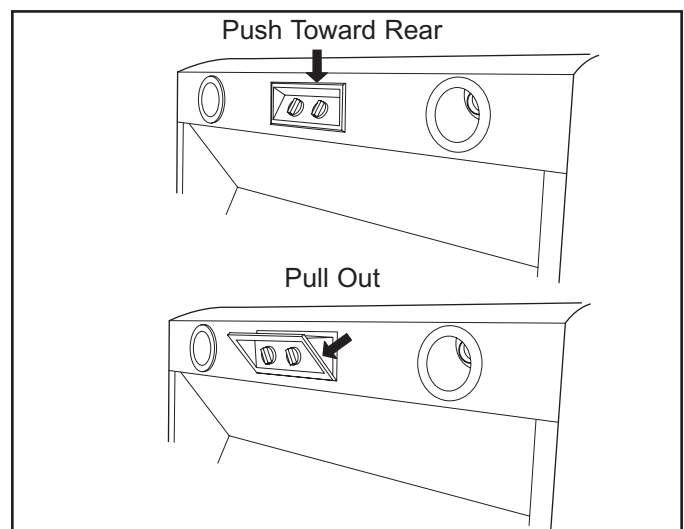

Figure 3-3.

Light and Fan Switch Removal

Once the switch bezel has been removed, the light and fan switches may be removed. Disconnect the electrical leads from the switch being removed. Remove the control knob by gently pulling from switch. Remove the nut securing the switch to the bezel. (See Figure 3-4)

NOTE: See **ELECTRIC SHOCK WARNING** at beginning of this section.

Light Socket Removal (Model W2418)

Loosen the top partition by removing the screws in filter track toward front of hood. (See Figure 3-5)

Remove the screws securing the top partition to the inner side panels. (See Figure 3-5)

NOTE: Front portion of the top partition is secured to the hood using two-sided tape. This tape may need to be replaced after the new light socket is installed.

Carefully push front of top partition downward to release from the two-sided tape holding it in place. You can now reach in behind the top partition and depress the metal clips on light socket and push downward to disengage the socket from the light holder. Disconnect the electrical leads from the socket. (See Figure 3-5)

NOTE: See **ELECTRIC SHOCK WARNING** at beginning of this section.

Light Socket Removal (Model I3418)

Loosen the front lower shroud by removing the screws securing it to the hood. (See Figure 3-6)

NOTE: Top portion of the shroud is secured to the hood using two-sided tape. This tape may need to be replaced after the new light socket is installed.

Carefully pull the top of the shroud downward to release from the two-sided tape holding it in place. You can now reach in behind the shroud and depress the metal clips on light socket and push downward to disengage the socket from the light holder. Disconnect the electrical leads from the socket. (See Figure 3-6)

NOTE: See **ELECTRIC SHOCK WARNING** at beginning of this section.

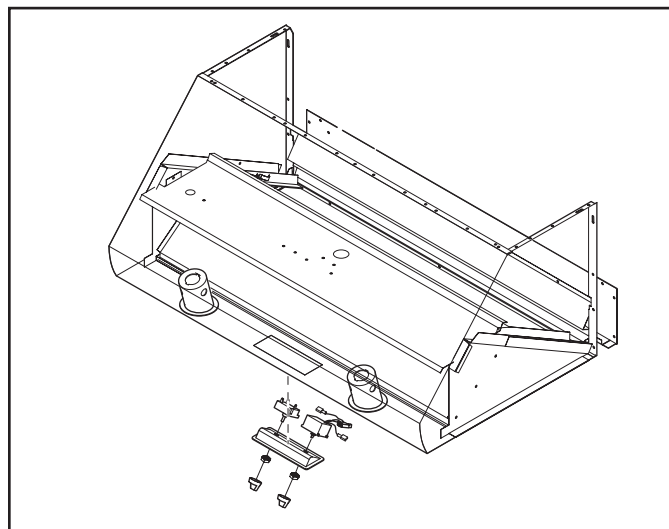

Figure 3-4

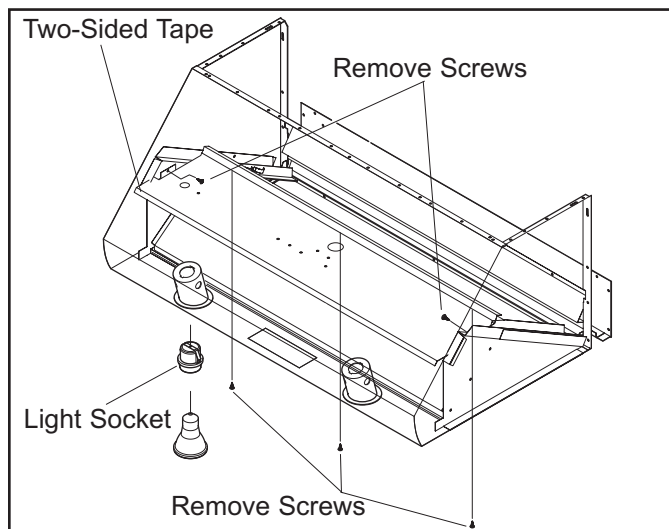

Figure 3-5

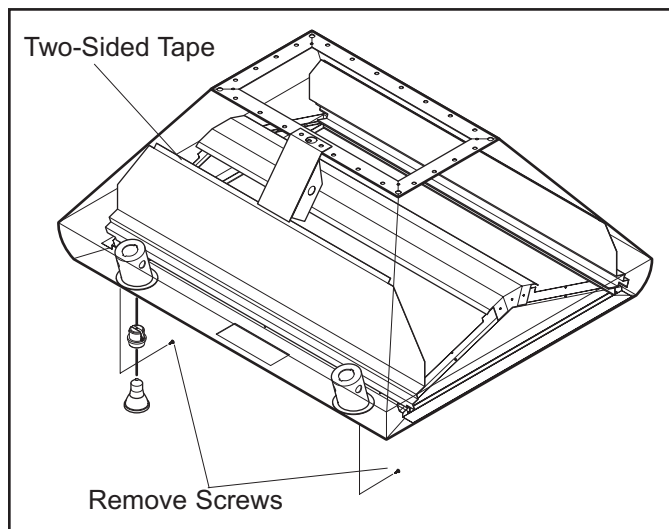

Figure 3-6