

# Air/Hydraulic Press Wire Rope Replacement Instructions

**Product Codes: PROSHPR50TA / PROSHPR30TA**

Follow the steps outlined below for the removal and replacement of the Wire Rope on Product Codes: PROSHPR50TA & PROSHPR30TA Air/Hydraulic Press.

**Step1:** Insert one end of the wire rope into the winch's hole(as shown in the figure), lock the M6 headless screw into the other hole of the winch to tighten the wire rope, and then turn the winch handle clockwise to wind the fixed wire rope for 1.5 cycles

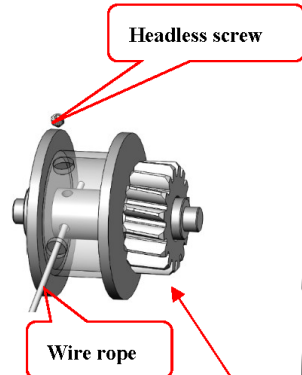

**Step2:** Pass the other end of the wire rope vertically down through the hole(longer one) on the working bench, then up through the other round hole on the working bench, and then down through the long hole, and lock the latch under the first winding of the working bench.

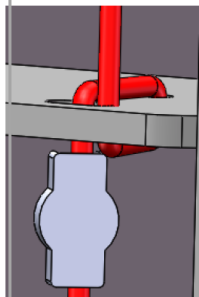

**Note:** 1.The lock catch should be locked at the end of the winding end to prevent falling off. 2.The working bench should be installed in the lowest position.

**Step3:** Cross the pulley (as shown in the figure)

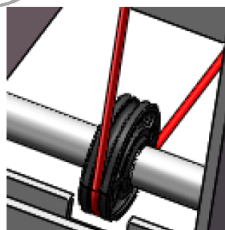

**Step 5:** Cross the pulley (as image shown)

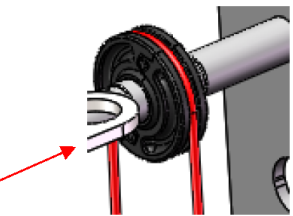

**Step 6:** Pass the other end of the wire rope vertically down through the hole(longer one) on the working bench, then up through the other round hole on the working bench, and then down through the long hole, and lock the latch under the first winding of the working bench.

**Note:** .The lock catch should be locked at the end of the winding end to prevent falling off.

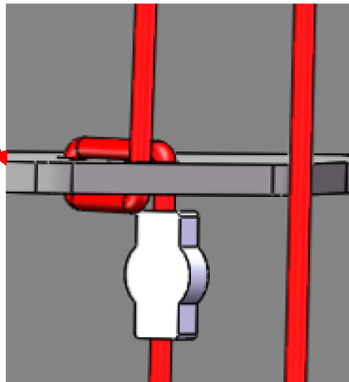

**Step 4:** Cross the pulley (as shown in the figure)

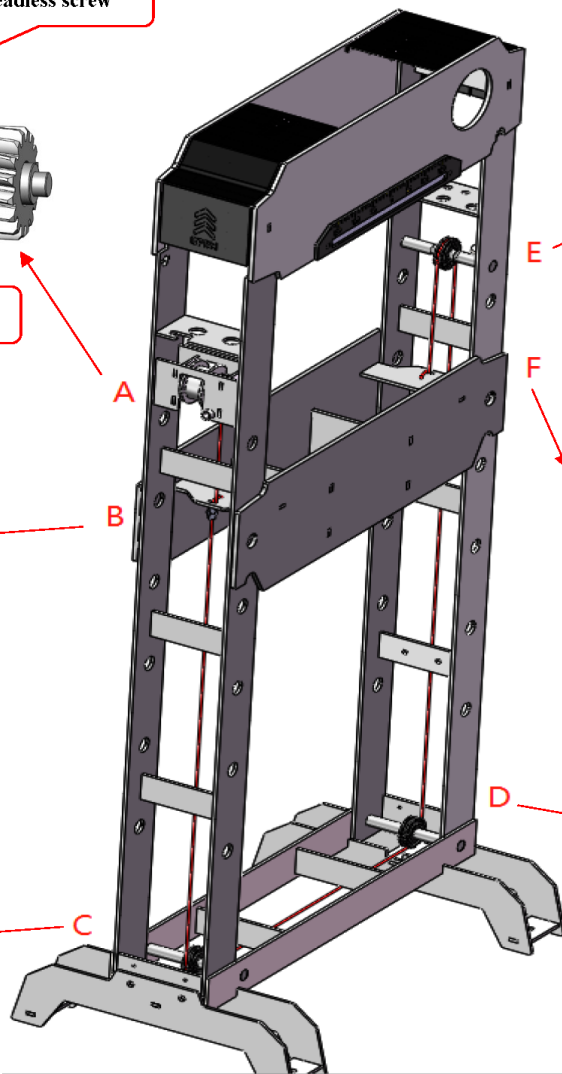
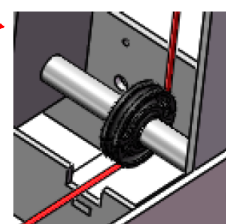

**Step 7:** Rotate the winch handle clockwise to raise the working bench, and observe whether gear shaft hole is aligned with the hole on the frame.

Note: You can use rubber hammer to knock the winding end of the wire rope and the working bench to get the horizontal position.

