



ASSEMBLY INSTRUCTIONS

READ THIS MANUAL

Do not use this product until you read and understand the instructions in this manual.

KEEP THIS MANUAL FOR FUTURE REFERENCE.



Installation QR



Model:GT829

This manual is intended for installation and use. The pattern should be subject to the product you receive.

Version 25.06.26



E-mail: us@gtplayer.com

Web: www.gtplayer.com

If you have any inquiries regarding the item, please reach out to us using the contact information provided on the left. We strive to resolve your concerns within 24 hours (excluding weekends and holidays).

01 Check Various Accessories

Details of accessories

Please check and ensure all the things are in the package.
Feel free to contact us for help if something is not included.



a x1
Back



b x1
Seat

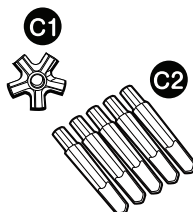

c x1 set
Base



d x1 set
Armrest



e x1
Gas Lift

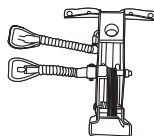

f x1
Mechanism

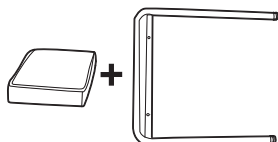

g x1 set
Footrest



h x1
Connector



i x5
Caster



j _____ x1
Headrest



k _____ x1
Lumbar Pillow



m _____ x2
Footrest Rail



n _____ x1
Gas Lift Cover

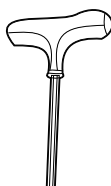

L _____ x1
Wrench

Screws and other accessories

 **o** M6*22 4pcs

 **p** M8*20 4pcs

 **q** M8*40 4pcs

 **s** M5*8 1pc

 **t** M6*20 5pcs

 **u** $\phi 16^* \phi 24$ 4pcs

 **w** M6*35 4pcs

 **x** M8*30 4pcs

 **y** CAP 4pcs

 **z** M6*25 2pcs

02 Instructions Before Using

Chair Installation

Please keep the original box incase you might need to return or replace the product.

1 Install the base.

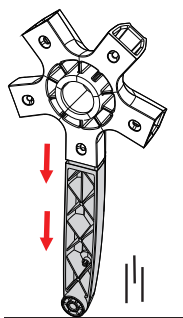

Attention

Snap on the ground to align the screw holes.

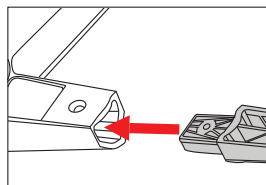
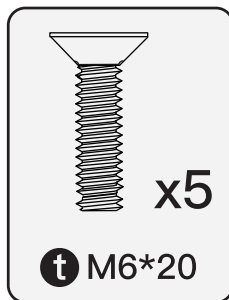
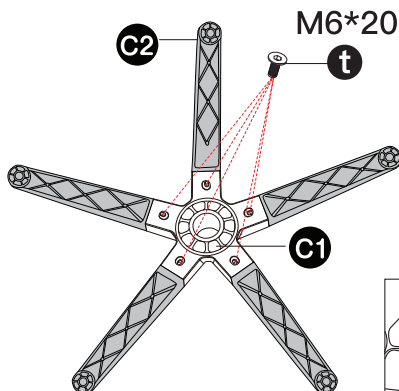

2 Insert the casters.

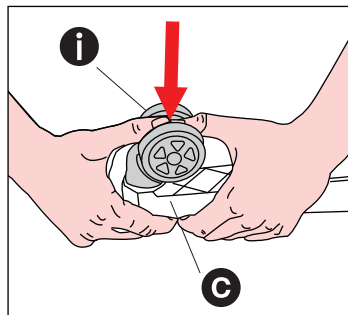
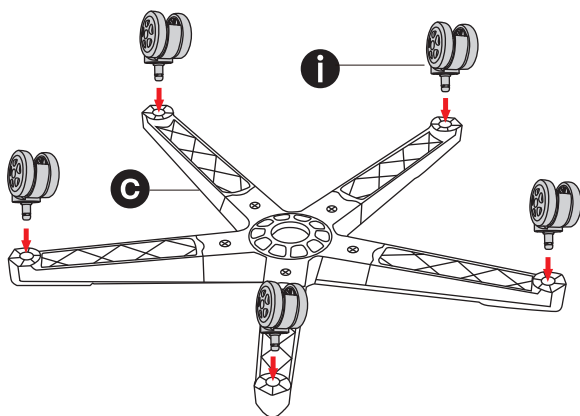

3 Install the gas lift and insert the gas lift cover.

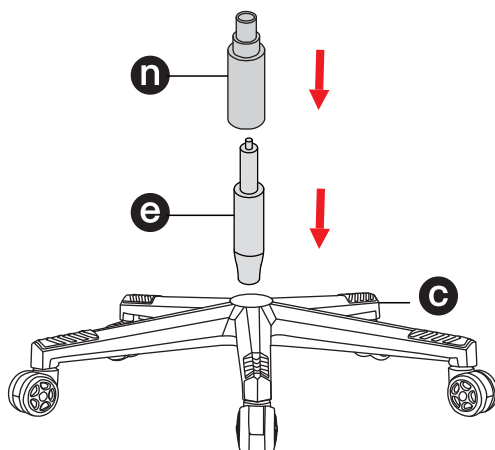

4 Install the mechanism.

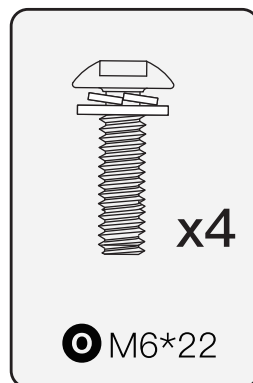
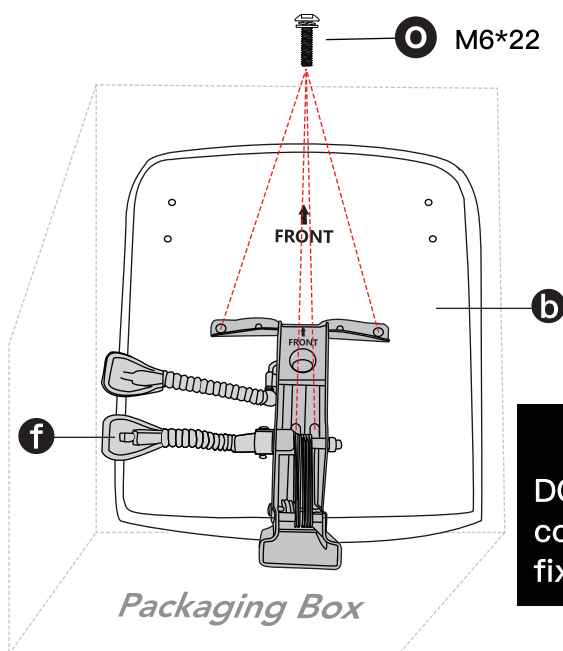

⚠ Attention

DO NOT tighten the screws completely until they are all fixed in the correct position.



5 Install the footrest rails.

(For easy installation, place the SEAT on top of the packaging box.)

Step1

Align the screw holes horizontally.

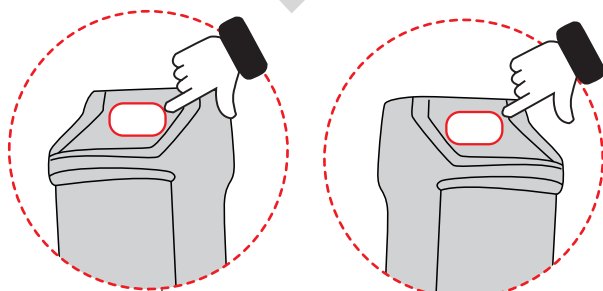

W M6*35

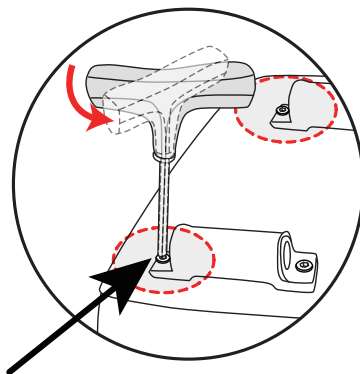
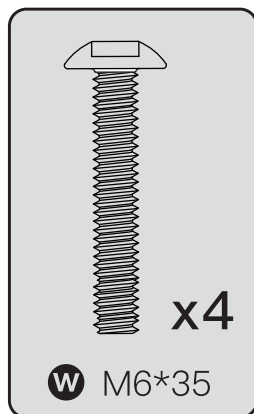
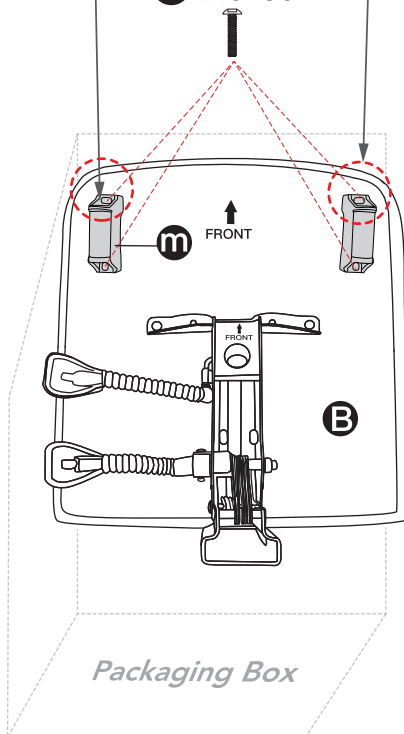

Step2:

Tighten first, then loosen by half a turn to smoothly install the footrest.

6 Install the footrest.

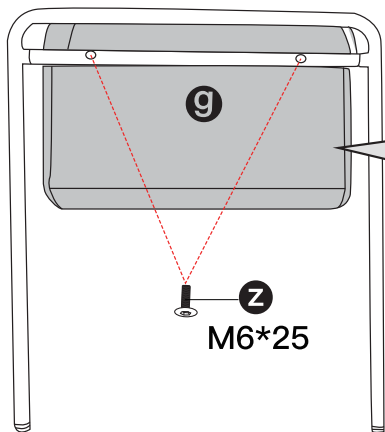

NOTE:

DO NOT mistake the front and back of the footrest paddle. Install the footrest as shown.

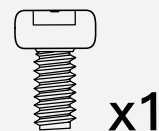
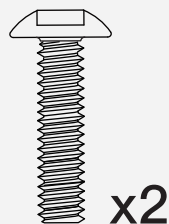

s M5*8

Attention

Please refer to the diagram for the front and back sides and proceed with caution during installation.

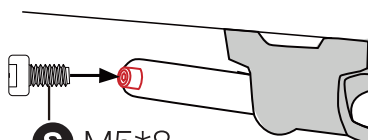

* Only install one side of the footrest rail.

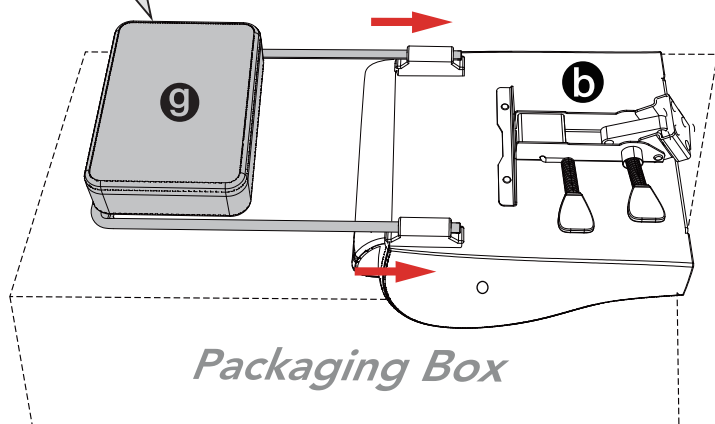

7 Place the seat on the gas lift.

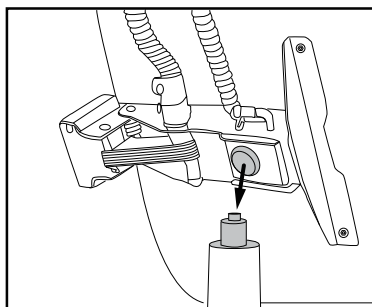
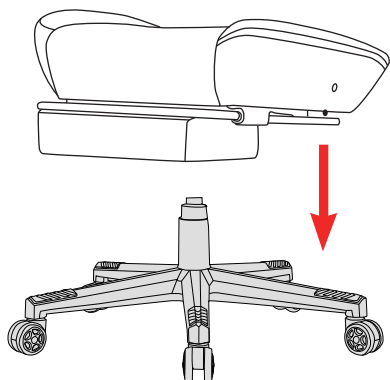

8 Install the connector on the chair back.

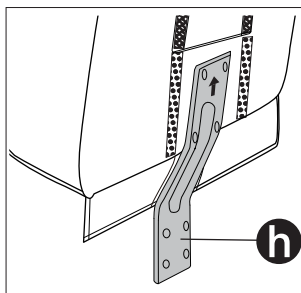
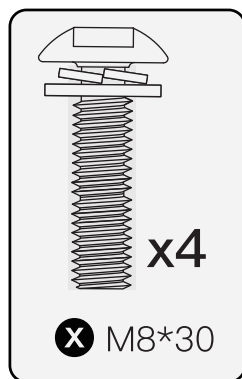
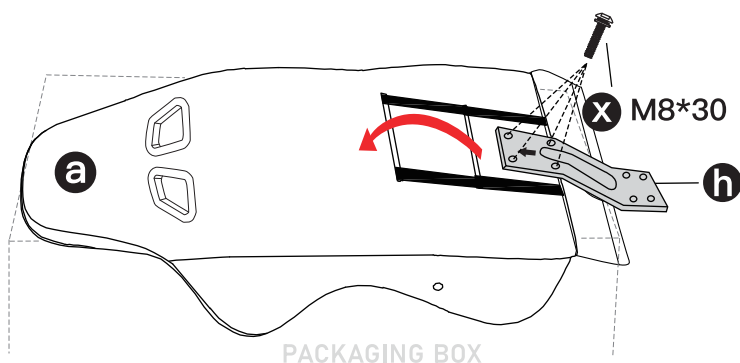

* Note that the direction of the connector.

9 Instal the connector into the rear end of mechanism.

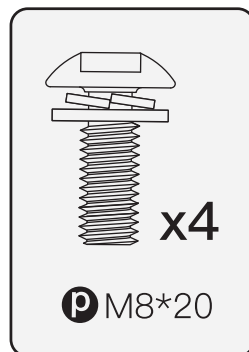
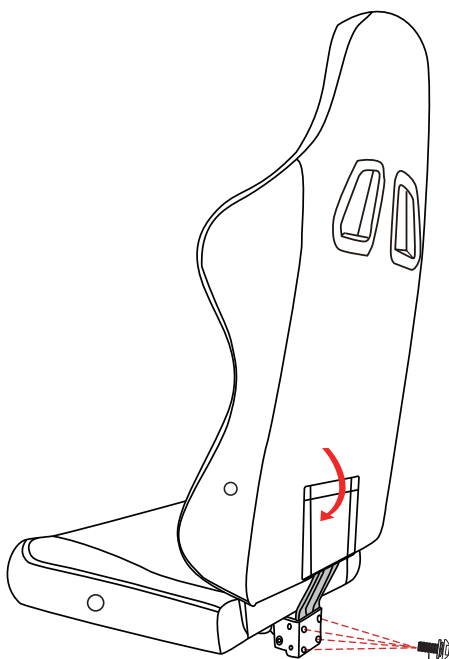

p M8*20

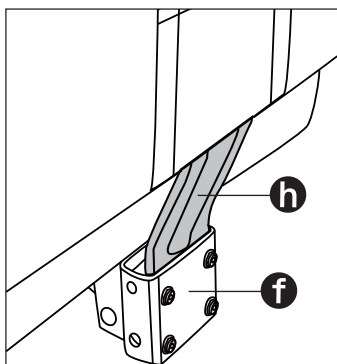

Note: Connector **h** INTO mechanism **f**.

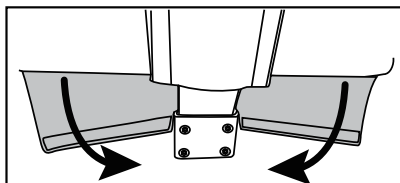

Stick the Velcro of the backrest to the seat bottom.

10 Align the screw holes and install the armrests.

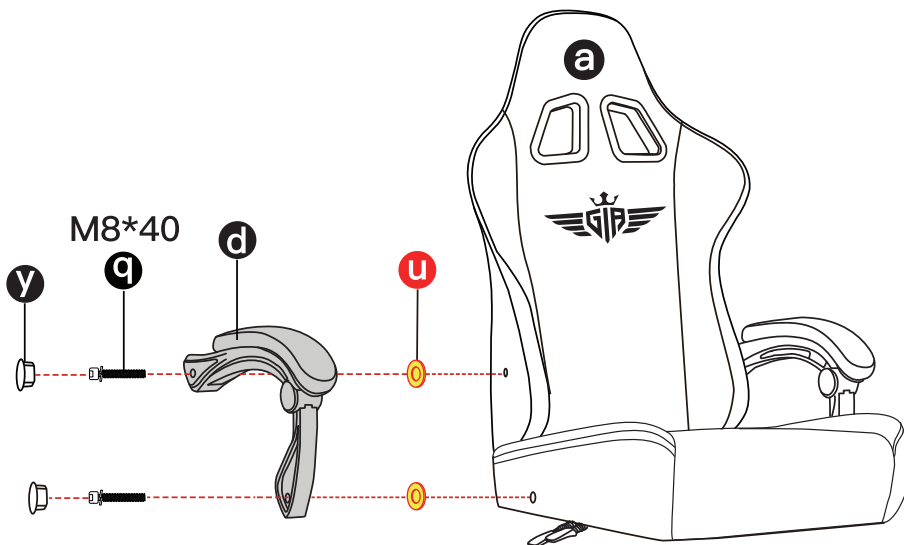
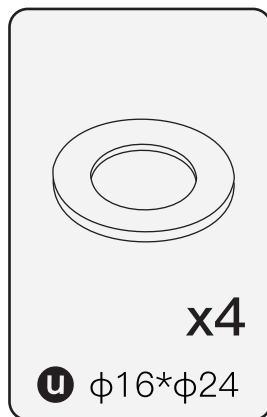
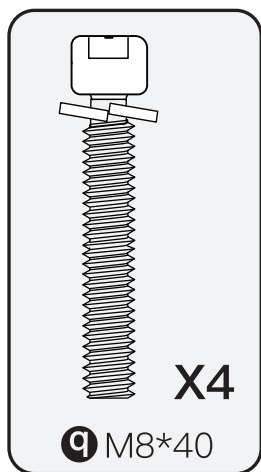

! Attention

DO NOT tighten the screws completely until they are all fixed in the correct position. Put **u** between the armrest and chair body.

11 Install the headrest.

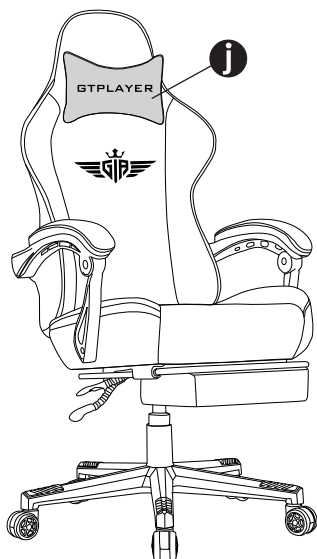

* Length-adjustable belt

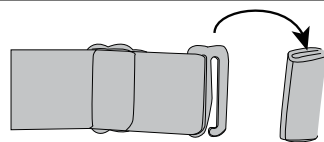

Method 1

Front



Back

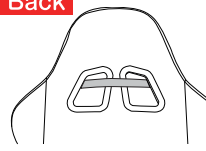

Method 2

Front

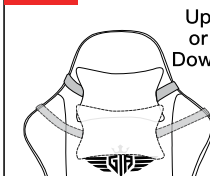

Back

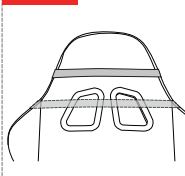

Up
or
Down

The belt can be adjusted up or down.

12 Put on the lumbar pillow. Complete.

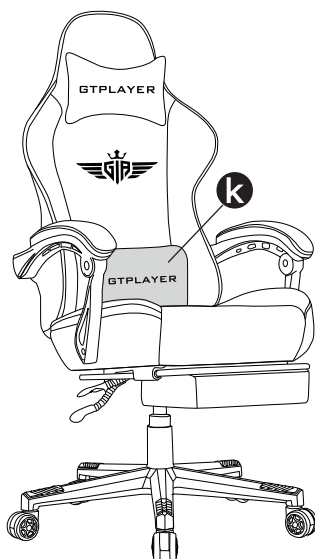

03 Instructions For Use

Functions Display

Please read the function introduction carefully.

A Height Adjustment

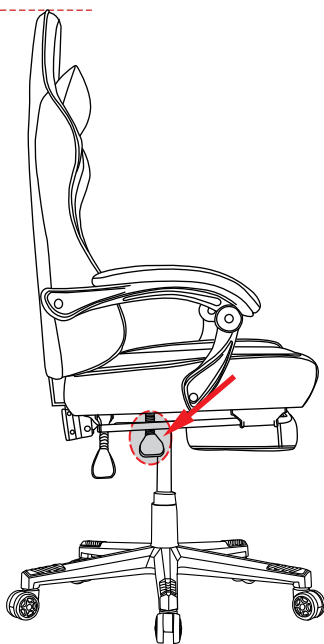
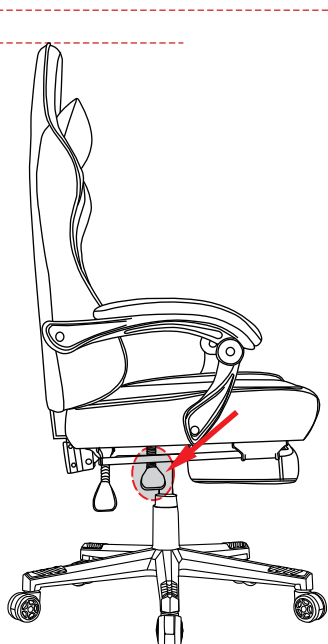
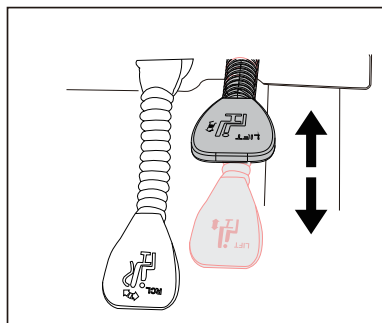

Lift up the “LIFT” lever to adjust the height of chair, and release the “LIFT” lever at a desired height. Lift body slightly off the seat when adjusting the height.

B Back Recline Function

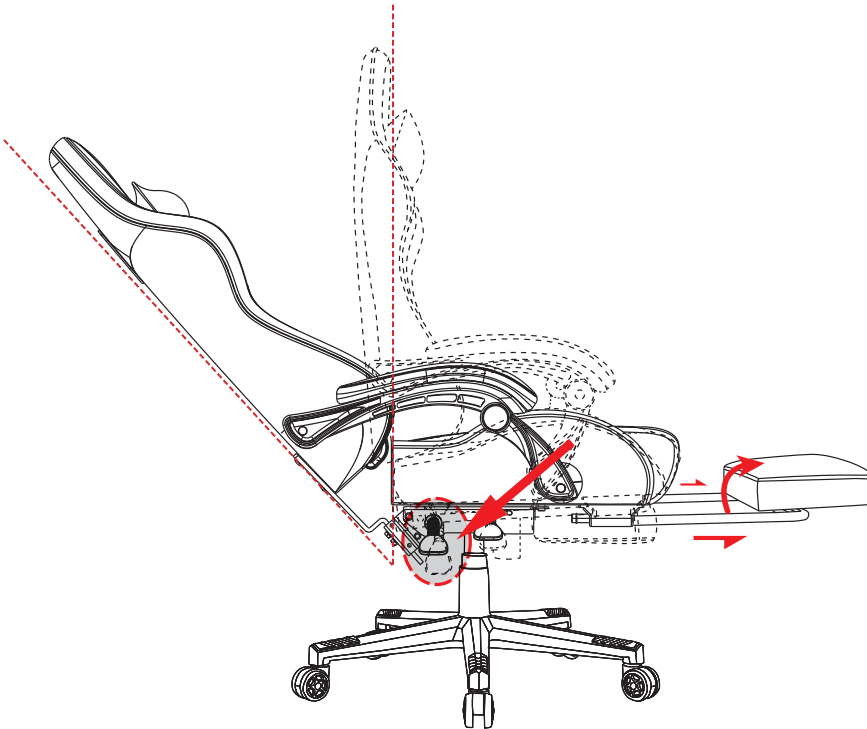
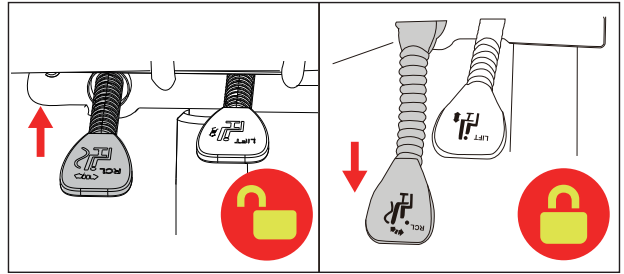

Lift up on the “RCL” lever and the back angle tilts independently with user’s motion. Push down on “RCL” lever and the back angle is locked in position. Rest on the back when resetting back to its normal position, otherwise the back may rebound rapidly.

04 Frequently Asked Questions:

Q1: Isn't the footrest sliding smoothly?

A1: Adjust the footrest rails.

Method 1

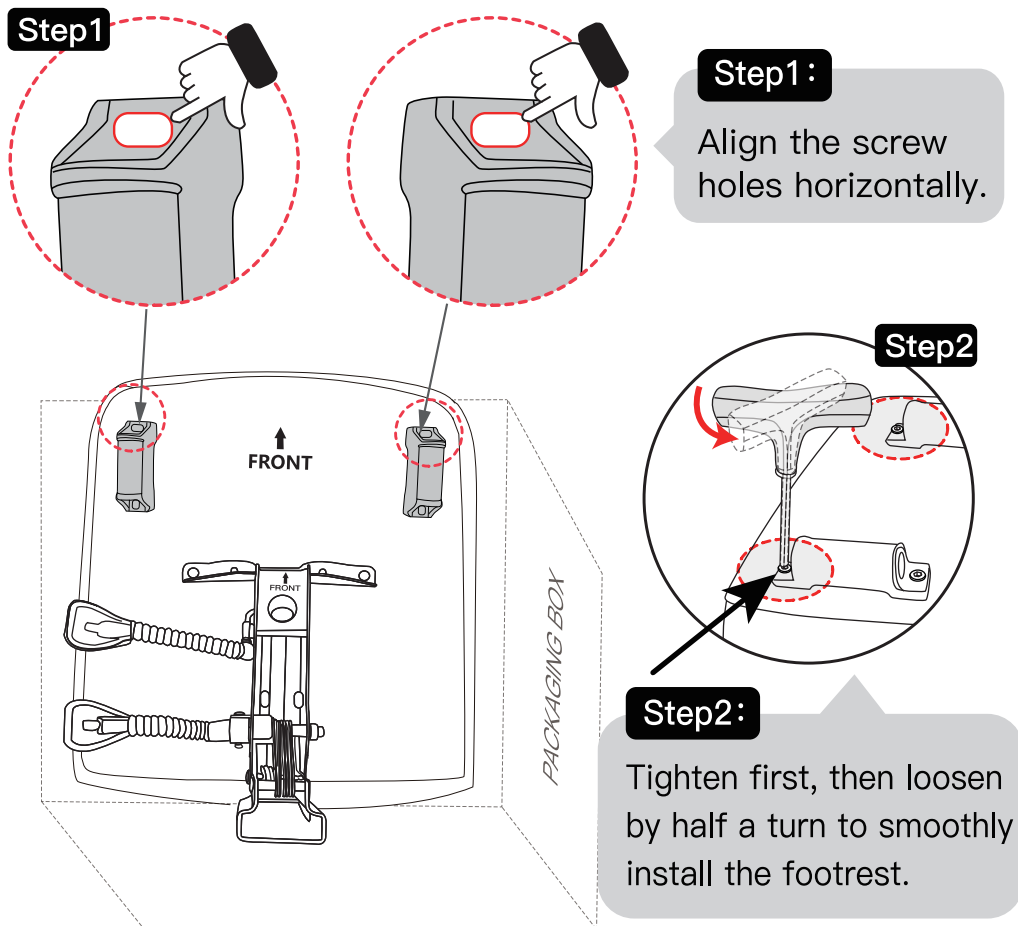

Method 2

Method 1 didn't work? Try applying a small amount of lubricating oil (Not included) evenly on the footrest rods as shown to make the footrest slide more smoothly.

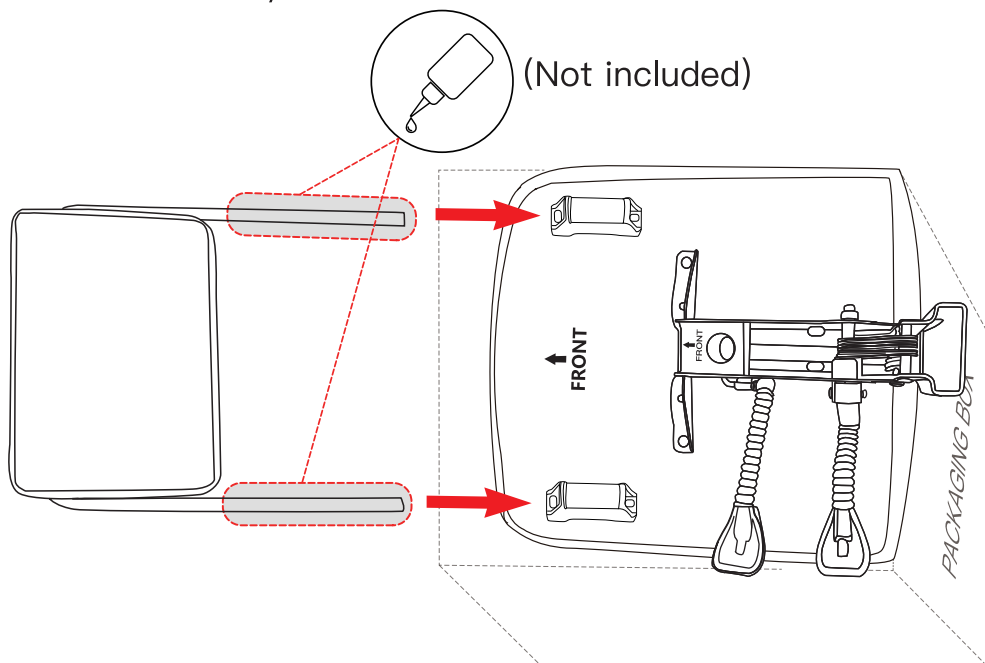

Q2: Why do the armrests loosen after a period of use?

A2: In most cases, the screws of the armrests and back become loose after a period of use, and re-tightening the screws can fix the problem.

05 SAFETY & MAINTENANCE

Please use the chair properly to prevent any potential safety accidents.



Sit in the center of the chair with your back to the backrest.



DO NOT sit at the front edge of the chair.



DO NOT stand on the chair.



DO NOT use the chair with more than one person.



DO NOT turn the chair around when a person is sitting in it.



DO NOT push down on the backrest when a person is reclined



DO NOT place only your back on the chair

SAFETY INFORMATION

- Use this chair for seating only one person at a time.
- ☒ DO NOT stand on the chair.
- ☒ DO NOT use the chair as stepladder.
- ☒ DO NOT use the chair unless all screws are firmly secured.
- ☒ Avoid contact with sharp objects to prevent puncturing the fabric.
- ☒ Every 6 months, check all screws to ensure they are all tight.
- ☒ To clean, spot clean only needs a damp towel and mild cleaner, first test on a small obscure area of fabric.

MAINTENANCE

- ◆ Thank you for choosing us. We are always dedicated to providing high –quality and safe products for comfort.
- ◆ We guarantee each of its new products to be free from defects in materials and/or defects caused by workmanship. This does not apply to normal wear and tear or to damage caused by neglect, lack of maintenance, abnormal operation or unreasonable use, damage caused by the use of accessories or parts not manufactured by us or components altered and/or disassembled.
- ◆ This warranty does not cover products purchased from unauthorized retailers or not owned by the original consumer. We does not cover lost or stolen items/parts.

Except to the extent prohibited by applicable law, any implied warranty of merchantability or fitness for a particular purpose on this product is hereby disclaimed .

We shall not be liable for any incidental, consequential, special, or punitive damages of any kind for breach of the express limited warranty on this product, or any warranty implied by operation of law.

Other than the express limited warranty set forth above, there are no other warranties that accompany this product, and any oral, written, or any other express.

Dear Customer,

Thank you for choosing us.

Has been implementing its brand and design concept “BE COOL BE FREE”, GTPLAYER is dedicated to enriching gaming and shopping experience for customers.

For safe use, please read this manual before installation, and keep it for after use. Please feel free to email us if you have any concerns about our products. We'll reply within 24 hours.

The following are the things you need to pay attention to so that we can provide you with services when you encounter problems during the installation and use of the product:

- When the product is damaged due to courier problems, please contact our customer service in time for verification.
- We will rectify the issue as soon as possible;
- We give a 1-year quality assurance.

We offer product explanations, installation instructions, product maintenance and maintenance methods.

If you feel satisfied with our product and service,

- Please set our store as your favorites;
- Please recommend our products to your friends;
- Please leave us your purchase experience in our store or product page.

Feedback or reviews from you will greatly help us offer better services to players around the world.

Best regards!

**All information stated is correct at the time of print and is subject to change without notice.*

E-mail: us@gtplayer.com

Web: www.gtplayer.com



If you have any questions about the product, please contact us through the contact information on the left. We will strive to resolve your problem within 24 hours on business days.
