

• ABOUT US •

Driven by the passion for innovation, we at Dr Trust endeavour to provide our customers with the latest medical inventions with an objective to promote good health and wellness all around the world. All the medical devices and health monitors provided by Dr Trust are supported by accurate, latest and ground breaking technologies, innovated at our headquarter in NY, USA. All our products adhere to the most stringent CE and FDA guidelines and are strongly recommended by doctors and health practitioners. Our products are designed in the utmost exemplary ways to ensure that their accuracy and convenience are unrivalled. The ease of their use and operation makes them even more suitable for users of all age groups.

Dr Trust strives to enhance the quality of lifestyle by providing with the most trusted and innovative health care and wellness products. Being a renowned global leader in health care products, Dr Trust ensures that our technically efficient team works dynamically and tirelessly to provide the best of the medical devices to our clients. The products that we have to offer are suitably designed for use at homes, laboratories and hospitals.

Our ground breaking solutions allow you to monitor your health in the easiest ways possible. In today's era when all of our lives are too hassled to handle, it becomes a bit difficult to pay attention to our health. But it has now become easier with the coming of the monitoring devices which can be conveniently used at homes and even on the go.

We bring to you a variety of best self medical devices, trusted and used by Doctors, medical professionals and home users all over the world.

Dr Trust COMPRESSOR PLUS NEBULIZER 405

• QUICK STARTUP GUIDE •

Step1

Wash your hands and place the compressor nebulizer near to power source.

Step2

Connect the air tubing from the compressor to the nebulizer base.

Step3

Add the correct dose of medication to the nebulizer.

Step4

Attach a mouthpiece to the nebulizer.

Step5

Turn the compressor on and check the nebulizer for misting.



• PRODUCT OVERVIEW •

The Dr Trust Compressor Plus Nebulizer 405 is a compact medical device developed for treating asthma, allergies, and other respiratory disorders effectively. It creates a stream of air that travels through a clear tube to the nebulizer. When air enters the nebulizer, it will convert the prescribed medication into aerosol mist for easy inhalation. With proper care and use, it will provide you with many years of reliable treatment. It is intended for use with a single adult, pediatric, or infant patient. To assure the correct use of the product basic safety measures should always be followed including the warnings and cautions listed in this instruction manual.

• KNOW YOUR UNIT •

Main Unit

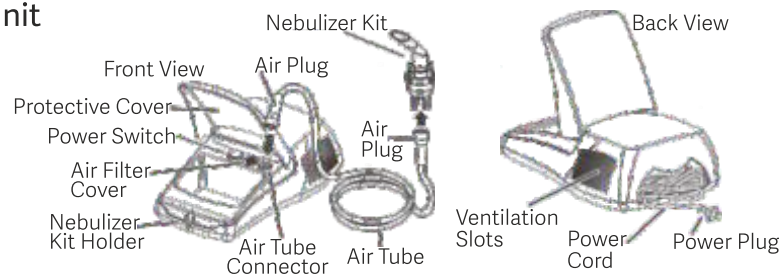

Nebulizer Kit:

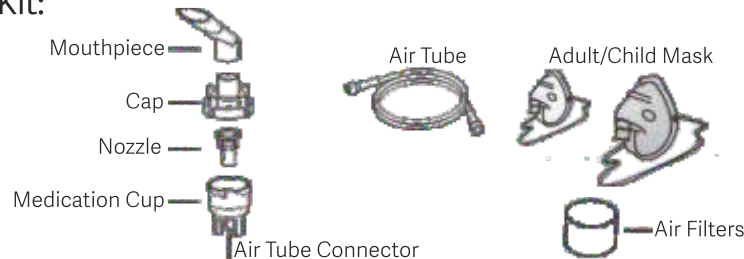

• WARNING •

- Do not block the ventilation slots located on the sides of the device. Do not place the device where the ventilation slots may be obstructed during operation. This could result in the compressor overheating or malfunctioning.
- Do not cover the compressor with a blanket, towel, or any other type of cover during use. This could result in the compressor overheating or malfunctioning.
- Do not use the device where the device may be exposed to flammable gas or vapors.
- Do not use tap or mineral water in the nebulizer for nebulizing purposes.
- Clean and disinfect the nebulizer kit, mouthpiece, and optional masks before using them for the first time after purchase.
- If the device has not been used for a long period of time clean and disinfect the nebulizer kit, mouthpiece, and optional masks before using them.
- Use fresh medication each time you use the device. Always dispose of any remaining medication in the medication cup after each use.
- Provide close supervision when this device is used by, on, or near infants, children, or compromised individuals.
- Make sure the air filter is clean. If the air filter has changed color or has been used for 60 days, replace it.



• SAFETY INFORMATION •

Operating the Device

- Make sure the nebulizer kit is correctly assembled, the air filter is properly installed, and the air tube is correctly connected to the compressor and the nebulizer kit.
- Make sure no parts are damaged, the nozzle and air tube are not blocked, and the compressor operates normally. Do not use the device if the air tube is bent. Do not block the air filter cover.
- Do not alter the nozzle in the medication cup or any part of the nebulizer kit. Do not add more than 5ml of medication to the medication cup.
- Do not operate the device at temperatures greater than +104°F (+40°C)
- Do not disassemble or attempt to repair the device or components.
- Operate the device only as intended. Do not use the device for any other purpose.

Risk of Electrical Shock

- Do not plug or unplug the power cord into the electrical outlet with wet hands.
- Do not spill water or other liquids on the compressor and power cord.
- Do not use or store the device in humid locations, such as a bathroom.
- Use the device within the operating temperature and humidity.
- Do not overload power outlets. Plug the device into an outlet with the appropriate voltage.
- Unplug the power cord from the electrical outlet after using the device.
- Unplug the power cord from the electrical outlet before cleaning the device.

Maintenance and Storage

- Do not leave the cleaning solution in the nebulizer parts. Rinse the nebulizer parts with clean hot tap water after disinfecting.
- Wash the nebulizer parts after each use. Dry the parts immediately after washing.
- Store the device and the components in a clean, dry, safe location.
- Do not carry or leave the nebulizer with medication in the medication cup.
- Do not place or attempt to dry the device, components, or any of the nebulizer parts in a microwave oven.
- Do not wrap the power cord around the compressor.

• PREPARING THE NEBULIZER FOR USE •

Clean and disinfect the nebulizer kit, mouthpiece, and optional masks before using them. Also make sure the air filter is clean. If the air filter has changed color or has been used for 60 days, must replace it.

1. Turn the power switch off. Make sure the power switch is in the O position.
2. Plug the power switch into the electrical outlet.

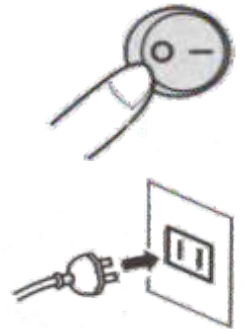

3. Lift up the mouthpiece from the nebulizer kit.
4. Rotate the cap counterclockwise and lift it to remove the cap from the medication cup.
5. Lift up the nozzle and remove the nozzle from the medication cup.
6. Add the correct amount of prescribed medication to the medication cup.

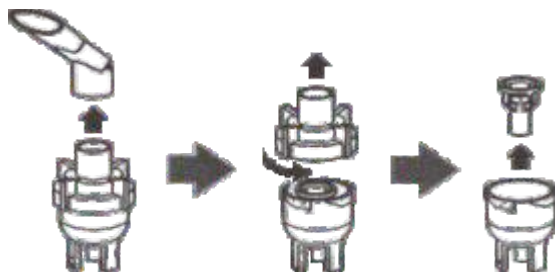

7. Place the nozzle back into the medication cup. Make sure the nozzle is correctly positioned in the medication cup.
8. Place the cap on the medication cup over the baffle. The top of the nozzle should be centered in the cap.



9. Align the protrusion on the inhalation top with the indentation on the medication cup. Turn the inhalation top clockwise until securely closed.
10. Attach the desired inhalation accessory.

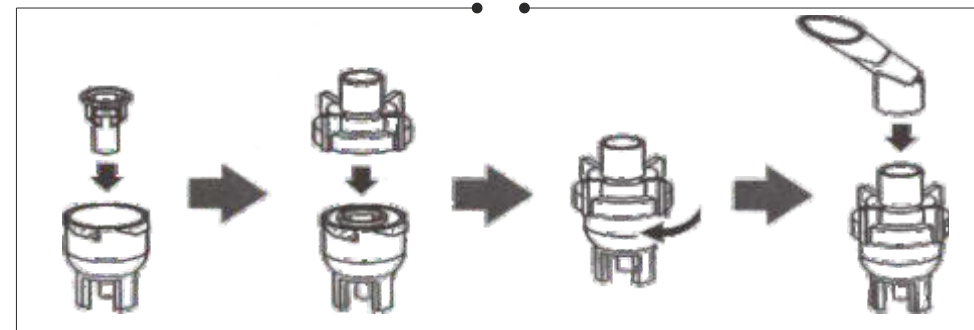

ATTACHING THE AIR TUBE

1. Push the Air Plug on one end of the Air Tube onto the Air Connector on the top side of the compressor.
2. Push the Air Plug on the other end of the Air Tube onto the Air Tube Connector on the bottom of the Nebulizer.

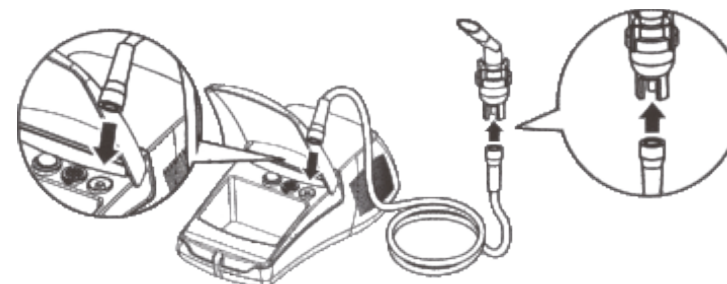

3. Use the Nebulizer Kit Holder as a temporary holder for the nebulizer kit.

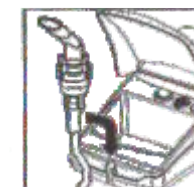

• USING THE MOUTHPIECE •

Insert the mouthpiece into your mouth. Inhale medication by breathing normally. Exhale normally through the mouthpiece. When you turn the power switch off, the power switch should be in the (O) Position. The compressor turns off and nebulization stops.

Attaching the mouthpiece

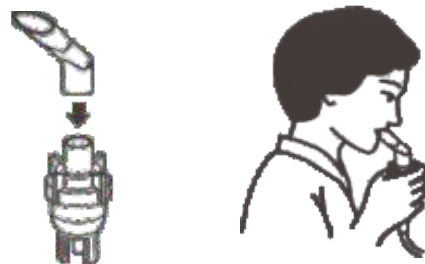

• USING THE CHILD MASK or THE ADULT MASK •

Place the mask over the nose and mouth. Pull the elastic strap over the head. Gently pull on the strap to securely hold the mask over the nose and mouth. Inhale the medication.

Attaching the mask to the cap.

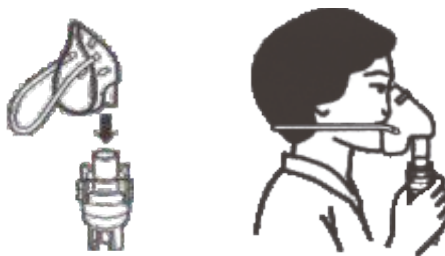

Exhale normally through the mask and complete the treatment.

Note: Inspect the compressor (main unit) and the nebulizer parts each time before using the device. Make sure no parts are damaged, the nozzle and air tube are not blocked, and the compressor operates normally.

• USING THE DEVICE •

1. Make sure the Air Tube is connected to the Air connector on the top side of the compressor.
2. When you turn the power switch on, the power switch should be in the (—) position. The compressor will start and pump air through the air tube to expel the moisture.
3. Turn the power switch off.
4. Disconnect the Air Tube from the compressor. Hold the Air Plug and gently pull the Air plug off the Air Connector on the top side of the compressor.
5. Unplug the device from the electrical outlet after using it.



• CLEANING AFTER EACH USE •

By following the cleaning instructions after each use will prevent drying any remaining medication in the bottle and infections.

1. Remove the inhalation accessory (mouthpiece and mask) from the nebulizer kit.
2. Disconnect the air tubing from the nebulizer kit.
3. Gently twist the cap counterclockwise and lift to separate the nebulizer kit into two sections.
4. Remove the nozzle.
5. Discard remaining medication in the medication cup.
6. Rinse all the parts of the nebulizer kit and the mouthpiece with hot tap water.
7. Rinse the mask with hot tap water.
8. Hand dry or air dry in a clean environment using a soft, clean, lint-free cloth.
9. Assemble the nebulizer kit and store the nebulizer kit in a dry place.

Note:

- The nebulizer kit should be replaced every 6 months.
- Wash the nebulizer parts after each use. Dry the parts immediately after washing.
- Always dispose of remaining medication in the medication cup after each use.
- Use fresh medication each time you use the device.

• DISINFECTION •

You can disinfect the device daily by soaking the parts in vinegar solution or using a commercially available medical disinfectant.

Vinegar Method

1. Make a solution of 1 part of white vinegar and 3 parts of distilled water to submerge the parts.
2. Remove the inhalation accessory (mouthpiece and mask) from the nebulizer kit.
3. Disconnect the air tubing from the nebulizer kit.
4. Gently twist the cap counterclockwise and lift to separate the nebulizer kit into two sections.
5. Remove the nozzle.
6. Wash all the parts of the nebulizer kit, the mouthpiece, or mask in warm water and a mild detergent. Afterward rinse in hot water and air dry all parts.

• CHANGING THE AIR FILTER •

1. Pull the air filter cover to remove from the top side of the compressor.
2. Remove the dirty filter with a small, pointed object.
3. Insert a new air filter into the air filter cover.
4. Put the air filter cover back on the compressor.



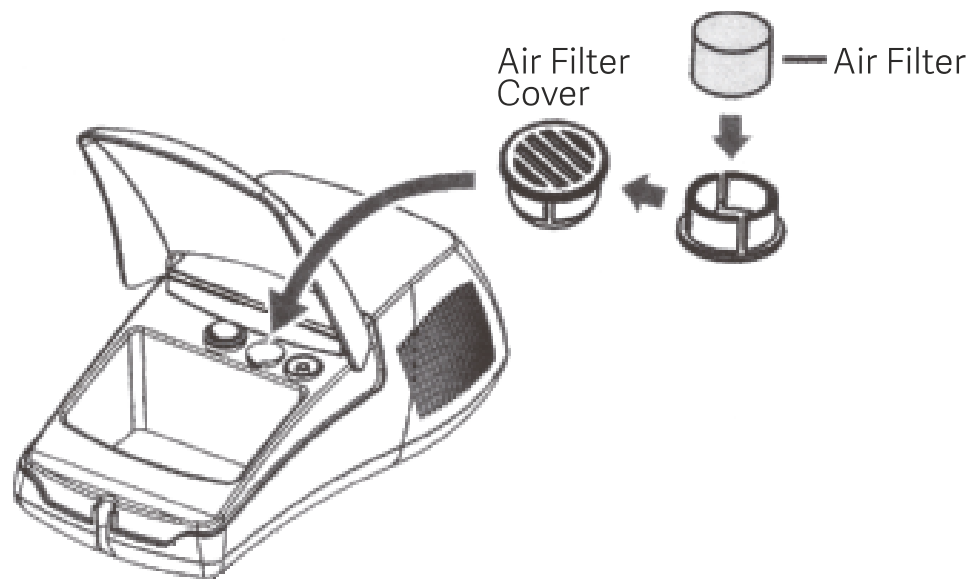

Note:

- Do not attempt to wash or clean the air filter. Damp air filters can cause blockages.
- Do not substitute cotton or any other material for the air filter.
- Wash the air filter cover regularly to prevent any blockage in the cover. Do not boil.
- Make sure the cover is dry before inserting the new air filter.

• TROUBLESHOOTING •

| PROBLEM | CAUSE | SOLUTION |
|--|---|---|
| No power on unit when the power switch is turned on. | The device is not plugged into an electrical outlet. | Turn the power switch off. Plug the power plug into an electrical outlet. Turn the device on. |
| | No medication in the medication cup. Too much or too little medication in the medication cup. | Add the correct amount of medication to the medication cup. |
| | The nozzle is not placed in the medication cup or incorrectly positioned. | Make sure the nozzle is correctly positioned in the medication cup. |
| | The nebulizer kit is not correctly assembled. | Make sure the nebulizer kit is correctly assembled and the inhalation accessory is correctly attached. |
| No nebulization or low nebulization rate when the power is on. | The nozzle is blocked. | Clean and disinfect the nebulizer kit to remove the blockage |
| | The nebulizer kit is tilted at an incorrect angle. | Hold the nebulizer kit correctly. Do not tilt the nebulizer kit so the angle of the kit is greater than 45 degrees. |
| | The air tube is incorrectly attached. | Make sure the air tube is correctly attached to the compressor and the nebulizer kit. |
| | The air tube is folded or damaged. The air tube is blocked. | Make sure the air tube is not folded, kinked, or bent. Inspect the air tube for any damage. Repair it if damaged. |



| | | |
|--|---|--|
| No power on unit when the power switch is turned on. | The air filter is dirty. | Replace the air filter with a new clean air filter |
| The device is abnormally loud | The air filter cover is incorrectly attached. | Attach the air filter cover correctly. Make sure the air filter cover is not blocked. |
| The device is very hot | The ventilation slots are blocked | Do not block the ventilation slots located On the sides of the compressor. Do not cover the compressor with any type of cover during use. Place the device where the ventilation slots are not obstructed during use |

• SPECIFICATIONS •

| | |
|-----------------------------|--|
| Power | AC 220V/50Hz |
| Power Consumption | 180 VA |
| Sound Level | 180 VA 55dBA (1 meter away from 001-ARG) |
| Compressor Pressure Range | 29 to 43 Psi (0.2 to 0.30 MPa) |
| Operating Pressure Range | 10 to 16 Psi (0.07 to 0.12 MPa) |
| Liter Flow Range | 4.5 ~71PM |
| Operating Temperature Range | 50°F to 104°F (10°C to 40°C) |
| Operating Humidity Range | (10°C to 40°C) 10 to 95% RH |
| Storage Temperature Range | -13°F to 158° F (-25°C to 70°C) |
| Storage Humidity Range | 10 to 95% RH |
| Dimension (L×W×H) | 275mm×192mm×100mm (10.82×7.55×3.93 inches) |

| | |
|---------------------------|---|
| Weight | 1764 g (without accessories) |
| Medication Capacity | 8ml (cc) |
| Particle Size | 0.5 to 10 µm |
| MMAD | 4µm |
| Average Nebulization Rate | 0.2ml/min (2%Saline Solution) |
| Standard Accessories | Nebulizer, Nebulizer Kit, Air Tube, Mouth piece ,Filters (5pcs), Adult and Child Mask |

• CUSTOMER SUPPORT •

CONTACT ADDRESS

USA

Nureca INC.USA
276 5th Avenue, Suite 704-397,
New York (NY) - 10001, USA

INDIA

Corporate Office (Mumbai)

Nureca Limited
B2-166, Time Square, 7th and 8th Floor, CTS No 349
and 349-1 Western Express Highway, Andheri East,
Mumbai, Mumbai City, Maharashtra, 400069

Contact us

India: +91-7527013265 / +91-9356658436

Website: www.drtrustusa.com

Email: customercare@nureca.com

Connect with us on social networks

Facebook: @drtrust

Instagram: @drtrustisin

Youtube: NurecaUsa

COPYRIGHT©2020 DR TRUST ALL RIGHTS RESERVED

