

# TV-BOOST

**Model: TV-B6000**



## Wireless TV Speaker Instruction Manual

Thank you for purchasing the TV-Boost™ Wireless TV Speaker System. Please read this operating guide carefully before use and keep it for future reference. If you have questions, please contact our Customer Excellence Dept.

## ■ IMPORTANT SAFETY INSTRUCTIONS

Please read these instructions carefully before using the Wireless TV Speaker.

- Always keep the TV-Boost™ Wireless TV Speaker System dry. Do not drop or immerse in water.
- For your safety, do not attempt to open the unit or battery compartment. Attempting to open or opening the battery compartment violates your warranty.
- The Wireless TV Speaker uses a lithium ion battery. Please observe the safety and handling instructions for the lithium ion battery. Please dispose of the unit/used batteries properly, following any local regulations.
- Do not dispose of the unit/used batteries in the household trash. Do not incinerate. Take the equipment to a nearby recycle center.
- Do not unplug by pulling on the cord. To unplug, grasp the plug, not the cord. Unplug from outlet when not in use and before servicing or cleaning.
- Do not operate any device with a damaged cord or plug, or after the device malfunctions, or is dropped or damaged in any manner. Return the device to the nearest authorized service facility for examination, repair or electrical or mechanical adjustment.
- This device is intended for home and personal use only.

## PACKAGE CONTENTS

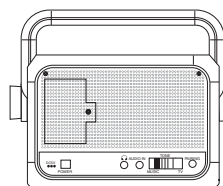

1 Wireless Receiver  
(Speaker)



1 Transmitter Base



1 Audio Switch Cable

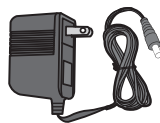

1 AC Adapter



1 Audio Cord



1 Headphones

## FEATURES IDENTIFICATION - PACKAGE CONTENT

### Receiver

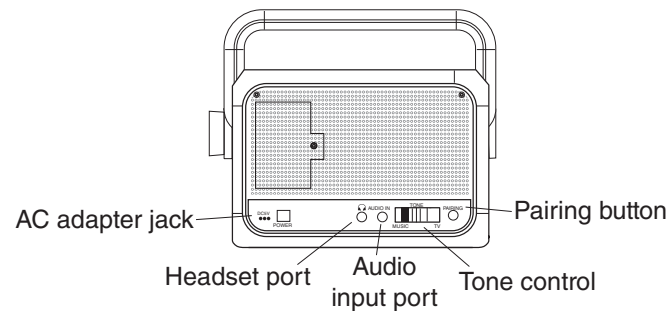
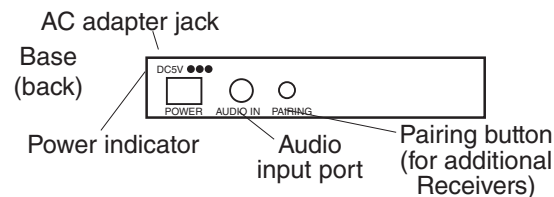
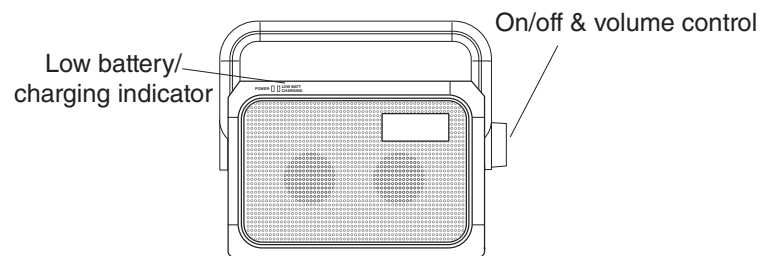

## ■ CONNECTING YOUR TV-BOOST™ WIRELESS SPEAKER SYSTEM TO YOUR TV – QUICK

There are several way to connect your TV-Boost™ Wireless Speaker System to your TV. In this section we will describe the steps to connect your TV-Boost™ Wireless Speaker System to your TV with the simplest, quickest, and easiest method. In Appendix A, we will describe alternative methods, which are more complicated and not necessarily preferred.

### ■ METHOD 1: CONNECT TO THE ANALOG AUDIO OUT ON YOUR TV USING RCA CABLES.

Connect the Base to the back of the TV using the RCA to 3.5mm cable as shown below (Figure 1). Make sure your TV is on. If you have this connection set and do not have sound, please check the settings menu in the Television to see if Audio settings need to be set to output sound to external speakers.

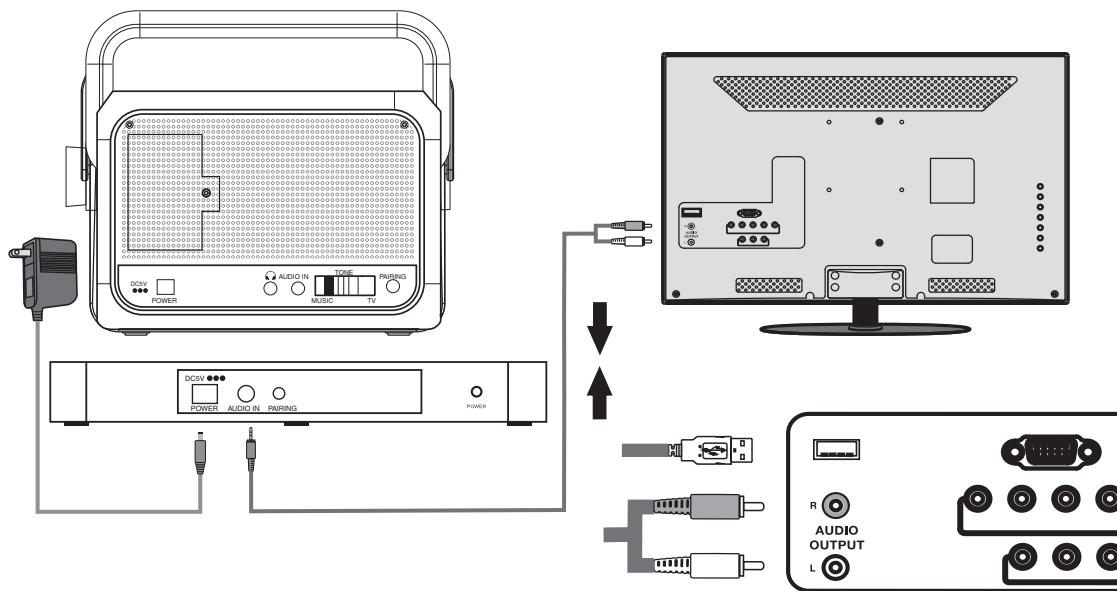

## ■ METHOD 2: CONNECT TO THE TV HEADPHONE OUTPUT JACK ON YOUR TV USING RCA CABLES.

Connect the Base to the back of the TV using the RCA to 3.5mm cable as shown below. Once audio is detected, the green LED on the Base will stop flashing; a slow blinking LED indicates audio is NOT detected. Make sure your TV is on and the Audio settings in your TV is set to output sound to external speakers.

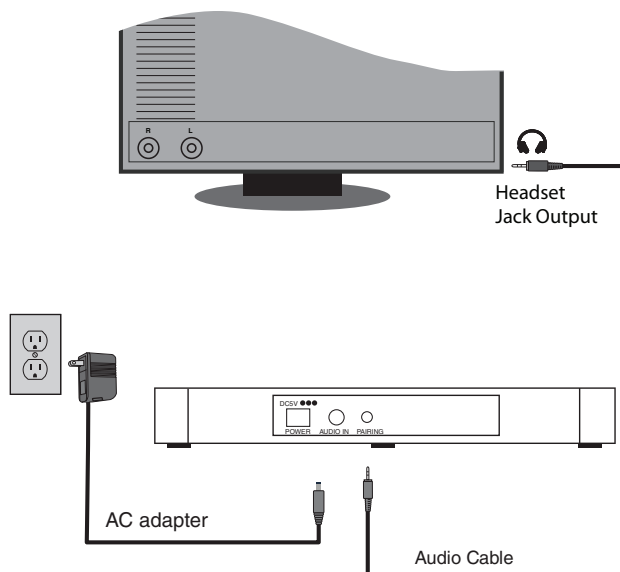

## ■ PLACEMENT OF TV-BOOST™ WIRELESS SPEAKER SYSTEM

We recommended to place the of TV-Boost™ Wireless Speaker System Base on your TV stand next to your TV as shown below.



## ■ DOLBY DIGITAL 5.1 AND PCM (PULSE CODE MODULATION):

Newer TVs have the option to set digital audio output to either Dolby or PCM (you can find what type of output your TV has in the audio/sound section of your TV menu). The TV-Boost™ Wireless Speaker System only works with PCM digital audio format. If your TV does not support PCM audio format and can only output Dolby Digital, you will need to use a Digital to Analog converter. Please note that some streaming services such as Netflix or other similar services will at times stream a program with Dolby Digital audio format.

## ■ CHARGING

Place the TV-Boost™ Wireless Speaker on the Dock/Base as shown below for at least 6 hours before first use. During charging, the low battery/charge LED indicator blinks. When the Placement of TV-Boost™ Wireless Speaker System

When the TV-Boost™ Wireless Speaker is fully charged, the LED will stop blinking and will stay steadily lit. A fully charged battery will provide approximately 8 hours of listening time at moderate volume.

When the TV-Boost™ Wireless Speaker is not in use or when the low battery indicator blinks, place the TV-Boost™ Wireless Speaker back on the Dock/Base for recharging.

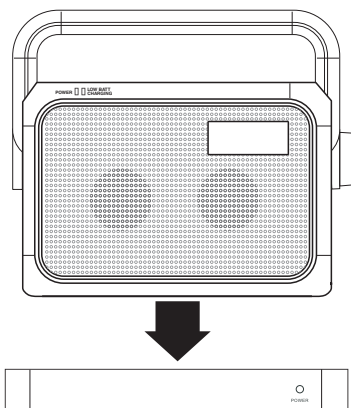

## ■ CONNECTING INCLUDED HEADPHONES TO TV-BOOST™ WIRELESS SPEAKER

Plug in your headphone to the Headphone jack on the side of the TV-Boost™ Wireless Speaker as shown below. No sound will be emitted from the Speaker while the Headphone jack is plugged in. Adjust the headphone volume by rotating the Volume knob on the Speaker.

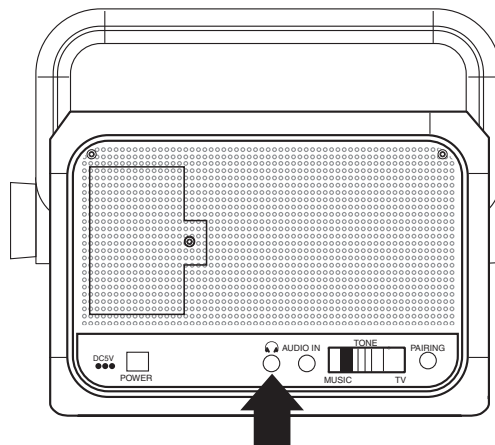

Plug Headphones in here

## ■ OPERATING YOUR TV-BOOST™ WIRELESS SPEAKER

- 1) Rotate the Volume knob to turn receiver On (or Off) and to adjust the sound volume to the desired level. The POWER LED will light up GREEN when the TV-Boost™ Wireless Speaker System is powered on.
- 2) The TV-Boost™ Wireless Speaker volume control works independently from the volume control of your TV speakers. You can turn the volume on your Television to low or even off. On some TV's, you may need to use your remote to go into the TV menu to achieve an optimal audio/speaker setting. Please refer to your Television User's Manual for more information.

- 3) To conserve battery power, the TV-Boost™ Wireless Speaker will turn itself off if no audio signal is received from the Base for a period of 3 minutes. The volume ON/OFF indicator will be off during this standby time. When an audio signal is re-detected, the receiver will resume normal operation.

NOTE: If the TV-Boost™ Wireless Speaker hibernates for an extended time which prevents the normal operation, simply turn the volume knob to the OFF position, then turn the knob back to the ON position. If sound is not heard, place the TV-Boost™ Wireless Speaker back on the base, rotate the volume knob to turn off again, then turn the volume knob back to the ON position. This will force a re-sync between the TV-Boost™ Wireless Speaker and its Dock/Base.

- 4) Set the Tone Control to a position that best allows you to hear and understand TV Sound dialog.

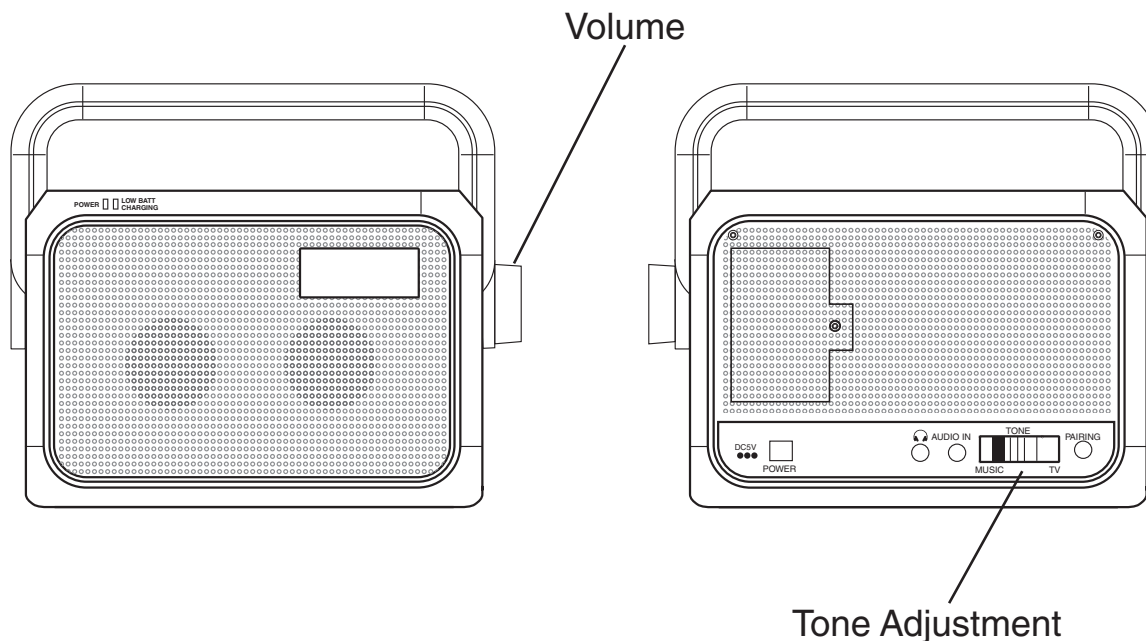



## WARRANTY

Subject to the exclusions contained below, Clearview Productions, Inc. ("Company") warrants the Tv-Boost product to be free from defects in materials and workmanship under normal consumer usage for a period of one (1) year from the date of original purchase, (the "Limited Warranty"). As utilized herein, the term "Products" (or the singular, product) shall include all products set forth above in the what's included section of this User Manual that may be sold by Company now or in the future.

This Limited Warranty is a consumer's sole and exclusive remedy regarding any express warranty claim by a consumer and is subject to the exclusions on the following pages:

**Exclusions:** The Limited Warranty shall not apply in the event of the occurrence of any of the following:

- 1. Normal Wear and Tear.** The Limited Warranty shall not apply to cover the maintenance, repair and/or replacement of parts or the Limitless products due to normal wear and tear by the consumer.
- 2. Abuse and Misuse.** The Limited Warranty shall not cover defects or damage that result in whole or in part from: (a) improper operation, storage, misuse or abuse, accident or neglect by the consumer (including, without limitation, physical damage, cracks and scratches to the surface of the Products; (b) contact with liquid, water, rain, extreme humidity or heavy perspiration, sand, dirt or the like, extreme heat, or food; (c) use of the Products for commercial purposes; (d) subjecting the Products to abnormal usage or conditions; and/or (d) other acts which are not the sole and absolute fault of Company.
- 3. Unauthorized Service or Modification.** The Limited Warranty shall not cover defects or damages resulting in whole or in part from service, testing, adjustment, installation, maintenance, alteration, or modification in any way by someone other than Company or its authorized service centers.
- 4. Altered Products.** The Limited Warranty shall not cover defects or damages to a Product with; (a) serial numbers or date tags that have, at any time, been removed, altered, or obliterated; (b) broken seals or that show evidence of tampering; (c) mismatched board serial numbers; or (d) non-conforming or non-company housings, or components.
- 5. Communication Services.** Defects, damage, or the failure of the Products due to any communication service or signal you may subscribe to or use with the Product or software.

## WHO IS COVERED?

This warranty extends only to the first consumer purchaser and is not transferable to any third party nor applicable to any subsequent owner other than the first consumer purchaser.

## WHAT WILL COMPANY DO?

If Company determines, in its sole and absolute discretion, that a claim is subject to the Limited Warranty, it will, at its sole option, repair or replace the Product or alternatively, it will, in its discretion, refund the purchase price of any Products or software. The Product replacement will be with a functionally equivalent reconditioned / refurbished / pre-owned or new Product or part.

For additional information, visit us at: [www.Easycustomersupport.com/warranty](http://www.Easycustomersupport.com/warranty).

## WHO DO I CONTACT TO MAKE A CLAIM?

In the event of any warranty claim under the Limited Warranty, you can contact the Company below or provide a written correspondence to the address below at which time and in response thereto, you will receive instructions on how to ship any Product at your expense, to a Company authorized repair center. To obtain service, you must include: (a) a copy of your receipt, bill of sale or other comparable proof of purchase; (b) a written description of the problem; (c) the name if your service provider, if applicable; and (d) your mailing address, email address and telephone number.

**Mailing Address (Please call (708-802-6100 first to obtain a RETURN AUTHORIZATION #)**

**Product Service Center WARRANTY Claims | 17720 Oak Park Av. | Tinley Park, IL 60477**

## WHAT OTHER LIMITATIONS ARE THERE?

ANY WARRANTY CLAIM SHALL BE LIMITED TO COMPANY COST OF MATERIAL ON THE PRODUCT DETERMINED TO HAVE A MANUFACTURER'S DEFECT. IN NO EVENT SHALL COMPANY BE LIABLE TO ANY PARTY FOR ANY LABOR COSTS OR ANY OTHER DIRECT, INDIRECT, CONSEQUENTIAL, INCIDENTAL OR SPECIAL DAMAGES, WHETHER IN CONTRACT OR TORT AND COMPANY EXPRESSLY DISCLAIMS LIABILITY FOR ANY DAMAGES OF ANY KIND ARISING UNDER ANY THEORY OF LAW WHATSOEVER. THE PERFORMANCE OF THE PRODUCT DEPENDS ON THE PURCHASER'S ADHERENCE TO MANUFACTURER PRODUCT INSTRUCTIONS AND COMPANY WILL NOT BE RESPONSIBLE TO PURCHASER FOR ANY DEVIATIONS THEREFROM. SOME STATES DO NOT ALLOW THE EXCLUSION OR LIMITATION OF INCIDENTAL OR CONSEQUENTIAL DAMAGES, SO THE ABOVE LIMITATION OR EXCLUSION REGARDING INCIDENTAL OR CONSEQUENTIAL DAMAGES MAY NOT APPLY TO YOU. ALL IMPLIED WARRANTIES, INCLUDING, WITHOUT LIMITATION, THE IMPLIED WARRANTY OF MERCHANTABILITY AND THE IMPLIED WARRANTY OF FITNESS FOR A PARTICULAR PURPOSE SHALL EXPIRE ON THE DATE WHICH IS 1 YEAR FROM THE DATE OF FIRST PURCHASE OF THE PRODUCT BY THE CONSUMER. SOME STATES DO NOT ALLOW LIMITATIONS ON HOW LONG AN IMPLIED WARRANTY LASTS, SO THE ABOVE LIMITATION MAY NOT APPLY TO YOU. WITH RESPECT TO THAT PERIOD OF TIME BEYOND THE COMPANY LIMITED WARRANTY PERIOD, COMPANY DISCLAIMS AND FURTHER MAKES NO WARRANTY OF ANY KIND, EXPRESS OR IMPLIED, INCLUDING BUT NOT LIMITED TO, ANY WARRANTY OF MERCHANTABILITY OR WARRANTY OF FITNESS FOR A PARTICULAR PURPOSE. PLEASE NOTE THIS COMPANY LIMITED WARRANTY GIVES YOU SPECIFIC LEGAL RIGHT, AND YOU MAY ALSO HAVE OTHER RIGHTS WHICH VARY FROM STATE TO STATE.

## NATIONAL STATUTORY RIGHTS

CONSUMERS IN SOME JURISDICTIONS MAY HAVE LEGAL RIGHTS UNDER APPLICABLE NATIONAL LEGISLATION GOVERNING THE SALE OF CONSUMER GOODS, INCLUDING, WITHOUT LIMITATION, NATIONAL LAWS IMPLEMENTING EC DIRECTIVE 99/44. THESE RIGHTS ARE NOT AFFECTED BY THE WARRANTIES IN THIS LIMITED WARRANTY.

## CONSUMER RIGHTS & ARBITRATION AGREEMENT

YOUR USE OF THE COMPANY PRODUCT SHALL BE GOVERNED BY THIS CONSUMER RIGHTS AND ARBITRATION AGREEMENT, ("AGREEMENT"). THIS AGREEMENT AFFECTS YOUR LEGAL RIGHTS AND REMEDIES BY PROVIDING THAT DISPUTES BETWEEN YOU AND THE MANUFACTURER OF THIS PRODUCT, CLEARVIEW PRODUCTIONS, INC., AN ILLINOIS CORPORATION ("COMPANY"), MUST BE RESOLVED THROUGH BINDING ARBITRATION, RATHER THAN IN A COURT. PLEASE READ THIS AGREEMENT CAREFULLY AS YOU ACCEPT THE TERMS OF THIS AGREEMENT BY RETAINING THE PRODUCT(S) PURCHASED IN CONNECTION WITH THIS AGREEMENT ("PRODUCT") FOR MORE THAN FOURTEEN (14) DAYS. IF YOU DO NOT AGREE TO THE TERMS OF THIS AGREEMENT AND YOU PURCHASED THE PRODUCT DIRECT FROM COMPANY (VIA WEB OR TELEPHONE), TO COORDINATE THE RETURN THE PRODUCT TO COMPANY WITHIN FOURTEEN (14) DAYS OF RECEIPT. IF YOU PURCHASED THE PRODUCT ELSEWHERE, WITHIN FOURTEEN (14) DAYS OF PURCHASE RETURN THE PRODUCT TO THE POINT OF PURCHASE. FOR ANY QUESTIONS RELATED TO THE ABOVE, PLEASE CALL (708)802-6100.

## RESOLUTION OF CLAIMS OR DISPUTES

Any claim or dispute between you and Company arising out of or relating in any way to the Product or this Agreement shall be resolved through final, binding arbitration. This arbitration obligation applies regardless of whether the claim or dispute involves a tort, fraud, misrepresentation, product liability, negligence, violation of a statute, or any other legal theory. Both you and Company specifically acknowledge and agree that you waive your right to bring a lawsuit based on such claims or disputes and to have such lawsuit resolved by a judge or jury.

## LIMITATION OF LEGAL REMEDIES

All arbitrations under this Agreement shall be conducted only on an individual (and not a class- wide) basis and an arbitrator shall have no authority to award class-wide relief. You acknowledge and agree that this Agreement specifically prohibits you from commencing arbitration proceedings as a representative of others or joining in any arbitration proceedings brought by any other person.

## ARBITRATION PROCEDURES

Before commencing any arbitration proceedings under this Agreement, you must first present the claim/dispute to Company by calling (708)802-6100, providing requested contact information and allowing Company the opportunity to resolve it. If your claim or dispute is not resolved within sixty (60) days, you may commence arbitration proceedings in accordance with the terms of this Agreement. The arbitration of claim(s)/dispute(s) under this Agreement shall be pursuant to the American Arbitration Association's ("AAA") United States Commercial Dispute Resolution Procedures and Supplementary Procedures for Consumer-Related Disputes (see [www.adr.org](http://www.adr.org) for their rules and procedures). The arbitration of any claim/dispute under this Agreement shall be in the State of Illinois or the location in which you received this Agreement. All administrative expenses of arbitration proceedings under this Agreement shall be divided equally between you and Company except that: (a) if the claim/dispute subject to the arbitration proceedings is less than ten thousand dollars (US \$10,000), you will be responsible for no more than one hundred twenty-five dollars (US \$125) in administrative expenses; (b) if the claim or dispute subject to the arbitration proceedings is more than ten thousand dollars (US \$10,000), but less than seventy-five thousand dollars (US \$75,000), you will be responsible for no more than three hundred seventy-five dollars (US \$375) in administrative expenses; and (c) if the claim/dispute subject to the arbitration proceedings is more than seventy-five thousand dollars (US \$75,000), then you will be responsible for administrative expenses in accordance with the Commercial Fee Schedule provided by the AAA. You acknowledge and agree that each party shall pay the fees and costs of its own counsel, experts and witnesses.

## CHOICE OF LAW & SEVERABILITY

This Agreement shall be governed by the United States Federal Arbitration Act and the laws of the state of Illinois. If any provision of this Consumer Rights and Arbitration Agreement is declared or found to be unlawful, unenforceable or void, such provision will be ineffective only to the extent that it is found unlawful, unenforceable or void and the remainder shall remain fully enforceable.

## EXPORT LAW ASSURANCES

This product is controlled under the export regulations of the United States of America. The Government of the United States of America may restrict the exportation or re-exportation of this product to certain destinations. For further information contact the U.S. Department of Commerce and International Trade Commission.

## COPYRIGHT NOTICE

All Company products and information shared in this manual are protected by copyright. Copying, reproducing, reverse engineering or distributing any information of Company-related product hardware or software without a formal and written authorization and license from Clearview Productions Inc. is prohibited and may result in legal action to the full extent of the law.

## FCC Notice

This device complies with Part 15 of the FCC Rules. Operation is subject to the following two conditions: (1) this device may not cause harmful interference, and (2) this device must accept any interference received, including interference that may cause undesired operations.

**WARNING:** Changes or modifications to this unit not expressly approved by the party responsible for compliance could void the user's authority to operate the equipment.

## APPENDIX A:

### PAIRING ADDITIONAL TV-BOOST™ WIRELESS SPEAKERS

You can pair up to 50 additional TV-Boost™ Wireless Speakers to operate with your Dock/Base. Each additional TV-Boost™ Wireless Speaker needs to be paired with the connected BASE/DOCK one at a time.

#### To Pair Additional TV-Boost™ Wireless Speakers to your TV Sound System

##### BEFORE YOU START

- Make sure your current TV-Boost™ Wireless Speaker base and TV-Boost™ Wireless Speaker are working properly and audio is playing on the TV-Boost™ Wireless Speaker.
- Make sure your new TV-Boost™ Wireless Speaker is fully charged.
- Continue the audio playing to the TV-Boost™ Wireless Speaker BASE/DOCK and TV-Boost™ Wireless Speaker.

##### START PAIRING PROCESS

1. Turn the new receiver ON.
2. Press and hold (about 5 seconds) the PAIRING button on the bottom of the TV-Boost™ Wireless Speaker until the ON/OFF indicator starts blinking. Active Pairing mode is active for approximately 20 seconds.
3. Press and hold the PAIRING button on the back of the TV-Boost™ Wireless Speaker BASE/DOCK until the power indicator starts blinking. Pairing with the new TV-Boost™ Wireless Speaker will take approximately 3-5 seconds.
4. When Pairing is successful, which should take just a couple seconds, the new TV-Boost™ Wireless Speaker's ON/OFF indicator will stop blinking, and will start broadcasting the Audio stream within 54 seconds.
5. If Pairing does not complete successfully, please repeat steps 1-4 again.

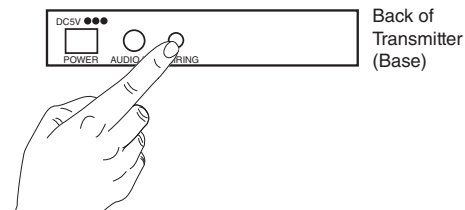
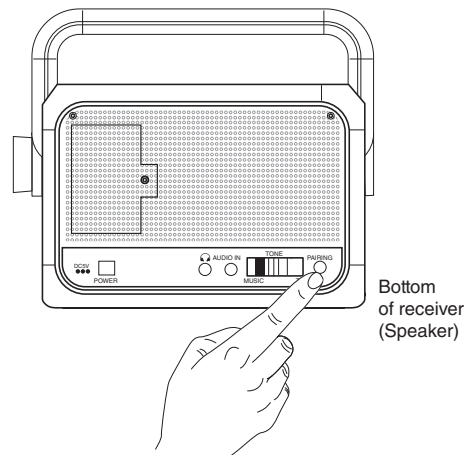

## APPENDIX B

### FEDERAL COMMUNICATION COMMISSION INTERFERENCE STATEMENT

This equipment has been tested and found to comply with the limits for a Class B digital device, pursuant to Part 15 of the FCC Rules. These limits are designed to provide reasonable protection against harmful interference in a residential installation. This equipment generates, uses and can radiate radio frequency energy and, if not installed and used in accordance with the instructions, may cause harmful interference to radio communications. However, there is no guarantee that interference will not occur in a particular installation. If this equipment does cause harmful interference to radio or television reception, which can be determined by turning the equipment off and on, the user is encouraged to try to correct the interference by one of the following measures:

- Reorient or relocate the receiving antenna.
- Increase the separation between the equipment and receiver.
- Connect the equipment into an outlet on a circuit different from that to which the receiver is connected.
- Consult the dealer or an experienced radio/TV technician for help.
- **FCC Caution:** Any changes or modifications not expressly approved by the party responsible for compliance could void the user's authority to operate this equipment. This device complies with Part 15 of the FCC Rules. Operation is subject to the following two conditions: (1) This device may not cause harmful interference, and (2) this device must accept any interference received, including interference that may cause undesired operation.

**APPENDIX C**  
**TROUBLESHOOTING**

- ***No sound from the receiver***

Check all connections to ensure that all the cords are firmly connected at the back of the base and TV. Also, confirm that the receiver is not more than 100 feet away from the base.

- ***There is sound from the TV speaker, but no sound from the receiver***

Check your TV speaker setting by going into the TV Menu, using your TV remote and ensuring the TV is sending audio signals to the base.

- ***The Low Battery/Charging indicator keeps blinking on the receiver***

This indicates that the battery is low and needs to be placed on the base for recharging. When fully charged, the blinking will stop (in about 3 hours). If the blinking does not stop, check to make sure the receiver is firmly connected and properly aligned to the base.

**CLEANING AND MAINTENANCE**

Unplug the AC Adapter from the wall. Then, use a dry, soft cloth to clean and dust the outside surfaces and the charging contacts on the Base. Do not immerse the Receiver in water.

**SPECIFICATIONS**

Transmission:	2.4 GHz Radio Frequency
Speakers:	2x3W Class D
Speaker Battery:	Built-in Lithium Ion Battery
Operating Range:	Over 30m (100 feet) in an open field
AC Adapter Power:	100-240VAC/50-60 Hz input; 5 VDC 1.5A output
Listening Time:	About 8 hours (at 50% volume)
Dimensions:	
Weight:	Final Product May Vary