

# Getting Started with the Insteon Starter Kit

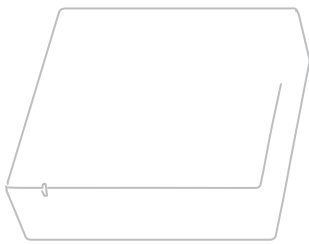

Watch the Setup Video  
[insteon.com/get-started-2244-236](http://insteon.com/get-started-2244-236)

## What's included in your Insteon Starter Kit



Insteon Hub

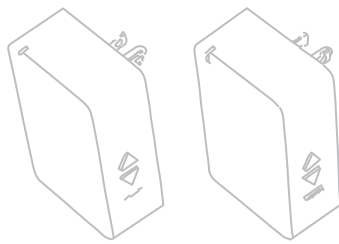

On/Off Modules

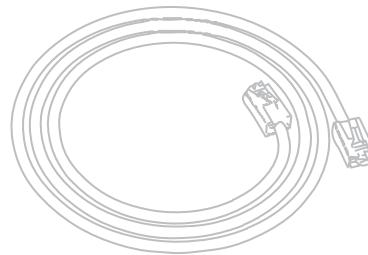

Ethernet Cable

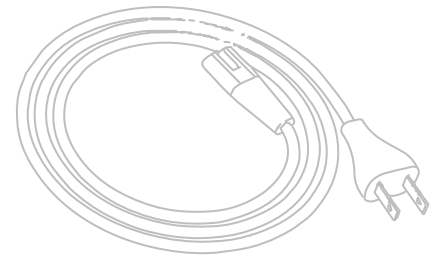

Power Cable

- 1 Connect the ethernet cable to your router and plug in the power cable.
- 2 Connect the cables to Insteon Hub.

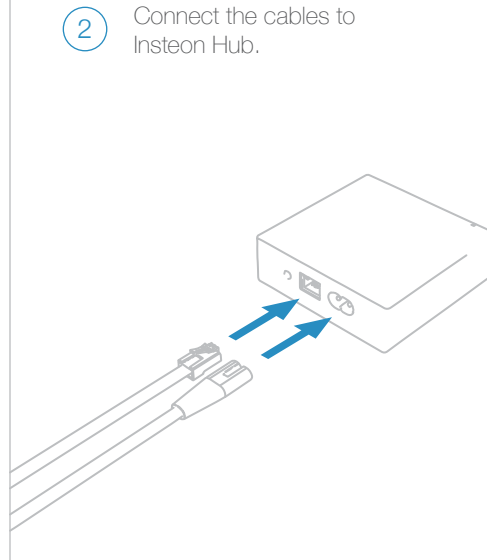
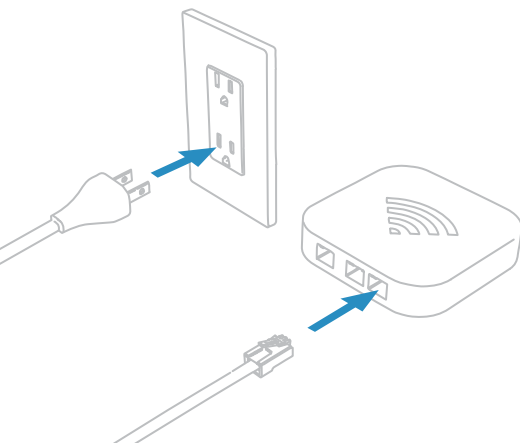

- 3 Download the **Insteon for Hub** app from your device's app store and create a new account.



- 4 Follow the on-screen instructions to scan the Setup Code and configure Insteon Hub.

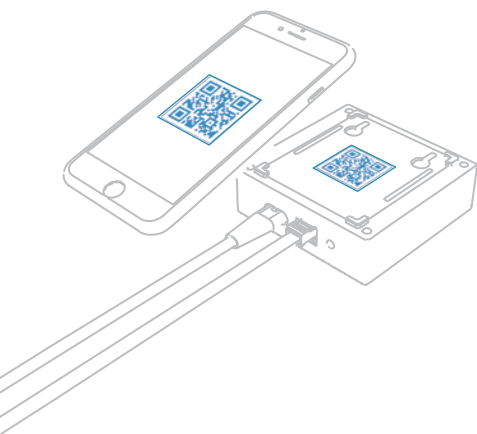

- 5 Turn on your lamp or appliance and connect its power cord to On/Off Module.

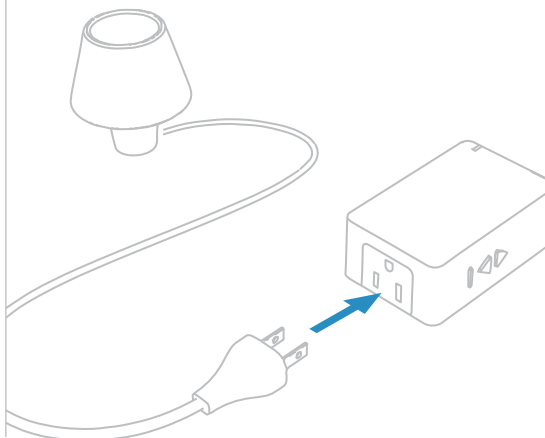

- 6 Plug On/Off Module into a power outlet.

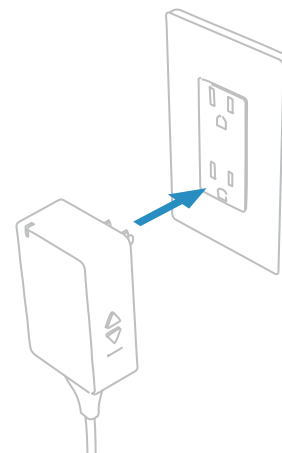

- 7 Return to the Insteon app, tap Plug-in Device and follow the on-screen instructions.



- 8 When prompted, press and hold On/Off Module's set button until you hear a double-beep.

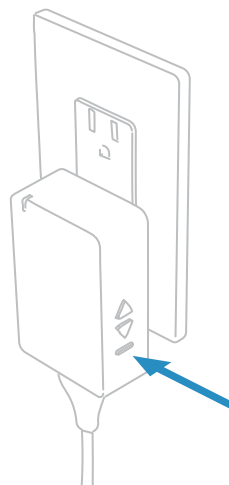

- 9 Repeat steps five through eight for the second On/Off Module.

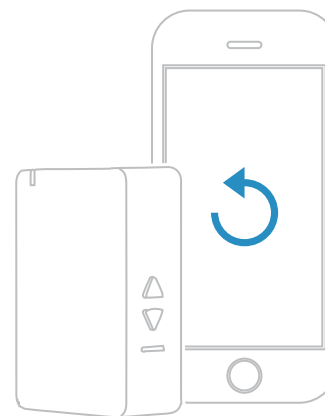

Go further and create schedules to turn your lights on and off at specific times.

[insteon.com/schedules](http://insteon.com/schedules)



Expand your Insteon system with sensors, wall switches, cameras and more.

[insteon.com/products](http://insteon.com/products)



866-243-8022

Have questions? We have answers.

[insteon.com/support](http://insteon.com/support)

For more documentation, visit:  
[insteon.com/get-started-2244-236](http://insteon.com/get-started-2244-236)