

Connecting the Radio Module Cable to the Control Unit

Step 1: Connect one end of the Radio Module cable to the Control Unit (CU). For wiring connections from the Control Unit to the module, refer to the Control Unit Installation Guide.

Step 2: Energize the luminaire and confirm that the green LED is on solid.

LED Description

Note: The purpose of wiring test is to serve as a sanity check regarding connectivity to the Radio Module. However, the overall responsibility of the quality of the device must meet the QC criteria for the light fixture manufacturer.

LED Status	Description/Solution
LED not ON	<ul style="list-style-type: none">In uncommission state: The Radio Module is not powered ON. Check power and wiring.In commission state: Radio Module is commissioned and running normally.
Solid Green	The uncommissioned Radio Module has powered up successfully and completed the wiring test with no unexpected conditions – waiting for discovery.
Blinking Red	The uncommissioned Radio Module has powered up and completed the wiring test with one or more conditions unexpected of a typical LED fixture – waiting for discovery.
Solid Red	Faulty Radio Module – replace the Radio Module.
Solid Blue	Radio Module received a request to identify itself.
Blinking Blue	The uncommissioned Radio Module powered up successfully, but the module is unable to detect an energy measurement device (CU or Driver), waiting for discovery.
Blinking Magenta	When the Radio Module is connected to the control unit that is currently in the process of an emergency test or an emergency test pending.



Copyright ©2024 Enlighted Inc. All rights reserved.
All other brand or product names are trademarks of their respective companies or organizations.

Company Contact Information

Location: 3979 Freedom Circle, #210,
Santa Clara, CA 95054
Phone: +1.650.964.1094
Web: enlightedincl.com
DoCs: <https://www.enlightedincl.com/eu-docs/>
Support Portal: support.enlightedincl.com

Model No. RM-6E
Product Code: RM-6E-8W
Power: 180mW
FCC ID: AQQ-SU6E
IC: 10138A-SU6E



This device complies with Part 15 of the FCC Rules and Innovation, Science and Economic Development Canada's license-exempt RSS standard(s). Operation is subject to the following two conditions: (1) This device may not cause harmful interference, and (2) This device must accept any interference received, including interference that may cause undesired operation of the device.

Changes or modifications not expressly approved by Enlighted could void the user's authority to operate the equipment.

Le présent appareil est conforme aux CNR d'Industrie Canada applicables aux appareils radio exempts de licence. L'exploitation est autorisée aux deux conditions suivantes: (1) l'appareil ne doit pas produire de brouillage, ET (2) l'utilisateur de l'appareil doit accepter tout brouillage radioélectrique subi, même si le brouillage est susceptible d'en compromettre le fonctionnement.

Pour éviter la possibilité de dépasser les limites d'exposition aux radiofréquences FCC et ISED, la proximité humaine avec le radiateur ne doit pas être inférieure à 20 cm pendant le fonctionnement normal.



Radio Module, 8-Pin (RM-6E-8W)
Install Guide



Radio Module and carrier

Shipped Components

- Enlighted Radio Module, 8-pin, (RM-6E-8W)

Supplemental Components

- Enlighted Radio Module Cable
- Enlighted Control Unit

Tools you may Need

- 7/8" Drill bit (1/2" knock out trade size)
- Hand drill

Caution

- A qualified electrician must perform installation and maintenance under local, state, and national electrical codes (NEC) and requirements.
- To avoid the possibility of exceeding the FCC and ISED radio frequency exposure limits, human proximity to the radiator shall not be less than 20cm during normal operation.

Fixture Mount Radio Module Installation

Step 1: De-energize the luminaire.

Note: For fixture mounting, use the fixture carrier and nut that is shipped with the module. The fixture mount can accommodate up to 0.25" thickness materials.

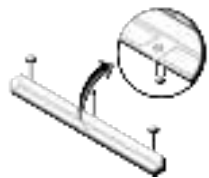
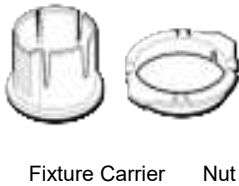

Step 2: Determine the location for the module in the fixture and cut a 1/2 inch (7/8" diameter) knockout in the fixture.

Step 3: Insert the fixture carrier through the hole in the fixture.

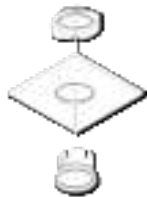

Step 4: From behind the fixture, align the tabs of the nut with the keys on the fixture carrier.

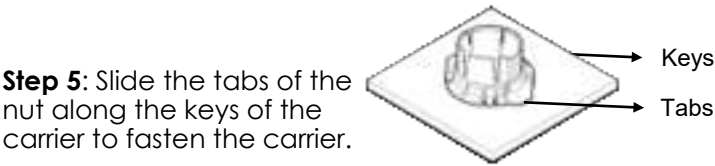

Step 5: Slide the tabs of the nut along the keys of the carrier to fasten the carrier.



Step 6: Insert the 8-pin end of the module cable through the carrier.

Step 7: Connect the 8-pin connector to the module.

Step 8: Guiding the wire from above, push the module into the carrier until it securely clicks into the carrier.

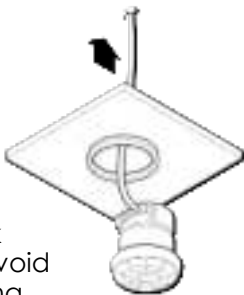

Step 9: Leave four inches of slack cable in the sequence loop to avoid pinching of the cable and to bring the module down if it needs to be replaced.

Note: Do not pull the cable forcefully as this might damage the cable or connector.

Step 10: See section Connecting the Radio Module Cable to the Control Unit on Page 5.

Tile Mount Radio Module Installation

Note: For tile mounting, the tile carrier and nut must be ordered separately. The tile mount can accommodate up to 1.5" thick tiles.

Step 1: De-energize the luminaire.



Step 2: Make a 7/8" diameter hole in the ceiling tile.



Step 3: Insert the tile carrier through the hole into the tile.

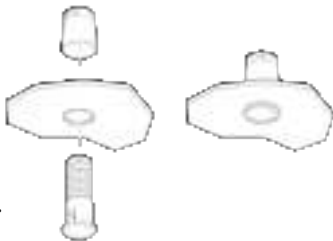

Step 4: Thread the plain end of the nut from behind the tile to secure the carrier.

If the tile is thicker than normal, flip the nut and thread the ribbed end of the nut to secure the carrier.

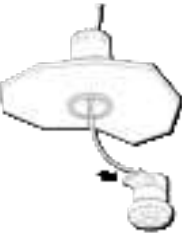

Step 6: Connect the 8-pin connector to the module.



Step 7: Guiding the wire from above, push the module into the carrier until it securely clicks into the carrier.

Step 8: Leave four inches of slack cable in the sequence loop to avoid pinching of the cable and to bring the module down if it needs to be replaced.

Note: Do not pull the cable forcefully as this might damage the cable or connector.

Step 9: See section Connecting the Radio Module Cable to the Control Unit on Page 5.