

Feature:

Product Name: Time Relay (8 pins/2 open and 2 closed)

Voltage: DC 12V, DC 24V, AC 220V (optional)

Time Range: 0.1s-99h

Time Error: 1%

Power Consumption: Max. 1.5VA

Environmental Temperature: -25~75°C

Permissible Voltage Range: 90-110% of rated voltage



High quality imported components

Comprehensive analysis

Selection of high-quality materials and a variety of components combined

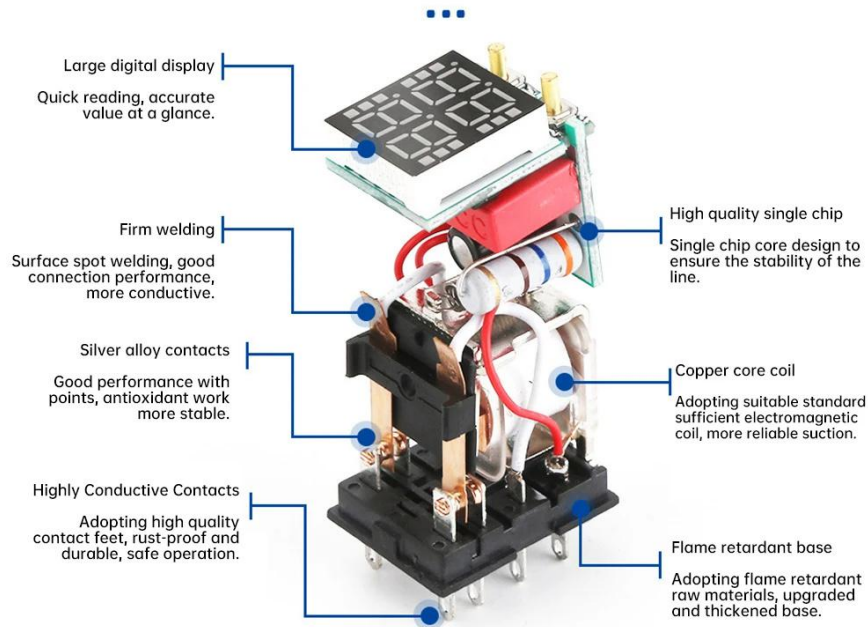

H3Y-2 N2 self-locking wiring diagram

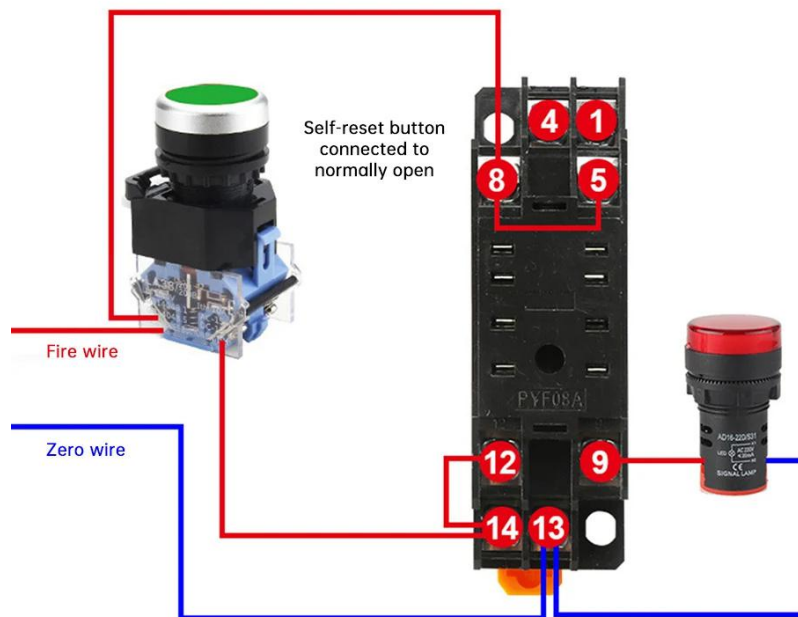

Wiring Diagram

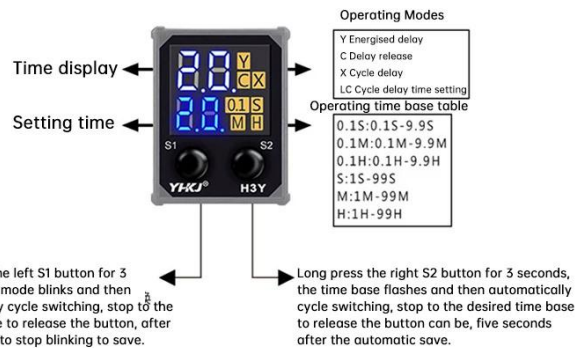
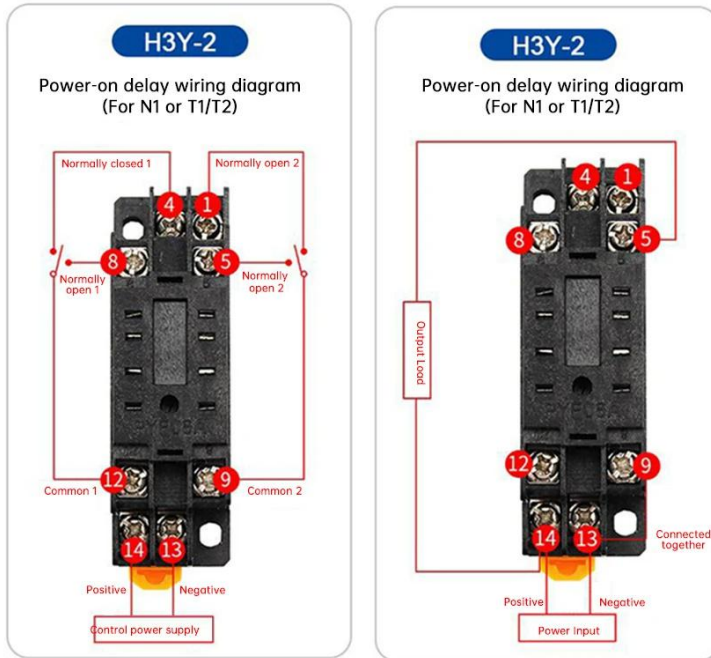

Mode Description

- Power Input
- Y Power-on delay
- C delay release (mode 1 is start timing time setting, 2 is release timing time)
- X cycle delay
- LC cycle delay number setting

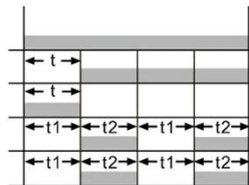

Mode setting: Long press the left S1 button for 3 seconds, the mode blinks and switches automatically in a cycle, stop to the desired mode to release the button, stop blinking after 5 seconds to save.

Time base setting: Long press the right S2 button for 3 seconds, the time base flashes and then automatically cycle switching, stop to the desired time base to release the button, five seconds after the automatic saving.

Digital setting: Left + ten digits right + single digit cycle plus digital.

LED High Definition Screen Dual-display panel for more intuitive



Operating Mode

- Y Power-on delay
- C delay release
- X cycle delay
- LC cycle delay time setting

Time base table

- 0.1S: 0.1S-9.9S
- 0.1M: 0.1M-9.9M
- 0.1H: 0.1H-9.9H
- S: 1S-99S
- M: 1M-99M
- H: 1H-99H

Long press the left S1 button for 3 seconds, the mode blinks and then automatically cycle switching, stop to the desired mode to release the button can be, after 5 seconds to stop blinking to save.

Long press the right S2 button for 3 seconds, the time base flashes and then automatically cycle switching, stop to the desired time base to release the button can be, 5 seconds after the automatic save.

Older models



Double display model

Delay range: 0.1S-99H

- Power on delay
- Delay release
- Cyclic delay
- Single cycle delay

New style



Double display model

Delay range: 0.1S-99H

- Power on delay
- Delay release
- Cyclic delay
- Cyclic delay time setting (Maximum 99 times)
- Key better press debugging mode more intuitive



Double display model

Delay range: 0.1S-99H

- Power on delay
- Delay release
- Cycle delay
- Cyclic delay times setting
(Maximum 99 times)
- Key better press debugging mode more intuitive

