



Swan Retro

designed for life



5 Speed Blender

Model: SP20180 (all colours)
Help line: **0333 220 6050**

v1.2





IMPORTANT INFORMATION - RETAIN FOR FUTURE USE

When using this electrical appliance, basic safety precautions should always be followed, including the following:

- Read all instructions.
- Before using check that the voltage indicated on the product corresponds with the voltage of your electrical outlet.
- Do not let cord hang on hot surface or over edge of table or counter.
- Do not operate any appliance with a damaged cord or plug or after the appliance malfunction or has been damaged in any manner. Return the appliance to the nearest authorized service facility for examination, repair or adjustment.
- If the supply cord is damaged, it must be replaced by the manufacturer or its service agent or a similarly qualified person in order to avoid a hazard.
- Close supervision is necessary when any appliance is used near children.
- Avoid contacting the moving parts.
- Keep hands and utensils out of container while blending to reduce the risk of severe injury to persons or damage to the blender. A scraper may be used but must be used only when the blender is not running.
- The use of attachments not recommended or sold by manufacturer may cause fire, electric shock or injury.
- Always disconnect the appliance from the supply if it is left unattended and before assembling, disassembling or





IMPORTANT INFORMATION - RETAIN FOR FUTURE USE

cleaning.

- This appliance shall not be used by children. Keep the appliance and its cord out of reach of children
- Appliances can be used by persons with reduced physical, sensory or mental capabilities or lack of experience and knowledge if they have been given supervision or instruction concerning use of the appliance in a safe way and if they understand the hazards involved.
- Children should be supervised to ensure that they do not play with the appliance.
- Do not leave the machine on and unattended.
- When removing the blender from the motor unit, wait until the blades have completely stopped.
- Always operate blender with cover in place.
- Always use the appliance on a secure, dry level surface.
- Never place this appliance on or near a hot gas or an electric burner or where it could touch a heated appliance.
- Do not use outdoors.
- Do not use appliance for other than its intended use.
- Switch off the appliance and disconnect from supply before changing accessories or approaching parts that move in use.

WARNING

DO NOT PROCESS HOT LIQUIDS IN THIS BLENDER



TECHNICAL DATA

Description: Retro 5 Speed Blender

Model: SP20180 (all colours). Input Voltage: 220-240V

Frequency: 50/60Hz. Power consumption: 600 Watts



Swan 3





PARTS & ASSEMBLY

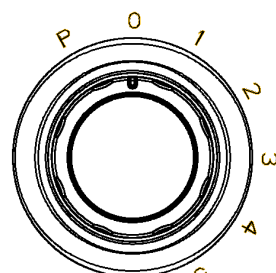
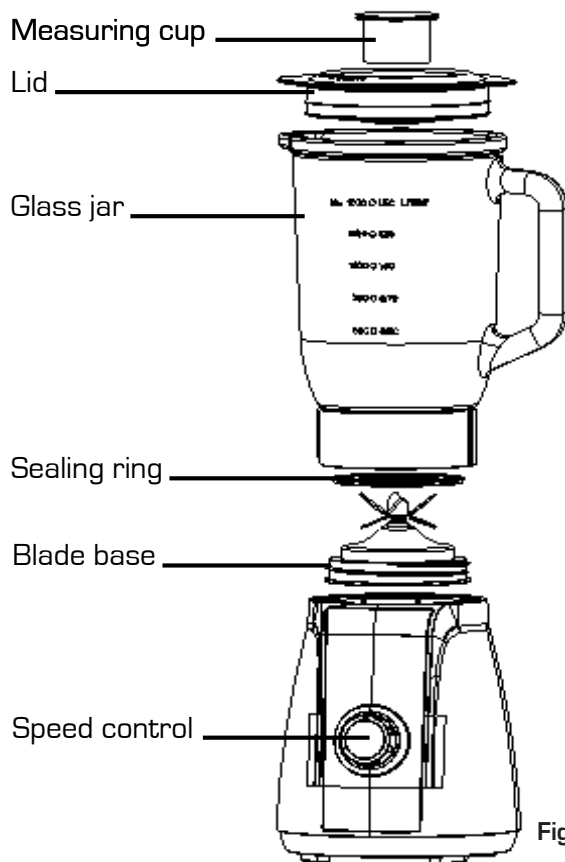

Speed control

Fig. 2

Fig. 1

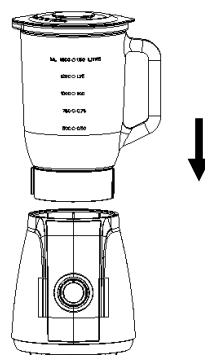
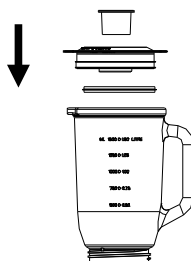
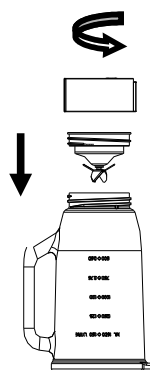



HOW TO USE

- Before first use, unpack the appliance and place all parts on a horizontal surface.
- Remove the jar assembly from the motor base & wash it in warm soapy water. Use a nylon brush to clean the inside of the jar. Rinse and dry thoroughly then return the jar to the motor unit.
- **TAKE GREAT CARE NEAR THE BLADES. THEY ARE VERY SHARP**
- It is a lot easier to clean if the jar is disassembled first. It is also a great way to get to know your blender better!
- Invert the jar unit onto a level surface, holding the jar handle, put the the seal ring and blade assembly onto the jar base bottom and secure the blade assembly by turning it anti-clockwise until tight [See Fig.3]
- Reposition the jar assembly with its opening upwards. Wrap the other seal ring around the lid bottom and put the lid onto the jar assembly. Place the measure cup exactly into the lid by ligning the small projection on the both sides of the cup into the slots of the lid and turning the cup clockwise until tight. [See Fig.4]
- Finally, place the assembled jar onto the motor unit by aligning the strip on the assembled jar bottom. [See Fig.5]

CAUTION: Jar and jar base is now secure. Do not try to twist the jar and jar base onto motor unit. This is not necessary.





HOW TO USE

- Peel and core any fruit or vegetables and then roughly cut into small pieces around 2cm in size
- Place the food to be blended into the jar. Usually, a small amount of water has to be added to facilitate the smooth running of appliance. If the mixture gets stuck, it is a sure sign that a little more water is needed. The amount of mixture should not exceed the max level as indicated on the jar.
- **Note: never use hot liquids or run the appliance empty.**
- Put the lid on the jar. Be sure the measuring cup insert in the lid is in place.
- Plug the power cord into a standard wall outlet.
- Turn the speed knob to the appropriate speed setting for your task.
- For quick or delicate blending tasks, turn the speed knob to P (Pulse) position and hold for a few seconds and then release, the knob will reset to O position automatically. Operate several times until the required consistency is achieved
- If you want to add ingredients while the blender is working, remove the measuring cup and place through the lid opening.
- When crushing ice or hard food, keep one hand firmly on the lid.
- When blending is complete, turn the knob to O position.
- **NOTE:** Do not operate the blender motor for more than **3 minutes** in any one session. If it hasn't blended in 3 minutes, it never will! After a long blending session, allow at least 10 minutes resting time to allow the motor to cool before using again.
- If you want to stop the machine during operation, turn the knob to O position anytime.

BLENDING TIPS

- For best results, put a little liquid into the jar before adding the solids.
- Some of the tasks that cannot be performed efficiently with a





HOW TO USE

blender are: beating egg whites, whipping cream, mashing potatoes, grinding meat, mixing dough, extracting juice from fruit and vegetables. Swan has lots of other machines that can do those things. Check the website.

- **The following items should never be placed in the unit as they may cause damage:** bones, large pieces of solid, frozen food, or tough foods such as turnips.
- To crush ice, add up to 6 ice cubes. If more ice is needed, remove the measuring cup insert and add cubes one by one through the lid opening.





CLEANING & MAINTENANCE

This motor unit contains no user serviceable parts. Refer service to qualified service personnel.

- Before cleaning, unplug the blender.
- Always wash immediately after use for easier cleaning. Don't let food dry on the jar assembly as this will make cleaning difficult.
- Quick clean: Pour a little warm soapy water into the jar and turn the knob to P position for a few seconds. And then empty the jar.
- Dismantle all detachable parts. Lift the jar assembly off the motor unit, To detach the blade assembly by turning it clockwise from the jar base bottom , and remove the seal ring 2 and blade assembly. In addition, detach the jar cover seal ring 1 from the jar cover

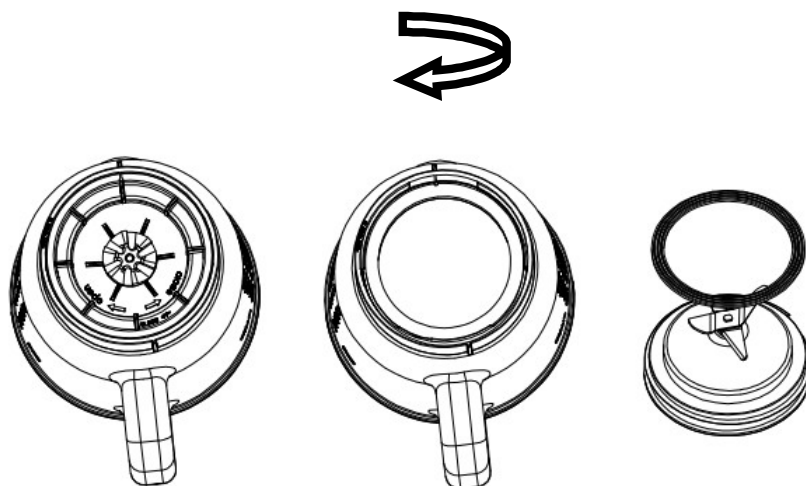



CLEANING & MAINTENANCE

- Rinse the measure cup, lid, seal rings, jar unit, and blade assembly by hand or in a dishwasher and then dry. They are dishwasher safe components, but the temperature setting should not exceed 65C
- Brush the blade clean using warm soapy water, then rinse thoroughly under the tap. Don't touch the sharp blades, handle carefully. Don't immerse the blade assembly in water. Leave to dry upside down away from children.
- Wipe the motor unit with a damp cloth and dry thoroughly. Remove the stubborn spots by rubbing with non-abrasive cleaner. If liquids spill into the motor unit; first unplug the unit, then wipe with a damp cloth and dry thoroughly.

CAUTION

- 1) Do not immerse the motor unit in liquid to prevent the risk of electric shock.
- 2) Do not use rough scouring pads or cleansers on parts or finish.



WARRANTY

This product is guaranteed for 2 years from the date of original purchase. If any defect arises due to faulty materials or workmanship the faulty products must be returned to the place of purchase. Refunds or replacement is at the discretion of the store.

The following conditions apply:

- The product must be returned to the retailer with proof of purchase.
- The product must be installed and used in accordance with the instructions contained in this instruction guide.
- It must be used only for domestic purposes.
- It does not cover wear and tear, damage, misuse or consumable parts.
- Swan Products Ltd has limited liability for incidental or consequential loss or damage.
- This guarantee is valid in the UK and Eire Only.



BS PLUG

The wires in the mains lead are coloured in accordance with the following code:

BLUE	NEUTRAL
BROWN	LIVE

As the colours of the wire in the mains lead of this appliance may not correspond with the colour markings identifying the terminals on your plug, proceed as follows:

The wire which is coloured BLUE must be connected to the terminal which is marked with the letter N or coloured black. The wire which is coloured BROWN must be connected to the terminal which is marked with the letter L or coloured red.

WARNING: THIS APPLIANCE IS DOUBLE INSULATED. DO NOT CONNECT ANY WIRE TO THE EARTH TERMINAL





DISPOSAL OF UNIT



Appliances bearing the symbol shown here may not be disposed of in domestic rubbish. You are required to dispose of old electrical and electronic appliances like this separately. Please visit www.recycle-more.co.uk or www.recyclenow.co.uk for access to information about the recycling of electrical items. Please visit www.weeeireland.ie for access to information about the recycling of electrical items purchased in Ireland. The WEEE directive, introduced in August 2006, states that all electrical items must be recycled, rather than taken to landfill. Please arrange to take this appliance to your local Civic Amenity site for recycling, once it has reached the end of its life.



NOTES





www.swan-brand.co.uk



Scan this QR code
to hear about
our story



We love
what we do



we're proud
of our quality



Find us on Facebook

* on selected products

Copyright © Swan Products Ltd.
PO Box 3117, Stoke-on-Trent ST4 9GD

