

nutribullet FLIP™



User guide.

 **WARNING!** To reduce the risk of serious injury, read the User Guide before operating your nutribullet Flip™. Save these instructions. Be sure anyone who uses the nutribullet® knows how to do so safely.

Important safeguards.

When operating your nutribullet Flip™, remember: SAFETY COMES FIRST.

WARNING! To avoid the risk of serious injury, death, property damage, or damage to your device, carefully read all instructions before operating your nutribullet Flip™.

When using any electrical appliance, basic safety precautions should always be observed, including the following important information. READ CAREFULLY AND THOROUGHLY BEFORE OPERATING.

If you let anyone else use your nutribullet Flip™, make sure that they understand the health and safety information in this User Guide, as well as any additional safety or usage instructions provided. Each person using a device should read the User Guide completely, and become familiar with the safe operation of the unit.

! Save these instructions! ● FOR HOUSEHOLD USE ONLY

READ ALL INSTRUCTIONS CAREFULLY AND THOROUGHLY BEFORE OPERATING.

HEAT AND PRESSURE SAFETY:

⚠ WARNING! DO NOT BLEND HOT, WARM, CARBONATED, OR EFFERVESCENT INGREDIENTS.

Such use may pressurize the Cup during blending, potentially causing the Lid to open forcefully, or the Cup and Hybrid Base to separate from the Cup. This could

expel hot ingredients and cause exposure to the blade, potentially resulting in bodily injury and/or property damage.

Only blend room-temperature or refrigerated ingredients (70°F/21°C or cooler).

Carbonated and effervescent ingredients (e.g., soda, baking powder, baking soda, yeast, some batters, cake

mix, dry ice, or other things that become bubbly) release gasses that increase pressure within the Cup when blending. Some protein powders also include effervescent ingredients. Always check your ingredients before blending.

⚠ WARNING! DO NOT BLEND CONTENTS FOR MORE THAN ONE MINUTE. DO NOT RUN CONSECUTIVE BLENDING CYCLES THAT EXCEED ONE MINUTE TOTAL.

The friction created by the blending process builds heat inside the Cup. Blending continuously for more than one minute increases this risk of pressurization. Consecutive blending cycles that exceed one minute total may over-pressurize the Cup, causing the Lid to open

forcefully, or the Cup and Hybrid Base to separate from the Cup. This could expel hot ingredients and cause exposure to the blade, potentially resulting in bodily injury and/or property damage.

⚠ WARNING! DO NOT LEAVE BLENDED FOODS IN A SEALED CUP FOR PROLONGED PERIODS OF TIME.

If left inside a sealed Cup, a blended mixture may spoil and ferment. During fermentation, the mixture may release gases that build pressure inside the Cup. Over-pressurization may cause the Lid to open forcefully, or the Cup and Hybrid Base to separate from the Cup. This could cause exposure to the blade, potentially resulting in serious bodily injury, property damage, or damage to your

unit. Do not leave blended ingredients in the sealed Cup for a prolonged period of time. To release pressure in the Cup, open the Lid to the drinking spout pointing away from your face and body. Always exercise caution, being mindful of escaping steam, gases, or foodstuffs that may splatter or spray out.

CUP CAUTION:

- Always use caution when opening the Lid. Open the Lid slowly with the opening pointed away from your face and body, being mindful of any splattering that may occur.

CUP SAFETY:

Proper Cup use is important for the safe operation your nutribullet Flip™. Using the Cup inconsistent with these instructions may result

in bodily injury, property damage, or damage to your unit.

- **ALWAYS** ensure the Cup is securely tightened and locked onto the Hybrid Base before blending. The motor will not turn on unless the Cup is situated in the locked position.
- **ONLY** operate the unit with the Lid cover snapped in place.
- Never operate your nutribullet Flip™ while the Cup is empty.
- **DO NOT** exceed the MAX line. Exceeding the MAX line can jam the blade or cause leakage.
- **NEVER** remove the Cup or open the Lid while the unit is in operation.
- **DO NOT** overfill the Cup with ice, as this may impede blade rotation, which can result in damage to the unit or injury. Always be sure to add a sufficient amount of liquid to the Cup

before blending.

- Only use genuine nutribullet® parts. Order replacement parts from **nutribullet.co.uk** or by contacting Customer Service.

BLADE SAFETY:

 **WARNING! BLADES ARE SHARP! HANDLE WITH CARE TO AVOID BODILY INJURY.**

- Do not touch the sharp edges of the blades.
- Do not place hands or fingers near the blades when attaching the Cup to the Hybrid Base.
- Handle with care when washing the blade by hand.
- Always ensure the power is off and the charger is unplugged when assembling, disassembling, or cleaning the blade or Hybrid Base.
- Do not store the Hybrid Base with the blades exposed. Always cover the blade with either

the Cup or Blade Cover.

- Do not open the Lid or remove the Hybrid Base from the Cup until the blades have come to a complete stop. Blades can still activate when the Hybrid Base is opened.
- **DO NOT** insert finger or any object in the sip/ straw hole while the motor is activated and the blades are spinning. Failure to follow these precautions may result in bodily injury, property damage, or damage to your unit.

BLADE CARE CAUTION:

 **WARNING! DISCONTINUE USE IF THE BLADE IS BENT OR DAMAGED.**

- Routinely inspect the blades for damage, and if detected, contact Customer Service for blade removal and replacement.
- Remove all utensils and non-food items from

Cup before operating to prevent bodily injury, or damage to the blade or Cup.

- Do not blend stone fruit in this appliance unless pits/seeds have been removed. Hard ingredients may damage the blade.
- The blades may stop turning if the Cup is overfilled or if there is an insufficient amount of liquid in the Cup. If this occurs, please refer to the Errors section in this User Guide.

SURROUNDING SAFETY:

⚠ WARNING! DO NOT USE YOUR NUTRIBULLET FLIP™ WHILE DRIVING, OPERATING MACHINERY, CYCLING, WALKING, OR ENGAGING IN OTHER ACTIVITIES THAT REQUIRE YOUR UNDIVIDED ATTENTION.

- Do not expose your nutribullet Flip™ to extreme temperatures or leave in the freezer or refrigerator, as this can damage the batteries, seals, and other components.
- Do not place your nutribullet Flip™ on uneven or unstable surfaces.
- Do not dry your device with a hair dryer, clothes dryer, conventional oven, or microwave oven. If your device becomes wet, gently wipe the exterior with a clean, dry cloth.
- Do not use your device near water or in wet, rainy, or snowy conditions.
- Do not use your device near an open flame or other heat source; near areas of excessive dirt, dust, oil, or chemicals; or in direct sunlight.
- Do not leave your nutribullet Flip™ inside your vehicle, especially

in the summer or winter. Prolonged exposure to extreme temperatures can cause the batteries to leak, rupture, or explode.

GENERAL USE AND SAFETY:

⚠ WARNING! FAILURE TO FOLLOW ALL INSTRUCTIONS REGARDING YOUR NUTRIBULLET FLIP™ MAY RESULT IN PROPERTY DAMAGE, SERIOUS PERSONAL INJURY, OR DEATH.

- This appliance is not intended for use by persons (including children) with reduced physical, sensory, or mental capabilities; or lack of experience and knowledge, unless they are closely supervised and instructed concerning the use of the appliance by a person responsible for their safety. Close supervision is necessary

when any appliance is used by or near children. Children should be supervised to ensure they do not play with the appliance.

- Periodically inspect your nutribullet Flip™ components for damage or wear that may impair proper functioning or create a safety hazard.
- Be aware of possible hazards when charging, using, or storing your nutribullet Flip™.
- Do not use this blender for anything other than its intended use.
- Avoid contact with moving parts. Do not attempt to defeat any safety interlock mechanisms.
- Do not insert anything other than the appropriate charger into the USB-C port. Do not allow dust to accumulate inside the port.
- Do not crush, drop, or damage the Hybrid

Base. Do not operate if this component is damaged in any manner.

- Use only nutribullet® attachments/ accessories specifically designed for your nutribullet Flip™. Always use genuine nutribullet® replacement parts and accessories. Aftermarket parts are not made to nutribullet® specifications and may damage your unit or cause serious injury.
- The manufacturer does not recommend the use of attachments, including canning jars, with the nutribullet Flip™. Attempting to use attachments not included with the product's configuration may result in injury to persons.
- Do not attempt to clean the Hybrid Base by immersing it in water or other cleaning liquids. Follow the instructions in the Care

& Maintenance section on page 26.

- Only the Cup and plastic accessories of the nutribullet Flip™ are dishwasher-safe. If you choose to clean these in the dishwasher, only place them on the top rack of the dishwasher and do not run the heat or sanitizing cycle. **NEVER PLACE THE HYBRID BASE IN THE DISHWASHER.**

ELECTRIC SAFETY:

 **WARNING! MODIFICATION, IMPROPER USE, AND FAILURE TO FOLLOW INSTRUCTIONS CAN INCREASE THE RISK OF PROPERTY DAMAGE, SERIOUS PERSONAL INJURY, OR DEATH.**

- Only use the Charging Cable and Charging Block that came with your unit.
- Do not charge this appliance with any other charger or

attempt to use the Charging Block on any other product.

- **NEVER USE UNAPPROVED POWER SOURCES OR RAPID CHARGERS.**
- To avoid the risk of electrical shock, fire, or bodily injury, **DO NOT** charge or use in wet conditions, or immerse the Charging Cable, Charging Block, or Hybrid Base in water or other liquids.
- Do not operate the unit if there is damage to the Charging Cable or Charging Block, if there has been an appliance malfunction, or if the Hybrid Base has been dropped or damaged in any manner.
- Always **POWER OFF** and **UNPLUG** the nutribullet Flip™ when not in use, and **BEFORE** assembling, disassembling, changing accessories, or cleaning.

- Do not charge your device around flammable materials, on your bed or couch, or on top of any type of paper.
- Only charge your device with the Charging Cable and Charging Block provided. Using incompatible parts or aftermarket accessories may damage your nutribullet Flip™ or create safety hazards that may cause personal injury or property damage.

POWER SUPPLY SAFETY:

 **WARNING! USE ONLY THE CHARGING CABLE AND CHARGING BLOCK PROVIDED WITH YOUR NUTRIBULLET FLIP™. NEVER USE AN UNAPPROVED POWER SOURCE OR RAPID CHARGER ON THIS UNIT.**

WARNING! FAILURE TO TAKE THE FOLLOWING PRECAUTIONS CAN RESULT IN SERIOUS PERSONAL INJURY,

DEATH FROM ELECTRIC SHOCK OR FIRE, OR DAMAGE TO YOUR DEVICE.

WARNING! DO NOT USE THE CHARGING BLOCK WITH A VOLTAGE CONVERTER DEVICE, ADAPTER, OR EXTENSION CORD.

- Do not use nonstandard power sources, such as generators or inverters. Use only AC power provided by a standard wall outlet or automobile lighter port.
- Do not use a rapid charger or higher-wattage charger. Use only with a standard wall outlet or automobile lighter port. Never start your car with the unit plugged into the automobile lighter port, as this can potentially cause a power surge that will short out the unit.
- Do not overload your wall outlet. Confirm that it is rated to handle the

total current (in amps) drawn by your device (as indicated on your Power Supply Unit) and any other devices using the same circuit.

- Never use a damaged Charging Block, or one that has been dropped or received a sharp impact.
- Do not charge in an area of extreme heat or cold.
- Always unplug the Charging Block when not in use.

CABLE AND CORD SAFETY:

⚠ WARNING! USE ONLY THE CHARGING CABLE THAT CAME WITH YOUR NUTRIBULLET FLIP™ TO CHARGE.

- Inspect your Charging Block and cables regularly.
- Exposed device cables and cords pose a potential tripping hazard. Arrange all

cables and cords so that people and pets are not likely to trip over or accidentally pull on them as they move around or walk through the area.

- Do not wrap or wind the Charging Cable too tightly when storing. Do not bend or crease the Charging Cable when using.
- When positioning your device or Charging Block, ensure that the cables are not bent sharply and that the connectors are not pushed against a wall or hard surface.
- Do not allow pets or children to bite or chew on cables and cords.
- Always disconnect the Charging Block from the outlet by pulling on the plug portion of the block. Never pull on the Charging Cable to remove the Charging Block from the wall.
- Do not let the Charging Cable touch hot

surfaces or any extreme heat source, or become knotted, tangled, or frayed.

- Do not grab or carry your device by the Charging Cable.
- Do not use an extension cord or let the Charging Cable hang over the edge of a table or counter.

BATTERY SAFETY:

Your nutribullet Flip™ contains rechargeable lithium-ion batteries. The batteries are not replaceable and must be recycled or disposed of properly. Improper disposal may result in injury, death, or property damage due to battery fluid leakage, fire, overheating, or explosion. **DO NOT** open or attempt to repair or replace the batteries, doing so may result in electric shock, damage to the unit, fire, personal injury, or property damage.

- Do not recharge your nutribullet Flip™ near a fire or heat source, or in extremely hot conditions.
- Do not expose the Hybrid Base containing the battery pack to fire or excessive heat. Exposure to fire or temperatures above 265°F/130°C may damage the batteries or cause a fire or explosion.
- The recommended storage and ambient charging temperature range for this device is between 50°F–104°F (10°C–40°C).
- **NEVER** leave your nutribullet Flip™ inside your vehicle, especially in the summer or winter. Prolonged exposure to extreme temperatures can cause the batteries to leak, rupture, or explode.
- Do not store your unit in any area with exposure to excessive heat, such as a cabinet above the

oven or stove, near a radiator or heater, or in any area exposed to direct sunlight.

- Do not use your unit in any area with a potentially explosive atmosphere (e.g., fueling areas or fuel service stations, below decks on boats or other vessels, fuel and/or chemical transfer and storage facilities, and areas where flammable chemicals or particles, such as grain dust or metal powders have collected in the air). Static electricity discharge may ignite combustible or flammable materials resulting in a fire or explosion.
- Do not use your unit if the Hybrid Base is overheated, has an odor, leaks, is bulging, or demonstrates any changes in color/shape, as this may indicate a leak from the battery cell. Leaks from battery

cells can occur under extreme conditions. Battery fluid is corrosive and may be toxic. It can cause burns and may be harmful or fatal if swallowed. If any signs of leakage occur, immediately discontinue all use of the unit and contact Customer Service.

- Avoid contact with battery fluid. If a battery leaks, keep the leaked fluid from touching your skin, eyes, clothes, or other surfaces. If the battery fluid contacts your skin, eyes, or clothes, immediately rinse the affected area with water and contact your doctor or other medical providers as appropriate.
- Dispose of batteries properly. The batteries contain elements that may pose health risks to individuals if they are allowed to leach into the ground water

supply. Disposal of these batteries with standard household waste may be illegal in some countries. Contact your local recycling or hazardous waste disposal centers in your area for proper disposal instructions.

- Do not incinerate the Hybrid Base. The batteries can explode.

! Save these instructions!

Contents.



1	Important safeguards
15	What's included
15	Before first use
16	Assembly guide
17	LED indicators
19	Using your nutribullet Flip™
22	Using the To-Go Lid
24	Troubleshooting
26	Care & maintenance
28	Replacement parts

Thank you for purchasing the nutribullet Flip™.

What's included.

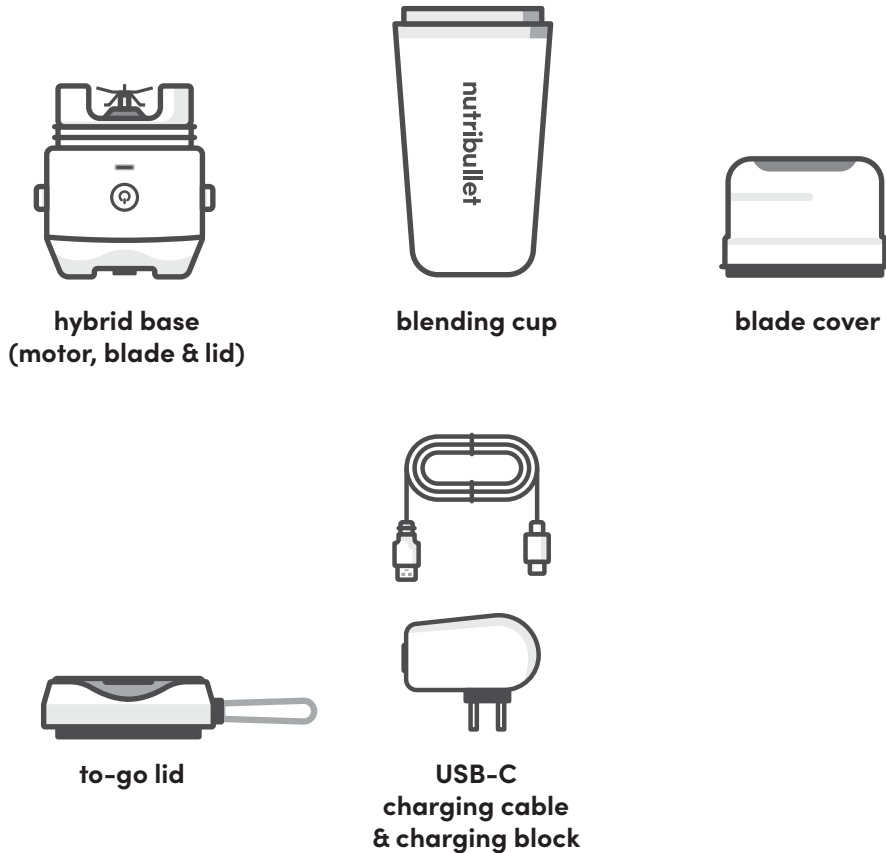

Before first use.

Remove all packaging materials, stickers, and the like, and clean your unit with care according to the instructions detailed in the Care & Maintenance section (pg. 26).

Charge the unit for at least 2 hours using the provided USB-C Charging Cable and Charging Block.

Assembly guide.

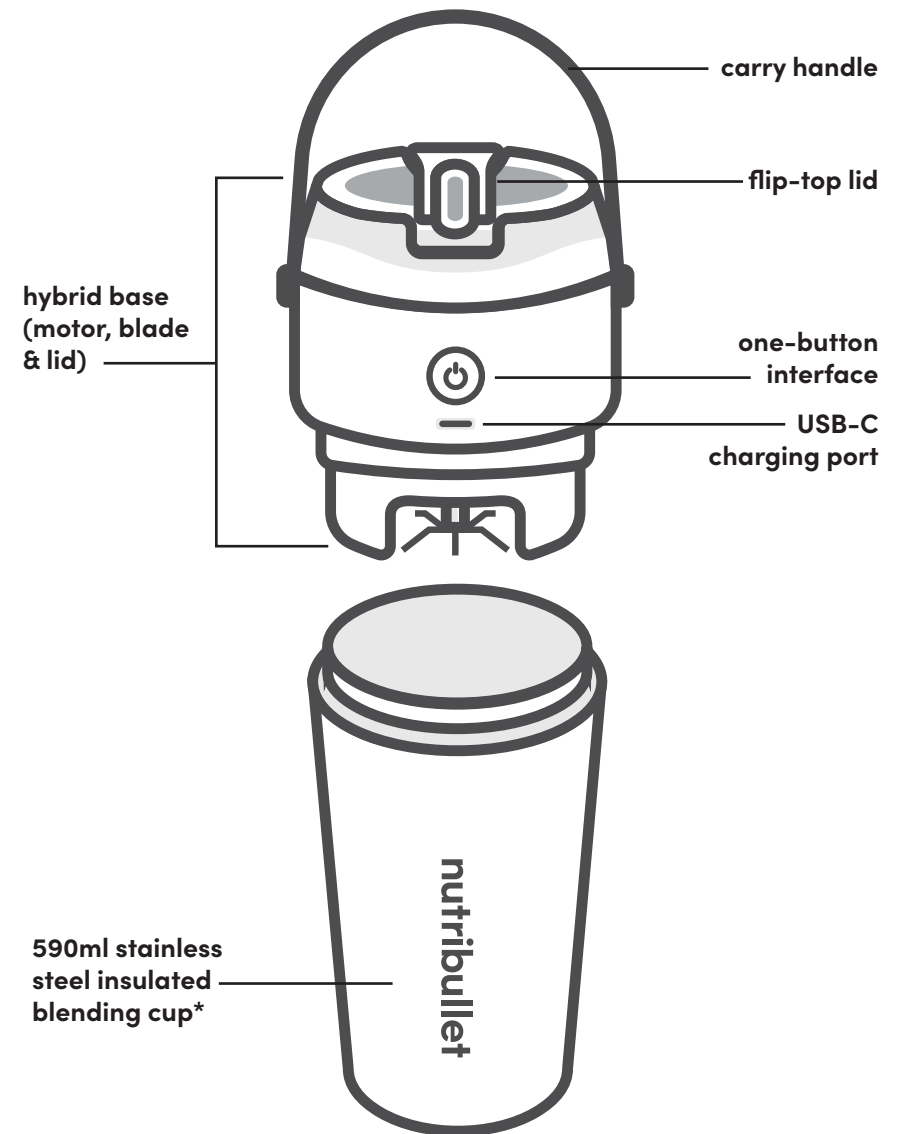

⚠️*WARNING! DO NOT exceed the MAX fill capacity. 590ml total Cup capacity. 470ml MAX fill line capacity.

LED indicators.

The nutribullet Flip™'s indicator has six LED light bars that appear white, yellow, red, or green according to the unit's operational status. The meaning of each display is detailed below.

Charging.



NO POWER:
All LEDs off.

LED light bars

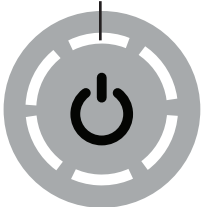

PLUGGED IN:
When plugged in to charge, the color of LED indicates charge status.

SOLID GREEN: full charge.

FLASHING GREEN: ready for normal use.

FLASHING YELLOW: low charge, can run several cycles.

FLASHING RED: needs charging, do not use to blend.

DURING USE:

FLASHING YELLOW: use error, refer to pg. 17 to diagnose issue

FLASHING RED: functional error. Immediately discontinue use of your blender. Refrain from pressing the Power Button for at least two minutes to allow the unit to shut down automatically, then refer to the troubleshooting guide on page 24 for details.

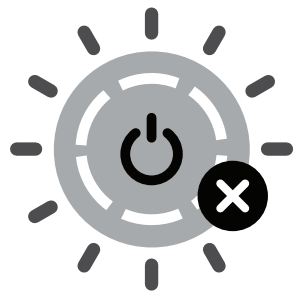

Settings.

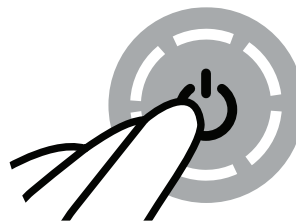

WAKE:

Press the **Power** button once to wake up your blender.

The LED ring will illuminate in a clockwise direction.

WHITE: ready for normal use.

YELLOW: low charge, can run several cycles.

RED: needs charging, do not use.

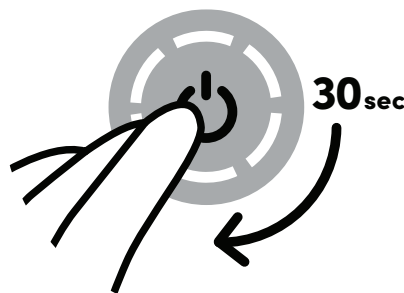

BLEND MODE:

Press the **Power** button to start a 30-second blend cycle.

White LEDs circulate clockwise during the blending cycle.



SLEEP MODE:

After 90 seconds of inactivity, your blender will automatically go into sleep mode. all lights will be off.

Using the nutribullet Flip.™



- 1 Place the **Blending Cup** on a clean, dry, and level surface.



- 2 Twist off the **Hybrid Base** and add ingredients.

NOTE: Make sure you don't overfill the **Cup**. Follow the minimum liquid and MAX fill marks on the **Cup**. When adding ice, it should not exceed 25% of the **Cup's** total volume. Always add a sufficient amount of liquid ingredients.

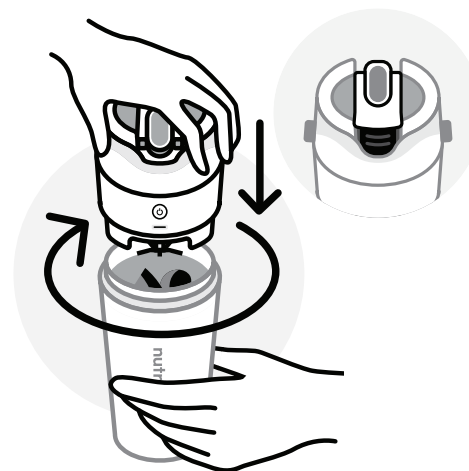

- 3 Twist the **Hybrid Base** back onto the **Blending Cup**. Make sure the **Flip-Top Lid** is snapped closed and sealed.



- 4 With the blender right side-up (**Hybrid Base** on top), press the **Power Button** once to wake up the blender. Wait about 1 second for the LED light ring to fully illuminate.

NOTE: The LED light ring will fully illuminate white if the **Hybrid Base** is properly installed. If the **Hybrid Base** is installed incorrectly, the LED light ring will flash yellow.



- 5 When ready, press the **Power Button** again to begin a 30-second blending cycle.

NOTE: To prevent blade blockage or stalling, start the blending cycle with the blender right-side-up (**Hybrid Base** on top).



- 6** Once blending begins, flip your blender upside-down (**Hybrid Base** on bottom) so the ingredients make contact with the blade. Place the blender on a clean, dry, and level surface until blending is complete.

NOTE: If you want to **Pulse** your ingredients or stop the blending cycle early, press the **Power Button** during the blending cycle.

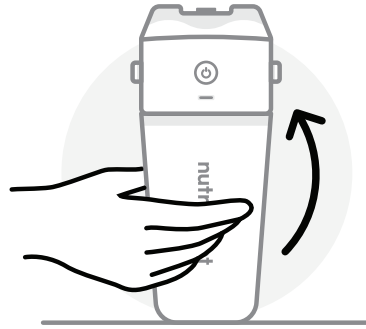

- 7** Once blending is complete, flip your blender so the **Hybrid Base** is right-side-up and open the **Flip-Top Lid** to enjoy your blend.



- 8** Use the **Carry Handle** to take your blend on the go.

⚠ WARNING! NEVER open the **Flip-Top Lid** or attempt to place anything into the sip hole while the motor is running to prevent injury or damage.

Using the to-go lid.

Your nutribullet Flip™ also comes with a twist-on **To-Go Lid** that you can swap with the **Hybrid Base**. The **To-Go Lid** offers two ways to enjoy your blend: through a sipping spout at the front of the **Lid**, or through the straw opening in the center of your **Lid**.

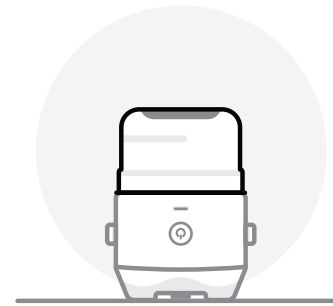

- 1** Remove, clean, and dry the **Hybrid Motor Base, Blade, and Lid**. Cover with the **Blade Cover** before storing.

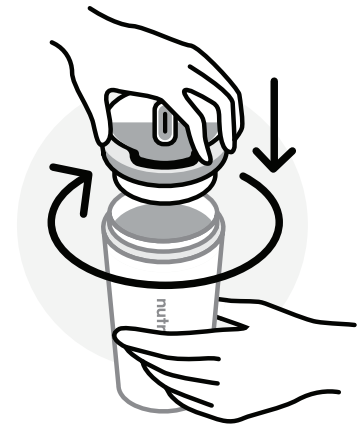

- 2** Twist on the **To-Go Lid**.



- 3** To open the sipping spout, unsnap the cover flap from the front of the **To-Go Lid**, then flip it all the way over, snapping it into place at the opposite side of the **To-Go Lid**.



- 4** The nutribullet® tab at the center of the **To-Go Lid** covers the straw opening. To reveal the opening, keep the sipping spout cover flap closed and slide the center tab towards the back of the **To-Go Lid**.

NOTE: The **To-Go Lid** is not leak-proof and will not prevent blends from seeping or spilling out of the **Cup**. Be sure to always keep your **Cup** upright when using the **To-Go Lid**.

Troubleshooting.

⚠ WARNING!

Before first use, review all warnings and caution statements in the important safeguards section (pages 1-12).

ALWAYS use caution when opening the Flip-Top Lid. **ALWAYS** power off unit before opening the Flip-Top Lid Cap slowly, being mindful that the spraying of contents may occur.

NEVER try to operate your nutribullet Flip™ while driving or while engaging in other situations that require your undivided attention.

NEVER use a rapid charger or a higher-wattage charger. Use only the AC power provided.

NEVER use the charger with any voltage converter device or adapter.

ONLY use the Charging Block and Charging Cable that came with your unit.

NEVER start your car with the unit plugged into the automobile lighter port, as this can potentially cause a power surge that will short out the unit.

DON'T leave your nutribullet Flip™ unattended when in use.

DON'T charge your nutribullet Flip™ if your USB-C charging port is wet, damaged, or dirty.

NEVER add hot or warm ingredients to your Blending Cup. Heated ingredients can cause pressure to build inside the Cup potentially causing the Flip-Top Lid to open forcefully, or the Cup and Hybrid Base to separate from the Cup. This could expel hot ingredients and cause exposure to the blade, potentially resulting in bodily injury and/or property damage.

DO NOT blend contents for more than one minute. Do not run consecutive blending cycles that exceeds one minute total. The friction created by the blending process builds heat inside the Cup. Consecutive blending cycles that exceed one minute total may over-pressurize the Cup, potentially causing the Flip-Top Lid to open forcefully, or the Cup and Hybrid Base to separate from the Cup. This could expel hot ingredients and cause exposure to the blade, potentially resulting in bodily injury and/or property damage.

Batteries are not replaceable. **NEVER** try to open, repair, or attempt to replace the batteries to your unit.

FLASHING LED COLOR: YELLOW

TROUBLESHOOTING:

Blending Cup may not be properly secured to the Hybrid Base.

SOLUTION:

Continue to tighten the Blending Cup to the Hybrid Base until the LED light ring turns white.

TROUBLESHOOTING:

Blades may be blocked.

SOLUTION:

Carefully dislodge any ingredients that are stuck in the blade.

Ensure you are using an adequate amount of liquid, the Cup is not overfilled, and ingredients all fall below the MAX fill line.

To prevent blade blockage or stalling, start the blending cycle with the Hybrid Base right-side-up. (Hybrid Base is on top).

TROUBLESHOOTING:

The Blending Cup has come loose or been removed from the Hybrid Base during the blending cycle.

SOLUTION:

Always ensure the Blending Cup is securely fastened to the Hybrid Base before blending. **NEVER** try to remove the Cup from the Hybrid Base before the cycle is complete.

FLASHING LED COLOR: RED

TROUBLESHOOTING:

Overheat and automatic lockout.

SOLUTION:

Immediately discontinue use and allow the blender to cool down. If the blender remains locked after 10 minutes of cooling off, contact Customer Service.

Care & maintenance.

When cleaning the nutribullet Flip™, always power off the unit, making sure the blades are completely stopped before assembling or disassembling.

! WARNING! NEVER submerge or rinse the entire Hybrid Base in water or any other liquid, and be sure to keep water and other liquids away from the USB-C port.

Cleaning.

AUTOMATIC CLEANING:

You may use a blending cycle to quickly clean your blender.



- 1 Rinse out the **Blending Cup** with fresh water. Add a drop of dish soap to the **Blending Cup** and fill halfway with water.

NOTE: For stubborn residue, allow the soap and water to sit for a few minutes on each end of the **Blending Cup** before running the cleaning cycle.



- 2 Start a blending cycle, and flip and shake the blender to agitate the water during the cycle.

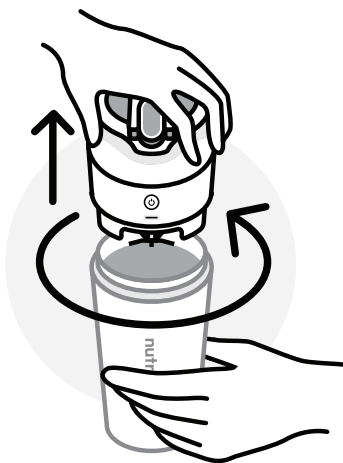

- 3** After the cycle ends, open the **Flip-Top Lid** that covers the sip hole and empty the contents. Repeat the cycle once more, using only fresh water for the final rinse. Do not add soap.

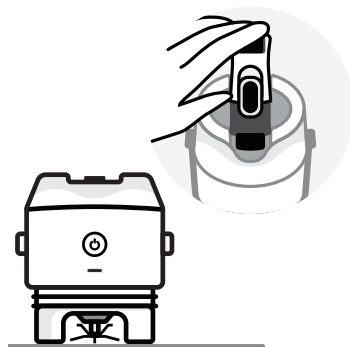

- 4** Dry the **Hybrid Base** upright with the **Flip-Top Lid** open.

NOTE: Make sure and pat the USB-C port dry before you begin charging.

CLEANING BY HAND:

HYBRID BASE:

When hand-cleaning, always be mindful not to rinse/submerge the entire **Hybrid Base** in water, and take care to prevent water from entering the USB-C port.

- **Blade:** point downward at an angle and carefully clean and rinse only the blade area of the **Hybrid Base**, keeping your thumb or finger over the USB-C port.
- **Drinking Spout:** with the blade facing up, carefully rinse out the sip hole under a gentle flow of warm water, keeping your thumb or finger over the USB-C port.

To dry, gently wipe and dry the **Hybrid Base** and the USB-C port with a clean cloth. Rest the **Hybrid Base** upright with the **Flip-Top Lid** open. Make sure the USB-C port is completely dry before charging.

! WARNING! DO NOT submerge or rinse the entire **Hybrid Base** in water or any other liquid.

BLENDING CUP:

Wash with soap and water.

DISHWASHER:

The **Blending Cup** and **To-Go Lid** are the only components of the nutribullet Flip™ that are dishwasher-safe, in the top rack only. To clean the blade and sip hole, follow the Hand Cleaning instructions above.

! WARNING! DO NOT place your **Hybrid Base** in the dishwasher.

Storage.

Always keep your nutribullet Flip™ in a dry, temperature-controlled location. Always store the **Hybrid Base** with the **Cup** or **Blade Cover** attached, so the blades are covered and not exposed. Do not stack any objects on top of the unit while storing.

For replacement parts.

Visit nutribullet.co.uk

EN/ Explanation of the markings



EN/ This marking indicates that this product should not be disposed with other household wastes throughout the EU. To prevent possible harm to the environment or human health from uncontrolled waste disposal; recycle it responsibly to promote the sustainable reuse of material resources. To return your used device, please use the return and collection systems or contact the retailer where the product was purchased. They can take this product for environmental safe recycling.



EN/ This product complies with the European regulation no. 1935/2004 on materials and articles intended to come into contact with food.



EN/ The transport and protective packing has been selected from materials, which are environmentally friendly for disposal and can be recycled. Ensure that any plastic, wrappings, bags etc. are disposed of safely and kept out of the reach of babies and young children. Rather than just throwing these materials away, recycle them



EN/ Manufacturer's declaration that product meets the requirements of the applicable UK regulations.



EN/ Manufacturer's declaration that product meets the requirements of the applicable EC directives.



Detachable supply unit.

**high
street tv**
Need help?
We're here
for you

Visit
nutribullet.co.uk for:

 FAQ'S

 Video Guides

 Register your product

Join our community



Capital Brands Distribution, LLC | All rights reserved.

nutribullet® and the nutribullet® logo are trademarks of CapBran Holdings, LLC registered in the U.S.A. and worldwide.

Illustrations may differ from the actual product. We are constantly striving to improve our products, therefore the specifications contained herein are subject to change without notice.

NBPB09350_240805