

Safety Instructions

Read and follow all the safety instructions:

- Rated as IP20 non-waterproof, this product can't be used outdoors or humid environment.
- Use the product with the provided power adapter only.
- Keep the product away from sharp objects or strong corrosive chemicals.
- Do not install the COB LED light strip near any heat sources.
- Do not allow children to install the COB LED strip light alone
- Do not extend the length of the light strip.

What's in Box?

COB LED Strip:	1
Power Adapter:	1
Controller:	1
RF Remote:	1
Quick Start Guide:	1

Specifications

Length:	16.4ft	32.8ft
Light Color:	3000K/4000K/6500K	3000K/4000K/6500K
Width:	8mm	8mm
Power Supply:	24V/1.5A, 36W	24V/2A, 48W

How to Install?

1.Perparation.

- Check all the items listed on in the packing list.
- Test the light strip before installation, confirm the controller button and remote work perfectly.

2.Wipe the surface, make sure it's CLEAN and DRY, the adhesive can not stick to fabric, dust wall, rough plastic, frosted glass.



02

3.Peel off the protective film of the adhesive tape, stick the COB led strip and PRESS over it firmly.

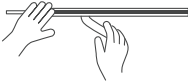

4.Turn on the light strip and start to use.

Control Box

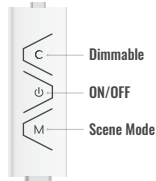

Remote

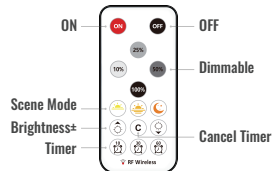

03

Pair remote to the controller: If I've so many sets of this light strip, how could I make each remote work separately.

a: One set doing the pair work, other sets should be unplug the power supply (For example, if you've 3 sets or more of this kit, unplug the power supply of the second set or third set before the first set do the pair work).

b: Hold "10%" and "50%" button at the same time for 3s, and then release the button, the light strip will flashing, pair work successful, and then pair the second set and third set.

Unpair the remote?

a: Hold the "OFF" button until the light strip flashing.

Replace Battery

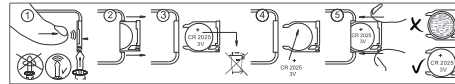

Cutting.

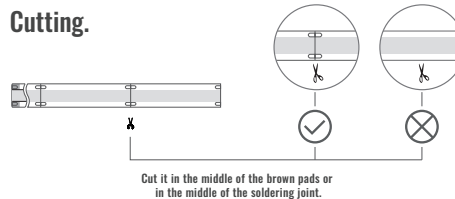

04

Trouble Shooting

Q: Why does the COB led strip not light up after connection?

A: Confirm the connection is firmly.

Q: Why does the COB led strip auto turn on/off or auto flashing?

A: Interference from other signals caused this problem, hold "10%" and "50%" button at the same time for 3s, and then release the button, the light strip will flashing, problem solved.

Q: Why does the adhesive tape not sticky in winter?

A: At low temperatures, the adhesive tape will become not strong enough, spread the light strip, and light up for 30 minutes before installation.

How to contact us?

Support email: Olaholii@hotmail.com
Click "Olaholii" on your order page.

Warranty

1 Year Warranty (not included the battery).

Any changes or modifications not expressly approved by the party responsible for compliance could void the user's authority to operate the equipment.

The device has evaluated to meet general RF exposure requirement. The device can be used be in portable exposure without restriction.

05

Instrucciones De Seguridad

Lea y siga todas las instrucciones de seguridad:

- Este producto está clasificado como IP20 no resistente al agua y no se puede utilizar en exteriores ni en entornos húmedos.
- Utilice el producto únicamente con el adaptador de corriente proporcionado.
- Mantenga el producto alejado de objetos afilados o productos químicos corrosivos fuertes.
- No instale la tira de luz LED COB cerca de ninguna fuente de calor.
- No permita que los niños instalen la tira de luz LED COB solos.
- No alargue la longitud de la tira de luz.

FCC Statement

Note: This equipment has been tested and found to comply with the limits for a Class B digital device, pursuant to part 15 of the FCC Rules. These limits are designed to provide reasonable protection against harmful interference in a residential installation. This equipment generates, uses and can radiate radio frequency energy and, if not installed and used in accordance with the instructions, may cause harmful interference to radio communications. However, there is no guarantee that interference will not occur in a particular installation. If this equipment does cause harmful interference to radio or television reception, which can be determined by turning the equipment off and on, the user is encouraged to try to correct the interference by one or more of the following measures:

- Reorient or relocate the receiving antenna.
- Increase the separation between the equipment and receiver.
- Connect the equipment into an outlet on a circuit different from that to which the receiver is connected.
- Consult the dealer or an experienced radio/TV technician for help.

This device complies with part 15 of the FCC Rules. Operation is subject to the following two conditions:(1) This device may not cause harmful interference, and (2) this device must accept any interference received, including interference that may cause undesired operation.

06