

# seca mBCA Alpha (545) seca TRU Alpha (452)

## LAN-Configuration

Configure your  
LAN connection  
in just a few  
steps



# LAN-Configuration

1. Please make sure that port 22020 is enabled for inbound and outbound connections within your firewall.
2. Please make sure that the unit is powered by the original power supply provided.
3. Connect the device to the network via LAN cable.
4. A LAN symbol appears at the top right in the display as soon as the device has connected to the network.

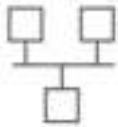

5. To connect the device to the seca analytics 125, enter the server address as shown below.
6. Enter the server address **gpx.secacloud.com** (**gpx.us.secscloud.com** for the US) and press the confirm button at the bottom right

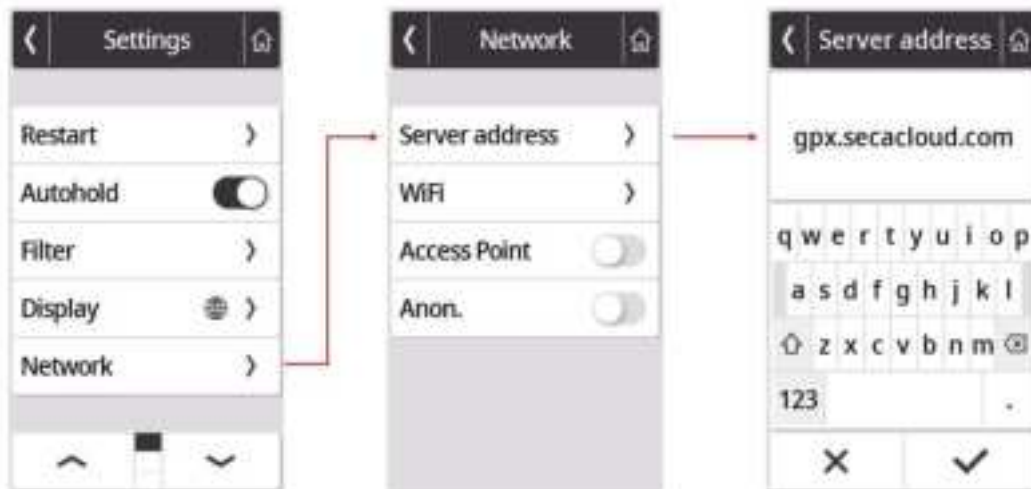

7. This step completes the network settings on the device.