

BTP-A1T2/A1T2S

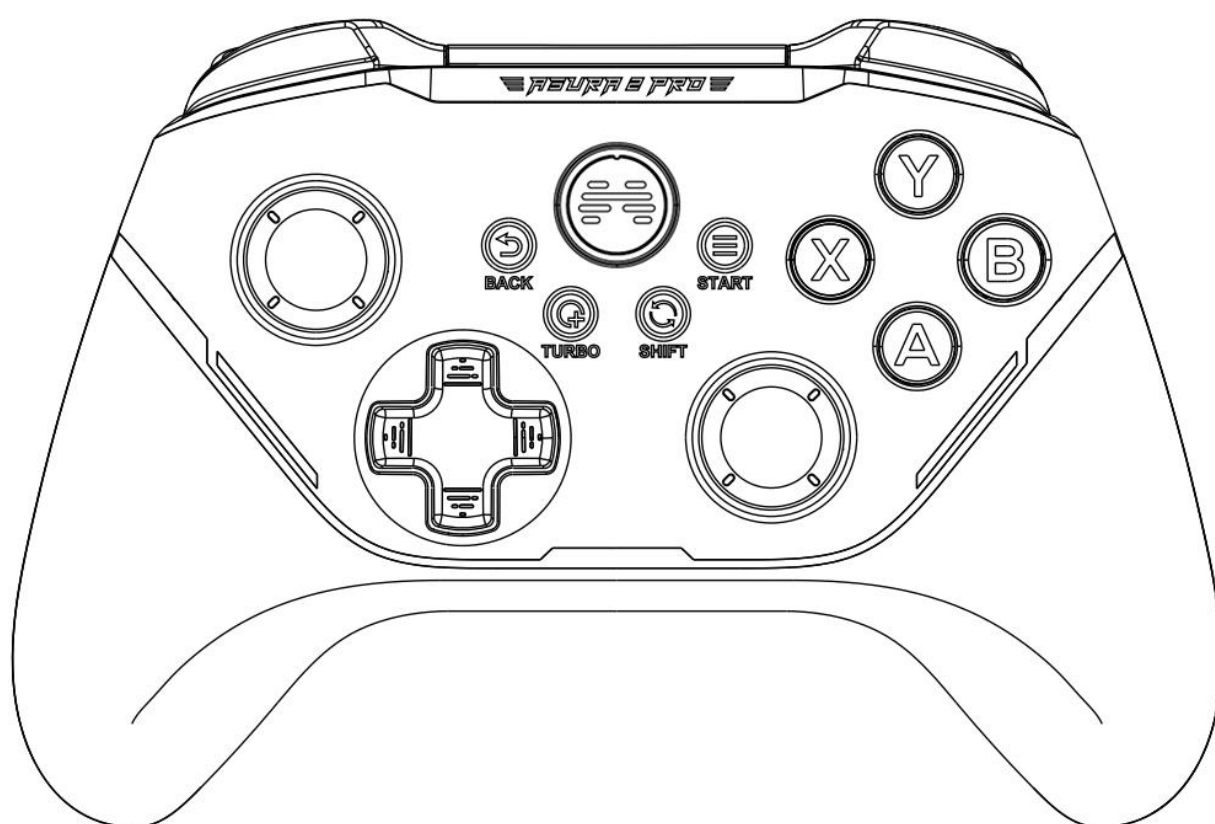

Button Introduction

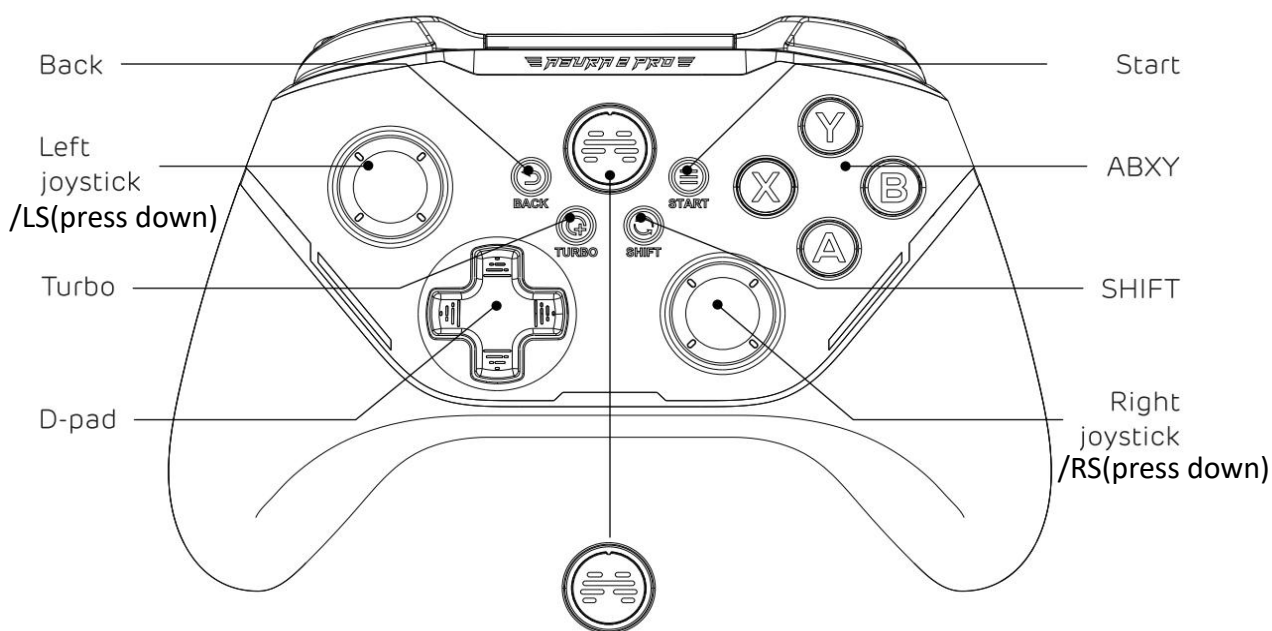

BEITONG
(HOME Button)

Front View

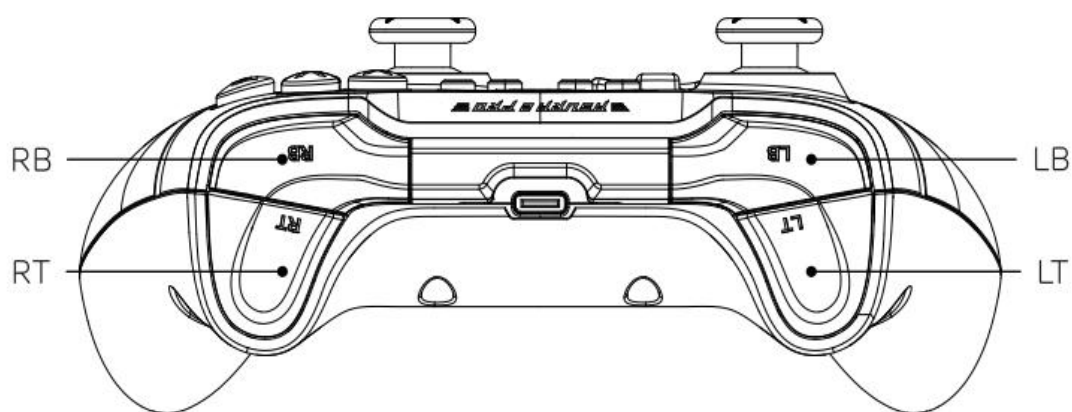

Vertical View

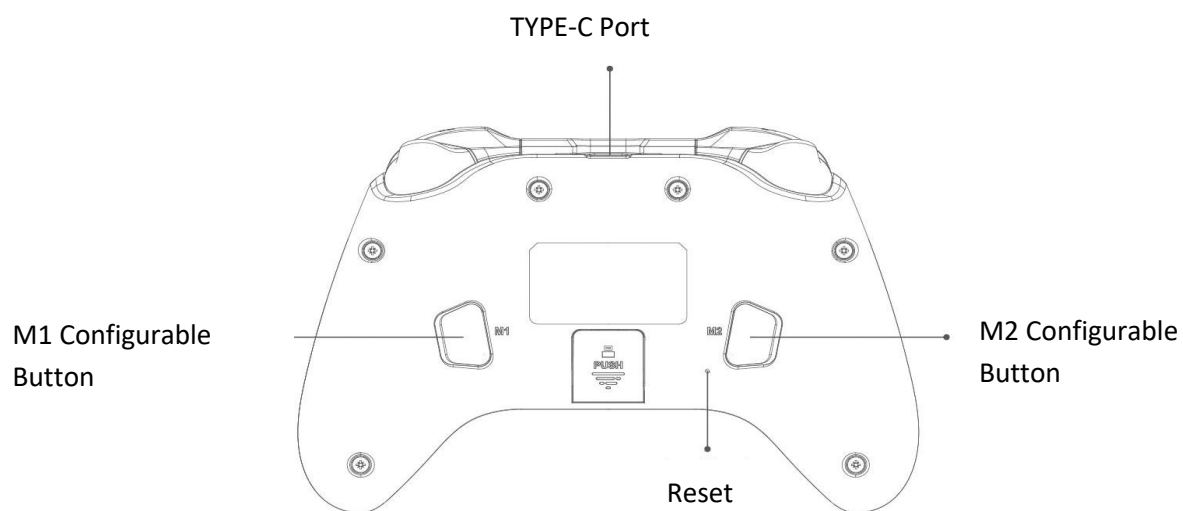

Back View

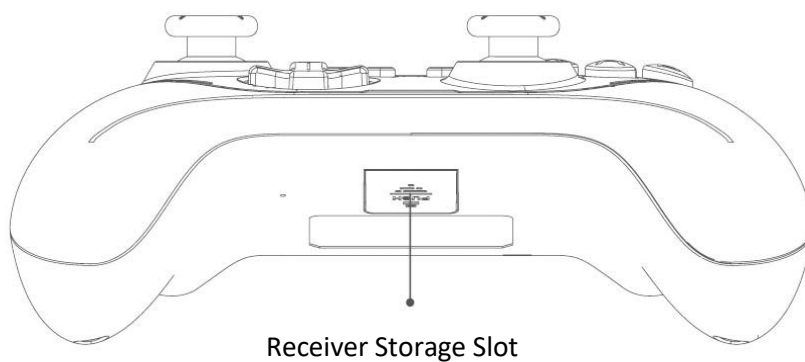

Bottom View

Power ON/OFF Procedure

Power ON

Using the receiver to connect the device, short press the BEITONG LOGO(HOME Button) to turn the Controller on.

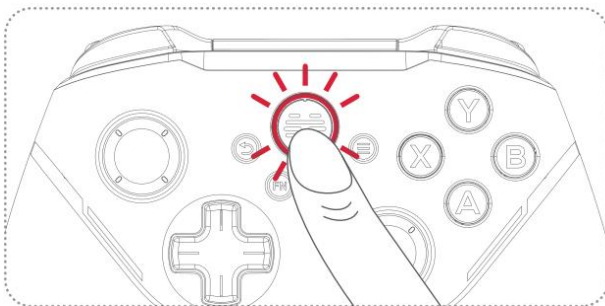

Power OFF

1. Press and hold the BACK button + B button for about 3 seconds, the Controller will be turned off.



2. When the Controller is connected, without any operation for 10 minutes, the Controller will automatically shut down.
3. When the Controller is not connected, without any operation for 120 seconds, the Controller will automatically shut down.
4. When the power cannot support the normal use of the Controller, it will be powered off if the power is low.

Pairing Clearance Tips: Press RB Button + BACK Button + RS Button + HOME Button in the power off state, pairing information can be actively cleared.

Light Introduction



*The Breathing Light refers to the RGB aperture on the outer edge of the HOME Button(BEITONG).

Under normal connection, the Breathing Light shows white. The state of Breathing Light can be customized through the BEITONG Gamepad Assistant.

| Situation | Light State |
|--------------------------|---|
| Normal Connection | Will stay on |
| Pairing | Multi-color flashing alternately |
| Battery is less than 30% | Flashes quickly |
| Charging | Flashes slowly |
| Full Charge | After the Breathing Light is on for 10 seconds, it will switch to the customize light state or light off. |

Connection Tutorial

1. Connect to Computer

Wireless Connection

Insert the wireless receiver into the USB interface of the computer, and press the BEITONG Logo (HOME Button) to turn Controller on. The connection is completed when the Controller vibrates and the breathing light is on.



Wired Connection

Use USB cable to connect the Controller and computer together, and then press the BEITONG Logo (HOME Button) to turn Controller on. The connection is completed when the Controller vibrates and the breathing light is on.



2. Connect to Android TV

Wireless Connection

Insert the wireless receiver into the USB interface of the TV, and press the BEITONG Logo (HOME Button) to turn Controller on. The connection is completed when the Controller vibrates and the breathing light is on.



* For a more stable connection during gaming, it is recommended to use an extension cable to connect the TV and wireless receiver.

Wired Connection

Use USB cable to connect the Controller and TV together, and then press the BEITONG Logo (HOME Button) to turn Controller on. The connection is completed when the Controller vibrates and the breathing light is on.



Software Support

*About the assistant software, it supports personalized function setting/key test/firmware upgrade.

It's recommended to download according to gamer's needs, but do not affect basic use of the controller without downloading.

1. BEITONG Gamepad Assistant for PC

① Download the software "BEITONG Gamepad Assistant" from BEITONG official website:

<https://www.betop-cn.com/en/#/down>

(Note: If you enter the Chinese Official Website, please set the language in the upper right corner to English, and then click the DOWNLOAD enter into the download page.)

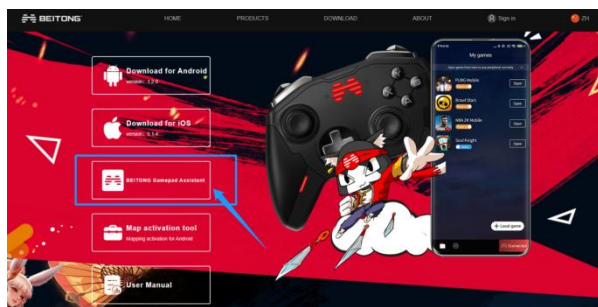

② Use USB cable to connect the Controller and computer together



③ Run the software "BEITONG Gamepad Assistant " to set up the Controller function.

NOTE:

- ① It's recommended to confirm upgrade if prompted for a firmware upgrade, to experience any updated features.
- ② In order to use the BEITONG Gamepad Assistant normally, the Gamepad must be connected to the computer with USB cable.
- ③ Please feel free to run our secure program, if it can't be downloaded and run normally, try again after closing the antivirus software.
- ④ If the firmware upgrade fails due to factors such as signal disconnection, disconnection or poor contact, please unplug the USB cable and then re-plug again to resume the firmware upgrade.

2. ASURA 2pro PC Gamepad Assistant Introduction

Customizable Buttons & TURBO Button Frequency Adjustment

①After entering the "BEITONG Gamepad Assistant ", click any button value to enter the button value modification interface.

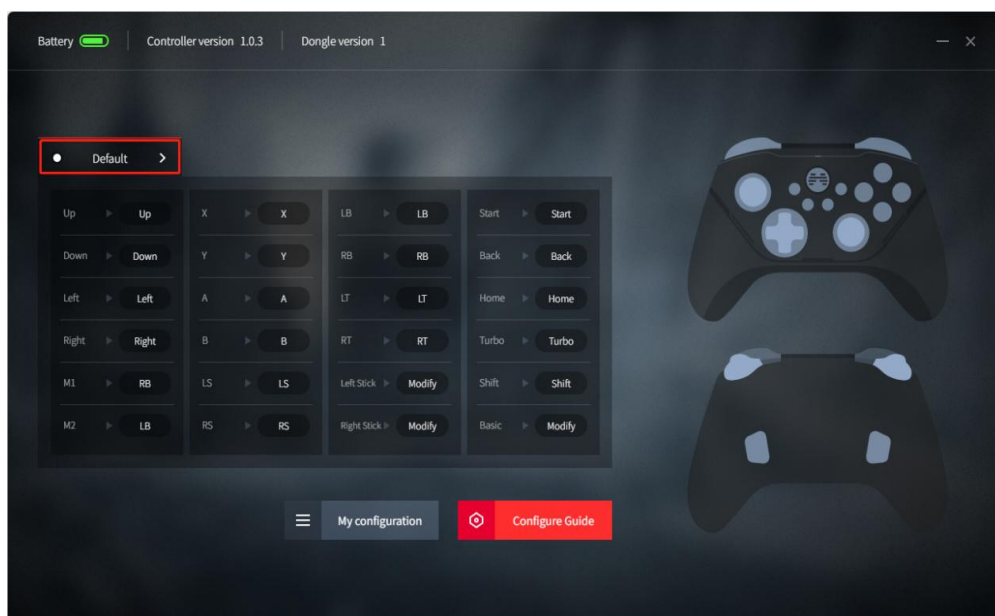

②And then press "Button" enter the customizable button interface, you can modify the button value according to your needs, click the "Restore Default" button, you can cancel all button modification operations and return to the default state.

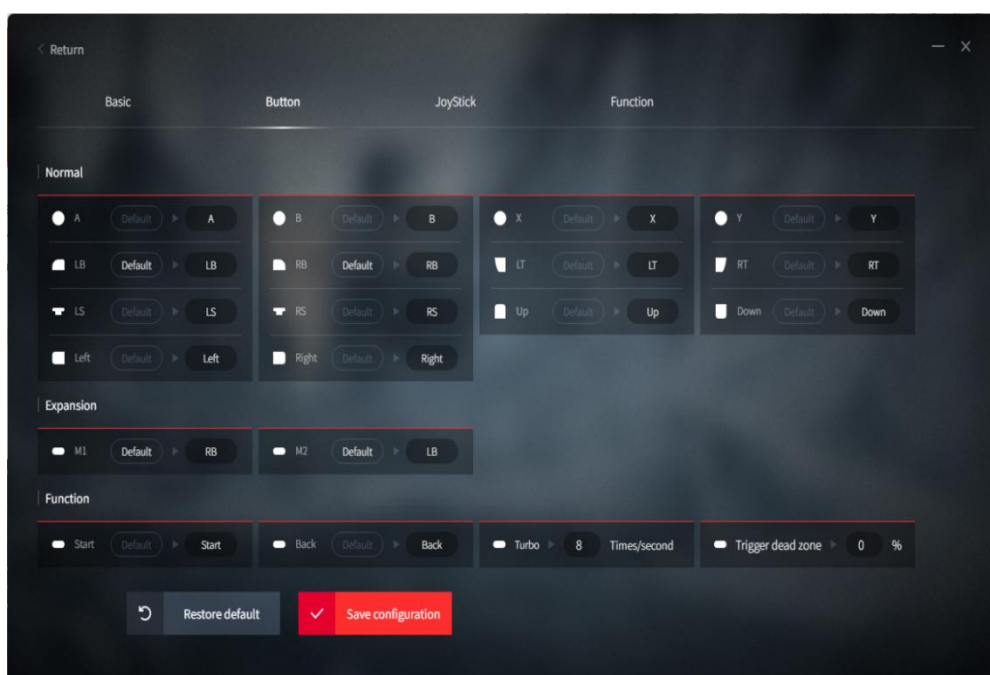

- ③ Manually adjust the number in the "Turbo" Button function in the "Button" tab to change the Turbo frequency. The default frequency of the Turbo button is 10 times/second, and the maximum frequency is 30 times/second.

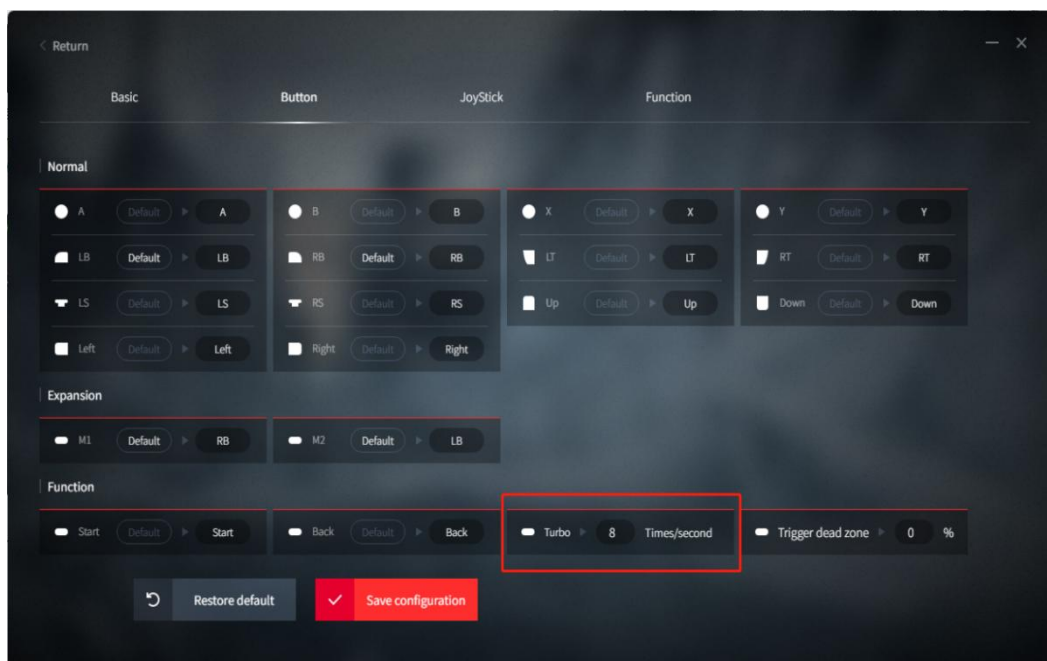

Vibration Customization & Breathing Light Adjustment

- ① Click the "Settings" button in the main interface to enter the advanced settings interface.

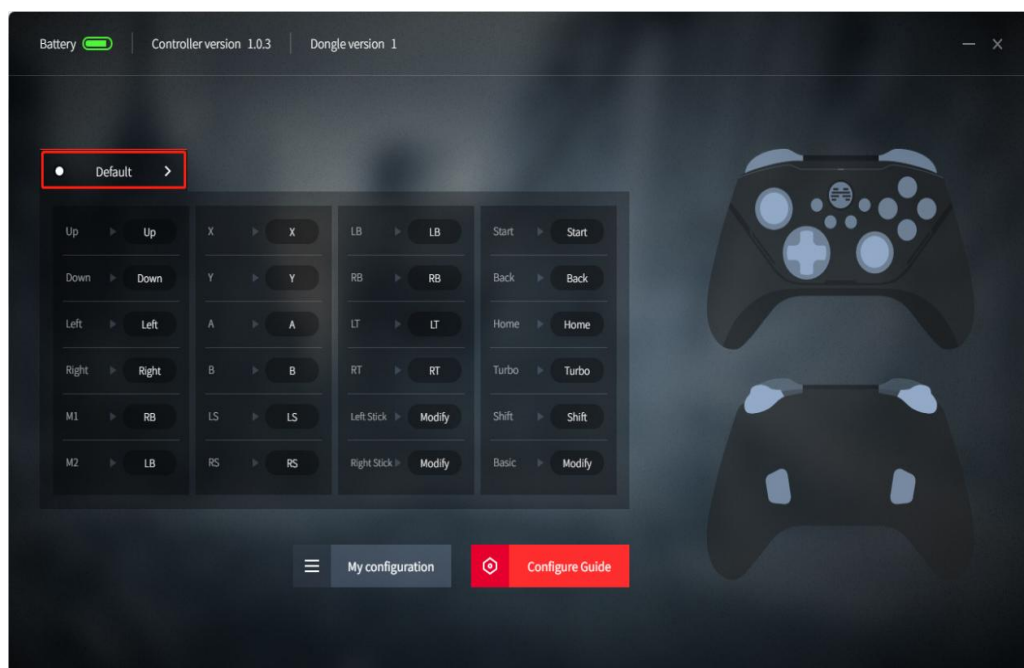

②And then press “Basic” enter the Basic Setting interface, Drag the "Vibration" slide to adjust the vibration intensity. The vibration motors on the left and right sides each have five gears that can be adjusted.

*Configuration Name can be customized

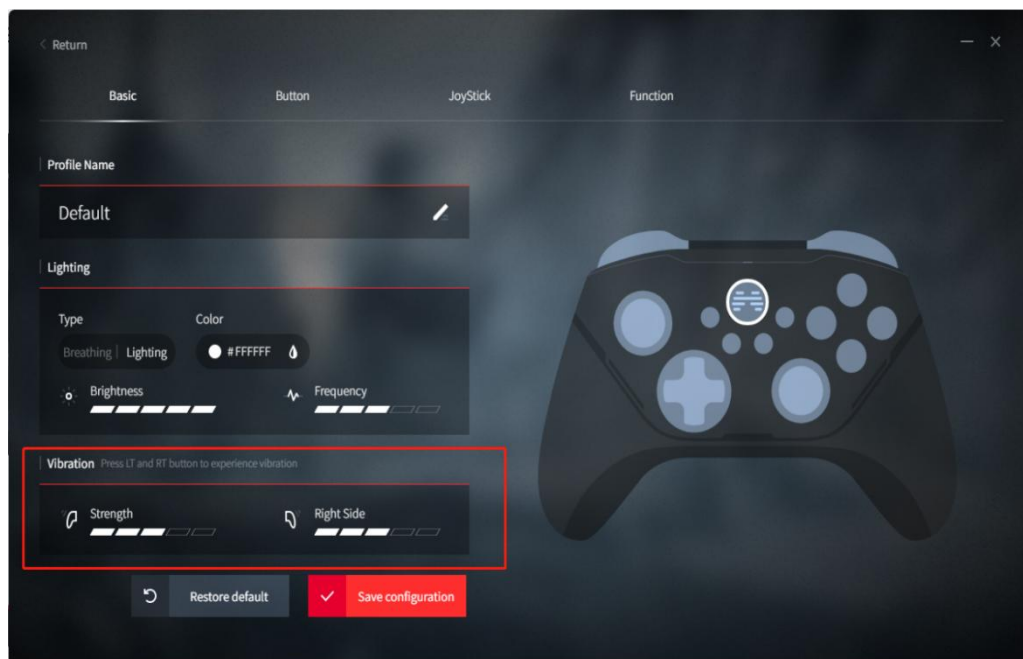

③The "Light" adjustment settings of the "Basic" tab can modify the color, brightness, frequency and work type of the Controller's Breathing Light as needed.

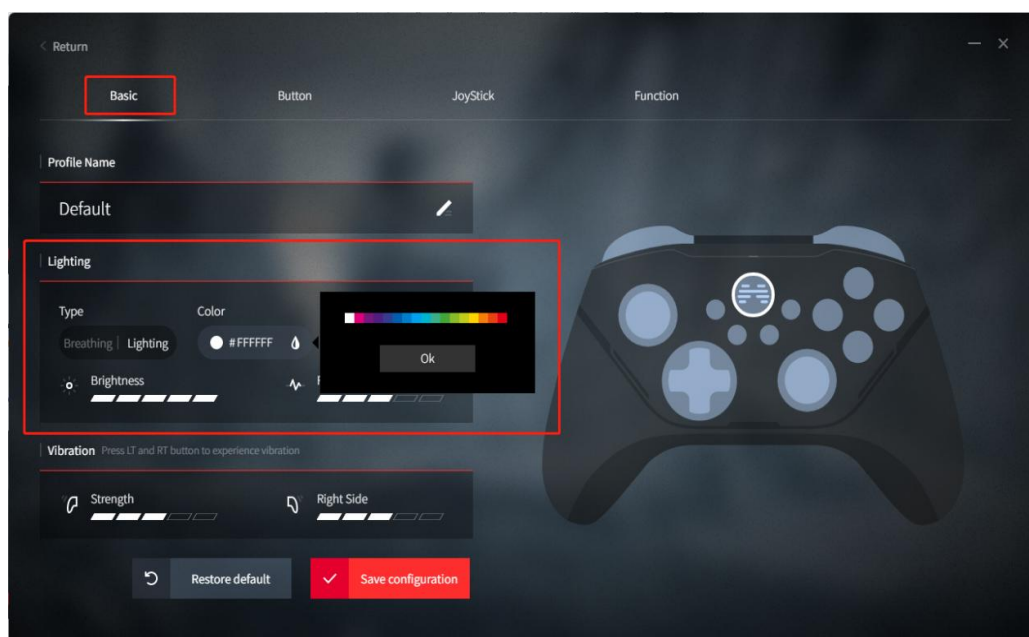

Adjust the Sensitivity of the Joystick

- ① Click the "Settings" button in the main interface to enter the advanced settings interface.

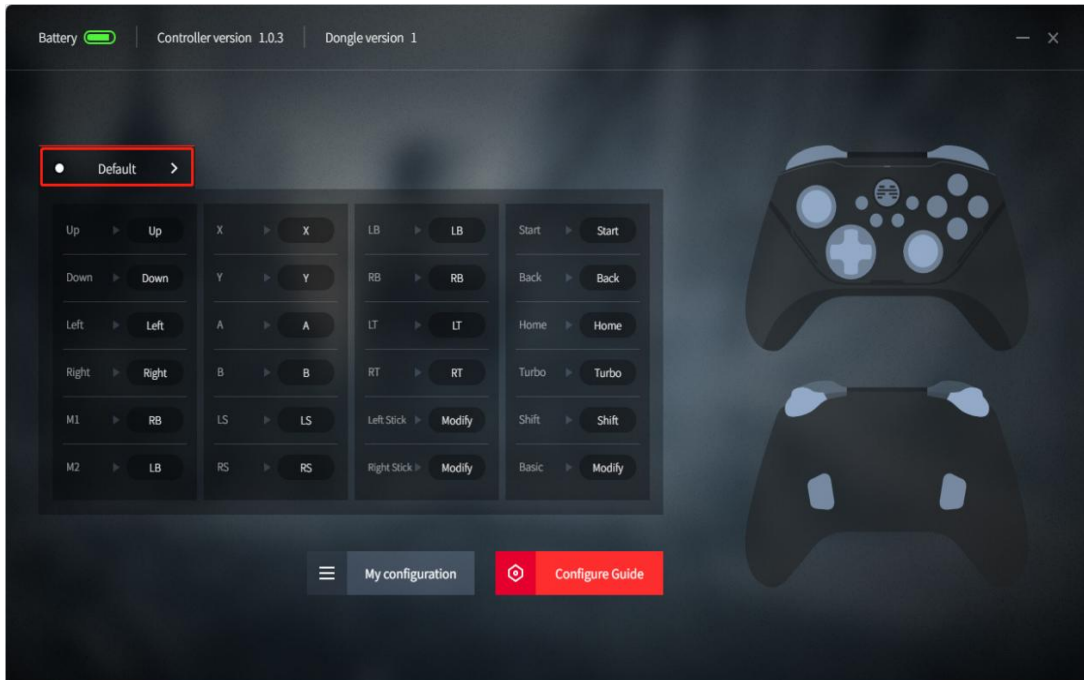

- ② And then press "Joystick" enter the Joystick interface, the sensitivity of the left and right joysticks of the Controller can be individually set.

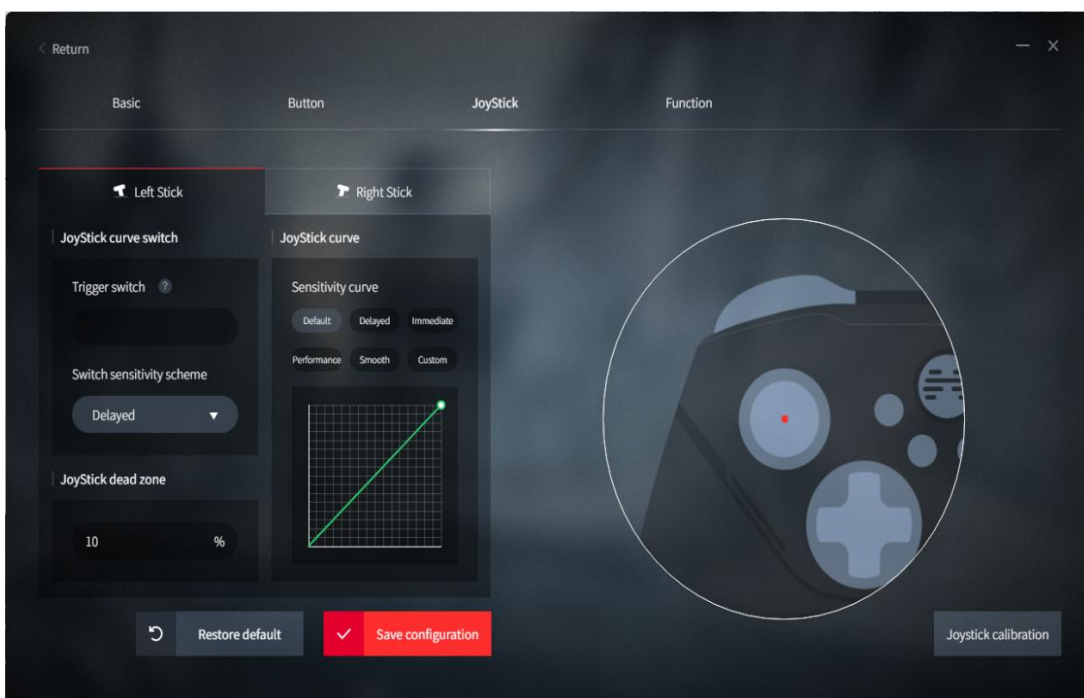

Button Macro Function

*BEITONG ASURA 2PRO Series supports custom macro settings for LB/RB, M1/M2 back buttons.

① In the Button Interface, click the "Default" button of any button of LB/RB, M1/M2 enter into the next interface.

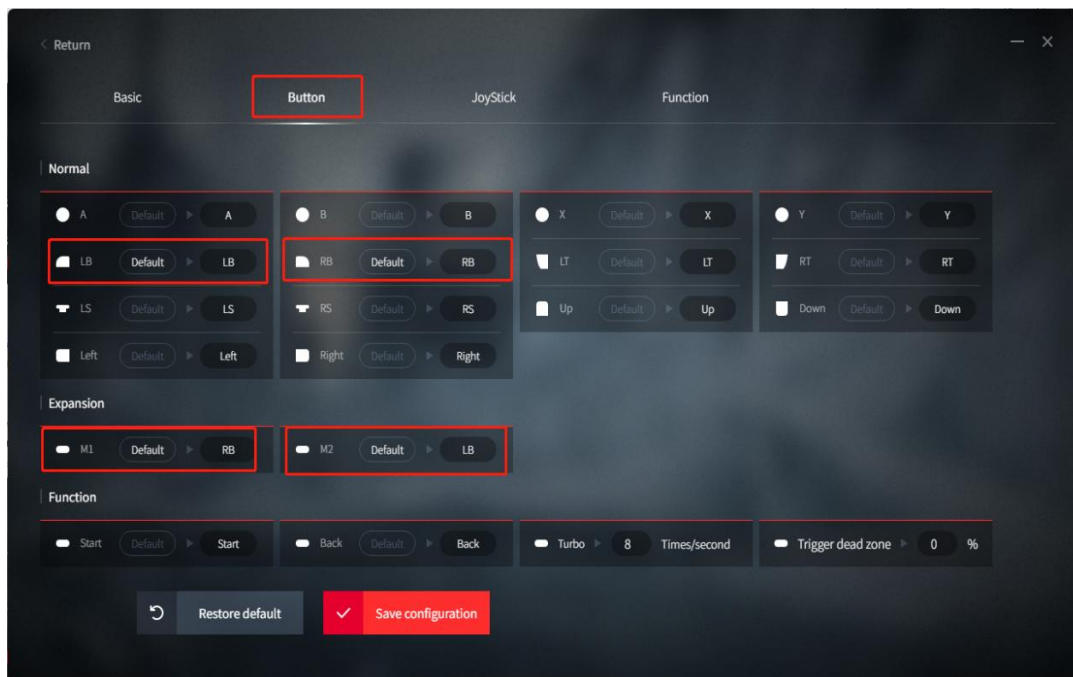

② On the next interface, click the "Default" button in the upper right corner, then click to select "Set Macro" in the drop-down menu.

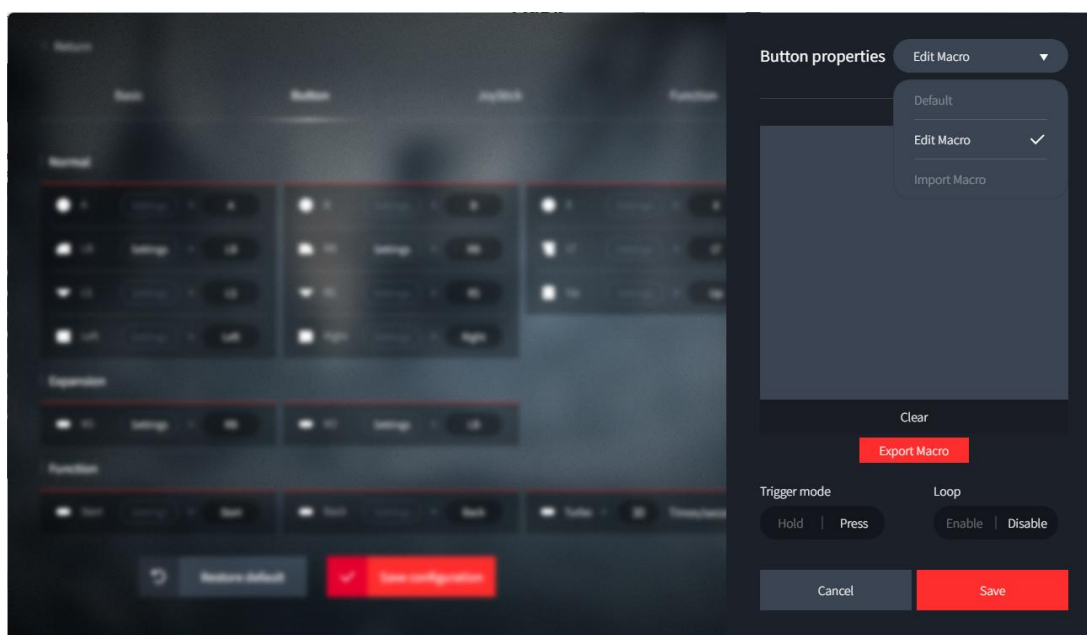

- ③ Press the desired button combination in the Controller to form a macro command, and then click "Save" to complete the button macro setting.

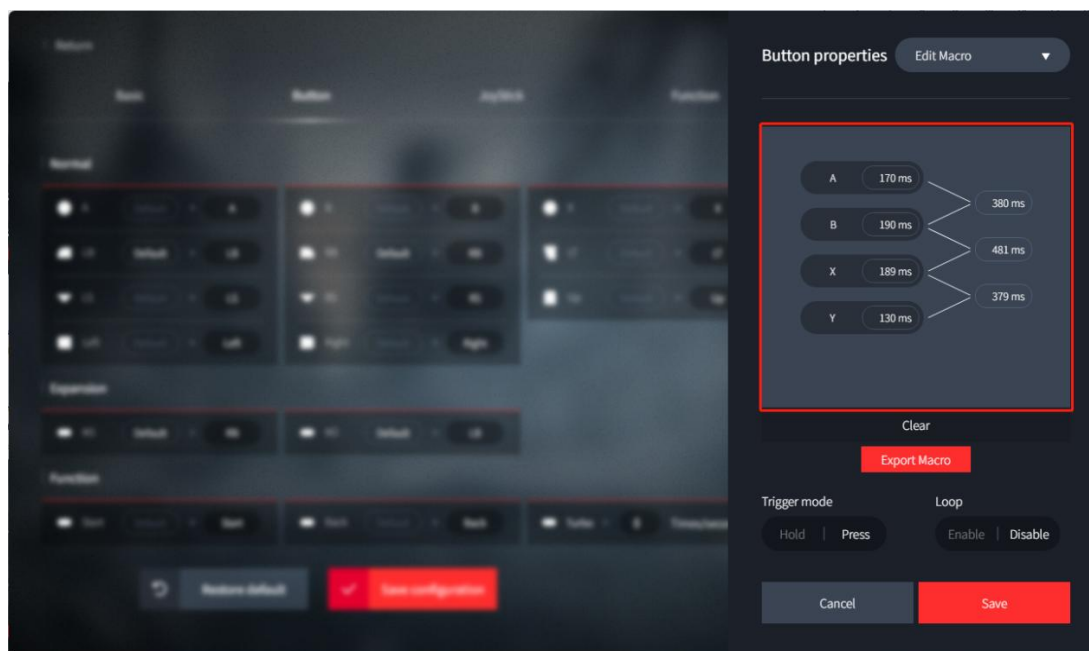

Custom Sleep Time of the Controller and Calibration Function

- ① Click the "Settings" button in the main interface to enter the advanced settings interface.

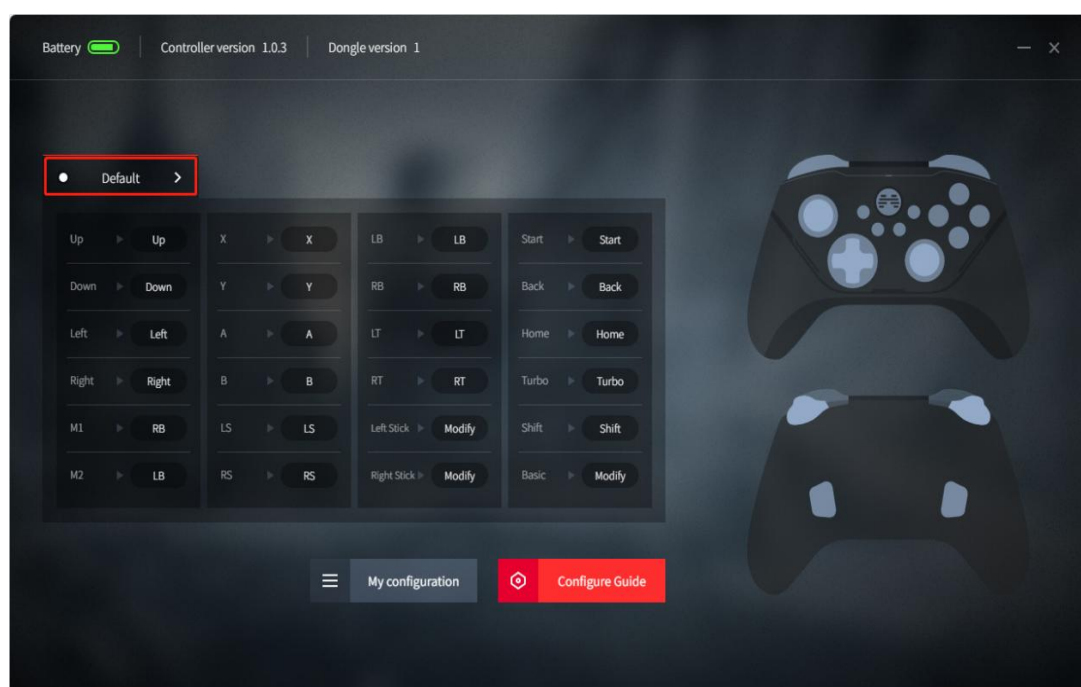

- ② In the "Function" tab, the sleep time can be adjusted, also can calibrate the joystick and trigger.

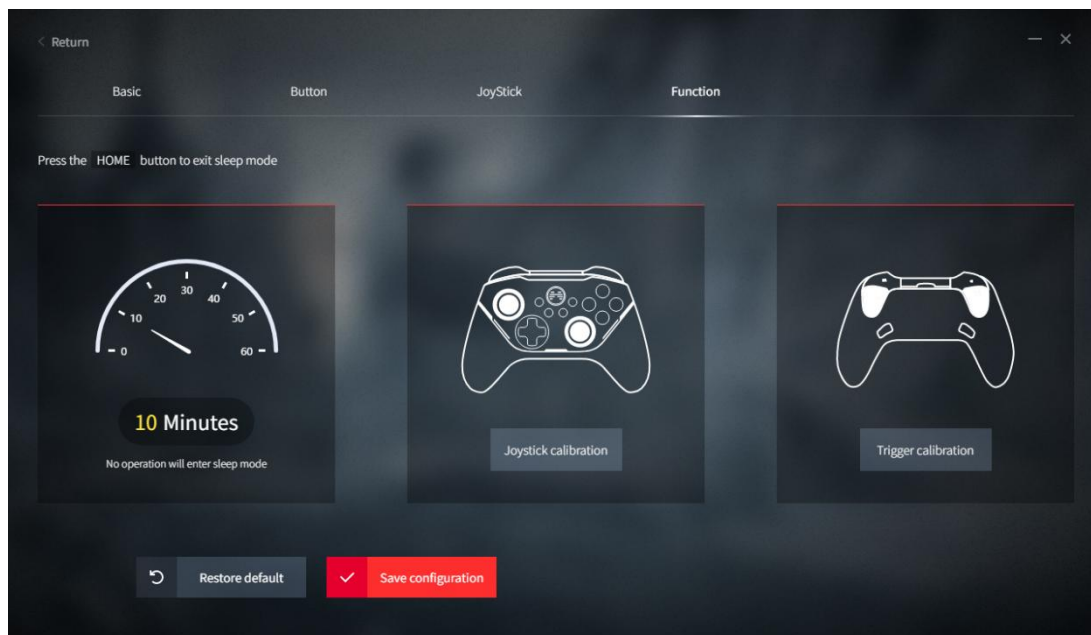

TURBO Button Introduction

Press and hold the Turbo button in the power-on state, and then press any button to set the Turbo function, repeat this operation to cancel the Turbo function.



SHIFT Button Introduction

Press gently [SHIFT Key] to enable/disable the function of switching between the left joystick and D-pad.

Joystick Calibration

***Controller Assistant also support joystick and trigger calibration**

If you encounter problems of Joystick such as drift, not work, or inability to return to the middle, you can try to use the joystick calibration function to solve:

Step 1: Press the START button + BACK button in the power-on state, and then press the Right Joystick(RS) to enter the calibration mode.

***After entering the joystick calibration state successfully, the Breathing Light turns pink.**



Step 2: Turn the left and right Joystick clockwise 2-3 turns.



Step 3: After completing the calibration operation, press the START Button + BACK Button at the same time, and then press the Right Joystick(RS) to exit the calibration.

*** After exiting the calibration mode, the Breathing Light returns to the multi-color flashing state.**



FAQ

Q How to upgrade the firmware ?

- A**
1. Visit the download page of BEITONG official website.
 2. Click [BEITONG Gamepad Assistant] to download the program.
 3. Connect controller & PC by USB cable, run betopgame.exe program to start the Gamepad Assistant
 4. Confirm firmware upgrade and wait.

Q How to troubleshoot when it cannot be turned on normally?

- A**
1. Please confirm whether the power of the controller is sufficient.
 2. Connect the power supply through the data cable and observe whether the indicator light of the controller is flashing.
 3. Connect the computer with the data cable to confirm the status of the controller.
 4. If none of the above methods can solve the problem, please contact customer service.

Product Specification

| | |
|----------------------------|---|
| Name | BEITONG Asura2 Pro Wireless Game Controller |
| Model | BTP-A1T2/A1T2S |
| Power Supply | 600mAh Rechargeable Lithium Ion Battery |
| Connection | 2.4G Wireless, USB Cable |
| Size | 160x110x50MM |
| Weight | About 250G |
| Adaptation platform | PC Window 7 and later, Android TV |
| Package Include | Gamepad x 1, Receiver x 1, USB Cable x 1, User Manual x 1 |

Customer Service

Dear customer,

Thanks for using BEITONG gaming peripheral products.

We focus on providing gamer with a better gaming experience, please provide the information through your email for customer service:

a. Purchasing Channel b. Buyer ID c. Order Number d. Product Model

Please provide the below information for us according to the product situation:

1. Please provide service reason

a. Function is not good b. Bad appearance c. Can not use in my device

d. Can not play the game i want to play e. Other reason

2. Please provide the service you need

a. Replacement b. Repairing c. Return d. Other

Customer service contact: beitong-oversea@betop-cn.com

We also welcome our customer to provide suggestion so that to improve and upgrade our product. Any good idea for our products, please feel free to contact us. It's very grateful. Meanwhile we'll select the customer who in high-quality advice to experience our new products for free opportunity.

Sincerely

BEITONG Customer Service Team

ABOUT BEITONG

Leading brand of smart gaming peripherals in China
Been focusing on game controller and software development more than 25 years
Sticking on quality, function and innovation
Customizing professional control solutions for different types of games
Creating the stronger experience of game control for gamers

CUSTOMER SERVICE

Official website: <https://www.betop-cn.com/en>
Service Email: beitong-oversea@betop-cn.com

More products and game information, please follow BEITONG official social media accounts.



Official YouTube



Official Amazon



Official Website