

Direct Sampling with the CALEX® Extraction Device

Your Test

Your healthcare professional has asked you to do a calprotectin test. This is used to determine if there is inflammation in your gut, which helps differentiate between different types of bowel disorders.

What Sample is Required?

A faecal sample is required. It is advisable to use the first bowel movement of the day because this is likely to contain the highest level of calprotectin, if it is present.

Key Things to Remember

- Do not use the CALEX beyond the stated expiry date.
- The faecal sample must not come into contact with the toilet water due to bleaches and disinfectants. Do not get urine in the sample as this will dilute it. Read the instructions carefully before you start.



How to Collect Your Sample

BEFORE YOU BEGIN...

Write the date of sample collection on the label. Also write your name, date of birth and NHS number if this is not already on the tube.



1. COLLECT THE FAECAL SAMPLE

There are a number of ways to collect your faecal sample:

- A clean takeaway container, paper/foil plate.
- **Loosely** draped cling film placed over the toilet towards the back to form a dip. (Do not flush after use).
- A plastic bag or glove covering your hand.

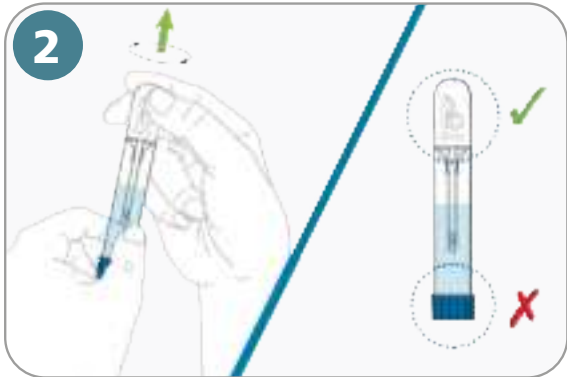

2. PREPARE THE CALEX CAP

Holding the CALEX Cap tube with the white cap pointing upward remove the sampling pin by simultaneously turning clockwise and pulling up the white cap.



3. TAKE THE SAMPLE

Dip the sampling pin into the faeces and twist. Repeat this process three to five times in different places in the sample.

Scan the QR code to watch a video on how to deal with different sample consistencies.

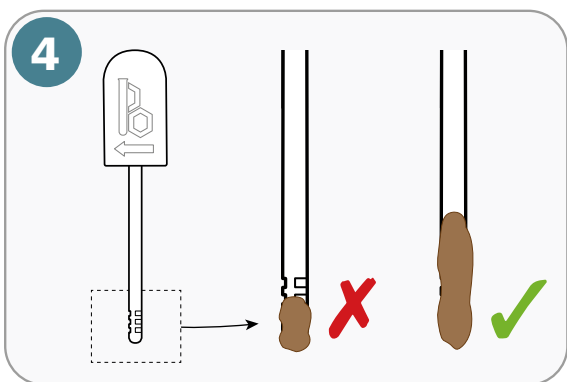

4. CHECK THE SAMPLE

Make sure all the grooves are completely filled on the end of the sampling pin.

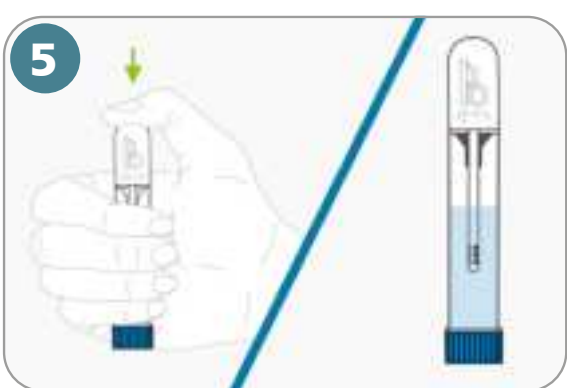

5. RE-SEAL THE CALEX CAP

Replace the sampling pin back into the CALEX Cap tube and push firmly into the locking position (you will feel and hear two clicks).

6. DO THIS ONLY ONCE

Once complete do not remove the sample pin or repeat the collection process as this will lead to inaccurate or incorrect results. Please return your sample in the plastic bag provided as quickly as possible to your GP or hospital laboratory.



DO NOT UNSCREW THE BLUE CAP

Liquid contains preservative which may cause allergic skin reactions. If skin irritation or rash occurs: Get medical advice/attention.

Checklist

- Ensure the white cap is replaced securely (you will hear two clicks).
- Ensure the CALEX® tube is clearly labelled with your name, date of sample collection, NHS number and date of birth.
- Put the CALEX® tube and the GP request form into the plastic bag and return as directed to the GP or hospital laboratory, as quickly as possible.

Access to Alternative IFU Format

Scan the QR code to visit our website where you can find different versions of the IFU, including: Narrated step-by-step.



Explanations of the advisory symbols used within the kit can be found on the website: www.alphalabs.co.uk/kit-symbols



Alpha Laboratories Ltd
40 Parham Drive, Eastleigh, Hampshire, SO50 4NU, UK
Tel: 023 8048 3000 | Email: kits@alphalabs.co.uk
Web: www.alphalabs.co.uk
Registered in England 1215816

Please Do NOT
send the
completed
sample to this
address