

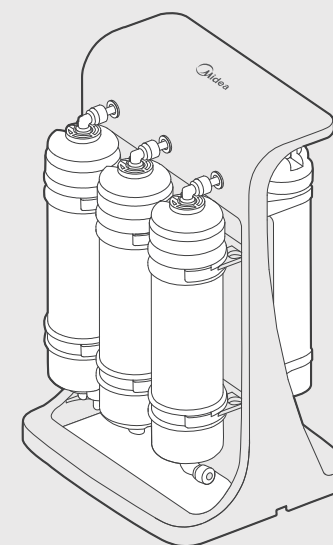

www.midea.com  
© Midea 2023 all rights reserved



**Reverse Osmosis Water Filtration System**

## **USER MANUAL**

**MWP30S1AWW-E**

Warning notices: Before using this product, please read this manual carefully and keep it for future reference. The design and specifications are subject to change without prior notice for product improvement. Consult with your dealer or manufacturer for details. The diagram above is just for reference. Please take the appearance of the actual product as the standard.

## THANK YOU LETTER

Thank you for choosing Midea! Before using your new Midea product, please read this manual thoroughly to ensure that you know how to operate the features and functions that your new appliance offers in a safe way.

# CONTENTS

THANK YOU LETTER .....	01
SAFETY INSTRUCTIONS .....	02
SPECIFICATIONS .....	04
PRODUCT OVERVIEW .....	05
PRODUCT INSTALLATION .....	07
OPERATION INSTRUCTIONS .....	12
CLEANING AND MAINTENANCE .....	13
TROUBLESHOOTING .....	15
TRADEMARKS, COPYRIGHTS AND LEGAL STATEMENT .....	16
DISPOSAL AND RECYCLING .....	17
DATA PROTECTION NOTICE .....	18

# SAFETY INSTRUCTIONS

## Intended Use

The following safety guidelines are intended to prevent unforeseen risks or damage from unsafe or incorrect operation of the appliance. Please check the packaging and appliance on arrival to make sure everything is intact to ensure safe operation. If you find any damage, please contact the retailer or dealer. Please note modifications or alterations to the appliance are not allowed for your safety concern. Unintended use may cause hazards and loss of warranty claims.

## Explanation of Symbols



### Danger

This symbol indicates that there are dangers to the life and health of persons due to extremely flammable gas.



### Warning of electrical voltage

This symbol indicates that there is a danger to life and health of persons due to voltage.



### Warning

The signal word indicates a hazard with a medium level of risk which, if not avoided, may result in death or serious injury.



### Caution

The signal word indicates a hazard with a low degree of risk which, if not avoided, may result in minor or moderate injury.



### Attention

The signal word indicates important information (e.g. damage to property), but not danger.



### Observe instructions

This symbol indicates that a service technician should only operate and maintain this appliance in accordance with the operating instructions.

Read these operating instructions carefully and attentively before using/commissioning the unit and keep them in the immediate vicinity of the installation site or unit for later use!

### **DANGER: Risk of Fire/Flammable materials**

- Do not store explosive substances such as aerosol cans with a flammable propellant in this appliance.
- The appliance must be disconnected from the main safter use and before user-performable maintenance is carried out.
- The following safety guidelines are intended to prevent unforeseen risks or damage from unsafe or incorrect operation of the appliance. Please check the packaging and appliance on arrival to make sure everything is intact to ensure safe operation. If you find any damage, please contact the retailer or dealer. Please note modifications or alterations to the appliance are not allowed for your safety concern. Unintended use may cause hazards and loss of warranty claims.

### **CAUTION: Risk of injury!**

**Failure to comply with the safety information and instructions may result in injury.**

**Safety of children and persons with reduced abilities.**

- This appliance can be used by children aged from 8 years and above if they have been given supervision or instruction concerning use of the appliance in a safe way and if they understand the hazards involved. Cleaning and user maintenance shall not be made by children unless they are older than 8 and supervised. Keep the appliance and its cord out of reach of children aged less than 8 years.
- Appliances can be used by persons with reduced physical, sensory or mental capabilities or lack of experience and knowledge if they have been given supervision or instruction concerning use of the appliance in a safe way and understand the hazards involved.
- Children shall not play with the appliance.

### **WARNING**

- If the supply cord is damaged, it must be replaced by the manufacturer, its service agent or similarly qualified persons in order to avoid a hazard.
- This appliance is intended to be used by expert or trained users in shops, in light industry and on farms, or for commercial use by lay persons.
- The appliance is suitable for indoor use only.
- WARNING: Keep ventilation openings, in the appliance enclosure or in the built-in structure, clear of obstruction.
- WARNING: When positioning the appliance, ensure the supply cord is not trapped or damaged.
- WARNING: Do not locate multiple portable socket-outlets or portable power supplies at the rear of the appliance.
- WARNING: To avoid a hazard due to instability of the appliance, it must be fixed in accordance with the instructions.
- The appliance must not be cleaned by a water jet.
- The appliance must not be immersed.
- This product is not recommended to use in areas above 1,500m altitude.
- The new hose-sets supplied with the appliance are to be used and that old hose-sets should not be reused.

## SPECIFICATIONS

Product Model	MWP30S1AWW-E
Applicable water pressure	0.2-0.4 MPa
Applicable water	Tap water
Applicable temperature	4-38°C
Stage 1	PP SEDIMENT FILTER
Stage 2	C1 PRE CARBON FILTER
Stage 3	RO REVERSE OSMOSIS
Stage 4	C2 POST CARBON FILTER
Pockage size(LxWxH)	610*285*490mm

# PRODUCT OVERVIEW

## Product

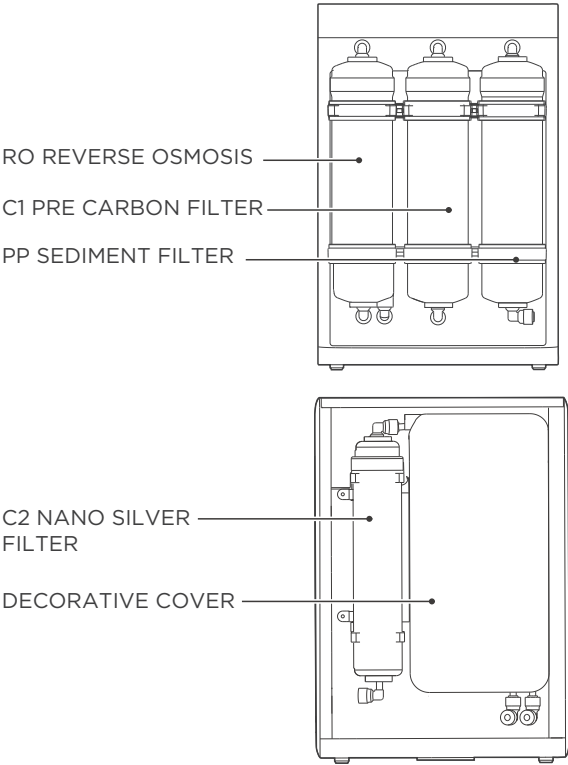

## Accessories

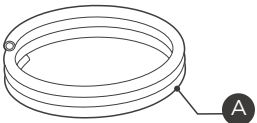

White 1/4" PE Tubing  
x 79"

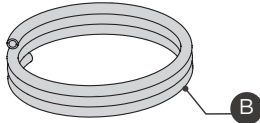

Yellow 1/4" PE Tubing  
x 79"

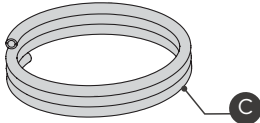

Blue 1/4" PE Tubing  
x 79"

# PRODUCT OVERVIEW

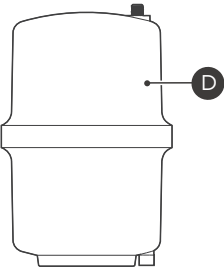

Pressure Tank

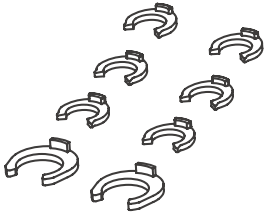

Locking clip (8x)



Drain saddle

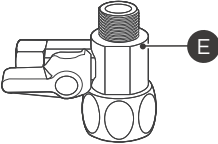

3-way valve

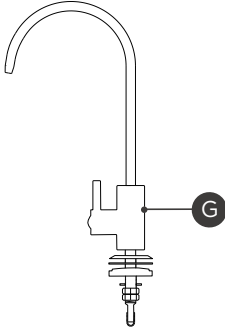

Faucet

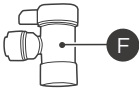

Pressure tank ball valve

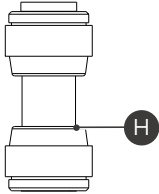

Faucet base connector

## Required tools(not included)



Power drill with 1/4" drill bit



Bucket

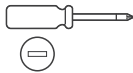

Cross-head screwdriver

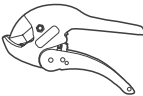

Pipe cutter



Adjustable wrench



Safety glasses

# PRODUCT INSTALLATION

## Use Guide

1. Firstly make sure the machine is well installed by the qualified personnel.
2. This product is only recommended for indoor use, especially when the temperature around the product is lower than zero degrees Celsius, the product is likely to crack and leak.
3. Make sure water source is open.
4. Installation of water Purifier:

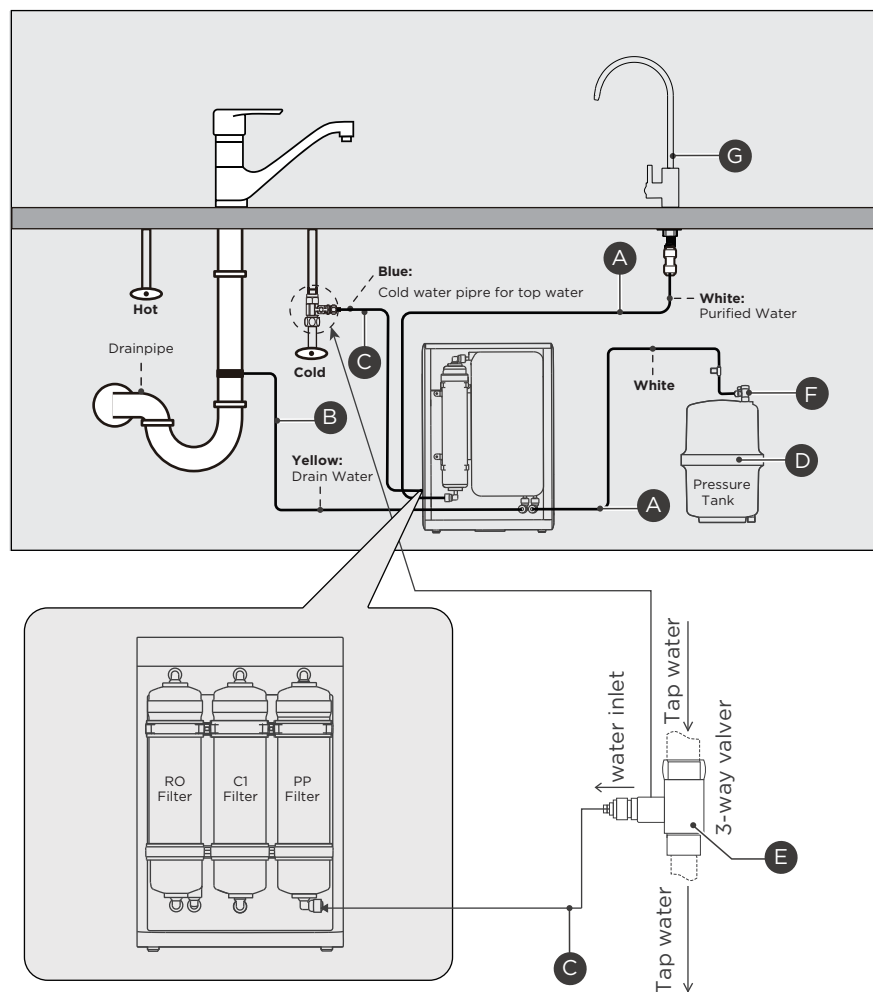

# PRODUCT INSTALLATION

## Flowchart of Water Generation

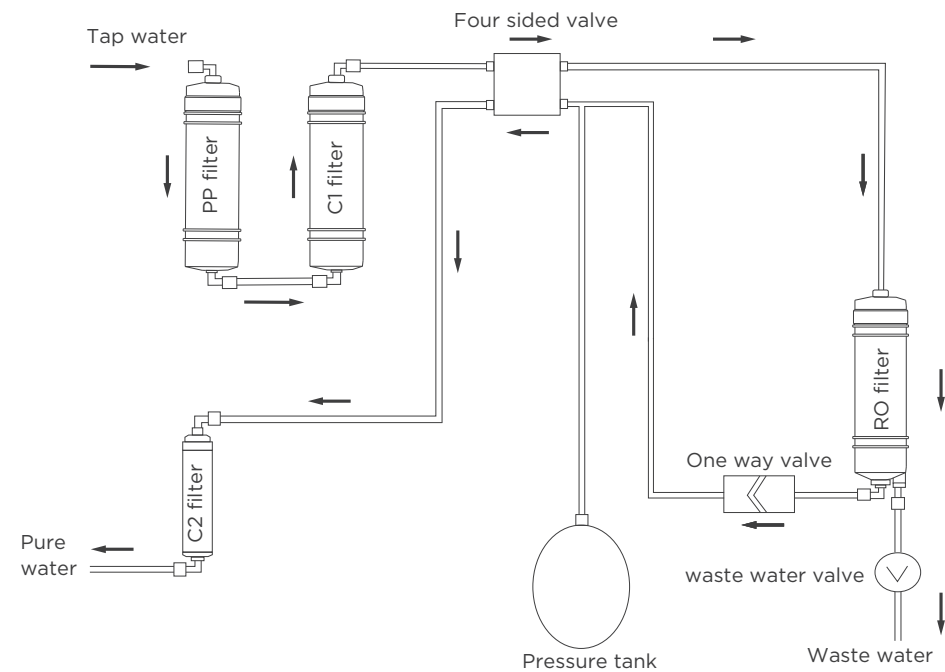

# PRODUCT INSTALLATION

## Installation Tips

### Hot to Use The Quick-Connect Fittings

#### To connect:

1. There is an existing mark (Figure 1) at the end of the tubing that you can use to confirm whether the tubing is fully inserted into the fitting. Push the tubing into the fitting until you reach the mark on the tubing.
2. If the tubing is not fully inserted, it will cause leakage. When the tubing is fully inserted, put the blue lock clip on the fitting. It will lock the tubing in place and prevent it from falling off.
3. If the tubing is too long, cut it to a suitable length using a sharp utility knife or pair of scissors. Cut the tubing squarely and cleanly (Figure 2). Make sure the tubing is fully inserted.

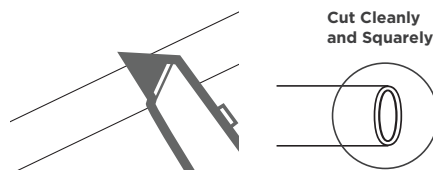
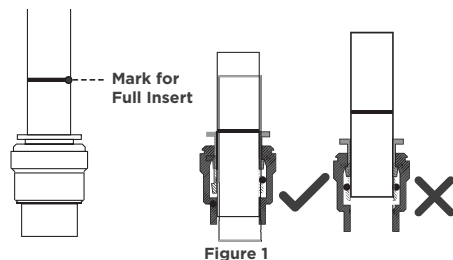

#### To disconnect:

1. Remove the blue lock clip from the fitting.
2. Use your thumb and index finger to press down on the lock sleeve. Use your other hand to pull out the tubing from the fitting (Figure 3).

**NOTE: Please do not pull out the tubing directly, or else it will damage the fitting and cause leakage.**

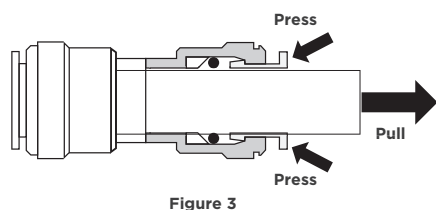

### How to Drill a Hole into Your Sink or Countertop (Optional)

#### NOTE:

- Please confirm if there is an existing hole available to install the faucet. If not, please drill a hole in accordance with the following steps.
- If the countertop is thicker than 2.95 inches, the faucet cannot be installed. It's highly recommended to watch the video "How to Drill Faucet Holes" for a better understanding of the process. There is also a sticker for your reference when you drill the hole. Remember to wear safety glasses to protect your eyes while drilling the faucet hole.

# PRODUCT INSTALLATION

1. Choose a diamond core bit for granite, and a carbide drill bit for stainless steel. Do not use a hammer drill on natural stone, glass, or ceramic.
2. Glue the sticker to your sink or countertop, and drill a hole referring to the size shown on the sticker (1").
3. Make an indent with a center punch on a stainless-steel sink before drilling to help guide the bit.
4. Be careful when drilling on a porcelain sink, as it can be easily chipped. Apply downward pressure firmly to the bit until breaking through the surface.
5. Starting at the lowest speed, hold the drill straight with firm pressure to prevent the bit from walking on the counter.
6. Once breaking through the surface, swirl the drill a little to apply pressure in a circle evenly.

## Installation steps

#### NOTE:

- Before installation, remove the RO system from the box and choose an easy-to-access area under the sink to place it. An adequate flat area is necessary to allow the system to rest securely. Do not lay it on its side, on its back, or upside down.
- The RO system must be connected to the COLD water supply ONLY.
- Do not install the system where it will be exposed to direct sunlight or harmful chemicals, nor in any place where it may be damaged.
- Do not install the system near any heat source.
- Do not install the system outdoors.

### Step 1: Install the Feed Water Adapter

1. Shut off the water supply. Turn on the kitchen faucet to release the water pressure; **NOTE:** Make sure the water has stopped before proceeding to the next step. Get a towel or bucket to catch any excess water.
2. Disconnect the cold water pipe from the cold water supply valve.
3. Connect the white 1/4" inlet water tubing to the feed water adapter and tightened the nut. **NOTE:** For convenient connecting, it's recommended to immerse one end of the inlet tube in warm water for a while, then connect it to the feed water adapter.
4. Twist the feed water adapter onto the cold water supply valve (with its washer) and tighten it with an adjustable wrench (Figure 4).
5. Twist the cold water pipe (with its washer) onto the feed water adapter and tighten with an adjustable wrench.

# PRODUCT INSTALLATION

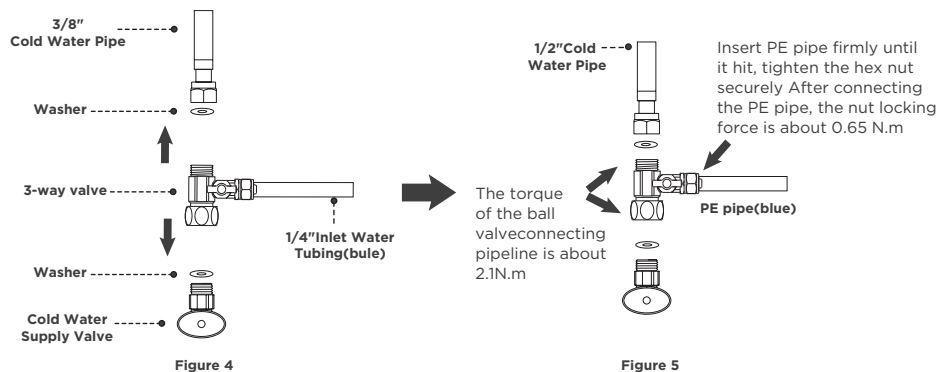

## Step 2: INSTALL REVERSE OSMOSIS FAUCET1

1. The RO faucet is included with your RO System. Locate and organize the RO installation parts, see Figure 6 for more details on assembly.
2. Referring to Figure 6, You will need to install the part in the order shown, Stainless Steel Washer. Thin Black Washer. Slide both onto the base of the faucet screw rod. The thin rubber washer should be sandwiched in between the faucet top and stainless steel washer.
3. Remove the red protective cap from the end of the RO faucet screw rod.
4. Now install the RO faucet through the mounting hole.
5. Under the cabinet install the following components in this order: Reference Figure 6: Thick Black Rubber Washer; Metal Serrated Washer. Nut. In the order shown above, slide onto the base of the RO faucet screw rod.
6. Hand tighten the nut to threaded rod of the RO faucet until the faucet cannot move freely. Check the RO faucet to make sure the stainless steel washer and thin black washer is centered under the faucet. Once aligned, tighten the nut with an adjustable wrench.
7. The RO Faucet Base Connector is included with your RO System. Install this connector to the base of the faucet. Push connector onto faucet base until the connector bottoms out, see Figure 6.
8. You will attach the "BLUE" PE tube to the base of the faucet quick connect connector.
9. After you have inserted the blue PE tube into the connector, insert the blue PE Tube Lock Clips into the quick connector end. See Figure 7 for order of installation.

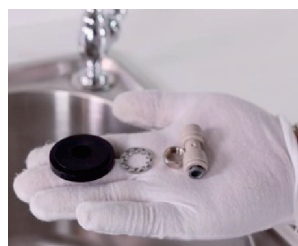
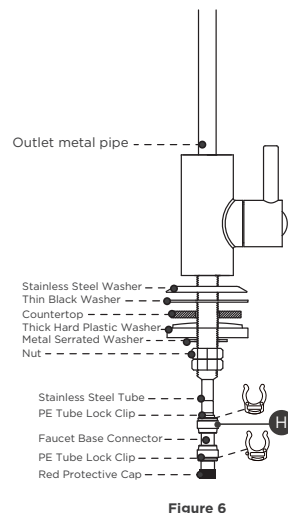

# OPERATION INSTRUCTIONS

## Product features

1. Four-stage high-precision filtration  
Four stage RO filtration, Filter accuracy of the machine is greater than 90%.
2. The purifier can be used normally with and without power  
Adopt innovative water control scheme to ensure that the purifier can work to filter water under the condition of power on and power off.

## Introduction to filter functions

Tag	Name	Illustration	
Stage 1	PP SEDIMENT FILTER		Carry out coarse filtration of the original water, and filter out mud, sand, impurity, iron rust and suspension, etc.
Stage 2	C1 PRE CARBON FILTER		Absorb unusual colors and odors. Remove residual chlorine and organic substances in water.
Stage 3	RO REVERSE OSMOSIS		Filtration accuracy is nearest to 0.001-0.0001μm, only allowing the passage of water molecules, and almost completely retaining harmful substances in water such as pesticide, bacteria, virus, and heavy metal ions.
Stage 4	C2 POST CARBON FILTER		Further absorb micro-molecules organic substances in water. Make water taste better.

# CLEANING AND MAINTENANCE

## Filter replacement Cycle

PP SEDIMENT FILTER	C1 PRE CARBON FILTER	RO REVERSE OSMOSIS	C2 POST CARBON FILTER
3-6 months	6-12 months	12-24 months	6-12 months

**Attention**

The data above are for references only. It is based on 10L per daily drinking water. The specific cycle for replacement of filters varies with local water quality and water amount consumed.

## Maintenance

1. Replace the filters in time to keep pure water quality.
2. Move the product carefully and slightly, never place the product in a direct sunshine.
3. Never put the product in a place where water may freeze to prevent the filters from damage due to freezing.
4. Never remove the parts on the machine to avoid leakage or damage.
5. By using a cloth dipped in water, clean the water purifier with soft detergent rather than strong volatile solvent such as gasoline.
6. In case of long-term no use, pull out the power plug, close the feed ball valve and cut off the water source. Open the faucet to drain out the water in pressure tank when reuse.
7. In case of failure, disconnect the water source and power supply promptly, and inform the local service agency immediately to eliminate the failure.
8. In the cases where the water purifier is used for the first time or reused after long time idle, drain out the first two tanks of water through the gooseneck faucet at first.
9. Drain out 500mL water everyday at the first time to clear the water in pipe.
10. Please replace the filters in time as requested. It can ensure better filtration effect.

# CLEANING AND MAINTENANCE

## Maintenance

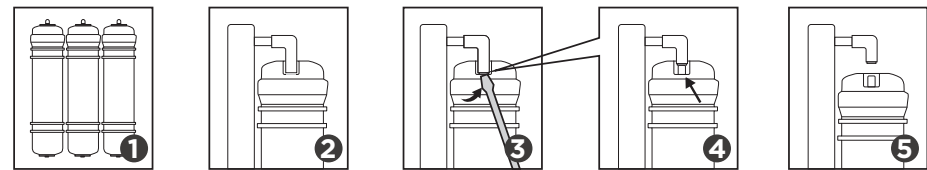

1. Rotate the filter element to rotate the easy-to-remove parts with notches as shown in Figure 2.
2. Use a screwdriver to pry open the quick-release clamp and remove the quick-release plug Figure 3.
3. The gray piece indicated by the arrow is the quick-release clamp Figure 4.
4. Repeat the above steps to remove the quick-connect fittings at both ends of the filter cartridge.
5. After removing the quick-release connector, pull the filter element outward with force to remove it Figure 5.
6. When installing the filter element, it is important to note that the text on the filter element cannot be reversed.
7. The newly replaced filter cartridge may produce black water because it contains high-quality activated carbon. Please follow the instructions and rinse it before use. It is recommended to rinse for 10-20 minutes. Please close the pressure tank ball valve during rinsing to avoid black water flowing into the discharge tank.



# TROUBLESHOOTING

Operation of your appliance can lead to errors and malfunctions. The following tables contain possible causes and notes for resolving an error message or malfunction. It is recommended to read the tables carefully below in order to save your time and money that may cost for calling to the service center.

Problem	Possible reason	Solution
Machine fails to run	• Feed ball valve closed	Open the feed ball valve
	• Power supply not put through	Switch on power supply
	• Booster pump not running	Contact the local service agency
	• Power cut	Wait for the power resumed
Noise occurring in operation	• Booster failing or fastening screws loosening	Contact the local service agency
	• Insufficient water in booster	Increase the water pressure of original water
Too much drop in amount of water generated or no water out	• RO membrane jammed	Contact the local service agency
	• Filter not replaced in time, beyond the use time	Contact the local service agency to replace the filter
No water out from gooseneck faucet	• Post active carbon filter jammed	Contact the local service agency to replace the the filter
	• Pre-treatment filters jammed	
	• RO membrane jammed	
Poor quality of water out	• Post active carbon filter not repaced in time, beyond the use time	Inform the local service agency to replace the the filter timely
	• RO membrane damaged	
	• Fine carbon powder contained in water	Wash post active carbon powder away or replace post active carbon filter
Booster pump not stopping	• High-pressure switch damaged	Please contact the local sevice agency
	• Waste water ratio solenoid valve damaged	

# TRADEMARKS, COPYRIGHTS AND LEGAL STATEMENT

 Midea logo, word marks, trade name, trade dress and all versions thereof are valuable assets of Midea Group and/or its affiliates ("Midea"), to which Midea owns trademarks, copyrights and other intellectual property rights, and all goodwill derived from using any part of an Midea trademark. Use of Midea trademark for commercial purposes without the prior written consent of Midea may constitute trademark infringement or unfair competition in violation of relevant laws.

This manual is created by Midea and Midea reserves all copyrights thereof. No entity or individual may use, duplicate, modify, distribute in whole or in part this manual, or bundle or sell with other products without the prior written consent of Midea.

All the described functions and instructions were up to date at the time of printing this manual. However, the actual product may vary due to improved functions and designs.

# DISPOSAL AND RECYCLING

## Important instructions for environment

Compliance with the WEEE Directive and Disposing of the Waster Product:  
This product complies with EU WEEE Directive (2012/19/EU). This product bears a classification symbol for waster electrical and electronic equipment (WEEE).

This symbol indicates that this product shall not be disposed with other household wastes at the end of its service life. Used device must be returned to official collection point for recycling of electrical electronic devices. To find these collection systems please contact to your local authorities or retailer where the product was purchased. Each household performs important role in recovering and recycling of old appliance. Appropriate disposal of used appliance helps prevent potential negative consequences for the environment and human health.



## Compliance with RoHS Directive

The product you have purchased complies with EU RoHS Directive (2011/65/EU). It does not contain harmful and prohibited materials specified in the Directive.

## Package information

Packaging materials of the product are manufactured from recyclable materials in accordance with our National Environment Regulations. Do not dispose of the packaging materials together with the domestic or other wastes. Take them to the packaging material collection points designated by the local authorities.



# DATA PROTECTION NOTICE

For the provision of the services agreed with the customer, we agree to comply without restriction with all stipulations of applicable data protection law, in line with agreed countries within which services to the customer will be delivered, as well as, where applicable, the EU General Data Protection Regulation (GDPR).

Generally, our data processing is to fulfil our obligation under contract with you and for product safety reasons, to safeguard your rights in connection with warranty and product registration questions. In some cases, but only if appropriate data protection is ensured, personal data might be transferred to recipients located outside of the European Economic Area.

Further information are provided on request. You can contact our Data Protection Officer via **MideaDPO@midea.com**. To exercise your rights such as right to object your personal data being processed for direct marketing purposes, please contact us via **MideaDPO@midea.com**. To find further information, please follow the QR Code.

## Call or LiveChat

Midea Customer Service Representatives are ready to help. Click the chat button to the right, or call the number below.



**1-866-646-4332**

**Service Time**

Monday through Friday 8am to 7pm EST Saturday 9 am to 4 pm EST.