

GARMIN®

FORCE® PRO TROLLING MOTOR INSTALLATION INSTRUCTIONS

Getting Started

WARNING

See the *Important Safety and Product Information* guide in the product box for product warnings and other important information.

Failure to install this device according to these instructions could result in personal injury, damage to the vessel or device, or poor product performance.

Do not run the motor when the propeller is out of the water. Contact with the rotating propeller may result in severe injury.

Do not use the motor in areas where you or other people in the water may come into contact with the rotating propeller, which could result in severe injury.

Always disconnect the motor from the battery before handling or working with the propeller, propeller drive motor, electrical connections, or electronics enclosures to avoid serious injury or property damage.

CAUTION

For the best possible performance and to avoid potential injury, damage to the device, or damage to your vessel, installation by a qualified marine installer is recommended.

To avoid possible personal injury, always wear safety goggles, ear protection, and a dust mask when drilling, cutting, or sanding.

When stowing or deploying the motor, be aware of the risk of entrapment or pinching from moving parts, which can result in injury.

When stowing or deploying the motor, maintain stable footing and be aware of slick surfaces around the motor. Losing your footing while stowing or deploying the motor may result in injury.

You must always secure the safety strap after stowing the trolling motor to prevent the motor from deploying unexpectedly. An unexpected deployment of the motor may lead to personal injury and damage to your boat and to the trolling motor.

NOTICE

When drilling or cutting, always check what is on the opposite side of the surface to avoid damaging the vessel.

Tools and Supplies Needed

- Drill and a $\frac{5}{16}$ in. (8 mm) drill bit
- #1 Phillips screwdriver
- #2 Phillips screwdriver
- 3 mm and 4 mm hex bits or wrenches (two 4 mm recommended)
- $\frac{9}{16}$ in. (14 mm) socket
- Torque wrench
- Circuit breaker rated for continuous 60 A
- Trolling motor plug and receptacle rated for 60 A or greater (optional)
- 6, 4, or 2 AWG (16, 25, or 35 mm²) wire for extended runs of the power cable
- Solder and heat-shrink tubing, if extending the power cable
- Stainless steel pan head $\frac{1}{4}$ -20 (M6x1) bolts (if the included bolts are not long enough to mount the motor to the deck)



Installation Preparation

Device Overview

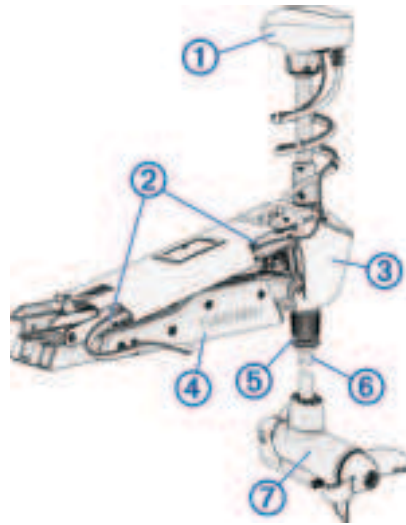

①	Shaft cap
②	Power and transducer cables
③	Steering system
④	Mount
⑤	Depth-adjustment collar
⑥	Shaft
⑦	Propeller drive motor

Mounting Considerations

⚠ CAUTION

You must install the motor in a location where no large metallic objects, such as a tool box, are near the display panel when it is deployed. Large metallic objects can interfere with the magnetic compass, affecting the built-in autopilot performance and potentially leading to personal injury or property damage.

When selecting a mounting location, observe these considerations.

- You must install the motor on the bow of your boat.
- You should install the mount so the deployed motor is as close to the centerline of the boat ① as possible.

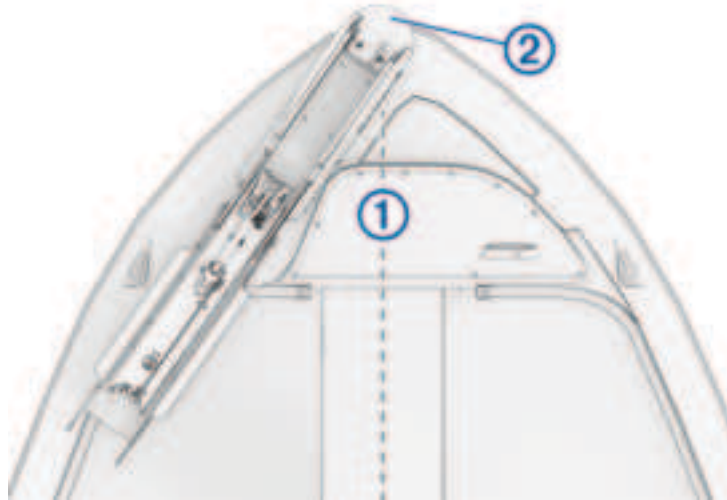

- You must install the mount with the bumper ② overhanging the gunwale of the boat.
- The motor secures to the deck of the boat using bolts, so you must have room to secure the mount from the underside using washers and nuts.
- The motor must have clearance to move from the deployed to the stowed position and back again, so the installation location must be clear of obstacles.
- Verify that the deck is strong enough for the weight and force of the trolling motor. Use a backing plate or reinforce the boat if needed.

Parts Bags

The installation hardware for the trolling motor is included in labeled bags. As you complete the installation process, each procedure begins with a reference to the label on the parts bag needed to complete the procedure. You can use this table to review or verify the parts bags needed for the installation procedures.

Ⓐ	Contains the safety strap and the hardware used to secure the mount base to the boat deck.
Ⓑ	Contains the pin needed to secure the steering system to the lower half of the mount.
Ⓒ	Contains the hardware needed to secure the upper and lower gas springs.
Ⓓ	Contains the pin needed to secure the steering system to the upper half of the mount.
Ⓔ	Contains the pull-cable handle hardware.
Ⓕ	Contains the hardware needed to secure the cables to the mount.

Connection Considerations

When making the wiring connections, observe the following considerations.

- You must connect the trolling motor to a 24 or 36 Vdc battery bank capable of supplying 60 A continuously.
- You must connect to the power source through a circuit breaker rated for continuous 60 A (not included).
- If necessary, you can extend the power cable using the appropriate wire gauge based on the length of the extension (*Power Cable Extensions*, page 16).
- For convenience, you can install a trolling motor plug and receptacle rated for 60 A or greater (not included) in the bulkhead to make it easier to disconnect the motor from the power source.

Installation Procedures

NOTICE

When assembling the motor, you must use hand tools to install all of the parts, observing the torque specifications when provided. Using power tools to assemble the motor may damage the components, and voids the warranty.

Installing the Mount on the Deck

Label identifying the parts bag required for this procedure:

Ⓐ

NOTE: If the supplied bolts are not long enough for the mounting surface, you must obtain the appropriate length stainless steel pan head $\frac{1}{4}$ -20 (M6x1) bolts.

- 1 Select a mounting location on the bow of your boat, according to the mounting considerations.
- 2 Pivot the top parts of the mount up and back so you can access the mounting holes on the mount base.
- 3 Place the included mounting template on the mounting location with the mount bumper on the template ① overhanging the gunwale or the edge of the boat deck.

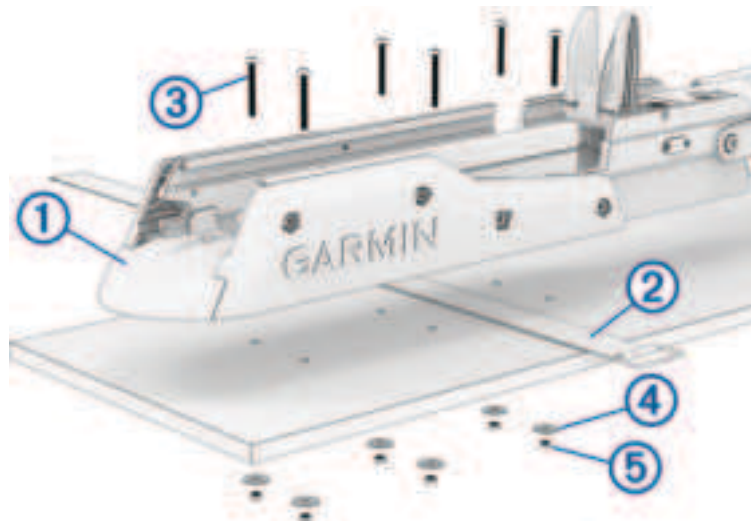

NOTE: There are two mounting hole options on the port side of the bow end of the base. You can choose which mounting hole to use depending on the installation angle and the shape of the hull.

- 4 Mark the mounting hole locations on the boat deck.
- 5 Using a $\frac{5}{16}$ in. (8 mm) drill bit, drill the mounting holes.
- 6 Place the safety strap ② under the mount base near the center, with the hook and loop fasteners facing downward.

NOTE: You must place the safety strap under the mount before you secure it to the surface. If you do not install the safety strap at this time, you may need to partially disassemble the motor later to install it correctly.

- 7 Place the mount base on the boat deck on top of the safety strap, aligning the holes on the mount with the mounting holes.
- 8 Secure the mount to the deck using the included bolts ③, washers ④, and locking nuts ⑤.
- 9 Tighten the nuts to 10.85 N m (8 lbf-ft.).

Installing the Steering Servo on the Lower Link of the Mount

Label identifying the parts bag required for this procedure:

Ⓑ

- 1 Pivot the lower link of the mount forward until it locks into the base.

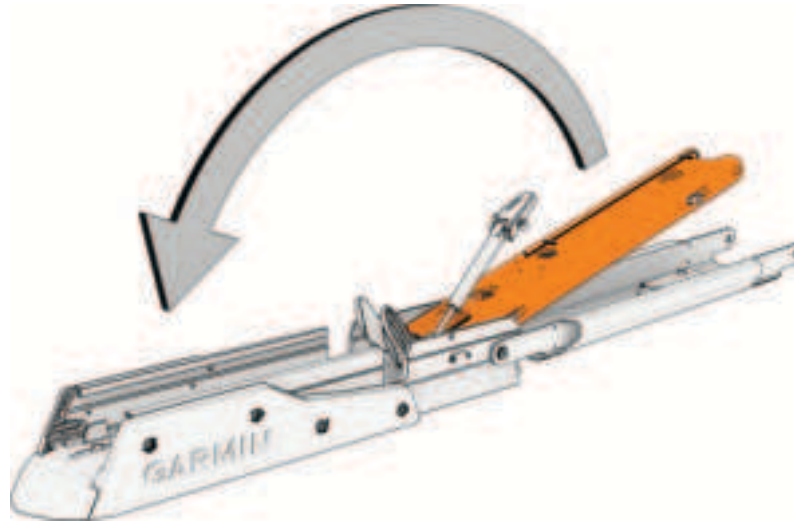

- 2 Push the two safety rods ① into the lower link as far as possible.

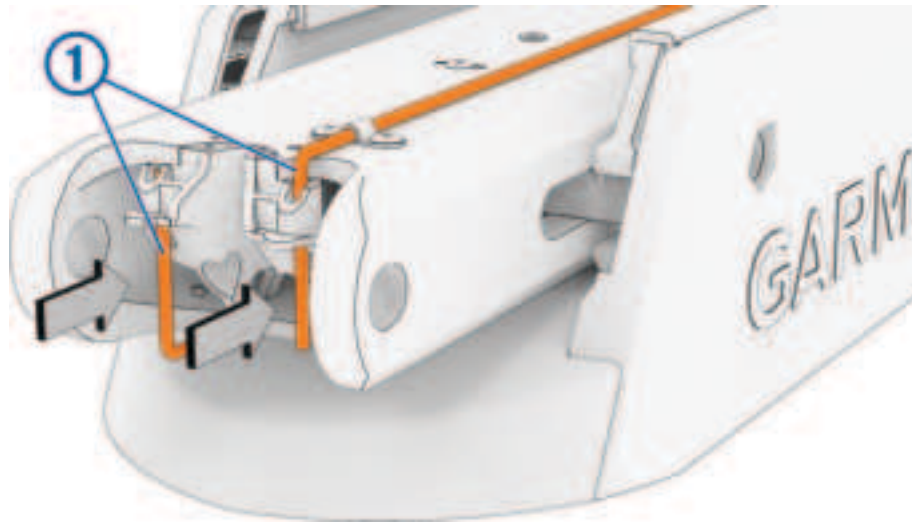

- 3 Make sure that the bushings ② are installed in the lower holes ③ on the steering servo housing.

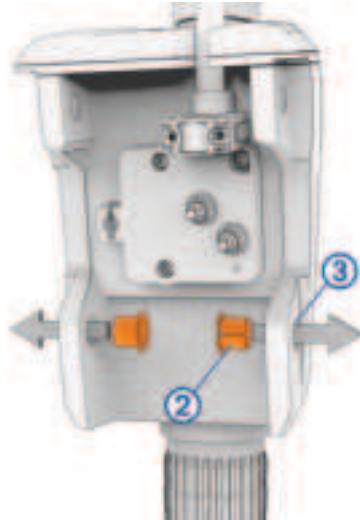

If the bushings were removed, you can re-insert them from the inside out.

- 4 Holding the pull cable ④ up, place the steering servo housing onto the lower link of the mount, aligning the lower holes on the housing with the holes on the link.

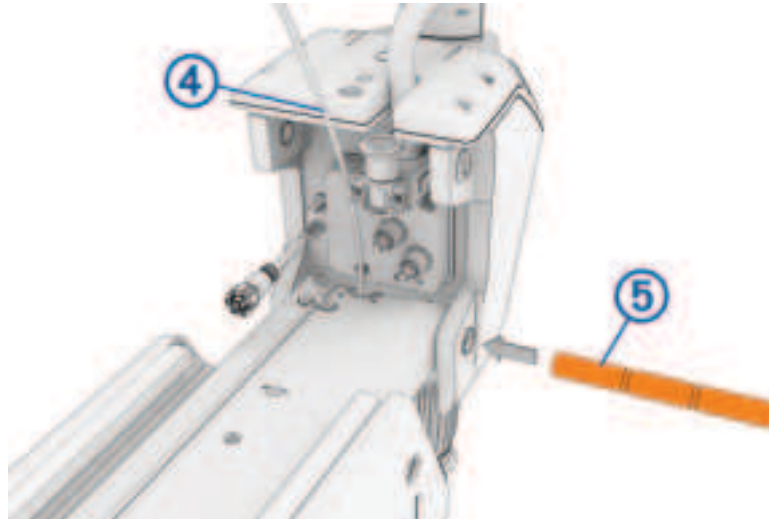

- 5 While lifting up on the steering servo housing, push the pivot pin ⑤ through the housing and the link to hold it in place.

NOTICE

Do not hit the pin with a hammer or other object. Do not drill or modify the holes. Although it is a snug fit, the pin slides in completely when pushed by hand. Damage caused by hammering the pin or modifying the holes is not covered under warranty.

- 6 Route the pull cable upward through the top of the steering servo housing ⑥.

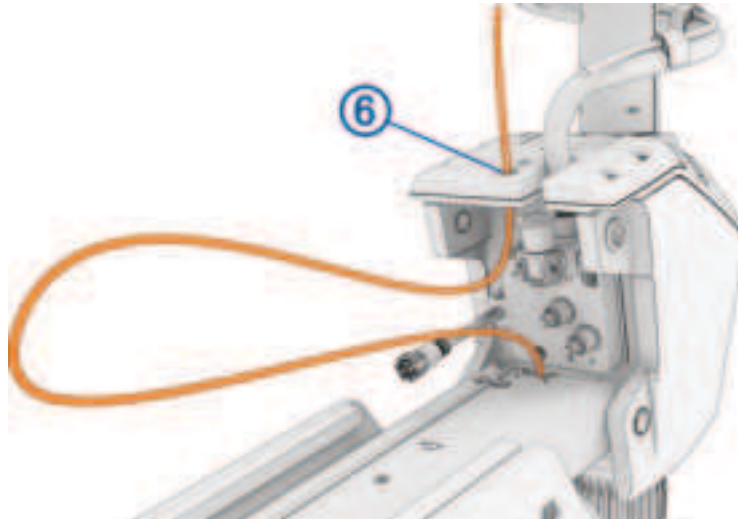

Securing the Upper Gas Spring

Label identifying the parts bag required for this procedure:

Ⓒ

- 1 Push the safety rod ① toward the steering servo housing as far as possible to lock the lower pivot pin in place.

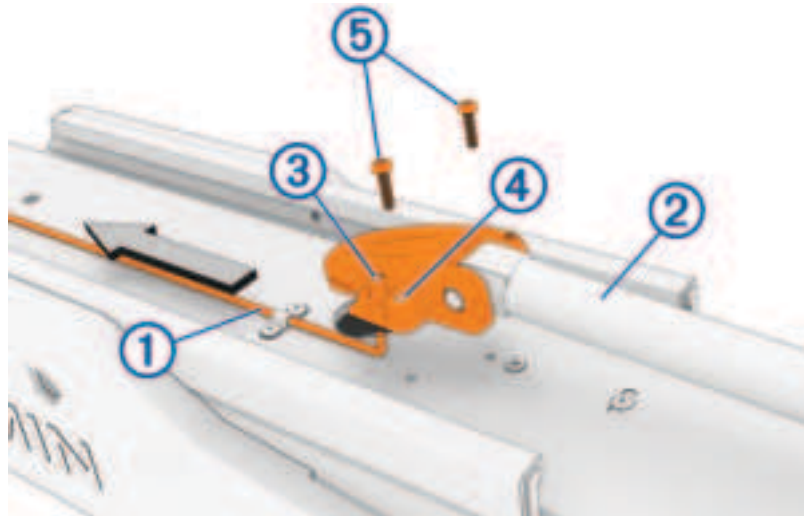

- 2 If necessary, pivot the upper gas spring ② toward the lower link of the mount so the base of the gas spring aligns with the safety rod and mounting holes.

⚠ CAUTION

If you must rotate the gas spring so the base aligns with the mount, rotate the spring in a clockwise direction only. Rotating the gas spring in a counter-clockwise direction may loosen the fittings, potentially leading to a premature failure of the gas spring, which could lead to personal injury or property damage while stowing or deploying the motor.

- 3 Align the single hole on the base of the gas spring ③ with the safety rod, and press down.
The screw holes on the base ④ should align with the holes on the bottom of the mount.
 - 4 Using a #2 Phillips screwdriver, secure the base of the gas spring to the lower link of the mount using the included screws ⑤.
- Keep the remaining screws in the parts bag. You must use them when securing the other gas spring in a later procedure.

Connecting the Upper Link of the Mount to the Steering Servo Housing

Label identifying the parts bag required for this procedure:

ⓓ

- 1 Remove the tape that secures the data cable ① to the steering servo housing.
- 2 Make sure that the bushings ② are installed in the upper holes on the steering servo housing.

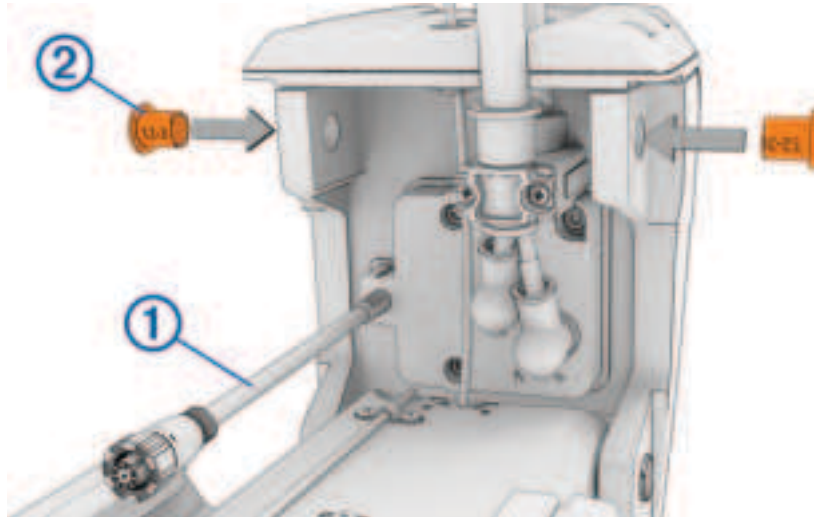

If the bushings were removed, you can re-insert them from the outside in.

- 3 Pivot the upper link of the mount forward.

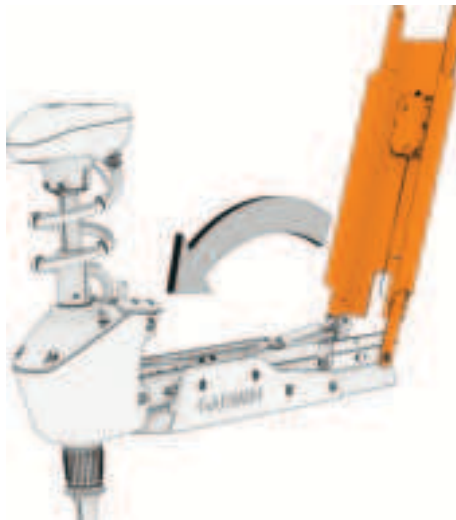

- 4 Tip the top of the steering servo housing inward so the holes on the upper link and the housing align.

- 5 Push the pin ③ through the holes on the upper link of the mount and the steering servo housing.



- 6 Using a 4 mm hex bit or hex wrench, secure the pin using the screws and washers ④ on both sides.

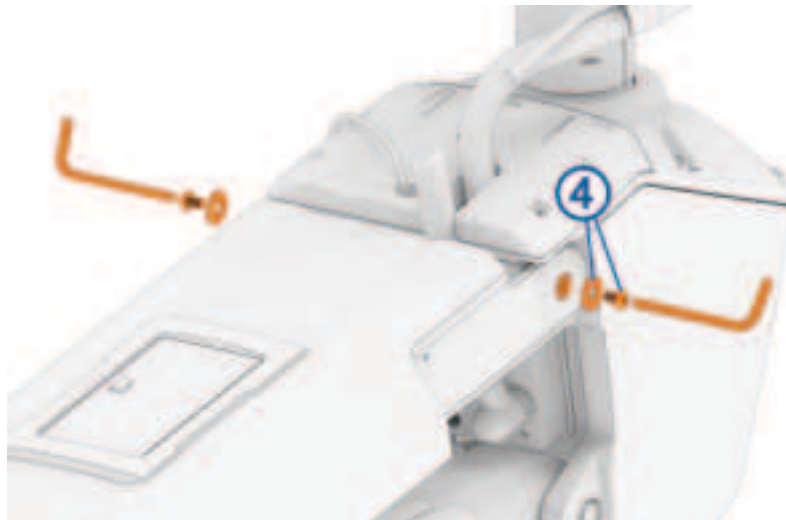

NOTE: To properly secure the pin, you should use two hex bits or wrenches so the pin does not rotate as you tighten the screws.

Connecting the Motor to the Display Panel

NOTICE

You must connect the cable from the steering servo to the display panel before proceeding further with the installation. If you do not make this connection now, the unsecured cable may damage the display panel when moving the mount.

- 1 Route the cable ① from the steering servo housing to the display panel ② on the upper link of the mount.



- 2 Push the connector onto the port on the display panel, and rotate the locking ring clockwise to secure it.
NOTE: The connector is keyed to fit into the port one way only, and will fit easily when aligned correctly. Do not force the connector into the port.

Installing the Handle on the Pull Cable

Label identifying the parts bag required for this procedure:

Ⓔ

⚠ CAUTION

You must install the included R-pin in the handle. Using an inadequate R-pin in the handle may cause a failure of the handle potentially leading to personal injury.

1 Insert the pull cable through the handle.

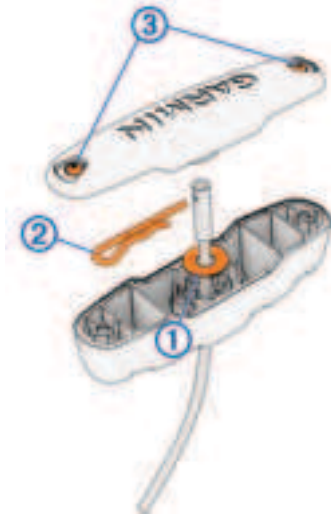

2 Insert the pull cable through the washer (1).

3 Push the R-pin (2) through the hole on the end of the pull cable.

4 Pull the cable down so that the washer and R-pin rest fully in the handle.

NOTE: If the washer and the R-pin are not fully seated in the handle, you will not be able to install the handle cover.

5 Place the handle cover on the handle and, using a #1 Phillips screwdriver, tighten the screws (3).

Routing the Power and Transducer Cables Through the Mount

Label identifying the parts bag required for this procedure:

Ⓕ

NOTICE

To avoid damaging the power and transducer cables when deploying and stowing the trolling motor and to avoid interference with the GPS and heading sensors in the motor, you must route the cables through the right (starboard) side of the mount and secure them using the included hardware. You must not route the power cable through the left (port) side of the mount, and it is not possible to install the included brackets on the left (port) side. The left (port) side is reserved for additional accessories or transducer cables that you may install in the future.

- 1 Measure approximately 40 cm (16 in.) on the power cable from where it connects to the steering servo housing, and look for the mark on the cable applied at the factory.

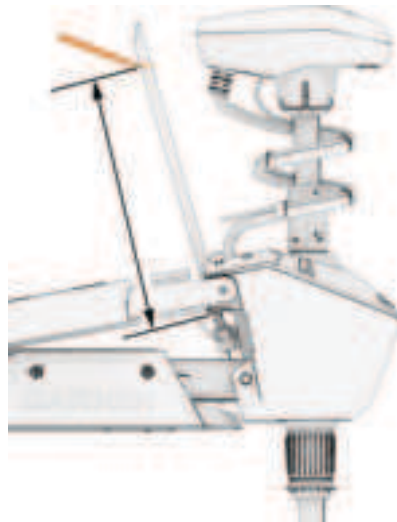

- 2 If you do not see a mark on the cable, or if the mark is not approximately 40 cm (16 in.) from the connection, make a mark with a marker or tape.
- 3 With the motor in the deployed position, route the transducer cable through the channel along the right (starboard) side of the mount ①.



TIP: To determine the right (starboard) side of the mount, stand in a location where you can read the information on the display panel.

- 4 Route the power cable through the channel above the transducer cable.

- Using the pull cable, carefully lift the motor from the deployed position to the stowed position.

⚠ CAUTION

Because only one of the lift-assist gas springs is secured at this point in the installation, you must use caution when lifting the motor to the stowed position. The weight of the motor may cause the mount to move quickly and pinch or crush hands or fingers.

NOTICE

You must secure the cables to the mount with the motor in the stowed position. If you complete this procedure with the motor in the deployed position, the cables are not at their fully extended length, and the added stress may damage the cables during use.

- Leaving a rounded bend in the cables ②, hold them against the side of the mount where they enter the channel.

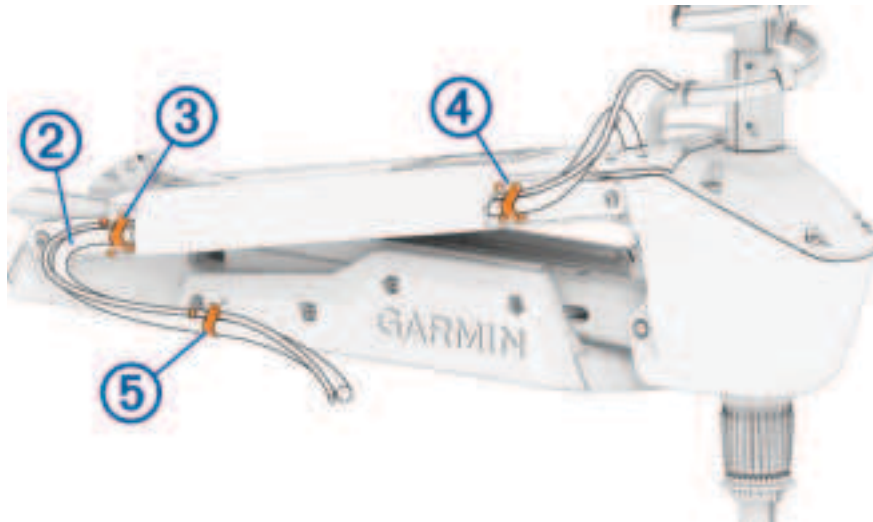

- At the marked location on the power cable, place one of the brackets ③ that have two screw holes over the cables and against the mount, aligning the holes on the bracket with the holes on the mount.
- Using a 3 mm hex bit or wrench, secure the bracket to the mount using two screws.
- Hold the cables against the bottom of the mount where they exit the channel.
- Place the other bracket ④ that has two screw holes over the cables and against the mount, aligning the holes on the bracket with the holes on the mount.
- Using a 3 mm hex bit or wrench, secure the bracket to the mount using two screws.
- Hold the cables against the plastic portion of the mount base, close to the boat deck.
- Insert the lower tab on the remaining bracket into a slot below the cables ⑤, and rotate the bracket toward the mount base to hold the cables.
- Using a #1 Phillips screwdriver, secure the upper tab of the bracket to the mount base using a single screw.
- Install additional plastic cable clips to secure the transducer cable to the power cable where needed (optional).

Securing the Lower Gas Spring

Label identifying the parts bag required for this procedure:

Ⓒ

NOTE: This procedure uses the rest of the hardware in the parts bag that you used when installing the upper gas spring.

- 1 If necessary, transition the trolling motor from the deployed to the stowed position.
If the gas spring is positioned on the other side of the mount after you stowed the motor, you may need to lift up the mount and flip over the gas spring so you can secure it to the mount.
- 2 Align the hole on the base of the lower gas spring ① with the safety rod ②, and press down.

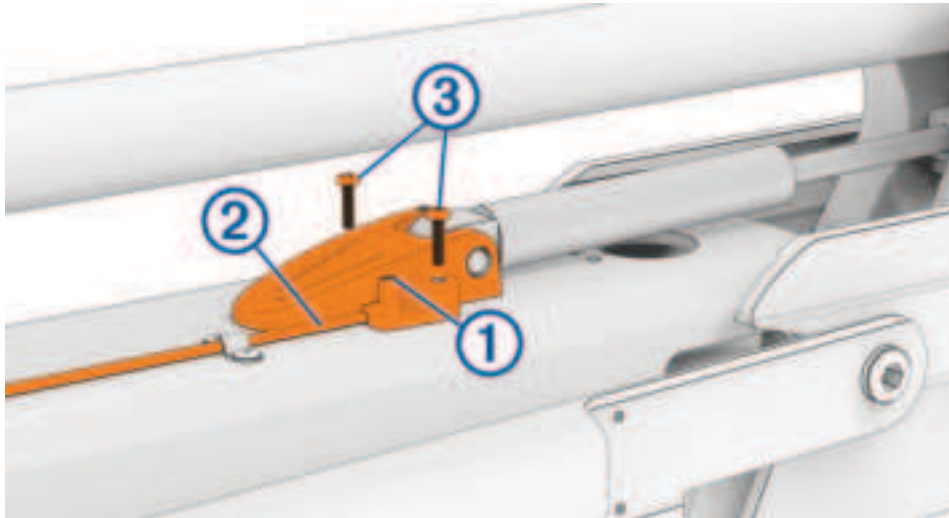

⚠ CAUTION

If you must rotate the gas spring so the base aligns with the mount, rotate the spring in a clockwise direction only. Rotating the gas spring in a counter-clockwise direction may loosen the fittings, potentially leading to a premature failure of the gas spring, which could lead to personal injury or property damage while stowing or deploying the motor.

- 3 Using a #2 Phillips screwdriver, secure the base of the lower gas spring to the mount using the included screws ③.

Installing the Propeller

The parts bag containing the hardware needed for this procedure is included in the box with the high efficiency propeller and does not have a label.

This product is packaged with a high efficiency propeller and a weedless propeller. You should choose the propeller that best suits your fishing. The high efficiency propeller is quieter and provides more thrust. The weedless propeller is designed to help prevent weeds from wrapping around the propeller and the shaft.

- 1 Insert the pin ① through the propeller motor shaft.

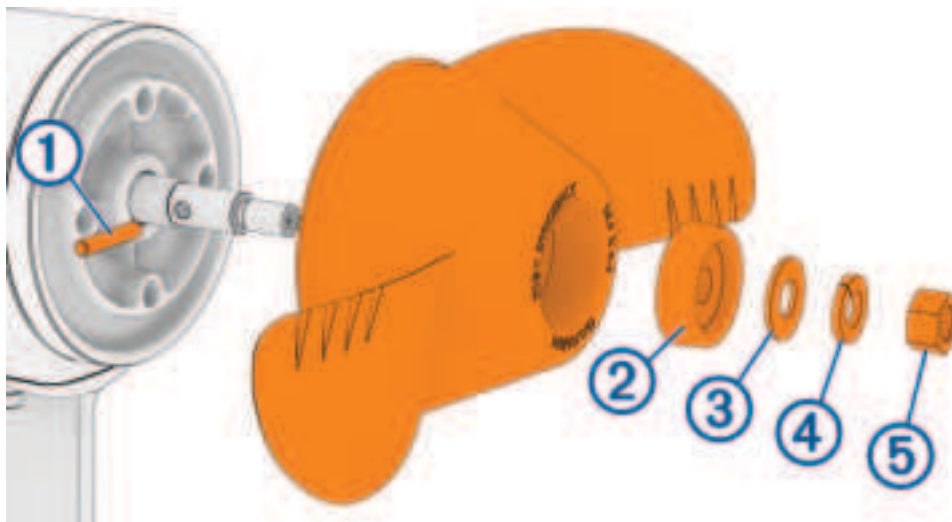

- 2 If necessary, rotate the motor shaft to orient the pin horizontally so it is less likely to fall out during installation.
- 3 Align the channel on the inside of the propeller with the pin, and slide the propeller onto the motor shaft.
- 4 Place the anode ②, washer ③, lock washer ④, and nut ⑤ onto the end of the motor shaft.
- 5 Using a $\frac{9}{16}$ in. (14 mm) socket, tighten the lock nut to 16.27 N-m (12 lbf-ft) to secure the propeller.

Connecting to Power

⚠ WARNING

To avoid possible serious personal injury or property damage, the circuit breaker must be in the off position before you connect the power cables from the trolling motor.

- 1 Route the power cable to the breaker panel or the location where you plan to install the breaker.
- 2 If necessary, extend the power cable using the appropriate wire gauge based on the length of the extension (*Power Cable Extensions, page 16*) using solder and heat-shrink tubing.
- 3 Install a trolling motor plug and receptacle rated for 60 A or greater where the power cable enters a bulkhead (optional).
- 4 Connect the power cable to a circuit breaker rated for 60 A (continuous).
- 5 If necessary, connect the circuit breaker to a 60 A, 24 or 36 Vdc power source.

Power Cable Extensions

⚠ CAUTION

You must follow these requirements when extending the power cables for this product. Improperly extended power cables will cause excess electrical current, potentially leading to personal injury or property damage.

- You must use single-conductor stranded wire with insulation rated for at least 75°C (167°F) that is not bundled, not sheathed, and not run through conduit.
NOTE: If you are using wire with insulation rated for at least 105°C (221°F), and it is run outside of engine spaces, you can bundle up to three wires inside a sheath or conduit.
- When installing the extension, you must follow all industry standards and best practices.
- You must use the appropriate wire gauge based on the length of the extension.

Extension length	Minimum wire gauge	Optimal wire gauge
0 to 3 m (0 to 10 ft.)	6 AWG (16 mm ²)	6 AWG (16 mm ²)
3 to 4.6 m (10 to 20 ft.)	6 AWG (16 mm ²)	4 AWG (25 mm ²)
4.6 to 9.1 m (20 to 30 ft.)	6 AWG (16 mm ²)	2 AWG (35 mm ²)

Connecting the Transducer to a Chartplotter

The built-in 12-pin transducer is compatible with select Garmin® chartplotter models. Go to garmin.com or contact your Garmin dealer for more information.

- 1 Route the transducer cable to the installed chartplotter.
- 2 Install the locking collar on the end of the transducer cable.
- 3 Connect the transducer cable to the transducer port on the back of the chartplotter.
You can refer to the instructions provided with your chartplotter to identify the transducer port.

Securing the Safety Strap

⚠ CAUTION

You must always secure the safety strap after stowing the trolling motor to prevent the motor from deploying unexpectedly. An unexpected deployment of the motor may lead to personal injury and damage to your boat and to the trolling motor.

The safety strap holds the motor securely to the base in the stowed position and prevents unintended deployment.

- 1 With the motor in the stowed position, lift the long end of the strap ① over the top of the motor.

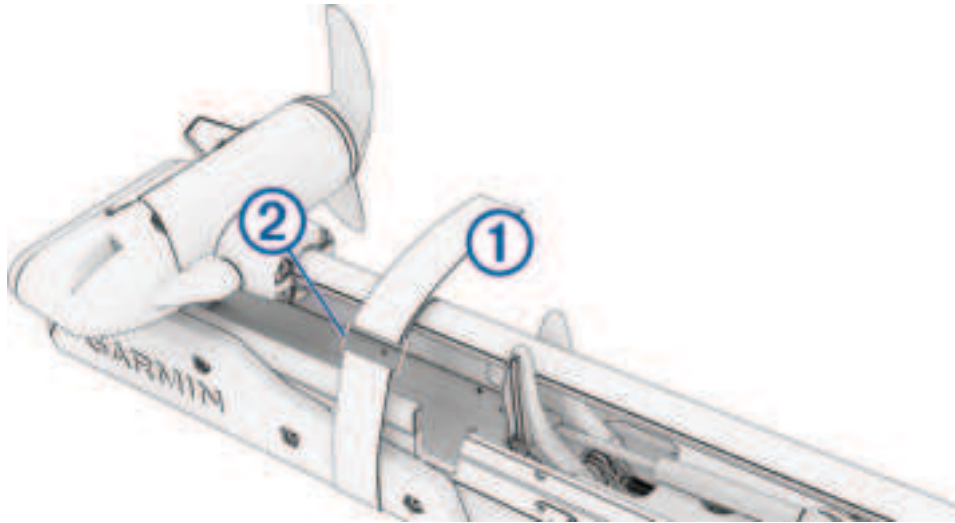

- 2 Feed the end of the strap through the buckle ② on the other end of the strap.
- 3 Pull the strap through the buckle until it holds the motor securely to the mount.
- 4 Pull the strap away from the buckle, and push down to fasten it to the other side of the strap.

Stabilizer Installation

The stabilizer is an optional accessory that can provide additional support for the trolling motor when it is in the stowed position.

NOTICE

You must install the stabilizer to reduce the risk of damage to the trolling motor mount and to the vessel while driving in rough conditions or trailering.

Installation instructions for the stabilizer are provided in the stabilizer box.

Foot Pedal Installation

The foot pedal connects to the trolling motor wirelessly and is paired at the factory.

Detailed mounting and power instructions are included in the foot pedal box. Operation instructions are included in the *Force Pro Trolling Motor Quick Start Manual*.

Remote Control Installation

The remote control connects to the trolling motor wirelessly and is paired at the factory.

Operation instructions are included in the *Force Pro Trolling Motor Quick Start Manual*.

Maintenance Needs and Schedule

NOTICE

After using the motor in salt water or brackish water, you must rinse off the entire motor with fresh water, and apply a water-based silicone spray using a soft cloth. You must avoid spraying jets of water at the shaft cap, to prevent water ingress that could lead to product damage.

To maintain your warranty, you must perform a series of routine maintenance tasks as you prepare your motor for the season. If you use or transport the motor in dry, dusty environments (traveling on gravel roads, for example) you should perform these tasks more often during the season.

For detailed procedures and information on service and replacement parts, download the *Force Pro Trolling Motor Maintenance Manual* from garmin.com/manuals/force_pro_trolling_motor.

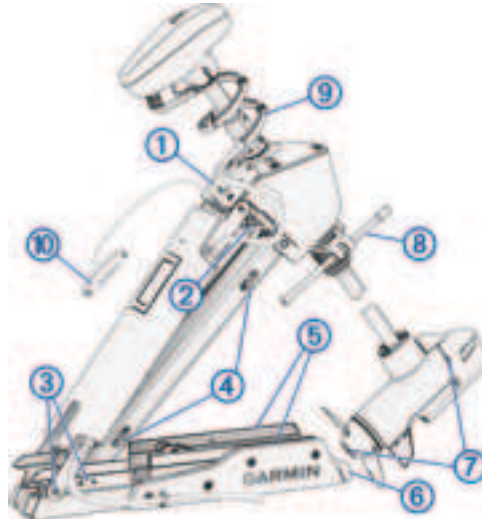

- Examine the power cable ① for wear, and replace it if necessary .
- Check and clean the power terminals and tighten the nuts ②, if necessary .
- Lubricate the hinges and bushings ③.
- Clean and lubricate the stow and deploy latch mechanism ④.
- Check the mount rails ⑤, and replace them if necessary .
- Check the mount bumper ⑥, and replace it if necessary .
- Clean or replace the anodes in the propeller drive motor ⑦.
- If installed, check the rubber stops on the ends of the stabilizer ⑧ for wear and replace them as necessary.
- Examine the coil cable ⑨ for wear, and replace it if necessary.
- Examine the pull-cable and handle ⑩ for wear, and replace it if necessary.

Motor Information

Stowed Dimensions

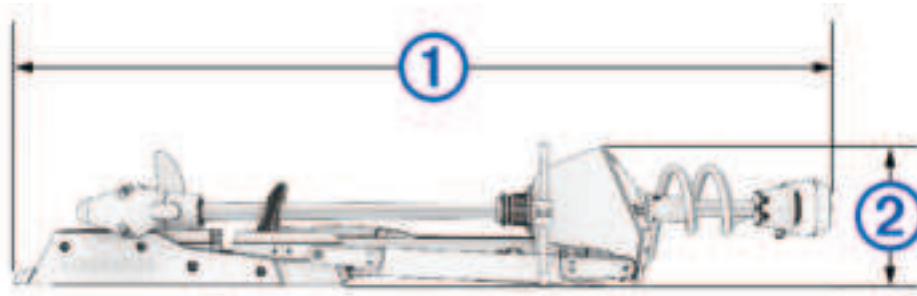

Item	50 in. Model	57 in. Model
①	1575 mm (62.00 in.) min. 1825 mm (71.85 in.) max.	1750 mm (68.90 in.) min. 2090 mm (82.28 in.) max.
②	330 mm (12.99 in.)	345 mm (13.58 in.)

Deployed Dimensions

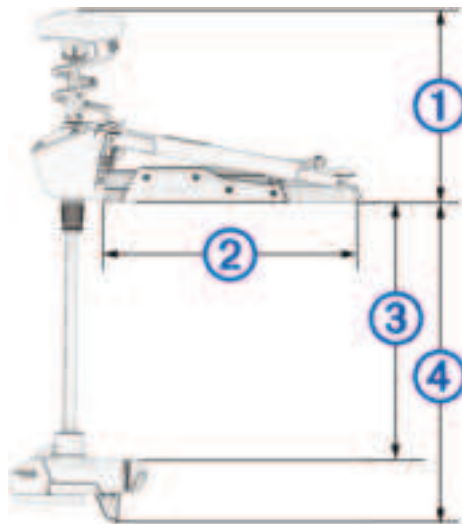

Item	50 in. Model	57 in. Model
①	496 mm (19.52 in.) min. 746 mm (29.37 in.) max.	496 mm (19.52 in.) min. 833 mm (32.80 in.) max.
②	708 mm (27.87 in.)	799 mm (31.46 in.)
③	644 mm (25.35 in.) min. 895 mm (35.24 in.) max.	730 mm (28.74 in.) min. 1065 mm (41.93 in.) max.
④	835 mm (32.87 in.) min. 1080 mm (42.52 in.) max.	930 mm (36.61 in.) min. 1259 mm (49.57 in.) max.

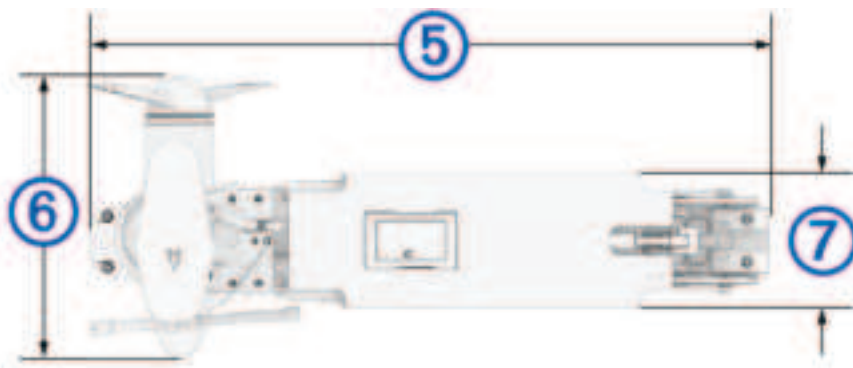

Item	50 in. Model	57 in. Model
⑤	931 mm (36.65 in.)	1021 mm (40.20 in.)
⑥	421 mm (16.57 in.)	421 mm (16.57 in.)
⑦	203 mm (7.99 in.)	203 mm (7.99 in.)

Contacting Garmin Support

- Go to support.garmin.com for help and information, such as product manuals, frequently asked questions, videos, and customer support.
- In the USA, call 913-397-8200 or 1-800-800-1020.
- In the UK, call 0808 238 0000.
- In Europe, call +44 (0) 870 850 1241.

Specifications

Trolling Motor

Weight (motor, mount, and cables)	50 in. model: 30.25 kg (66.7 lb.) 57 in. model: 32.06 kg (70.7 lb.)
Weight (stabilizer)	0.54 kg (1.2 lb.)
Operating temperature	From -5° to 40°C (from 32° to 104°F)
Storage temperature	From -40° to 85°C (-40° to 185°F)
Material	Mount and motor housing: aluminum Shaft cap, display panel, and side panels: plastic Motor shaft: fiberglass
Water rating	Shaft cap: IEC 60529 IPX5 ¹ Steering motor housing: IEC 60529 IPX7 ² Display panel housing: IEC 60529 IPX7 Propeller drive motor housing: IEC 60529 IPX8 ³
Compass safe distance	91 cm (3 ft.)
Power cable length	50 in. model: 1.2 m (4 ft.) 57 in. model: 1.1 m (3.5 ft.)
Input voltage	From 20 to 45 Vdc
Input amperage	60 A continuous
Breaker (not included)	42 VDC or greater, suitable for 60 A continuous NOTE: You can protect the system by using a larger circuit breaker, not to exceed 90 A, if you are operating under high temperatures or if you are sharing the circuit with other devices. You should verify that your boat wiring meets marine wiring standards using a larger breaker before changing it.
Main power usage at 36 Vdc 60 A	Off: 72 mW Full power: 2160 W
Radio frequency	Bluetooth®: 2.4 GHz @ 20 dBm maximum Wi-Fi®: 802.11 b/g/n @ 20 mhz

¹ The part withstands projected water exposure from any direction (such as rain).

² The part withstands incidental immersion in water up to 1 m deep for up to 30 min.

³ The part withstands continuous immersion in water up to 3 m deep.

Remote Control

Dimensions (W×H×D)	152 x 52 x 32 mm (6 x 2 x 1 ¹ / ₄ in.)
Weight	109 g (3.8 oz.) without batteries
Material	Glass-filled nylon
Display type	Sunlight-visible, transfective memory-in-pixel (MIP)
Display resolution	R240 x 240 pixels
Display size (diameter)	30.2 mm (1 ³ / ₁₆ in.)
Operating temperature	From -15° to 55°C (5° to 131°F)
Storage temperature	From -40° to 85°C (-40° to 185°F)
Battery type	2 AA (not included)
Battery life	240 hr., typical use
Radio frequency	2.4 GHz @ 10.0 dBm nominal
Water rating	IEC 60529 IPX7 ⁴
Compass-safe distance	15 cm (6 in.)

联系信息

制造厂商：台湾国际航电股份有限公司

销售厂商：上海佳明航电企业管理有限公司

联络地址：上海市徐汇区桂平路 391 号（新漕河泾国际商务中心 A 座 37 层）

电话：021-60737675

客服专线：400-819-1899

⁴ Withstands incidental exposure of water up to 1 m for up to 30 min.

物質宣言

部件名称	有毒有害物质或元素									
	铅	汞	镉	六价铬	多溴联苯	多溴二苯醚	邻苯二甲酸二(2-乙基己)酯	邻苯二甲酸丁苄酯	邻苯二甲酸二丁酯	邻苯二甲酸二异丁酯
印刷电路板组件	✗	○	○	○	○	○	○	○	○	○
金属零件	✗	○	○	○	○	○	○	○	○	○
电缆 电缆组件 连接器	✗	○	○	○	○	○	○	○	○	○
塑料和橡胶零件	○	○	○	○	○	○	○	○	○	○

本表格依据 SJ/T11364 的规定编制。

○: 代表此种部件的所有均质材料中所含的该种有害物质均低于 (GB/T26572) 规定的限量

✗: 代表此种部件所用的均质材料中, 至少有一类材料其所含的有害物质高于 (GB/T26572) 规定的限量

* 该产品说明书应提供在环保使用期限和特殊标记的部分详细讲解产品的担保使用条件。



产品

NBTC SDoC



© 2024 Garmin Ltd. or its subsidiaries

Garmin®, the Garmin logo, ActiveCaptain®, and Force® are trademarks of Garmin Ltd. or its subsidiaries, registered in the USA and other countries. These trademarks may not be used without the express permission of Garmin.

You should reference United States Code of Federal Regulations: 33 CFR 183 - Boats and Associated Equipment and ABYC E-11: AC and DC Electrical Systems on Boats when installing this trolling motor.

拖釣推進器 M/N: A04968 (57") / B04968 (50")

遙控器 M/N: AA03474

脚踏板控制器 M/N: A03473

