

Installation Guide

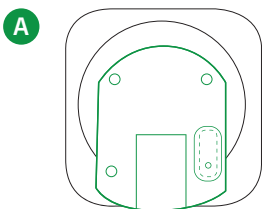

Remove Easy-fix mounting support back part.

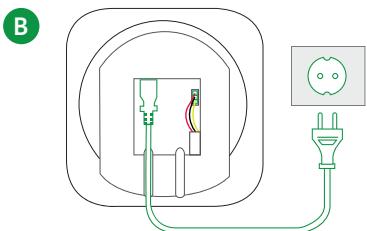

Connect the power to the Control Unit, using the power supplied.
Connect the battery through the appropriate connector. Alternatively you can power the Central using a 12 V DC source through the supplied terminal block.

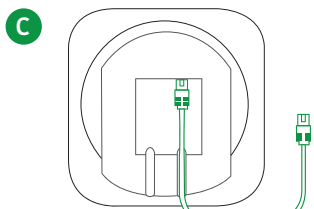

Connect the Ethernet cable to a router or internet outlet. The initial configuration of the operating parameters requires the use of an Ethernet connection with internet access.

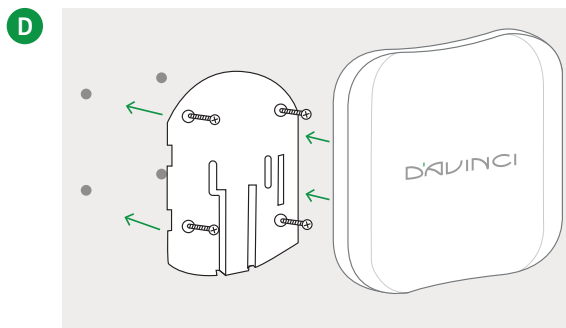

Fix the support to the wall using the supplied screws. Fix the control unit on the support and tighten the locking screws.

Control panel configuration via App D'AVINCI

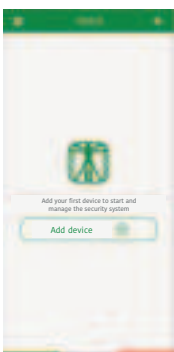

Run the app and add Lisa Control Panel.

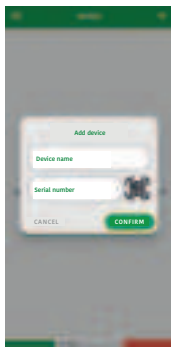

Scan the QR code present on the Control Panel, Insert the name of Control Panel (e.g.: Office, Home, etc..).

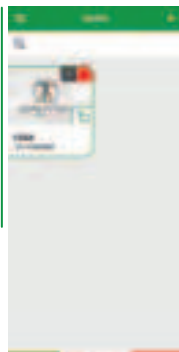

Verify that the device is been added correctly. Subsequently add rooms and proceed with the parameter configuration. In case of addition of additional devices to the control panel, follow the guide to the device to be associated.



download from
Google Play



download from
App Store

Install the **D'AVINCI application** on your smartphone (iOS / Android). As soon as you start the App, follow the procedure to register your account (email entry, number telephone) and wait for the request from the Cloud D'AVINCI. Connect to your e-mail and validate the registration using the code you received. Access the app to verify that the transaction has been successful.

Signal Management

The LED of the Control Panel characterizes the state of the system or the events that occur.
The D'AVINCI logo on the front of the Central can light up in red, white, green depending by control panel status.

INDICATION	EVENT
The three D'AVINCI logo LEDs lit in fixed mode in the sequence green - white - red	Regular state and implant not armed
The full D'AVINCI logo in fixed red mode	System status armed
The full D'AVINCI logo in fixed blue mode	System status armed in Stay mode
LED left green off	Control unit not connected to the D'AVINCI Cloud
Flashing green LED on the left	Central connected to the D'AVINCI Cloud
LED and on the left green on in steady mode	Regular connection to the D'AVINCI Cloud
White LED(in central position) flashing	LTE module fault(Sim not inserted, network search)
White LED(in central position) in fixed mode	Regular cellular connection (regular LTE module)
Yellow LED(in central position) in fixed mode	Connection to the Cloud through the Carrier backup, LTE module
Flashing red LED on the right	Radio fault associated devices
Red LED on the right in fixed mode	Regular status of associated devices
Green LED when the control unit is turned on	The control unit looks for the connection with the cloud and after that all three tricolour LEDs light up
Short flashing, every three seconds, of the green, white and red led	System disarmed with AC loss
Short flashing, every three seconds, of all the red LEDs	System armed with AC loss
Short flashing, every three seconds, of all the blue LEDs	System armed in Stay mode with AC loss

Technical specifications

Type	Wireless central unit 868 Mhz/WiFi +Ethernet module and 4G LTE communicator	Operating frequencies	868.20 Mhz, 868.95 Mhz
Power supply	230 V AC / 12 V DC Built-in backup battery: Li-Ion 3000 mAh	Communication channels	Ethernet; WiFi(802.11b/g/n); 4G LTE; 2G Voce
Radio range	Up to 2000 meters in open space	Sim card supported	Micro SIM
Manageable wireless devices	Up to 200	Installation	Indoor
Sirens	Max 6	Protection class	IP40
Users allowed	Max 200	Operating temperatures	From -10°C a +40°C
Rooms	Max 30	Maximum allowable humidity	Up to 75%
Repeaters	Max 5	Dimensions	170X165X50
Encryption	Proprietary protocol based on AES	Weight	150 grams
Anti-sabotage protection	- Antijammer - Anti-tampering (anti-tear) and anti-opening tamper		
Radio communication protocol	GENIO		