

CONGRATULATIONS!

You've received the best furniture for your pet.

**FOR
ASSEMBLY
YOU WILL
NEED:**



CHECK YOUR SET

1 pcs

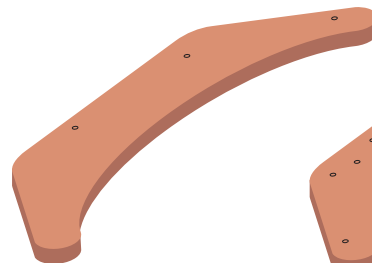

1 pcs

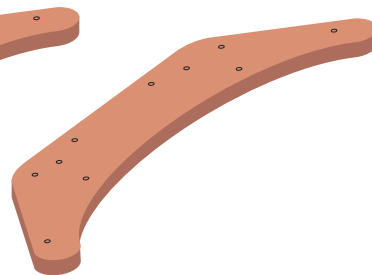

2 pcs

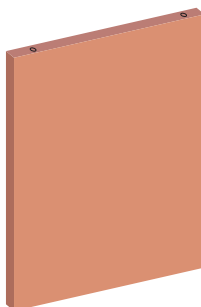

1 pcs



SCREWDRIVER OR HAMMER DRILL

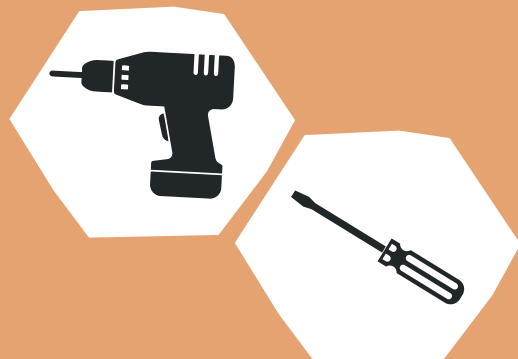

SCREWS AND DOWELS

Included to the package.

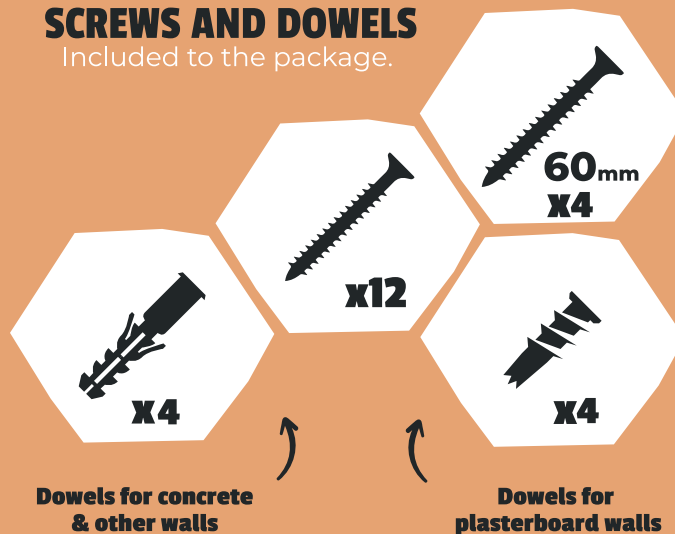

CAT WOODEN BED

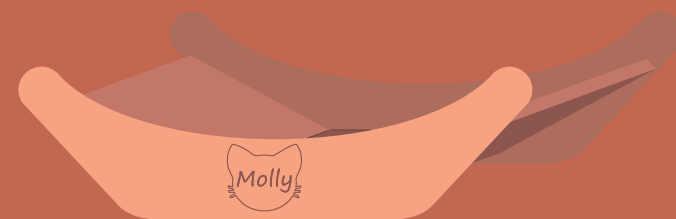

cats
MODE

1

Get yourself comfortable and prepare all of the tools needed for assembling.

2

Drill three pieces into the front panel.

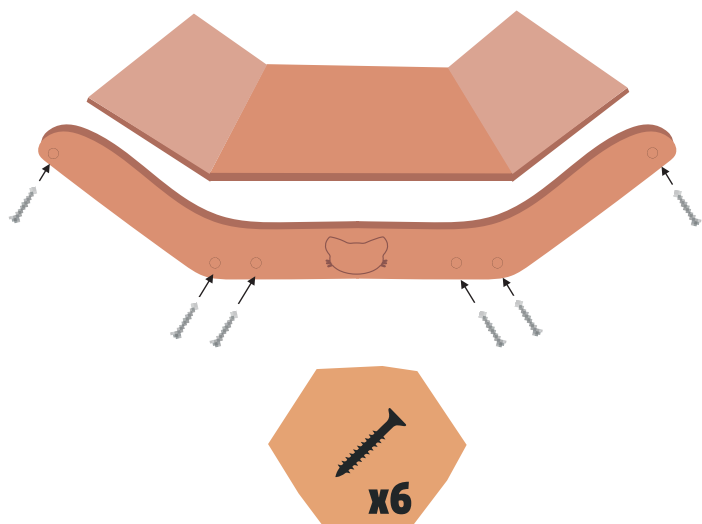

3

Complete assembly by screwing the other side to the cat bed as shown.

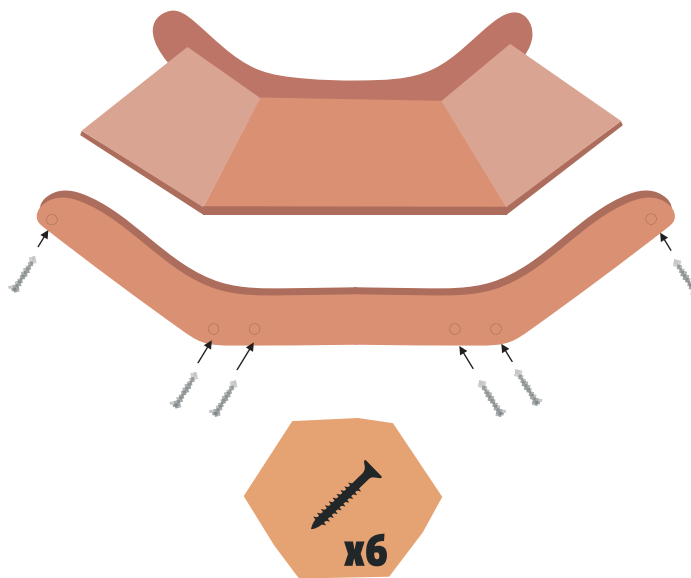

4

Use dowels to hang your cat bed on the wall. Put dowels into wall and then drill the bed through these 4 holes as shown.

