

Small wall light

INSTRUCTIONS

INCLUDED

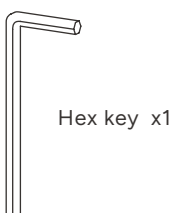
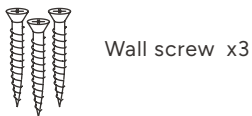
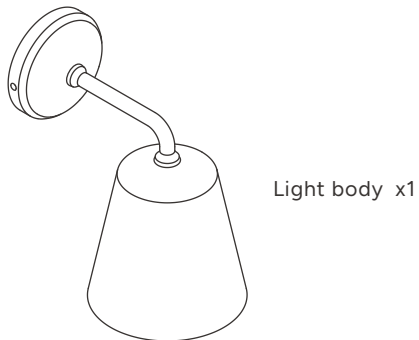

TOOLS YOU'LL NEED

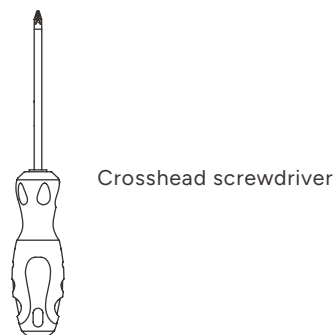
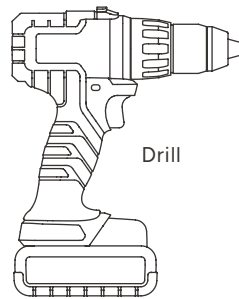

Small wall light instructions

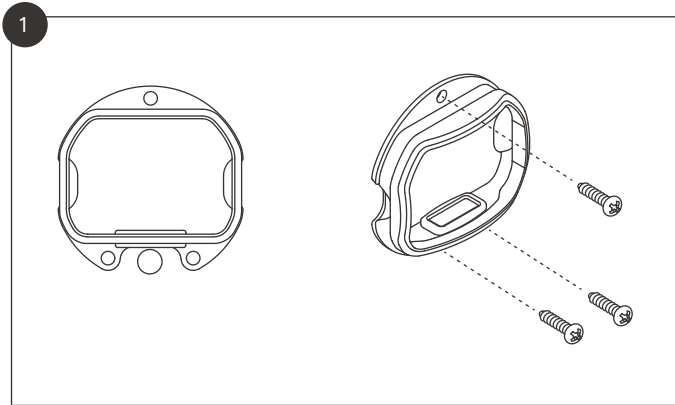

Install the wall light mount. See **page 4** for dimensions.

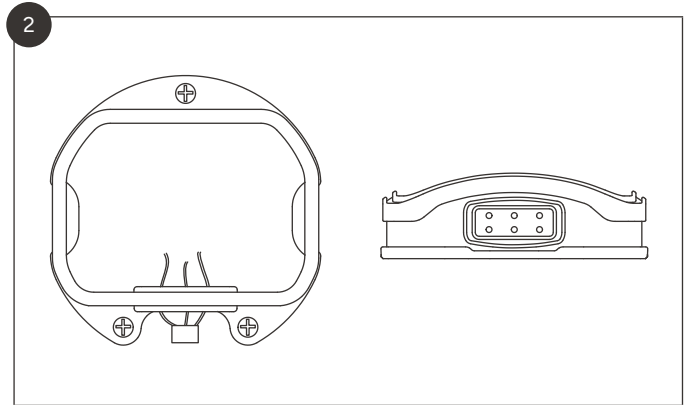

Push wires through the grommet.

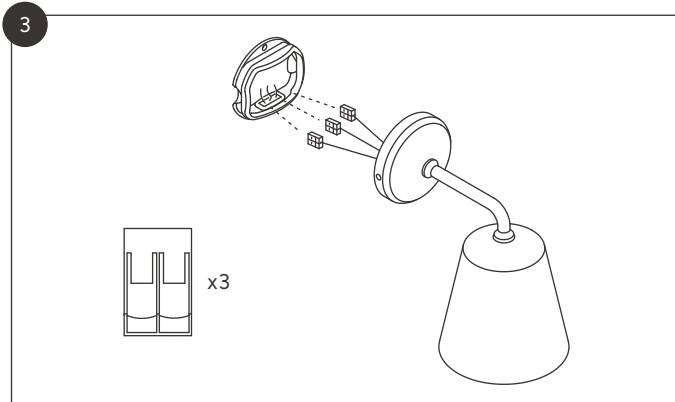

Connect the WAGOs inside the base.

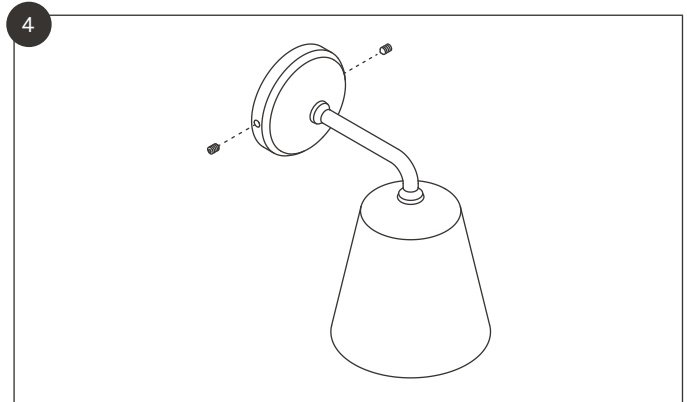

Tighten the grub screws.

Small wall light instructions

5

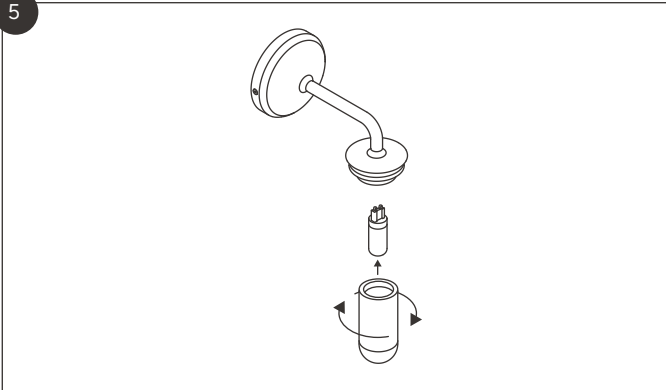

Unscrew the glass cover to add the bulb.

Note: the glass cover protects the bulb in wet environments and is required for the IP rating. If the light is installed in a dry setting, you can remove the glass cover to increase the life expectancy of the bulb.

6

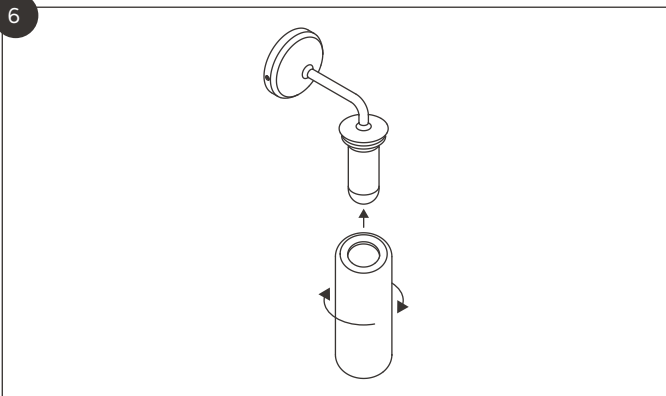

Claremont: screw the shade onto the body.

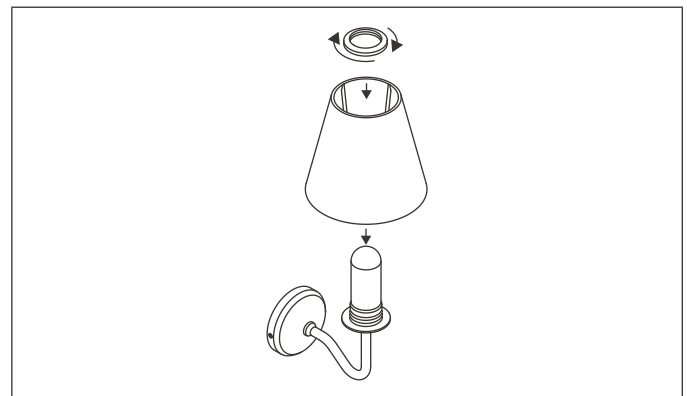

Malvern: use the shade ring to secure the shade.

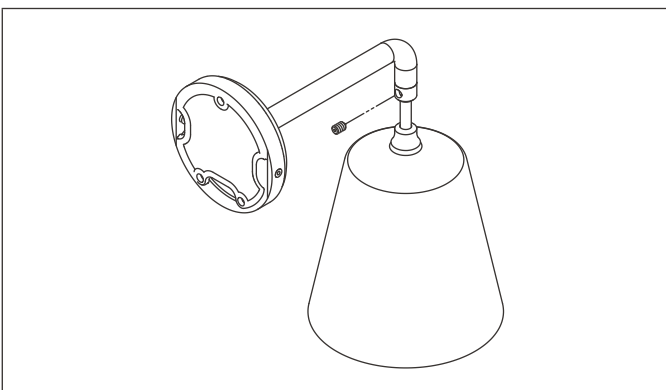

Richmond (hanging): use the grub screw to adjust the shade height.

Small wall light instructions

