

Pro Audio Solutions

Mic Pre/ Signal Booster with Gain Control

User Manual



BOOST-MATE-20





Thank you for choosing Kopul.

Place Kopul's BOOST-MATE-20 inline between your microphone and audio interface or mixing board to add up to 25 dB of clean and transparent gain to any low-output dynamic or ribbon microphone. The BOOST-MATE-20 features high-quality XLR inputs and outputs for flawless signal flow. Use it as a signal booster to increase the signal gain to an audio interface, or as a mic pre that connects directly to your mixing board. The BOOST-MATE-20 operates on 48 V phantom power but doesn't pass it through, so sensitive ribbon mics will be protected from damage. Its metal construction and compact size are made for travel, and its sturdy design will last through live shows and repeated use when recording.

Precautions

- Please read and follow these instructions, and keep this manual in a safe place.
 - Keep this unit away from water and any flammable gases or liquids.
 - Do not attempt to disassemble or repair the equipment—doing so will void the warranty, and Kopul will not be responsible for any damage.
 - Use only the correct, recommended voltage.
 - Clean the unit with only a soft, dry cloth.
 - Exposure to high sound levels can cause permanent hearing loss. Avoid listening at high volumes for extended periods of time.
 - All images are for illustrative purposes only.
-

Connecting the BOOST-MATE-20

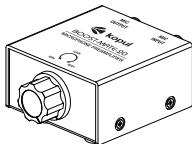

Make sure 48 V phantom power is turned on.

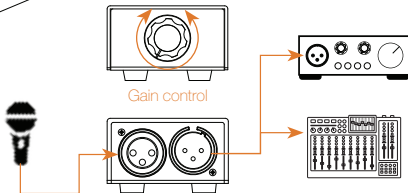

Specifications

Connector 1 3-pin XLR
Female (input)

Connector 2 3-pin XLR
Male (output)

**Number of
Channels** 1

Gain +25 dB

Controls Gain (stepless)

**Operating
Voltage** 48 V (phantom
power)

Material Steel

**Dimensions
(H × W × L)** 1.25 × 2.3 × 2.4 in.
(3.2 × 5.8 × 6 cm)

Weight 6.6 oz. (187 g)

One-Year Limited Warranty

This KOPUL product is warranted to the original purchaser to be free from defects in materials and workmanship under normal consumer use for a period of one (1) year from the original purchase date or thirty (30) days after replacement, whichever occurs later. The warranty provider's responsibility with respect to this limited warranty shall be limited solely to repair or replacement, at the provider's discretion, of any product that fails during normal use of this product in its intended manner and in its intended environment. Inoperability of the product or part(s) shall be determined by the warranty provider. If the product has been discontinued, the warranty provider reserves the right to replace it with a model of equivalent quality and function.

This warranty does not cover damage or defect caused by misuse, neglect, accident, alteration, abuse, improper installation or maintenance. EXCEPT AS PROVIDED HEREIN, THE WARRANTY PROVIDER MAKES NEITHER ANY EXPRESS WARRANTIES NOR ANY IMPLIED WARRANTIES, INCLUDING BUT NOT LIMITED TO ANY IMPLIED WARRANTY OF MERCHANTABILITY OR FITNESS FOR A PARTICULAR PURPOSE. This warranty provides you with specific legal rights, and you may also have additional rights that vary from state to state.

To obtain warranty coverage, contact the Kopul Customer Service Department to obtain a return merchandise authorization ("RMA") number, and return the defective product to Kopul along with the RMA number and proof of purchase. Shipment of the defective product is at the purchaser's own risk and expense.

For more information or to arrange service, visit www.kopulcables.com or call Customer Service at 212-594-2353. Product warranty provided by the Gradus Group. www.gradusgroup.com KOPUL is a registered trademark of the Gradus Group.

© 2024 Gradus Group LLC. All Rights Reserved.