

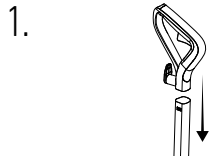

POWERDASH™ PET CARPET CLEANER

HOW TO ASSEMBLE



Insert handle into upper handle pole.



Insert the upper handle pole into the base.

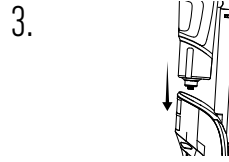

Slide the Clean Water Tank securely into place on the back of the unit.

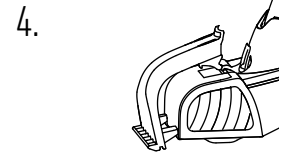

Align the hooks on the nozzle cover to the arrows on the unit and rock cover into place.

HOW TO USE

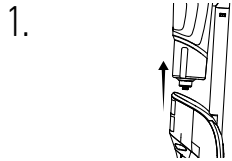

Remove Clean Water Tank, twist off water cap and add warm water to the fill line.

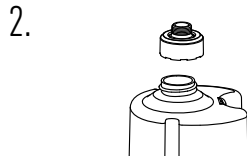

Add Hoover® cleaning solution to the solution fill line then replace and tighten the cap.

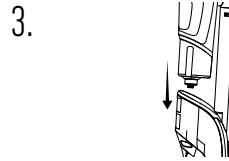

Slide the Clean Water Tank back into the unit.

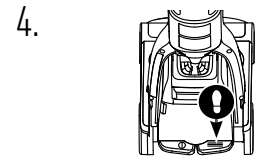

Plug power cord into electric outlet. Step on the Handle Release Pedal to recline the unit into the cleaning position.

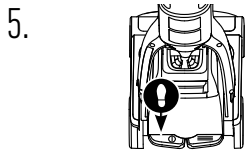

Step on the ON/OFF Pedal to turn ON.



Slowly push forward then backwards while squeezing the trigger to apply water and cleaning solution.



Release trigger then slowly push forward then backwards to remove water and dry the carpet.

PRO TIP

Use only with Hoover® Cleaning Solutions and follow the fill lines found on the clean water tank when adding solution.

964A00292-R0



POWERDASH™ PET CARPET CLEANER

HOW TO ASSEMBLE

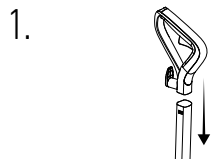

Insert handle into upper handle pole.



Insert the upper handle pole into the base.

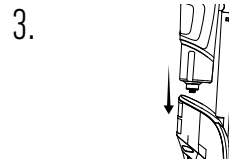

Slide the Clean Water Tank securely into place on the back of the unit.

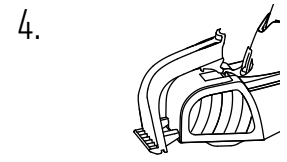

Align the hooks on the nozzle cover to the arrows on the unit and rock cover into place.

HOW TO USE

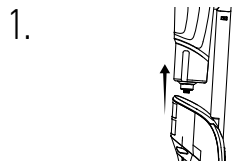

Remove Clean Water Tank, twist off water cap and add warm water to the fill line.

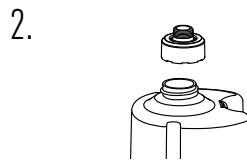

Add Hoover® cleaning solution to the solution fill line then replace and tighten the cap.

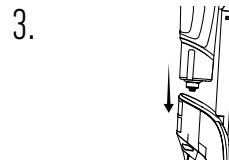

Slide the Clean Water Tank back into the unit.

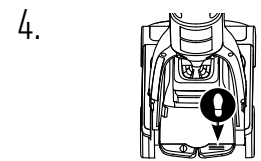

Plug power cord into electric outlet. Step on the Handle Release Pedal to recline the unit into the cleaning position.

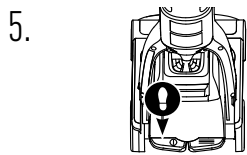

Step on the ON/OFF Pedal to turn ON.



Slowly push forward then backwards while squeezing the trigger to apply water and cleaning solution.

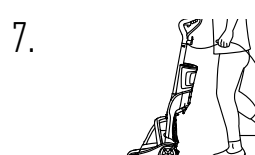

Release trigger then slowly push forward then backwards to remove water and dry the carpet.

PRO TIP

Use only with Hoover® Cleaning Solutions and follow the fill lines found on the clean water tank when adding solution.

964A00292-R0