



User Guide

MAC500s

Multi Air Cleaner





IMPORTANT SAFETY INSTRUCTIONS **READ AND SAVE THESE INSTRUCTIONS**

WARNING!!!

TO REDUCE THE RISK OF FIRE, ELECTRIC SHOCK, OR INJURY TO PERSONS OBSERVE THE FOLLOWING:

- Before opening the appliance, it must be switched off, and unplugged from the socket to prevent being switched on accidentally. When the service disconnecting means cannot be locked, securely fasten a prominent warning device, such as a tag. When the device is open, there is a risk of radiation from the UV-C light. *This can lead to painful corneal inflammation (conjunctivitis)*
- When servicing or replacement of a component make sure to reinstall or remount all safety requirements as previously installed.
- Use this unit only in the manner intended by the manufacturer. If you have questions, contact the manufacturer.
- Skin or eye damage may result from directly viewing the light produced by the lamp in this apparatus. Always disconnect power before relamping or servicing. Replace Lamp With Lamp Model No. J205-1122-8W UV-OZ LL, Manufactured by JIMCO. Do not operate any appliance with a damaged cord or plug. Discard appliance or return to an authorized service facility for examination and/or repair
- Do not run cord under carpeting. Do not cover cord with throw rugs, runners, or similar coverings. Do not route cord under furniture or appliances. Arrange cord away from traffic area and where it will not be tripped over.
- This appliance must be grounded. In the event of an electrical short circuit, grounding reduces the risk of electric shock by providing an escape wire for the electric current. This appliance is equipped with a cord having a grounding wire with a grounding plug. The plug must be plugged into an outlet that is properly installed and grounded. Improper grounding can result in a risk of electric shock.
- Place the machine on a solid surface. Profitable high for the best effect.
- For wall mounting, follow instructions on page 6-10.
- Never immerse the appliance in water.
- For indoor use only.

AVERTISSEMENT !!

POUR RÉDUIRE LES RISQUES D'INCENDIE, DE CHOC ÉLECTRIQUE OU DE BLESSURE, RESPECTEZ LES CONSIGNES SUIVANTES :

- Avant d'ouvrir l'appareil, il faut l'éteindre et le débrancher de la prise de courant pour éviter qu'il ne soit mis en marche accidentellement. Lorsque le dispositif de déconnexion ne peut pas être verrouillé, fixer solidement un dispositif d'avertissement bien visible, tel qu'une étiquette. Lorsque l'appareil est ouvert, il y a un risque de rayonnement de la lumière UV-C. Cela peut entraîner une inflammation douloureuse de la cornée (conjonctivite).
- Lors de l'entretien ou du remplacement d'un composant, veiller à réinstaller ou à remonter tous les dispositifs de sécurité tels qu'ils ont été installés précédemment.
- N'utilisez cet appareil que de la manière prévue par le fabricant. Si vous avez des questions, contactez le fabricant.
- Les dommages à la peau ou aux yeux peuvent résulter de l'observation directe de la lumière produite par la lampe de cet appareil. Débranchez toujours l'appareil avant de le rallumer ou de le réparer. Remplacez la lampe par la lampe n° J205-1122-8W UV-OZ LL, fabriquée par JIMCO. Ne faites pas fonctionner un appareil dont le cordon ou la fiche est endommagé. Mettez l'appareil au rebut ou retournez-le dans un centre de service agréé pour examen et/ou réparation.
- Ne faites pas passer le cordon sous la moquette et ne le recouvrez pas d'un tapis, d'un tapis de sol ou d'un autre revêtement similaire. Ne pas faire passer le cordon sous les meubles ou les appareils. Placez le cordon à l'écart des zones de circulation et à un endroit où il ne risque pas de causer de chutes .
- Cet appareil doit être mis à la terre. En cas de court-circuit électrique, la mise à la terre réduit le risque de choc électrique en fournissant un fil de sortie pour le courant électrique. Cet appareil est équipé d'un câble comportant un fil de mise à la terre et une fiche de mise à la terre. La fiche doit être branchée dans une prise correctement installée et mise à la terre. Une mise à la terre incorrecte peut entraîner un risque d'électrocution.
- Placez la machine sur une surface solide. De préférence surélevée pour un effet optimal.
- Pour un montage mural, suivez les instructions de la page 6-10.
- Ne jamais immerger l'appareil dans l'eau.
- Pour un usage intérieur uniquement



Description

MAC500s produces UV-C light under controlled conditions. Different UV-C wavelengths have different properties. The MAC500s uses two wavelengths. One is a powerful sterilizer when it is in direct contact with pathogens and the other wavelength uses the available oxygen (O₂) to naturally produce a low level of ozone (O₃). The low level of ozone recreates the fresh air from outside in nature inside your home or office. The ozone dynamically attacks dangerous airborne pathogens in the air you breathe and can deactivate airborne virus.

This method is called photolytic oxidation and JIMCO A/S has won EU environmental Award for Developing a Cleaner Technology.

The purpose with the MAC500s is to purify the air you breathe.

Intended use

The MAC500s is intended to be used 24 hours a day. The recommended room size is 60 m³ (24 m² with a ceiling height of 2,5 m). The unit should not be operated while situated on the floor but should be placed as high as possible for maximum efficiency.

The unit must not be operated without cover.

When more units are placed in a room they must be placed as far from each other as possible to get an even distribution of the area they cover.

Function

Photolytic oxidation makes a cold incineration with airborne pathogens and organic particles such as fungal spores, virus, bacteria, yeast, ethylene gasses, nicotine etc. The process is environmentally friendly and the cold incineration will reduce the airborne pathogens and organic particles significantly.

The MAC500s reduce ethylene gasses, bacteria and fungal spores, which will extend the shelf life of food, fruit and vegetables.

The MAC500s will effectively reduce odor from rooms deposited in walls, carpets, textiles, furnitures etc.

Technical Data MAC500s:

Room area:	60 m ³	Power consumption:	23 w
UV lamps:	1x8 W	Height:	3.8 inch (96 mm)
Operating hours:	8000	Length:	15.8 inch (400 mm)
Voltage:	120V	Width:	3.7 inch (93 mm)



Lifetime of the lamps

The lifetime of the JIMCO special lamp is around 8,000 operating hours. After the expiry of 8,000 operating hours, the efficiency of the lamp will be reduced, which means if the air is not purified as usual then the lamp should be replaced.

8,000 operating hours, equals to approximately a year of operation. If the effect of the device drops before the end of 8,000 operating hours, you should check, if the JIMCO Special lamp is dirty with e.g. dust particles. Is this the case? Then follow the cleaning instructions.

Maintenance

To maintain the optimal performance of the MAC500s, we recommend – for regular use – to clean the lamp and fan about every 3 month. When it is used in heavily soiled/dusty rooms, this should be done more often.

Cleaning the appliance:

Turn off the appliance and then unplug the appliance from the socket.

Clean the outside of the appliance with a damp cloth, use a little detergent if necessary (Follow the instructions of the detergent). Clean the lamp and fan with a clean and soft cloth, use a little ethylalkohol if necessary. Note the date of cleaning.

Operation Instructions

- Switch the appliance on and off with the On / Off switch
(1) The red lamp lights to indicate that the appliance is now switched on
- When there are 500 operating hours left, the On / Off lamp will start to flash. When the appliance has been in operation for more than 8000 hours, all 3 red lights start flashing and an acoustic signal is heard around every 30 minutes. The lamp must now be replaced.
- When the lamp is replaced Reset the Timer by holding down the Reset button (2) for more than 5 seconds. 5 quick beeps are heard, and the unit is ready for use again.



Warranty Regulations

On the MAC500s, JIMCO A/S provides 24-month warranty. Guarantee periods is 12 months. The warranty is calculated from the date of sale from your JIMCO dealer. To provide this, a receipt must be kept. Within the stated warranty period, JIMCO A/S will cover, without charge, every defect that are subject to material or manufacturing defects and, at your option, provides warranty repair or replacement of the MAC500s.

Prerequisite for the guarantee benefit is that the appliance is used according to its purpose and in accordance with the operating instructions. Excluded from the warranty are damages caused by improper use, wear or interference on the part of the owner or third parties. The warranty does not cover consumables – E.g. the lamp – Or wear objects as a fan and lacking which only negatively affect the value or usefulness of the MAC500s.



MAC500s

Installation instruction

In the package

- 1x MAC500s (Multi Air Cleaner)
- 2x Screws (in the bottom of the MAC500s)
- 2x DIN Rail Brackets (in the box)
- 1x DIN Rail (in the box)

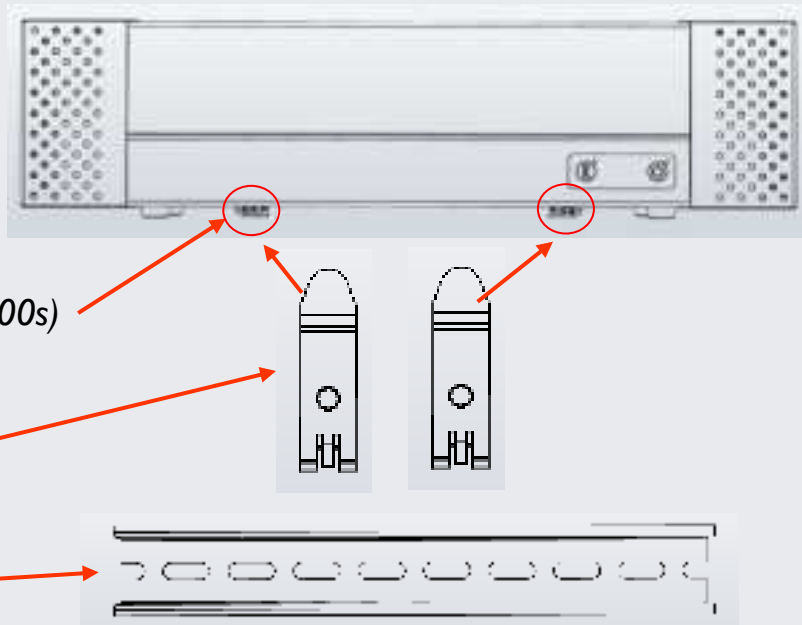

1. Find a suitable place for your MAC500s

Note: We recommend to place the MAC500s at least 200 mm. away from any side obstacles on both sides of the MAC500s to ensure inlet and outlet air.

2. Connect the instrument to a suitable plug socket
3. Place the MAC500s on a solid surface e.g. on a shelf
4. To get the best effect we recommend to place the MAC500s as high as possible
 - e.g. 5.9 feet

For wall mounting see the mount instruction on page 5-11.



Installation instruction

Wall mount your MAC500s

See drawings on page 6-11

1. Find a suitable place for your MAC500s

Note: We recommend to place the MAC500s at least 200 mm. away from any side obstacles on both sides of the MAC500s to ensure inlet and outlet air. It must be vertical installed.

2. Place the DIN rail on the wall and level it

3. Mark the holes with the pencil (On each side of the rail)

4. Drill the holes and insert the anchors (if needed)

5. Mount the DIN rail with suitable screws/anchors/plugs for the surface.

6. Mount the DIN rail brackets on the back side of the MAC500s with the screws/anchors/plugs.

Note 1: The harder you tighten the screws the harder will MAC500s be mounted on the DIN rail.

Note 2: You can choose individually on which side you want the outlet air from the MAC500s, outlet air is on the same side as the operation buttons

Note 3: By turning the DIN rail brackets 180° (degree) you choose individually on which side you want the outlet air.

Note 4: Hooks on the DIN rail brackets shall always be placed at the top according to the choice of the outlet air.

7. Mount MAC500s on the mounted DIN rail on the wall. Make sure to attach the hooks on the DIN rail brackets first to the DIN rail and then push the MAC500s towards the wall

Note 5: Make sure that you hear “click”



2-3-4

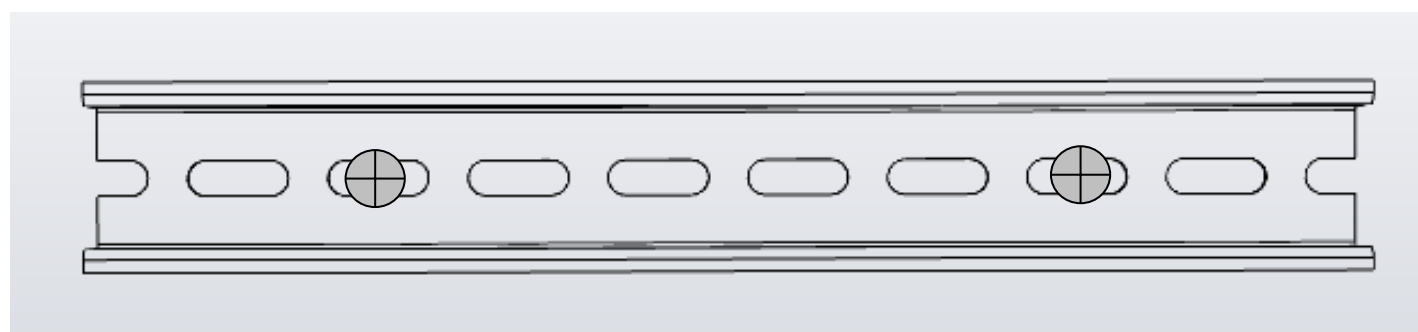
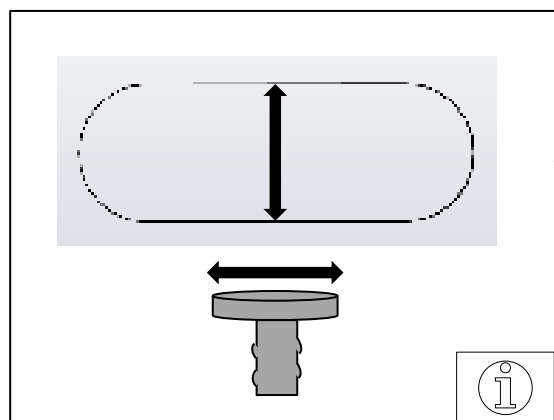
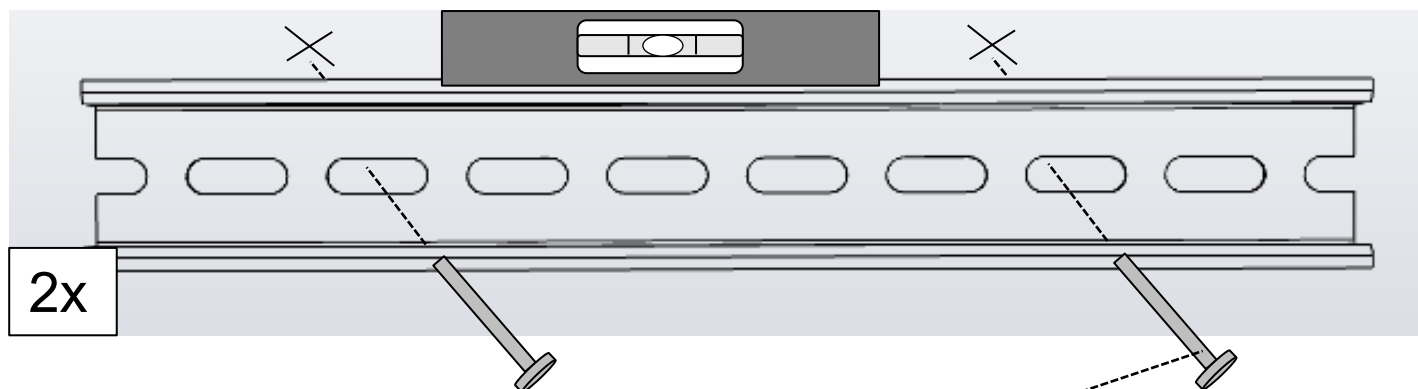



Note 4

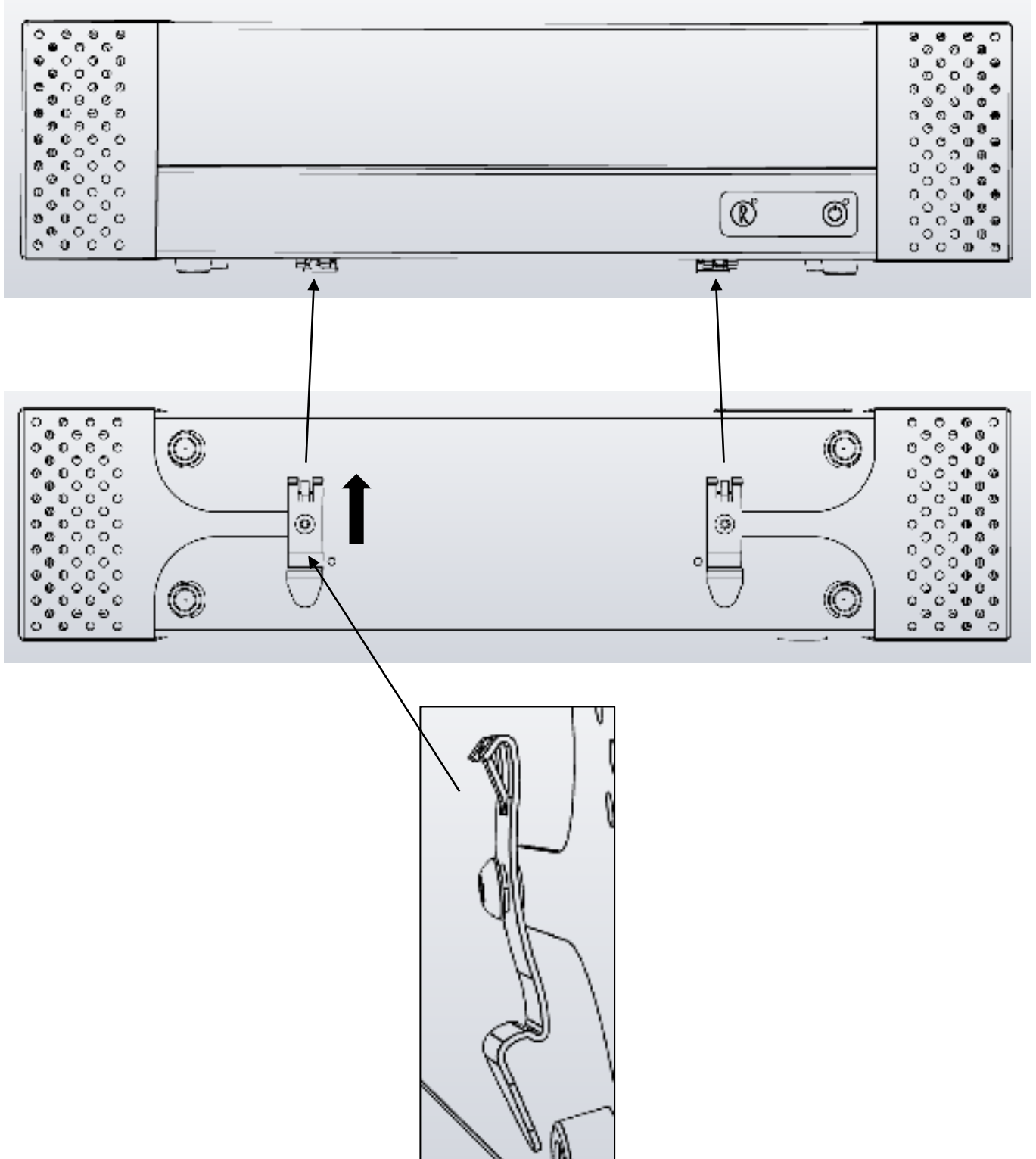

i

Note 4

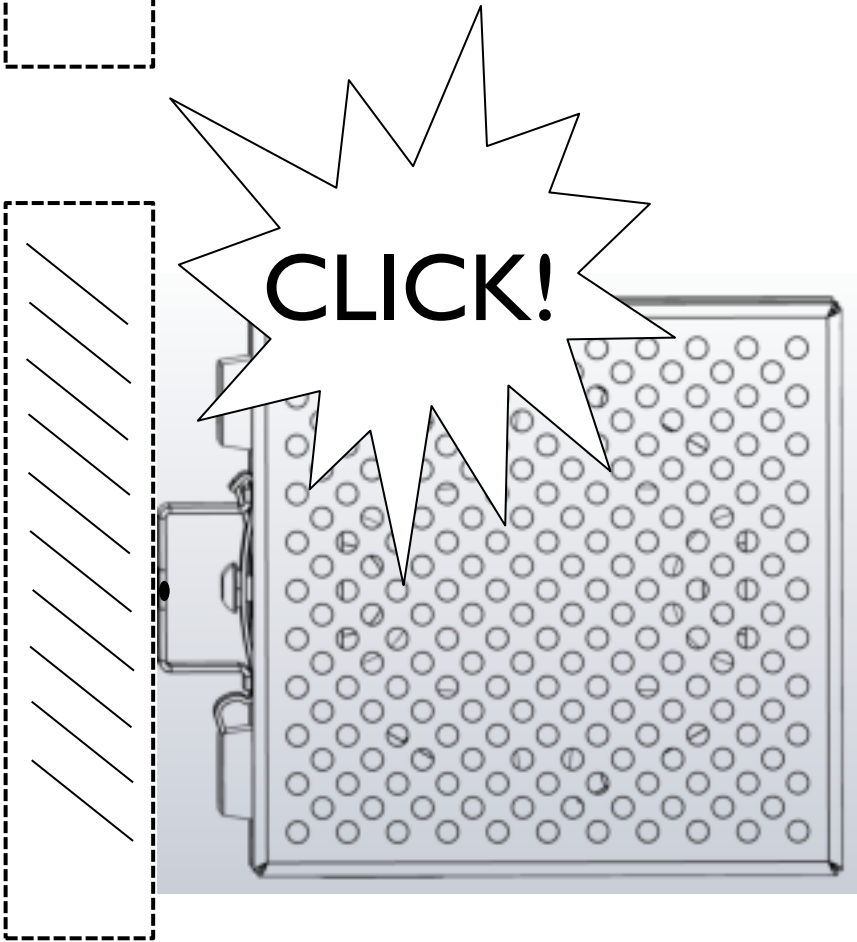
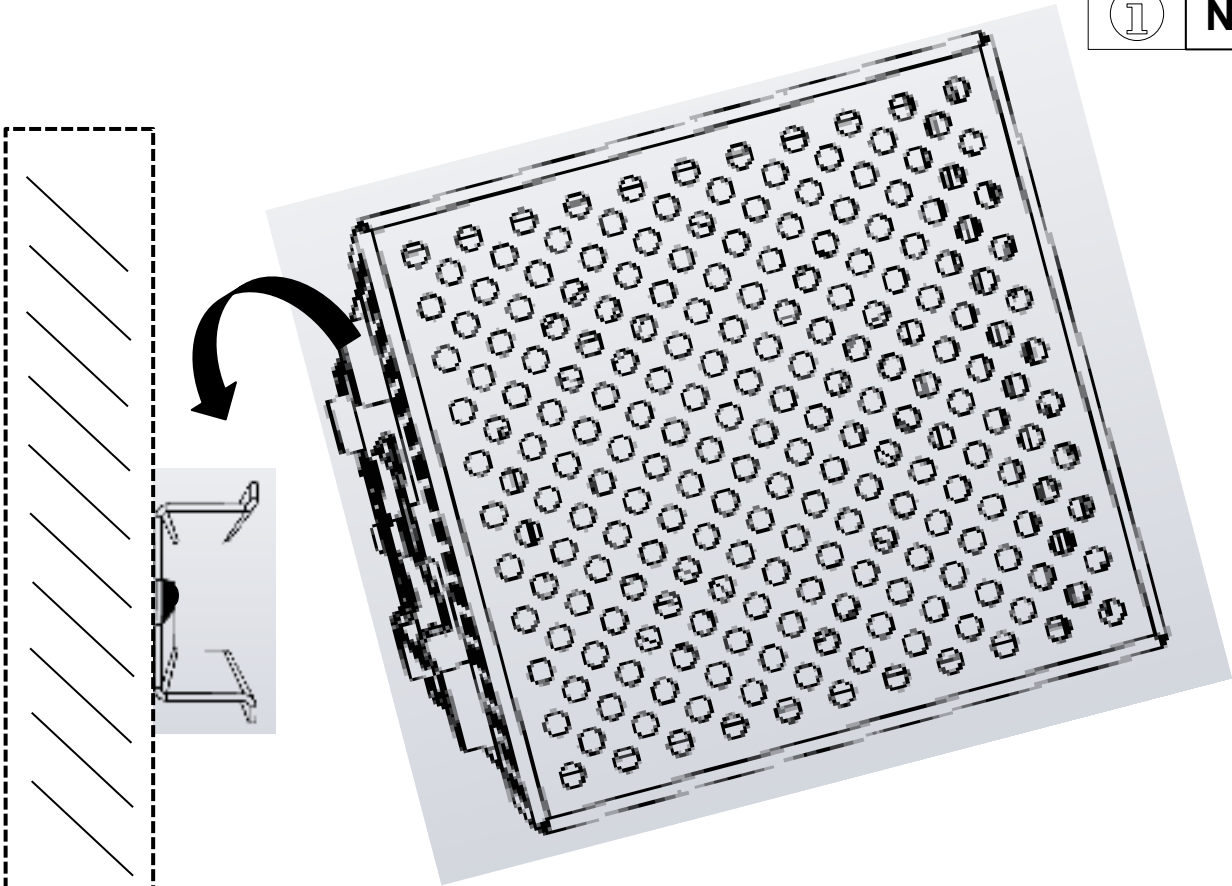

i

Note 5

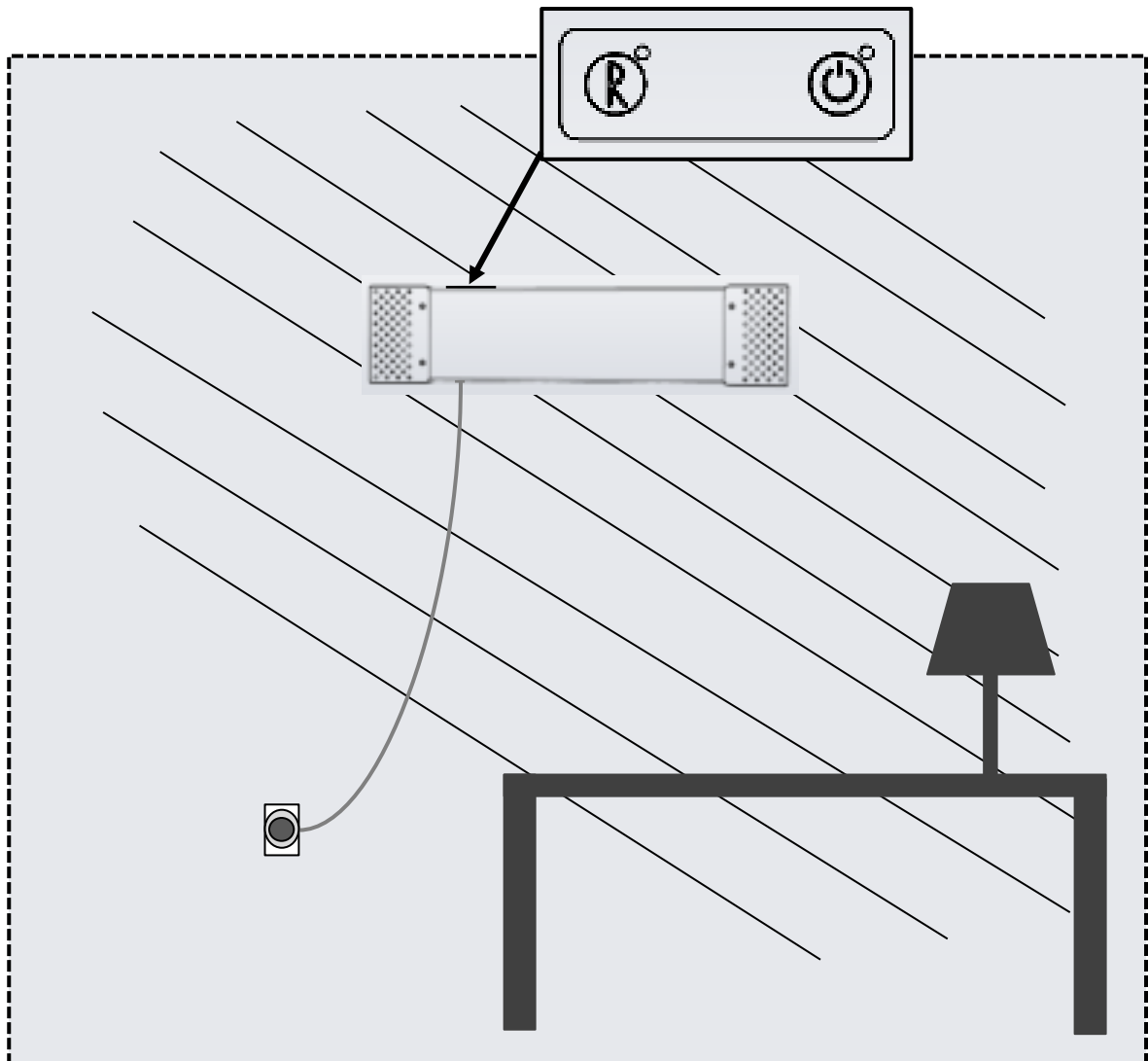



Lamp change:

Step: 1



Disconnect the power to the MAC500s by unplugging (position 2) from the wall socket

Step: 3

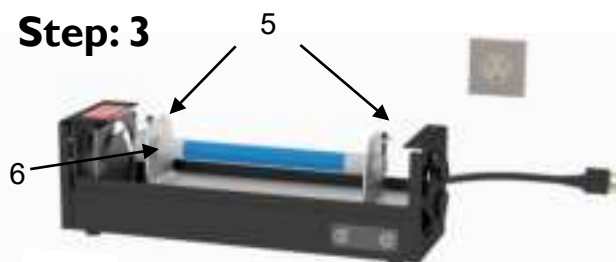

Untighten the screws on the lamp holders (position 5) and disconnect the lamp connector (position 6).

Step: 5



Insert the new lamp into the lamp holders and connect the lamp connector.

Step: 7

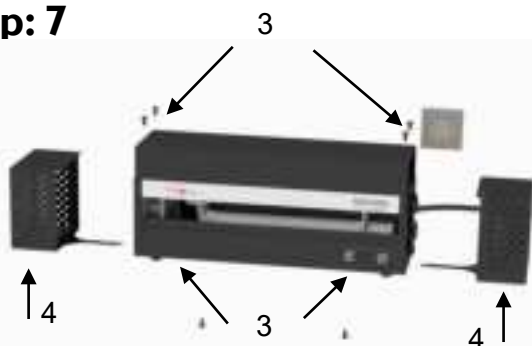

Attach the cover and guards. Reinstall the screws (position 3 and 4)

Step: 2

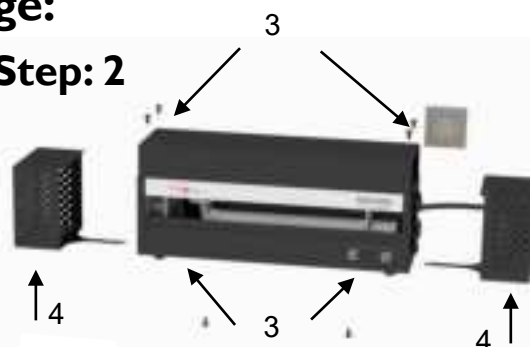

Remove the six screws (position 3) and remove the cover and guards (position 4)

Step: 4

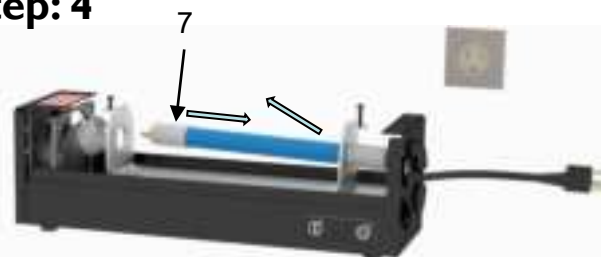

Pull the lamp (position 7) out of the lamp holders

Step: 6

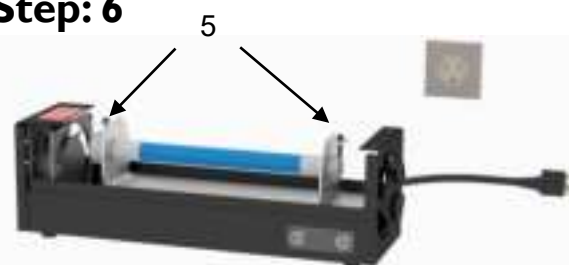

Slightly tighten the screws (position 5)
DO NOT USE EXCESSIVE FORCE.



STATEMENT OF COMPLIANCE

The undersigned, who represent the manufacturer mentioned below

Manufacturer:	Jimco A/S
Address:	Mjølbyvej 7 – DK-5900 Rudkøbing
or who represent the manufacturers authorised representative within the EU	
Authorised representative:	
Address:	
Declare that	
Product identification :	MAC500S

is manufactured in compliance with the following EU directives:

Reference No.	Title
2014/35/EU	Low Voltage Directive(LVD)
2014/30/EU	Electromagnetic Compatibility (EMC) Directive

And that standards and/or technical specifications mentioned below.
 Year when CE label was affixed: 1999

Identification of signer: Jimmy Larsen

Date: 18-05-2021

Signature:

References to standards and/or technical specifications which are used for this "Statement of Compliance" or parts thereof.

- Harmonised standards:

No.	Version	Title	Parts
EN60204-1	2	Machinery Safety – Electrical material on machinery	
EN IEC 55014-1		Electromagnetic compatibility- Requirements for household appliances and similar products	Part 1: Emission

- Other standards and/or technical specifications:

No.	Version	Title	Parts

- Other technical solutions, where detailed information is included in the technical documentation or the technical dossier for the construction.

.....



Contact

Producer: JIMCO A/S - Denmark
Mjølbyvej 7 – DK-5900 Rudkøbing
+45 6251 5456
www.jimco.dk

Lamp switch:



Always stay safe