

# Model: DE-NEST-GFL01

ENGLISH

## Manual

LED Lantern



### Names of individual components

#### Main unit

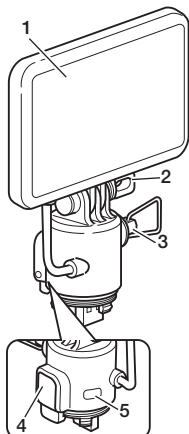

#### Mini tripod

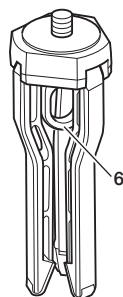

- 1 Light
- 2 Joint screw
- 3 Rotary switch
- 4 Lock
- 5 Button switch
- 6 Strap loop

This LED lantern is designed to be used specifically with the NESTOUT outdoor battery. The battery is not included. Please purchase the battery separately.

#### Connector



### How to use

#### How to connect

- ① Open the battery's cap and attach the connector.

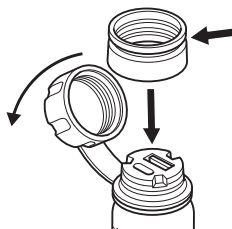

- \* Screw on the connector until there is no gap.
- \* It may be a little difficult to screw on the connector. This is normal.

- ② Check that the rotary switch on the main body is at OFF.

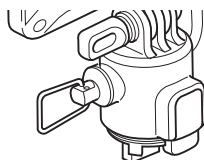

- \* The LED may not light up when connected to the battery while the switch is at ON due to the battery's protection function.

- ④ Turn the rotary switch to ON to switch on the light.

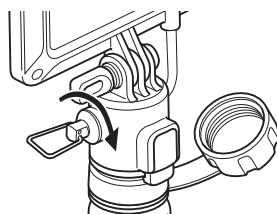

- ⑤ Turn the switch OFF before removing this product. Press the lock to unlock and hold while pulling the LED lantern out from the battery. Finally, remove the connector.

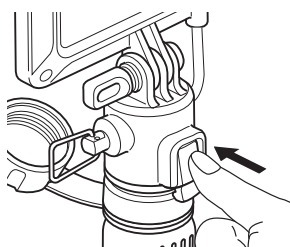

- \* Push it in until there is no gap and it will be locked in.

#### Brightness adjustment

Turn the rotary switch to power it ON and continue turning it to increase the brightness. Adjust it to your preferred brightness.

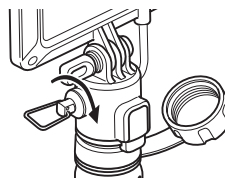

#### Changing the light color

Press the button switch to cycle from Cool white → warm white → daylight.

#### Possible usage time: (reference value) Usage time for 5000 mAh capacity: approximately 1.5-17 hours and above

- \* The usage time may be shorter due to the characteristics of the portable power charger and surrounding temperature.

- \* The switch is analog and unstepped. There may be individual differences between the displayed value and the minimum and maximum brightness.

- \* The display indicating remaining battery charge may not display correctly when used on the minimum brightness continuously. The usable time will not be reduced.

- \* When the output of the dedicated gear is low (low intensity), the light will automatically turn off in approximately 2 hours if the battery side is in normal mode, and in approximately 12 hours in gear mode.

#### Gear mode (operate on the battery)

The portable power charger will turn OFF automatically after approximately 2 hours, when the light is on low light. Gear mode will allow for continuous use of approximately 12 hours.

Click the power button on the side of the battery twice quickly (double click) to turn gear mode ON / OFF.

Gear mode ON → Power LED blinks



- \* Gear mode will be deactivated when the same action is performed or when the power is turned OFF.

#### How to attach the mini tripod

Unfold the tripod and screw the battery onto it by twisting the strap loop in the center to secure.

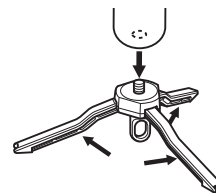

- \* The mini tripod can be opened to 2 heights.

#### Adjusting the angle of the light

- ① Loosen the joint screw slightly by turning it half a round counter-clockwise.

- \* The screw may come off if over loosened.

- ② Adjust the angle of the light, then turn the joint screw clockwise to tighten.

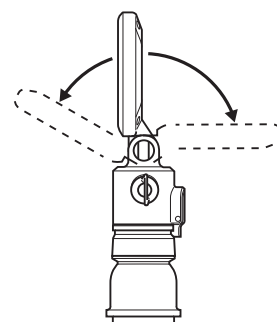

#### Folding in the rotary switch

The tab of the rotary switch can be folded in. Please fold it in at the power OFF position, as illustrated.

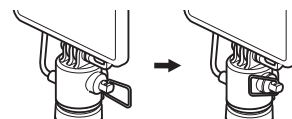

### Specifications

Brightness		Approximately 30 lm - 1000 lm * Theoretical brightness
Color adjustment		Cool white / warm white / daylight
Color temperature		Approximately 2800 K - 6000 K
Dimensions [Width] × [Depth] × [Height]	Light	Approximately 100 × 35 × 119 mm (Approximately 3.9 × 1.4 × 4.7 in.)
	Mini tripod	(Unfolded) Approximately 145 × 130 × 45 mm (Approximately 5.7 × 5.1 × 1.8 in.)  (Folded) Approximately 31 × 29 × 90 mm (Approximately 1.2 × 1.1 × 3.5 in.)
Input		5 V/2.0 A
Input terminal		USB-A

## Safety Precautions

- ⊘ Prohibited action
- ❗ Mandatory action
- ⚠ Situation that needs attention

### ⚠ WARNING

- ❗ Stop using the product immediately in the following cases and consult the store you purchased it from. A fire or electric shock may result from continual usage.
  - Smoke, abnormal odors or noises are coming from the product.
  - When the product is wet.
  - When foreign materials or liquid enters the product.
  - The case has been damaged.
- ⊘ Do not touch the cable when your hands are wet. Doing so can cause fire and electric shock.
- ⊘ Do not use or store in unstable places.
- ❗ The connector must be firmly inserted deep into the NESTOUT outdoor battery port. A loose connection may result in fires and electric shocks.
- ⊘ Always hold the connector and not the cable when plugging or unplugging this product. It can cause the external cord damage, disconnection, and lead to a fire or electric shock.
- ⊘ Please do not look directly into the lighted LED light. It may damage your eyes.
- ⊘ Please do not look directly into the LED light for long periods of time.
- ⊘ Do not attempt to disassemble or modify the product as it may result in fire, electric shock or injuries.
- ⊘ Do not put this product in a fire as it may cause an explosion or breakage.

### ⚠ CAUTION

- ❗ Before using this product, check that there is no foreign matter such as dust or liquid in the connectors of this device or the NESTOUT outdoor battery. Charging when the connector is wet or has foreign matter in it may cause fires, electric shocks, or malfunctions.
- ⊘ Do not use or store the product in the following places as fire, electric shock or malfunctions may result:
  - Places exposed to direct sunlight and locations with high temperatures, such as near a space heater.
  - Places with high humidity or close to water sources.
  - Places with a lot of dust.
  - Places with a lot of vibration.
- ⊘ Do not use or store the product near places that have a lot of dust such as near bedding. Doing so may cause a fire or device failure.
- ❗ Stop using this product immediately if you notice damage, such as cracks, deformation or deterioration.
- ⊘ Do not use alcohol or other chemicals on this product.
- ❗ Remove this product from the NESTOUT outdoor battery if it is not in use for a long time. Doing so can cause electric malfunctions.
- ⊘ Do not drop the product, subject it to strong shocks, or place objects on it.
- ❗ Please keep out of reach of children.
- ⚠ A slight temperature rise of the product during use may occur and that is normal.
- ❗ If the product body becomes dirty, wipe it with a soft, dry cloth. If the product is badly soiled, wipe it with a cloth that has been soaked in water or diluted neutral detergent and wrung dried.

#### ■ Regarding waterproofing and dust-proofing

- ⚠ Do not remove this product from the battery when wet or dirty. Malfunctions can occur when water or foreign matter enters the port. Wipe off all moisture or dirt before removing from the battery.
- ⚠ Note that if the o-ring of this product is damaged or deformed, the waterproof and dustproof function may not work properly.

#### ■ Other safety precautions

- ⚠ Please remove the dedicated gear from the portable power charger after use. Otherwise, this may deplete the battery.

## Limitation of Liability

- In no event will ELECOM Co., Ltd be liable for any lost profits or special, consequential, indirect, punitive damages arising out of the use of this product.
- ELECOM Co., Ltd will have no liability for any loss of data, damages, or any other problems that may occur to any devices connected to this product.

## Compliance status

www.elecom.co.jp/global/certification



This device complies with Part 15 of the FCC Rules. Operation is subject to the following two conditions: (1) This device may not cause harmful interference, and (2) this device must accept any interference received, including interference that may cause undesired operation. In order to make improvements to this product, the design and specifications are subject to change without prior notice.

#### Responsible party

ELECOM USA, Inc.  
2211 Michelson Dr, Suite 900  
Irvine, CA  
92612 USA  
elecomusa.com

## ELECOM CO., LTD.

www.elecom.co.jp/global/

ELECOM USA, Inc. 2211 Michelson Dr., Suite 900, Irvine, CA 92612 USA elecomusa.com
ELECOM Korea Co., Ltd. Dome-Bldg 5F, 60, Nambusunhwan-ro 347-gil, Seocho-gu, Seoul, 06730, South Korea TEL : +82 (0) 2 - 1588 - 9514 FAX : +82 (0) 2 - 3472 - 5533 elecomusa.co.kr
ELECOM Sales Hong Kong Ltd. 2/F, Block A, 2-8 Watson Road, Causeway Bay, Hong Kong TEL : +852 2806 - 3600 FAX : +852 2806 - 3300 email : info@elecom.asia
ELECOM Sales Hong Kong Ltd. 2/F, Block A, 2-8 Watson Road, Causeway Bay, Hong Kong TEL : +852 2806 - 3600 FAX : +852 2806 - 3300 email : info@elecom.asia
ELECOM (SHANGHAI) TRADING Co., Ltd Room 208-A21, 2nd floor, 1602 Zhongshanxi Road, Xuhui District, Shanghai, China, 200235 TEL : +86 021-33680011 FAX : +86 755 83698064
ELECOM Singapore Pte. Ltd Blk 10, Kaki Bukit Avenue 1, #02-04 Kaki Bukit Industrial Estate, Singapore 417942 TEL : +65 6347 - 7747 AX : +65 6753 - 1791

- ELECOM CO., LTD. owns the copyright of this manual.
- Unauthorised copying and/or reproducing of all or part of this manual is prohibited.
- If you have any suggestions or doubts about this Manual, please contact your dealer.
- The specifications and appearance of this product may be changed without prior notice for product improvement purposes.
- We shall bear no responsibility for any device failure or malfunction of other devices resulting from the use of this product.
- To export the part of this product applicable to strategic goods or services, export or service trading permission according to foreign currency laws is necessary.
- The company and product names on the packaging and the manual are, in general, trademarks or registered trademarks of their respective companies.
- The images are for illustration purposes only and may differ from your actual product.
- In order to make improvements to this product and for improved safety, the colors and specifications are subject to change without prior notice.

A customer who purchases outside Japan should contact the local retailer in the country of purchase for enquiries. In "ELECOM CO., LTD. (Japan)", no customer support is available for enquiries about purchases or usage in/from any countries other than Japan. Also, no foreign language other than Japanese is available. Replacements will be made under stipulation of Elecom warranty.

#### LED Lantern

Manual, Safety precautions, and Compliance with regulations  
1st edition, December 23, 2022

# ELECOM

©2024 ELECOM Co., Ltd. All Rights Reserved.