

70MM

60MM

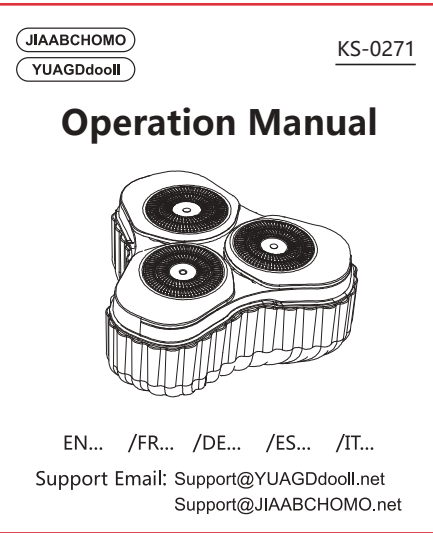

EN

## Introduction

Thanks to choose KS-0271 electric shaver. Please read this booklet carefully before using the shaver. General description (Fig.1)

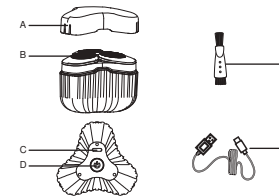

- A - Protection cap for the shaving unit  
B - Shaving unit  
C - Type-C plug  
D - On/off button  
E - Cleaning brush  
F - USB cable

Note: The accessories supplied may vary for different products. The box shows the accessories that have been supplied with your appliance. Please read this booklet carefully before using the shaver.

## Danger

Make sure the charging adaptor and connector do not get wet. The shaver is washable and can be cleaned under the tap do not wash the shaver with water hotter than 60°C. (Fig. 2)  
Please take good care of the instruction for future reference.

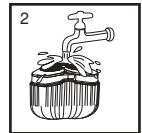

## Charging

Shaver should be charged under the circumstance of temperature between 5°C -35°C. Please don't charge it in the sun or beside a warmer. (Fig. 3)

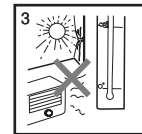

The suitable voltage for the appliance charger is 110V-240V~50Hz/60Hz.  
It is recommended to use DC 5V 1A charging equipment to charge this product.  
Do not use Quick Charger such as 9V or 12V to charge or it shortens the battery lifespan or causes battery damage.  
Do not charge the appliance for more than 10 hours.

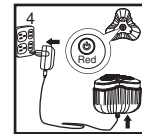

Charging takes approx 2 hours.  
When the appliance is fully charged, It has an operating time of 60 minutes.  
1. Make sure the appliance is switched off. (Fig.5)  
2. Connect the USB charging line to the USB interface and the computer USB interface to charge. (Fig. 6)  
The charging light indicates that the appliance is charging.

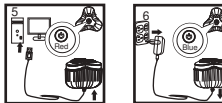

**Note:** When the battery is running low, the charging light starts to flash. When the battery is fully charged, the charging light is converted to blue. Optimizing the lifetime of the rechargeable batteries. Discharge the rechargeable batteries completely twice a year by letting the motor run until it stops.  
Then fully recharge the batteries.

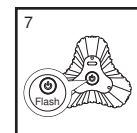

## Shaving

You can shave without charging by connecting the shaver with charger to the mains voltage DC 5V 1000mA.  
Press the switch on/off button to switch on the shaver.  
Rapidly move the shaver back and forth against the growing direction of the beard. (Fig. 8 9 10)



Shaving is best when the face is dry. So please shave before or sometime after the face washing.  
It will take some time for your skin to get used to the Shaving device. Hair on the neck can also be shaved in this way.  
Press the switch on/off button to switch off the shaver. And cover with a protective cover to avoid damage. (Fig. 11)

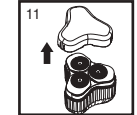

Don't use it if the case that shaving heads are damaged. as it may hurt your skin.

## Cleaning &amp; Maintenance

To ensure a better shaving effect, the shaver must be cleaned regularly. Note: Waterproof, dustproof features are not permanently effective and may decline due to daily wear and tear. Damage due to immersion in liquids is not covered by warranty.

1. Make sure the appliance is switched off and disconnected from the mains.

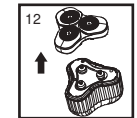

2. Pull the blade holder removal opening and remove the shaver parts. (Fig. 12)  
3. The shaver parts can be washed directly under the faucet, and the charging port should be kept dry when the fuselage is washed. (Figure 13)

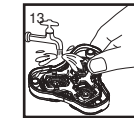

4. After rinsing, drain the water from the razor and place it horizontally in a ventilated area to dry.  
5. For best-using effect. Please add some lubricating oil every three months. The Lubricate oil is not included in this package. You need to purchase it by yourself. (Fig. 14)

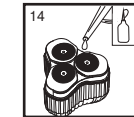

You can clean them while washing the shaver heads and hair chamber by using a brush.

## Replacement

Replace your shaver head once a year for an optimal shave. The shaver has a long service life if it is not damaged by the human factor. Damaged shaving heads can only be replaced with our shaving heads.

1. Unscrew the knob on the shaving heads set carefully. Remove the shaving heads from the shaving head holder and throw them away. (Fig. 15 16)



2. Place new shaving heads in the holder. Fix up the shaving heads set on the unit by screwing the knob. (Fig. 17 18)

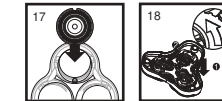

**Note:** Make sure the notches on both sides of the shaving heads fit exactly on the shaving head holder.

## Environmental Protection

1. To discard the product, please don't put it together with general domestic rubbish heaps but hand it to the officially designated recycling center for environmental protection.



2. The built-in rechargeable battery contains substances that may pollute the environment, so it must be unloaded from the product or sent to the officially designated recycle center to be disposed of before it is discarded. (Fig. 19)

2023.7.26 凯锐KS-0271说明书 单页60X70MM 风琴折 单黑印刷