

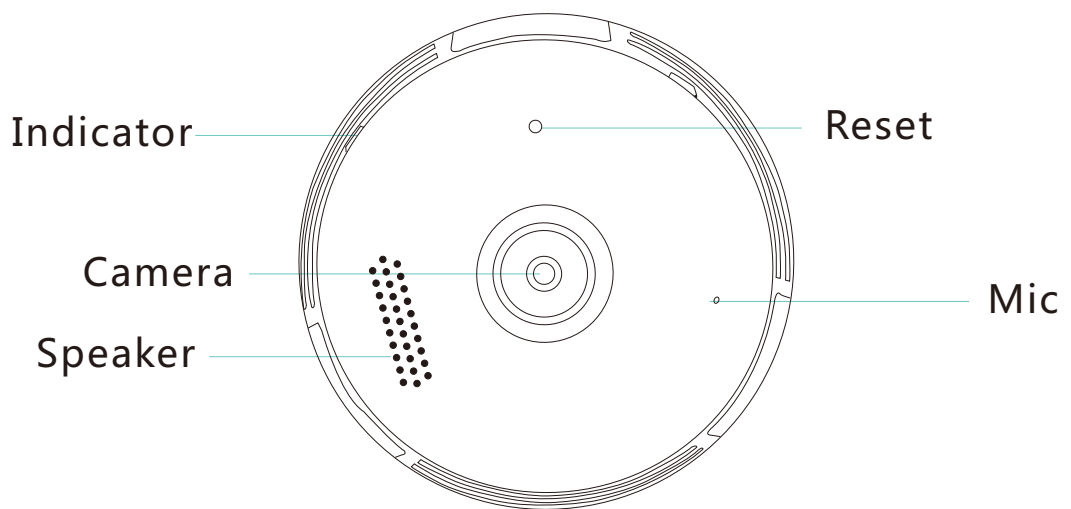

Light Bulb Camera

Quick User Manual

Camera Parts

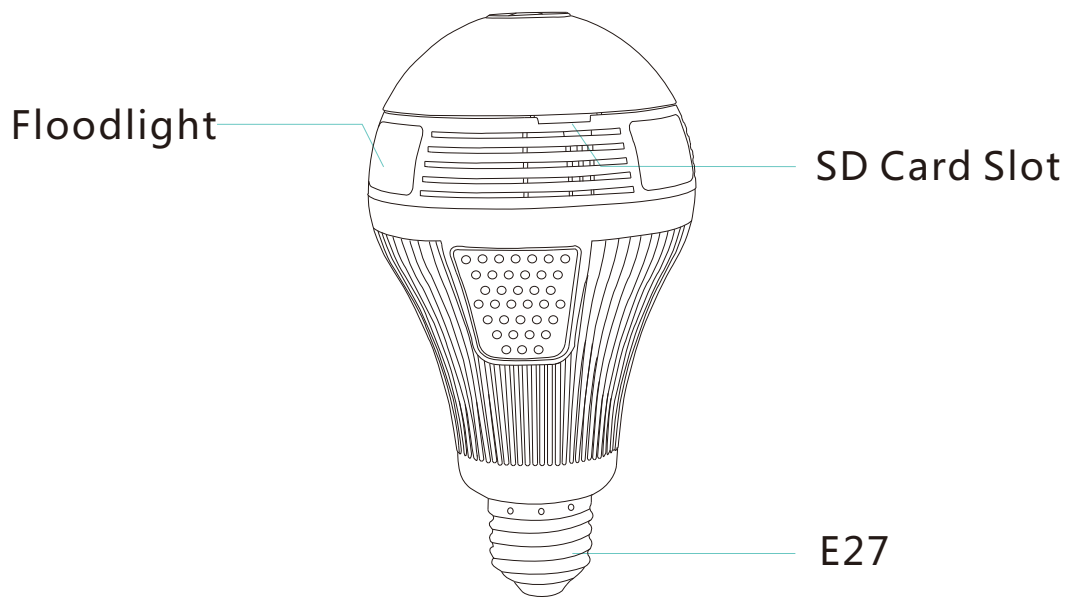

Installation

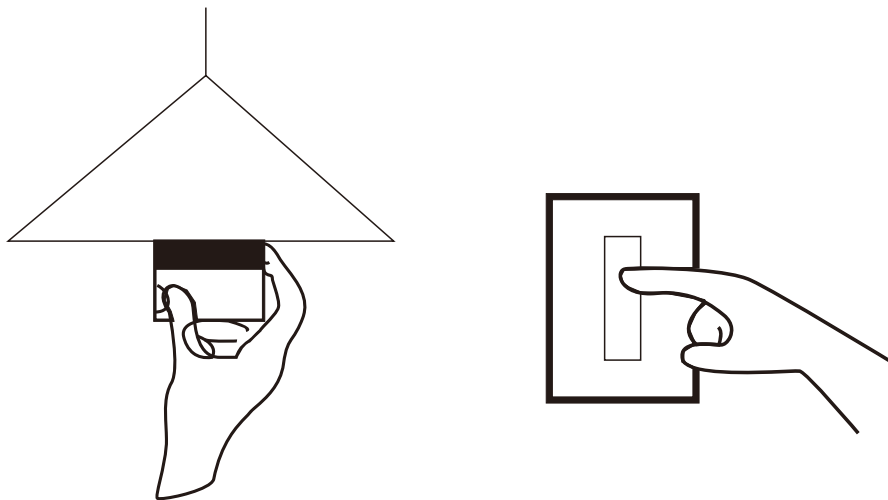

Precaution

Please turn off the power before installing the bulb camera.
Please make sure the voltage is correct.

The bulb will generate heat in the work, do not touch the bulb after prolonged use.

Please use the camera function legally.

How to Download APP

Method 1:

Scan the QR Code to download the App.

Method 2:

Search for "Crorzar Cameras" in the App Store or "Crorzar Pro" in Google Play Store and download directly.

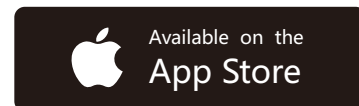

Scan this QR code to download App for iOS devices



Scan this QR code to download App for Android devices

User registration & login

- 1 If you have a Facebook ID, you can tap the Facebook icon on the APP interface directly to log in.
- 2 You can also create a new account and log in: Click "Sign Up" to register a new account.
- 3 Enter new username and password.
- 4 Enter a email address and tap "Get Code" (a verification email with a code will be sent to this address so please find the email to get the code and then input this code in where you just entered the email address and tap Sign Up).
- 5 Then log in using the username and password you just registered.

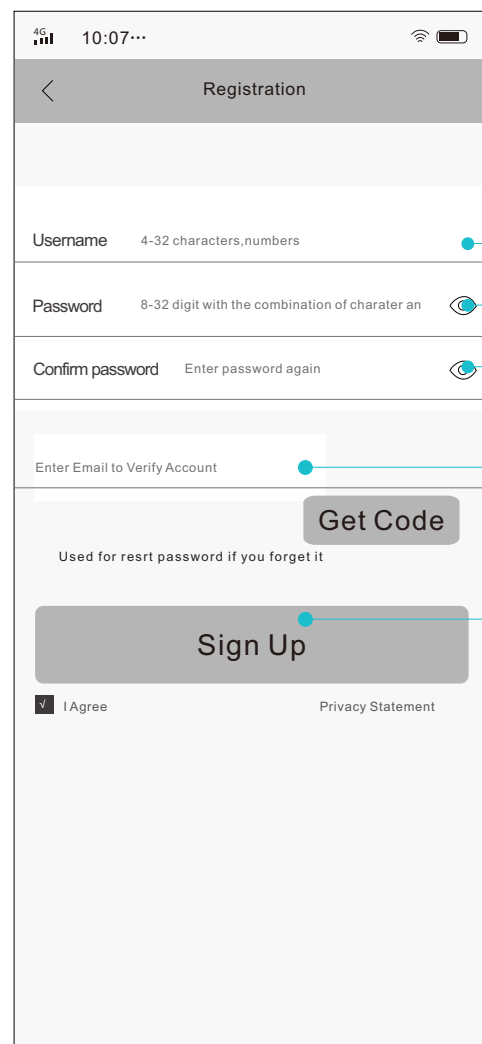
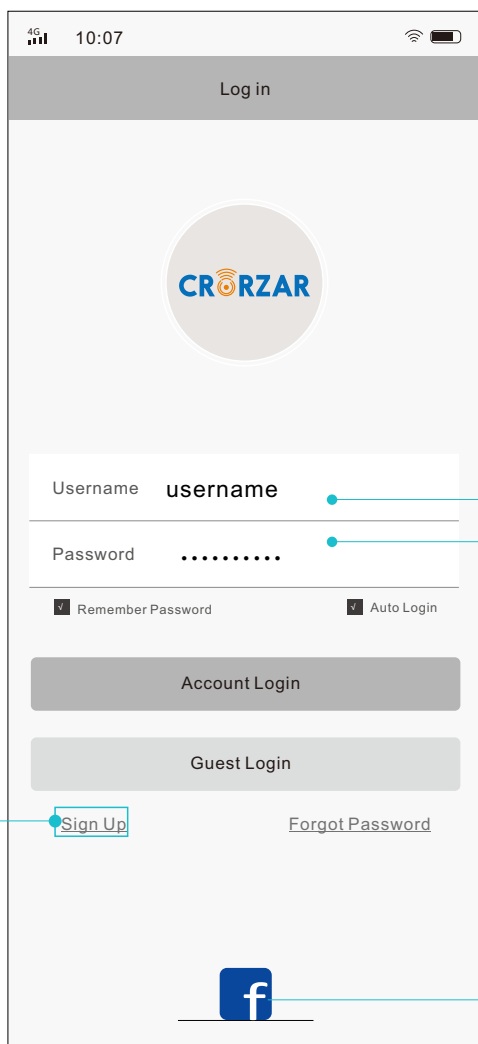

Configure network connection for camera (through WIFI)

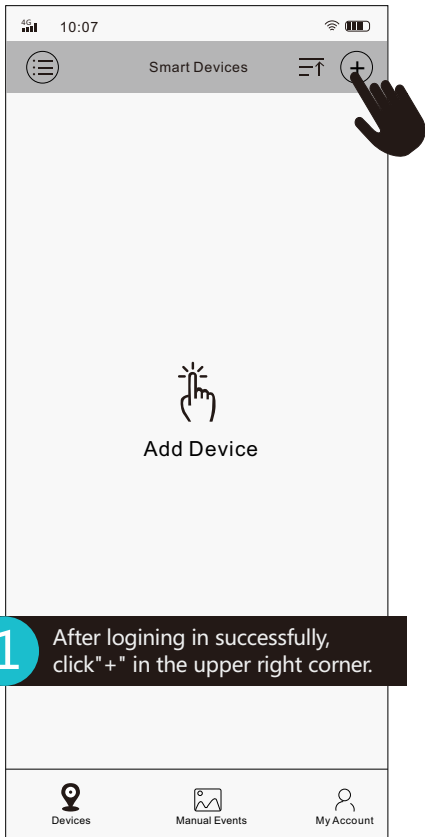

1 After logging in successfully, click "+" in the upper right corner.

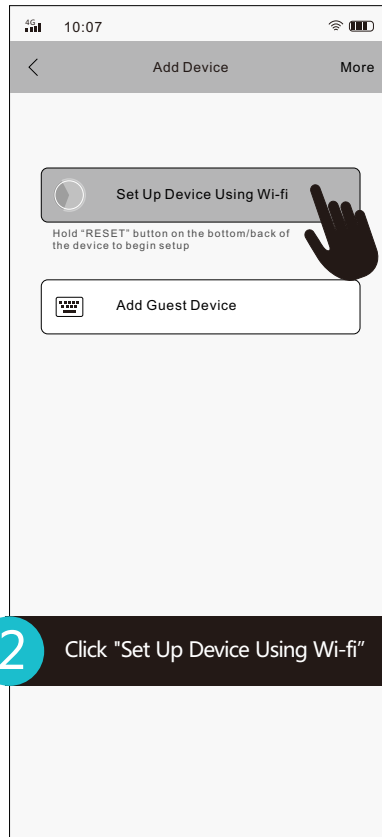

2 Click "Set Up Device Using Wi-fi"

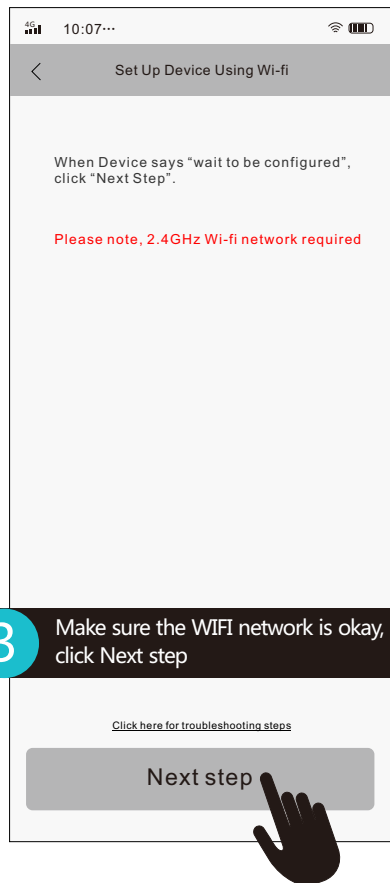

3 Make sure the WIFI network is okay, click Next step

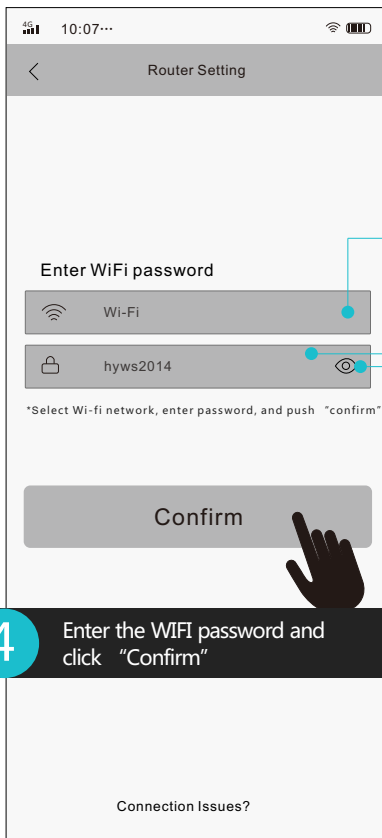

4 Enter the WIFI password and click "Confirm"

Make sure your device is connected to the same WIFI network that you wish the camera to connect to

Make sure WIFI password is correct

Click "eye" to check whether the WIFI password is visible or not

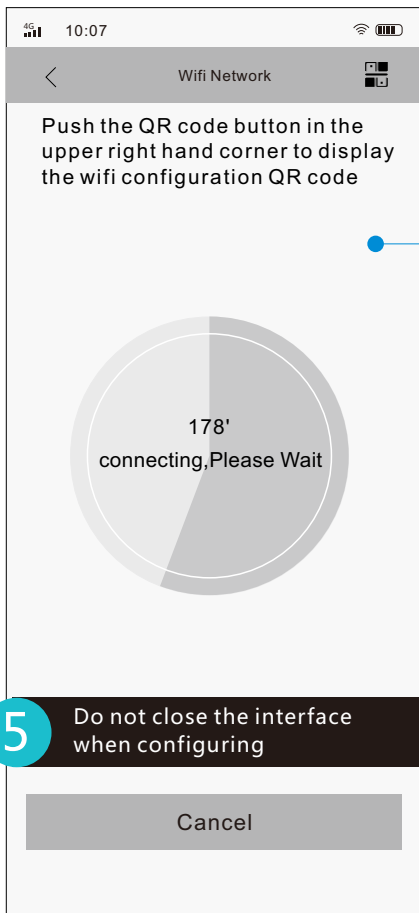

Push the QR code button in the upper right hand corner to generate a configuration code on your device. Hold this code a few inches from the camera lens for a few seconds to initiate camera setup. Hold the QR code in place until you hear 2 prompts. The first will say "Connecting, please wait" , and the second will say "Connect to router successfully" . HOLD THE QR CODE IN FRONT OF THE LENS UNTIL YOU HEAR BOTH PROMPTS.

If you do not hear both prompts after 1 minute, press and hold the reset button on the back of your camera for 5-10 seconds until you hear a prompt indicating that the camera is restoring to factory settings. Restart the learn in process.

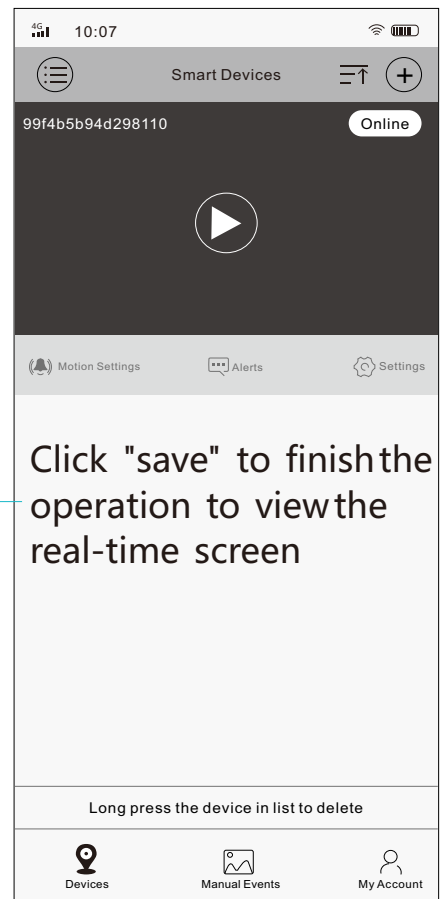
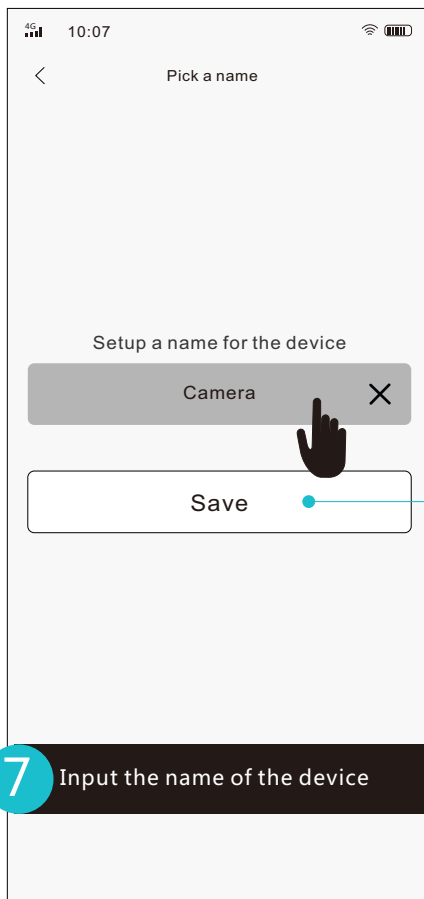
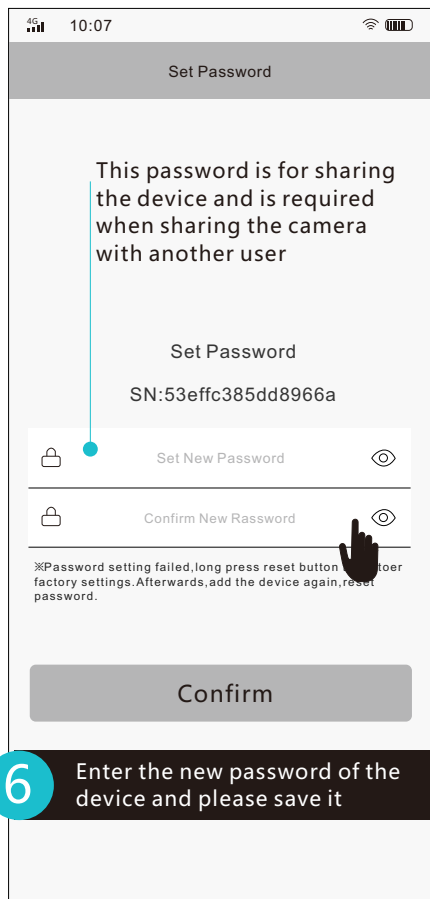

Manage cameras

Multiple cameras can be added on the App and all of them will show up on the main screen of the App, long press on an camera can lead to menu that user can share, set or delete the camera.

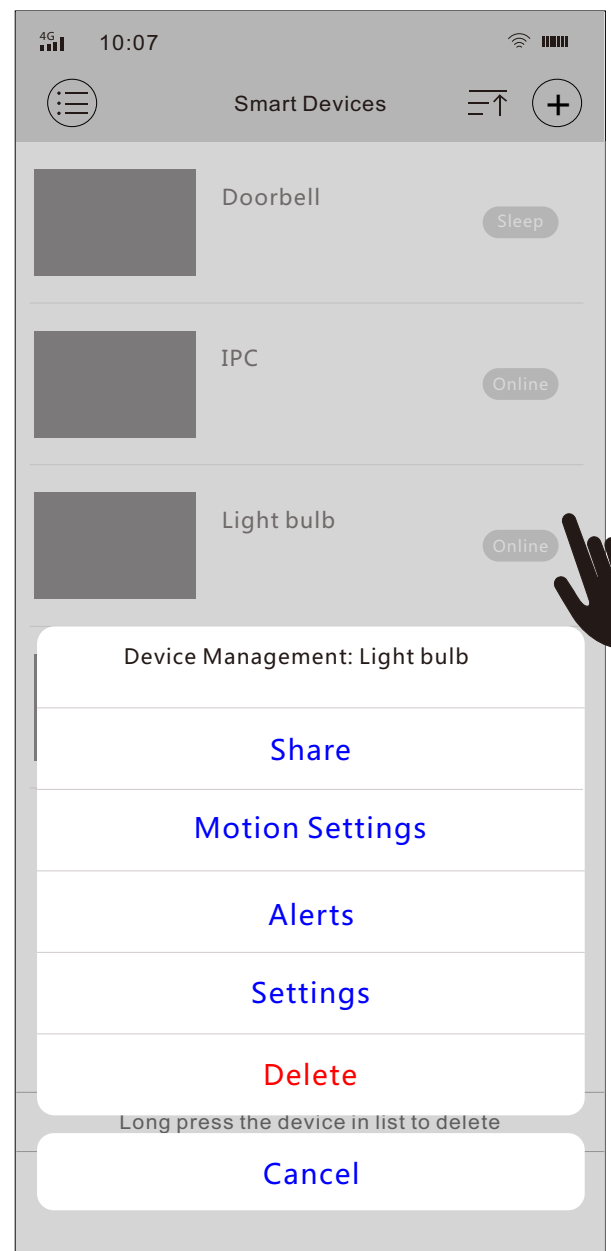
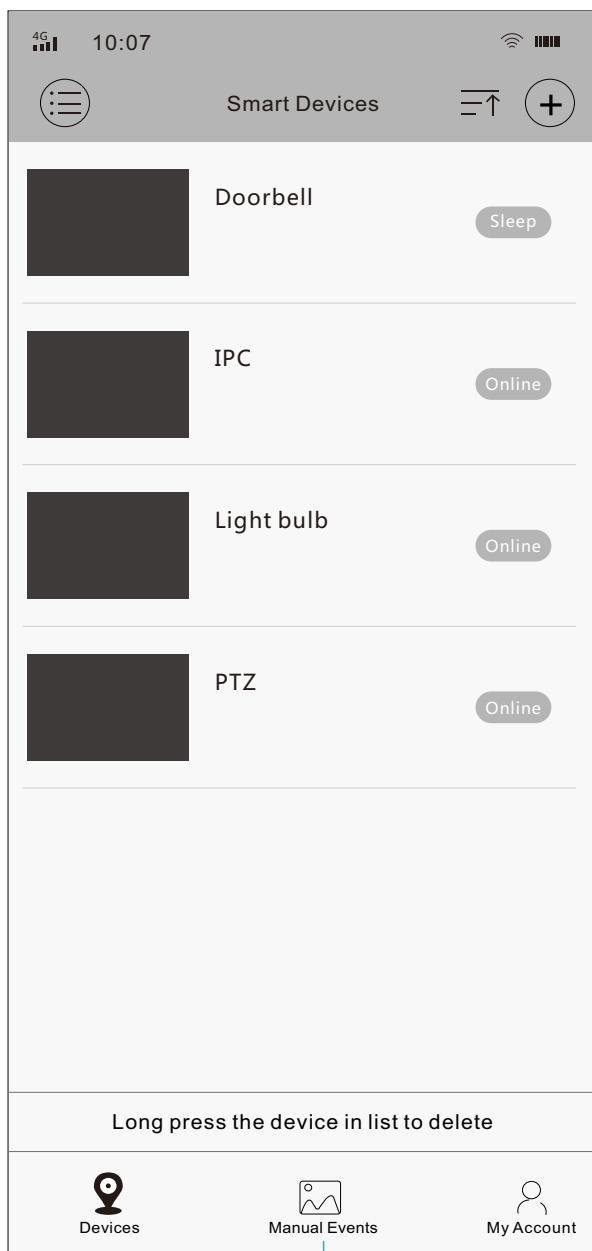

Access manually recorded events from all of your cameras

View the camera through App

User can achieve the real time monitoring through the camera once it is added successfully on App, there are also some functions available user can use on the page below.

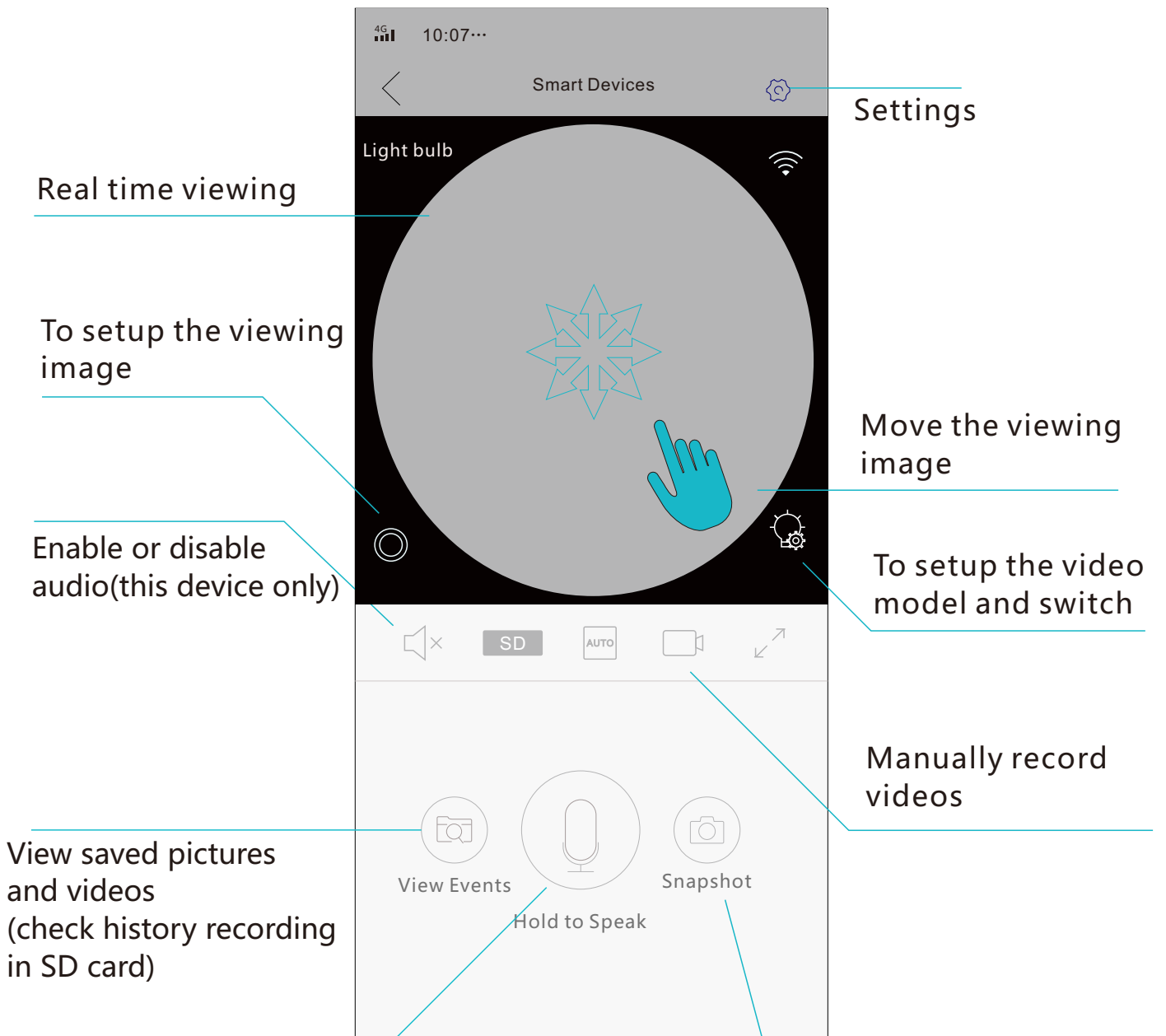

(Fig 1)

Hold it to speak through camera to talk to people in front of camera

Setup viewing image and video model

Press icon in Fig 2 to setup viewing image, press icon in Fig 3 to setup video model and switch.

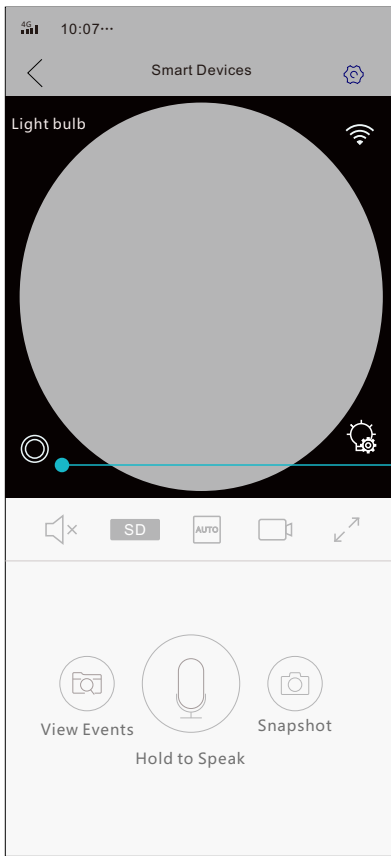

(Fig 2)

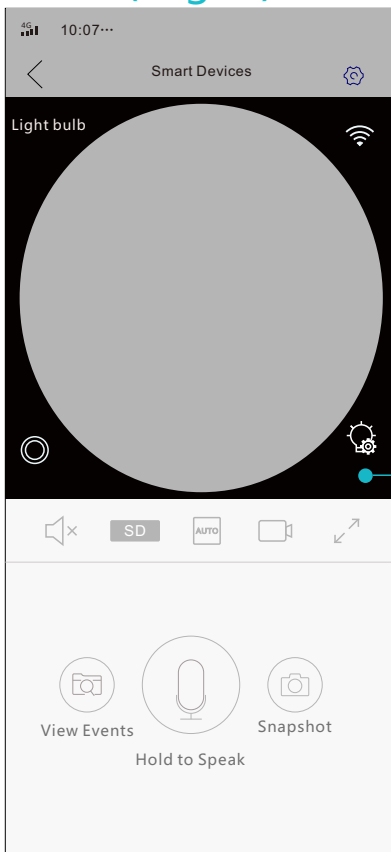
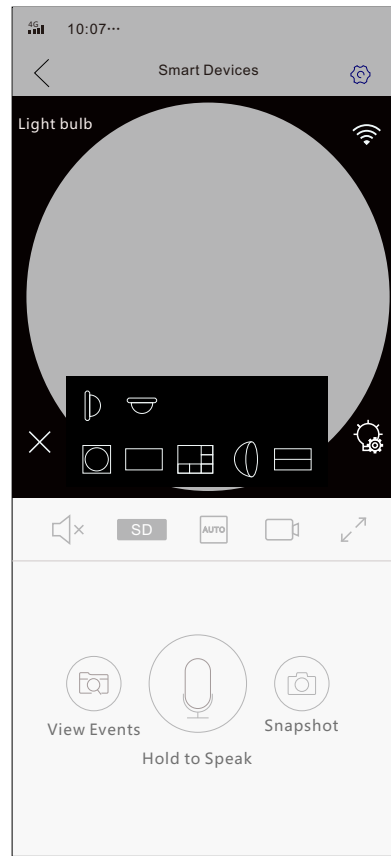

(Fig 3)

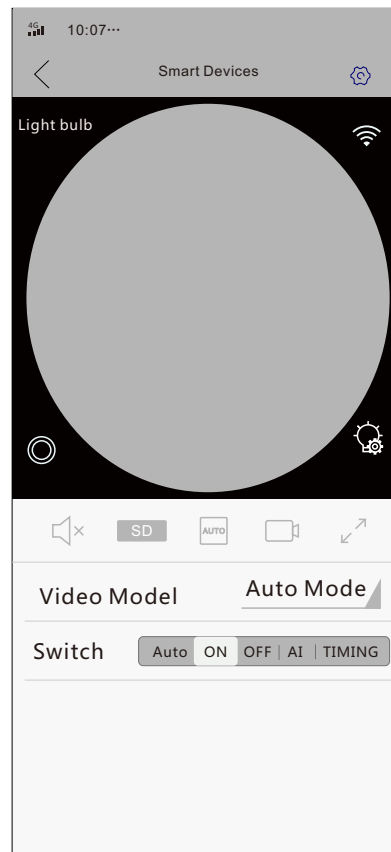

Camera Settings

User can setup the camera when necessary, press the “setting” icon in the upper right hand corner on Fig 1.

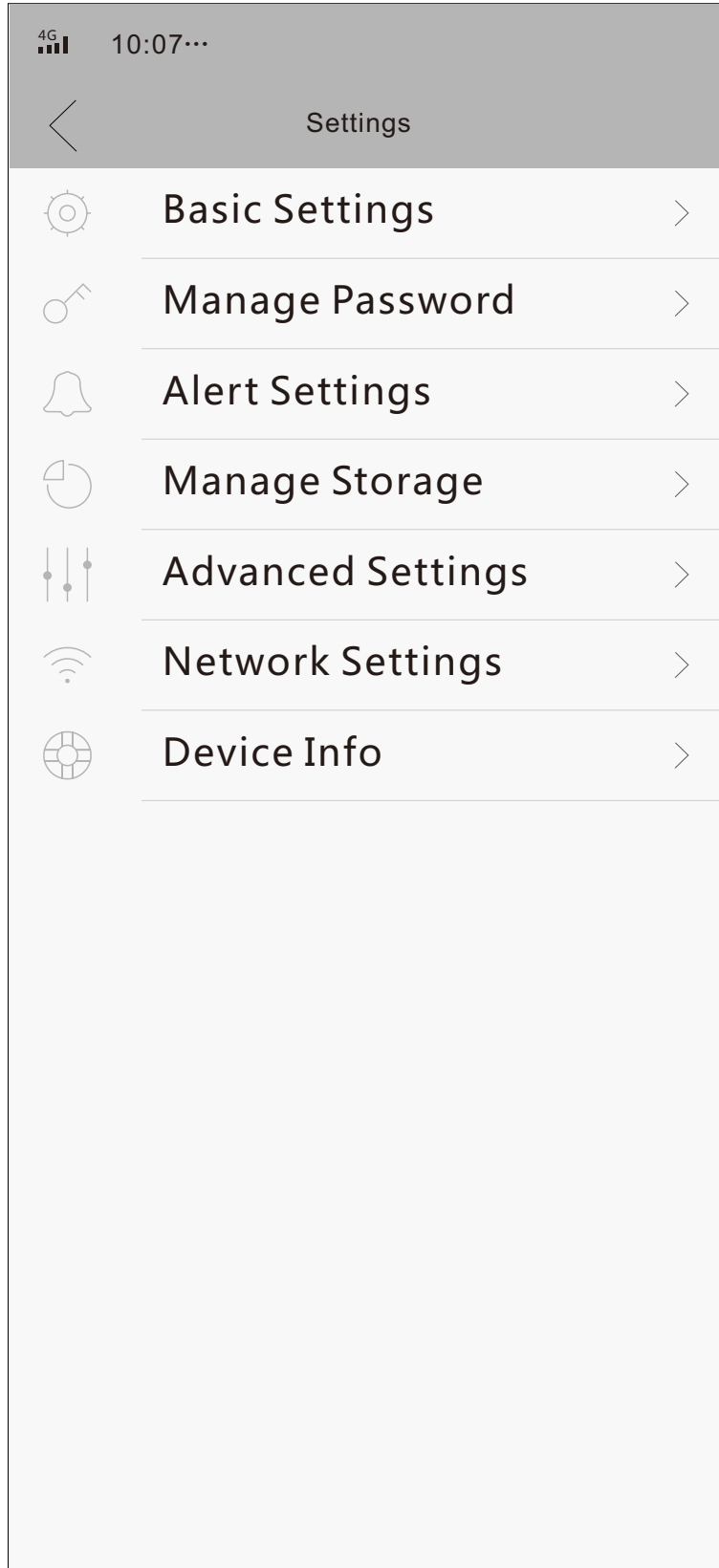

Basic Settings

Enable or disable voice prompts

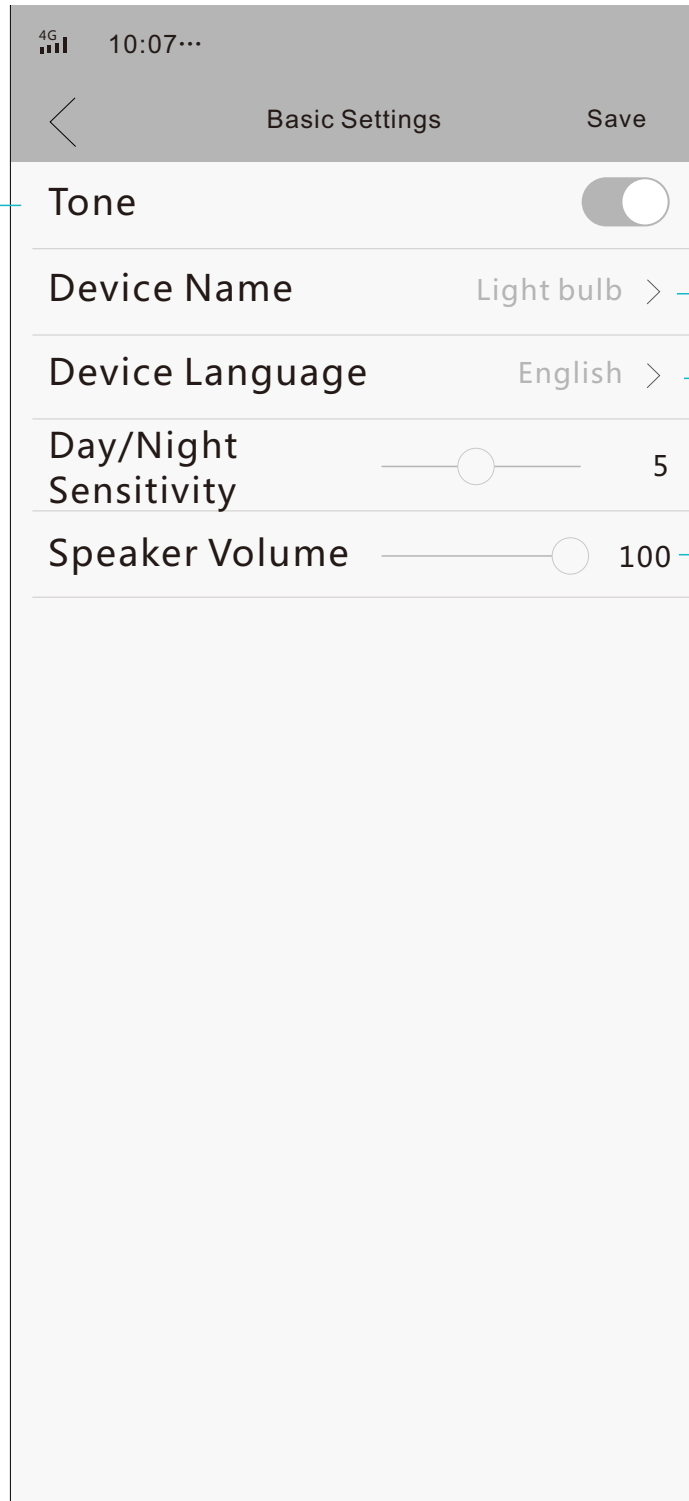

Change device name

Change device language

Change volume of speaker with camera

Manage Password

The screenshot shows a mobile application interface for setting a password. At the top, the status bar displays '4G' and '10:07...'. Below that is a navigation bar with a back arrow and the title 'Set Password'. The main content area contains three password input fields, each with a lock icon on the left and an eye icon on the right. The fields are labeled 'Current Password', 'New Password', and 'Confirm Password'. A 'Save' button is located at the bottom of the screen. Annotations with blue lines point to each of these elements.

Input current password

Input a new password

Input the new password again

Press "Save" to finish operation

Alert Settings

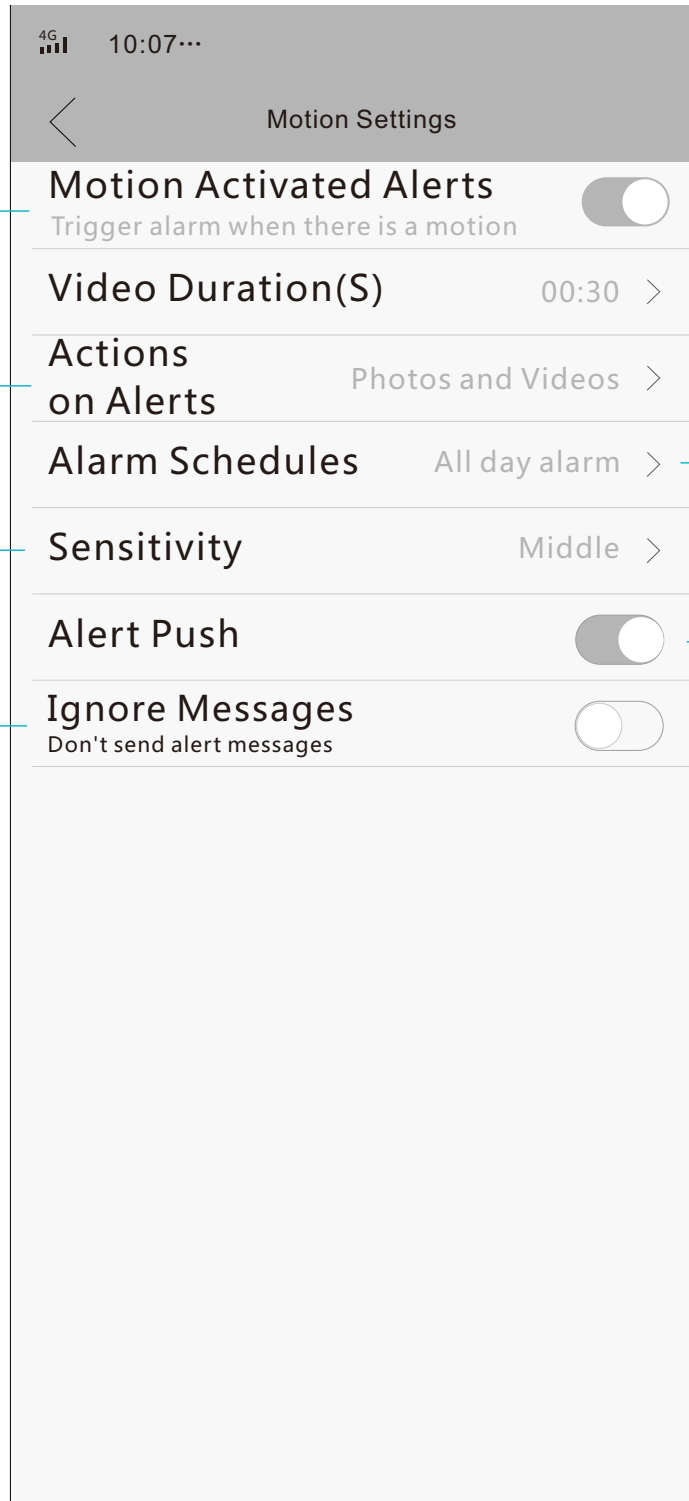

Enable or disable motion activated alerts

Change the actions on alerts

Change the sensitivity of motion detection

App on mobile phone will not receive alert messages if this is enabled

Set the time of video duration for recording upon alerts

Change the schedules for alarm

Enable or disable push notification for alerts sent from camera

Manage Storage

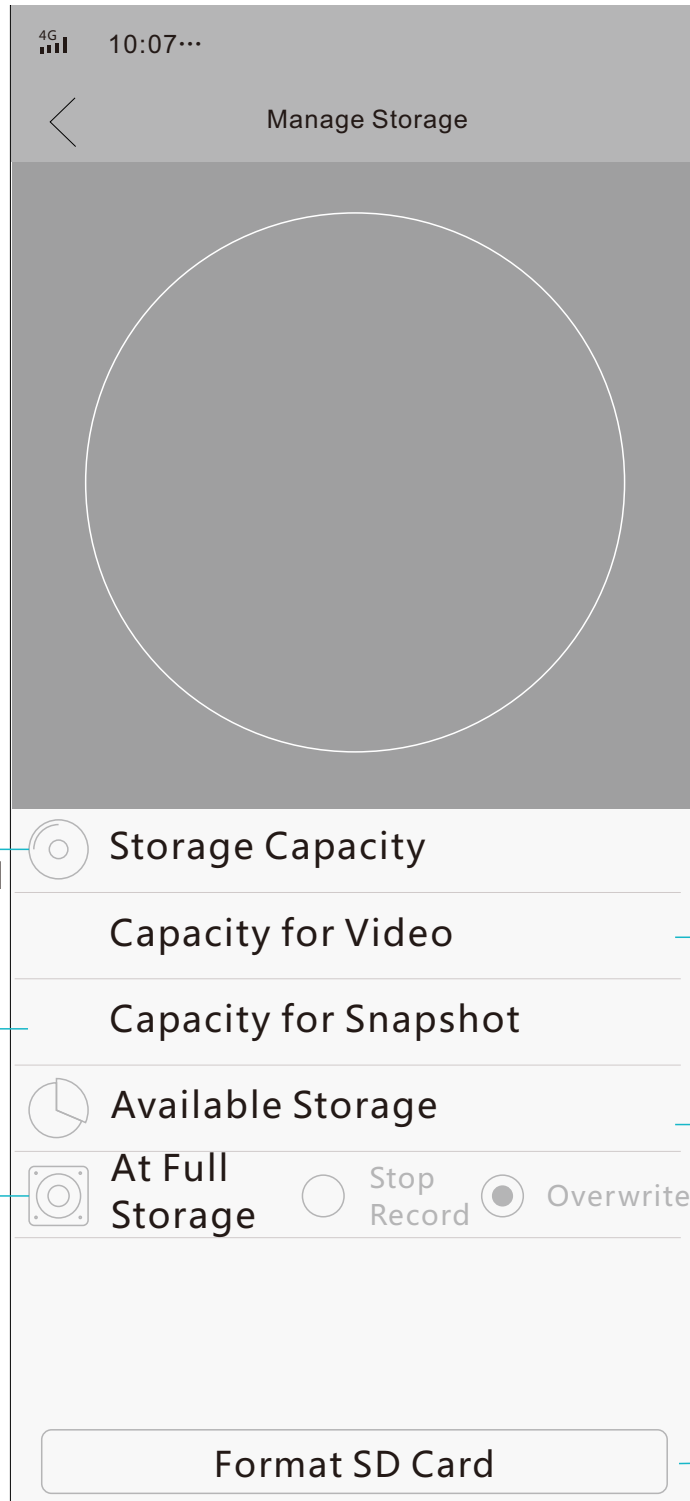

Check entire capacity of SD card

Check the storage capacity for snapshots on SD card

Set the action when SD card is full

Check the storage capacity for videos on SD card

Check the available storage on SD card

Format SD card

Advanced Settings

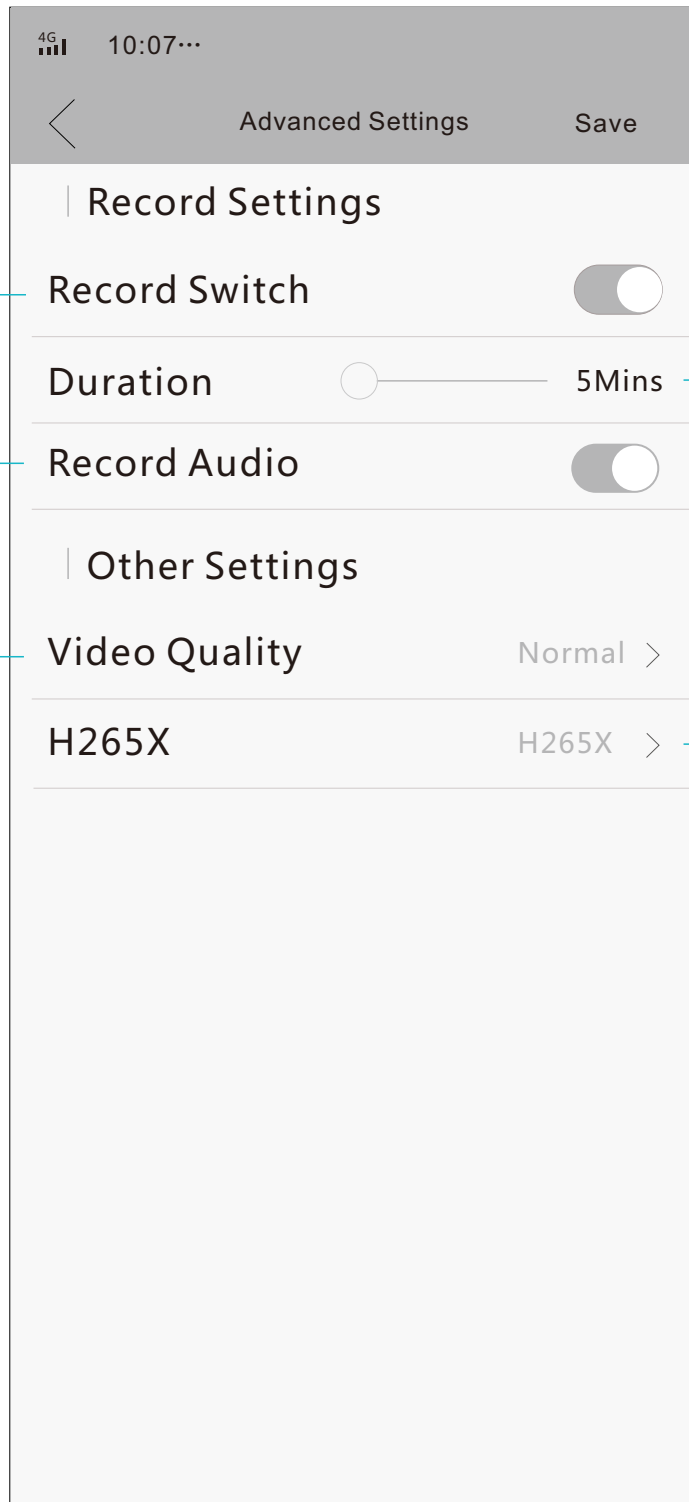

Turn on/off video recording on SD card

Enable or disable audio recording

Change video quality

Set the duration of video clips on SD card

Change video format

Network Settings

Select the network connection mode for camera

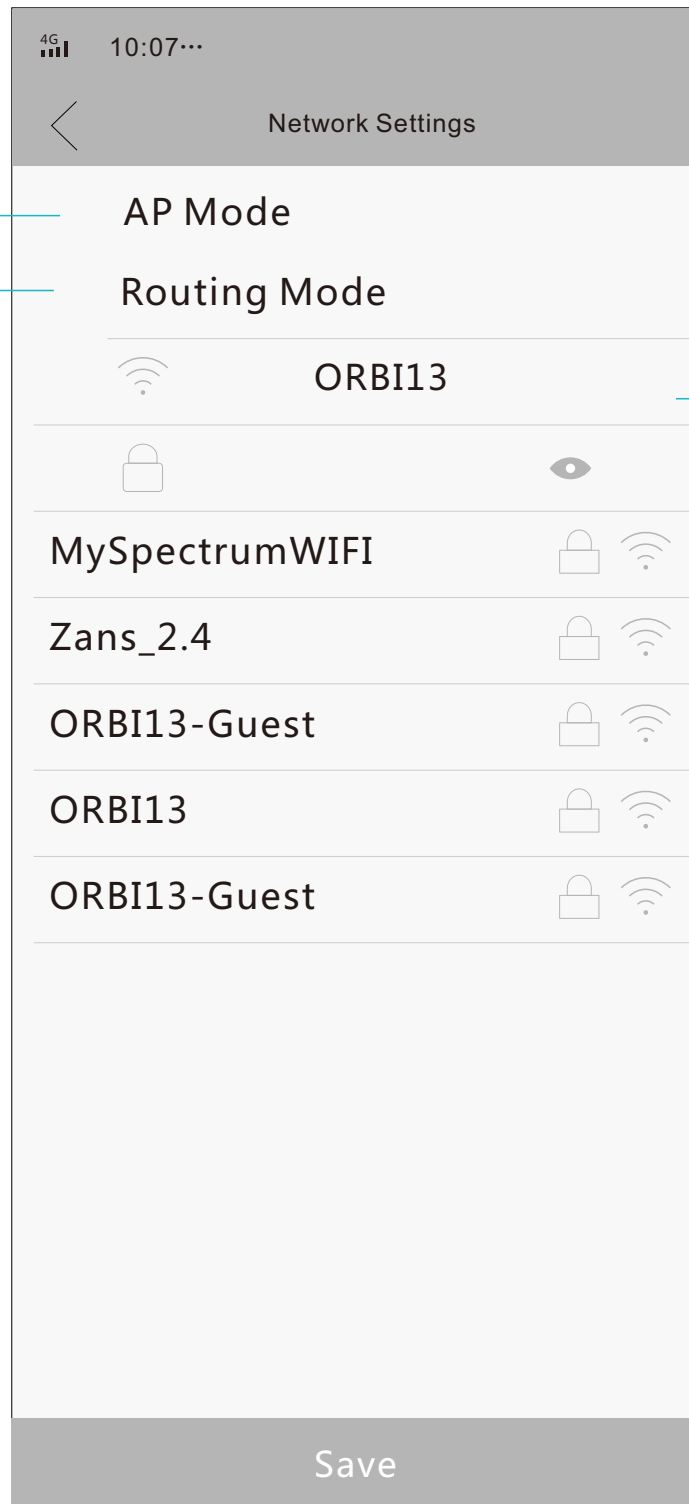

Select an available WIFI network for camera



1 (855) 700-2482

cs@crorzar.com

For questions or help, please contact us. Answers to frequently asked questions, as well as video demonstrations of setting up your camera, can be found at <https://www.crorzar.com/pages/cameras>