



**Green Lion**

## **G-Blade Hair & Nose Trimmer /Shaver**

SKU: GNGBLDTRIMGY

Model No: GL-TM

## Table of Contents

|                                   |    |
|-----------------------------------|----|
| Device Description                | 2  |
| Quick View                        | 3  |
| Introduction                      | 4  |
| Danger                            | 4  |
| Usage Instructions                | 4  |
| Shaving Instructions              | 6  |
| Attaching/ Detaching Attachments  | 6  |
| Grooming facial hair (nose hair)  | 7  |
| Trimming Nose Hair                | 7  |
| Changing Shaving Head             | 8  |
| Environmental Disposal Guidelines | 8  |
| Specification                     | 8  |
| Disposal                          | 10 |
| Warranty                          | 10 |
| Contact Us                        | 10 |

## Device Description

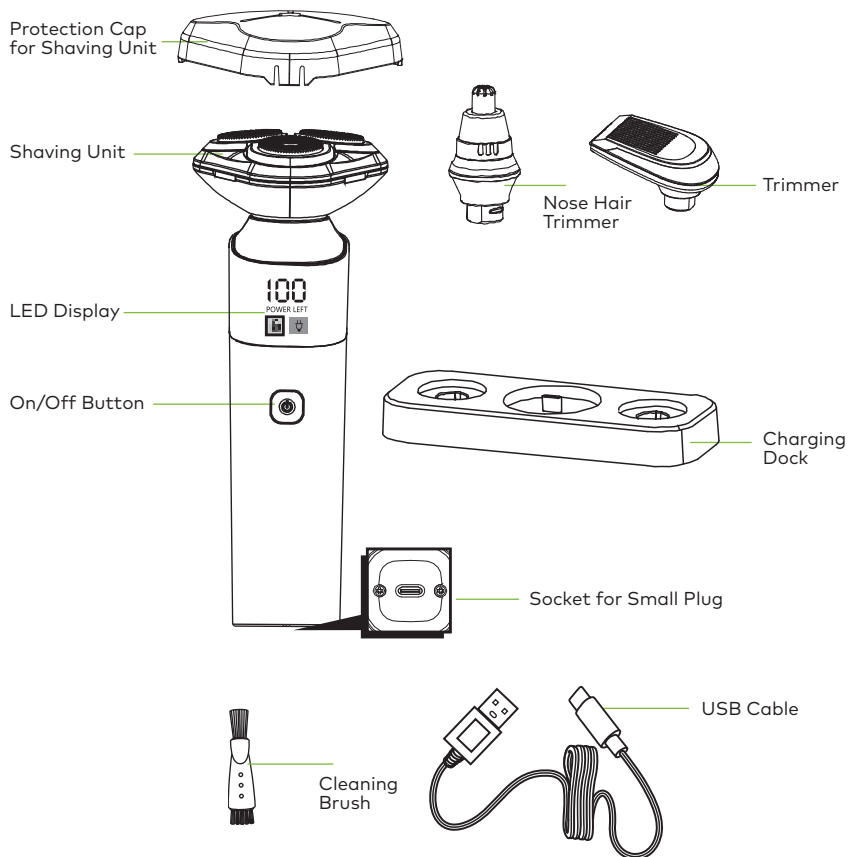



## Introduction

Thank you for choosing our electric shaver. This product is designed for efficient and comfortable shaving. Please read this booklet carefully before using the shaver to ensure proper usage and maintenance for optimal performance.

The accessories supplied may vary for different products. The box shows the accessories that have been supplied with your appliance. Please read this booklet carefully before using the shaver.

## Danger

Make sure the charging adapter and connector do not get wet. The shaver is washable and can be cleaned under the tap. Do not wash the shaver with water hotter than 60°C (Fig. 1). Please take good care of the instructions for future reference.

## Usage Instructions

### Charging:

- The shaver should be charged within a temperature range of 5°C to 35°C.
- Do not charge it in the sun or near a warmer (Fig. 2).
- It is recommended to use DC 5V 1A charging equipment to charge this product.
- Do not use quick chargers such as 9V or 12V, as they may shorten the battery lifespan or cause damage.
- Do not charge the appliance for more than 10 hours.
- Charging takes approximately 2 hours.
- When the appliance is fully charged, it has an operating time of 90 minutes.

- 1.Ensure the appliance is switched off.
- 2.Insert the end of the power line into the socket of the shaver and plug the power supply into the main socket. The battery charge percentage and the plug symbol will light up to indicate that the appliance is charging (Fig. 3).
- 3.After charging, please take care of the USB for spare use. Once the power cord is damaged, it must be replaced by the manufacturer or an after-service center.
- 4.Optimizing the lifetime of rechargeable batteries: Discharge the rechargeable batteries completely twice a year by letting the motor run until it stops. Then fully recharge the batteries.

#### Display:

-When the appliance is charging, the battery charge percentage and the plug symbol will light up to indicate that the appliance is charging (Fig. 3).

-The remaining battery capacity is indicated by the battery charge percentage shown on the display.

#### Battery Fully Charged:

When the battery is fully charged, the battery availability time display lights up in full 100 %(Fig. 5).

At this point, the external charger can be unplugged from the power source.

#### Battery Low:

When the battery is almost empty, the plug symbol starts to flash (Fig. 6).

#### Cleaning Reminder:

For optimal shaving performance, we advise you to clean the shaver after every use.

#### Travel Lock:

You can lock the shaver when you are traveling. The travel lock prevents the shaver from being switched on accidentally.

### Activating the Travel Lock:

Press the on/off button for 3 seconds to enter the travel lock mode. When you activate the travel lock, the travel lock symbol will light up on the screen (Fig. 7).

### Deactivating the Travel Lock:

Press the on/off button for 3 seconds. The travel lock symbol will be extinguished (Fig. 7).

The shaver is now ready for use again. You can also deactivate the travel lock by connecting the appliance to the mains.

## Shaving Instructions

Press the switch on/off button to switch on the shaver.

Rapidly move the shaver back and forth against the growing direction of the beard (Fig. 8 ,9 ,10).

The shaving is best when the face is dry. So please shave before or some time after the face washing.

It will take some time for your skin to get used to the shaving device.

Hair on the neck can also be shaved in this way.

Press the switch on/off button to switch off the shaver. Cover with the protector cover to avoid damage (Fig. 11).

Don't use it if the shaving head is damaged, as it may hurt your skin.

## Attaching/Detaching Attachments

All attachments (shaving unit, trimmer attachment and nose/hair trimmer) can be attached and detached in the same way.

Pull the shaving unit straight off the appliance (Fig. 12).

Insert the trimmer attachment into the top of the shaver. Then press down the unit to attach it to the appliance "click" (Fig. 13).

## Trimming Nose Hair

-Trimming Nose Hair

1. Make sure your nostrils are clean.
2. Switch on the appliance and insert the tip of the trimmer into one of your nostrils. Do not insert the tip more than 0.5cm into your nostril.
3. Slowly move the tip in and while turning it round at the same time to remove unwanted hair.
4. To reduce the ticking effect, make sure that you press the side of the tip firmly against the skin.

## Cleaning & Maintenance

To ensure a better shaving effect, the shaver must be cleaned regularly.

**Note:** Waterproof, dustproof features are not permanently effective and may decline due to daily wear and tear. Damage due to immersion in liquids is not covered by warranty.

1. Make sure the appliance is switched off and disconnected from the mains.
  2. Pull the blade holder removal opening and remove the shaver parts (Fig. 14).
  3. The shaver parts can be washed directly under the faucet, and the charging port should be kept dry when the fuselage is washed (Fig. 15).
  4. After rinsing, drain the water from the razor and place it horizontally in a ventilated area to dry.
  5. For best cleaning, please also add some lubricating oil every three months. The Lubricant oil is not included in this package. You need to purchase it separately (Fig. 16).
- You can clean them while washing the shaver heads and hair chamber by using the brush.



## Changing Shaving Head

Change the shaver head once a year to get the best shaving effect. The shaver has a long service life if not damaged by human factors. The damaged shaver head can only be replaced with a shaver head from this company.

1. Unscrew the knob on the shaving head set carefully. Remove the shaving heads from the shaving head holder and throw them away (Fig. 18 ,17).
  2. Place new shaving heads in the holder. Fix up the shaving heads set on the unit by screwing the knob (Fig. 20 ,19).
- Note:** Make sure the notches on both sides of the shaving heads fit exactly on the shaving head holder

## Environmental Disposal Guidelines

1. To discard the product, please do not dispose of it with general household waste. Instead, hand it to the officially designated recycling center for environmental protection.
2. The built-in rechargeable battery contains substances that may pollute the environment, so it must be removed from the product or sent to the officially designated recycling center for disposal before the product is discarded (Fig. 21).

## Specification

|           |                       |
|-----------|-----------------------|
| Model No. | GL-TM49               |
| Material  | ABS + Stainless Steel |
| Blade     | Stainless Steel       |

|                    |                  |
|--------------------|------------------|
| Motor              | DC Brushed Motor |
| Battery            | 600mAh           |
| Power              | 5W               |
| RPM Range          | 3000 RPM         |
| Waterproof         | IPX7             |
| Charging Port      | Type-C           |
| Charging Time      | 2 Hrs            |
| Working Time       | 90 min           |
| Product Weight     | 174.1 g          |
| Product Dimensions | 60*65*165 mm     |



## Disposal

This product must not be disposed of as unsorted household waste. It is important to separate such waste for proper treatment and recycling, in compliance with local waste management regulations.

## Warranty

Products that you buy directly from our **Green Lion** website or shop come with a 24-month warranty.

When you buy **Green Lion** products from any of our approved sellers, you only get a 12-month warranty. If you want to extend this warranty, go to our website at <https://www.greenlion.net/warranty> and fill out the form with your information. Don't forget to upload a picture of the product too. After we've checked and accepted your request, we'll send you an email to confirm that your product's warranty has been extended.

For more info, please check:  
<https://www.greenlion.net/warranty>

## Contact Us

If you have any questions about this Privacy Policy, please contact us at:

Website: <https://www.greenlion.net/>

Sales: [sales@greenlion.net](mailto:sales@greenlion.net)

Service Support: [Support@greenlion.net](mailto:Support@greenlion.net)

Telegram: [@greenlion\\_global](https://t.me/greenlion_global)

Instagram: [@greenlion\\_global](https://www.instagram.com/greenlion_global)