



WIRELESS HDMI DISPLAY TRANSMITTER & RECEIVER SET



DA-H1R1 SERIES USER MANUAL

FEATURES

- Display output up to 1080p@60Hz via H.264 encoding/decoding with HDMI 1.4a and HDCP 1.4 support
- Supports mirror and extend display modes in Windows, macOS, and Linux with audio transmission
- Low power consumption, designed for 1.5W
- Low latency and long distance, using 5GHz (802.11n) 1T1R Wi-Fi
- Channel Switch Announcement (CSA) to reduce interference
- Compatible with desktops, laptops, projectors, cameras, AV receivers, DVD and Blu-ray players, set-top boxes, and other compliant devices

PACKAGE CONTENTS

- Wireless HDMI Display Transmitter & Receiver Set
- User manual

PRODUCT OVERVIEW

Transmitter

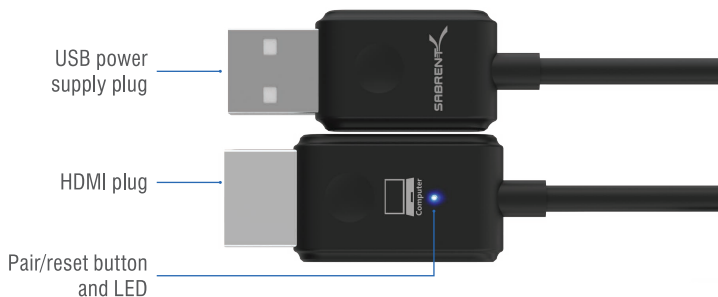

Receiver

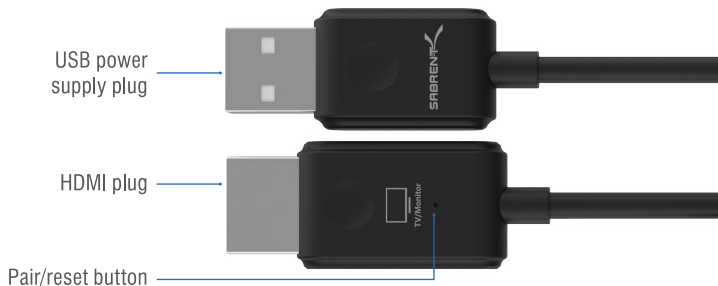

LED STATUS INDICATORS

Transmitter	Status	Description
LED Status	Solid	Device has successfully connected to the receiver and is operating properly
	Blinking (slow)	The device is ready and attempting to connect to the receiver
	Blinking (fast)	The device is pairing with the receiver
	Light off	The device has malfunctioned or lacks power

GETTING STARTED

How To use

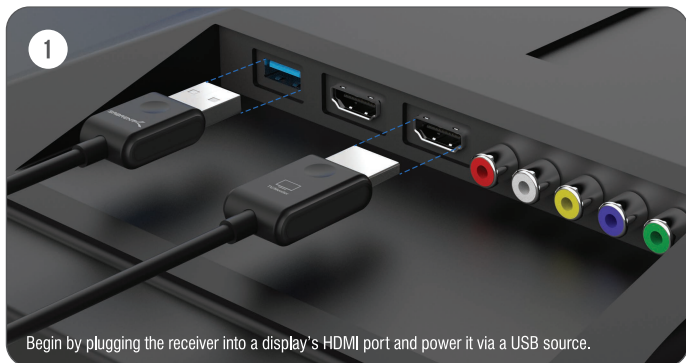

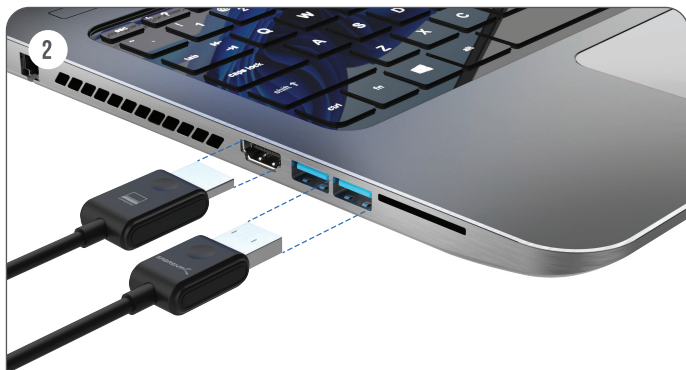

Next, plug the transmitter into the HDMI port on your device and power it via a USB source.



Your display should now work wirelessly. To stop and restart mirroring/extending your display, remove and replace the transmitter as needed.

How To Pair

1. Ensure that both the receiver and transmitter are connected and powered.
2. To initiate the pairing process, insert a paperclip into the receiver's pair/reset hole to press down and hold the button for approximately 2 seconds. The monitor will display "release the button to pair," at which point you can withdraw the paperclip.
3. When "ready to pair" appears on the screen, insert a paperclip into the transmitter's pair/reset hole. Press down and hold the button for approximately 5 seconds until the light turns off, indicating that pairing is complete. Your display should now work wirelessly.

Note: There are 2 modes for the reset button on the receiver - 2 seconds to turn on pairing mode, 10 seconds to reset the receiver to default.

FREQUENTLY ASKED QUESTIONS

Q. I've plugged in the transmitter and receiver, but my display is not working wirelessly. What should I do?

A. First, ensure that both the transmitter and receiver are adequately powered by 5V/1A or better USB sources. Double-check the HDMI connections as well as the input selection on your display. If the issue persists, try removing and replacing the transmitter to reestablish the connection. You can also try re-pairing the set.

Q. What range should I expect?

A. The wireless range depends on many factors such as physical obstructions and interference. Operating on the 5GHz frequency, this product automatically adjusts channels for optimal range. While it can cover a significant distance in clear environments, noisy spaces or obstacles may limit the range, requiring careful placement.

Q. Does this work with adapters?

A. This will work with many adapters but has the same limitations that a native HDMI cable would have.



FOR HELP, COMMENTS, QUESTIONS OR CONCERNS
PLEASE CONTACT OUR TECH SUPPORT TEAM VIA OUR WEBSITE
WWW.SABRENT.COM