

**BILT HARD**

**OWNER'S MANUAL**

**20 INCH OSCILLATION PEDESTAL FAN**

SKU: HFC-0503/HFC-0504

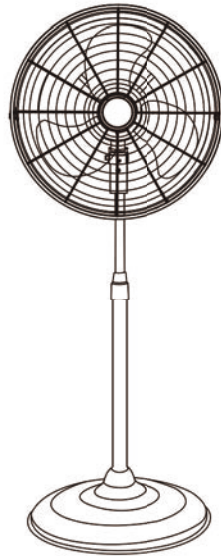

**READ & SAVE THESE INSTRUCTIONS**

**SAFETY INFORMATION**

**WARNING**

1. Read and save these instructions. Do not operate fan unless you have read these instructions.
2. Unplug the fan before moving it or performing maintenance. Do not touch the fan when your hands are wet.
3. Those who are not qualified electricians should not disassemble, repair or rebuild the fan.
4. Unplug the fan when it is not in use.
5. DO NOT unplug the fan by pulling the cable cord. Unplug by holding the plug and pulling.
6. DO NOT use the fan when there is damage to the cable cord or plug. If the supply cord is damaged, it has to be replaced by the manufacturer, its service agent or similarly qualified persons.
7. DO NOT use the fan with extension cord.
8. DO NOT use the fan close to fires.
9. DO NOT insert your hand or other objects into the grille or the movable parts.
10. To reduce the risk of fire or electric shock, do not use this fan with any solid-state speed control device.
11. DO NOT use this fan outdoors, this fan is designed for indoor use only.

**CAUTION**

1. Unplug the fan from the socket and clean it with a soft cloth.
2. DO NOT immerse the fan.
3. Fit the guard onto fan before starting up the fan.
4. This fan is not intended for use by people (including children) with reduced physical, sensory or mental capabilities or lack of experience and knowledge unless they have been given supervision or instruction concerning use of the fan by a person responsible for their safety. Supervise children to ensure they do not play with the fan.

1

**ASSEMBLY INSTRUCTION**

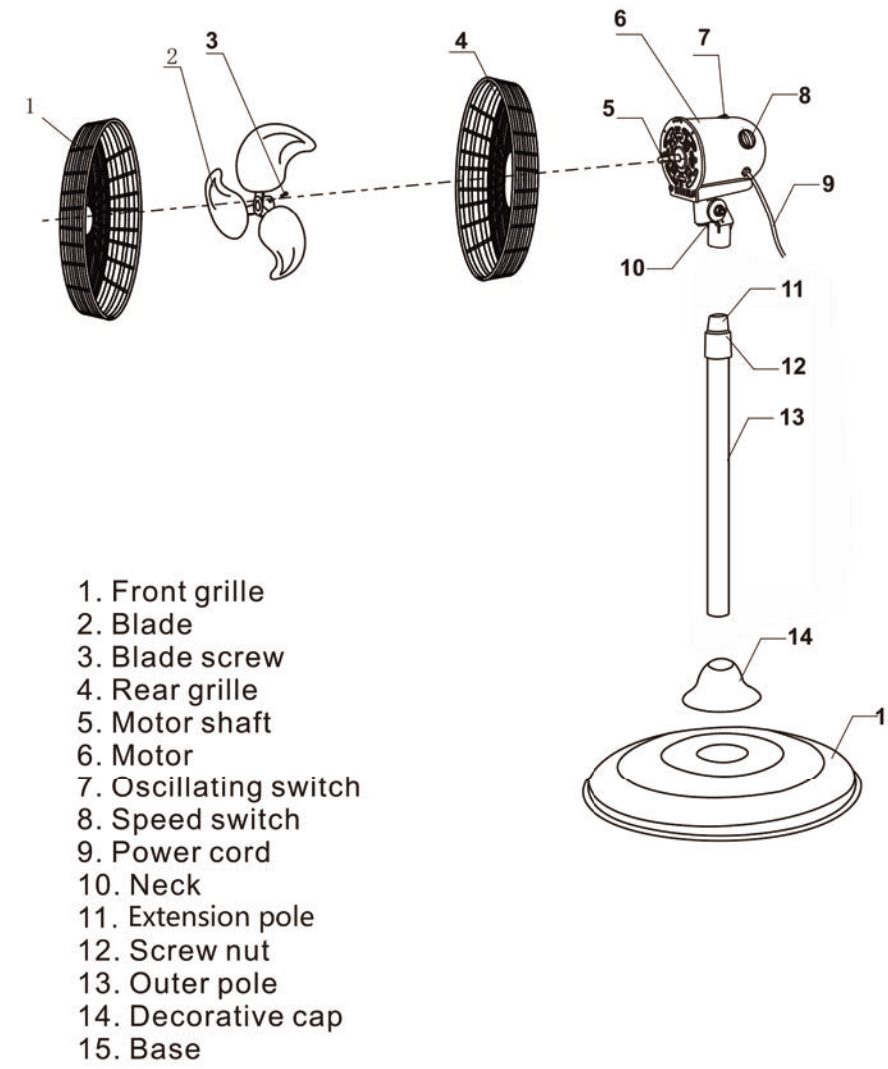

2

**Simple assembly is required to use this fan.**

1. Insert the end of the outer pole into the base hole, align the screw holes on the base and the outer pole, then insert the screws through the holes, and tighten them up with nuts under the base. Fig.1 and 2.
2. Loosen the extension pole nut onto the outer pole. Fig. 3.
3. Insert the cap through the outer pole. Fig. 4.
4. Thread extension pole nut onto threads of inner pole.
5. Take fan motor housing and insert in into inner pole, tighten the neck set screw securely. Fig. 5.
6. Remove four mounting screws from motor housing where indicated to use for rear guard then assemble rear guard onto motor housing using screws, tighten the 4 screws securely. Fig. 6 and 7.
7. Place fan blade onto motor shaft. Tighten blade by set screw securely on flat surface on motor shaft. Fig. 8.
8. Attach front guard to rear guard with hook clip centered on the top above wire handle. Press remaining guard clips onto rear guard to securely attached front guard. Do not operate fan without guard in the place. Fig.9 and 10.

Fig.1

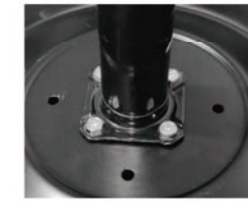

Fig.2

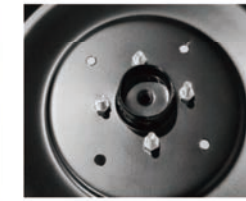

Fig.3



Fig.4



3

Fig.5



Fig.6



Fig.7



Fig.8



Fig.9



Fig.10



**OPERATION INSTRUCTION**

**SPEED CONTROL:**

Select air speed by setting switch at the back of the fan Low, Medium and High speed for desired air movement. It is normal for the motor to feel warm to the touch after continuous operation. This fan features a thermostat that will automatically shut off it when overheats to 135°C for any reason. If it happens, unplug the fan from the outlet immediately.

**OSCILLATION CONTROL:**

Control the fan oscillation by pressing the rocker switch on the fan motor housing.

4

**SERVICING INSTRUCTION**

1. Unplug the fan by gripping the plug directly.
2. Open fuse cover.
3. Select a suitable tool, small flat screwdriver or similar tool, and insert the tip of the tool into the gap of the plug face.
4. Press the tool down, then pry the protection door of the fuse out until the fuse out until the fuse is fully accessible.
5. Carefully remove the fuse.
6. To avoid risk of fire, make sure replacement fuse is a 5 Amp 125V Fuse.
7. Place the new fuse in the slot and carefully press down by pushing gently on the copper caps on either side. Be careful not to push too hard to avoid damage to the fuse.
8. Close fuse cover. Push the protection door back into place. If the door will not go back into original place, ensure that the fuse is properly situated. Be careful not to force the door as this could damage the fuse or the door.



**CARE AND MAINTENANCE**

1. Unplug the appliance before cleaning.
2. Do NOT use water directly on the fan for cleaning metal surfaces. Never immerse the fan or any wires in water.
3. Slightly moisten a cloth and then wipe off the surface of the fan. In order to remove the dust from the grill, use a vacuum cleaner or remove the front grill by removing the securing screw on the edge of the grill with a screwdriver.
4. After cleaning, remount the grill and fasten the securing screw on the edge of the grill.

5