

Redmi Buds 3 Lite

User Manual

Redmi

Read this manual carefully before use, and retain it for future reference. Illustrations of product, accessories, and user interface in the user manual are for reference purposes only. The actual product and functions may vary due to product enhancements.

Product Overview

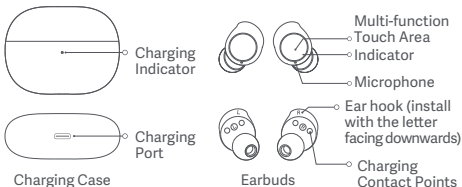

Charging

- Before use, please remove the protective film from the contact points on both earbuds and fully charge the charging case and the buds.

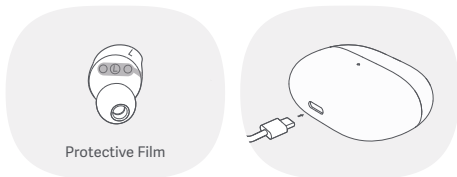

- Connect the charging cable to the charging case and keep the earbuds inside the case to charge simultaneously.
- When the charging case is not fully charged, its indicator is white. When it is fully charged, its indicator is off.

Turning On

Make sure the charging case is not out of battery with earbuds in it. The earbuds will automatically turn on when removed from the charging case.

Turning Off

- Make sure the charging case is not out of battery. Place both earbuds in the charging case and the indicators on them will turn white. The earbuds will automatically disconnect and start charging, and turn off once being fully charged.
- When the earbuds enter the pairing state and are out of the charging case, they will be automatically turned off if not connecting to any device within 10 minutes.

Wearing

- Gently place the earbud into your ear canal, then adjust it to a comfortable position.
- During calls, make sure to point the primary microphone towards your mouth for clearer calls.

Note: The M-size ear tips and L-size ear hooks are pre-installed on the earbuds. If they are not suitable, please replace them with a proper size.

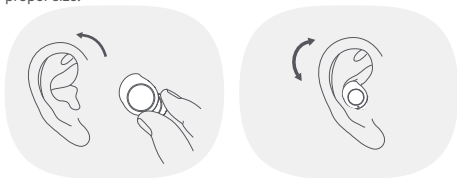

Connection

First time connection

Open the lid and take out the earbuds. When the indicators on both earbuds slowly blink white, it means the earbuds can be connected. Enable the Bluetooth function on your phone, and then search and tap "Redmi Buds 3 Lite" to connect the earbuds.

Note: If the earbuds cannot be connected, place them back into the charging case, close the lid and repeat the above operation.

Connecting to other devices

Disable the Bluetooth connection of the paired phone or reset the earbuds to connect to other devices.

Reset Earbuds

If the earbuds cannot connect properly, please carry out the following steps to reset them. Make sure the charging case is not out of battery before reset. Open the lid of the charging case and place both earbuds in the case. Press and hold the multi-function touch areas on both earbuds for at least five seconds and then release. Indicators on both earbuds will blink white three times, indicating the earbuds have been reset successfully. (The connection records between the left and right earbuds, and the earbuds and the phone have been cleared.)

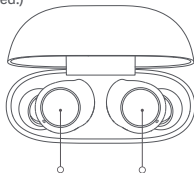

Press and hold both earbuds for 5 seconds simultaneously

Function Overview



Answer/End calls

Double tap the left/right earbud's multi-function touch area to answer a call; and tap the left/right earbud's multi-function touch area three times to decline or hang up the call.

Play/Pause music

Press and hold the left/right earbud's multi-function touch area to pause/play the audio.

Play next track

When playing audio, double tap the earbud's multi-function touch area to play the next track.

Answer a second call

Double-tap the left/right earbud's multi-function touch area to put the ongoing call on hold and answer the incoming call. After answering the second incoming call, double-tap the multi-function touch area to switch between the two calls. And tap the left/right earbud's multi-function touch area three times to hang up the current call and answer the call on hold.

Wake up the phone's voice assistant

When wearing the earbuds (not during a call), tap the multi-function touch area three times to wake up the voice assistant.*

* The device connected to the earbuds needs to support the voice assistant function.

Switch between single/dual bud mode

When both buds are connected successfully, they are in dual-bud mode. If place one of the buds back into the charging case and close its lid, the other bud will automatically enter the single-bud mode.

When removing the second bud from the charging case, the dual-bud mode will automatically be restored again.

Automatic connection

Once the earbuds are taken out of the charging case, they will automatically connect to the most recently used Bluetooth device. If the earbuds are not connected to any device, they will automatically enter the awaiting connection mode.

Disconnected

When the device's Bluetooth is disabled or when it manually disconnects from the earbuds, the earbuds will automatically enter the awaiting connection state. If no device is connected within 10 minutes, the earbuds will turn off automatically.

Low latency mode

When the earbuds are connected to the phone (not during a call), simultaneously press and hold the multi-function touch areas of the left and the right earbuds to enable the low latency mode. Once the low latency mode is enabled, simultaneously press and hold the multi-function touch areas of the left and the right earbuds or put both earbuds into the charging case to disable the low latency mode.

Note: Once the weather is cold outdoors and your hands become dry, the buds may not function when touching them.

Specifications

Name: Wireless Earphones

Model: M2110E1

Frequency Band: 2402–2480 MHz

Max RF Output Power: < 20 mW

Earbuds

Dimensions: 24.5 × 16.7 × 24.6 mm

Wireless Range: 10 m (in an obstacle-free environment)

Input: 5 V=50 mA

Wireless Connectivity: Bluetooth® 5.2

Charging Case

Model: M2110E1

Dimensions: 60 × 46 × 23.7 mm

Input: 5 V=300 mA

Output: 5 V=150 mA

Storage Temperature: 0 °C to 45 °C

Operating Temperature: 0 °C to 45 °C

Service Life: 1 year

Important Safety Information

- The product has a built-in battery that can not be removed or replaced. To avoid damage to the battery or the product, do not disassemble or modify the battery by yourself. The battery can only be replaced by the authorized service providers and must be replaced with the same type. Replacement of a battery with an incorrect type may defeat a safeguard (such as catching fire, explosion and leakage of corrosive electrolyte). Do not dispose of used batteries with household waste. Disposal of this product and the used batteries shall comply with local laws and regulations.
- Do not attempt to disassemble, repair or modify the product, as this may cause fire or even completely damage the product.
- Keep the product's indicator away from the eyes of children and animals while the product is in use.
- Do not disassemble, puncture or crush the product nor expose it to fire.
- Please stop using the product immediately and seek medical assistance if the contact area on your skin shows signs of redness or swelling.
-  To prevent possible hearing loss, do not use high volume for long periods of time.
- This product is not a toy and may contain small parts. Please keep them out of the reach of children.
- Disposal of a battery into fire or a hot oven or water or other liquids or mechanically crushing or cutting of a battery, that can result in an explosion.
- Leaving a battery in an extremely high temperature surrounding environment that can result in an explosion or the leakage of flammable liquid or gas.
- A battery subjected to extremely low air pressure that may result in an explosion or the leakage of flammable liquid or gas.
- Product information and certification marks are located in the Charging Case.
- = The symbol indicates DC voltage.

The Bluetooth® word mark and logos are registered trademarks owned by Bluetooth SIG, Inc. and any use of such marks by Xiaomi Inc. is under license. Other trademarks and trade names are those of their respective owners.



EU DECLARATION OF CONFORMITY

Hereby, Dongguan Yingsheng Electronic Technology Co., Ltd. declares that the radio equipment type M2110E1 is in compliance with Directive 2014/53/EU. The full text of the EU declaration of conformity is available at the following internet address:
<http://www.mi.com/global/service/support/declaration.html>



WEEE Information

All products bearing this symbol are waste electrical and electronic equipment (WEEE as in directive 2012/19/EU) which should not be mixed with unsorted household waste. Instead, you should protect human health and the environment by handing over your waste equipment to a designated collection point for the recycling of waste electrical and electronic equipment, appointed by the government or local authorities. Correct disposal and recycling will help prevent potential negative consequences to the environment and human health. Please contact the installer or local authorities for more information about the location as well as terms and conditions of such collection points.



Hereby, Dongguan Yingsheng Electronic Technology Co., Ltd. declares that the radio equipment type M2110E1 is in compliance with Radio Equipment Regulations 2017. The full text of the UKCA declaration of conformity is available at the following internet address: <https://www.mi.com/uk/service/support/declaration.html>

Complies With
IMDA Standards
DB106135



77150/SDPPI/2021
9003



Manufactured for: Xiaomi Communications Co., Ltd.

Manufactured by: Dongguan Yingsheng Electronic Technology Co., Ltd.
(a Mi Ecosystem company)

Address: Suite 204, 4th Block, No. 86 Hongtu Road, Nancheng
District, Dongguan, Guangdong, China.

For further information, please go to www.mi.com

User Manual Version: V1.0

Importer:

Beryko s.r.o.

Na Roudné 1162/76, 301 00 Plzeň

www.berkyo.cz