

WTA



Installation Guide



Ford Transit Shelf

It is crucial to ensure that all WTA products are assembled and securely attached to your vehicle. Failure to do so may result in automobile accidents, posing a significant risk of bodily injury or even death to yourself and others. As the owner, it is your responsibility to properly assemble and secure WTA products, diligently inspecting the mounting points and attachments before use, and regularly checking for any signs of wear or damage.

To guarantee optimal safety, we strongly advise engaging the services of a professional installer for the installation of any aftermarket accessories to your vehicle. If you lack mechanical experience or are unfamiliar with the installation procedures, it is imperative to have the product installed by a qualified professional or individuals who possess the necessary expertise. Remember, the responsibility lies with you, and it must be taken seriously to ensure the safety of all individuals involved.

PACKAGE CONTENTS

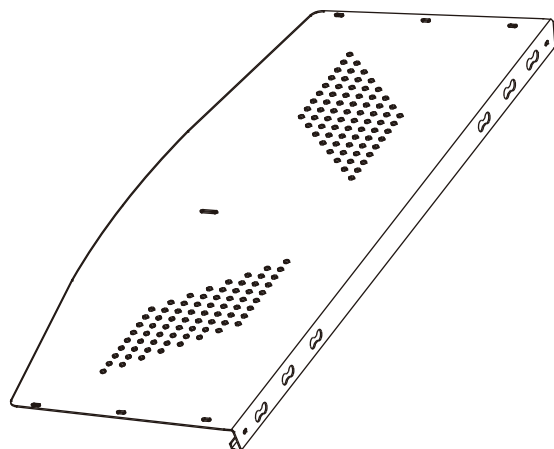

TRANSIT HEADLINER SHELF
QTY-1

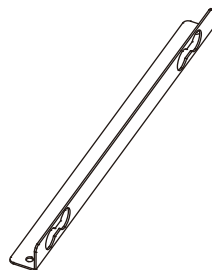

HEADLINER SHELF STIFFENER
QTY-2

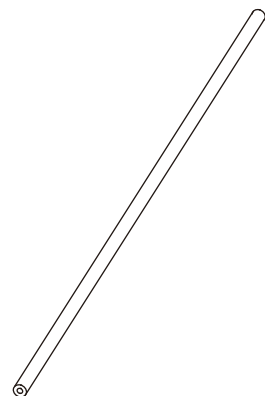

TRANSIT CURTAIN ROD
QTY-1

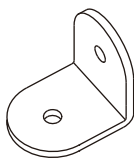

CURTAIN ROD BRACKET
QTY-2

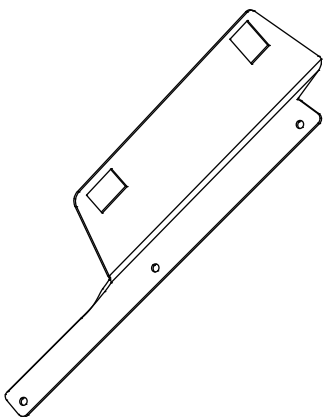

TRANSIT SHELF BRACKET LEFT
QTY-1

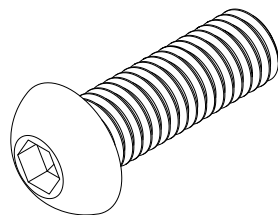

M5-15 BUTTON HEAD SCREWS
QTY-10

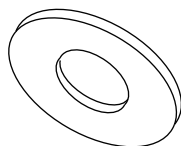

M5 WASHER
QTY-10

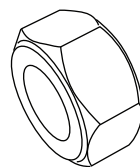

M5 NYLOCK NUT
QTY- 8

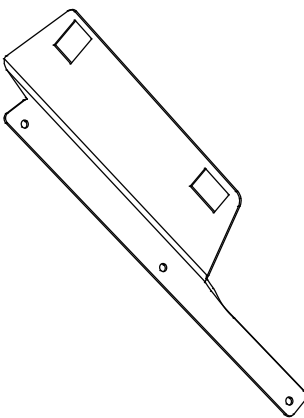

TRANSIT SHELF BRACKET RIGHT
QTY-1

LET'S GET STARTED!

FIGURE 1

1. FIRST REMOVE THE TWO SCREWS UNDER THE HANDLE ATTACHED TO THE SUN VISOR ON BOTH SIDES (SAVE THESE SCREWS AS YOU WILL USE THEM AGAIN)
2. SLIDE THE TRANSIT SHELF BRACKET BETWEEN THE HANDLE BASE AND THE HEADLINER ALIGNING THE BRACKET HOLES WITH THE SCREW HOLES (NOTE ONE BRACKET IS FOR EACH SIDE, THE LONGER THIN SECTION WILL POINT TO THE BACK OF THE VAN) YOU MAY NOW REINSTALL THE FACTORY HANDLE HARDWARE.

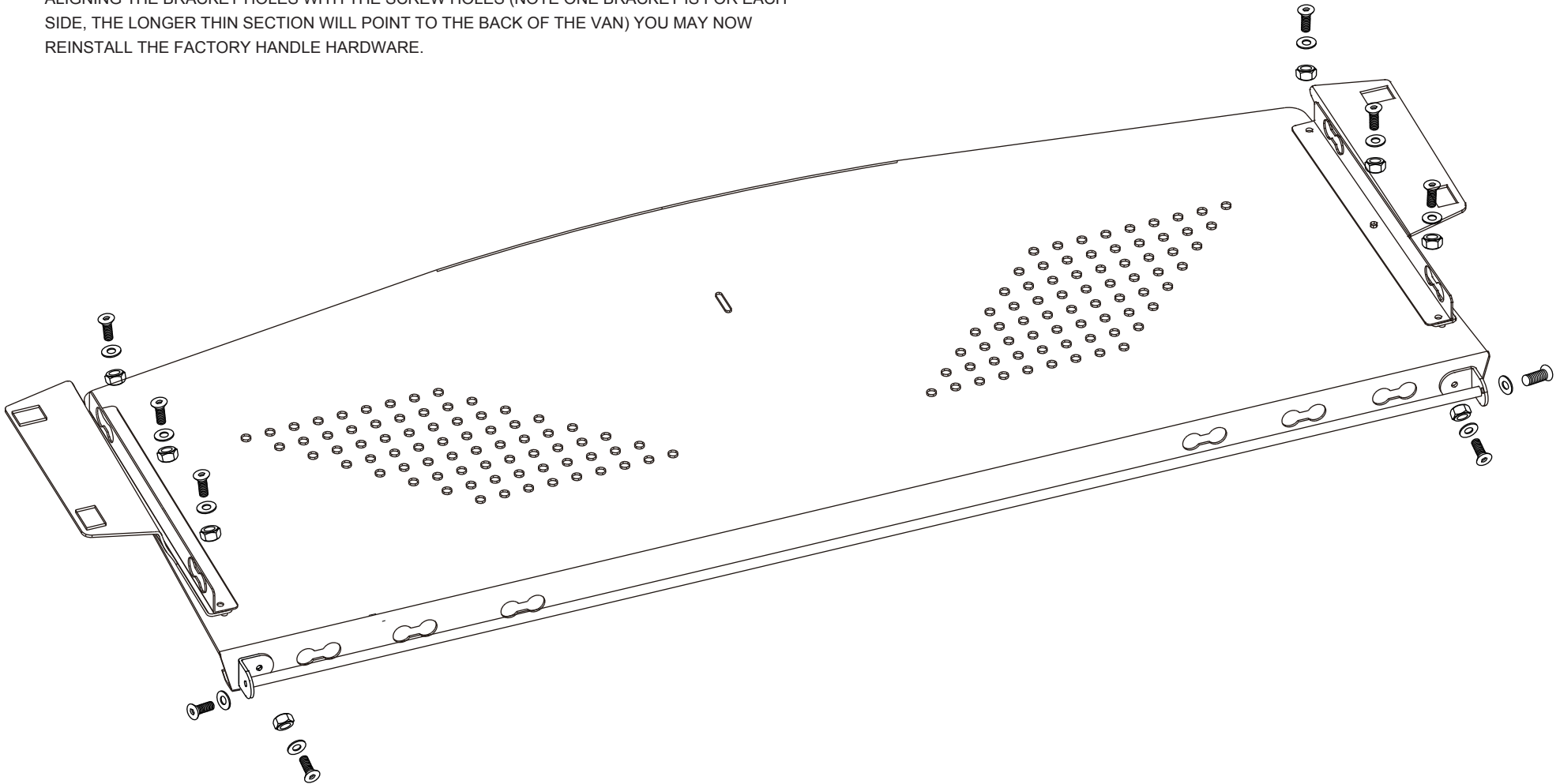

3. THE NEXT STEP WILL BE PLACING THE TRANSIT HEADLINER SHELF ON TOP OF THE SHELF BRACKETS YOU WILL NEED TO ALIGN THE THREE HOLES ON EACH SIDE AND INSERT SIX OF THE M5 BUTTON HEAD SCREWS, ALIGNING A WASHER AND NUT WITH EACH (SEE FIGURE 1), TIGHTEN THEM DOWN WITH A 3MM ALLEN KEY AND 8MM SOCKET

FIGURE 2

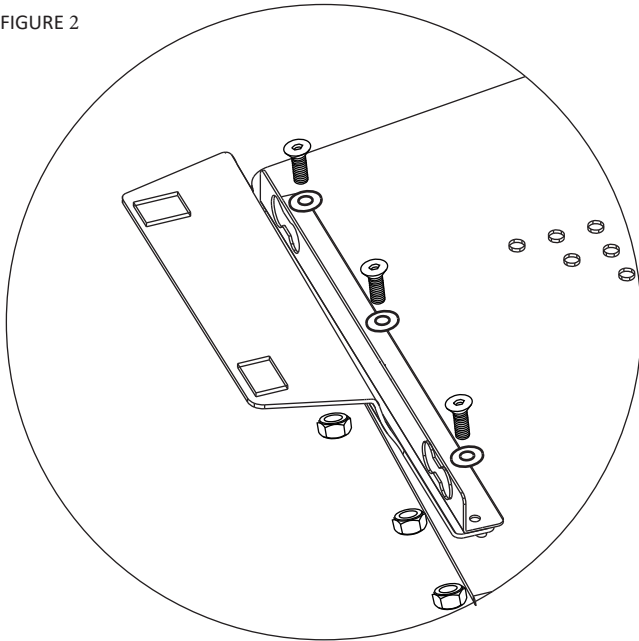
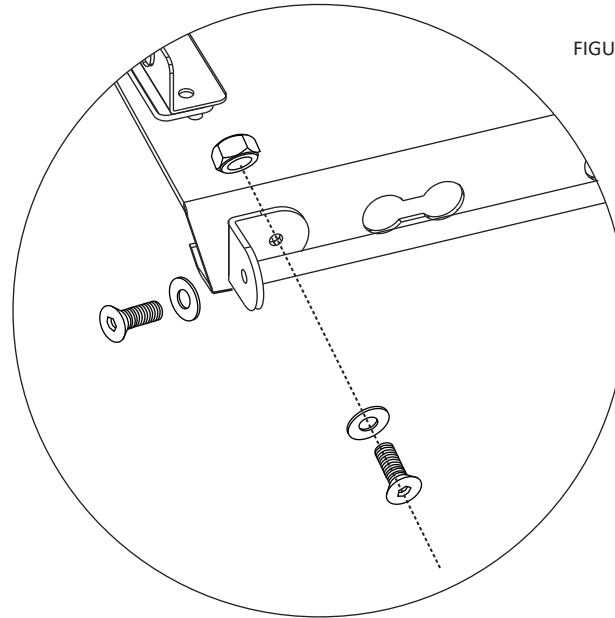

FIGURE 3



4. THE FINAL STEP WILL BE TO INSTALL THE OPTIONAL CURTAIN ROD, THIS UTILIZES FOUR OF THE M5 SCREWS, FOUR M5 WASHERS AND TWO M5 NYLOCK NUTS. THIS REQUIRES YOU TO INSTALL THE BRACKETS FIRST THEN THE CURTAIN ROD, SOME CURTAINS WILL REQUIRE THE INSTALATION OF THE CURTAIN ON THE ROD BEFORE THE ROD IS INSTALLED.ON THE BRACKETS.

GET THERE WITH WHITE TOP ADVENTURES



info@whitetopadventures.com



thanks!