

PROTECT LIFE & PROPERTY

TIMED CONTROL FOR DRUG TESTING LAB WATER SUPPLIES

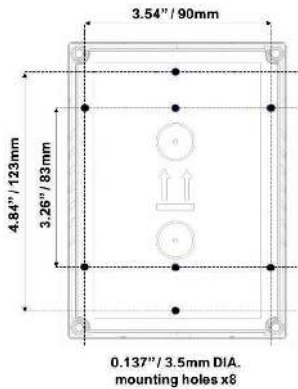

Automatic or Manual

Control over water



Four Timed Delay Options

2 minutes, 5 minutes, 10 minutes
or timed water cut off disabled



Adaptable Utility Output

For water or electric control
110VAC or 24VAC/DC



Power Supply

110VAC or 24VAC/DC



Dry Contact Inputs

For remote panic buttons
and fire alarms



Easy To Use

Clear LED status display



Modern & Compact Design

Strong polycarbonate PA-765,
designed to withstand
daily use



Optional Covers Available

Wall mounted with
flush or lockable shield
available

PRODUCT OVERVIEW

The AGSTWC provides a timed supply of water via a 110VAC or 24VAC/DC normally open water solenoid valve, or an electrical power supply.

Typically used for drug testing laboratories to comply with the Department of Transportation (DOT) 49 CFR 40.43 – Subpart D. Each controller has a selectable time out function built-in via internal dip switches, for 2 minutes, 5 minutes, 10 minutes or timer disabled. When the timer has reached the owner's selected setting, the front LED will flash to warn user of the time out.

The AGSTWC is manufactured in a modern polycarbonate enclosure which provides protection from damage. The AGSTWC is designed to replace contractor constructed solutions for timed supply and panic shutdown, incorporating a crucial reset of the timed supply after a panic shutdown.

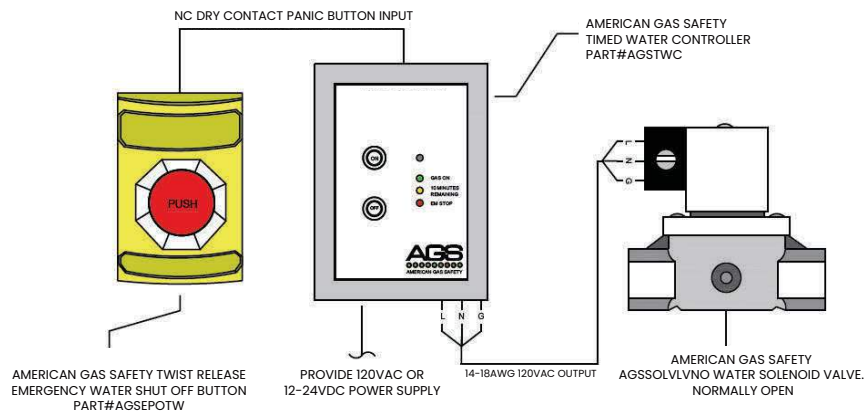

PROVIDING SAFETY & CONTROLS IN

- SCIENCE LABORATORIES • BOILER ROOMS • GAS FEATURES
- COMMERCIAL KITCHENS • PARKING GARAGES • EMS STATIONS

FIND OUT MORE

info@americangassafety.com
(727)-608-4375

SIMPLE OPERATION

Press **ON** to manually turn on water supply.

Press **OFF** to close water supply. Press to reset water shut off timeout.

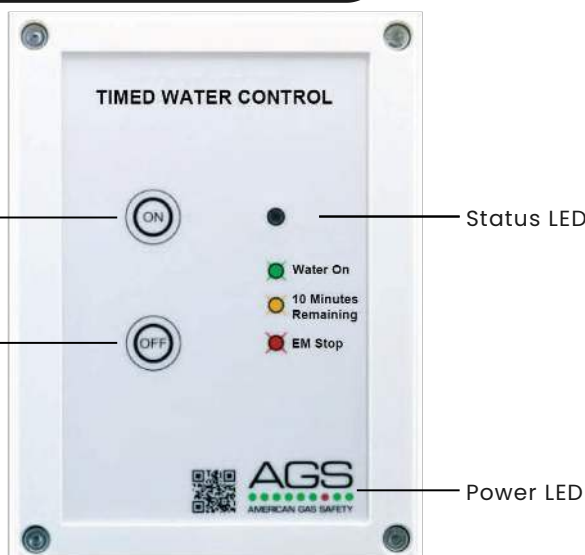

Green. Remains illuminated when water valve is closed.



Amber. The controller LED will turn amber ten (1) minute before the automatic water shut off timeout is reached and the buzzer will beep, and the amber LED will then intermittently flash. After this time, the water will automatically turn on until reactivated.



Red. Remains illuminated when a remote emergency stop device has been activated. The water supply is isolated until the emergency has been investigated, rectified, and reset. Press ON to re-enable/open the water supply.

PROTECTIVE COVERS AVAILABLE



These indoor/outdoor low-profile covers protect devices without restricting legitimate operation.

The versatile cover offers excellent protection against physical damage (both accidental and intentional), dust and grime as well as severe environmental conditions inside and out.

Wall Mount Cover:
AGSTWCWMCOVER

Flush Mount Cover:
AGSTWCFMCOVER

PLUG & PLAY INSTALLATION

Internal Fuse: Anti-Surge 3.15A 250V~
Wire Rating Min. 18AWG Tinned Copper @ 167°F

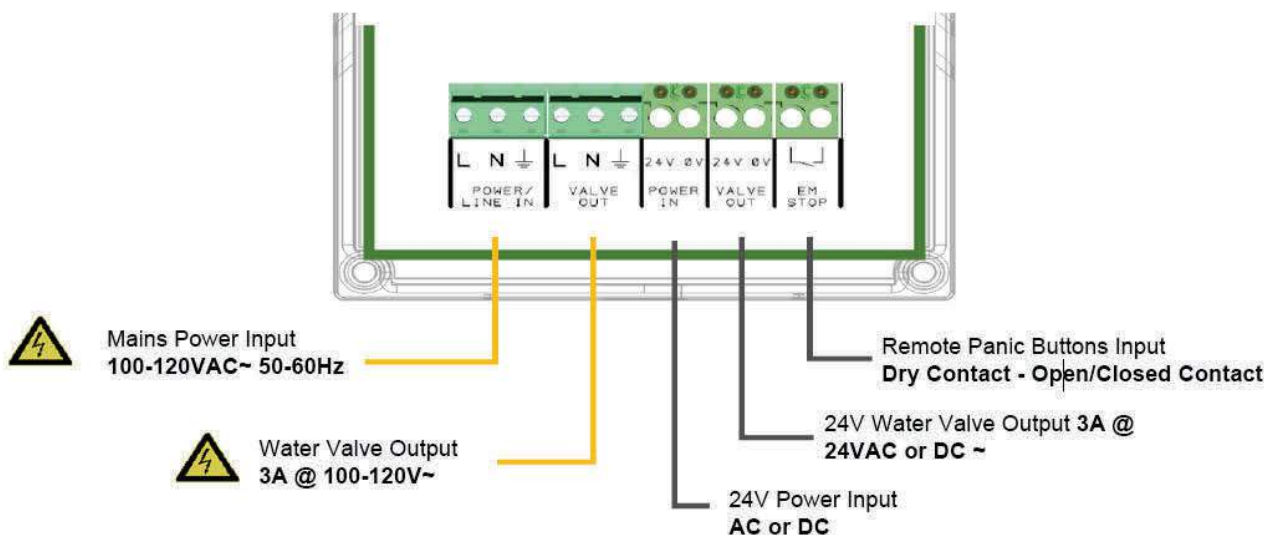

FIND OUT MORE

info@americangassafety.com
(727)-608-4375

PROVIDING SAFETY & CONTROLS IN

- SCIENCE LABORATORIES • BOILER ROOMS • GAS FEATURES
- COMMERCIAL KITCHENS • PARKING GARAGES • EMS STATIONS