

Yeelight Ceiling Light
A2001R900
YEELIGHT

Product Description

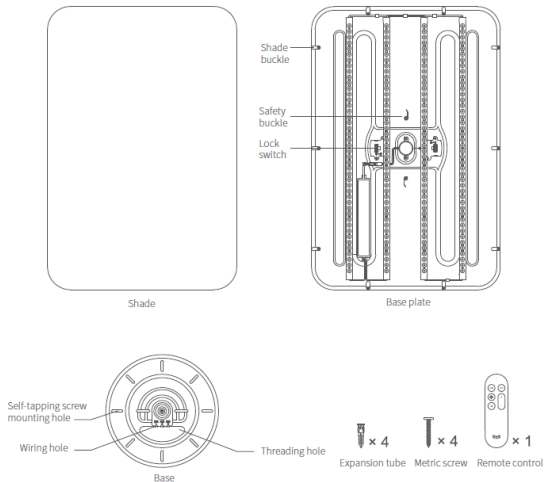

Mounting Instructions

Drilling

1. Open the package and take out the various parts of the ceiling light.
2. Use an impact drill 8 mm in diameter to make holes with a depth (L) of ≥ 40 mm. Then mount four expansion tubes into the holes.
3. Thread the power cord through the wiring hole. Use self-tapping screws to fix the base on the ceiling, and verify the base is securely mounted.

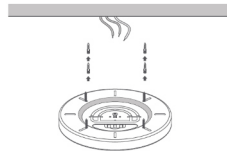

Connect the Power Cord

1. The wiring hole is suitable for power leads with a cross-sectional area of 1.5-2.5 mm². Strip the power cord by 11-13 mm.
2. Connect the neutral, ground, and live wires to the wiring holes marked with N, a grounding sign, and L in turn.
3. Tidy up the power cord and check whether the wiring is firm.



11 ~ 13mm
*A solid or stranded hard wire is used as the power lead.

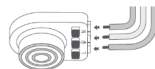

Connect the neutral, ground, and live wires to the wiring holes marked with N, a grounding sign, and L in turn. (When unplugging the power cord, press the red button on the wiring hole first, and then pull it out).



Arrange the power cord as shown in the figure, and check for firm wiring.



* The neutral and live wires must be connected to the N and L ports respectively; be careful not to mix them up, or the light beads may emit some weak light.



* Before mounting, make sure to disconnect the power supply to prevent electric shock. Mounting should be performed in strict accordance with the instructions. Improper mounting is liable to cause accidents such as fall, fire, and electric shock.



* Make sure to disconnect the power when disassembling the light.

Mount the Base Plate

1. Hold the base plate with both hands, and align it vertically with the center of the base coupler through the circular transparent part in the center of the base plate (see Figure 1).
2. Push the base plate upwards vertically. After hearing a "click" sound, visually check that the lock on the base plate is aligned with the lock switch position.
3. After the base plate is mounted, rotate it left and right (see Figure 2) to get the two symmetrical lock switches back to the lock position (see Figure 3). Rotate the two metal safety buckle switches in the center of the base plate from (see Figure 4).



*Always check for proper mounting after you have finished. Improper mounting may cause the product to fall.

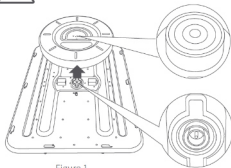

Figure 1

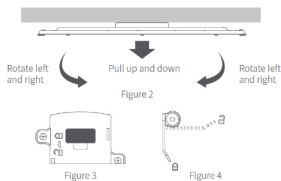

Figure 2

Figure 3

Figure 4

Mount the Shade

Open all the hooks (see Figure 5).

Hold both sides of the shade with both hands and fully insert it into the backboard (see Figure 6). Rotate the hooks to fix the shade.

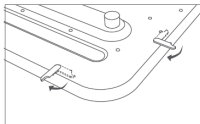

Figure 5

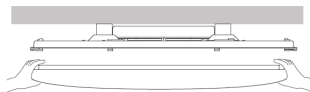

Figure 6

Connect to Yeelight App

This product can be controlled on Yeelight App and be configured to interact with other Yeelight products.

Download App

Search for "Yeelight" in an App store or scan the QR code on the right to download and install the App.

Add Device

- Go to the Yeelight App homepage, and click "+" in the upper right corner to add your device.

- Proceed with the configuration as instructed on the App.

- Once you've added a device successfully, you can find it in the device list.

Note: The operation procedure may differ from what's described here due to App updates.

Please proceed as instructed on the App.

This product can also be controlled on Mi home, Google Home App, and Amazon Alexa. You can download and install one of these Apps from an App store, and configure your device as instructed on the App. After you have finished the configuration, you can use the App to control the light.



Apple HomeKit Smart Control

1. Open the Home app on your iPhone or iPad.

2. Tap "Add Accessories" and follow the instructions to scan the QR code either on the back cover of the user manual or on the junction box, or enter the 8-digit setup code above the QR code to grant the Apple Home app access.

*Make sure a Wi-Fi network with Internet access is available (this product does not support 5 GHz networks).

To control this HomeKit-compatible accessory, it is recommended that you use iOS 9.0 or above. The HomeKit setup code is in the user manual and on the junction box, do not lose it. When adding the product to the Home app after the factory settings are restored, you will need the HomeKit setup code again.

In case the user manual is lost, remove the lampshade and scan the QR code or enter the setup code on the junction box. iPad and iPhone are the trademarks of Apple Inc., and they are registered in the United States and other countries.

Restore to factory settings

Use the wall switch to turn the ceiling light on and off seven times consecutively (turn off the ceiling light and wait for two seconds, then turn it on and wait for two seconds, this counts as one time).

The ceiling light then starts breathing and automatically restarts after five seconds, and the factory settings of the ceiling light have been restored.

Note: When using the ceiling light in a new network environment, you need to restore the factory settings and connect to the network again.

Product Features

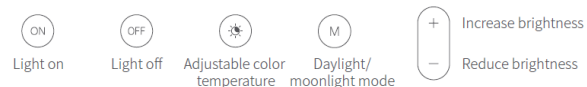

Product Features

Model: YLXD033
Power Factor: 0.9
Operating Temperature: 25° C
Operating Humidity: 0-85% RH
Color Temperature: 2700-6500 K
Rated Input: 220-240V ~ 50/60Hz Max. 0.43A
Rated Power: 95 W (176 × 1 W/LED module)
Compatible with: Android 4.4 & iOS 9.0 or above
Wireless Connectivity: Wi-Fi IEEE 802.11 b/g/n 2.4 GHz, Bluetooth 4.2 BLE
Operating Frequency: 2412-2472 MHz (Wi-Fi) 2402-2480 MHz (BT)
Maximum Output Power: 17.21 dBm (Wi-Fi) 5.08 dBm (BT-LE)

Product Features

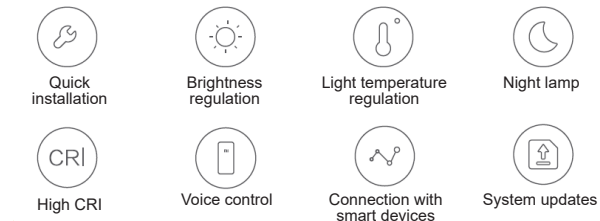

Precautions

- Make sure the voltage is consistent with the ceiling light's operating voltage before use. Using the mismatched voltage may damage the ceiling light and cause safety hazards.
- Do not replace the light source of the ceiling light by yourself. The light source should only be replaced by the manufacturer, after-sales service, or a qualified electrician.
- The ceiling light generates heat during working. Please keep it is well ventilated for heat dissipation.
- This ceiling light can be controlled by an app or remote control (not included, sold separately). Turning off the ceiling light by remote control or app does not cut it off from the electricity, hence, do not touch, replace, or disassemble this ceiling light. Otherwise, it may cause an electric shock, injury, or even death.
- The light installation requires a qualified electrician, and the wiring must comply with IEEE electrical standards or national standards.
- The ceiling light should be installed in a stable location to prevent it from dropping down or falling off.
- Under normal use of condition, this equipment should be kept a separation distance of at least 20cm between the antenna and the body of the user.
- For indoor use only.
- The light source contained in this luminaire shall only be replaced by the manufacturer or his service agent or a similar qualified person.

EU Declaration of Conformity

Hereby, Qingdao Yeelink Information Technology Co., Ltd. declares that the radio equipment type YLXD036/YLXD037 is in compliance with Directive 2014/53/EU.

WEEE Disposal and Recycling

All products bearing this symbol are waste electrical and electronic equipment (WEEE as in directive 2012/19/EU) which should not be mixed with unsorted household waste. Instead, you should protect human health and the environment by handing over your waste equipment to a designated collection point for the recycling of waste electrical and electronic equipment, appointed by the government or local authorities. Correct disposal and recycling will help prevent potential negative consequences to the environment and human health. Please contact the installer or local authorities for more information about the location as well as terms and conditions of such collection points.