

WWB & TSC Maintenance

Thank you for buying the Wayne Water Bug or TSC Utility Pump.



These pumps can be used for many application to remove standing water around the home. They are designed to remove virtually all standing water and as such, do require maintenance to keep them performing their best. Occasionally, it may become necessary to remove debris clogging some or all of the discharge areas. This is the procedure to do that.

1. Unplug the pump from the power source before handling or performing any maintenance on your pump.



2. Using a faucet or garden hose, rinse any debris that has accumulated from the bottom of the pump.

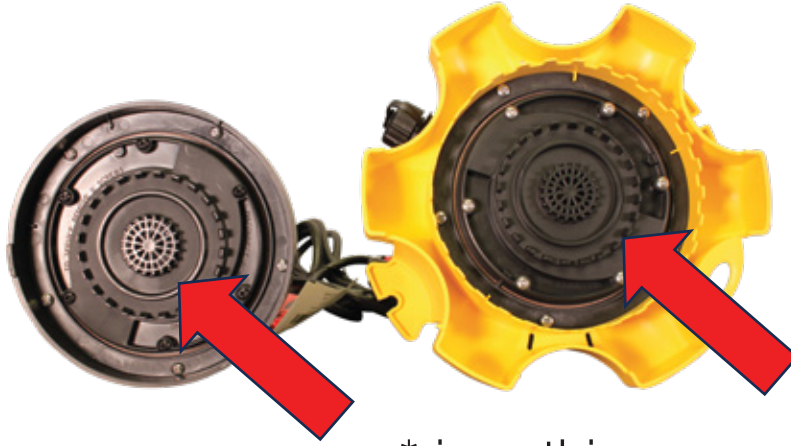

*rinse this area

3. On the bottom of the pump, remove the 6 screws using a #2 Phillips screwdriver. This will loosen the inlet screen from the pump. Do not remove the outer screw as this is not required to remove the inlet screen (red X's signify screw to NOT remove).

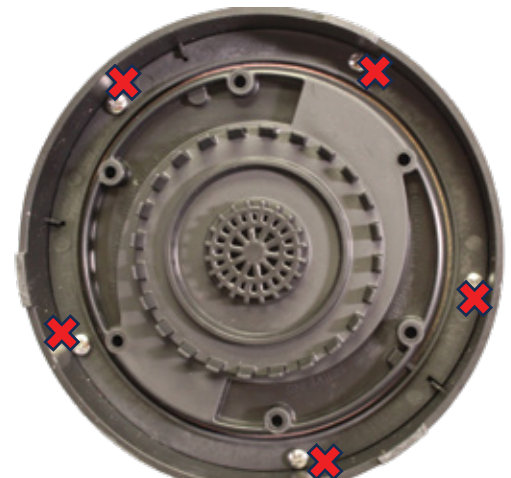
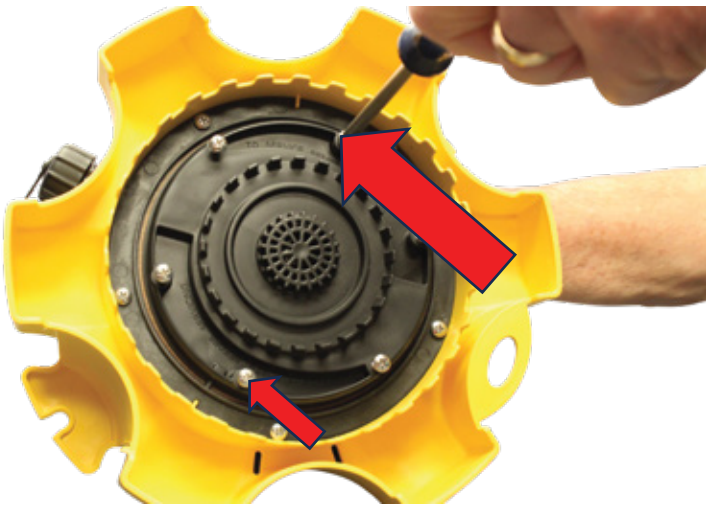

4. Using care to not tear the cork gasket on the bottom side of the inlet screen, gently separate the inlet screen from the pump. Clean and rinse any debris from the inlet screen.

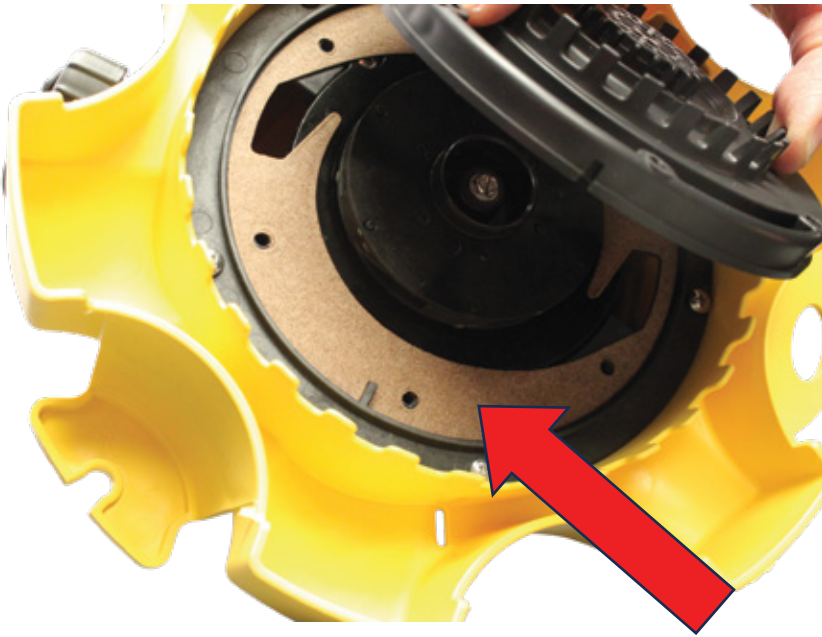

*caution do not tear



*rinse/clean

5. Rinse any debris from the impeller area. If there is debris caked onto the impeller area, you may soak the area in a bucket or tub of water. You may use a mild dish detergent and an old tooth brush to help remove debris. Periodically inspect the pump and continue to soak until the debris has loosened and you can fully clean.

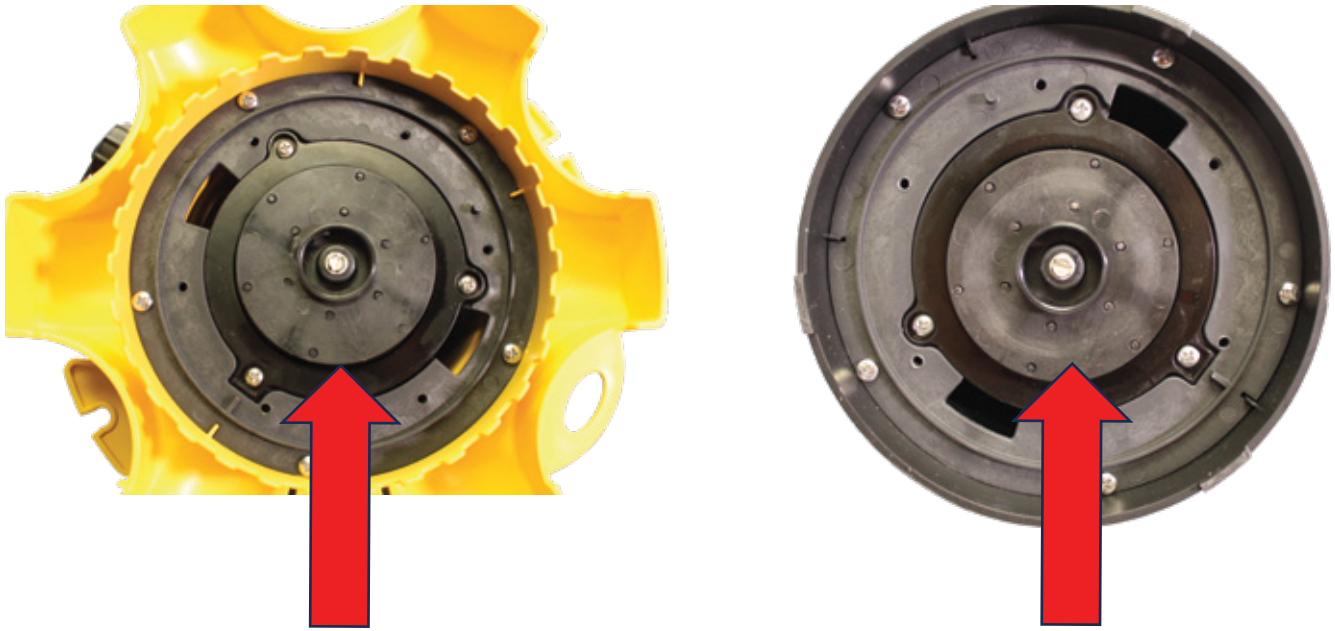

6. Once all debris has been removed, reposition the cork gasket using the alignment features shown in the figure, and take care not to cover the pump discharge openings.

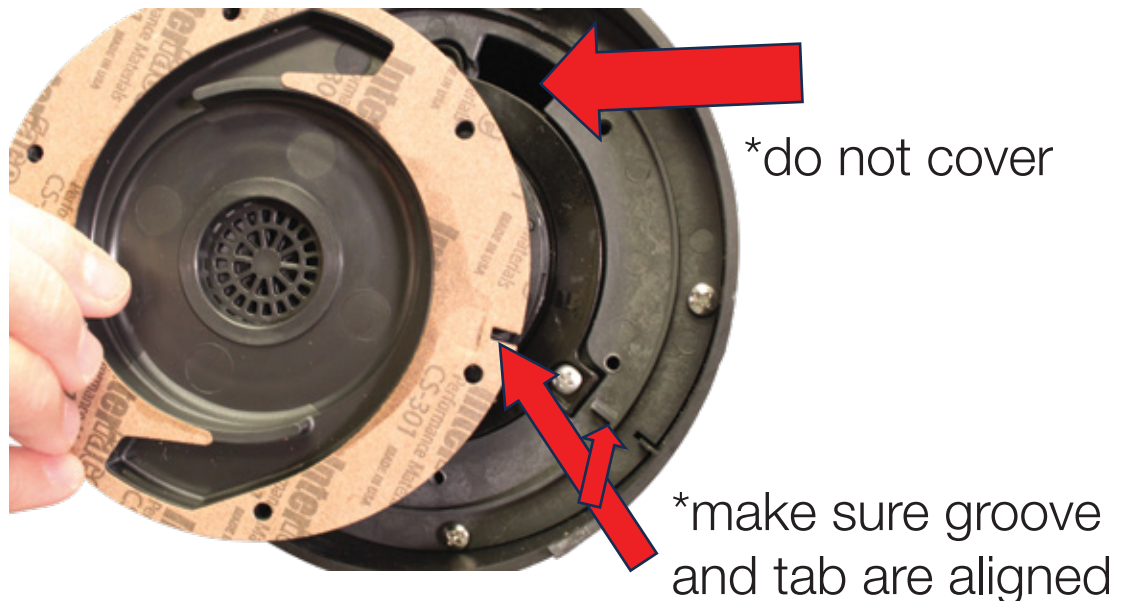

7. Reinstall the inlet screen using caution not to over tighten or strip the screws or screw holes.



8. Now your pump is ready to be used again.

