

Instruction for use of eufy

Omni E28

Contact Us

Phone:

USA: +1-800-994-3056

Mon-Fri 6:00AM - 5:00PM (PT)

Sat 7:00AM - 3:30PM (PT)

UK: +44 (0) 1604 936 200

Mon-Fri 9:00AM-5:00PM (GMT)

Email: support@eufy.com

(We will respond to you within 24 hours on workdays.)



Contents:

1. How to Ensure Optimal Obstacle Avoidance of E28? (1-3)
2. How can I optimize Omni E28's cleaning performance? (4-6)
3. How can I optimize Omni E28's mopping performance? (7-9)
4. How can I use the PDC (Portable Deep Cleaner) effectively? (10)
5. How to Achieve Better Carpet Cleaning of E28? (11-12)
6. How to ensure the Omin E28 can clean your whole house in single cleaning? (13-14)

1. How to Ensure Optimal Obstacle Avoidance of E28

- **AI.See Settings**

Enable this feature to allow the robot to use AI algorithms for local object recognition and active obstacle avoidance during cleaning tasks. The robot's smart obstacle recognition and avoidance capabilities will continuously improve over time.

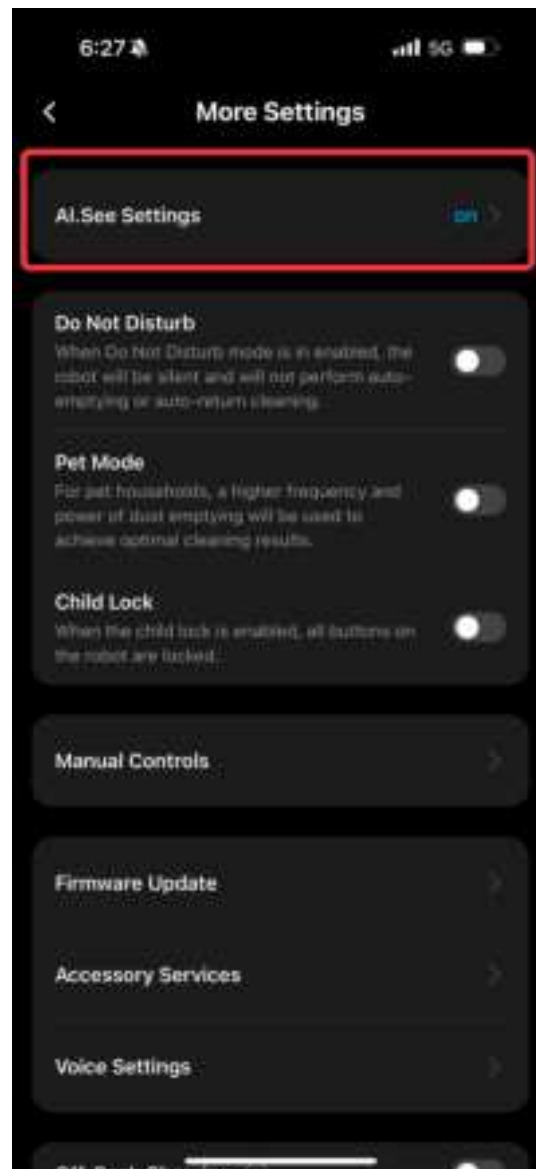

- **Clear the Floor**

Remove wires or other small-sized obstacles to prevent the vacuum from getting stuck.



- **Secure Carpet Edges**

Fix the edges of thin carpets to prevent entanglement and ensure smooth operation.

- **Avoidance of Dark or Reflective Surfaces**

Remove black or highly reflective objects near thresholds to prevent confusion in E28's navigation system.

- **Set No-Go Zones**

For areas like dark-colored stairs, walls, furniture, thin chair legs, furniture bottoms lower than 116mm, and carpets thicker than 26mm, set up no-go zones to avoid the robot getting stuck and to maintain cleaning performance.

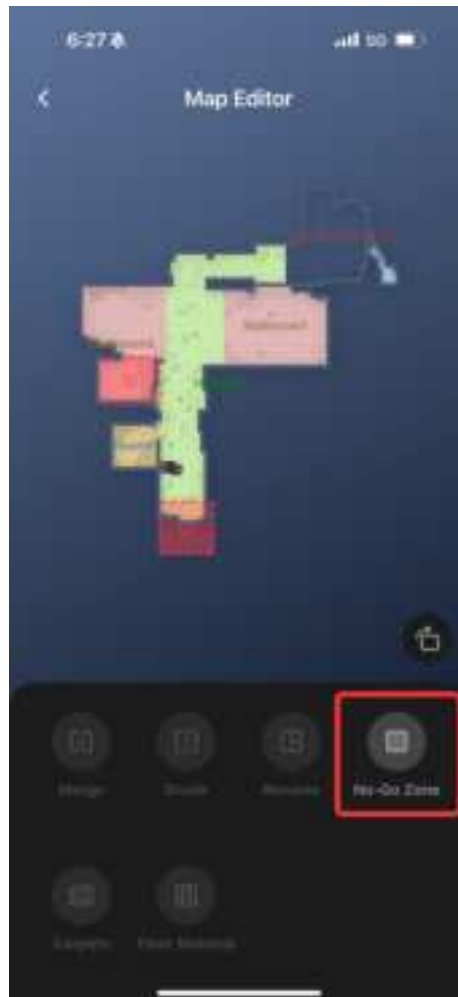

- **Avoidance of Dark or Reflective Surfaces**

Remove black or highly reflective objects near thresholds to prevent confusion in E28's navigation system.

- **Keep Software Updated**

Regularly update the software and firmware to the latest version to ensure optimal performance and access to new features.

2. How can I optimize Omni E28's cleaning performance?

- **For Pet Owners**

In the **More Settings** menu, enable **Pet Mode** to utilize higher dust collection frequency and stronger suction power for optimal cleaning performance.

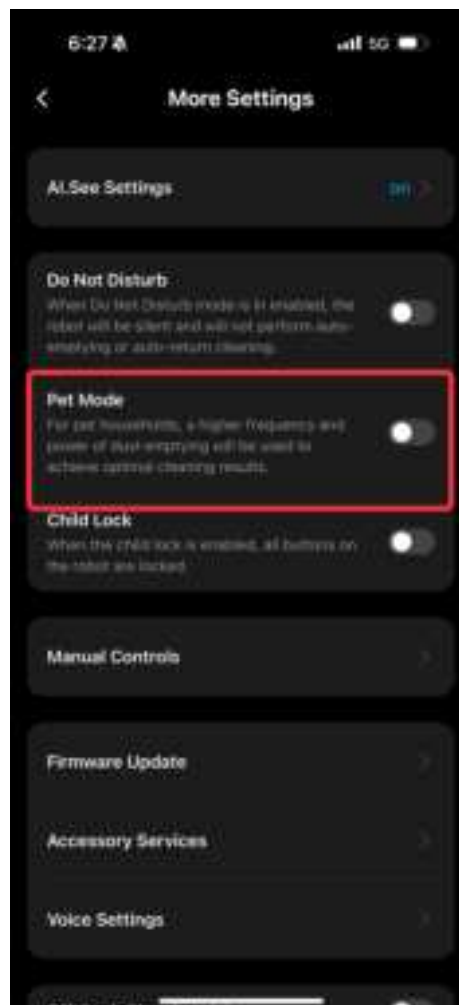

- **Carpet Stains**

Use the PDC (Portable Deep Cleaner) along with its dedicated **fabric cleaner** for effective stain removal on carpets.

- **Dirty Spot Cleaning**

Enable the **Dirty Spot Cleaning** feature, the robot will detect stains like coffee spills and perform deep precision mopping.

Note: In vacuum-only mode, it will automatically switch to vacuum and mopping mode upon detecting dirt.

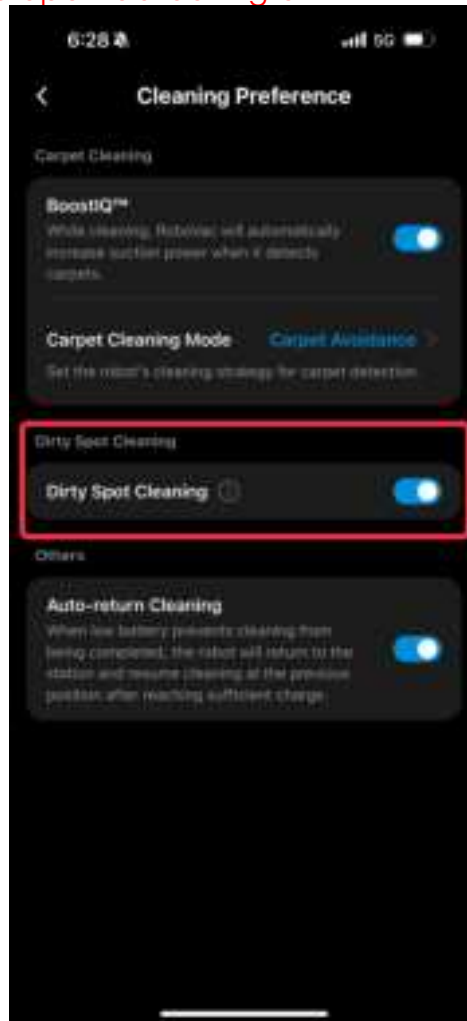

- **Dirt Inspection**

Enable the **Dirt Inspection** feature, the robot will auto-inspect the room after completing a full house cleaning to ensure no stains are left behind.

- **Accessories Maintenance**

For optimal performance, robot accessories (especially the roller and filter for dustbin) need to be cleaned and replaced regularly.

- **Keep Software Updated**

Regularly update the software and firmware to the latest version to ensure optimal performance and access to new features.

3. How can I optimize Omni E28's mopping performance?

If your home hasn't been deeply cleaned recently, the first time you use E28 may result in visible mopping streaks as it dislodges thick dust from under furniture. This is normal and will be reduced by multiple cleaning.

Tips:

- **Cleaning solution**

Use eufy's official cleaning solution (Floor Cleaner) and enable the automatic cleaning solution dispenser.

- **Vacuum-only Mode**

Before the first mopping session with your E28, use the vacuum-only mode to remove dust and hair via the eufy Clean app.

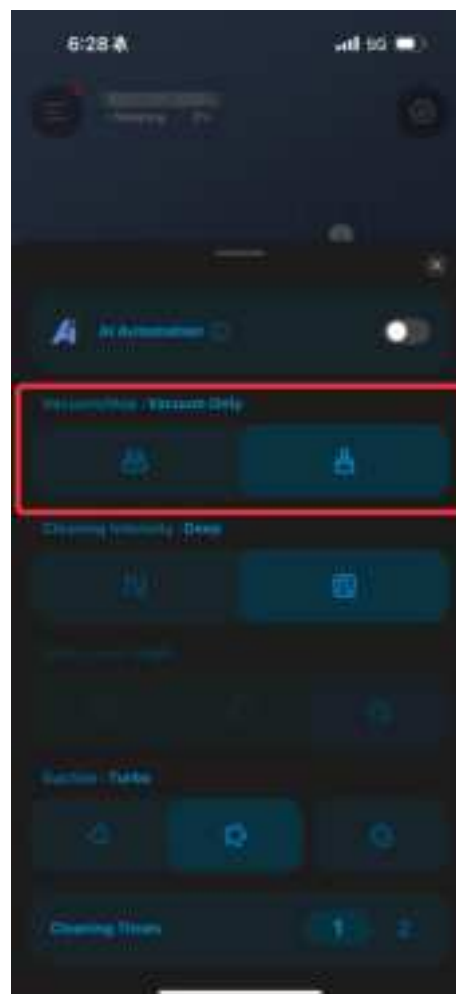

- **Adjust Water Level**

Adjust the appropriate water level in the app based on the floor type for more effective mopping. For stubborn stains, select the area and choose to mop it twice.

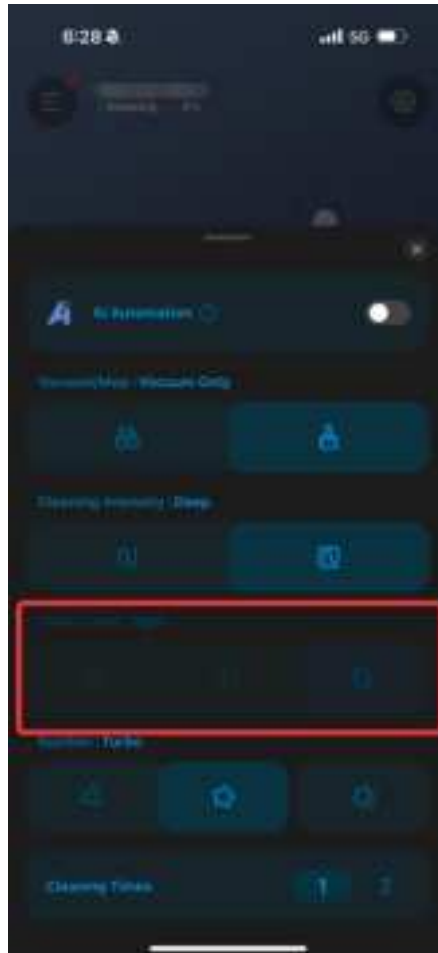

- **Dirt Inspection**

Enable the Dirt Inspection feature, the robot will auto-inspect the room after completing a full house cleaning to ensure no stains are left behind.

- **Dirty Spot Cleaning**

Enable the Dirty Spot Cleaning feature, the robot vacuum will detect stains like coffee spills and perform deep precision mopping.

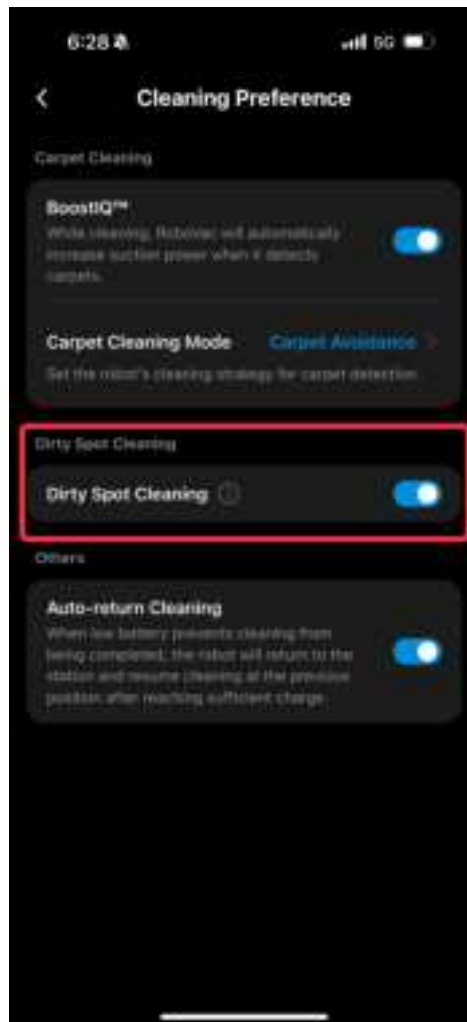

- **Accessory Maintenance**

Clean the roller mop and dirty water tank regularly to maintain optimal results.

- **Keep Software Updated**

Regularly update the software and firmware to the latest version to ensure optimal performance and access to new features.

4. How can I use the PDC (Portable Deep Cleaner) effectively?

- **Use Cleaning Solution**

Pair the PDC with a fabric cleaning solution for optimal cleaning results.

- **Cleaning Limitations**

PDC is designed to clean liquid stains only; it cannot remove fibers, hair, or solid particles.

- **Prevent Overheating**

Allow the PDC to cool for 3.5 hours after 30 minutes of use to protect the fan from damage.

- **Handle Humidity**

In humid weather, use a hairdryer to dry cleaned areas to prevent moisture buildup.

- **Self-Cleaning**

Hold the self-cleaning button for 5 seconds to clean pipes.

- **Avoid Leaks**

After use, wait 3 seconds to drain pipe water and prevent brush head leaks.

- **Proper Shutdown**

Press the switch once to turn off the device. Avoid pulling the hose too tightly during winding to ensure the dust cover closes properly.

- **Regular Maintenance**

Clean the PDC brush head regularly to maintain its performance.

5. How to Achieve Better Carpet Cleaning of E28

- **Carpet cleaning Mode**

For short-pile carpets

Use the "Vacuum Only" mode. The device will automatically raise its mopping module to vacuum without mopping when detecting carpets to avoid wetting the carpet.

For medium- and long-pile carpets

Select the "Carpet Avoidance" mode. The device will avoid carpets entirely and skip cleaning them upon detection.

Note: Please note that dark carpets may not be detectable. Please set up a No-Go Zone.

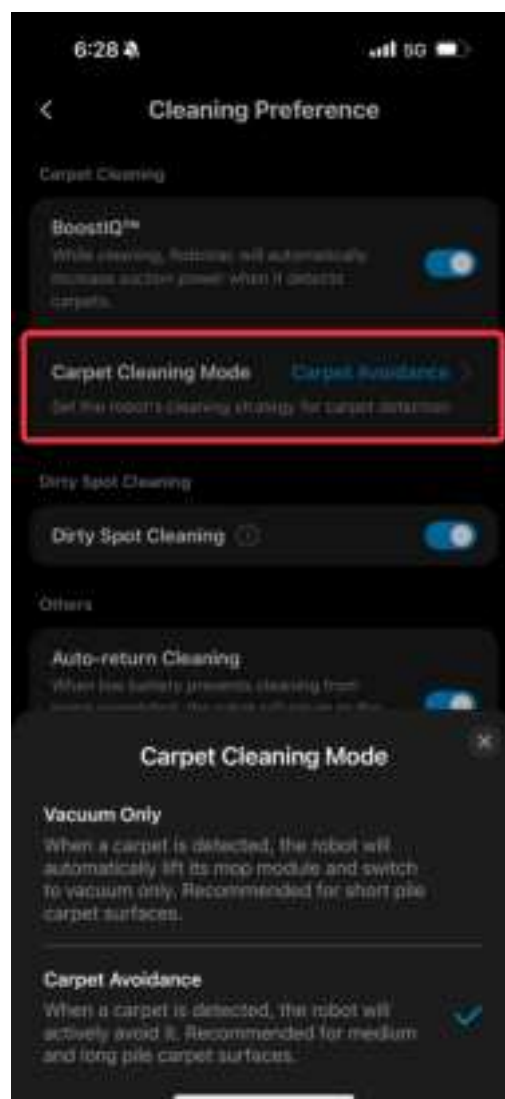

- **Boost IQ**

Enable the Boost IQ feature via the app, the robot will auto-increase the suction power when it detects the carpets to improve better cleaning performance.

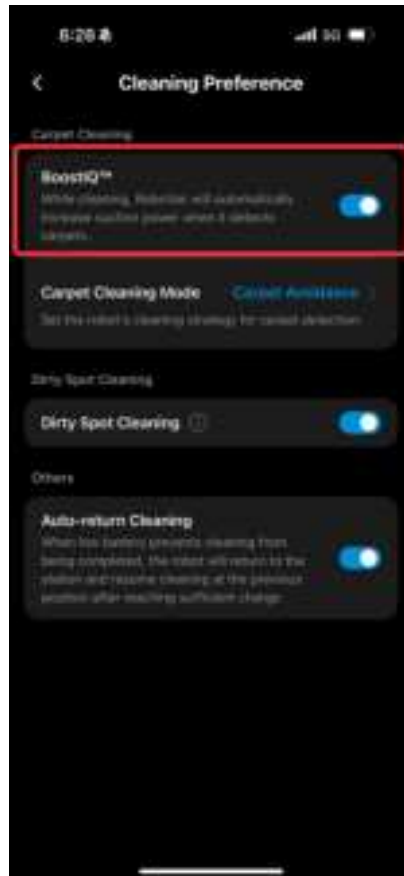

- **Keep Software Updated**

Regularly update the software and firmware to the latest version to ensure optimal performance and access to new features.

6. How to ensure the Omin E28 can clean your whole house in single cleaning?

- **Collect Small Objects**

Collect cords and other small-sized obstacles before using the Omin E28 to avoid it getting stuck.

- **Customizable No-Go Zones**

For carpets with a height exceeding 26mm, or those that are particularly light and thin, create no-go zones within the app. This prevents the robot from getting trapped or tangled.

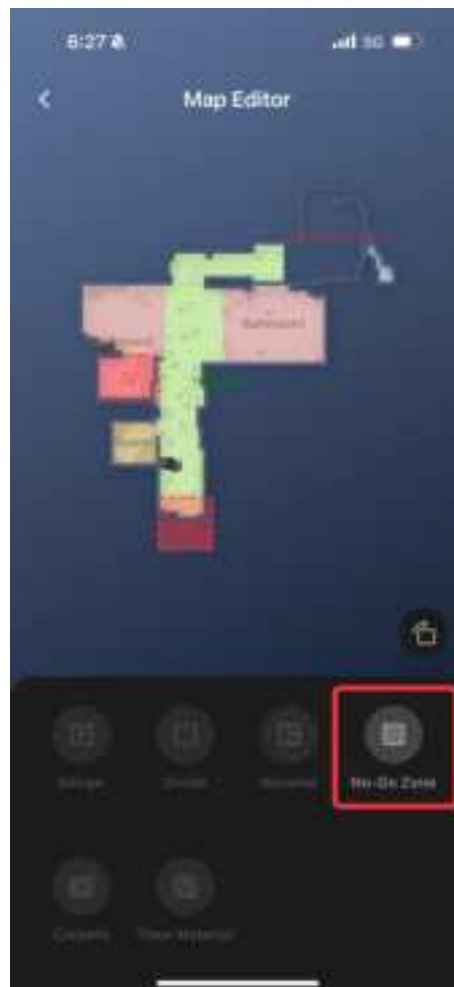

- **Carpet Edge Management**

If your carpet edges tend to curl, flatten or secure them to ensure smooth navigation for Omin E28.

- **Auto-return Cleaning**

If your home has a large area, please enable the auto-return cleaning function via the app.

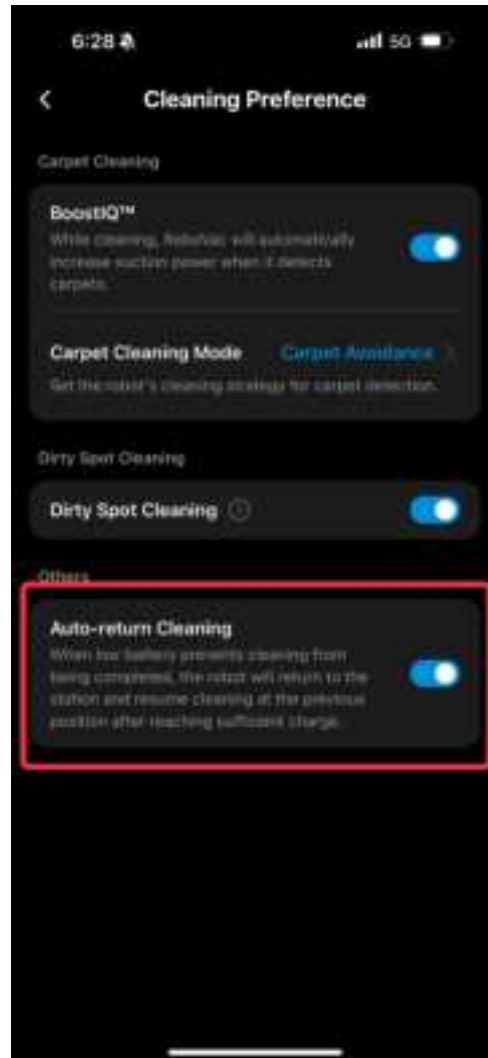

- **Firmware Upgrade**

Keep an eye on new firmware updates in the app and upgrade for better performance.