

BULUSE



M11

USER GUIDE

Please read this instruction thoroughly before using this product and keep it for future references.

GETTING STARTED

POWER ON/OFF

- * Press and hold the power button for 3 seconds to turn on your tablet. Select your language and set up your tablet following the start guide.
- * Press and hold the power button for 2 seconds, then release it. It will show **Power off**, **Restart** and **Screenshot** on the screen. Tap **Power off** to turn off the tablet.
- * Press and hold the power button for 7-8 seconds to do a forced reboot.

BATTERY

- * A rechargeable Li-ion battery is installed in the tablet.
- * We suggest to drain the battery completely once a month if tablet is only used occasionally.
- * DO NOT dispose tablet in a fire.

SLEEP MODE

Simply press the power button once to switch the tablet to **Sleep Mode**. When the tablet is **ON**, press the power button again to wake it up.

Tip:

Go to Settings > Display > Advanced > Sleep to set the time of entering the Sleep Mode.

SCREENSHOT

- * Press and hold the Volume- button and the Power On/Off button together to capture a picture.
- * Press and hold the power button for 2 seconds, then release it. It will show **Power off**, **Restart** and **Screenshot** on the screen. Tap Screenshot to capture a screenshot.

HOME SCREEN

NAVIGATION BUTTONS



1. Back

2. Home Screen

3. Recent Activities

Home Settings, Widgets and Wallpapers



Tap and hold the empty section of a Home screen. **Home settings**, **Widgets** and **Wallpapers** will be displayed.







- * Tap **Home Settings** to enable/disable Add icon to Home screen. This is applicable to the new Apps installed from Play Store. It also provides the shortcut to enable/disable the notification dots. In addition, you can set the option for **Pull down action** on the screen and change **Home screen style**, and more.
- * Tap **Widgets**, touch and hold any application (e.g. Clock), then slide and add it to the home screen. Remove it by sliding it to **X Remove**.
- * Tap **Wallpapers** style to change the current wallpaper of the tablet from the default wallpapers, live Wallpapers or from your photos.

SETTING BASICS

QUICK SETTINGS

Swipe down from the top of the screen to access Quick Settings.



-  **Wi-Fi.** Tap to connect/disconnect to a wireless network.
-  **Bluetooth.** Enable/disable the Bluetooth of the tablet.
-  **Do not disturb.** Block sound after enabling this function.
-  **Turn on/off the Auto-rotate of the screen.**
-  **Tap to choose the power setting you prefer to save the battery time.**
-  **Airplane mode.** Turn on/off all the network connectivity.

 : Eye comfort. Enable/disable the eye protection mode.

Tap the  icon to change the options in the **Quick Settings**. Long press each icon to enter the interface of its detailed settings.

MORE SETTINGS

Swipe down from the top of the screen, then tap the  icon to enter the detailed setting interface. Or, tap the **Settings App** on the Home screen to enter.



Network & internet

- * Connect to any working Wi-Fi
- * Enable/disable the **Airplane Mode**
- * Monitor the data usage

Connected devices

- * Turn on/off Bluetooth
- * Pair with Bluetooth devices and check the paired devices
- * Check the received files from other devices via Bluetooth connection
- * Add and check printers

Apps & notifications

- * Check the Apps recently opened
- * Check all the Apps on the tablet
- * Check the received files from other devices via Bluetooth connection
- * Set the App permissions
- * Uninstall the third-party Apps
- * Clear the cache of the Apps
- * Check the screen time

Battery

- * Display or hide the remaining power as a percentage
- * Enable/disable **Battery Manager**
- * Set **Power saving optimization**
- * Manage the battery optimization for apps

Display

- * Adjust the screen brightness
- * Adjust the font size and display size
- * Set a screen saver
- * Change the wallpaper

- * Adjust the time of entering the **Sleep Mode**
- * Adjust **Color and Contrast** of display
- * Set to check the notifications and other info, when you lift the tablet with screen locked

Scheduled power on/off

- * Set the time and days of the week for the tablet to automatically turn on/off

Navigation bar

- * Show or hide the navigation bar
- * Select a combination of navigation buttons from the four options provided

Audio profiles

- * Select audio profiles from **General** and **Silent**
- * Set the volumes for notification, media and alarm

Storage

- * View and manage your storage space

Security & location

- * Set screen lock pattern, e.g. Password, PIN, Swiipe etc.
- * Enable/disable all the notifications while the screen is locked
- * Enable **Face Lock** to unlock screen by your face
- * Turn on/off the location services for specific Apps
- * Set to show/hide the password when input a password

Accounts

- * Add and manage the user accounts on your tablet

Accessibility

- * For vision and hearing impaired users, manage settings for **Screen readers**, **Display**, **Interaction Controls**

Digital Well being & parental controls

- * Check your app usage based on Screen time, Notifications received, or Times opened from Dashboard
- * Set a schedule for **Wind Down** and turn on the setting you prefer
- * Manage the related notification settings to reduce interruptions
- * Set up **Parental controls** to help your kids balance their screen time

Google

- * Set the preferences for Google™ related services

System

- * Set Language
Tap **Languages & Input** > **Languages** > **+Add a language** to add your language. After adding, hold and slide the  to the top to change the language.
- * Restore factory setting
Tap **Advanced** > **Reset options** > **Erase all data (factory reset)** to restore the factory setting
- * Set the date and time
- * Turn on/off the **Back up to Google Drive**
- * Check and update the tablet's system
- * Check the detailed information about the tablet
- * Enable/Disable Gestures to quickly launch camera or lift tablet to check notifications

NETWORK CONNECTION

Go to network settings from the Settings App or by long pressing the **Wifi/Bluetooth** icon in **Quick Settings**.

WIFI CONNECTION

1. Tap **Network & Internet** and turn on the **WiFi**. All the WiFi connections available will be listed.
2. Select your WiFi and input the correct password.



BLUETOOTH PAIRING

Turn on the Bluetooth on your tablet and your bluetooth device.

1. Tap **Connected devices**
2. Tap **+Pair new device** to enter the scanning interface. Devices available will be displayed after a few seconds.
3. Tap the desired device to get a pairing code and click **PAIR** on both devices.
Automatic connection is applied to some devices.

APP MANAGEMENT

APP DOWNLOAD AND INSTALLATION

1. Tap and open Play Store on the Home screen.
2. Log in to your google account, search and download the App you need.

APP MANAGEMENT

Move the App

Tap and hold the App, then slide it to a desired screen.

Remove the App from the Home screen

Touch and hold the App, then slide to **X Remove** to remove it from your Home screen.

Uninstall the App

Touch and hold the App, then slide to the  Uninstall icon to uninstall the App.

Clear the Cache of the App

1. Go to Settings > Apps & notifications.
2. Select an App > Storage > **CLEAR CACHE** to clear the cache.

INTERNET NAVIGATION

Please make sure that the tablet is connected to a working Wifi network before navigating the Internet.

You may use the pre-installed Chrome browser or use another browser downloaded from Play Store.

CONNECTING TO A COMPUTER

1. Connect your tablet to the computer with a USB cable.
2. **Media device(MTP)** is the default setting. Go to your computer and find your tablet X8 to transfer files between your tablet and computer.

Tips:

Go to Quick Settings, tap Android System - USB file transfer turned on > Tap for more options > USB computer connection to select the option preferred.

* Select Charge Only to charge your tablet.

* Select Camera(PTP) to transfer photos between the devices.

* Select MIDI to play MIDI instruments on the tablet.

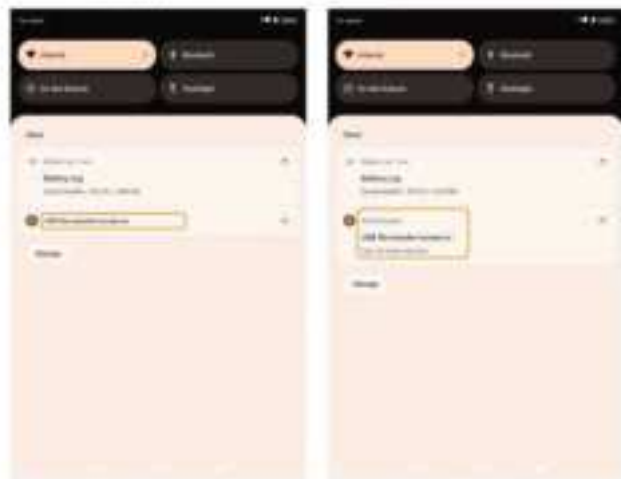



CONNECTING TO AN EXTERNAL DEVICE

1. Install a microSD card into the microSD card slot and go to **Quick Settings**.
2. Tap **SET UP**.
3. Set the microSD card as a portable storage by selecting **Portable storage**. Enter **microSD Card storage** to move files between the card and tablet.



CARD DESCRIPTION



The device uses standard micro SD card and nano SIM card. If the card, with different specifications is used, the card slot may be damaged or the device will not recognize the card. If the SIM card you are using does not match the device, please contact the operator.



Standard SIM card
(large card)



Micro SIM card
(medium card)



Nano SIM card
(small card)

Please refer to the figure below to complete the operation of inserting the card. Please pay attention to the direction of the notch when inserting the card.

SIM card and Micro SD card installation

Procedure for installing a SIM card

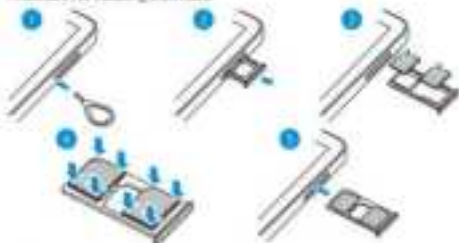

Combination of SIM card and Micro SD card



Note: The maximum storage capacity of microSD card is 512GB

SPECIFICATION

Size	8"
Chipset	MT8768T
GPU	Power VR G6330
CPU	Octa-core,2.3GHz
RAM	4 GB
Storage	64 GB
Display/Resolution	1280X800IPS
Front-facing Camera	2MP
Back Camera	5MP
Battery	5000mAh
Operating System	Android™ 13
Connection	WiFi+BT
Network	802.11 a/b/g/n/ac, BT5.0
Power Supply	DC5V/2A
Touch	Multi-touch
Ports	Type-c Port/Micro SD Card Slot/Sim Card

TROUBLESHOOTING

Q1. The tablet doesn't power on.

- * Reboot your tablet after charging for more than 30 minutes.
- * Press the power button to check if the tablet is in the **Sleep Mode**.
- * Press and hold the power button for 7-8s to reboot it.
- * Press the **Reset** button with a pin to reboot the tablet.

Q2. The tablet doesn't charge.

- * Make sure the USB cable is properly plugged into the charging port.
- * Try another compatible USB cable and adapter.

Q3. Error message occurs during the operation.

- * Uninstall the App with the error message, then download and install again.
- * Press the **Reset** button with a pin to reboot the tablet.

Q4. The tablet cannot be detected by the computer.

- * Make sure the tablet is powered on.
- * Try another USB cable.
- * Try another USB port on the computer.
- * Instead of **Charge only**, choose **Media device(MTP)** or **Camera(PTP)** when connecting the tablet to the computer.

Q5. The tablet cannot connect to the WiFi.

- * Make sure the WiFi in your tablet is **ON**.
- * Make sure you input the correct password when connecting the WiFi.
- * Restart the router.
- * Make sure there is no filter setting or device connection limitation in the setting of the router.
- * Forget the current WiFi, reset the router and connect the WiFi again.

Q6. The storage space of the tablet is not enough

- * Delete the Apps you don't use
- * Clear the cache of the Apps regularly
- * Install a microSD card to expand the storage.

Q7. The screen is unresponsive

- long press the power button until the tablet shuts down . Press again the power button to turn on the tablet .
- If tablet is still unresponsive , use it for a while until the battery drains . Then , charge the tablet afterwards .

CAUTION

RISE OF EXPLOSION IF BATTERY IS REPLACED BY AN INCORRECT TYPE. DISPOSE OF USED BATTERIES ACCORDING TO THE INSTRUCTIONS.



The symbol indicates DC voltage



RECYCLING

Get support by contacting us through |

Email : customercare@ubctech.ph

Telephone :0219520-8187

FCC Caution

This device complies with Part 15 of the FCC Rules. Operation is subject to the following two conditions: (1) this device may not cause harmful interference, and (2) this device must accept any interference received, including interference that may cause undesired operation.

Any changes or modifications not expressly approved by the party responsible for compliance could void the user's authority to operate the equipment.

Information to the user.

Note: This equipment has been tested and found to comply with the limits for a Class B digital device, pursuant to part 15 of the FCC Rules. These limits are designed to provide reasonable protection against harmful interference in a residential installation. This equipment generates and can radiate radio frequency energy and, if not installed and used in accordance with the instructions, may cause harmful interference to radio communications. However, there is no guarantee that interference will not occur in a particular installation. If this equipment does cause harmful interference to radio or television reception, which can be determined by turning the equipment off and on, the user is encouraged to try to correct the interference by one or more of the following measures:

- Reorient or relocate the receiving antenna.
- Increase the separation between the equipment and receiver.
- Connect the equipment into an outlet on a circuit different from that to which the receiver is connected.
- Consult the dealer or an experienced radio/TV technician for help.

Specific Absorption Rate(SAR) information:

This mobile phone meets the government's requirements for exposure to radio waves. The guidelines are based on standards that were developed by independent scientific organizations through periodic and thorough evaluation of scientific studies. The standards include a substantial safety margin designed to assure the safety of all persons regardless of age or health.

FCC RF Exposure Information and Statement The SAR limit of USA(FCC) is 1.6W/kg averaged over one gram of tissue. Device types: Portable Equipment(FCCID: 2BDCX-BULUSE-M11) has also been tested against this SAR limit. The highest SAR value reported under this standard during product certification for use at the head is 0.761W/kg and when properly worn on the body & worn is 0.726W/kg. This device was tested for typical body-worn operations with the back of the handset kept 0mm from the body. To maintain compliance with FCC RF exposure requirements, use accessories that maintain a 0mm separation distance between the user's body and the back of the handset. The use of belt clips, holsters and similar accessories should not contain metallic components in its assembly. The use of accessories that does not satisfy these requirements may not comply with FCC RF exposure requirements, and should be avoided.

BULUSE