

# BELEN Wall-Hung Toilet

## FEATURES

LSLF01WH01+TC01

- Wall-Hung Toilet
- Elongated Bowl
- Quick-Released Toilet Seat
- Powerful Rimless Flush
- Rear Outlet Design
- Full-Skirted Trapway
- Fully Glazed Trapway
- Installation Kit Included
- Compatible with In-Wall Cisterns



## SPECIFICATIONS

<b>Brand</b>	Los Flexi	<b>Dimensions</b>	22 <sup>7</sup> / <sub>16</sub> "D * 14 <sup>3</sup> / <sub>4</sub> "W * 13 <sup>3</sup> / <sub>16</sub> "H
<b>Model</b>	LF01WH01	<b>Installation Type</b>	Wall Mounted
<b>Color</b>	White	<b>Seat Material</b>	Polypropylene
<b>Bowl Material</b>	Ceramic	<b>Flush Type</b>	Rimless Flush
<b>Bowl Shape</b>	Elongated	<b>Country of Origin</b>	China
<b>Net Weight</b>	57.32LB	<b>Warranty</b>	2 Years Warranty

## PRODUCT VIEWS



Top View



Front View



Side View



Back View

## DIMENSIONS

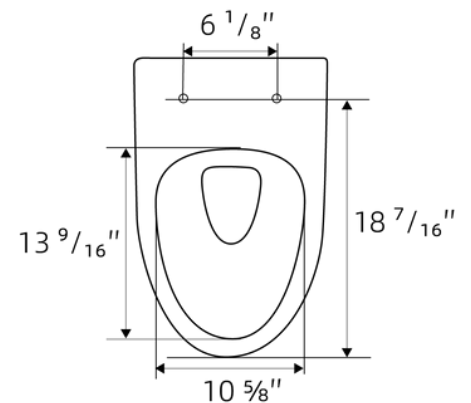
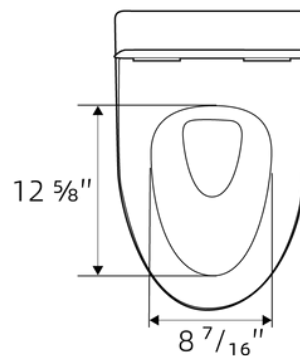
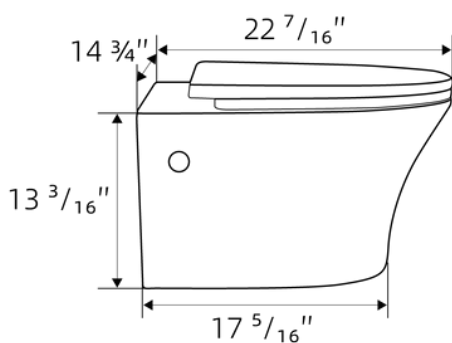
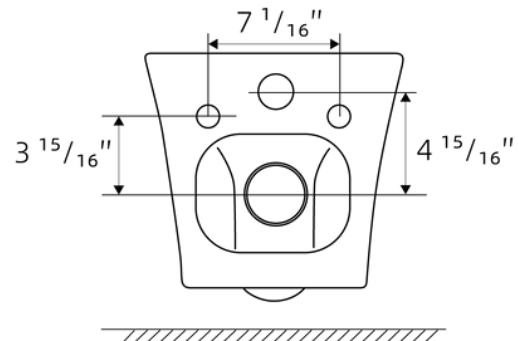
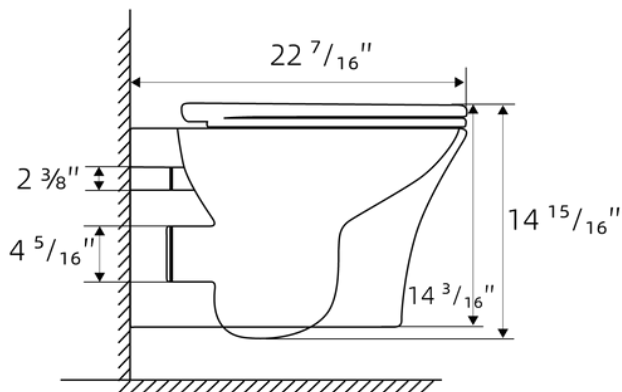

## PACKAGE INCLUDES



Toilet Bowl



Toilet Seat & Lid



Hole Cover



Plastic Tube & Set Screw

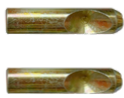

Stud Cover



Allen Key



Bracket



Plastic Nut



Seal



Retaining Bolt Key

Bowl Accessories



Cover



Fixing Bracket



Screw



Spigot

Seat Accessories

# In-Wall Tank & Carrier System

## FEATURES

- Concealed In-Wall Tank
- Dual Flush System
- 0.8/1.6 GPF Water Consumption
- Adjustable Mounting Height
- Flush Actuator Plate Included
- Installation Kit Included
- Compatible with G  $\frac{1}{2}$ " & G  $\frac{5}{8}$ " Water Line



LSLF01WH01+TC01

## SPECIFICATIONS

<b>Brand</b>	Los Flexi	<b>Dimensions</b>	2 $\frac{3}{4}$ "D * 19 $\frac{11}{16}$ "W * 49 $\frac{7}{16}$ "H
<b>Model</b>	LF01TC01	<b>Installation Type</b>	In-Wall
<b>Water Use</b>	0.8 & 1.6 GPF	<b>Adjustable Height</b>	0 - 4 $\frac{3}{4}$ "
<b>Flush Mode</b>	Dual Flush	<b>Min. Water Pressure</b>	7.25 psi (0.05 MPa)
<b>Net Weight</b>	33.29LB	<b>Max. Water Pressure</b>	362.60 psi (2.5 MPa)
<b>Warranty</b>	2 Years Warranty	<b>Country of Origin</b>	China

## PRODUCT VIEWS



Front View



Side View



Back View

## DIMENSIONS

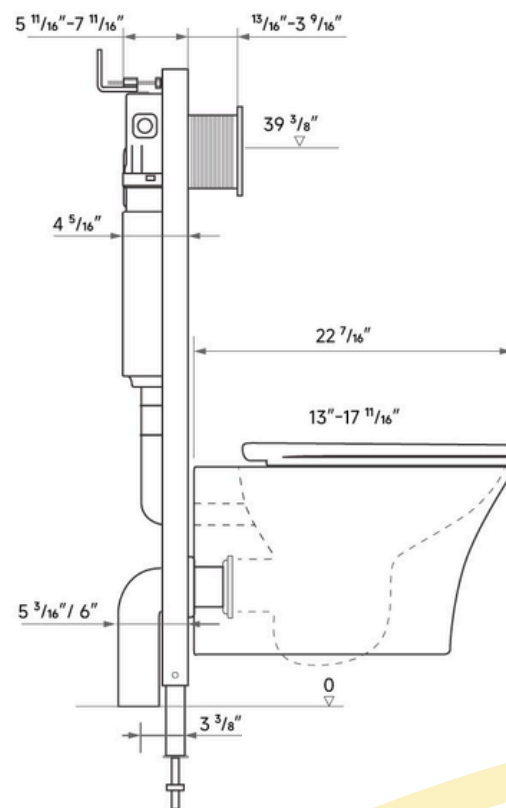
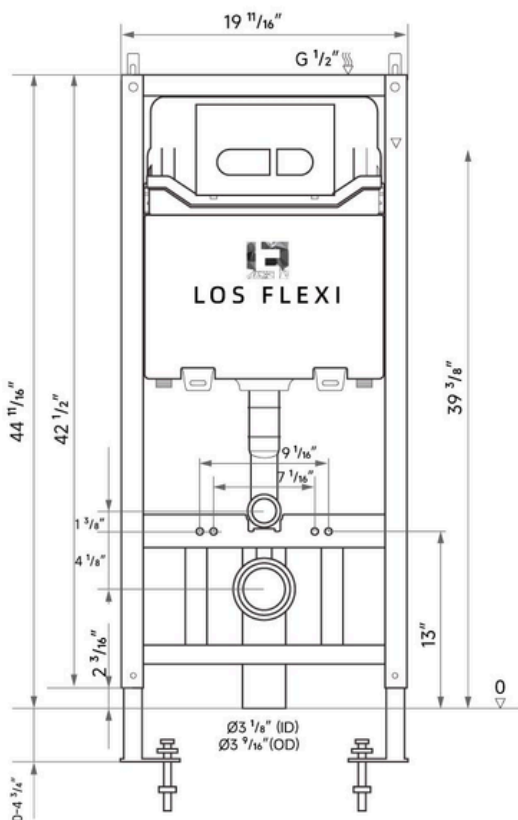

## PACKAGE INCLUDES



Tank & Carrier System



Flush Actuator Plate

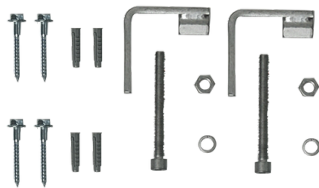

Carrier Fastening Kit



Push Plate Cover



Mud Cover Kit

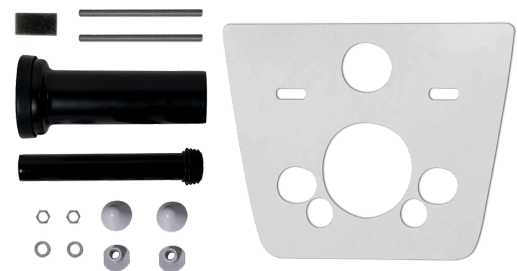

Tank-to-Bowl Installation Kit  
and Spare Parts



Brass Adapter

## DIMENSIONS

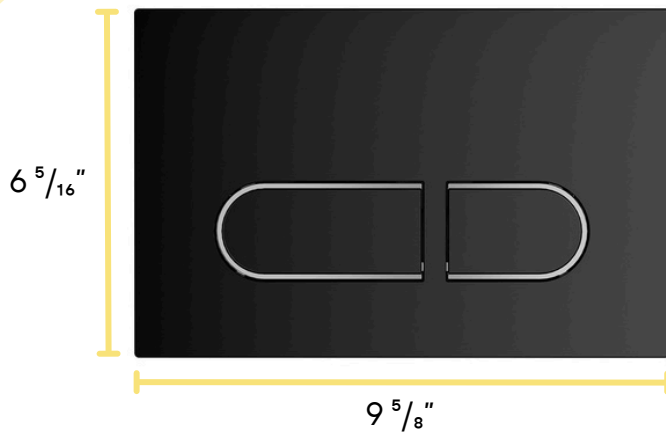

**Flush Plate**

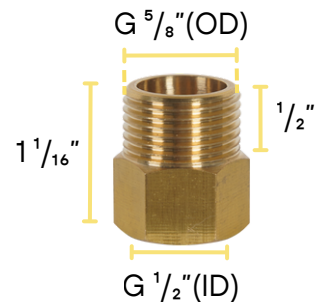

**Brass Adapter**



**Discharge Pipe**

