



INSTALLATION INSTRUCTIONS FOR PART 99-5815

APPLICATIONS

See application list inside

Ford/Lincoln/Mercury 2004-2012 99-5815

KIT FEATURES

- DIN radio provision with pocket
- ISO mount radio provision with pocket
- Double DIN radio provision
- Stacked ISO mount unit provision



KIT COMPONENTS

• A) Radio housing (DIN and ISO DIN) • B) ISO brackets • C) ISO trim plate • D) Side brackets • E) Radio housing (Double DIN and stacked ISO DIN) • F) Double DIN brackets • G) (4) Screws • H) (8) Spacers

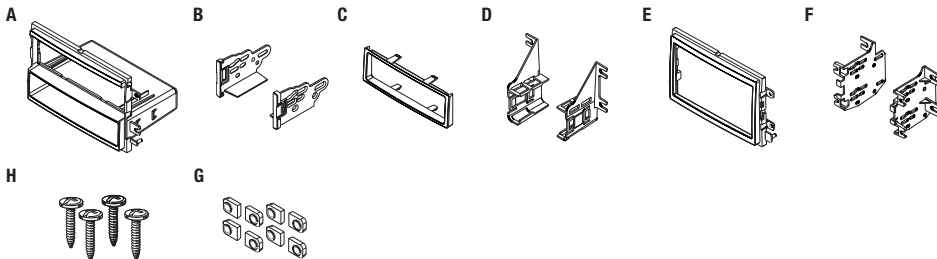

ANTENNA CONNECTIONS (sold separately)

Antenna Adapter:

- 40-CR10 - Chrysler antenna adapter 2002-up

TOOLS REQUIRED

- Cutting tool • Panel removal tool
- Phillips screwdriver • Socket set

CAUTION: Metra recommends disconnecting the negative battery terminal before beginning any installation. All accessories, switches, and especially air bag indicator lights must be plugged in before reconnecting the battery or cycling the ignition.

NOTE: Refer to the instructions included with the aftermarket radio.



99-5815

Applications

Ford

500	2005-2007
E-Series.....	2009-up
Edge	2007-2010
Expedition	2007-2012
Explorer	2006-2010
Explorer Sport Trac	2006-2010
F-150	2004-2008
F-Series Super Duty	2005-up
Focus	2005-2007
Freestar	2004-2007
Freestyle	2005-2007
Fusion	2006-2009
Mustang	2005-2009
Taurus	2008-2009
Taurus X	2008-2009

Lincoln

Navigator <i>with OE NAV</i>	2007-2012
Mark LT	2005-2008
MKX <i>with OE NAV</i>	2007-2009

Mercury

Milan	2006-2009
Montego	2005-2007
Monterey	2004-2007
Mountaineer	2006-2010
Sable	2008-2009



Dash Disassembly 99-5815

Ford F-150 2004-2008/ Edge 2007-2009/ Expedition 2007-2012, Lincoln Mark LT 2005-2008

1. Unsnap and remove entire panel surrounding the radio and climate controls. (Figure A)
2. Remove (4) 9/32" screws to remove the factory radio. (Figure B)

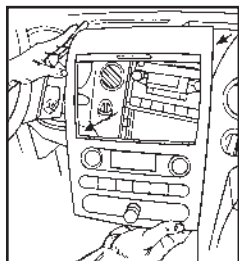

(Figure A)

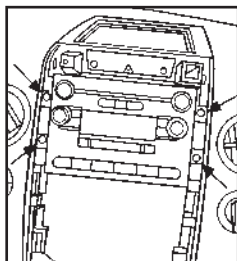

(Figure B)

Ford Mustang 2005-2009

1. Remove the small rectangular shifter lever trim panel if equipped. (Figure A)
2. Remove (2) Phillips screws from under the center armrest at the back of the shifter trim panel (including cup holders). (Figure B)
3. Unclip and remove panel. (Figure B)
4. Unclip and remove the (2) center stack trim panels from the left and right side of the radio and climate controls. (Figure C)
5. Remove (6) 9/32" screws from center trim panel surrounding the radio and climate controls then unclip and remove panel. (Figure D)
6. Remove (4) 9/32" screws from the radio to remove. (Figure E)

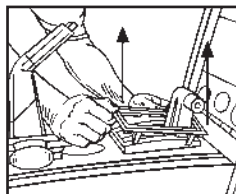

(Figure A)

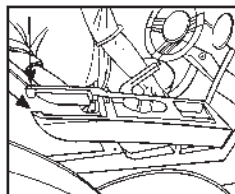

(Figure B)

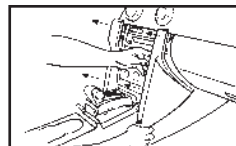

(Figure C)

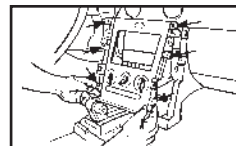

(Figure D)

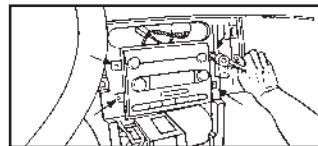

(Figure E)

Ford 500 2005-2007/ Taurus 2008-2009, Mercury Montego 2005- 2007/Sable 2008-2009

1. Unclip and remove the small rectangular trim around shift lever. (Figure A)
2. Unclip and remove the entire panel (including cup holders) surrounding the shift lever. (Figure B)
3. Remove (2) 9/32" screws at the bottom of the center radio/climate control panel. (Figure C)
4. Unclip and remove the center panel. (Figure D)



Dash Disassembly 99-5815

Ford 500 2005-2007/ Taurus 2008-2009, Mercury Montego 2005- 2007/Sable 2008-2009

5. Remove (4) 9/32" screws from the radio to remove. (Figure E)

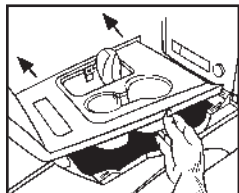

(Figure B)

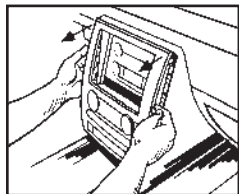

(Figure D)

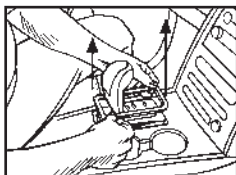

(Figure A)

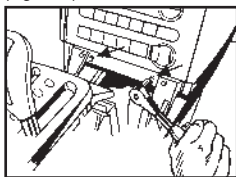

(Figure C)

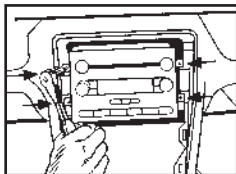

(Figure E)

Ford Fusion 2006-2009 Mercury Milan 2006-2009

1. Unsnap and remove entire panel surrounding the radio and climate controls. (Figure A)
2. Remove (4) 9/32" screws to remove the factory radio. (Figure B)

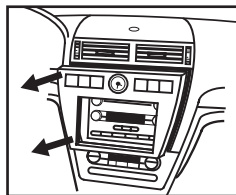

(Figure A)



(Figure B)

Ford Freestyle 2005- 2007/Taurus X 2008-2009

1. Unclip and remove entire panel surrounding the radio and A/C controls. (Figure A)
2. Remove (4) 9/32" screws from radio to remove. (Figure B)

Ford Freestyle 2005- 2007/Taurus X 2008-2009

Continue to kit assembly

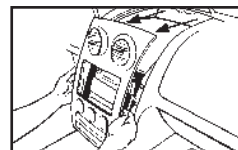

(Figure A)

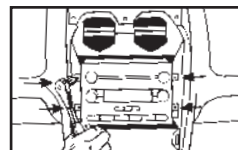

(Figure B)

Ford Freestar/Mercury Monterey 2004-2007

1. Unsnap and remove entire panel surrounding the radio and climate controls. (Figure A)
2. Remove (4) 9/32" screws to remove the factory radio. (Figure B)

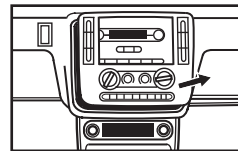

(Figure A)

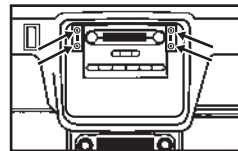

(Figure B)



Dash Disassembly 99-5815

Ford Focus 2005-2007

1. Unsnap and remove entire panel surrounding the radio and climate controls. (Figure A)
2. Remove (4) 9/32" screws to remove the factory radio. (Figure B)

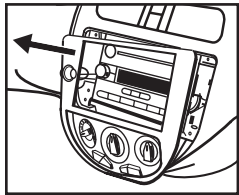

(Figure A)

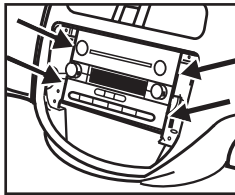

(Figure B)

Ford Explorer/Explorer Sport Trac/Mercury Mountaineer 2006-2010

2. Remove dash panel surrounding radio to access the factory radio screws. (Figure B)
3. Remove (4) 9/32" screws to remove the factory radio. (Figure B)

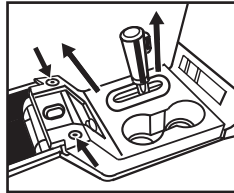

(Figure A)

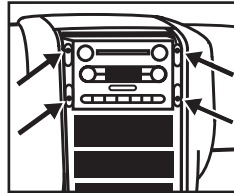

(Figure C)

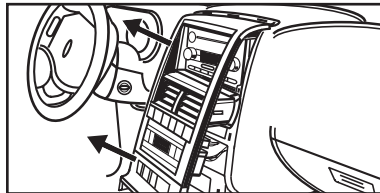

(Figure B)

Ford E-Series 2009-up/ F-Series Super Duty 2005-up

1. Unsnap and remove entire panel surrounding the radio and climate controls. (Figure A)
2. Remove (4) 9/32" screws to remove the factory radio. (Figure B)

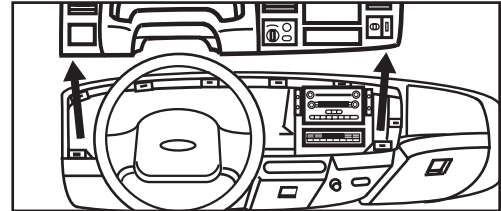

(Figure A)

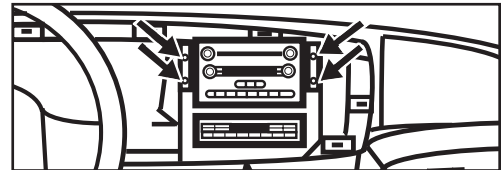

(Figure B)

Ford Explorer/Explorer Sport Trac/Mercury Mountaineer 2006-2010

1. Open center console and remove (2) Phillips screws then unclip and remove entire panel surrounding shifter. (Figure A)



Dash Disassembly 99-5815

Kit Assembly 99-5815

Lincoln Navigator 2007-2012

1. Unclip and remove the panel surrounding the shifter. (Figure A)
2. Remove (2) 9/32" screws from the bottom of the radio/climate control trim panel. (Figure B)
3. Unclip and remove the entire panel surrounding the radio and including the climate controls. (Figure B)
4. Remove (4) 9/32" screws securing the radio. Unplug and remove the radio.

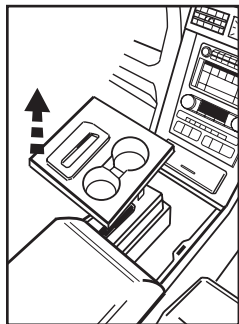

(Figure A)

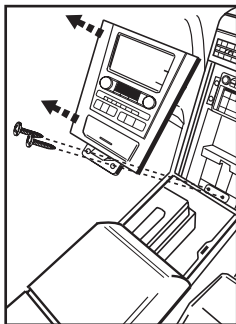

(Figure B)

Lincoln MKX 2007-2009

1. Open center console lid and unclip and remove the center console trim panel surrounding the shifter. (Figure A)
2. Remove (2) Phillips screws from the storage bin then unclip and remove the bin. (Figure B)
3. Unclip and remove the upper and lower center trim panel as one assembly. (Figure C)
4. Remove (4) 9/32" screws securing the radio. Unplug and remove the radio.

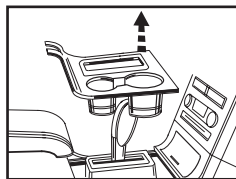

(Figure A)

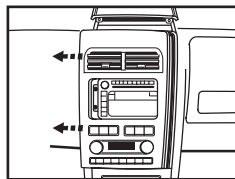

(Figure C)

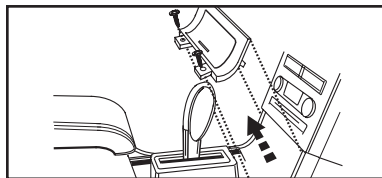

(Figure B)

DIN radio provision with pocket

1. (a) For the Ford Edge 2007-2010, Expedition 2007-2012, Explorer 2006-2010, Fusion 2006-2009, and the Mustang 2005-2009 attach the included spacers to the back of the radio housing mounting tabs. (Figure 1A)

Note: Use the screws supplied with this kit to mount the radio housing in the vehicles that require the spacers.

(b) For the Ford Freestar 2004-2007, Monterey 2004-2007, Focus 2005-2007, and the F-Series Super Duty 2005-2012, slide the included brackets onto the sides of the radio housings pocket from the back of the housing forward. (Figure 1B)

If your vehicle is not listed above move to Step 2.

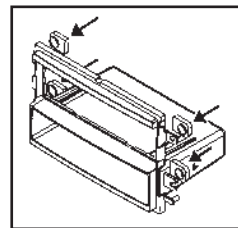

(Figure 1A)

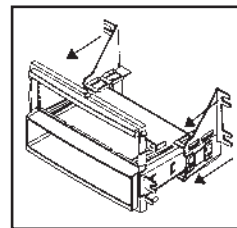

(Figure 1B)



Kit Assembly 99-5815

DIN radio provision with pocket

2. Slide the DIN cage into the radio housing and secure by bending the metal locking tabs outward. (Figure A)
3. Slide the aftermarket radio into the cage until it snaps in place. (Figure B)
4. Locate the factory wiring harness in the dash. Metra recommends using the proper mating adapter from Metra or AXCESS. Re-connect the negative battery terminal and test the unit for proper operation.
5. Reassemble dash in reverse order of disassembly.

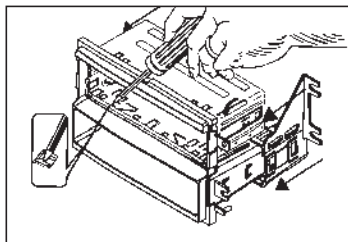

(Figure A)

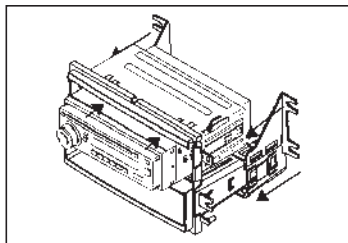

(Figure B)

ISO mount radio provision with pocket

1. (a) For the Ford Edge 2007-2010, Expedition 2007-2012, Fusion 2006-2009, and the Mustang 2005-2009 attach the included spacers to the back of the radio housing using the screws. (Figure 1A)

Note: Use the screws supplied with this kit to mount the radio housing in the vehicles that require the spacers.

- (b) For the Ford Freestar 2004-2007, Monterey 2004-2007, Focus 2005-2007, and the F Series Super Duty 2005-2012, slide the included brackets onto the sides of the radio housing pocket from the back of the housing forward. (Figure 1B)

If your vehicle is not listed above move to Step 2.

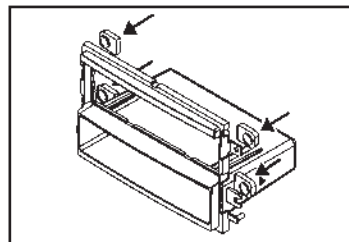

(Figure 1A)

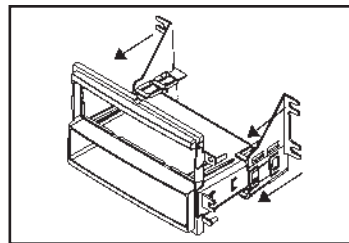

(Figure 1B)



Kit Assembly 99-5815

ISO mount radio provision with pocket

2. Mount the ISO brackets to the head unit with the screws supplied with the unit. (Figure A)
3. Slide the head unit into the radio opening until the side clips engage. (Figure B)
4. Snap the trim plate into the radio housing. (Figure B)
5. Locate the factory wiring harness in the dash. Metra recommends using the proper mating adapter from Metra or AXCESS. Re-connect the negative battery terminal and test the unit for proper operation.
6. Reassemble dash in reverse order of disassembly.

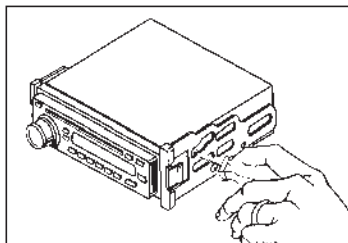

(Figure A)

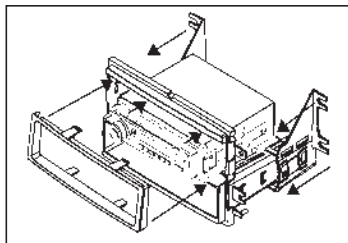

(Figure B)

Double DIN radio provision

1. For the Ford Edge 2007-2010, Expedition 2007-2012, Explorer/Fusion/Mercury Milan 2006-2009, F-150 2004-2008, Ford 500/Freestyle/Mercury Montego 2005-2007, Mustang 2005-2009, and the Lincoln Mark LT 2005-2008, cut and remove the rear mounting tabs from the double DIN brackets

If your vehicle is not listed above move to Step 2.

2. For the Ford Edge 2007-2010, Expedition 2007-2012, Explorer 2006-2010, Fusion 2006-2009, and the Mustang 2005-2009 attach the included spacers to the back of the radio housing mounting tabs.

If your vehicle is not listed above move to Step 3. (Figure A)

Note: Use the screws supplied with this kit to mount the radio housing in the vehicles that require the spacers.

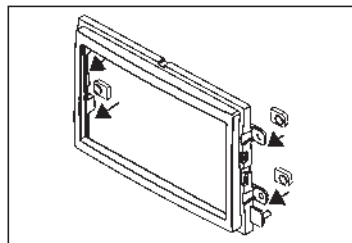

(Figure A)



Kit Assembly 99-5815

Double DIN radio provision

3. Attach the double DIN brackets to the radio housing.

Note: The notch in the housing should be on top. (Figure 3A, 3B)

4. Slide the double DIN radio into the radio housing/bracket assembly and secure the radio to the assembly using the screws supplied with the radio. (Figure C)

5. Locate the factory wiring harness in the dash. Metra recommends using the proper mating adapter from Metra or AXCESS. Re-connect the negative battery terminal and test the unit for proper operation.

6. Reassemble dash in reverse order of disassembly.

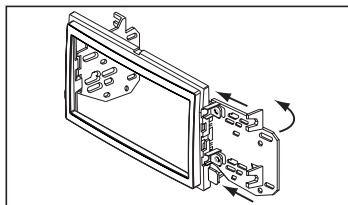

(Figure 3A)

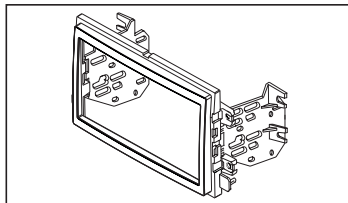

(Figure 3B)

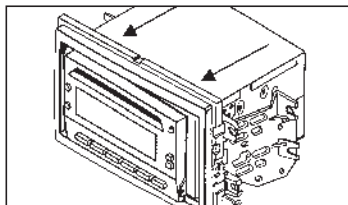

(Figure C)

Stacked ISO mount unit provision

1. For the Ford Edge 2007-2010, Expedition 2007-2012, Explorer/Fusion/Mercury Milan 2006-2009, F-150 2004-2008, Ford 500/Freestyle/Mercury Montego 2005-2007, Mustang 2005-2009, and the Lincoln Mark LT 2005-2008, cut and remove the rear mounting tabs from the Double DIN brackets.

If your vehicle is not listed above move to Step 2.

2. For the Ford Edge 2007-2010, Expedition 2007-2012, Explorer 2006-2010, Fusion 2006-2009, and the Mustang 2005-2009 attach the included spacers to the back of the radio housing mounting tabs. (Figure A)

If your vehicle is not listed above move to Step 3.

Note: Use the screws supplied with this kit to mount the radio housing in the vehicles that require the spacers.

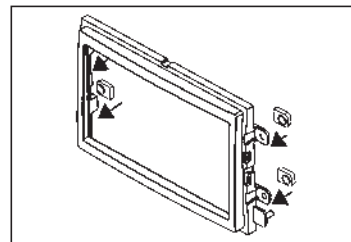

(Figure A)



Kit Assembly 99-5815

Stacked ISO mount unit provision

3. Attach the double DIN brackets to the radio housing.

Note: The notch in the housing should be on top. (Figure 3A, 3B)

4. Slide the ISO mount units into the radio housing/bracket assembly and secure the units to the assembly using the screws supplied with the units. (Figure C)

5. Locate the factory wiring harness in the dash. Metra recommends using the proper mating adapter from Metra or AXCESS. Re-connect the negative battery terminal and test the unit for proper operation.

6. Reassemble dash in reverse order of disassembly.

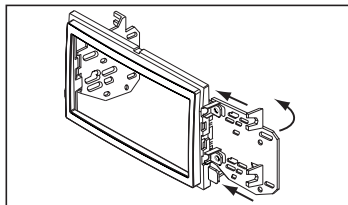

(Figure 3A)

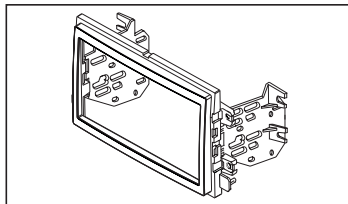

(Figure 3B)

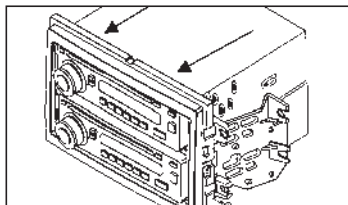

(Figure C)