

Matter Setup Instructions

How to Set Up MixPad D1 to Join a Third-Party Matter Hub

*This instruction is not intended for public or commercial use.



Preparation and Notes:

- First, prepare a hub that supports Matter protocol, such as speakers of Alexa/Google/Apple (Please refer to the FAQ for the specific list) , and add it to its specific App.
- MixPad D1 and the hub should be in the same LAN (local area network).
- The WiFi router should support or have IPv6 enabled.
- After you've joined a Matter controller, then if you want to change the light bulb type from "Dimmable" to "Non-Dimmable", or on the contrary, you need to reset or delete MixPad D1 from the present Matter hub and rejoin to show the right UI of the light bulb on the App.

1. How to get the "Add to App" Matter QR code on MixPad

D1 switch?

- For new or reset devices, the QR code will be displayed during the new device setup process, as shown below:

"Start" - "Select the Type of Light" - "Minimum Brightness Setting" - "Download and Install ORVIBO Home App" - "QR Code for Adding Matter/ORVIBO App"



- If the device skipped the setup process or has already joined the ORVIBO Home app: Navigate to the "Settings" page of MixPad D1 and tap on "Add to App".

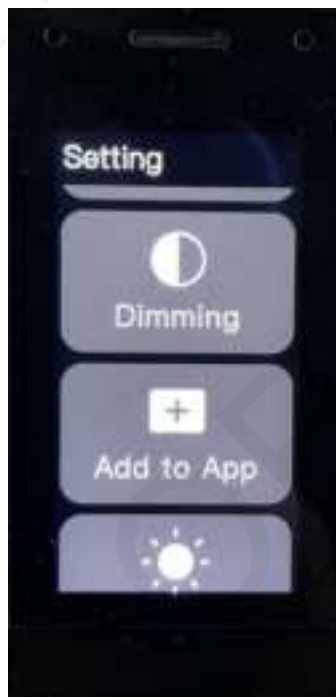

2. Using a Different Matter Supported App to Add MixPad D1 switch.

*Different app versions may have slight differences in the interface and steps mentioned below.

Using the Google Home App

- Open the camera app on your Android device.

- Scan the Matter QR Code and tap "Continue", then "Add".
- Tap on "Google Home" in the list of apps.



- Tap "I Agree" to add the product and then wait for the device to connect. Once the device is added, tap "Done".



- Choose a location for the device, then tap "Next".
- Give the device a name and tap "Next".
- Your Matter-enabled device has been successfully added.



Using the Alexa App

- Open the Alexa App, and tap on "Devices"
- Tap the "+" and select "Add Device".



- Tap "Connect your ORVIBO Light Bulb", then tap "Next" and "Yes" to "Scan QR Code"

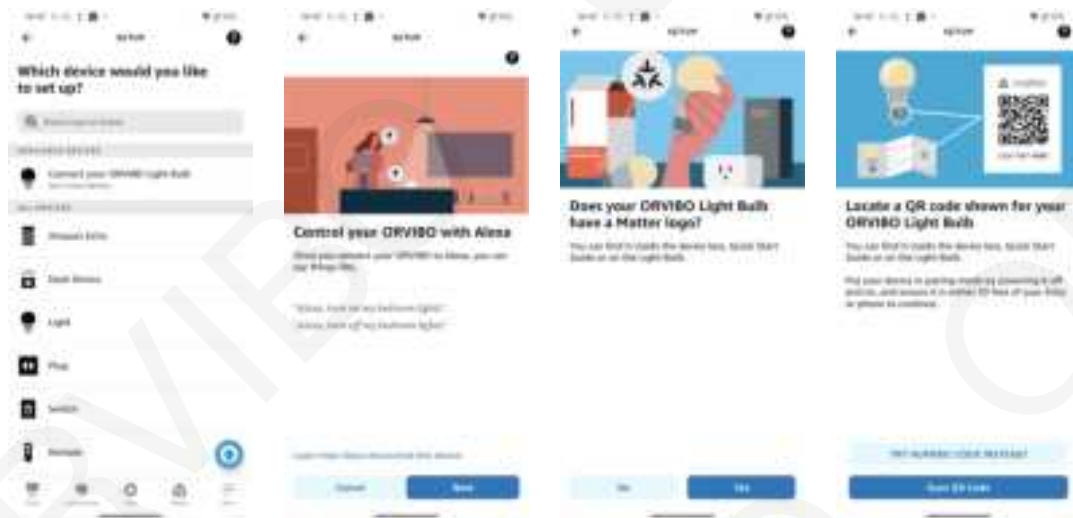

- Scan Matter QR Code on MixPad D1 switch.



- Select your network, then tap "Next" and wait for it to connect the network. Once the connection is established, the setup process is complete.



- Select your groups, tap "Add To Group" and done.

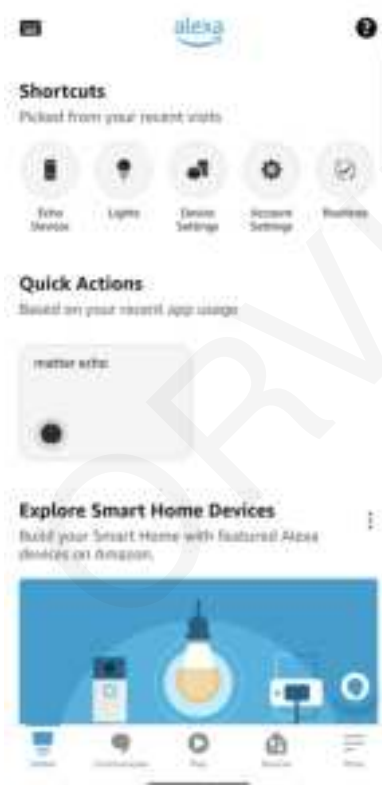

Using Apple Home App

- Open the Home app and tap "+" to "Add Accessory".
- Scan the Matter QR Code, then wait for the device to connect to the Home app.

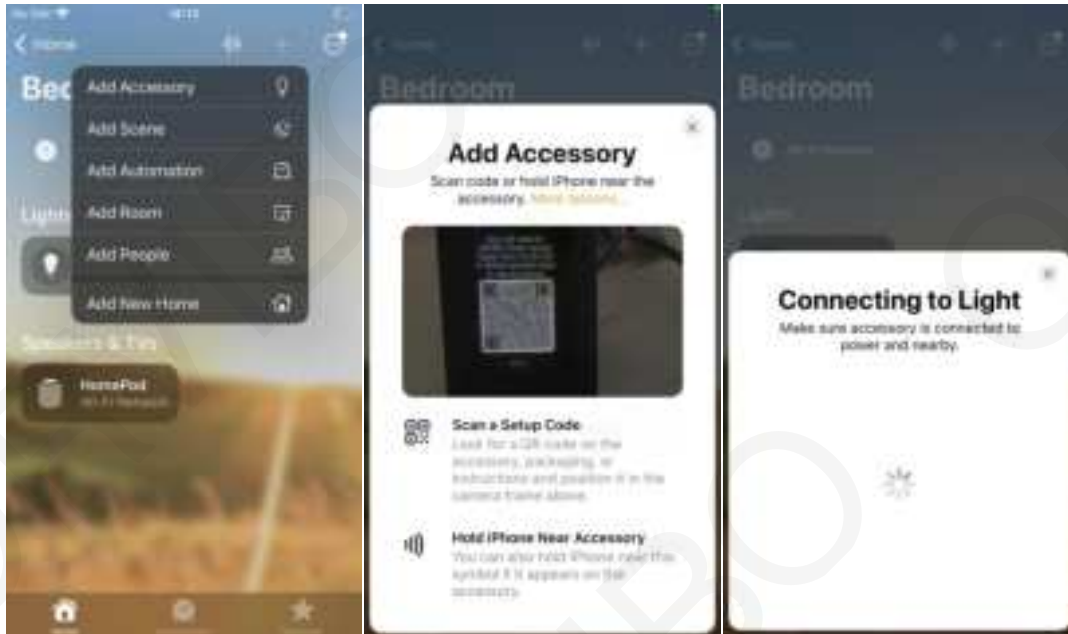

- Choose a location then tap "Continue", and then enter a name, tap "Continue".
The setup process is now complete.

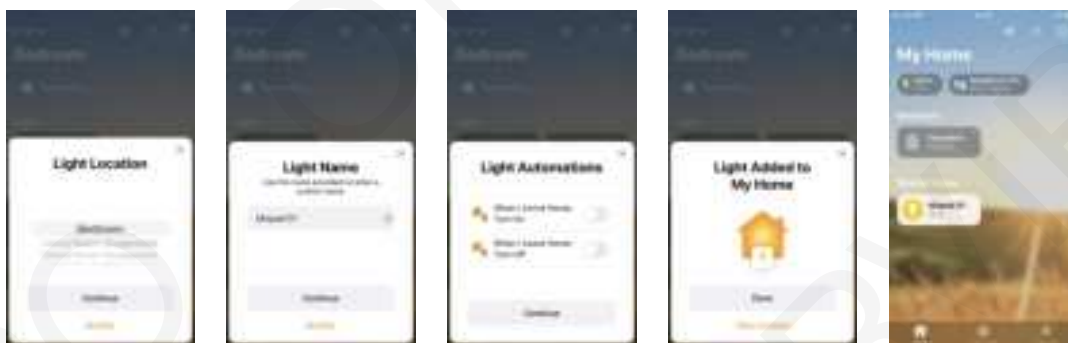

3. Adding MixPad D1 to the ORVIBO Home App (Currently, it does not support adding other Matter-compatible brands' products to this app):

Please refer to the instruction manual specific to the Orvibo MixPad D1 for guidance.