

HAMPTON BAY

USE AND CARE GUIDE

28 GALLON DECK BOX ASSEMBLY

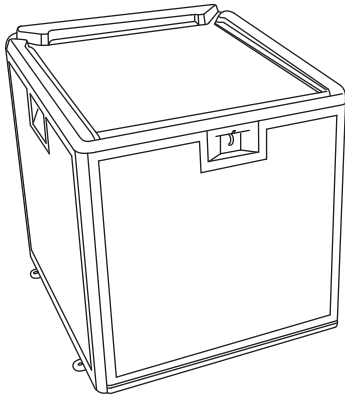

THANK YOU

We appreciate the trust and confidence you have placed in Hampton Bay through the purchase of this deck box. We strive to continually create quality products designed to enhance your home. Visit us online to see our full line of products available for your home improvement needs.
Thank you for choosing Hampton Bay!

Warranty

WHAT IS COVERED

This product is covered under a 2 year limited warranty against defects in materials and workmanship from the date of purchase.

WHAT IS NOT COVERED

This warranty does not cover damage due to neglect, abuse, or weather related damage.

Contact the Customer Service Team at 1-855-HD-HAMPTON or visit www.HAMPTONBAY.com.

HAMPTON BAY

Questions, problems, missing parts? Before returning to the store, call Hampton Bay Customer Service.

8 a.m. – 7 p.m., EST Monday – Friday, 9 a.m. – 6 p.m., EST Saturday

1-855-HD-HAMPTON

HAMPTONBAY.COM

Safety Information

CAUTION: Never use this product to store flammables, explosives, or hazardous materials.

CAUTION: To avoid the risk of suffocation, never allow children to play inside the container.

CAUTION: Supports 225 lb evenly distributed weight.

CAUTION: This product is not a toy and is not intended for use by children.

Pre-Assembly

TOOLS REQUIRED

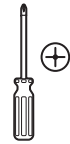

Phillips Screwdriver

PACKAGE CONTENTS

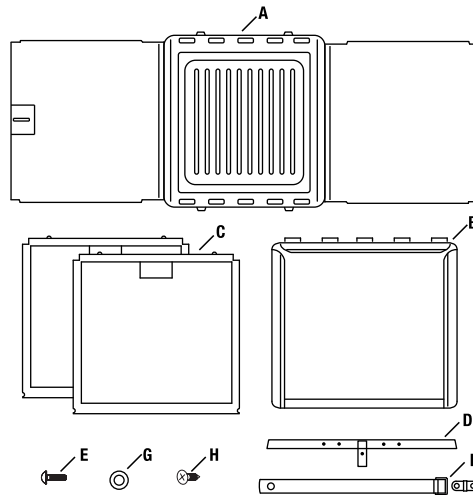

Part	Description
A	Front/Back/Bottom Panels x 1
B	Seat-Lid Panel x 1
C	Side Panels x 2
D	Lid Support x 1

Part	Description
E	Machine Screws x 2
F	Lid Strap/Clip x 1
G	Washer x 1
H	Self-Tapping Screws x 4

Assembly

1 Preparing for Assembly

- Place the front/back/bottom panel (A) on a level surface.
- Raise the front and back panels to an upright position.

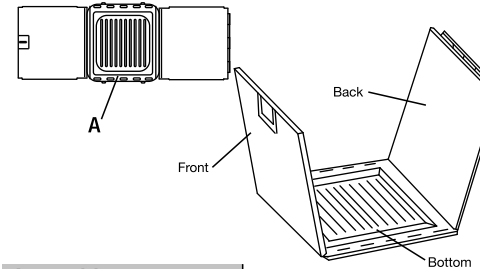

Assembly

3 Attaching the Seat-Lid Panel

- Attach the lid support (D) to the front edge of the seat-lid panel (B) using four self-tapping screws (H).
- Hold the seat-lid panel (B) horizontally and line up the lid hinge tabs with the back panel hinge pins.
- Push the seat-lid panel (B) horizontally into the hinge pins and rotate the seat-lid (B) closed to lock in place.

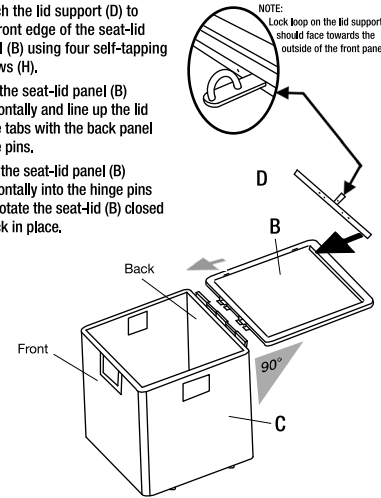

Assembly

2 Attaching the Side Panels

- Slide a side panel (C) into position using the slots at the edge of the front and back panels of (A).
- Push the side panel (C) down and press the lock tabs (1) into the slots (2) in the bottom panel of (A) to lock in place.
- Repeat for the other side panel.

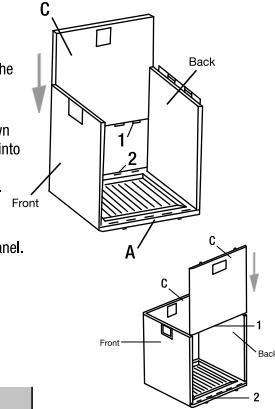

Assembly

4 Attaching the Strap

- Fold strap clip around the metal loop at the bottom end of the lid strap (F).
- Attach the finished end of the lid strap/clip (F) to the inside of the left side panel (C) with a machine screw (E).
- Attach the top end of the strap to the seat-lid panel (B) using the washer (G) and other machine screw (E).

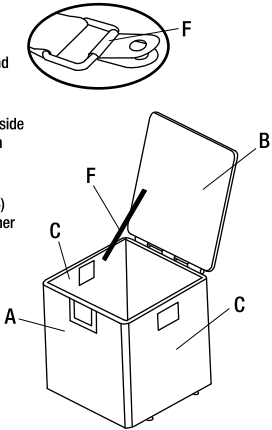

Care and Cleaning

- Use soap and water with a soft cloth to clean the product. DO NOT use bleach, ammonia, or caustic cleaners, as these will damage the finish.
- Locks, latches, and hinges should be lubricated regularly, and gas shocks wiped with a dry cloth to remove dust and dirt.
- Rinse with clean water and dry with a soft, absorbent cloth towel.