

VOICE RECOGNITION TIPS

(If equipped)

BLUETOOTH®

Command

Example

Dial <Phone #> ——— “Dial 7-1-4-9-6-5-3-0-0-0”

Call <Name> ——— “Call John Smith”

Improving how you store your contacts can optimize your Bluetooth® Voice Recognition performance:

• Use full names instead of short or single-syllable names (“John or Dad”)

• Avoid using special characters/emojis or abbreviations (“Dr.”) when saving contacts

NAVIGATION

Command

Example

Find Address ——— “1-2-3-4-5 1st Street, <House #, Street, City, State>

Find <POI Name> — “Find McDonald’s”

- ☐ HOW TO DEFROST - page 19
 - 1 Press the front windshield defrost button.
 - 2 Set to warmest temperature setting.
 - 3 Set to highest fan speed.
- ☐ WINDSHIELD WIPER / WASHER - page 09

MIST

OFF

INT/AUTO

LO

HI

- To activate wipers, move the switch down to one of the three positions (INT, LO, HI).
 - To adjust "INT" speed, move switch.
 - To spray washer fluid, pull lever toward you.
 - Push lever up for a single wiper pass.

- ☐ INTRODUCTION AND LOCATION OF THE SERVICE DEPARTMENT
- ☐ SET FIRST SERVICE APPOINTMENT
- ☐ REVIEW FACTORY RECOMMENDED MAINTENANCE SCHEDULE
- ☐ WAS THE CONDITION OF YOUR VEHICLE (AT DELIVERY) TO YOUR SATISFACTION?

- ☐ BLUELINK®
 - Assist with creating MyHyundai.com account
 - Assist with Bluelink enrollment
 - Show Bluelink User's Manual
 - Encourage customer to download the MyHyundai with Bluelink® app

MAINTENANCE

Scheduled Maintenance	Normal Usage		Severe Usage*	
Tire Rotation	Perform	5,000 or 4 mos.	Perform	Same As Normal
Climate Control Air Filter (for Evaporator and Blower Unit)	Replace	15,000 or 12 mos.	Replace	More Frequently
Air Conditioning Refrigerant	Inspect	15,000 or 12 mos.	Inspect	Same As Normal
Brake Hoses & Lines	Inspect	15,000 or 12 mos.	Inspect	Same As Normal
Drive Shafts & Boots	Inspect	15,000 or 12 mos.	Inspect	More Frequently
Disc Brake/Pads, Calipers & Rotors	Inspect	15,000 or 12 mos.	Inspect	More Frequently
Steering Gear Rack, Linkage & Boots/ Lower Arm Ball Joint, Upper Arm Ball Joint	Inspect	15,000 or 12 mos.	Inspect	More Frequently
Brake fluid	Inspect	15,000 or 12 mos.	Inspect	Same As Normal
Coolant	Replace	40,000 or 36 mos	Replace	Same As Normal
Reduction Gear Fluid	Inspect	35,000 or 28 mos.	Inspect	75,000
*See Owner's Manual for details.				

Looking For more detailed information? This Quick Reference Guide does not replace your vehicle's Owner's Manual. If you require additional information or are unsure of a specific issue, we recommend that you always refer to the vehicle's Owner's Manual or contact your authorized Hyundai dealer. The information contained in this Quick Reference Guide is correct at the time of printing; however, specifications and equipment can change without notice. No warranty or guarantee is being extended in this Quick Reference Guide, and Hyundai reserves the right to change product specifications and equipment at any time without incurring obligations. Some vehicles are shown with optional equipment.

HYUNDAI IONIQ ELECTRIC

Quick Reference Guide



Roadside Assistance: 1-800-243-7766
Consumer Affairs: 1-800-633-5151
Sirius XM® Radio: 1-800-967-2346
Bluelink: 1-855-2BLUELINK (1-855-225-8354)



Sales Consultant

Date

Sales Manager

Date

Customer

Date

Email

HYUNDAI VEHICLE OWNER PRIVACY POLICY

Your Hyundai vehicle may be equipped with technologies and services that use information collected, generated, recorded or stored by the vehicle. Hyundai has created a Vehicle Owner Privacy Policy to explain how these technologies and services collect, use, and share this information.

You may read our Vehicle Owner Privacy Policy on the Hyundaiusa.com website at <https://www.hyundaiusa.com/owner-privacy-policy.aspx>. If you would like to receive a hard copy of our Vehicle Owner Privacy Policy, please contact our Customer Care Center at:

Hyundai Customer Care
P.O. Box 20850
Fountain Valley, CA 92728
800-633-5151
consumeraffairs@hmmausa.com

Hyundai's Customer Care Center representatives are available Monday through Friday, between the hours of 6:00 AM and 5:00 PM PST and Saturday between 6:30 AM and 3:00 PM PST (English). For Customer Connect Care assistance in Spanish or Korean, representatives are available Monday through Friday between 6:30 AM and 3:00 PM PST.

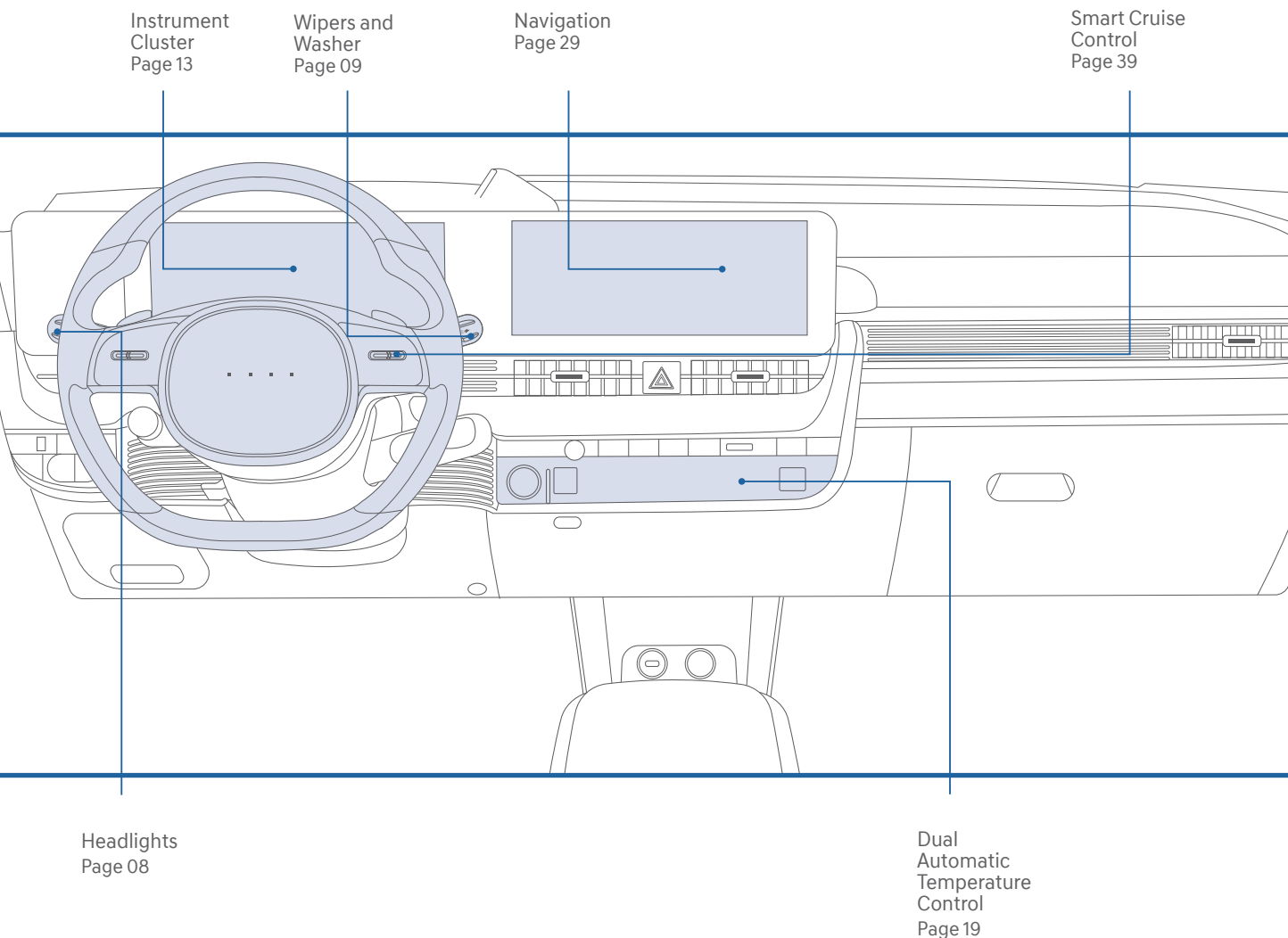

FEATURES AND CONTROLS

Automatic climate control system	19
Aux. battery saver+	17
Charging door	06
Driver's main controls	03
Electric vehicle system modes	18
Hand free smart liftgate	05
Headlights	08
High voltage battery SOC (state of charge) gauge	15
Homelink wireless control system	11
Instrument cluster	13
Instrument panel illumination	17
Key hole access (driver door)	10
LCD display control	16
LCD display modes	16
Power liftgate operation	05
Seat-Driver position memory system	03
Seat-Heated/Ventilated front seat	02
Seat-Power driver's seat adjustment	01
Seat-Rear seat adjustment	02
Service interval reminder system	17
Vehicle power gauge	15
Vision roof	04
Warnings and indicators	13
Wipers and washer	09

INFOTAINMENT

Android Auto™	31
Apple CarPlay™	33
Bluelink connected car system	24
Bluetooth® phone call operational tips	22
Bluetooth® phone operational	21
Bluetooth® phone pairing	21
Navigation	29
Radio mode	28
Steering wheel audio control	21
USB charger	27
USB port	27
Voice recognition tips	23
Wireless cellular phone charging system	27

DRIVING

Blind-Spot collision warning (BCW)	42
Digital key pairing	44
Drive mode	46
Electronic parking brake (EPB)	40
Forward collision-avoidance assist (FCA)	41
Highway driving assist (HDA)	40
Lane keeping assist system (LKA)	41
Near field communication (NFC)	45
Regenerative brake level control paddles	37
Shift By Wire Gear Selector	37
Smart cruise control	39
Tire pressure monitoring system (TPMS)	43
Virtual engine sound system (VESS)	42

WARNING!

To reduce the risk of serious injury to yourself and others, read and understand the important SAFETY INFORMATION in your Owner's Manual.

Use this Quick Reference Guide to learn about the features that will enhance your enjoyment of your Hyundai. More detailed information about these features are available in your Owner's Manual.

* Some vehicles may not be equipped with all the listed features.

POWER DRIVER'S SEAT ADJUSTMENT

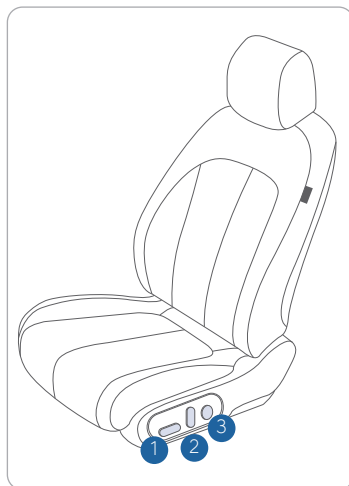

Forward and backward ①

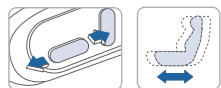

Seat height ①



Seatback angle ②



Lumbar support ③

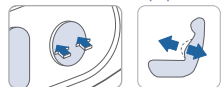

REAR SEAT ADJUSTMENT

Forward and rearward adjustment Seatback angle

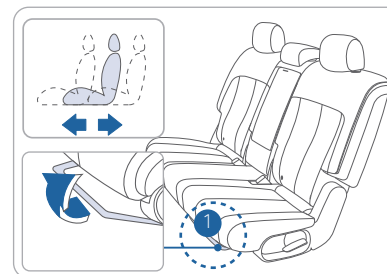

Pull the adjustment lever up ① to move seat forward or backward and release the lever.

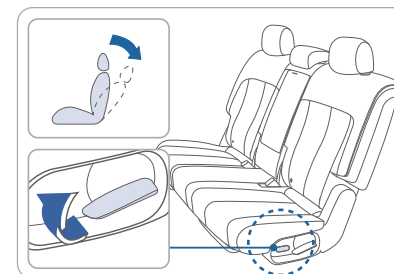

Pull the seatback lever up to change the seatback angle and release the lever.

HEATED/VENTILATED FRONT SEATS

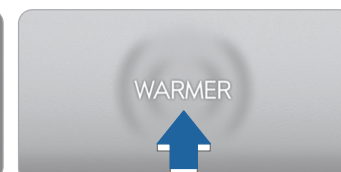
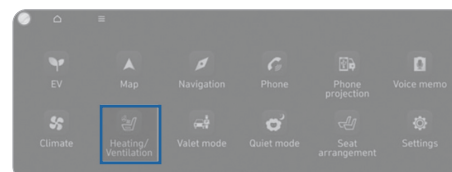

While the vehicle is running, touch Heating/Ventilation icon in the infotainment home screen. Press WARMER in the front climate control panel.

To activate seat warmer/air ventilation of each front seat, touch ▲ icon on the infotainment screen. Adjust the temperature by pressing either ▲ or ▼ icons.

DRIVER POSITION MEMORY SYSTEM

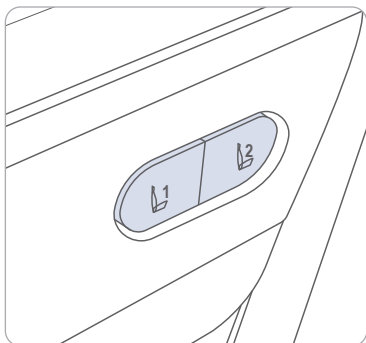

Storing Memory Positions

1. Shift to P (Park) while the Start/Stop button is in the ON position.
2. Adjust the driver's seat position, outside rearview mirror position, and head-up display height to the desired position.
3. Hold the button (1 or 2). The system will beep once and notify you 'Driver 1 (or 2) settings saved' will appear on the infotainment screen.

NOTE: The gear position must be in P (Park).

Recalling

Press the desired memory button (1 or 2). The system will beep once.

DRIVER'S MAIN CONTROLS

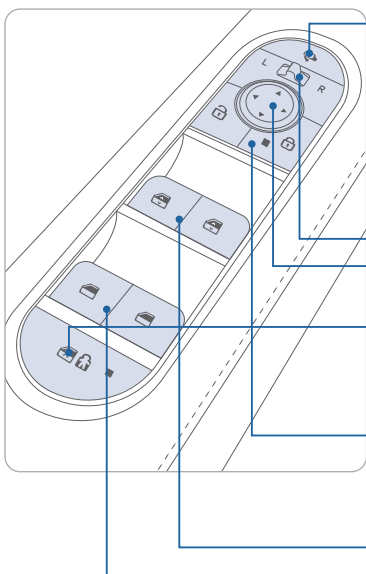

Folding outer side view mirrors

Press to fold/unfold mirrors.
Press the lock or unlock button on the smart key in AUTO position, and the mirrors will be folded or unfolded.

Outer side view mirror

- Press the L or R button.
- Adjust the mirror by using the directional switch.

Power window lock button

Disables the power window switches on the rear passenger doors.

Door lock

Locks/unlocks all doors.

Window switches

- Front doors power window switches.
- Rear doors power window switches.

VISON ROOF (if equipped)

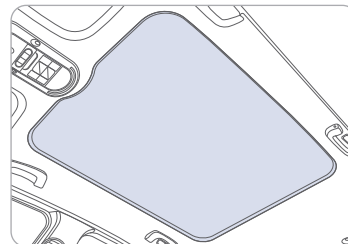

If your vehicle is equipped with a vision roof, you can slide open the power sunshade and an all-glass roof appears.

Power sunshade

Use the power sunshade to block direct sunlight coming through the sunroof glass.

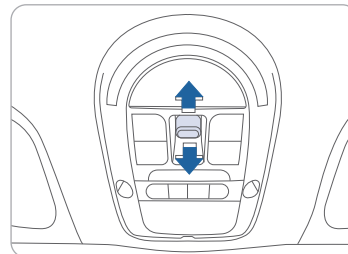

The power sunshade can only be operated when Start/Stop button is in the ON or START position.

- Push the switch rearward, the power sunshade automatically slides open.
- Push the sunroof switch forward, the power sunshade automatically closes.

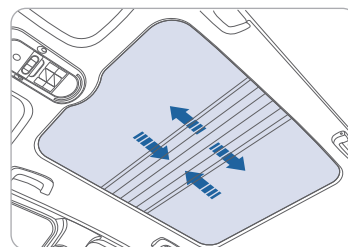

To stop the power sunshade at any point, push the switch in any direction.

Resetting the Vision Roof

1. It is recommended to perform the reset procedure with the vehicle in the ready mode. Start the vehicle in P (Park).
2. Make sure the power sunshade is in the fully closed position. If the power sunshade is open, push the switch forward until the power sunshade and is fully closed.
3. Release the switch when the power sunshade is fully closed.
4. Push the switch forward until the power sunshade moves slightly. Then release the switch.
5. Once again push and hold the switch forward until the power sunshade slides open and close. Do not release the switch until the operation is completed.

POWER LIFTGATE OPERATION

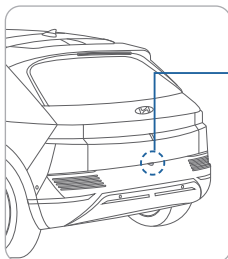

Press to open.
Smart key must be within the range.

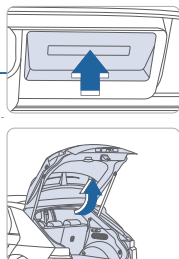

Press for about 1 second to open. Press and hold to close.

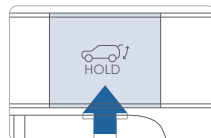

Car must be in Park (P). Press for about 1 second to open. Press and hold to close.

HANDS FREE SMART LIFTGATE

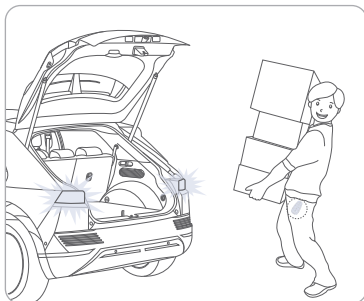

On vehicles equipped with Smart Liftgate, the liftgate can be opened with no-touch activation.

To activate

To enable Smart Liftgate, go to User Settings mode on the LCD display, or Setup, then Vehicle on the Navigation display and under the Door menu make sure the Power Liftgate and Smart Liftgate boxes are checked.

Power Liftgate Opening Height

For your convenience, there are four levels to adjust the liftgate opening height. These can be selected in the User Settings menu.

1. Select User Settings from the LCD Display, or Setup - Vehicle from the Navigation screen.
2. Select Door Menu, then Power Liftgate Opening Height
3. Choose between Level 1 ~ 3 or Full Open

Hands Free Smart Liftgate Operation

The liftgate can be opened with no-touch activation after the below conditions are met:

- After 15 seconds from when all doors are closed and locked
- You approach the rear of the vehicle (liftgate area) for at least 3 seconds with the Smart Key in your possession

CHARGING DOOR

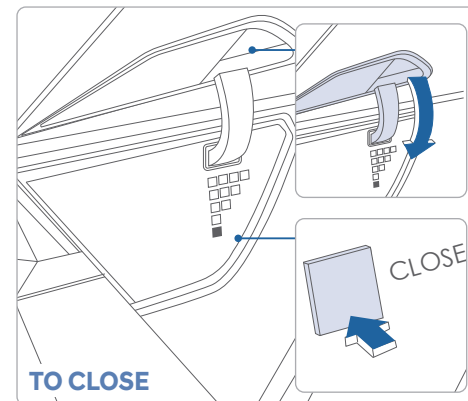
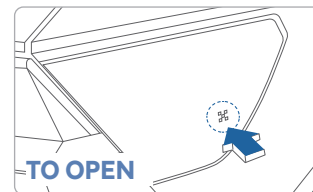

To open, press on the outside of the charging door or use the Smart Key. After recharging, install the bottom inlet cover first before installing the upper inlet cover. Press the close button to close the charging door.

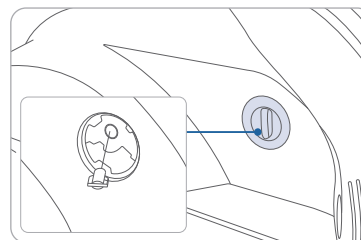

Emergency charging door opening

If the charging door does not open by pressing the release button, open the tailgate and pull the emergency cable.

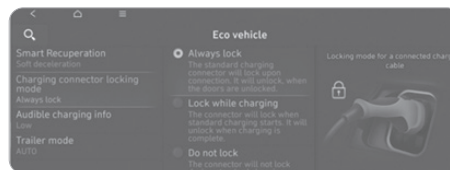

Charging Connector Lock

Locking mode for connected charging cable.

	Always lock	Lock while charging	Do not lock
Before charging	○	×	×
While charging	○	○	×
Finished charging	○	×	×

Charging Status

Electric Charging door

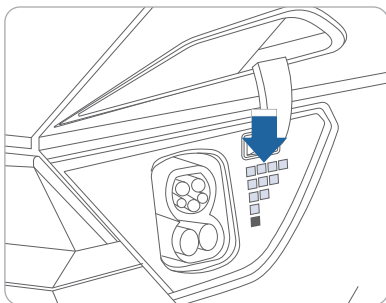

Front Center Bumper (if equipped)

Electric Charging door

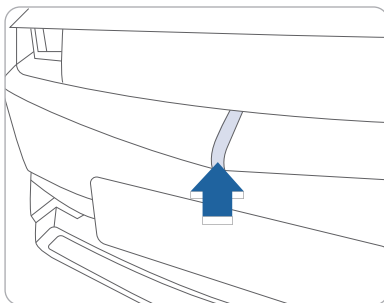

Lamp status	Battery SOC (%)
	0~24
	25~49
	50~74
	75~100

Lamp status	Battery SOC (%)
	0~20
	21~40
	41~60
	61~80
	81~100

HEADLIGHTS

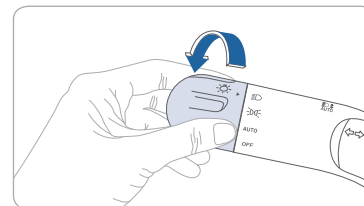

- Headlights
- Parking lights
- Auto headlights
- All lights OFF

Headlight Delay

Headlights may stay on for 15 seconds after exiting and locking vehicle. Press the lock button on the smart key twice to turn the headlights off.

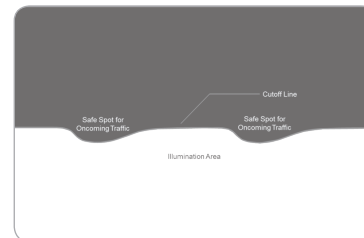

LED Headlights

This vehicle is equipped with a special beam pattern that helps achieving the good road illumination distance while protecting oncoming driver's eye.

It is normal to see a certain dark spot or pattern on the beam. Please refer the beam pattern shape illustrated.

Turn signals and lane change signals

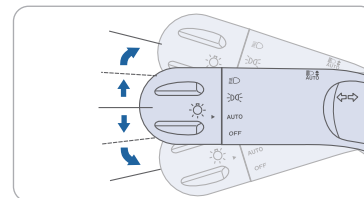

Flashing headlights

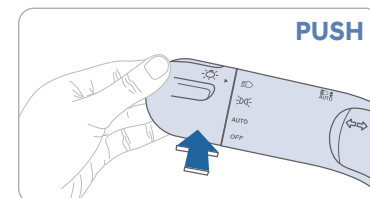
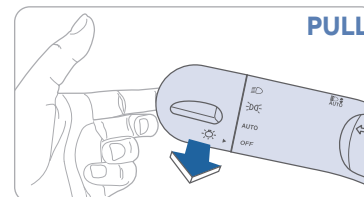

NOTE: To turn off the high beam, pull the lever towards you.

Smart High Beam Function

1. Select auto position.
2. Push lever forward to engage Auto High Beam.
3. Push lever forward again to disengage.

WIPERS AND WASHER

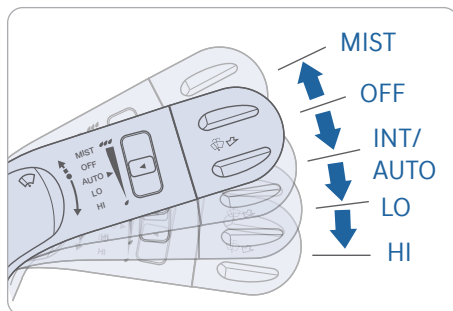

- MIST** - Single wipe
- OFF** - Off
- INT** - Intermittent wipe
- LO** - Low wiper speed
- HI** - High wiper speed

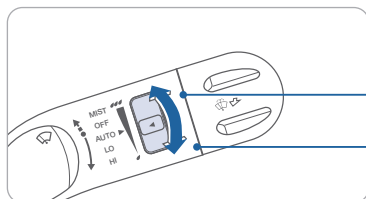

Intermittent wipe time adjustment
Move the speed control switch

- Fastest wiper speed
- Slowest wiper speed

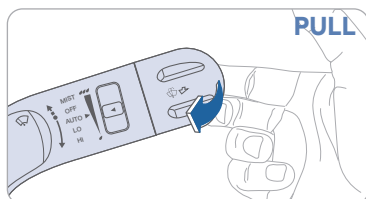

Windshield Washer

Pull the lever gently towards you to spray washer fluid on the windshield and to run the wipers 1-3 cycles.

KEY HOLE ACCESS (driver door)

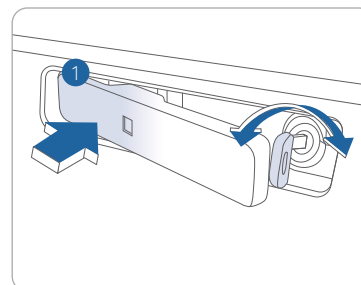

Press the front part ① of the door handle to pull out the rear part of the door handle. While keep pressing the front part of the door handle, insert the mechanical key to the lock.

To lock the door, turn the key toward the front (left side) of the vehicle. To unlock, turn the key toward the rear (right side) of the vehicle.

HOMELINK WIRELESS CONTROL SYSTEM

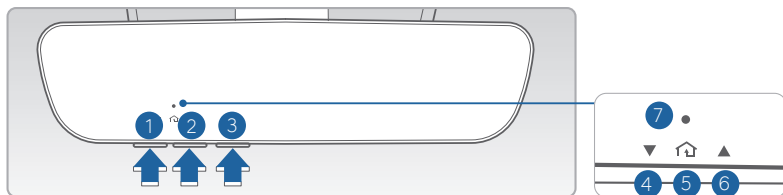

1. Press and release ①, ② or ③ button.
 - If the indicator ⑦ is turned ON in Orange, go to Step 3 (programming mode)
 - If the indicator ⑦ is continuously turned ON or flashes in Green rapidly several times, go to Step 2 (erasing mode)
2. Press and hold the button you wish to program for approximately 15- 25 seconds until the LED flashes in Orange for several times.
3. Hold the Garage Door Opener Original Transmitter near the HomeLink Mirror.
4. Press the Original Transmitter button until the indicator ⑦ is turned continuously ON or flashes in Green for approximately 10 seconds and it indicates the programing is completed.

NOTE: If the indicator ⑦ flashes in Green continuously, but if the garage door opener does not operate, please continue to follow Rolling Code Programming steps below.

Two Way Communication

Some new garage door openers come equipped with a two-way communication feature. If your garage door opener has this feature, please also continue to follow the Rolling Code Programming steps below. For more information and programming tips on two-way communication please visit www.homelink.com/compatible/two-waycommunication or call (800)-355-3515.

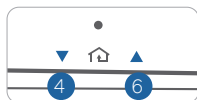

Indicator ④ & ⑥:

Flashes in orange → “Closing” & “Opening”
Solid Green → “Closed” & “Opened”

NOTE: If your garage door opener has Two-Way Communication functionality, it is possible for HomeLink to stop functioning the garage door shortly after initial programming, if the Two-Way Communication Programming wasn't properly completed. If you experience this, completing the “Programming a New HomeLink Button” and “Two-Way Communication Programming” will restore door operation.

Rolling Code Programming

- You may need a ladder to access your garage door opener.
- You may need help from a second person.
- Be prepared some of the steps are time sensitive.

1. Firmly press and release the “Learn”, “Smart”, or “ Program” button of garage door opener on the ceiling while the indicator ⑦ flashes in Green. Once the button is pressed, you have approximately 30 seconds to initiate the next step.

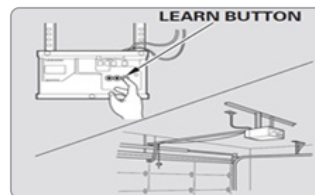

2. Return to the vehicle and firmly press the HomeLink button, hold for two seconds and release the button up to three times. Do not press the HomeLink button rapidly. At this point programming is complete and your device should operate.

For more detailed information, please refer to your Owner's manual or visit www.homelink.com or call (800) 355-3515



INSTRUMENT CLUSTER

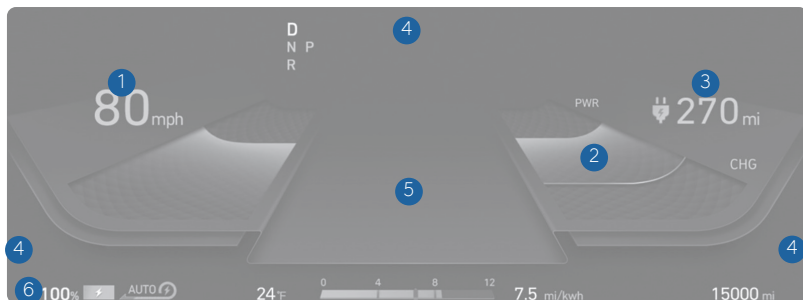

- 1 Speedometer
- 2 Power/Charge gauge
- 3 Distance to empty
- 4 Warning indicator lights
- 5 LCD display
- 6 Battery SOC (State of Charge) gauge

WARNINGS AND INDICATORS

Ready indicator	Service warning light	Power down warning light
Charging indicator	High voltage battery low level warning light	Air bag warning light
Seat belt warning light	Parking brake & brake fluid warning light	EPB Electric Parking Brake (EPB) warning light
Anti-lock Brake System (ABS) warning light	Electronic Brake force Distribution (EBD) System warning light	Electric Power Steering (EPS) warning light
Charging system warning light (for 12-volt battery)	TPMS Malfunction / Low tire pressure warning light	AUTO HOLD indicator
Lane Keep Assist System (LKAS) indicator	Rear Cross-Traffic Collision Warning	LED headlamp warning light
Master warning light	Electronic Stability Control (ESC) Indicator Light	Electronic Stability Control (ESC) OFF indicator light
Adaptive Front Lighting System (AFLS) warning light	Immobilizer indicator	Turn signal indicator light
High beam indicator light	Light ON indicator light	CRUISE indicator
SET Cruise SET indicator	SPORT mode indicator	ECO mode indicator
Forward Collision Avoidance Assist		

Main indicators in cluster for Electric Vehicle

- Ready indicator**
When the vehicle is ready to be driven, this indicator is illuminated.
When the ready indicator goes off or blinks, we recommend the vehicle be checked by an authorized HYUNDAI dealer.
- Service warning light**
If a problem with the electric vehicle control system occurs, the service warning light will illuminate. We recommend the vehicle be checked by an authorized HYUNDAI dealer.
- Power down warning light**
When the vehicle power should be limited for the safety of the electric vehicle, this warning light illuminates. Charge the battery immediately when the high voltage battery level is not enough.
- Charging cable indicator**
This indicator shows the charging status of the high voltage battery.
• When a charge cable is connected, the indicator illuminates in red. The approximate charge time will be displayed on the dash after a few minutes.
- High voltage battery low level warning light**
This warning light illuminates when the high voltage battery level is low.
When the warning light turns ON, charge the battery immediately.

NOTE: DC Quick charge session is time limited and may not reach maximum charge in one session depending on initial battery % SOC. The maximum charge possible in Ioniq Electric is 94% SOC on a DC Quick charger which will show a slightly lower range than with Level-1 and 2 chargers with maximum possible charge to 100% SOC.

VEHICLE POWER GAUGE

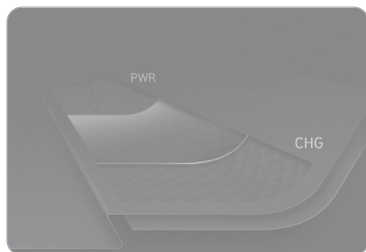

The ECO guide shows the energy consumption rate of the vehicle and the charge/discharge status of the regenerative brakes.

POWER

It shows the energy consumption rate of the vehicle when driving uphill or accelerating.

ECO

It shows the energy consumption rate during normal driving condition.

CHARGE

It shows the charging status of the battery when it is being charged by the regenerative brakes (decelerating or driving on a downhill road).

HIGH VOLTAGE BATTERY SOC (STATE OF CHARGE) GAUGE

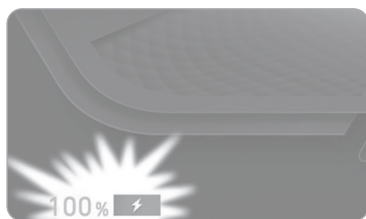

The SOC gauge shows the charging status of the high voltage battery. "L(Low)" position on the indicator indicates that there is not enough energy in the high voltage battery. "H(High)" position indicates that the driving battery is fully charged. When there are 2~3 gauge bars (near the "L(Low)" area) on the gauge, the warning light turns ON and, the vehicle can drive an additional 12~18 miles depending on the driving condition. Charging is required.

LCD DISPLAY CONTROL

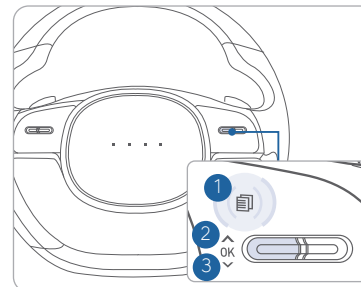

- 1 : MODE button for changing modes
- 2 : MOVE switch for changing items
- 3 : SELECT / RESET button for setting or resetting the selected item

LCD DISPLAY MODES

Modes	Symbol	Explanation
Trip Computer		This mode displays driving information such as the tripmeter, fuel economy, etc.
Turn By Turn (TBT) (if equipped)		This mode displays the state of the navigation.
Assist		<ul style="list-style-type: none"> This mode displays the state of the Advanced Smart Cruise Control (ASCC) and Lane Keep Assist System (LKAS). This mode displays information related to Tire Pressure.
User Settings		In this mode, you can change settings of the doors, lamps, etc.
Warning		This mode displays warning messages related to the Blind Spot Detection system, etc.

INSTRUMENT PANEL ILLUMINATION

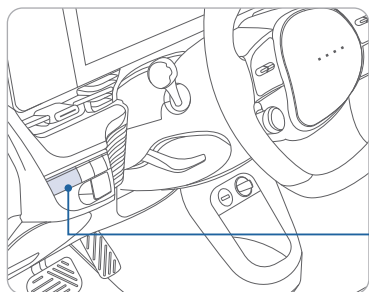

Press the illumination control button to adjust the instrument cluster illumination brightness.



SERVICE INTERVAL REMINDER SYSTEM



This system is designed to notify you of your next vehicle maintenance interval.

To Activate:

Press the (Mode) button on steering wheel and navigate to user settings and select the following:

Service Interval > Enable Service Interval > Set/Adjust Interval.

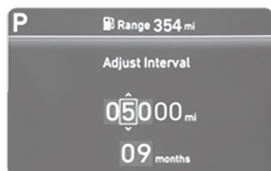

AUX. BATTERY SAVER+



The Aux. Battery Saver+ function monitors the charging status of the 12 V auxiliary battery. If the auxiliary battery level is low, the main high voltage battery charges the auxiliary battery.

NOTE: Do not touch the high voltage electric wire(orange), connector, and all electric components and devices when the function is activating.

ELECTRIC VEHICLE SYSTEM MODES

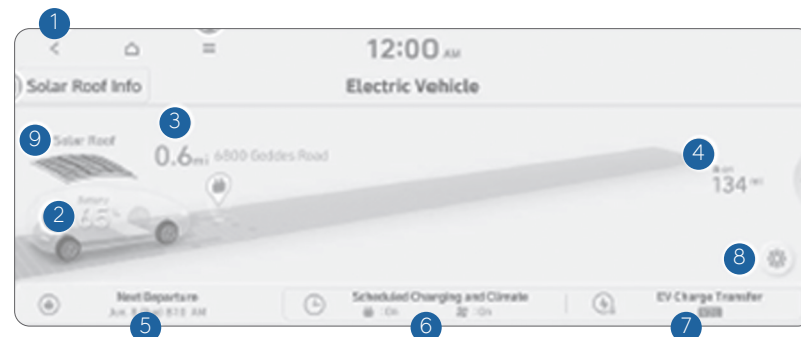

- 1 Returns to the previous step.
- 2 View the current battery level.
If you press the vehicle image, the energy information screen appears.
- 3 Can search for nearby charging stations.
The details of charging stations displayed on the map screen may not match the actual information.
- 4 View the distance to empty for the current climate control settings.
The details of drivable range displayed on the map screen may not match the actual information.
- 5 Set the next departure time. ▶ See "Setting the next departure time."
- 6 Configure settings to perform charging and/or climate control according to the departure time. ▶ See "Scheduling a charge and climate controls."
- 7 Set an electricity usage limit. ▶ See "Setting an electricity usage limit."
• V2L: This technology uses the battery power of an electric vehicle to power electronic devices in the vehicle.
- 8 You can set to enable the Electric Vehicle mode. ▶ See "Configuring the EV settings."
- 9 Shows the solar roof charging status (if equipped).

AUTOMATIC CLIMATE CONTROL SYSTEM



- 1 Driver's temperature control
- 2 Passenger's temperature control
- 3 Display the air flow direction
- 4 View climate infotainment screen
- 5 AUTO(automatic control)
- 6 Mode selection button
- 7 Fan speed up
- 8 Fan speed down / OFF
- 9 Front windshield defroster
- 10 Rear windshield defroster
- 11 Air intake control
- 12 Driver only mode
- 13 A/C (air conditioning) ON/OFF
- 14 Heating ON/OFF
- 15 SYNC
- 16 Ambient temperature display
- 17 Seat warmer/air ventilation infotainment screen



To view the climate information screen, select Climate in the main infotainment screen when the vehicle is ON.

DEFOGGING/DEFROSTING

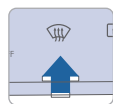

1. Press the front windshield defrost control button.

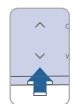

2. Set the temperature control to the warmest setting.

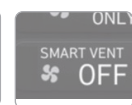

3. Set the fan speed to the highest setting.

NOTE: To reduce the tendency of the glass fogging and also to improve visibility, keep the interior surface of the windshield clean by wiping it with a clean cloth and glass cleaner. In addition, select air intake control to the outside (fresh) air position whenever possible while operating the vehicle.

AUTOMATIC HEATING / AIR CONDITIONING



1. Press the AUTO button.



2. Set the temperature control to the desired setting.

Controls the modes, fan speeds, air intake and air-conditioning automatically.

SYSTEM OFF

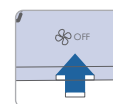

Pressing the OFF button will place the system in the OFF mode.

- Blower will turn off.
- Outside (fresh) air position will be selected.
- Vented air will be at last set temperature.

MODE SELECTION



Changes the direction of the air flow as follow.



AIR INTAKE CONTROL



Recirculated air position



Outside (fresh) air position

Air from the passenger compartment will be recirculated through the system and heated or cooled according to the function selected.

Air enters the vehicle from outside and is heated or cooled according to the function selected.

HEAT BUTTON



To manually control the system, push the HEAT button to turn the heater on.

DRIVER ONLY



If you press the DRIVER ONLY button, cold air mostly blows in the direction of the driver's seat.

REAR WINDOW DEFROSTER

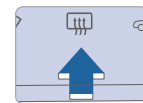

Press to activate/deactivate the rear window defroster.

BLUETOOTH PHONE PAIRING

Pairing tutorials, phone compatibility and operational tips can be found through the Smart QR code using the QR reader application on your Smartphone.



BLUETOOTH PHONE OPERATION

Phone setup (pairing phone)

1. Turn Bluetooth® on from your mobile phone. : All Menus > Setup > Device Connections > Bluetooth > Bluetooth Connections > Add New.

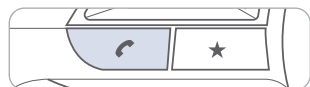
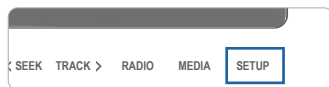

2. Select the function to connect.

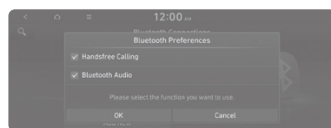

3. Turn on Bluetooth on the Bluetooth device to connect and select the vehicle system on the list of searched devices.



4. Bluetooth is connected.

NOTE: Vehicle must be parked to complete pairing process.

STEERING WHEEL AUDIO CONTROL

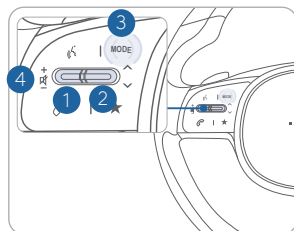

1. **VOLUME**
Raises or lowers the speaker volume. Press to Mute.
2. **SEEK / PRESET**
Changes the station.
3. **MODE**
Changes the audio source.
4. **MUTE**
Press the MUTE button to mute the sound
Press the MUTE button again to activate the sound

BLUETOOTH OPERATIONAL TIPS

In the following situations you or the other party may have difficulty hearing each other:

1. Keep the Bluetooth volume low. High level volume may result in distortion and echo.
2. When driving on a rough road, high speeds and/or with the window open.
3. When the air conditioning vents are facing the microphone and/or when the air conditioning fan is at the max speed.

Steering wheel bluetooth control

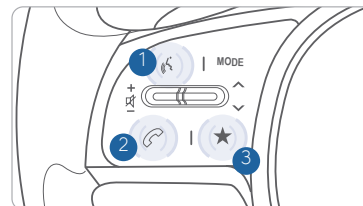

1. **VOICE RECOGNITION**
Activates voice recognition of a connected smartphone via phone projection. Activates system voice recognition on vehicles equipped with navigation.

2. **CALL/ANSWER/CALL END**
Answer a call or end a call. Press and hold to reject an incoming call.

3. **CUSTOM**
Use a custom function.
Press and hold to access the Custom Button settings screen.

To Answer a Call:

- Press the button on the steering wheel.

To Reject a Call:

- Press the button on the steering wheel.

To Adjust Ring Volume:

- Use the VOLUME buttons on the steering wheel.

To Transfer a Call to the handset (private mode):

- Press and hold the button on the steering wheel until the audio system transfers a call to the phone.

To Finish a Call:

- Press the button on the steering wheel.

Making a call using voice recognition:

Use your smartphone's functions, such as calling and messaging, from the [push to talk] button.

On vehicles equipped with navigation, use the [push to talk] button to activate the system voice recognition.

The menu tree identifies available voice recognition Bluetooth® functions.

Calling by Name:

1. Press the  button.
2. Say the following command:
 - “Call <John>”: Connects the call to John.
 - “Call <John> <on Mobile / at Work / at Home >”: Connects the call to John's Mobile, Home, or at Work phone number.

Dialing by Number:

1. Press the  button.
2. Say “Dial Number”.
3. Say the desired phone number.

For the complete list of commands, please refer to your Owner's Manual.

VOICE RECOGNITION TIPS

Your vehicle may be equipped with a Voice Recognition technology which allows drivers to operate their phones without having to take their eyes off of the road to minimize distractions.

Voice recognition performance may be affected if driving with windows and sunroof open; when the heating-cooling system is on; when passing in a tunnel or when driving on rugged and uneven roads.

Quick reference on using voice commands:

To start a voice command, press the  button, the following commands are available:

Command	Function
More Help	Provides guidance on commands that can be used anywhere in the system.
Help	Provides guidance on commands that can be used within the current mode.
Calls <Name>	Calls <Name> saved in Contacts. Ex) Call “John”
Dial <Number>	Call can be made by dialing the spoken numbers. Ex) Call “123”
Phone	Provides guidance on Phone related commands. After saying this command, say “Call History”, “Contacts” to execute the corresponding functions.
Contacts (Call by Name)	Displays the Contacts screen. After saying this command, say the name of a contact saved in the Contacts to automatically connect a call.
Dial Number	Displays the Dial number screen. After saying this command, you can say the number which you want to call.

BLUELINK CONNECTED CAR SYSTEM

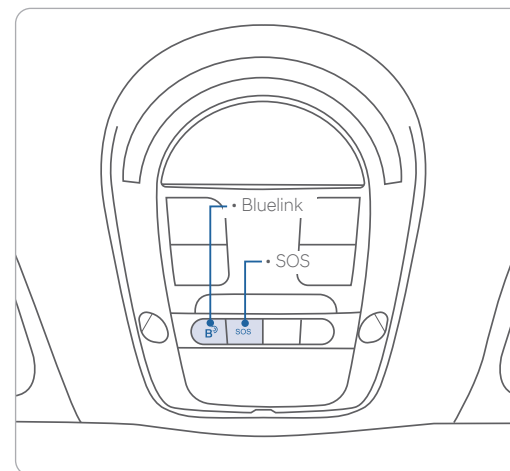

Bluelink subscription is required. To enroll, please visit your dealership or MyHyundai.com.

Press the **B** button to access the voice-response menu of services.

- You can say:

Service Link
Roadside Assistance
Bluelink Account Services
Help
Cancel

Press the **SOS** button for SOS Emergency Assistance.

Visit HyundaiBluelink.com for more information or refer to your Bluelink User's Manual for detailed information on system operation.

For immediate assistance with subscription services, please call 1-855-2BLUELINK (1-855-225-8354).

MyHyundai with Bluelink App



You can download the MyHyundai with Bluelink app to your compatible smart phone from the following sites:

- iPhone® — Apple® App Store
- Android™ — Google Play™

Visit HyundaiBluelink.com FAQs to see a list of compatible devices.

Remote Climate Control

Remote Climate Control* enables you to remotely enable climate control and turn on the front window defroster, ensuring a warm or cool car is ready to go when you are.

- To use this feature, you must have a Bluelink Personal Identification Number (PIN). To create or change your PIN, log in to www.MyHyundai.com.

Remember:

- Remote Start will automatically shut off after 10 minutes or after selected engine timer runs out.
- To continue to operate the vehicle, the proximity key must be inside the vehicle with the driver, prior to pressing the brake and being able to move the gearshift from the P (Park) position.

NOTE: Remote Climate Control is not available on all models. Remote Climate Control is only available for Push Start equipped vehicle with an Automatic Transmission. Remote Climate Control with Climate Control additionally requires Fully Automatic Temperature Control.

Preconditions:

- Ignition is OFF
- Alarm is armed (i.e., vehicle locked by key fob Remote Door Lock)
- Gearshift level is in the P (Park) position
- Brake pedal is not depressed
- Engine hood is securely closed
- All the doors are closed and locked
- The tailgate or trunk lid is closed
- The security / panic system is not activated
- The battery power is not low
- Vehicle is located in an open area
- It has been less than 4 days since last vehicle ignition off
- Vehicle located in area with good cell reception

Remote Climate Control will terminate:

- After 15 minutes or after selected engine timer runs out
- Brake is pressed without the proximity key inside the vehicle
- Alarm is triggered without the proximity key inside the vehicle
- Door / trunk is opened from inside the vehicle

Notice: Laws in some communities may restrict the use of the features that remotely start the engine. For example, some laws may require a person using the remote start feature to have the vehicle in view when doing so, or limit the length of time a vehicle engine may idle. Please check local and state regulations for any requirements and restrictions on remote starting of vehicles and engine idling time.

WARNING!

Do not remote start vehicle in an enclosed environment (i.e., closed garage). Prolonged operation of a motor vehicle in an enclosed environment can cause a harmful build-up of carbon monoxide. Carbon monoxide is harmful to your health. Exposure to high levels of carbon monoxide can cause headaches, dizziness or in extreme cases unconsciousness and / or death. Do not leave children or animals unattended in a vehicle while using the remote start function.

CAUTION!

If the vehicle's windshield wipers are left on when the vehicle was last driven, then the wipers will turn on if the remote start function is activated. To avoid damage to the wiper blades (i.e., due to heavy ice or snow accumulated on the windshield), please always turn the vehicle's windshield wipers off when parking the vehicle.

WIRELESS CELLULAR PHONE CHARGING SYSTEM

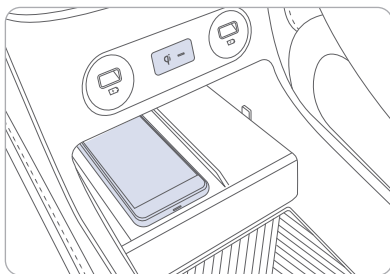

There is a wireless cellular phone charging system in front of the cup holders. The system operates with all doors closed, and the Engine Start/Stop button in the ACC/ON/START position.

Wireless charging system can be disabled in the instrument cluster settings menu.

NOTE: The wireless cellular phone charging system supports only the Qi-enabled cellular phones (Qi).

NOTE: Do not place any metallic items such as coins, keys on the charger. Avoid placing credit cards on the charger as they may be damaged by the magnetic field.

The charging area may be warm while using wireless charging.

USB PORT

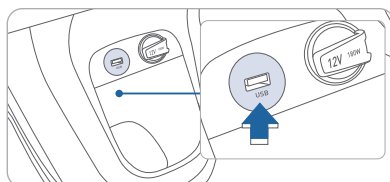

Use the input jack to connect an external audio device and listen to it through the audio system in your vehicle.

USB CHARGER

FRONT USB CHARGER

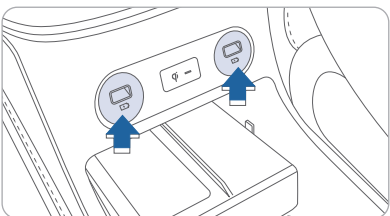

The USB charger is designed to recharge batteries of small size electrical devices using a USB cable.

The electrical devices can be recharged when the Start/Stop button is in the ON or START position.

REAR USB CHARGER

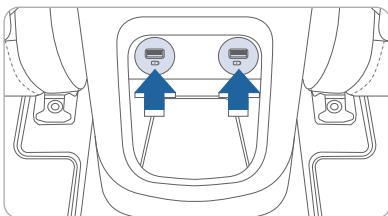

RADIO MODE



Press **POWER** button **A** to turn radio on.

TUNING/LISTENING TO CHANNELS

1. Press **BAND** button **B** on screen to select FM/AM/SiriusXM®.
2. Select **SEEK/TRACK** **C** to desired channel.

NOTE A clear view of the southern sky helps ensure SiriusXM® radio reception.

SETTING PRESET MEMORY BUTTONS

Press and hold any preset button **D** on the screen until an audible beep is heard to store current channel.

ADJUSTING THE SOUND CONTROL

1. On the All Menus screen, press **Setup > Sound**
The sound settings screen appears.
2. Adjust to desired setting.



NAVIGATION

Basic features on the map screen

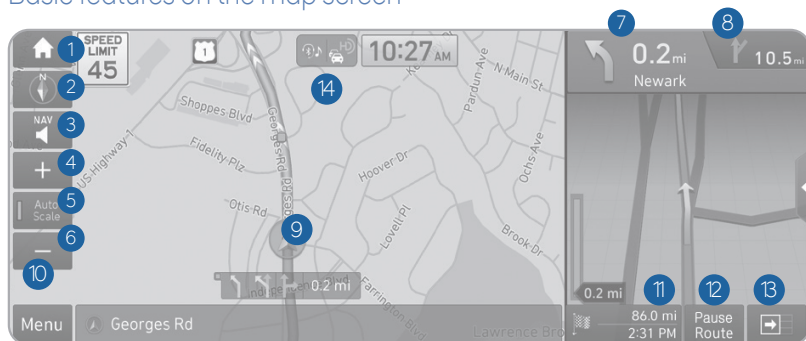

- 1 Displays the Home screen.
- 2 Used to change the map display mode.
- 3 You can adjust the volume of navigation or GPS warning sound.
- 4 Zoom in the map
- 5 The scale of the map automatically changes.
- 6 Zoom out the map
- 7 Guides the point to change the driving direction.
- 8 Guides the next point to change the driving direction.
- 9 Displays the lanes in different colors.
- 10 Displays quick menu items that can be used during a guidance.
- 11 Displays the remaining distance to the destination and the estimated time of arrival. For more details, touch the information item.
- 12 Pause Route (press and hold pause to cancel route)
- 13 Displays or hides the detailed guidance.
- 14 You can see the system information on the map.

Destination search screen

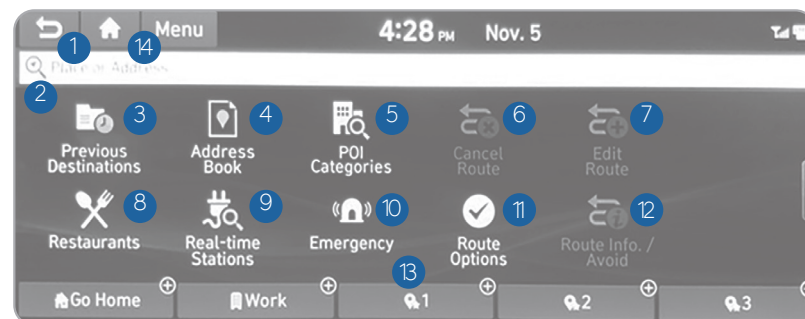

Press **[NAV]** button in the navigation head unit, and finds a destination by using the **[Destination]** menu.

- 1 Returns to the previous step.
- 2 Search for a location by entering various types of keywords such as place name and address.
- 3 Select any of previous destinations to set as a destination.
- 4 Register the location or use the address book for setting a destination.
- 5 Search for POIs by category to set as a destination.
- 6 You can cancel guidance to the destination.
- 7 You can edit the current route so that you can travel via waypoints on the way to the destination.
- 8 You can easily search for restaurants.
- 9 You can set a destination after searching for EV charging stations.
- 10 You can easily search for emergency services.
- 11 You can change the route search criteria to resume routing.
- 12 You can see the entire route information to the destination.
- 13 You can register your home, office, or other frequently visited place as a favorite for ease of search.
- 14 The list of menu items appears.

ANDROID AUTO™

REQUIREMENTS:

- USB cable
- OS Android™ 5.0 or higher
- Compatible Android Phone
- Data and wireless plan for applicable features

BEFORE YOU BEGIN:

- Android Auto features may operate differently than on your phone.
- Message and data charges may apply when using Android Auto.
- Android Auto relies on the performance of your phone. If you experience performance issues:
 - Close all apps and then restart them
 - Disconnect and then reconnect your phone
- Using the USB cable that was provided with your phone is recommended.

ANDROID AUTO SUPPORT



<https://support.google.com/androidauto/>

PHONE SETUP

Turn on Bluetooth® on your phone and connect the micro USB cable to your phone and the USB port on the vehicle.

Phone will prompt you to download the Android Auto app and update other needed apps (e.g. Google Maps™, Google Play Music™, Google Now™).

NOTE: Vehicle must be parked.

- Location mode setting should be set to High accuracy.
- Car and phone setup should be completed in one sitting. If phone setup needs to be resumed, recommend to Force Stop the Android Auto app on the Phone then reopen the app and accept the Disclaimer notifications.

CAR SETUP

1. Press the SETUP button on the radio.
2. Touch the “Device Connections” icon on screen.
3. Select Android Auto
4. Select Enable Android Auto
5. Connect your Android phone to the vehicle USB port. Agree to the notification and disclaimers on your phone then the “Android Auto” icon will appear confirming the setup.

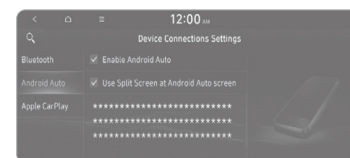

For more detailed information on how to operate Android Auto, please refer to your display audio or navigation manual.

For additional Android Auto support, please refer to the Android Auto Support Website
<https://support.google.com/androidauto/>

Android Auto, Google Play, Android, and other marks are trademarks of Google Inc.

APPLE CARPLAY™

REQUIREMENTS

- Apple Lightning® cable (Apple-certified cable)
- Latest iOS
- iPhone® 5 or above
- Data and wireless plan for applicable features

BEFORE YOU BEGIN

- Apple® CarPlay features may operate differently than on your phone.
- Message and data charges may apply when using Apple CarPlay.
- Apple CarPlay relies on the performance of your phone. If you experience performance issues:
 - Close all apps and then restart them
 - Disconnect and then reconnect your phone
- Using the Apple Lightning cable that was provided with your phone is recommended.

PHONE SETUP

On your phone, go to Settings > General > CarPlay to allow CarPlay access.

On your phone, go to Settings > Siri and ensure Siri is turned ON.

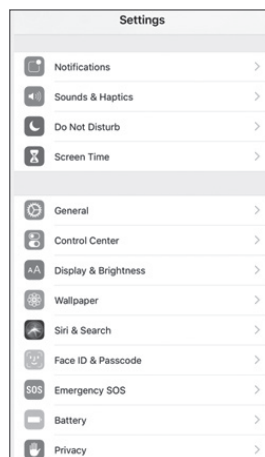

CAR SETUP

1. Press the SETUP button.
2. Touch the “Device Connections” icon on the screen.
3. Touch Apple CarPlay.
4. Touch Enable Apple CarPlay.
5. Connect your Apple iPhone to the vehicle USB port then touch ‘OK’ when the pop-up message appears. The Apple CarPlay icon will now appear on the vehicle Home screen confirming the setup.

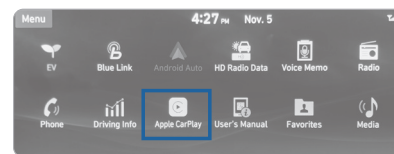

Apple CarPlay, Apple, and other marks are trademarks of Apple Inc.

CarPlay Home Screen

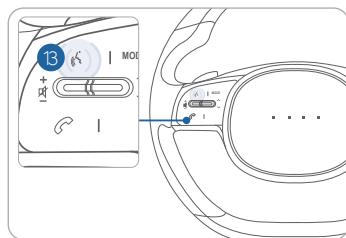

- | | |
|-------------------------|----------------------------------|
| 1 HOME ICON | 7 APPLE MAPS |
| 2 WIRELESS CONNECTIVITY | 8 MESSAGES |
| 3 CELLULAR SIGNAL | 9 3RD PARTY APPS |
| 4 PHONE TIME | 10 SCREEN PAGE INDICATOR |
| 5 PHONE | 11 EXIT TO HYUNDAI |
| 6 APPLE MUSIC™ | 12 CURRENT CARPLAY AUDIO PLAYING |
| | 13 VOICE RECOGNITION |

SIRI

Apple CarPlay uses Siri to perform many actions like sending messages, placing calls, and looking up/setting POI/Destinations. A Siri session can be initiated on any screen by:

1. Touch and holding the HOME icon 1 on the CarPlay screen or
2. Press and hold steering wheel Voice Recognition 13 button.

Note: Ensure Siri feature is set to ON in your phone (Go to Settings > General > Siri).

3. Say any of the following commands;

- “Text <John Smith> ‘Call you later’” to send a text message.
- “Read text messages” to read available text message.
- “Call <John Smith>” to make a phone call.
- “Find <POI/Destination>” to locate a POI/Destination.

PHONE

Touch the PHONE 5 icon to access the Phone screen. Siri will automatically asks ‘Who you would like to call’ when the PHONE 5 icon is selected.

NOTE: Phone call sound quality is dependent on the wired connection. Using the Lightning cable that came with the phone is recommended.

APPLE MUSIC

Touch the APPLE MUSIC 6 icon to access the Apple Music screen.

APPLE MAPS

Touch the APPLE MAPS 7 icon to access the Apple Map screen.

MESSAGES

Touch the MESSAGES 8 icon to access the Message screen. Siri will automatically asks ‘To hear unread messages or create a new one’ when the MESSAGE icon is selected.

3rd PARTY APPS

Supported CarPlay apps that are downloaded on your phone will appear on the CarPlay screen. Touch the apps icons to access those supported apps.

NOTE: A list of the supported CarPlay supported apps can be found at <http://www.apple.com/ios/carplay/>

Ensure phone has latest version of the 3rd Party Apps.

SHIFT BY WIRE GEAR SELECTOR

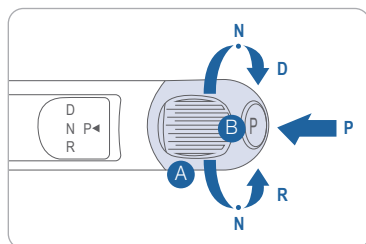

To change the gear, depress the brake pedal and rotate the rotary gear shift dial.

- A Rotary gear shift dial
- B P (Park) button

To shift the gear to P (Park), press the P button while depressing the brake pedal.

If you turn the vehicle off in R (Reverse), N (Neutral) or D (Drive), the gear will automatically shift to P (Park).

REGENERATIVE BRAKE LEVEL CONTROL PADDLES

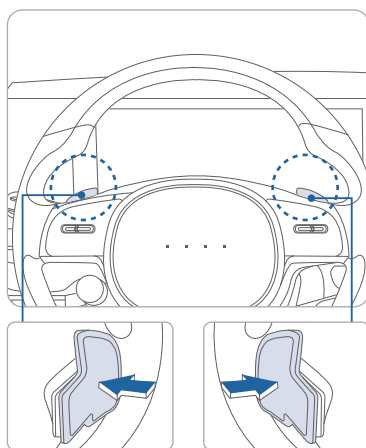

The paddle shifter is used to adjust the regenerative braking rate from 0 to 3 during decelerating or braking.

- Left side (⬅️): Increases regenerative braking and deceleration.
- Right side (➡️): Decreases regenerative braking and deceleration.

The paddle shifter does not operate.

- When the two paddle shifters are pulled at the same time.
- When the Cruise Control system or Advanced Cruise Control system is activated.

NOTE: There is an available "Smart Automatic Regeneration" mode that will automatically adjust regenerative braking to slow the vehicle down as it approaches traffic. Refer to the owners manual for more detailed information.

Q. What are the advantages of regenerative braking?

- A. Regenerative braking is a technology in which the electric motor connects to the generator to charge the battery during deceleration and braking. Using regenerative braking reduces energy loss and extends the drivable range, resulting in increased fuel efficiency. It is good to use regenerative braking in urban areas where braking is frequent.

Q. There is a feeling of deceleration during regenerative braking, is that normal?

- A. When the vehicle decelerates during regenerative braking, there is a feeling of deceleration, so much so the driver can feel it. The higher the regenerative braking level, the greater the feeling of deceleration. This is normal.

NOTE: Pulling the (+) paddle shifter (⬅️) while coasting may activate the one pedal driving feature, resulting in a vehicle stop. For more information, see "One pedal driving" in the owner's manual.

Q. How does regenerative braking differ by level?

- A. There are four levels (from 0 to 3) of regenerative braking, and you can change the levels using the paddle shifter (⬅️, ➡️) on either side of the steering wheel.

Level	Description
1-3	The higher the regenerative braking level during coasting, the greater the vehicle deceleration and battery charging amount (regenerative amount).
0	The brake disc cleaning feature will run about 10 times. During operation, regenerative braking performance may be reduced. Because of this, the fuel efficiency may decrease.

NOTE: Depending on the drive mode (NORMAL/ECO/SPORT/SNOW), there are different levels of regenerative braking that you can use. For more information, see "Regenerative braking system" in the owner's manual.

SMART CRUISE CONTROL

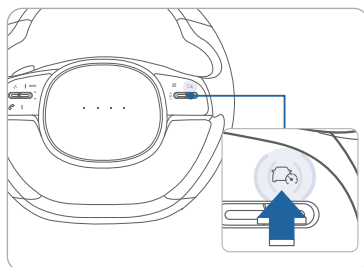

Turning on Smart Cruise Control

Press the Driving Assist () button to turn on Smart Cruise Control. The speed will be set to the current speed on the cluster.

Setting vehicle distance

Each time the button is pressed, the headway changes as follows:



Increasing set speed

Push the + switch up and release it immediately. The set speed will increase by 1mph (1 km/h) each time the switch is operated in this manner.

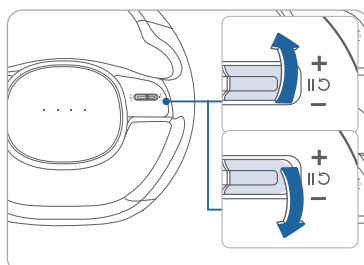

Decreasing set speed

Push the - switch down and release it immediately. The set speed will decrease by 1mph (1 km/h) each time the switch is operated in this manner.

Note: Quick toggle up/down will change speed by 1 mph. Holding switch up/down will change speed by 10 mph.

Temporarily canceling Smart Cruise Control

Press the II switch or depress the brake pedal to temporarily cancel Smart Cruise Control.

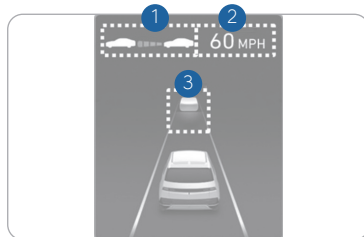

ELECTRONIC PARKING BRAKE (EPB)

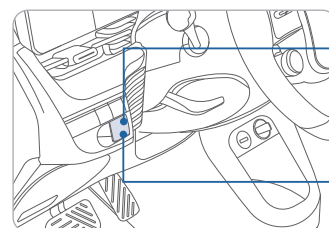

Applying

Stop the vehicle then pull up the EPB switch

Releasing

Press the EPB switch while depressing the brake pedal.

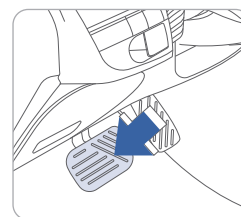

Automatic releasing

- When shifted to P: Depress the brake pedal and shift out of P to R or D.
- When shifted to N: Depress the brake pedal and shift out of N to R or D.

HIGHWAY DRIVING ASSIST (HDA) (if equipped)

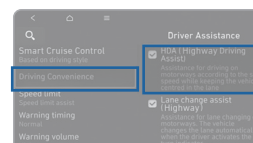

The Highway Driving Assist (HDA) system helps keep the vehicle between lanes, maintain a distance with the vehicle ahead, and automatically adjusts the vehicle speed to the speed limit while driving on the highway.

NOTE: If the vehicle is turned off then on again, the system maintains the last setting.

With the vehicle on, select or deselect 'Driver Assistance → Driving Convenience' from the Settings menu to set whether to use each function.

- If 'Highway Driving Assist' is selected, it helps maintain distance from the vehicle ahead, maintain the set speed, and helps center the vehicle in the lane.

Operating Conditions:

- Driving on the highway main line.
- Smart Cruise Control is operating.
- If the Smart Cruise Control is in the READY state the Highway Driving Assist will be in the READY state. The indicator on the cluster will illuminate white.
- Vehicle speed is under 95 mph (153 km/h).

If all the mentioned conditions are satisfied, the system is ENABLED and the indicator on the cluster will illuminate green.

LANE KEEPING ASSIST SYSTEM (LKA)

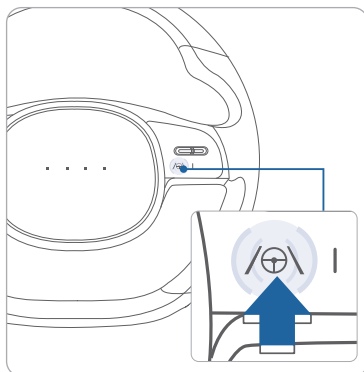

The Lane Keeping Assist System detects lane markers on the road with a camera and assists the driver's steering to help keep the vehicle between lanes. The system operates when the vehicle speed is between 40 mph and 110 mph

- To turn on the LKA, Press and hold to turn on LKA.
- To turn off the LKA, Press and hold again to turn off LKA.

NOTE: In some circumstances, LKA may not activate as intended. ex: blurred lane condition, backlight, heavy fog, reflection of light due to water on the road, sharp bend in the road, etc. Please refer to the Owner's Manual for more information.

FORWARD COLLISION-AVOIDANCE ASSIST (FCA)

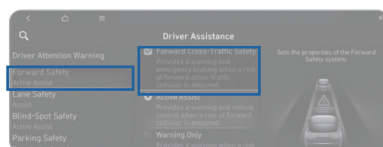

Forward Collision-Avoidance Assist (FCA) system is designed to help detect and monitor the vehicle ahead in the roadway through camera recognition to warn the

driver that a collision is imminent, and if necessary, apply emergency braking. On vehicles equipped with both front view camera and front radar sensor, a cyclist detection is also available.

Setting Forward Safety function

The driver can activate FCA by placing the ignition switch to the ON position and by selecting:

Driver Assistance → Forward Safety' from the Settings menu to set whether or not to use each function.

Warning Only- Braking assist is not applied

Off- System deactivates

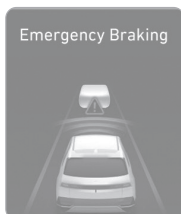

VIRTUAL ENGINE SOUND SYSTEM (VESS)

The Virtual Engine Sound System (VESS) generates engine sound for pedestrians to hear vehicle sound because there is no sound while the Electric Vehicle (EV) is operating.

- If the vehicle is moving at low speed, the VESS will operate.
- When the gear is shifted to R (Reverse), an additional warning sound will be heard.

BLIND-SPOT COLLISION WARNING (BCW)

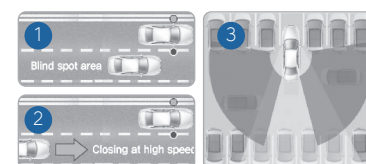

Blind-Spot Collision Warning (BCW) system uses radar sensors in the rear bumper to monitor and warn the driver when it detects an approaching vehicle in the driver's blind spot area.

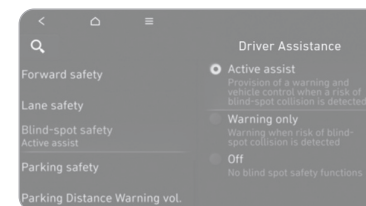

- 1 Blind-Spot Area
- 2 Lane Departure Warning
- 3 Rear Cross-Traffic Collision Warning

To turn on/off select or deselect 'Driver Assistance → Blind-Spot Safety' from the Settings menu to set whether to use each function.

Rear Cross-Traffic Collision Warning

When the vehicle is in R (reverse), the system provides an alert if a vehicle is approaching from the sides.

TIRE PRESSURE MONITORING SYSTEM (TPMS)

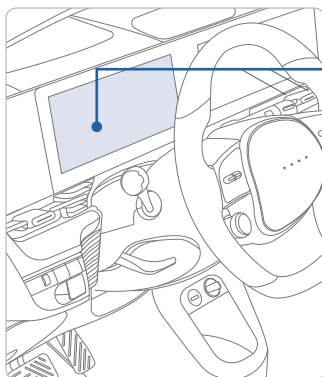

Low Tire Pressure Indicator / TPMS Malfunction Indicator



Low Tire Pressure / Tire Pressure Monitor / TPMS Malfunction Display (shown on the cluster LCD display)

LOW TIRE PRESSURE INDICATOR



Illuminates if one or more of your tires are significantly under-inflated.

TPMS MALFUNCTION INDICATOR

Blinks for approximately one minute, then remains illuminated when there is a malfunction with the TPMS. Inspect all tires and adjust the tire pressure to specification. If the lamp remains illuminated, we recommend the vehicle be checked by an authorized HYUNDAI dealer.

LOW TIRE PRESSURE / TIRE PRESSURE MONITOR / TPMS MALFUNCTION DISPLAY(LCD DISPLAY)

Select the Driving Assist mode  by pressing the mode button on the steering wheel to display tire pressure.

Tire pressures will display after driving a short distance. If a tire pressure drops lower than predetermined specification, the Low Tire Pressure Indicator  will illuminate and the cluster  display will indicate tire(s) requiring air.

NOTE: Environmental factors can affect the tire pressure. The two main environmental factors are ambient air temperature and elevation. Colder ambient air will reduce tire pressure, while hotter ambient air will increase tire pressure. High elevation may also increase tire pressure.

DIGITAL KEY PAIRING (if equipped)

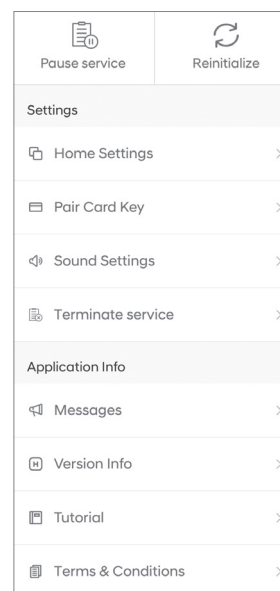
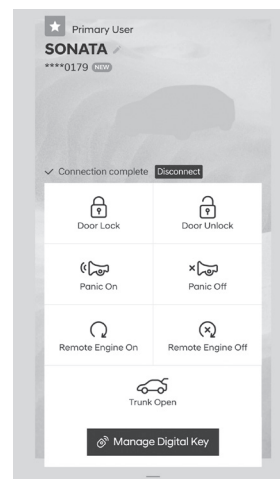

Hyundai Digital Key allows drivers to start the engine of their car using a smartphone app and Near-Field Communication (NFC). Hyundai Digital Key provides many of the same functions as your physical key. To pair your smartphone, complete the following steps:

1. Login to the Hyundai Digital Key Application using your MyHyundai username and password
2. Start the vehicle with the proximity key
3. Pair the phone to the vehicle as follows:
 - Navigation Vehicles: Settings → Vehicle → Digital Key → Smartphone Key → Save
 - Display Audio: Instrument Cluster User Settings Mode → Digital Key → Smartphone Key → Save
4. Open the Hyundai Digital Key Application on the primary user's smartphone. Select the + Icon on the main screen of the smartphone app.
5. Place the smartphone on the Wireless Phone Charger in the vehicle and the process will begin automatically
6. Once the screen in the vehicle says saved, your Digital Key is ready to use.

NOTE: This application is only available for Android users.

If the NFC card is lost or stolen, please contact your local Hyundai dealer for replacement.

NEAR FIELD COMMUNICATION (NFC)

Hyundai Key Card

1234 5678

Pair Card Key authentication

Authenticate using NFC

Authenticate using BLE

To lock/unlock your vehicle using the NFC key card, hold the key card up to the center of the door handle **A**.

If you try to lock your vehicle with the NFC card under the following conditions, it will not work:

- The Smart Key is in the vehicle.
- The POWER button is in ACC or ON position.
- Any of the doors, hood and trunk are open.

NOTE: If you overlap and use the key card with other NFC-enabled cards such as a transportation card or credit card, it will not work.

*For security reasons, the vehicle can only have one NFC key card paired to it at one time. Any time that a new Key card is paired to the car it will disable the previously paired Key Card .

DRIVE MODE

You can set the proper drive mode according to the road conditions or your driving habits.

Press the DRIVE MODE button on the steering wheel.

- Pressing the button repeatedly changes the drive mode, and the changed mode is displayed on the instrument cluster.
- To change to snow mode, press and hold the button.

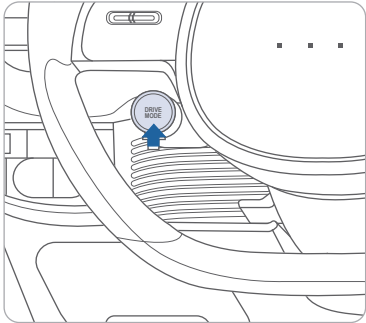

Level	Description
NORMAL	Ordinary driving mode.
ECO	Drive mode for fuel efficiency. This mode results in driving at a constant speed without rapid acceleration or deceleration.
SPORT	Drive mode for sporty and dynamic driving. This mode reacts sensitively when you press down on the pedal or rotate the steering wheel. The fuel efficiency may decrease.
SNOW	Drive mode for driving on icy or rainy roads which are slippery. This mode helps with stable acceleration and reduces tire slipping.

IONIQ ELECTRIC CUSTOMER DELIVERY CHECKLIST

CUSTOMER NAME	DEALERSHIP NAME
SALES CONSULTANT	DATE
VIN	

BEFORE DELIVERY

- ☐ SET TIRE PRESSURE LF__RF__RR__LR__
- ☐ VERIFY VEHICLE IS CLEAN, IN GOOD CONDITION, FREE OF CHIPS AND SCRATCHES · CLEAN WINDSHIELD AND BACK WINDOW
- ☐ ENSURE FLOOR MATS ARE SNAPPED INTO PLACE

WALK THE CUSTOMER THROUGH EACH OF THE FOLLOWING KEY DELIVERY FEATURES

- ☐ REVIEW QUICK REFERENCE GUIDE
- ☐ PAIR CUSTOMER'S PHONE TO THE BLUETOOTH SYSTEM
- ☐ OPERATION OF THE NAVIGATION SYSTEM
- ☐ REVIEW AND TEAR OFF VOICE COMMAND / QUICK TIP CARD
- ☐ OPERATION OF THE AUDIO SYSTEM

CONNECTING YOUR PHONE

On the radio:

1. Push the **SETUP** button.
2. Select **Bluetooth**.
3. Select **Bluetooth Connection**.
4. Select **Add New**.

In your phone's Bluetooth settings:

5. Select the <Vehicle Name> on your phone.
6. Enter the passkey from the radio or accept the authorization pop-up on your phone.

SWITCHING BETWEEN PAIRED PHONES

Using Voice Command: "Change Bluetooth device"

On the radio:

1. Push the **SETUP** button.
2. Select **Bluetooth**.
3. Select **Bluetooth Connection**.
4. Select **Connect** next to the desired phone.

For more information, visit HyundaiBluetooth.com